

DATE	
BY	
REVISIONS	
PLANNED	
CHECKED	
NO. 1	
NO. 2	
NO. 3	
NO. 4	
NO. 5	

DATE	
BY	
REVISIONS	
PLANNED	
CHECKED	
NO. 1	
NO. 2	
NO. 3	
NO. 4	
NO. 5	

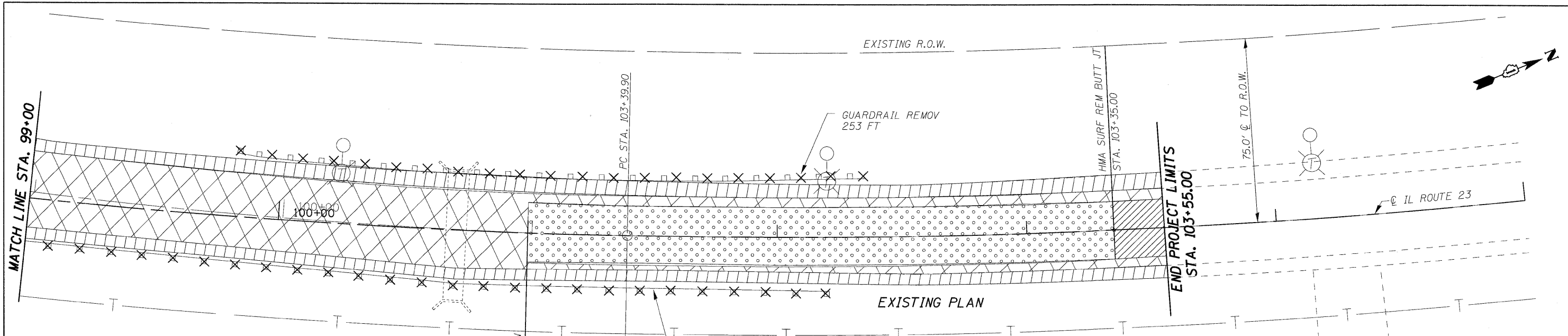

EXISTING PLAN LEGEND

- HMA SURF REM BUTT JT
- PAVED SHLD REMOVAL
- HMA SURF REM VAR DP
- PAVEMENT REM
- APPROACH SLAB REM 2 @ 30'-0" BY 46'-0"

PROPOSED PLAN LEGEND

- BR APPR PVT CON (FLX)
- BRIDGE APPROACH SLAB, PAID AS CONCRETE SUPERSTRUCTURE, 2 @ 30'-0" BY 48'-4"
- BIT MATLS PR CT, HMA SC "D" N70, 1 1/2", HMA BC IL-19.0 N70, 2 1/4", & LEV BIND MM N70, 3/4"
- HMA SC "D" N70, 2", HMA BC IL-19.0 N70, 2 1/4", HMA BASE CSE 10, & AGG SUBGRADE 12 SHALL BE PAID FOR AS HMA PAVT FD 1 1/4"
- BIT MATLS PR CT, & HMA SHOULDERS 6

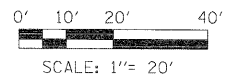
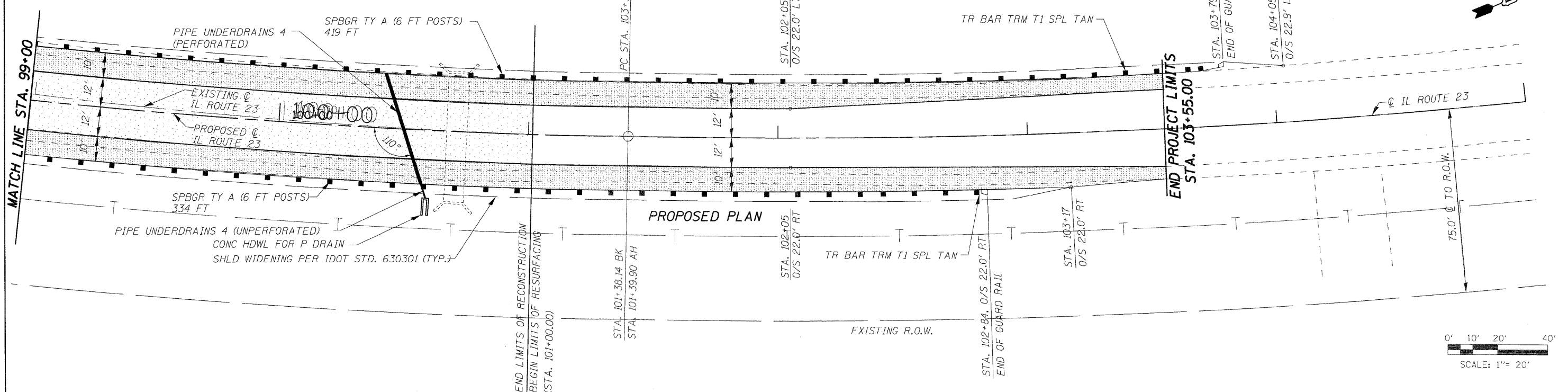

LOCO, INC.
CONSULTING ENGINEERS
1560 WALL ST, SUITE 222
NAPERVILLE, ILLINOIS 60563 PH: (630) 577-9100

DESIGNED	- MJY, ST	REVISED	-
DRAWN	- ST	REVISED	-
CHECKED	- MJY	REVISED	-
DATE	- 12/30/2010	REVISED	-

**STATE OF ILLINOIS
DEPARTMENT OF TRANSPORTATION**

**EXISTING AND PROPOSED PLAN
IL ROUTE 23 OVER COON CREEK**

SCALE: 1" = 20' SHEET NO. 3 OF 3

STA. 99+00 TO STA. 103+55

F.A.P. RTE. NO.	SECTION	COUNTY	TOTAL SHEETS	SHEET NO.
324	24 B-2	McHENRY	76	16
D-91-178-09			CONTRACT NO. 60F64	
FED. ROAD DIST. NO. ILLINOIS FED. AID PROJECT				