

FINAL SURVEY SUPERSEDED BY DATE
 SURVEY PLOTTED
 NOTE BOOK TEMPLATE AREAS CHECKED
 NO. _____

ORIGINAL SURVEY SUPERSEDED BY DATE
 SURVEY PLOTTED
 NOTE BOOK TEMPLATE AREAS CHECKED
 NO. _____

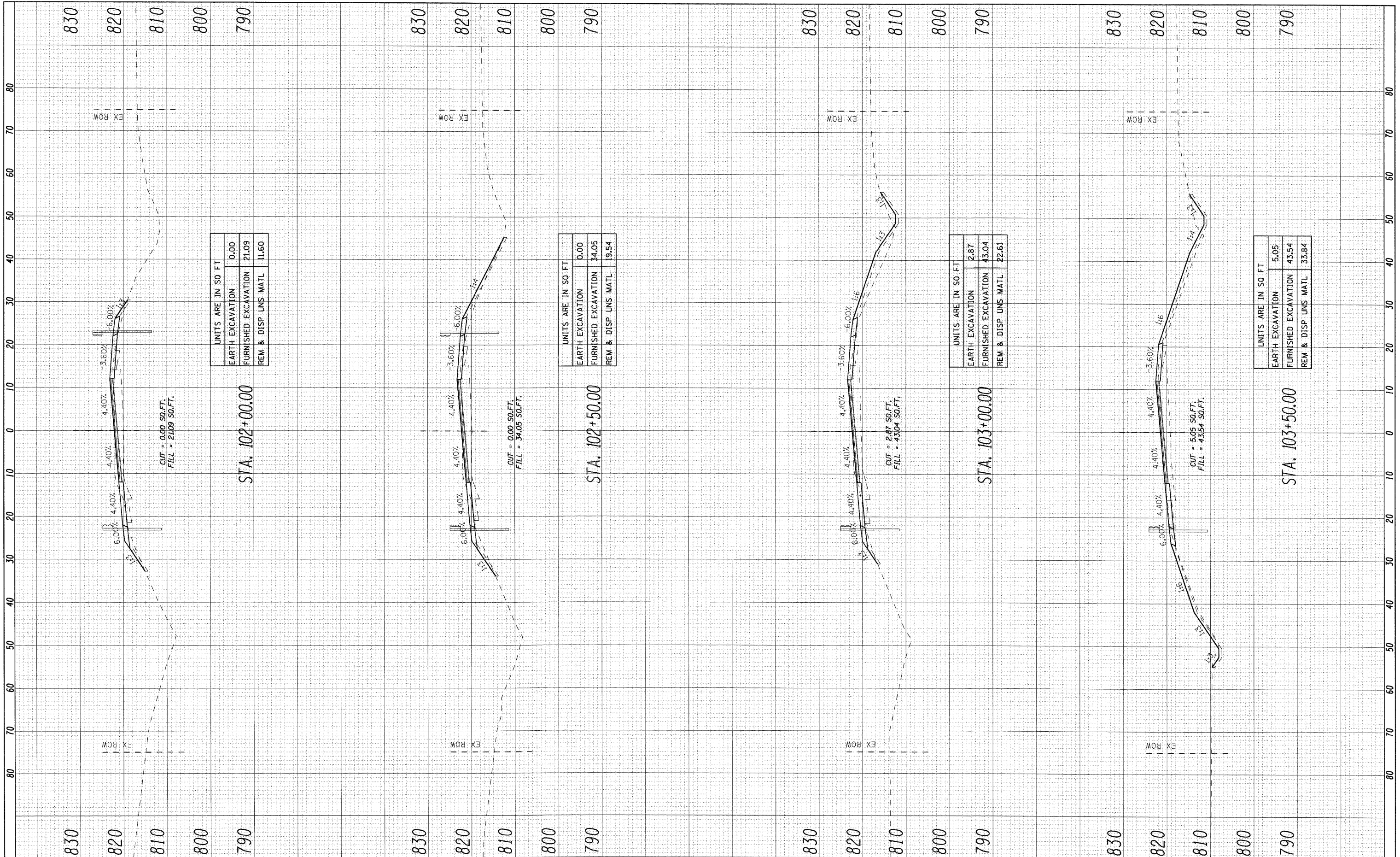

LONCO INC.
 CONSULTING ENGINEERS
 1560 WAL. ST. SUITE 222
 NAPERVILLE, ILLINOIS 60563 PH (630) 577-9100

DESIGNED - ST
 DRAWN - ST
 CHECKED - MJY, SLV
 DATE - 12/30/2010

REVISED -
 REVISED -
 REVISED -
 REVISED -

**STATE OF ILLINOIS
 DEPARTMENT OF TRANSPORTATION**

**CROSS SECTIONS
 IL ROUTE 23 OVER COON CREEK**
 SCALE: 1" = 20' SHEET NO. 10 OF 12 SHEETS STA. 102+00 TO STA. 103+50

F.A.P. RTE. 324	SECTION 24B-1	COUNTY McHENRY	TOTAL SHEETS 76	SHEET NO. 64
D-91-116-09			CONTRACT NO. 60F64	
ILLINOIS FED. AID PROJECT				