

R 10 E R 11 E

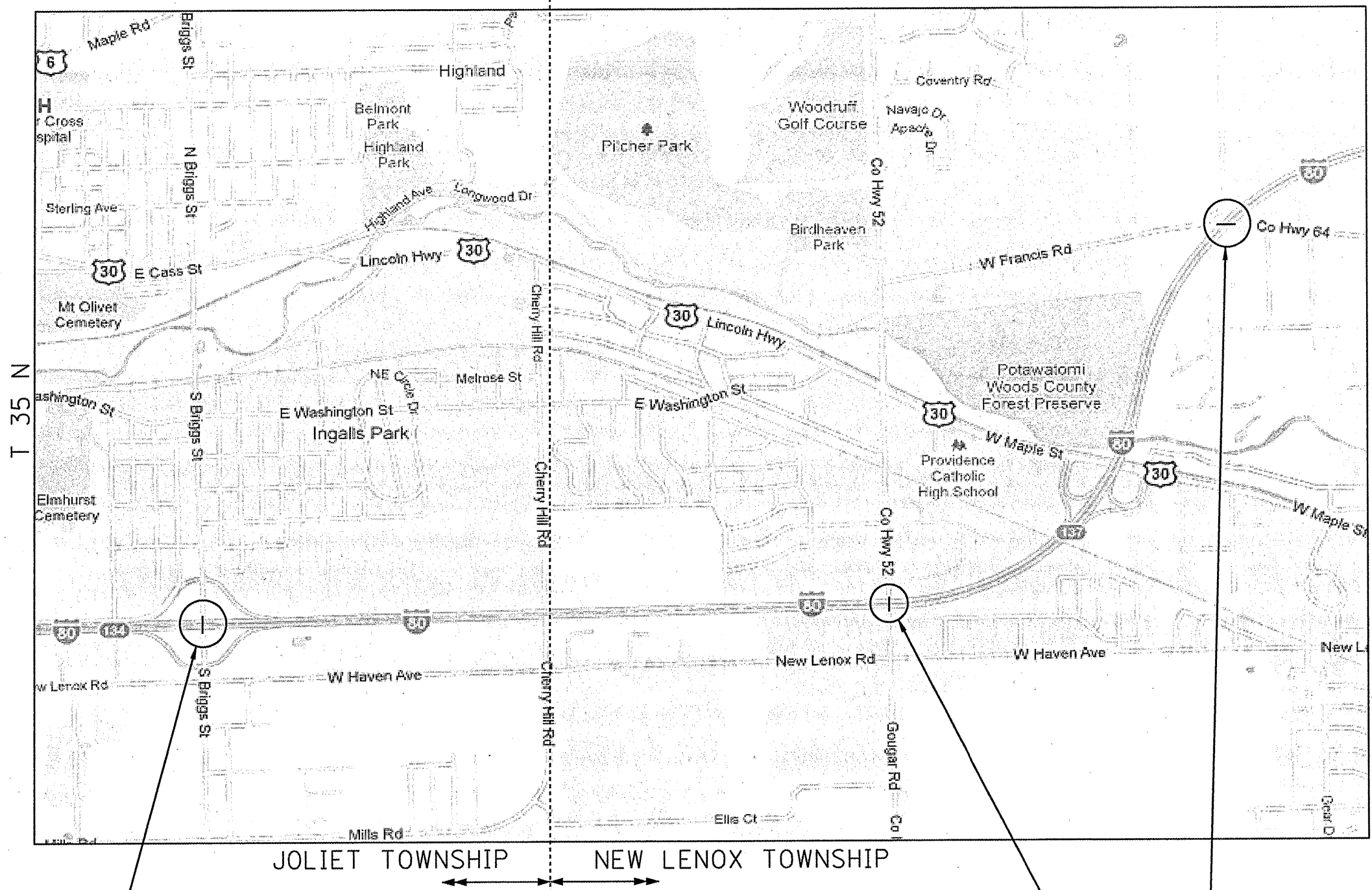

LOCATION 7
BRIGGS ST OVER I-80
VILLAGE OF JOLIET, WILL COUNTY
(SN 099-0216)

TRAFFIC DATA: (I-80)
SPEED LIMIT = 55 MPH
2009 ADT = 87,200

LOCATION 6
GOUGAR RD OVER I-80
VILLAGE OF NEW LENOX,
WILL COUNTY
(SN 099-0203)

TRAFFIC DATA: (I-80)
SPEED LIMIT = 65 MPH
2007 ADT = 75,700

LOCATION 5
FRANCIS RD OVER I-80
VILLAGE OF NEW LENOX,
WILL COUNTY
(SN 099-0205)

TRAFFIC DATA: (I-80)
SPEED LIMIT = 65 MPH
2009 ADT = 80,500

STATE OF ILLINOIS
DEPARTMENT OF TRANSPORTATION

LOCATIONS 5 - 7
LOCATION MAPS

SCALE: SHEET NO. OF SHEETS STA. TO STA.

F.A.I. RTE.	SECTION	COUNTY	TOTAL SHEETS	SHEET NO.
VAR	2010-064-I	VARIOUS	28	6
CONTRACT NO.			60L45	
FED. ROAD DIST. NO. 1 ILLINOIS FED. AID PROJECT				