

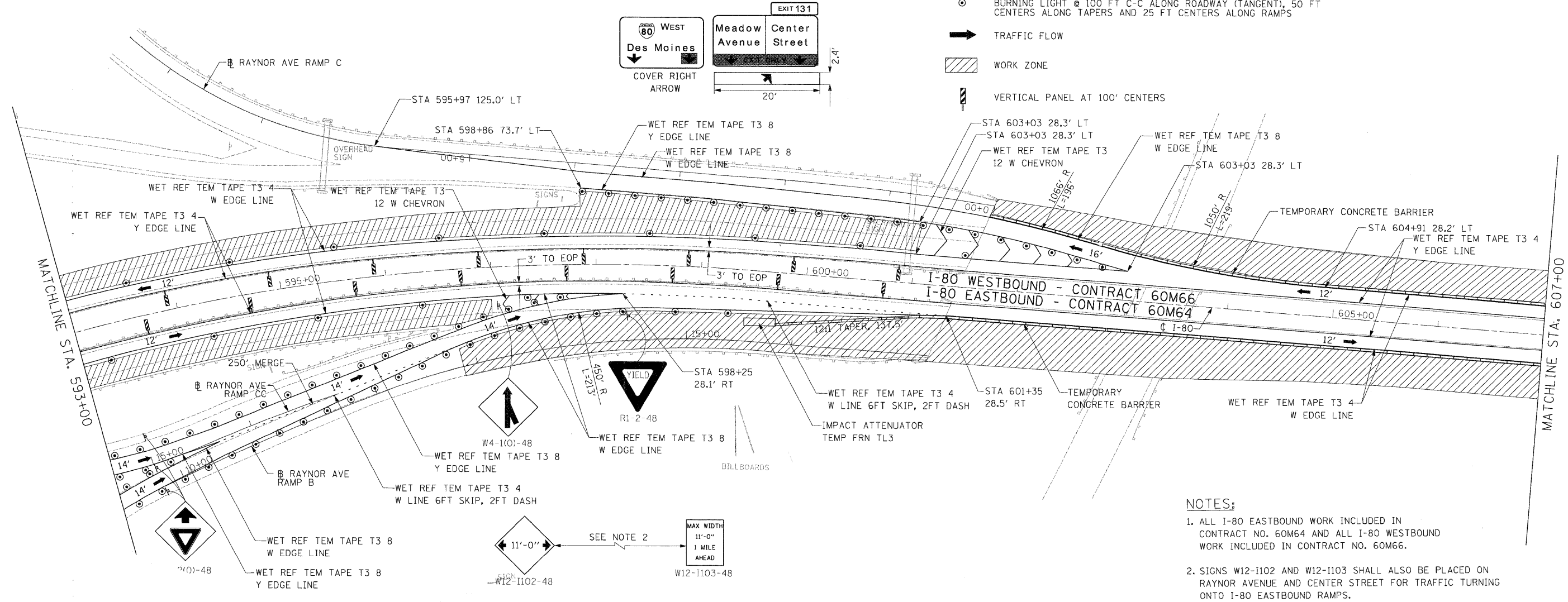

LEGEND:

- TRAFFIC CONTROL SIGN
- ARROW BOARD
- TYPE II BARRICADE OR DRUM WITH MONO-DIRECTIONAL STEADY BURNING LIGHT @ 100 FT C-C ALONG ROADWAY (TANGENT), 50 FT CENTERS ALONG TAPERS AND 25 FT CENTERS ALONG RAMPS
- TRAFFIC FLOW
- WORK ZONE
- VERTICAL PANEL AT 100' CENTERS



- NOTES:**
1. ALL I-80 EASTBOUND WORK INCLUDED IN CONTRACT NO. 60M64 AND ALL I-80 WESTBOUND WORK INCLUDED IN CONTRACT NO. 60M66.
 2. SIGNS W12-I102 AND W12-I103 SHALL ALSO BE PLACED ON RAYNOR AVENUE AND CENTER STREET FOR TRAFFIC TURNING ONTO I-80 EASTBOUND RAMPS.

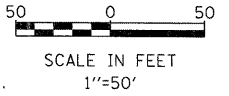

DESIGNED - JK	REVISIONS
DRAWN - JK	REVISIONS
CHECKED - RR	REVISIONS
DATE - 01/21/2011	REVISIONS



**STATE OF ILLINOIS
DEPARTMENT OF TRANSPORTATION**

**MAINTENANCE OF TRAFFIC - STAGE 1
I-80 MAINLINE**

SCALE: 1"=50'	SHEET NO. 5 OF 11 SHEETS	STA. 593+00.00 TO STA. 607+00.00
---------------	--------------------------	----------------------------------

F.A.I. RTE.	SECTION	COUNTY	TOTAL SHEETS	SHEET NO.
80	99(2&3)RS-3	WILL	200	39
FED. ROAD DIST. NO.	ILLINOIS FED. AID PROJECT			CONTRACT NO. 60M64