

LEGEND:

- ⊥ TRAFFIC CONTROL SIGN
- ➡ ARROW BOARD
- ⊙ TYPE II BARRICADE OR DRUM WITH MONO-DIRECTIONAL STEADY BURNING LIGHT @ 100 FT C-C ALONG ROADWAY (TANGENT), 50 FT CENTERS ALONG TAPERS AND 25 FT CENTERS ALONG RAMPS
- ➡ TRAFFIC FLOW
- ▨ WORK ZONE
- ⊥ VERTICAL PANEL WITH MONO-DIRECTIONAL STEADY BURNING LIGHT AT 100' CENTERS

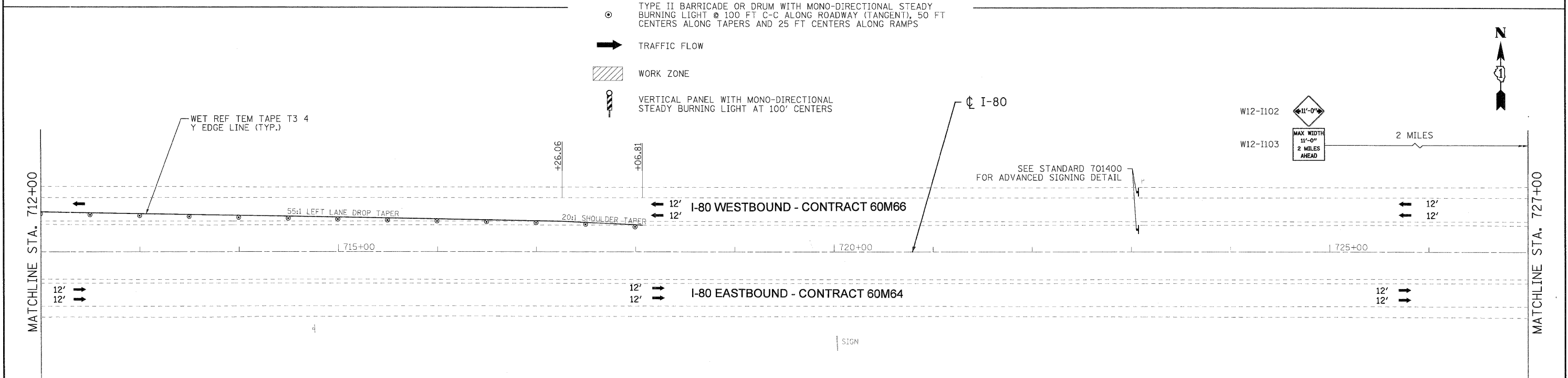

- NOTES:**
- ALL I-80 EASTBOUND WORK INCLUDED IN CONTRACT NO. 60M64 AND ALL I-80 WESTBOUND WORK INCLUDED IN CONTRACT NO. 60M66.
 - SIGNS W12-I102 AND W12-I103 SHALL ALSO BE PLACED ON BRIGGS STREET AND US ROUTE 30 FOR TRAFFIC TURNING ONTO THE I-80 WESTBOUND RAMPS.

USER NAME = tkoppen@rdwy.lisle	DESIGNED - MJV	REVISED -		STATE OF ILLINOIS DEPARTMENT OF TRANSPORTATION	MAINTENANCE OF TRAFFIC - STAGE 2 I-80 MAINLINE	F.A.I. RTE.	SECTION	COUNTY	TOTAL SHEETS	SHEET NO.
PLOT CONFIG = PDF(arge).plt	DRAWN - MJV	REVISED -				80	99 (2 & 3) RS-3	WILL	200	56
PLOT SCALE = 1:50	CHECKED - DTH	REVISED -				CONTRACT NO. 60M64				
PLOT DATE = 1/23/2011	DATE - 1/21/2011	REVISED -				FED. ROAD DIST. NO. 1 ILLINOIS FED. AID PROJECT				
FILE NAME = ...ND160M64-sht-staging-02-03.dgn			SCALE: 1"=50'		SHEET NO. 11 OF 11 SHEETS	STA. 697+00.00 TO STA. 727+00.00				