

℄ I-80

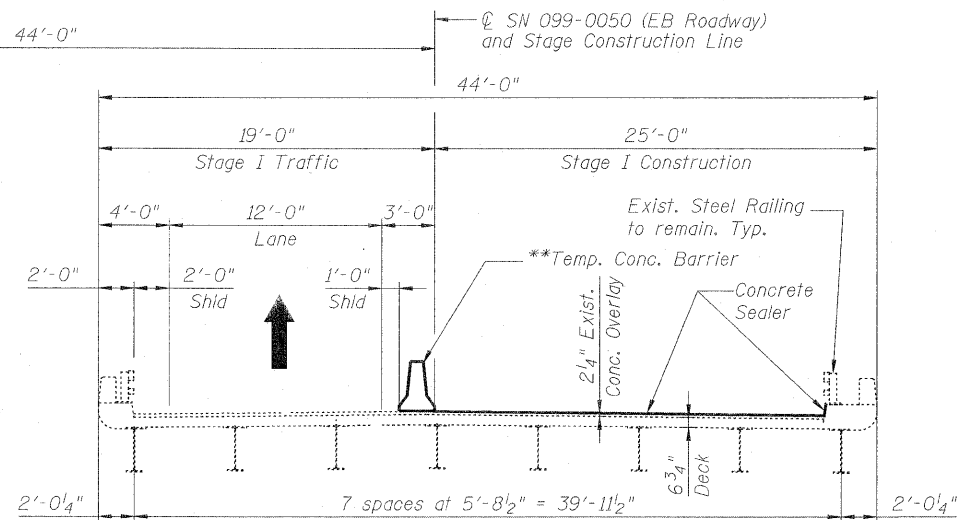

STAGE I CONSTRUCTION & TRAFFIC

(Looking East)

℄ I-80

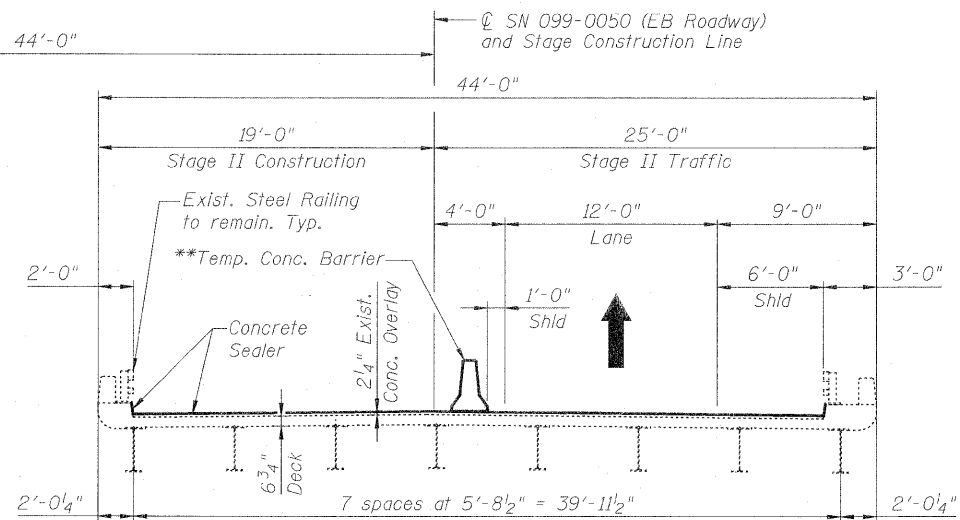

STAGE II CONSTRUCTION & TRAFFIC

(Looking East)

** After removal of temporary concrete barrier, repair dowel holes with non-shrink epoxy grout as directed by the Engineer. Cost of anchorage and repair is included with Temporary Concrete Barrier.

USER NAME = ajorgicoglu(Rdwy_L1s1e)	DESIGNED - A.Y./L.C.	REVISED -
PLOT CONFIG = PDF(I-80_TopoGray_Large).pl	DRAWN - L.C./A.Y.	REVISED -
PLOT SCALE = 1:5.33334	CHECKED - A.Y./R.L.D.	REVISED -
PLOT DATE = 2/8/2011	DATE - 01/21/2011	REVISED -



STATE OF ILLINOIS
DEPARTMENT OF TRANSPORTATION

CONSTRUCTION STAGING
EASTBOUND I-80 OVER MIDLAND AVENUE
SN 099-0050

SCALE: SHEET S2 OF S6 STA. TO STA.

F.A. RTE.	SECTION	COUNTY	TOTAL SHEETS	SHEET NO.
80	99 (2&3) RS-3	WILL	200	92
FED. ROAD DIST. NO. 1 ILLINOIS FED. AID PROJECT			CONTRACT NO. 60M64	