

Existing Structure: S.N. 099-0055 carrying I-80 Eastbound over Southbound Center Street to Eastbound I-80 Ramp was originally constructed in 1964 as FAI Route 80, Section 99-3HB-2. The structure consists of a single span wide flange beam and reinforced concrete deck superstructure supported by stub abutments. The skew is 49°26'38" forward right tangent to ϕ I-80 at Sta. 590+22.78. The deck was repaired in 1992 and 2001.

Stage construction shall be utilized to maintain traffic during construction.

No salvage.

INDEX OF SHEETS

1. General Plan, Notes & Total Bill of Material
2. Construction Staging
3. Deck, Joint and Abutment Repair Details
4. Protective Shield, Special
5. Temporary Concrete Barrier for Stage Construction

TOTAL BILL OF MATERIAL

ITEM	UNIT	SUPER	SUB	TOTAL
Polymerized Hot-Mix Asphalt Surface Course, Stone Matrix Asphalt, N80	Ton	56	-	56
Protective Shield, (Permanent)	Sq. Yd.	360	-	360
Hot-Mix Asphalt Surface Removal (Deck)	Sq. Yd.	492	-	492
Structural Repair of Concrete (Equal to or Less Than 5")	Sq. Ft.	-	190	190
Deck Slab Repair (Full Depth, Type II)	Sq. Yd.	13	-	13
Deck Slab Repair (Partial)	Sq. Yd.	63	-	63
Silicone Joint Sealer, 2"	Foot	138	-	138
Temporary Shoring and Cribbing	Each	-	1	1
Polymer Concrete	Cu. Ft.	5	-	5

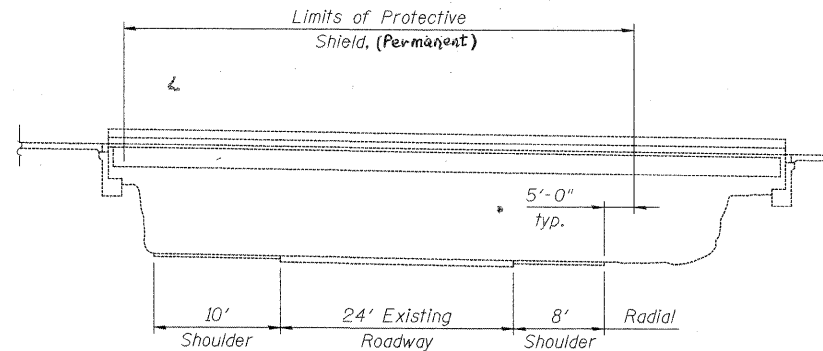

ELEVATION

* Note:
Structure No. 099-0188 not shown. The minimum vertical clearance above SN 099-0055 is 16'-3".

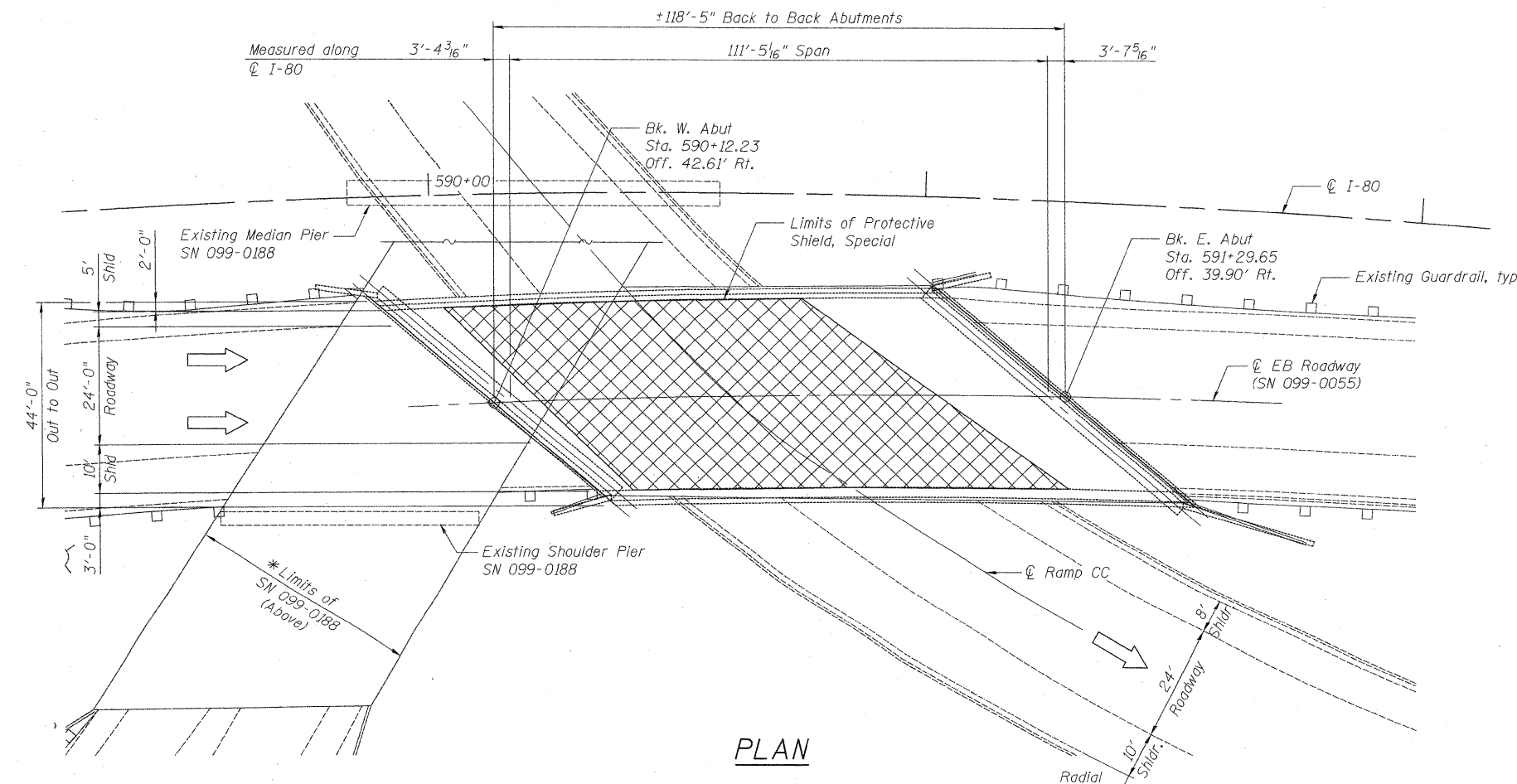

PLAN

SCOPE OF WORK

1. Install Protective Shield, (Permanent)
2. Remove existing HMA overlay.
3. Deck slab repair (full and partial depth).
4. Remove and replace silicone joint seals.
5. Repair structural concrete of abutments.
6. Apply HMA overlay.

DESIGN SPECIFICATIONS

2002 AASHTO, Standard Specifications for Highway Bridges, 17th Edition

DESIGN STRESSES

$f'c = 3,500$ psi

GENERAL NOTES

1. Reinforcement bars shall conform to the requirements of ASTM A 706 Grade 60. See Special Provisions.
2. Protective Shield, Special shall be installed as shown in the plans and shall be installed prior to start of deck slab repair work. See Special Provision for installation requirements of protective shield adjacent to existing underpass luminaires.
3. Plan dimensions and details relative to existing plans are subject to nominal construction variations. The Contractor shall field verify existing dimensions and details affecting new construction and make necessary approved adjustments prior to construction or ordering of materials. Such variations shall not be cause for additional compensation for a change in scope of the work, however, the Contractor will be paid for the quantity actually furnished at the unit price bid for the work.
4. Areas of proposed deck repairs are estimated. Actual type, location and dimension of deck repairs are to be determined by the Engineer during construction.
5. See Roadway Plans for Ramp CC maintenance of traffic details.

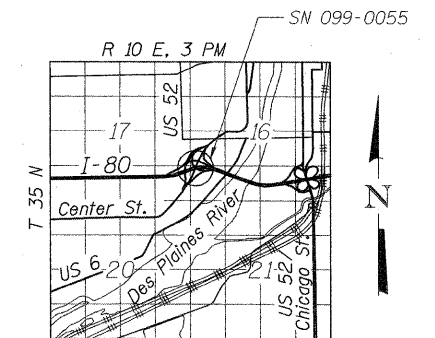

LOCATION SKETCH



SIGNED: *Brian L. Umbright*
DATE: Jan. 19, 2011
EXPIRES: November 30, 2012

DESIGNED - DF	REVISIONS
DRAWN - LAM	1. CHECKED - BLU
CHECKED - BLU	2. DATE - 01/21/2011
DATE - 01/21/2011	



STATE OF ILLINOIS
DEPARTMENT OF TRANSPORTATION

GENERAL PLAN, NOTES & TOTAL BILL OF MATERIAL
EASTBOUND FAI-80 OVER CENTER STREET RAMP CC
STRUCTURE NO. 099-0055
SHEET NO. S-1 OF S-5 SHEETS

F.A.I. RTE.	SECTION	COUNTY	TOTAL SHEETS	SHEET NO.
80	9912&3RS-3	WILL	200	103
FED. ROAD DIST. NO.	ILLINOIS FED. AID PROJECT	CONTRACT NO. 60M64		