

STAGE I CONSTRUCTION & TRAFFIC

(Looking East)

* Varies 3'-9 11/16" to 7'-4 1/4"

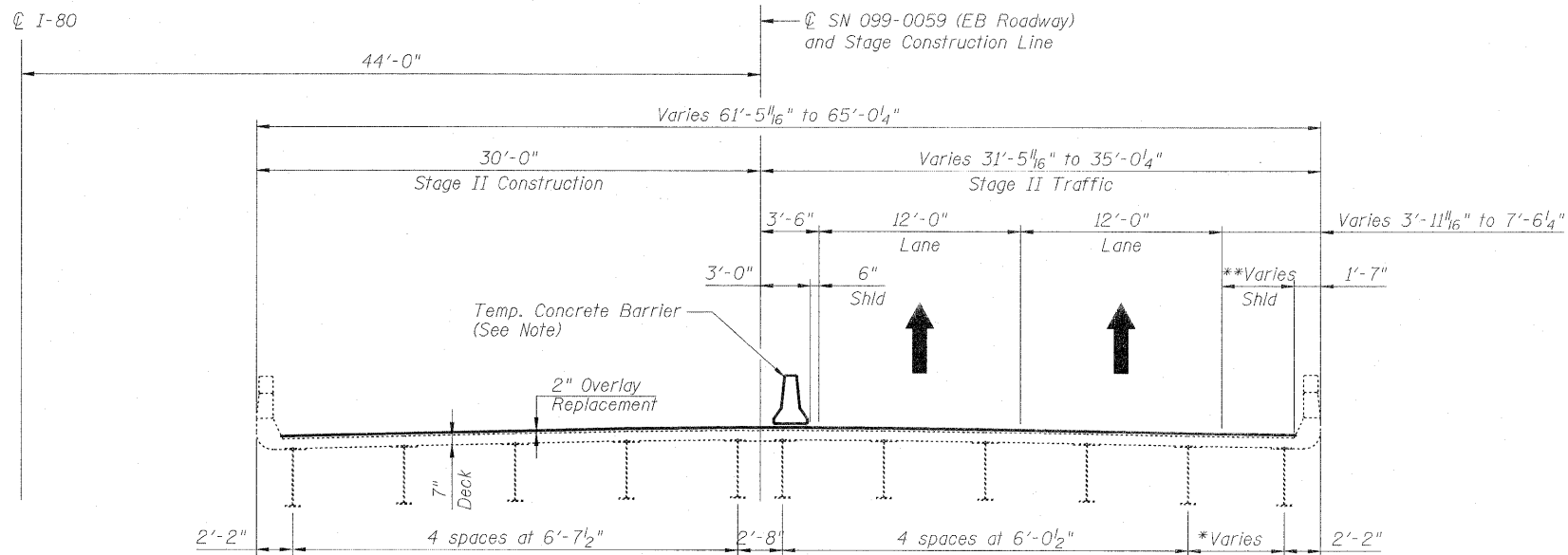

STAGE II CONSTRUCTION & TRAFFIC

(Looking East)

* Varies 3'-9 11/16" to 7'-4 1/4"
 ** Varies 2'-4 11/16" to 5'-11 1/4"

TOTAL BILL OF MATERIAL

ITEM	UNIT	SUPER	SUB	TOTAL
Polymerized Hot-Mix Asphalt Surface Course, Stone Matrix Asphalt, N80	Ton	137	-	137
Protective Shield (Permanent)	Sq. Yd.	641	-	641
Hot-Mix Asphalt Surface Removal (Deck)	Sq. Yd.	1,218	-	1,218
Structural Repair of Concrete (Depth < 5")	Sq. Ft.	-	87	87
Structural Repair of Concrete (Depth > 5")	Sq. Ft.	-	214	214
Deck Slab Repair (Full Depth, Type II)	Sq. Yd.	38	-	38
Deck Slab Repair (Partial)	Sq. Yd.	193	-	193
Silicone Joint Sealer, 1"	Foot	63	-	63
Silicone Joint Sealer, 1 3/4"	Foot	126	-	126
Silicone Joint Sealer, 2 3/4"	Foot	63	-	63
Temporary Shoring and Cribbing	Each	3	-	3

Note:

After removal of temporary concrete barrier, repair dowel holes with non-shrink epoxy grout as directed by the Engineer. Cost of anchorage and repair is included with Temporary Concrete Barrier.

USER NAME = aysrgicogl/Rdwg_Lis1e	DESIGNED - A.Y./L.C.	REVISED -	HBP Illinois Partners	STATE OF ILLINOIS DEPARTMENT OF TRANSPORTATION	CONSTRUCTION STAGING AND TOTAL BILL OF MATERIAL		F.A.I. RTE.	SECTION	COUNTY	TOTAL SHEETS	SHEET NO.
PLOT CONFIG = PDF(I-B01_Topo0reg_Large).pl	DRAWN - L.C./A.Y.	REVISED -			80	99 (2&3) RS-3	WILL	200	144		
PLOT SCALE = 1:5,333,333	CHECKED - A.Y./R.L.D.	REVISED -			CONTRACT NO. 60M64						
PLOT DATE = 2/8/2011	DATE - 01/21/2011	REVISED -			FED. ROAD DIST. NO. 1 ILLINOIS FED. AID PROJECT						
					SCALE:	SHEET S2 OF S6	STA.	TO STA.			