

EXISTING LEGEND

[Hatched Box]	MEDIAN REMOVAL
[Cross-hatched Box]	RETAINING WALL REMOVAL
[Diagonal Lines Box]	SIDEWALK REMOVAL
[Dotted Box]	TREE REMOVAL, ACRES
[Cross-hatched Box]	BITUMINOUS PAVEMENT REMOVAL
[X-hatched Box]	RAILROAD TRACKS, TIES AND BALLAST REMOVAL
[Circle with X]	TREE REMOVAL WITH UNIT DIAMETER TRUNK
[Dashed Line]	LINEAL REMOVAL ITEM

- NOTES**
1. FOR ADDITIONAL REMOVALS SEE SHEET PD-01
 2. ALL STATIONS AND OFFSETS ARE FROM THE CENTERLINE OF THE NEW WESTBOUND TRACK

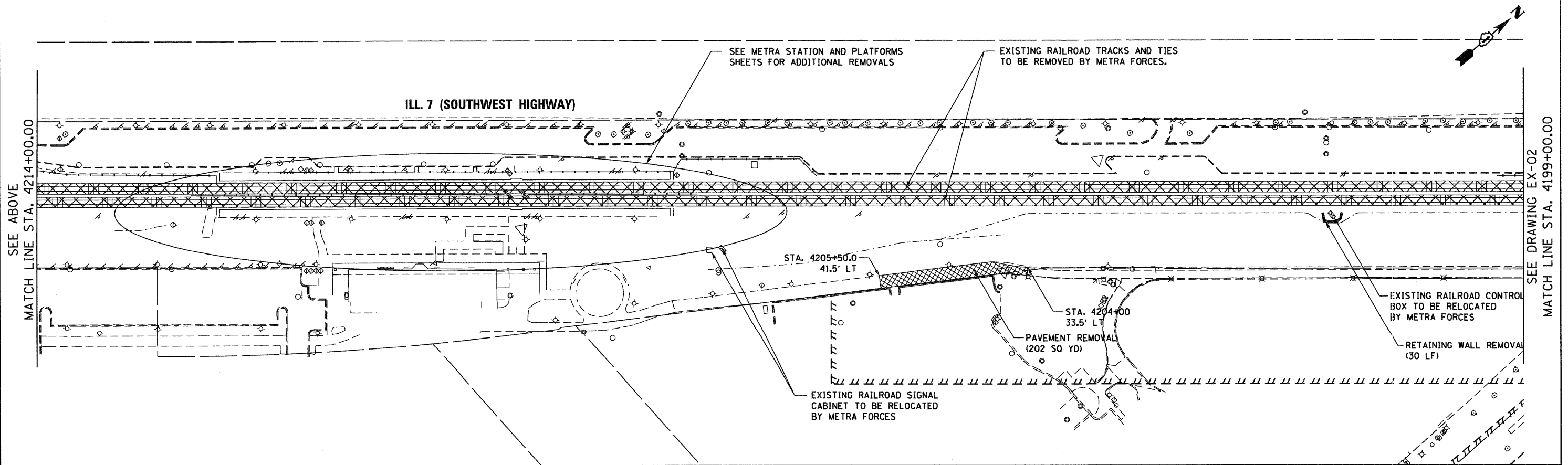

McDonough Associates Inc.
 Engineers / Architects
 130 East Randolph Street, Chicago, Illinois 60601

FILE NAME = D:\62089-SHT-REM\01.dgn	USER NAME = TKluegel	DESIGNED - BA	REVISED -
PLOT SCALE = 1:50	CHECKED -	DRAWN - BA	REVISED -
PLOT DATE = 12/29/2010	DATE - 12/17/10	REVISIONS	REVISIONS

STATE OF ILLINOIS
DEPARTMENT OF TRANSPORTATION

EXISTING PLAN AND REMOVALS
 SCALE: 1"=50' SHEET NO. 1 OF 3 SHEETS STA. TO STA.

F.A.P. RTE. 330	SECTION 2010-135-1	COUNTY COOK	TOTAL SHEETS 101	SHEET NO. 16
EX-01			CONTRACT NO. 60N09	
ILLINOIS FED. AID PROJECT				

SEE BELOW
MATCH LINE STA. 4214+00.00

SEE ABOVE
MATCH LINE STA. 4214+00.00

SEE DRAWING EX-02
MATCH LINE STA. 4199+00.00