

**NOTES**

1. ALL CASINGS SHALL BE STEEL AND MEET THE REQUIREMENTS OF THE SPECIAL PROVISION SP-13.
2. CHLORINATION AND FLUSHING SHALL OCCUR FROM EXISTING VALVE VAULTS AT STA 32+73 AND STA 35+36.
3. CONTRACTOR TO REMOVE AND RESTORE ALL IMPACTED PAVEMENT, SIDEWALK, AND LANDSCAPING. ESTIMATED IMPACTED AREAS ARE AS FOLLOWS:  
 SEEDING, CLASS 1A (SPECIAL) - 0.02 AC  
 PCC SIDEWALK 5 INCH - 190 SF  
 SIDEWALK REMOVAL - 190 SF  
 CLASS D PATCHES, TYPE II - 49 SY

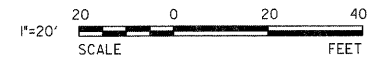

DATE	
BY	
REVISIONS	
PLANNED	
ALIGNED	
CHECKED	
DATE	
FILE NAME	
NO.	

DATE	
BY	
REVISIONS	
PLANNED	
ALIGNED	
CHECKED	
DATE	
FILE NAME	
NO.	

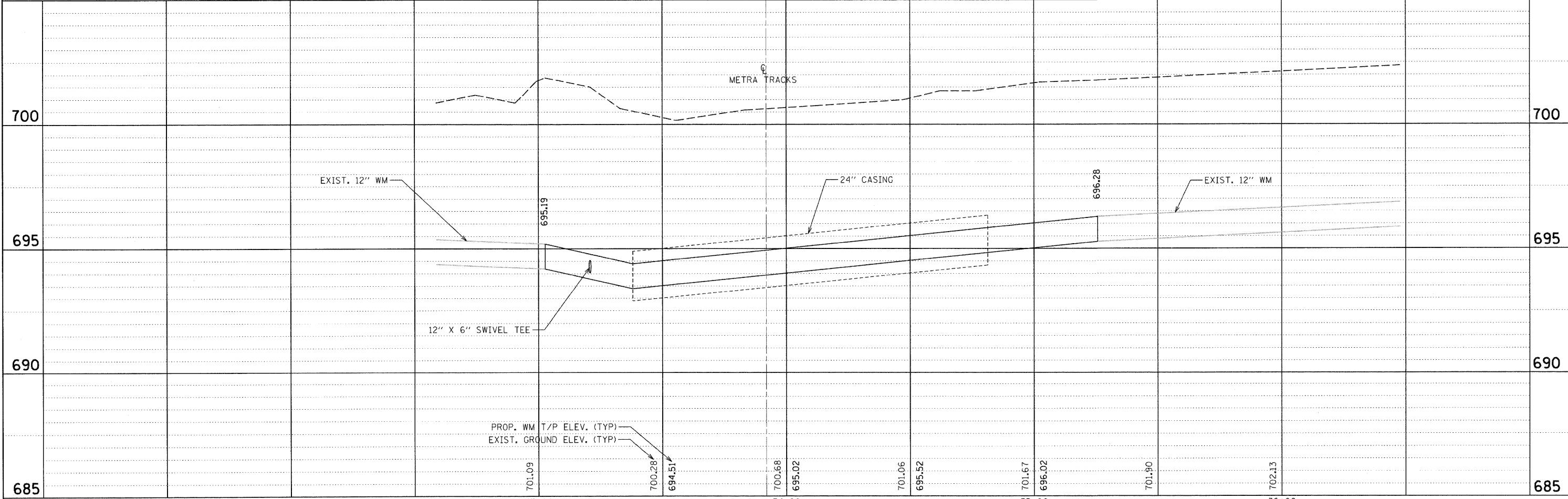
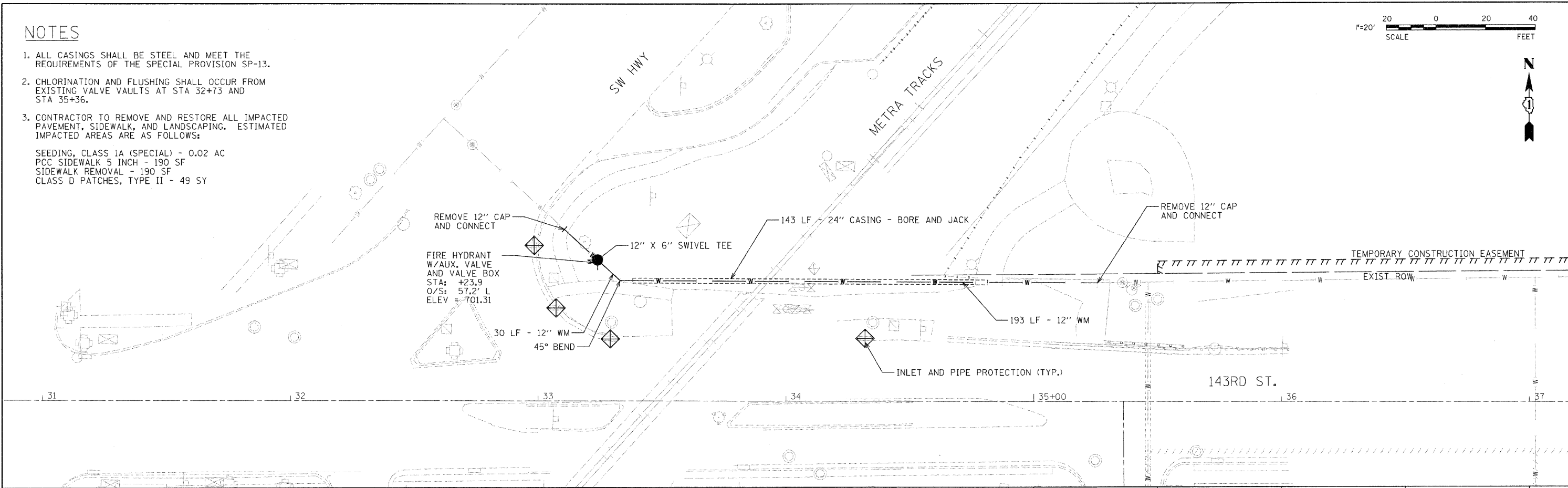

FILE NAME =	USER NAME = #USER#	DESIGNED -	REVISED -	<b>STATE OF ILLINOIS DEPARTMENT OF TRANSPORTATION</b>	<b>143RD ST AND SW HWY WATERMAIN CONNECTION PLAN AND PROFILE</b>	F.A.P. RTE. 330	SECTION 2010-135-I	COUNTY COOK	TOTAL SHEETS 101	SHEET NO. 36	
#FILE#		DRAWN -	REVISED -			CONTRACT NO. 60N09		ILLINOIS FED. AID PROJECT			
		CHECKED -	REVISED -			SCALE: SHEET NO. OF SHEETS STA. TO STA.					
		DATE -	REVISED -								