

POINT NO.	NORTHING	EASTING	POINT NO.	NORTHING	EASTING
1	1808289.43	1113639.10	24	1808286.24	1113779.14
2	1808281.97	1113659.35	25	1808286.42	1113786.26
3	1808284.68	1113722.97	26	1808285.11	1113734.32
4	1808254.62	1113689.35	27	1808311.15	1113758.70
5	1808258.96	1113687.35	28	1808316.62	1113752.86
6	1808247.58	1113682.75	29	1808300.18	1113766.77
7	1808246.76	1113680.98	30	1808298.88	1113736.26
8	1808244.34	1113624.20	31	1808297.35	1113700.25
9	1808256.25	1113623.74	32	1808299.38	1113681.00
10	1808271.24	1113623.16	33	1808216.30	1113658.95
11	1808230.35	1113624.74	34	1808215.49	1113639.97
12	1808232.45	1113674.08	35	1808220.05	1113625.65
13	1808214.84	1113657.59	36	1808223.62	1113704.84
14	1808209.37	1113663.43	37	1808217.66	1113691.00
15	1808232.81	1113685.37	38	1808216.78	1113670.37
16	1808236.29	1113763.79	39	1808299.37	1113747.67
17	1808237.04	1113780.56			
18	1808251.03	1113779.98			
19	1808247.94	1113711.08			
20	1808252.29	1113709.08			
21	1808259.31	1113715.65			
22	1808260.13	1113717.42			
23	1808262.92	1113779.73			

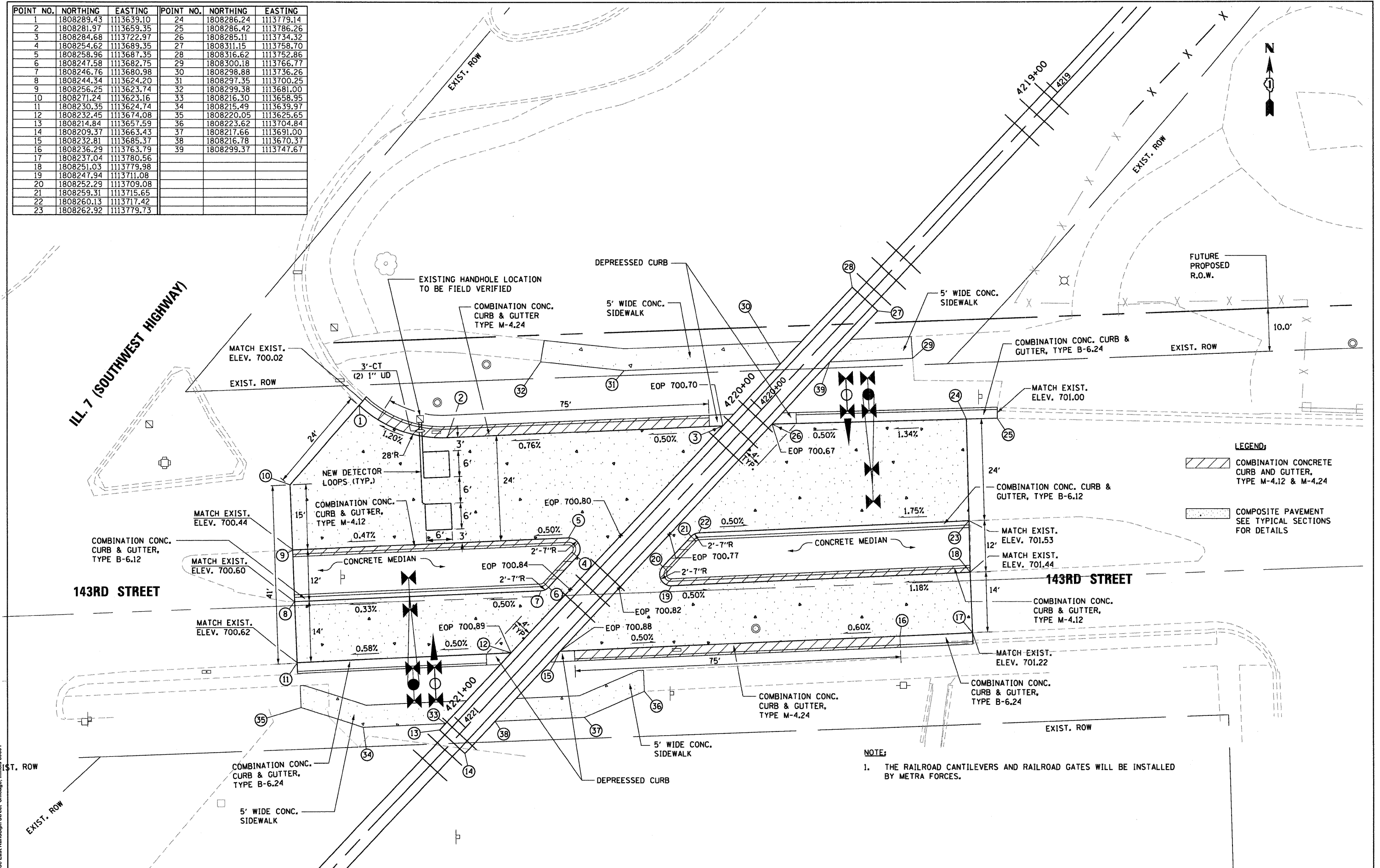

**LEGEND:**

COMBINATION CONCRETE CURB AND GUTTER, TYPE M-4.12 & M-4.24

COMPOSITE PAVEMENT SEE TYPICAL SECTIONS FOR DETAILS

**NOTE:**

1. THE RAILROAD CANTILEVERS AND RAILROAD GATES WILL BE INSTALLED BY METRA FORCES.

McDonough Associates Inc.  
 Engineers / Architects  
 130 East Randolph Street, Chicago, Illinois 60601

FILE NAME = D:\160809-SHT-PD01.dgn	USER NAME = TKI\uegl	DESIGNED - BA	REVISED -	<b>STATE OF ILLINOIS DEPARTMENT OF TRANSPORTATION</b>	<b>PAVEMENT ELEVATION AND DETAILS</b>			F.A.P. RTE. 330	SECTION 2010-135-1	COUNTY COOK	TOTAL SHEETS 101	SHEET NO. 38
PLOT SCALE = 1"=10'	PLOT DATE = 12/29/2010	DRAWN - BA	REVISED -		SCALE: 1"=10'	SHEET NO. 1 OF 1 SHEETS	STA. TO STA.	CONTRACT NO. 60N09				
CHECKED - MJT	DATE - 12/17/10	REVISER -	REVISER -		ILLINOIS FED. AID PROJECT							