

QUANTITY  
 4 (100) LINE = 64.1 ft. (19.7 m)  
 21.1 sq. ft. (1.97 sq. m)

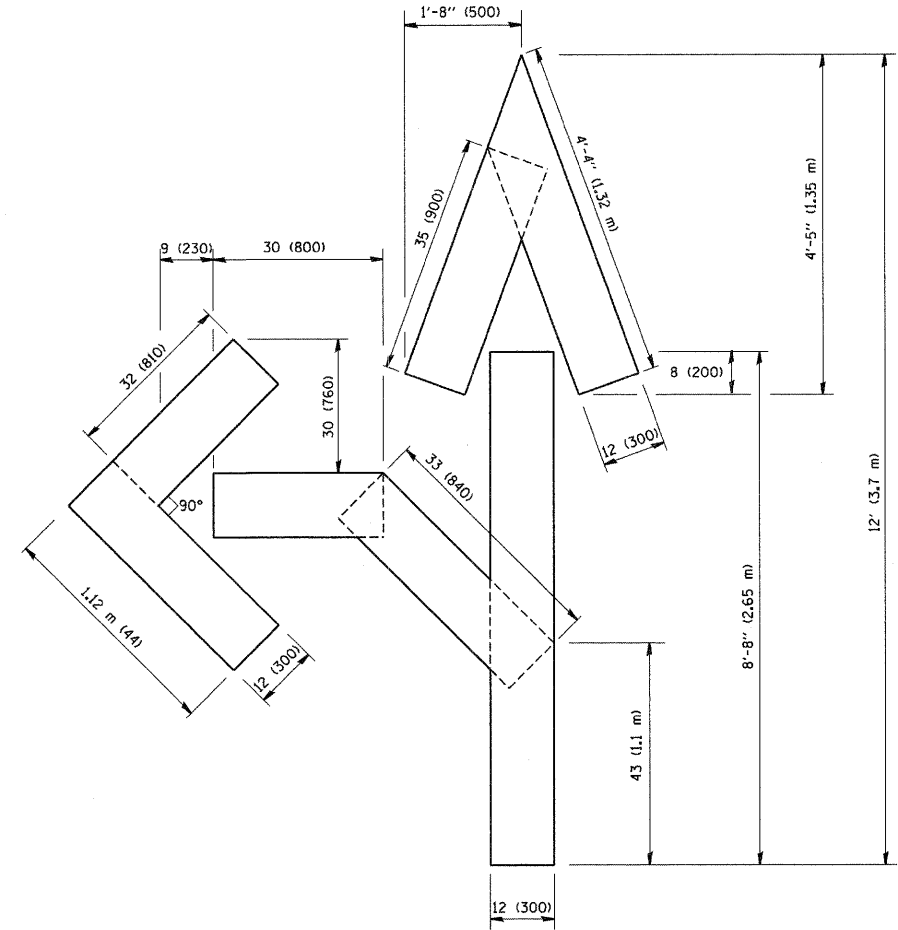

QUANTITY  
 4 (100) LINE = 82.5 ft. (25.3 m)  
 27.5 sq. ft. (2.53 sq. m)

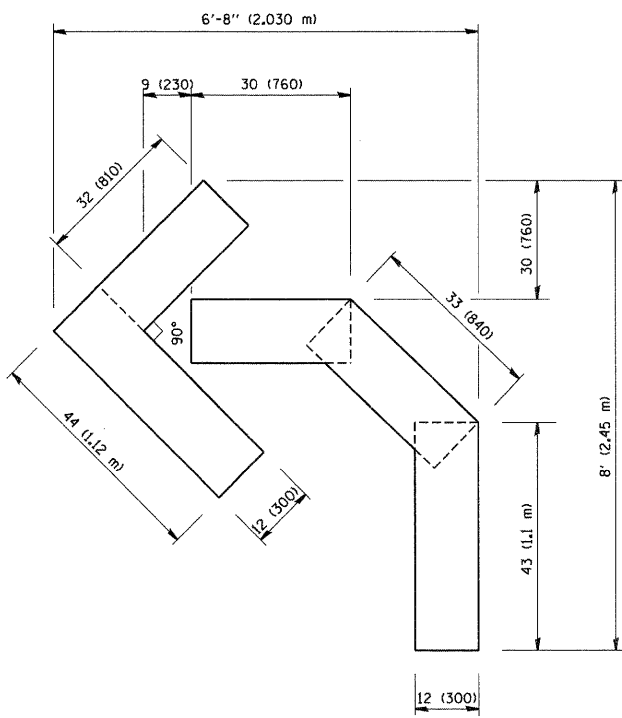

QUANTITY  
 4 (100) LINE = 45.5 ft. (13.9 m)  
 15.2 sq. ft. (1.39 sq. m)

All dimensions are in inches (millimeters) unless otherwise shown.

|  |                        |                 |                                 |
|--|------------------------|-----------------|---------------------------------|
| FILE NAME =<br>W:\diststd\22x34\tcl6.dgn | USER NAME = geglianobt | DESIGNED -      | REVISED - T. RAMMACHER 06-05-96 |
|  |                        | DRAWN -         | REVISED - T. RAMMACHER 11-04-97 |
|  |                        | CHECKED -       | REVISED - T. RAMMACHER 03-02-98 |
|  |                        | DATE - 09-18-94 | REVISED - E. GOMEZ 08-28-00     |

**STATE OF ILLINOIS  
 DEPARTMENT OF TRANSPORTATION**

|   |                         |      |         |
|---|-------------------------|------|---------|
| <b>PAVEMENT MARKING LETTERS AND SYMBOLS<br/>FOR TRAFFIC STAGING</b> |                         |      |         |
| SCALE: NONE   | SHEET NO. 1 OF 1 SHEETS | STA. | TO STA. |

|   |                       |                |                     |                 |
|---|-----------------------|----------------|---------------------|-----------------|
| F.A.P. RTE.<br>330                              | SECTION<br>2010-135-I | COUNTY<br>COOK | TOTAL SHEETS<br>101 | SHEET NO.<br>69 |
| TC-16   |                       |                | CONTRACT NO. 60N09  |                 |
| FED. ROAD DIST. NO. 1 ILLINOIS FED. AID PROJECT |                       |                |                     |                 |