

ELEVATION

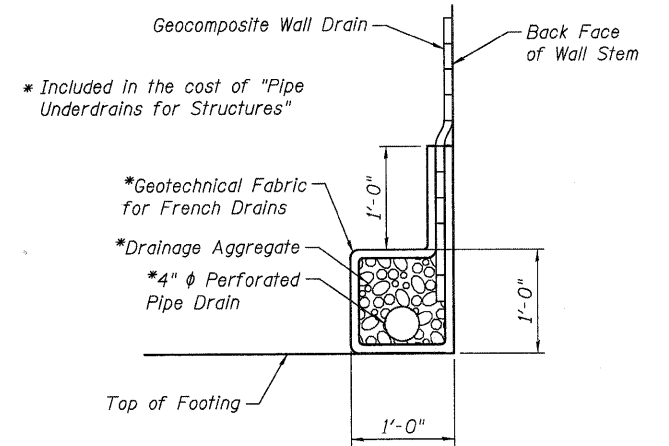

PIPE UNDERDRAIN DETAIL

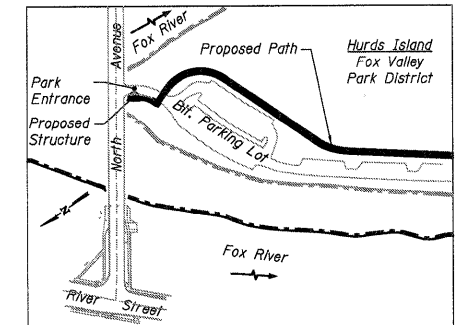

LOCATION SKETCH

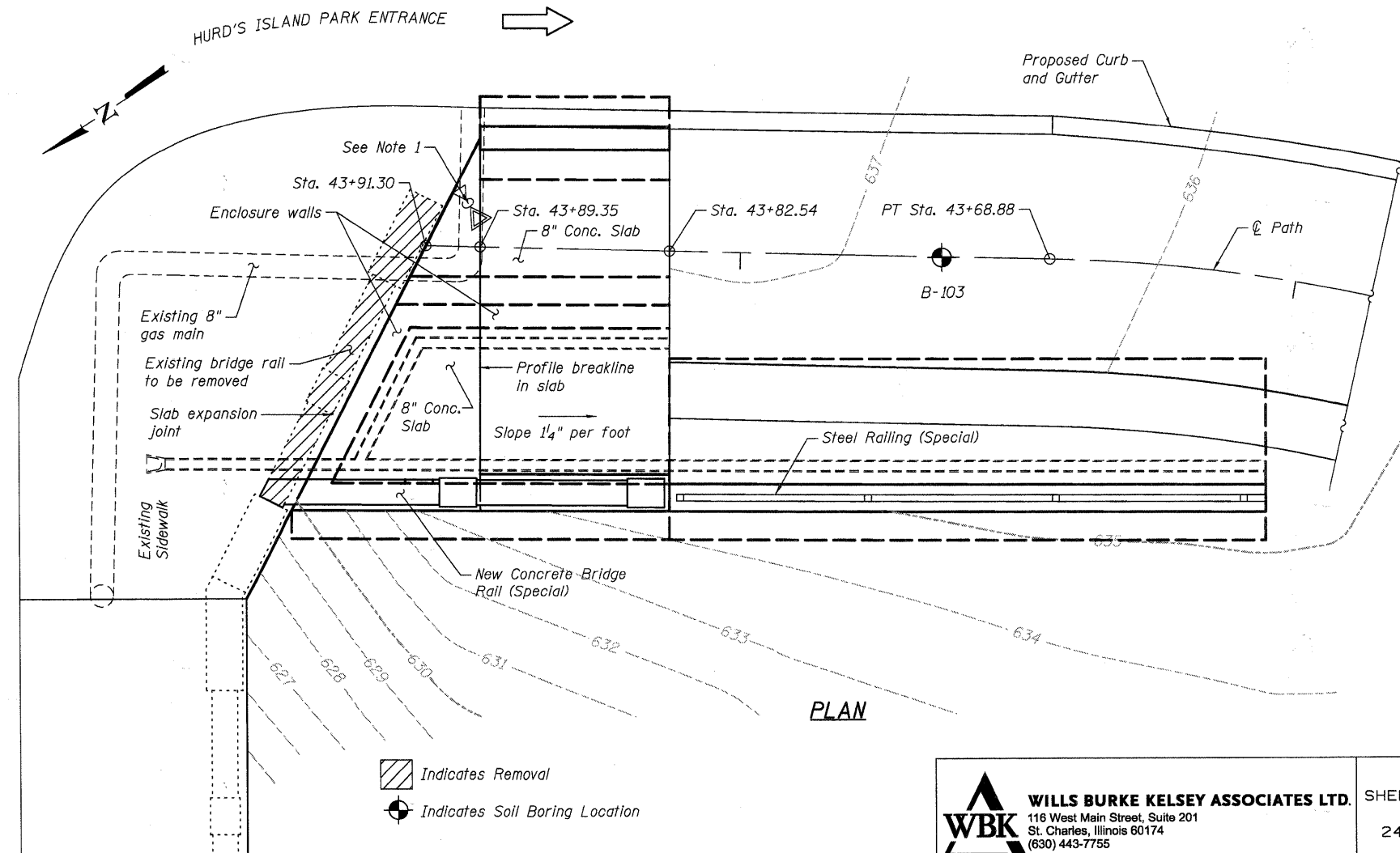

PLAN

**GENERAL PLAN AND ELEVATION
NORTH AVENUE RETAINING WALLS**

- NOTES**
1. A Nicor Electrical Test Station will be in conflict with construction of the walls and slab. Prior to construction, the Contractor shall contact Gall Goldasch, Supervisor - Corrosion Control at 630-317-2263 to coordinate the relocation of the test station during construction.

In addition, Jeff Leihelt, Sr. Supervisor - Field Operations Construction for Nicor shall be contacted at 815-754-3140 with field inquiries during construction.

This project has been assigned Nicor Engineering #SC8489.
 2. Thicken slab over retaining wall to maintain level surface for new Precast Bridge Rail (Special).
 3. For slab and wall expansion joints, see Sheet No. 15.
 4. For Steel Railing (Special) details, see Sheet No. 17.

DESIGNED -	DLS
CHECKED -	AEU
DRAWN -	AWH
CHECKED -	DLS

Indicates Removal
 Indicates Soil Boring Location

WILLS BURKE KELSEY ASSOCIATES LTD.
 116 West Main Street, Suite 201
 St. Charles, Illinois 60174
 (630) 443-7755

SHEET NO. 11 24 SHEETS	F.A.U. RTE.	SECTION	COUNTY	TOTAL SHEETS	SHEET NO.
		05-F3000-06-BT	KANE	58	32
CONTRACT NO. 63517					
FED. ROAD DIST. NO.		ILLINOIS	FED. AID PROJECT		

PLOT DATE = 12/29/2010
 FILE NAME = P:\CBBEL\EST\Projects\2009\123148 FoxRvr\T-PTH\Structural\Drawings\Final\Plan\Bkbrdg-811-RetWall.dgn