

### BRIARGATE DRIVE

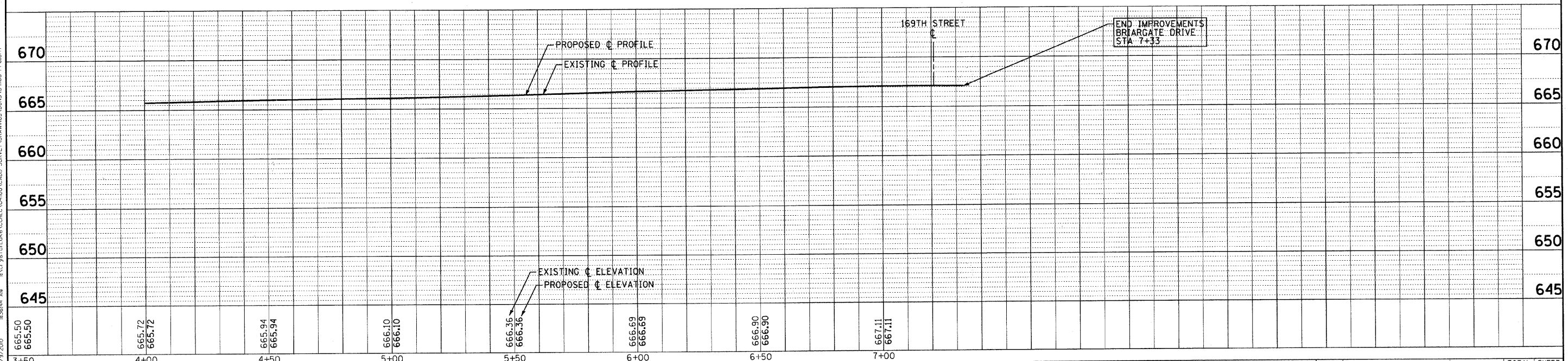

COPYRIGHT © 2010 BY BAXTER & WOODMAN, INC.  
 ALL RIGHTS RESERVED. THIS DRAWING IS THE PROPERTY OF BAXTER & WOODMAN, INC. AND IS NOT TO BE REPRODUCED OR TRANSMITTED IN ANY FORM OR BY ANY MEANS, ELECTRONIC OR MECHANICAL, INCLUDING PHOTOCOPYING, RECORDING, OR BY ANY INFORMATION STORAGE AND RETRIEVAL SYSTEM, WITHOUT THE WRITTEN PERMISSION OF BAXTER & WOODMAN, INC.  
 LICENSE NO. 184-00122 - EXPIRES 4/30/2011  
 12/9/2010 11:36:44 AM



DESIGNED - MWP	REVISED - 12-01-10 IDOT REVIEW
DRAWN - KAR	REVISED -
CHECKED - RWL	REVISED -
DATE - 10-01-10	FILE - 041180-PP6.shd

**CITY OF COUNTRY CLUB HILLS, ILLINOIS**  
**GLEN OAKS DRIVE INFRASTRUCTURE IMPROVEMENTS**

**PLAN AND PROFILE**  
**BRIARGATE DRIVE**

SCALE: H: 1"=20' V: 1"=5'      STA. 4+00      TO STA. 7+21

F.A. RTE.	SECTION	COUNTY	TOTAL SHEETS	SHEET NO.
-	04-00027-03-PV	COOK	36	18
C-91-004-05		CONTRACT NO. 63539		
FED. ROAD DIST. NO.		ILLINOIS FED. AID PROJECT HPD-097(008)		