

QUANTITY
 4 (100) LINE = 64.1 ft. (19.7 m)
 21.1 sq. ft. (1.97 sq. m)

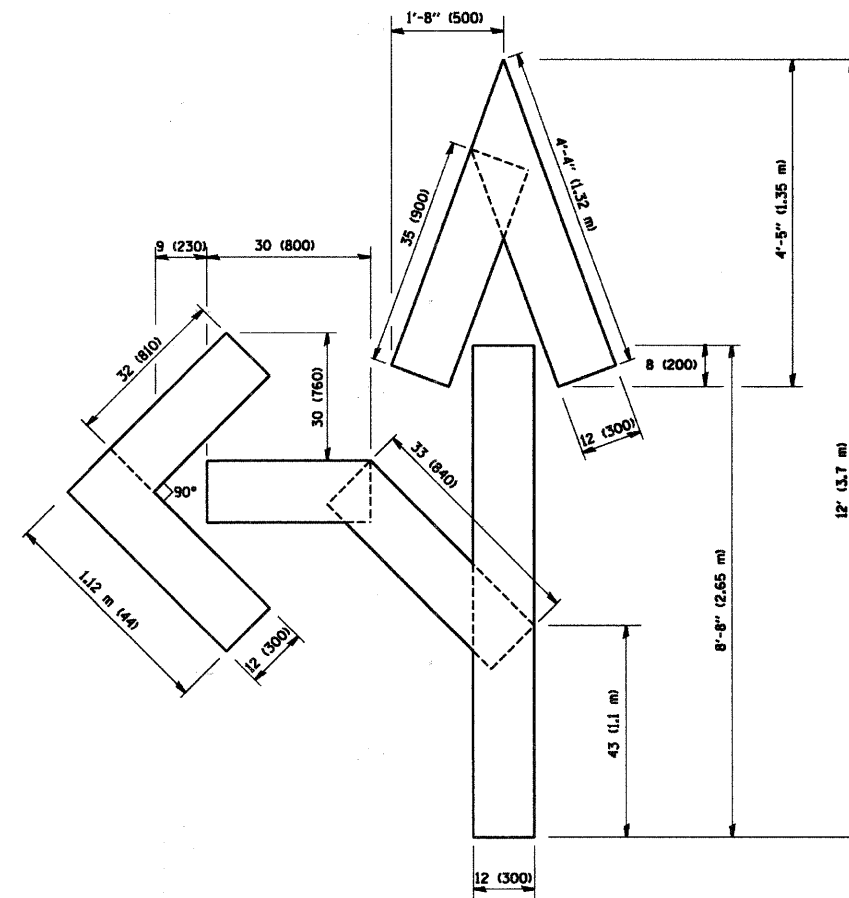

QUANTITY
 4 (100) LINE = 82.5 ft. (25.3 m)
 27.5 sq. ft. (2.53 sq. m)

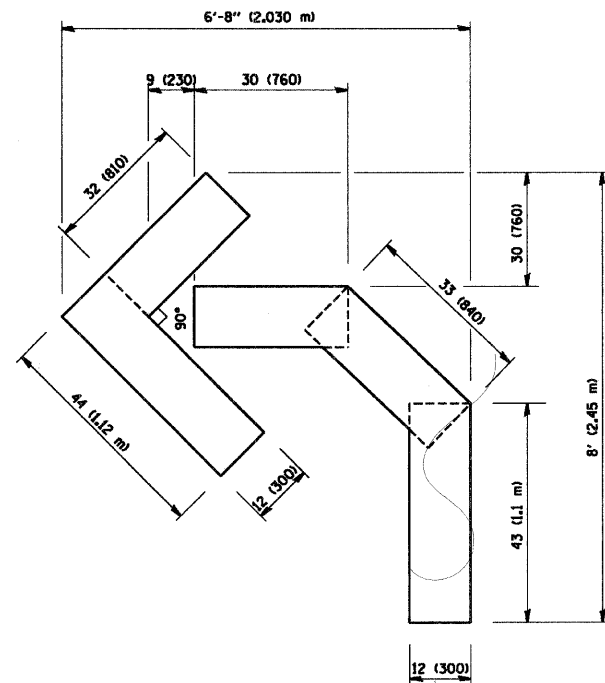

QUANTITY
 4 (100) LINE = 45.5 ft. (13.9 m)
 15.2 sq. ft. (1.39 sq. m)

All dimensions are in inches (millimeters) unless otherwise shown.

COMPANY NAME: SEC Group, Inc.
 PROJECT: 1050-TRANS.TBL
 CLIENT: City of Aurora
 DATE PLOTTED: 12/20/2010 10:02:54 AM
 FILE NAME: 86100291-det-85.dgn
 PLOT DRIVER: McHenry-1050-plotter-AS.IS.DIF
 PEN TABLE: STANDARD-TRANS.TBL



USER NAME = JSrzal	DESIGNED -	REVISED - T. RAMMACHER06-05-96
FILE NAME = 86100291-det-85.dgn	DRAWN -	REVISED - T. RAMMACHER11-04-97
PLOT SCALE = NA	CHECKED -	REVISED - T. RAMMACHER03-02-98
PLOT DATE = 12/20/2010	DATE = 12/20/10	REVISED - E. GOMEZ 08-28-00

CITY OF AURORA

PAVEMENT MARKING LETTERS AND SYMBOLS
 FOR TRAFFIC STAGING

SCALE: NA SHEET NO. 5 OF 6 SHEETS STA. NA TO STA. NA

F.A. RTE: 1502	SECTION 10-00291-00-RS	COUNTY KANE	TOTAL SHEETS 15	SHEET NO. 13
TC-16		CONTRACT NO. 63543		
FED. ROAD DIST. NO. ILLINOIS FED. AID PROJECT				