

FOR INDEX OF SHEETS, SEE SHEET NO. 2  
FOR HIGHWAY STANDARDS, SEE SHEET NO. 2

STATE OF ILLINOIS

DEPARTMENT OF TRANSPORTATION

DIVISION OF HIGHWAYS

PLANS FOR PROPOSED  
FEDERAL AID HIGHWAY

71ST STREET (FAU 1537)  
AT CSXT / IHB RAILROAD CROSSING  
GRADE SEPARATION  
PROJECT NO.: CRE-9003(709)  
SECTION NO.: 06-00050-00-GS  
VILLAGE OF BRIDGEVIEW  
COOK COUNTY

|                     |                |              |              |           |
|---------------------|----------------|--------------|--------------|-----------|
| F.A.U. RTE.         | SECTION        | COUNTY       | TOTAL SHEETS | SHEET NO. |
| 1537                | 06-00050-00-GS | COOK         | 209          | 1         |
| FED. ROAD DIST. NO. | ILLINOIS       | CONTRACT NO. | #63556       |           |

- 9-200

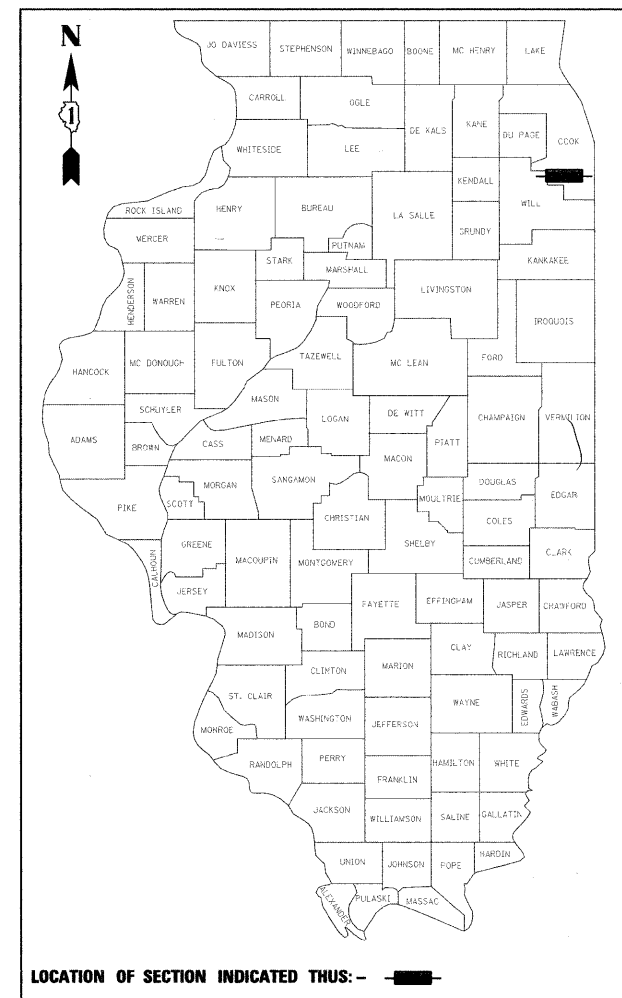

LOCATION OF SECTION INDICATED THUS: -



*Tim W* 12/22/2010  
TIMOTHY J. WHALEN DATE  
LICENSE EXPIRES 11/30/2011  
SHEET RANGE 2-7, 11-13, 14, 17-18, 22-27, 31-43, 47-49, 51-52, 66-68, 78-78, 147, 165-209

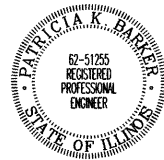

*Pat K Barker* 12/17/2010  
PATRICIA K. BARKER DATE  
LICENSE EXPIRES 11/30/2011  
SHEET RANGE 10, 19-21, 44-46, 50, 53-56, 61-72

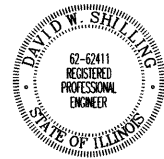

*David Shilling* 12/17/2010  
DAVID W. SHILLING DATE  
LICENSE EXPIRES 11/30/2011  
SHEET RANGE 71-87

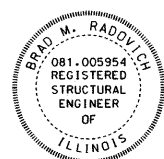

*Brad M Radovich* 12/22/2010  
BRAD M. RADOVICH DATE  
LICENSE EXPIRES 11/30/2012  
SHEET RANGE 95-106, 108-111, 113-116, 148-158, 164

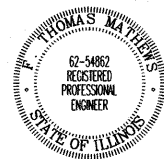

*F. Thomas Mathews* 12/01/2010  
F. THOMAS MATHEWS DATE  
LICENSE EXPIRES 11/30/2011  
SHEET RANGE 88-94

| 71ST STREET          |                 |
|----------------------|-----------------|
| 2010 ADT -           | 4,400           |
| 2030 ADT -           | 7,000           |
| POSTED SPEED LIMIT - | 35 mph          |
| DESIGN PERIOD -      | 20 YEARS        |
| DESIGN SPEED LIMIT - | 35 mph          |
| DESIGN DESIGNATION - | URBAN COLLECTOR |

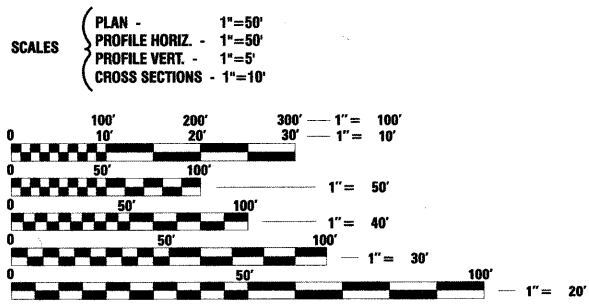

FULL SIZE PLANS HAVE BEEN PREPARED USING STANDARD ENGINEERING SCALES. REDUCED SIZED PLANS WILL NOT CONFORM TO STANDARD SCALES. IN MAKING MEASUREMENTS ON REDUCED PLANS, THE ABOVE SCALES MAY BE USED.

J.U.L.I.E.  
JOINT UTILITY LOCATION INFORMATION FOR EXCAVATION  
1-800-892-0123  
OR 811

71ST ST OVER CSXT / IHB  
S.N. 016-7721, LENGTH = 73'2"  
71ST STREET STA 23+39.90  
CSX RAILROAD STA 1+00.00

BEGINNING OF PROJECT  
71ST STREET STA 15+50

RETAINING WALLS  
S.N. 016-7722 THRU  
S.N. 016-7726

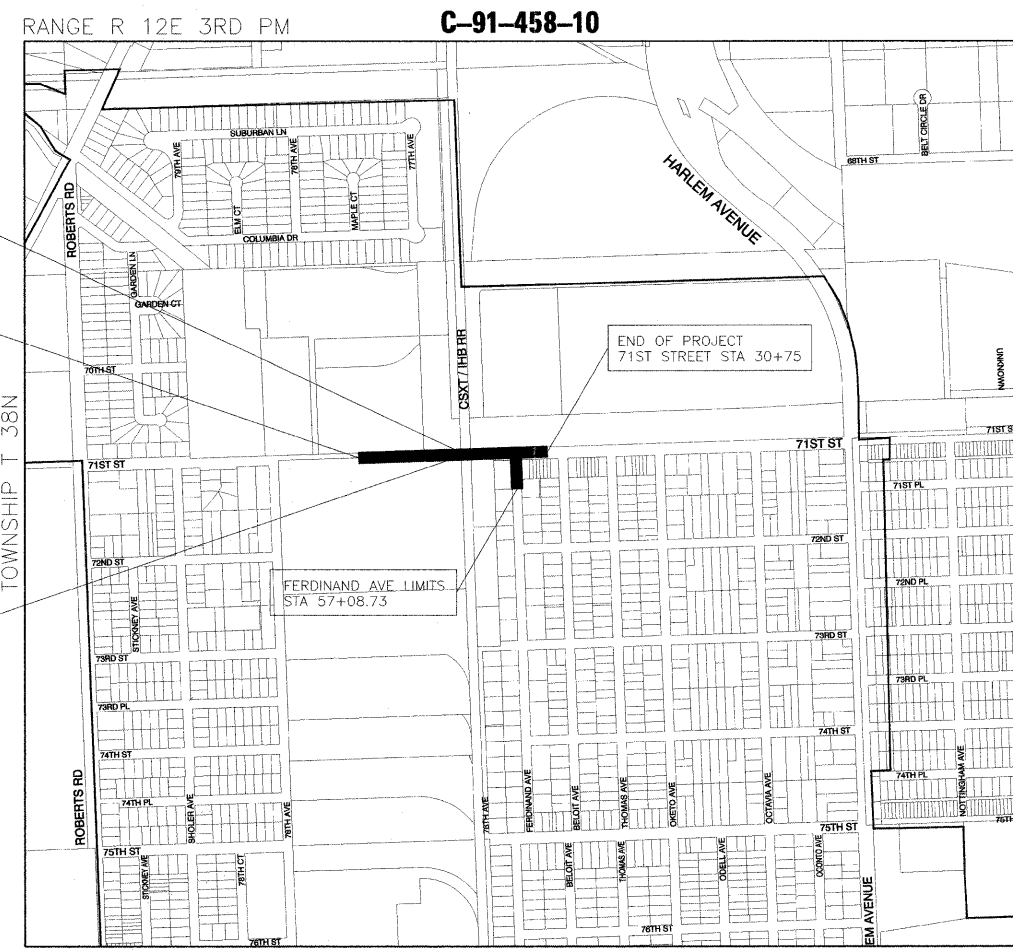

LOCATION MAP - NOT TO SCALE  
- INDICATES PROPOSED IMPROVEMENT  
GROSS LENGTH = 1,816 FT. = 0.34 MILES  
NET LENGTH = 1,816 FT. = 0.34 MILES

STATE OF ILLINOIS  
DEPARTMENT OF TRANSPORTATION  
DIVISION OF HIGHWAYS

APPROVED *Dec. 20, 2010*  
*Steve Ledell*  
PRESIDENT, VILLAGE OF BRIDGEVIEW

PASSED *JANUARY 16, 2011*  
*Christopher Holt*  
DISTRICT 1 ENGINEER OF LOCAL ROADS & STREETS

RELEASING FOR BID  
BASED ON LIMITED  
REVIEW *JANUARY 7, 2010*  
*Dina M. O'Keefe*  
DEPUTY DIRECTOR OF HIGHWAYS, REGION 1 ENGINEER

PRINTED BY THE AUTHORITY  
OF THE STATE OF ILLINOIS



PROGRAM & OFFICE ENGINEER: CHARLES F. RIDDLE, P.E. (847) 705-4406 SCHAUMBURG, IL

CONTRACT NO. 63556