

SECTION 24, TOWNSHIP 38, RANGE 12
SECTION 25, TOWNSHIP 38, RANGE 12

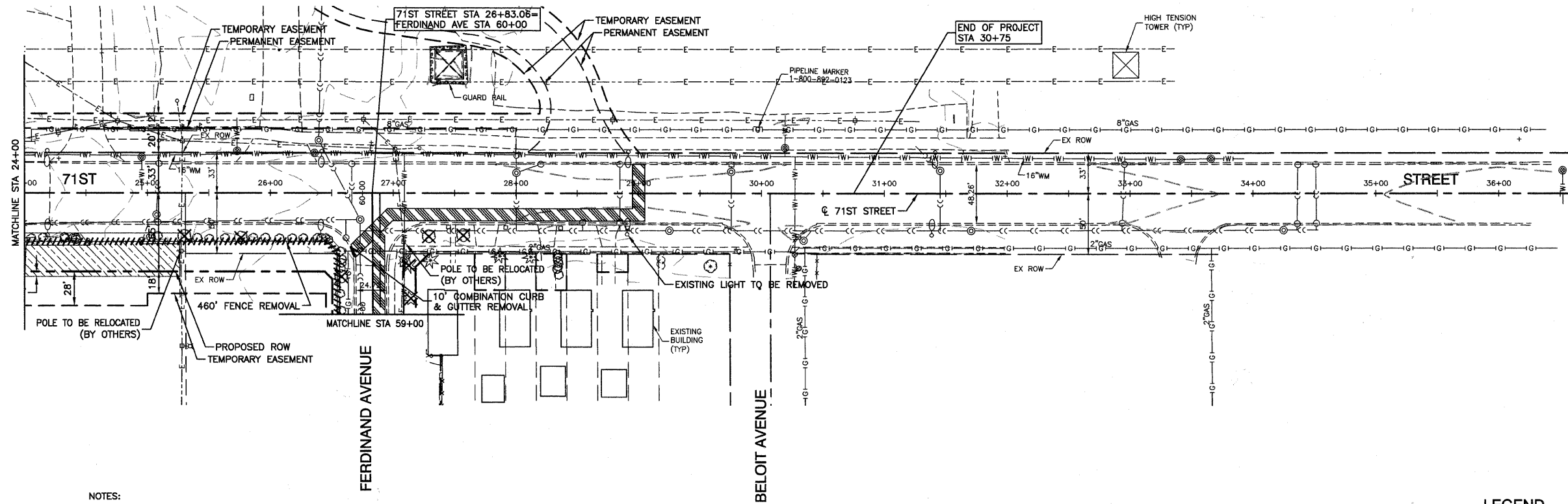

DATE	BY

DATE	BY



NOTES:

- CONTRACTOR MUST MAINTAIN ACCESS TO PROPERTIES AT ALL TIMES.

EXISTING CONDITIONS

LEGEND

- DRIVEWAY PAVEMENT REMOVAL
- CONCRETE SIDEWALK REMOVAL
- PAVEMENT PATCHING
- PAVEMENT REMOVAL
- SUB-BASE GRANULAR MATERIAL TYPE B, 4" AND HOT-MIX ASPHALT PAVEMENT (FULL DEPTH), 12"
- HOT-MIX ASPHALT DRIVEWAY PAVEMENT; 6" HOT-MIX ASPHALT SURFACE COURSE, MIX "C", N50(IL-9.5mm); 2" HOT-MIX ASPHALT BINDER COURSE, IL-19.0, N50; 4"

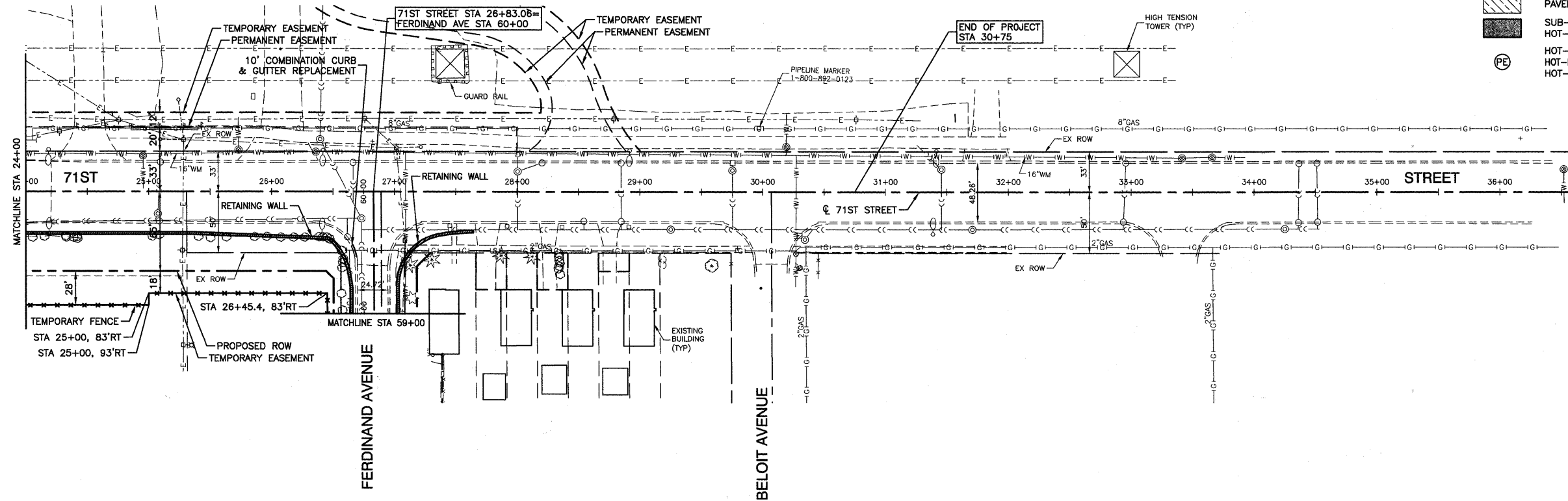

PROPOSED IMPROVEMENT

BENCH MARK: BWW249

SQUARE CUT ON N CONC BASE OF RR SIGNAL
MAST ARM BASE ON S ROW OF 71ST STREET
1/2 MILE WEST OF HARLEM AVENUE
ELEVATION=620.57

FILE NAME = 08353-PLPR-01 - EX02

USER NAME =	DESIGNED -	PKB	REVISED -	REL - 01-14-11
PLOT SCALE =	CHECKED -	PKB	REVISED -	
PLOT DATE =	DRAWN -	PS	REVISED -	
	CHECKED -	AG	REVISED -	

STATE OF ILLINOIS
DEPARTMENT OF TRANSPORTATION

71ST STREET	
UTILITY RELOCATION INTERIM ROADWAY PLAN	
SCALE: 1"=50'	SHEET NO. 20 OF 209 SHEETS
STA. 24+00	TO STA. 30+75

F.A.U. RTE.	SECTION	COUNTY	TOTAL SHEETS	SHEET NO.
1537	06-00050-00-GS	COOK	209	20
CONTRACT NO. 63556				
FED. ROAD DIST. NO. 1 ILLINOIS FED. AID PROJECT CRE-9003(709)				