

**CONSTRUCTION STAGING NOTES**

**STAGE 1**

**TRAFFIC**

1. SET UP FERDINAND AVENUE DETOUR SIGNING PER THE DETOUR PLAN.
2. DETOUR FERDINAND AVENUE THROUGH TRAFFIC. CLOSE FERDINAND TO VEHICULAR AND PEDESTRIAN TRAFFIC.

**CONSTRUCTION**

3. CONSTRUCT ALONG THE SOUTH SIDE OF 71ST STREET AND THE WEST SIDE OF FERDINAND AVENUE THE PROPOSED 78" AND 84" STORM SEWERS.
4. TIE THE PROPOSED 84" STORM SEWER ALONG 71ST STREET INTO THE EXISTING STORM SEWER AS DETAILED ON THE PLANS. COORDINATE THIS WORK WITH NICOR AND COMED DUE TO CONFLICTS WITH THEIR FACILITIES.
5. CLOSE FERDINAND AVENUE. TIE THE PROPOSED 78" STORM SEWER ALONG FERDINAND AVENUE INTO THE EXISTING STORM SEWER. COORDINATE THIS WORK WITH NICOR AND COMED DUE TO CONFLICTS WITH THEIR FACILITIES. REOPEN FERDINAND AVENUE UPON COMPLETION OF THE SEWER AND PATCHING WORK.
6. ALLOW NICOR GAS TO RELOCATE THEIR FACILITIES IN ORDER TO ALLOW FOR THE INSTALLATION OF THE PROPOSED 16" WATER MAIN.
7. CONSTRUCT THE 16" WATER MAIN FROM THE EAST END OF THE PROJECT GOING WEST ALONG 71ST STREET AND THE 8" WATER MAIN ALONG FERDINAND AVENUE.
8. CONSTRUCT THE STORM SEWERS ALONG THE SOUTH SIDE OF 71ST STREET BETWEEN FERDINAND AND BELOIT. TIE INTO THE NEW 78" STORM SEWER.
9. COMPLETE THE PAVEMENT, CURB AND GUTTER, AND SIGNAGE AT SIGNODE.
10. CONSTRUCT THE TEMPORARY PAVEMENT AND RAIL CROSSING AND INSTALL THE TEMPORARY GUARDHOUSE AT PEPSICO'S NORTH ENTRANCE. COMPLETE THE TEMPORARY PAVEMENT MARKING AND SIGNING.

**STAGE 2**

**TRAFFIC**

1. DETOUR PEPSICO TRAFFIC TO THE NORTH ENTRANCE UTILIZING THE MLRP TEMPORARY EASEMENT. CLOSE PEPSICO ENTRANCE OFF OF 71ST STREET.

**CONSTRUCTION**

1. CONTINUE STAGE 1 WORK.
2. CONSTRUCT 71ST STREET FROM STA 15+50 TO STA 18+85. CONSTRUCT TEMPORARY PAVEMENT AND TEMPORARY CURB & GUTTER FROM STA 18+85 TO STA 20+35.
3. DRIVE PILES FOR RETAINING WALLS.
4. CONSTRUCT THE NEW TOYOTA PARK SI PARKING LOT ENTRANCE, INCLUDING STORM SEWERS, PAVEMENT, CURB & GUTTER, MARKINGS AND SIGNAGE. REMOVE THE EXISTING PAVEMENT.
5. REMOVE THE EXISTING PEPSICO GUARDHOUSE. CONSTRUCT THE NEW PEPSICO ENTRANCE, INCLUDING STORM SEWERS, PAVEMENT, CURB & GUTTER, SIDEWALK, LIGHTING, MARKINGS AND SIGNAGE. CONSTRUCT THE NEW GUARDHOUSE AND RECONNECT THE UTILITY SERVICES.
6. BEGIN CONSTRUCTION OF THE LIFT STATION.
7. REGRADE THE EXISTING DETENTION POND AND INSTALL EROSION CONTROL MEASURES.

**STAGE 3A**

**CONSTRUCTION**

1. CONTINUE STAGE 1 AND STAGE 2 WORK.
2. PERFORM ADVANCE WORK FOR CONSTRUCTION OF THE BRIDGE INCLUDING INSTALLATION OF PILES, LONGITUDINAL SHEETING, AND TEMPORARY JUMP SPANS. - REFER TO STRUCTURAL STAGING DETAILS ON SHEET NOS. 108-110.
3. ASSEMBLE THE EAST HALF OF THE BRIDGE. - REFER TO STRUCTURAL STAGING DETAILS ON SHEET NOS. 108-110.

**RAILROAD OPERATIONS**

4. MAINTAIN LIVE RAIL TRAFFIC OPERATIONS ON ALL FOUR (4) TRACKS EXCEPT AS NOTED BELOW. PILES AND SHEETING TO BE INSTALLED BETWEEN TRAIN OPERATIONS.
5. TWO (2), THREE (3) TRACK OUTAGES WILL BE PERMITTED FOR INSTALLATION OF THE TEMPORARY JUMP SPANS. EACH OUTAGE DURATION WILL BE TEN (10) HOURS. SCHEDULING OF THE OUTAGES IS SUBJECT TO CSXT APPROVAL.

**STAGE 3B**

**TRAFFIC**

1. SET UP 71ST STREET DETOUR SIGNING PER THE DETOUR PLAN.

**CONSTRUCTION**

2. CONTINUE STAGE 2 WORK.
3. REMOVE THE SECTIONS OF THE EXISTING 84" SEWER AT THE GRADE CROSSING.
4. CONSTRUCT THE NORTH AND SOUTH BRIDGE ABUTMENTS. - REFER TO STRUCTURAL STAGING DETAILS ON SHEET NOS. 108-110.
5. ASSEMBLE THE WEST HALF OF THE BRIDGE. - REFER TO STRUCTURAL STAGING DETAILS ON SHEET NOS. 108-110.

**RAILROAD OPERATIONS**

6. MAINTAIN LIVE RAIL TRAFFIC OPERATIONS ON ALL FOUR (4) TRACKS.

**STAGE 4A AND 4B**

**TRAFFIC**

1. DETOUR 71ST STREET TRAFFIC AS SHOWN ON THE PLAN. CLOSE 71ST STREET TO VEHICULAR AND PEDESTRIAN TRAFFIC.

**CONSTRUCTION - STAGE 4A**

2. CONTINUE STAGE 3B WORK.
3. REMOVE THE EXISTING GRADE CROSSING WARNING DEVICES, INCLUDING THE SIGNALS AND GATE ARMS. (BY CSXT FORCES)
4. INSTALL THE EAST HALF OF THE BRIDGE SUPERSTRUCTURE. - REFER TO STRUCTURAL STAGING DETAILS ON SHEET NOS. 108-110. (NOVEMBER 24, 2011)

**CONSTRUCTION - STAGE 4B**

5. INSTALL THE WEST HALF OF THE BRIDGE SUPERSTRUCTURE. - REFER TO STRUCTURAL STAGING DETAILS ON SHEET NOS. 108-110. (DECEMBER 25, 2011)

**RAILROAD OPERATIONS**

6. MAINTAIN LIVE RAIL TRAFFIC OPERATIONS ON ALL FOUR (4) TRACKS EXCEPT AS NOTED BELOW.
7. TWO (2), THREE (3) TRACK OUTAGES WILL BE PERMITTED FOR INSTALLATION OF THE BRIDGE ON THE DATES INDICATED ABOVE. EACH OUTAGE DURATION WILL BE TWENTY-FOUR (24) HOURS.

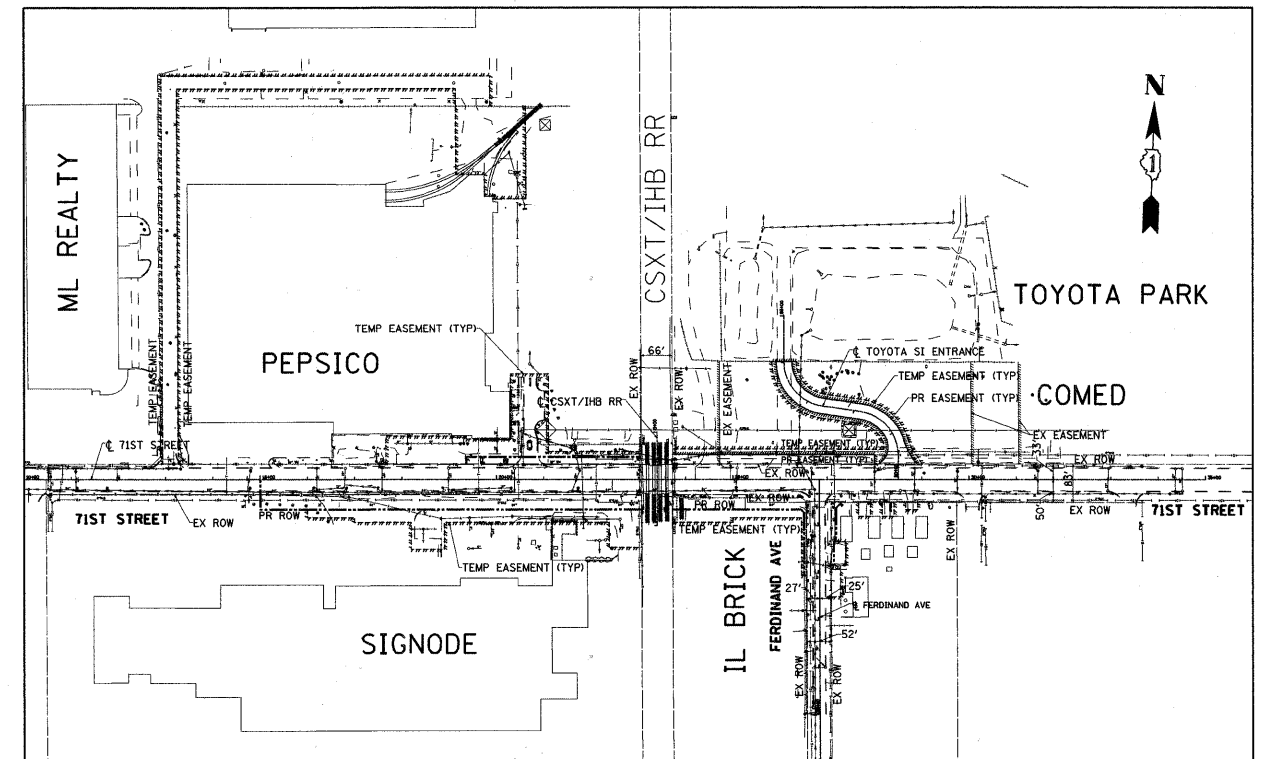

**STAGE 5**

**TRAFFIC**

1. MAINTAIN DETOUR AND CLOSURE OF 71ST STREET.
2. SET UP FERDINAND AVENUE DETOUR SIGNING PER THE DETOUR PLAN.
3. DETOUR FERDINAND AVENUE THROUGH TRAFFIC. CLOSE FERDINAND TO VEHICULAR AND PEDESTRIAN TRAFFIC.

**CONSTRUCTION**

4. CONSTRUCT RETAINING WALLS.
5. CONSTRUCT STORM SEWERS BELOW 71ST STREET AND ADJACENT TO THE RETAINING WALLS.
6. CONSTRUCT THE PAVEMENT, CURB & GUTTER, AND SIDEWALK ALONG 71ST STREET AND FERDINAND AVENUE.
7. COMPLETE ANY REMAINING REMOVAL WORK.
8. COMPLETE PAVEMENT MARKINGS AND SIGNAGE.

**STAGE 6**

**TRAFFIC**

1. OPEN 71ST STREET AND FERDINAND AVENUE TO TRAFFIC.

**CONSTRUCTION**

2. COMPLETE PAVEMENT RESURFACING AT THE MLRP TEMPORARY EASEMENT.
3. COMPLETE ROADWAY LIGHTING, RESTORATION, LANDSCAPE, AND FENCING.

FILE NAME = P:\60158377\000\_CAD\001\_Drawing\Sheet\Civil\08158377-ait-puggas-steel-construction-staging-08-A.dgn



|                              |                        |           |
|------------------------------|------------------------|-----------|
| USER NAME = manfj            | DESIGNED - TJW         | REVISED - |
| PLOT SCALE = 200.000 ' / IN. | DRAWN - JWM            | REVISED - |
| PLOT DATE = 1/28/2011        | CHECKED -              | REVISED - |
|                              | DATE - JANUARY 7, 2010 | REVISED - |

**STATE OF ILLINOIS  
DEPARTMENT OF TRANSPORTATION**

**SUGGESTED CONSTRUCTION STAGING**

SCALE: 1"=200'    SHEET NO. 1 OF 1 SHEETS    STA    TO STA

| F.A.J. RTE.   | SECTION        | COUNTY | TOTAL SHEETS | SHEET NO. |
|---|----------------|--------|--------------|-----------|
| 1537  | 06-00050-00-GS | COOK   | 209          | 29        |
| CONTRACT NO. 63556  |                |        |              |           |
| FED. ROAD DIST. NO. 1   ILLINOIS   FED. AID PROJECT CRE-9003(709) |                |        |              |           |