

**ELEVATION**  
Concrete Facing Panels 7-9

**BILL OF MATERIAL**

Bar	No.	Size	Length	Shape
h7(E)	470	#5	31'-7"	————
h8(E)	18	#5	27'-5"	————
v23(E)	341	#4	5'-9"	————
v24(E)	341	#6	6'-9"	————
v25(E)	13	#4	12'-6"	————
v26(E)	13	#6	12'-6"	————
v27(E)	62	#4	4'-6"	————
v28(E)	62	#4	5'-11"	————
v29(E)	62	#4	7'-5"	————
v30(E)	62	#4	9'-1"	————
v31(E)	62	#4	11'-2"	————
v32(E)	62	#4	13'-4"	————
v33(E)	62	#4	15'-2"	————
v34(E)	62	#4	16'-10"	————
v35(E)	62	#4	18'-5"	————
v36(E)	62	#4	19'-9"	————
v37(E)	62	#4	20'-11"	————
Concrete Structures			Cu. Yd.	256
Reinforcement Bars, Epoxy Coated			Pound	27,020

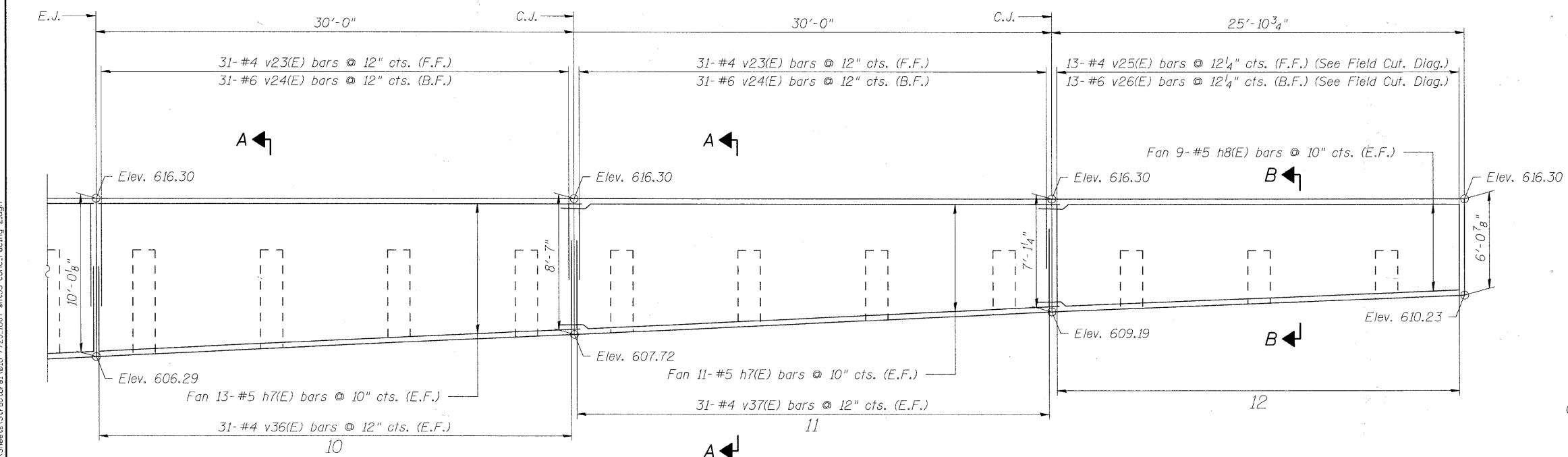

**ELEVATION**  
Concrete Facing Panels 10-12

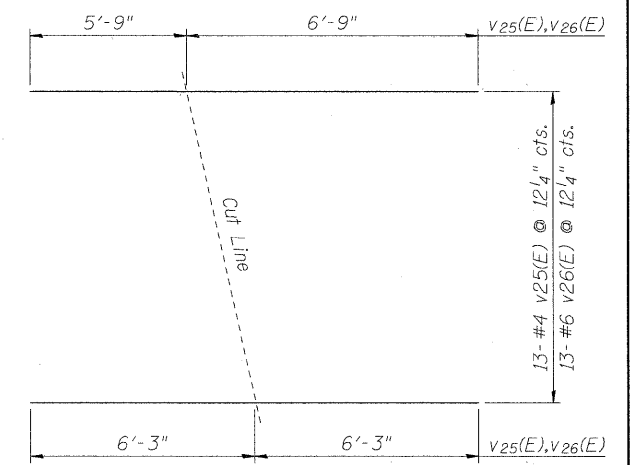

**FIELD CUTTING DIAGRAM**  
Order v25(E), and v26(E) full length.  
Cut as shown and use remainder of bars at the opposite end.

**MIN. BAR LAPS**  
#4 bars - 2'-0"  
#5 bars - 2'-6"  
#6 bars - 3'-0"

**NOTES**  
For Sections See Sheet 51 of 61.  
E.J. = Expansion Joint  
C.J. = Construction Joint  
B.F. = Back Face  
F.F. = Front Face  
E.F. = Each Face

FILE NAME = F:\60155877\000\_CAD\001\_Drawing\Sheets\Structure\1016-7725\_1001-sh23-Conc. Facing 2.dgn

<b>AECOM</b>	USER NAME = dabezi0d	DESIGNED - DD	REVISED -	<b>STATE OF ILLINOIS DEPARTMENT OF TRANSPORTATION</b>	<b>SOLDIER PILE PLAN &amp; ELEVATION I STRUCTURE NO. 016-7723</b>		F.A.U. RTE.	SECTION	COUNTY	TOTAL SHEETS	SHEET NO.
	PLOT SCALE = 0:1.0000 '1' / IN.	DRAWN - DD	REVISED -		1537	06-00050-00-GS	COOK	209	127		
	PLOT DATE = 1/21/2011	CHECKED - EJO	REVISED -		SCALE: SHEET NO. 33 OF 61 SHEETS STA. TO STA.		CONTRACT NO. 63556		ILLINOIS FED. AID PROJECT		
	DATE = 11/22/2010	REVISOR -	REVISED -								