

**OUTSIDE FACE
SOUTHBOUND PARAPET**

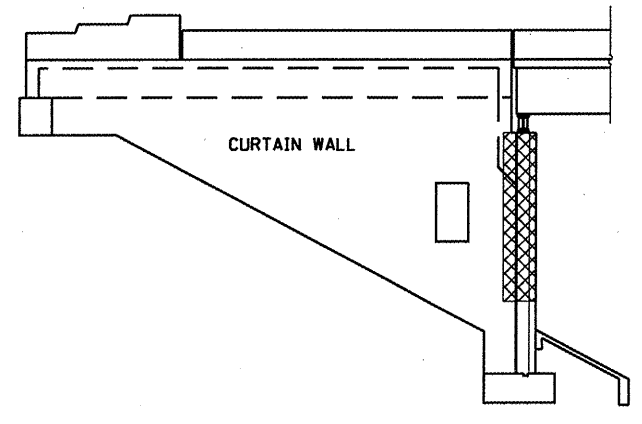

NW CURTAIN WALL

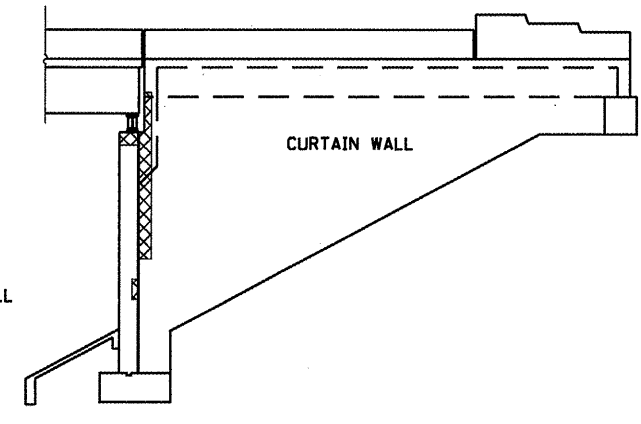
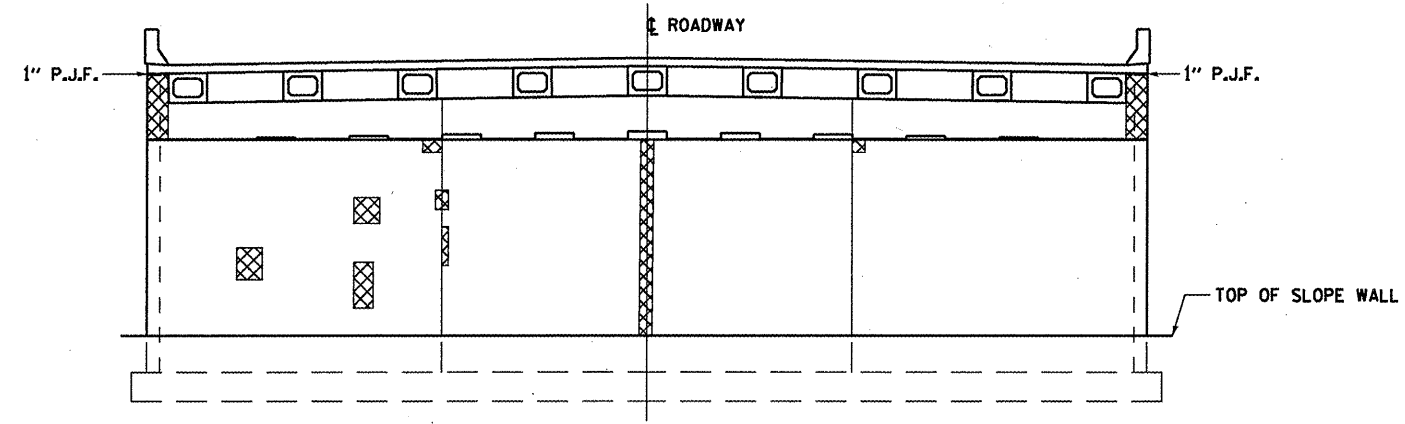

NE CURTAIN WALL

**NORTH ABUTMENT
LOOKING NORTH**



STRUCTURAL REPAIR OF CONCRETE
(LESS THAN OR EQUAL TO 5")

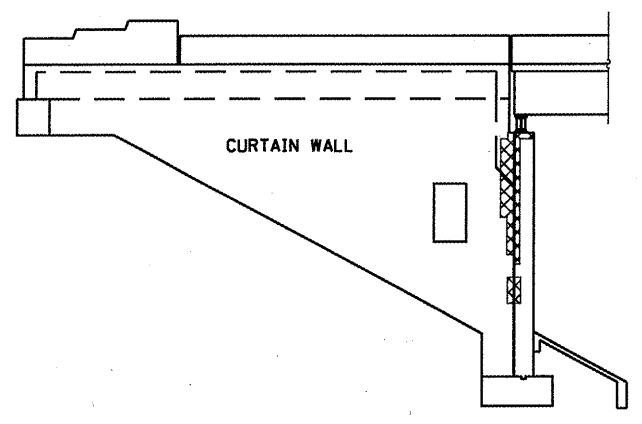

SE CURTAIN WALL

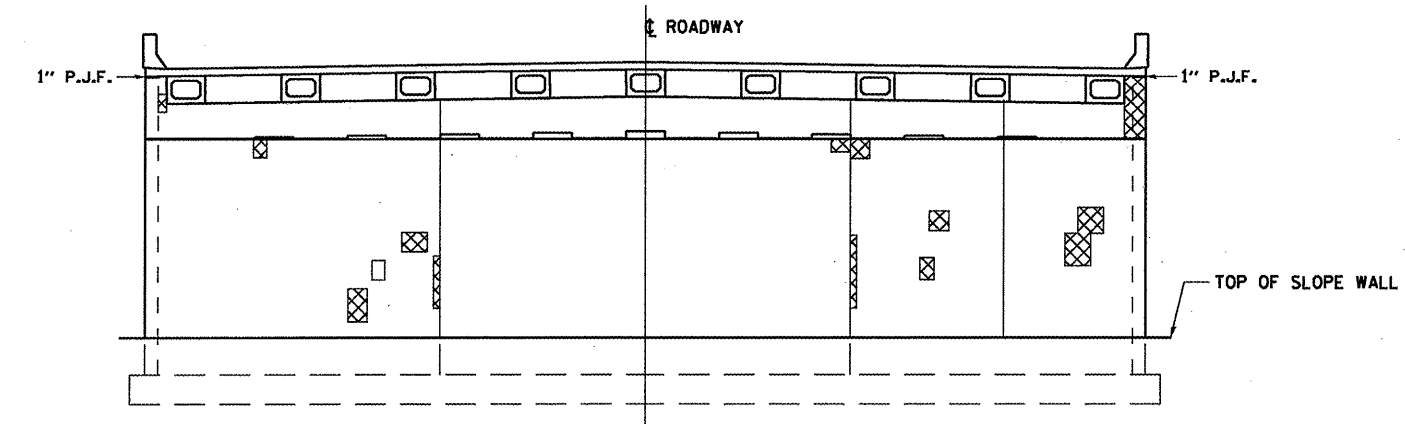

**SOUTH ABUTMENT
LOOKING SOUTH**

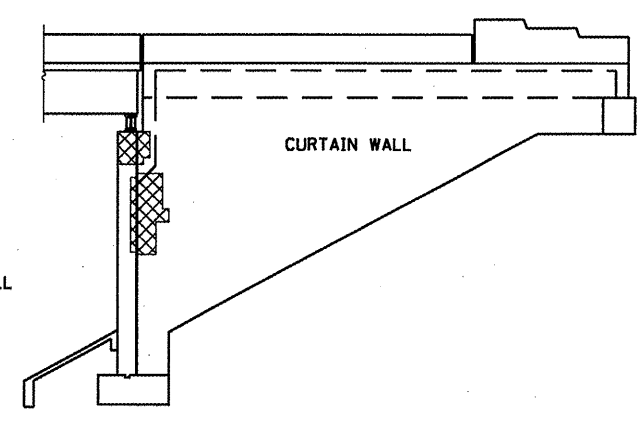

SW CURTAIN WALL

THE ENGINEER SHALL SOUND THE DESIGNATED AREAS
FOR EXACT LOCATIONS AND REPAIR AREAS PRIOR TO
BEGINNING REMOVAL OPERATIONS.

BILL OF MATERIAL

Item	Unit	Total
STRUCTURAL REPAIR OF CONCRETE (DEPTH EQUAL TO OR LESS THAN 5")	SQ FT	152

STRUCTURAL REPAIR OF CONCRETE
FAS 2370 (IL 26) SECTION (78-1HB-11)
PUTNAM COUNTY
STA. 40 + 00.00
S.N. 078-0010