

**INDEX OF SHEETS**

- 1. COVER SHEET
- 2. GENERAL NOTES
- 3. SUMMARY OF QUANTITIES
- 4. TYPICAL SECTION
- 5 - 6. TRAFFIC CONTROL AND PROTECTION, (SPECIAL)
- 7. TEMPORARY CONCRETE BARRIER
- 8. WIDTH RESTRICTION SIGNING
- 9 - 14. STRUCTURE PLANS

**STANDARDS**

- 000001-06 STANDARD SYMBOLS, ABBREVIATIONS AND PATTERNS
- 001001-02 AREAS OF REINFORCEMENT BARS
- 001006 DECIMAL OF AN INCH AND OF A FOOT
- 635011-02 REFLECTOR MARKER AND MOUNTING DETAILS
- 701001-02 OFF-ROAD OPERATIONS 2L, 2W, MORE THAN 15' (4.5 m) AWAY
- 701006-03 OFF-ROAD OPERATIONS 2L, 2W, 15' (4.5 m) TO 24" (600 mm) FROM PAVEMENT EDGE
- 701201-04 LANE CLOSURE, 2L, 2W, DAY ONLY, FOR SPEEDS ≥ 45 MPH
- 701301-04 LANE CLOSURE, 2L, 2W, SHORT TIME OPERATIONS
- 701321-11 LANE CLOSURE, 2L, 2W, BRIDGE REPAIR WITH BARRIER
- 701901-01 TRAFFIC CONTROL DEVICES
- 704001-06 TEMPORARY CONCRETE BARRIER

**STATE OF ILLINOIS**  
**DEPARTMENT OF TRANSPORTATION**  
**DIVISION OF HIGHWAYS**  
**PROPOSED**  
**HIGHWAY PLANS**

**FAS 2247 (US 6)**  
**SECTION (13C-BR)I**

**BRIDGE REPAIRS**  
**BUREAU COUNTY**

C-93-114-10

F.A.S. RTE.	SECTION	COUNTY	TOTAL SHEETS	SHEET NO.
2247	(13C-BR)I	BUREAU	14	1
		ILLINOIS	CONTRACT NO. 66A29	

D-93-002-11

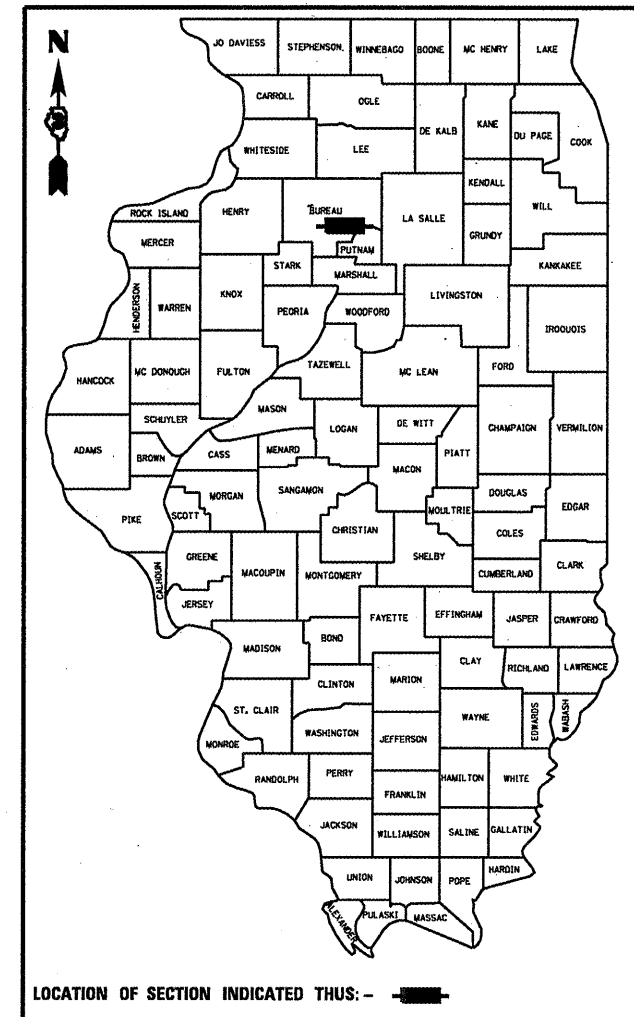

**FUNCTIONAL CLASSIFICATION**  
**RURAL - MAJOR ARTERIAL**  
**2009 ADT = 2600**  
**P.V. = 95.8%**  
**S.U. = 2.3%**  
**M.U. = 1.9%**

STATE OF ILLINOIS  
 DEPARTMENT OF TRANSPORTATION  
 DIVISION OF HIGHWAYS

SUBMITTED DECEMBER 28 2010  
George E. Ryan  
 DEPUTY DIRECTOR OF HIGHWAYS, REGION ENGINEER

February 4 2011  
Scott E. Stitt, P.E.  
 ENGINEER OF DESIGN AND ENVIRONMENT

February 4 2011  
Christine M. Reed  
 DIRECTOR OF HIGHWAYS, CHIEF ENGINEER

**PRINTED BY THE AUTHORITY**  
**OF THE STATE OF ILLINOIS**

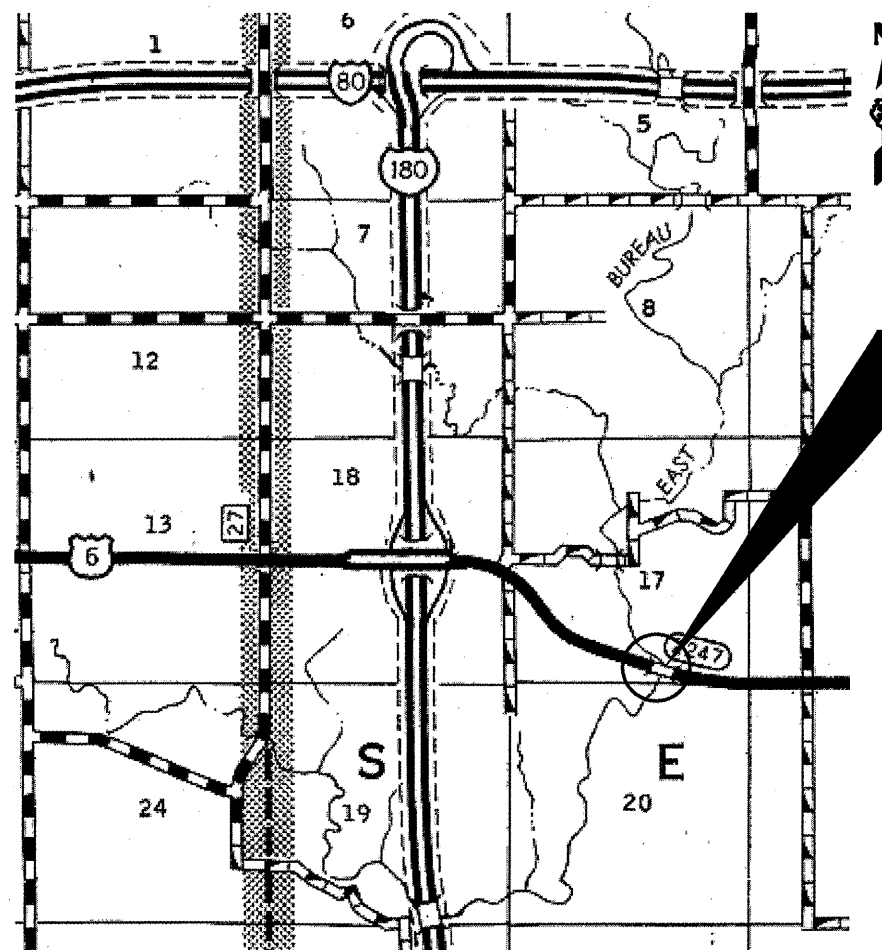

**PROJECT LOCATION**  
 SN 006-0137  
 CARRYING FAS 2247 (US 6) OVER  
 EAST BUREAU CREEK  
 1.3 MILES EAST OF I-180

POINT LOCATION

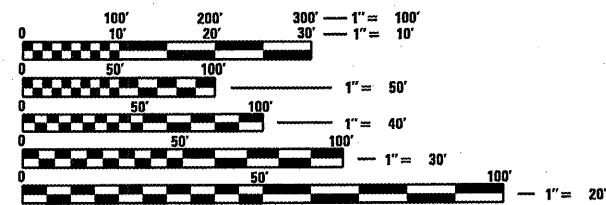

FULL SIZE PLANS HAVE BEEN PREPARED USING STANDARD ENGINEERING SCALES. REDUCED SIZED PLANS WILL NOT CONFORM TO STANDARD SCALES. IN MAKING MEASUREMENTS ON REDUCED PLANS, THE ABOVE SCALES MAY BE USED.

J.U.L.I.E.  
 JOINT UTILITY LOCATION INFORMATION FOR EXCAVATION  
 1-800-892-0123  
 OR 811

**PROJECT ENGINEER: JOE KANNEL**  
**UNIT CHIEF: RON WOODSHANK**  
**TOWNSHIP: SELBY**

**CONTRACT NO. 66A29**