

**WIDTH RESTRICTION
SN 006-0137**

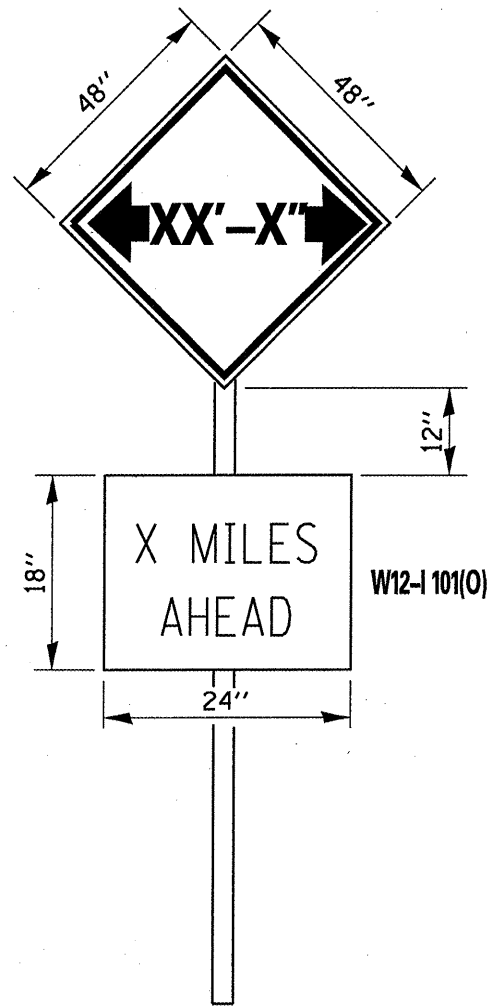

12" D BLACK LETTERING
WITH ORANGE BACKGROUND

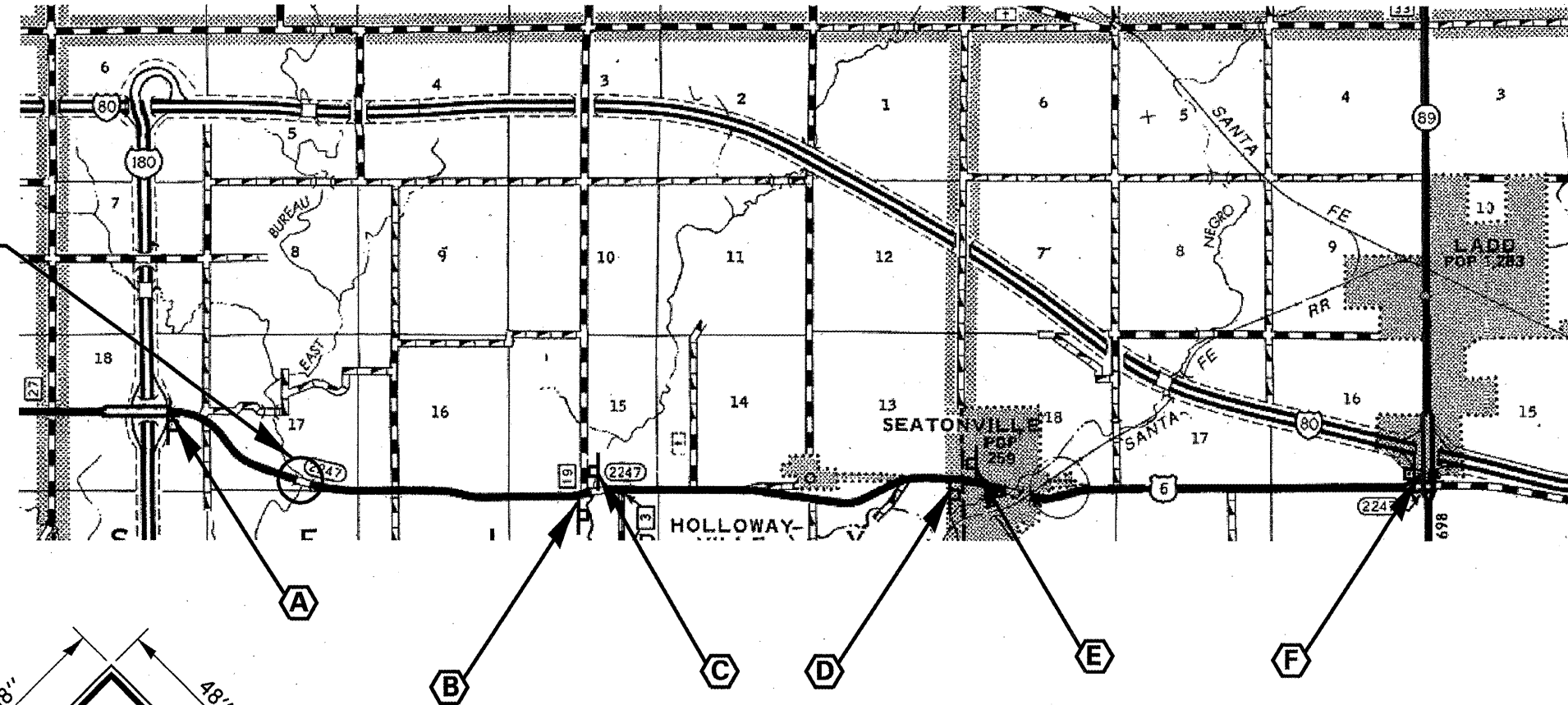
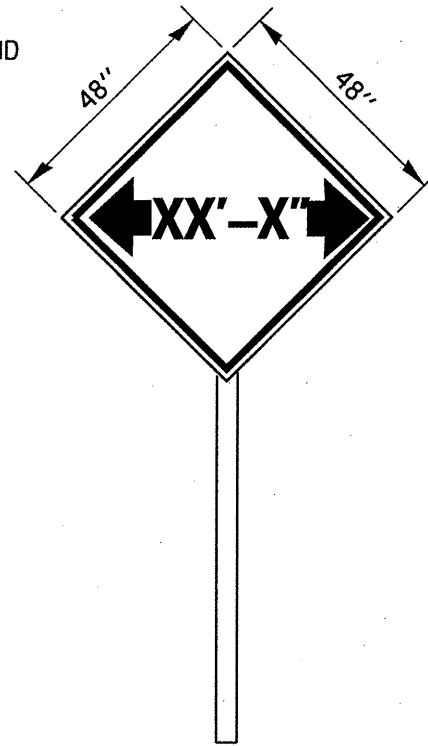

TO BE POST MOUNTED AS SHOWN ELSEWHERE IN THE PLANS.

THE ENGINEER WILL NOTIFY DISTRICT 3 BUREAU OF OPERATIONS 14 CALENDAR DAYS PRIOR TO INSTALLING ANY TRAFFIC CONTROL DEVICES THAT WILL RESTRICT THE PAVEMENT WIDTH.

THE CONTRACTOR SHALL BE RESPONSIBLE FOR COORDINATING WITH THE ENGINEER TO MEET THIS REQUIREMENT.

WIDTH RESTRICTION SIGNING TABLE				
NO. OF SIGNS	TYPE OF SIGN	SIGN DESIGNATION	LOCATION	WIDTH RESTRICTION & DISTANCE
1	WIDTH RESTRICTION W12-1-101-(O) M6-3	A	ON US 6 AT TOP OF I-180 EB OFF RAMP (FOR US 6 EB TRAFFIC)	10'-0" 1.1 MILES
1	WIDTH RESTRICTION W12-1-101-(O) M6-3	B	ON US 6 SW CORNER AT 2625 E ST. (FOR US 6 EB TRAFFIC)	10'-0" 1.6 MILE
1	WIDTH RESTRICTION W12-1-101-(O) M6-3	C	ON US 6 NE CORNER AT 2625 E ST. (FOR US 6 EB TRAFFIC)	10'-0" 1.6 MILE
1	WIDTH RESTRICTION W12-1-101-(O) M6-3	D	ON US 6 SW CORNER AT CR 3000 E (FOR US 6 EB TRAFFIC)	10'-0" 4.4 MILE
1	WIDTH RESTRICTION W12-1-101-(O) M6-3	E	ON US 6 NE CORNER AT CR 3000 E (FOR US 6 EB TRAFFIC)	10'-0" 4.4 MILE
1	WIDTH RESTRICTION W12-1-101-(O) M6-3	F	ON US 6 NW CORNER AT IL RTE. 89 FOR US 6 WB TRAFFIC)	10'-0" 7.4 MILE