

**LEGEND**

- DETECTOR LOOP
- CONDUIT IN TRENCH
- - - ELECTRIC CABLE IN CONDUIT, LEAD-IN 14 1 PAIR
- EXISTING UNDERGROUND CONDUIT
- ◻ EXISTING DOUBLE HANDHOLE
- ◻ EXISTING HANDHOLE
- ◻ EXISTING CONTROLLER
- EXISTING DIVE HOLES

DRILL EXISTING FOUNDATION 1 EACH  
 STA. 10+87  
 109' LT.

- Ⓐ EXISTING 2 1/2" ± CONDUIT
- Ⓑ EXISTING 1 1/4" ± CONDUIT
- Ⓒ EXISTING DIVE HOLES

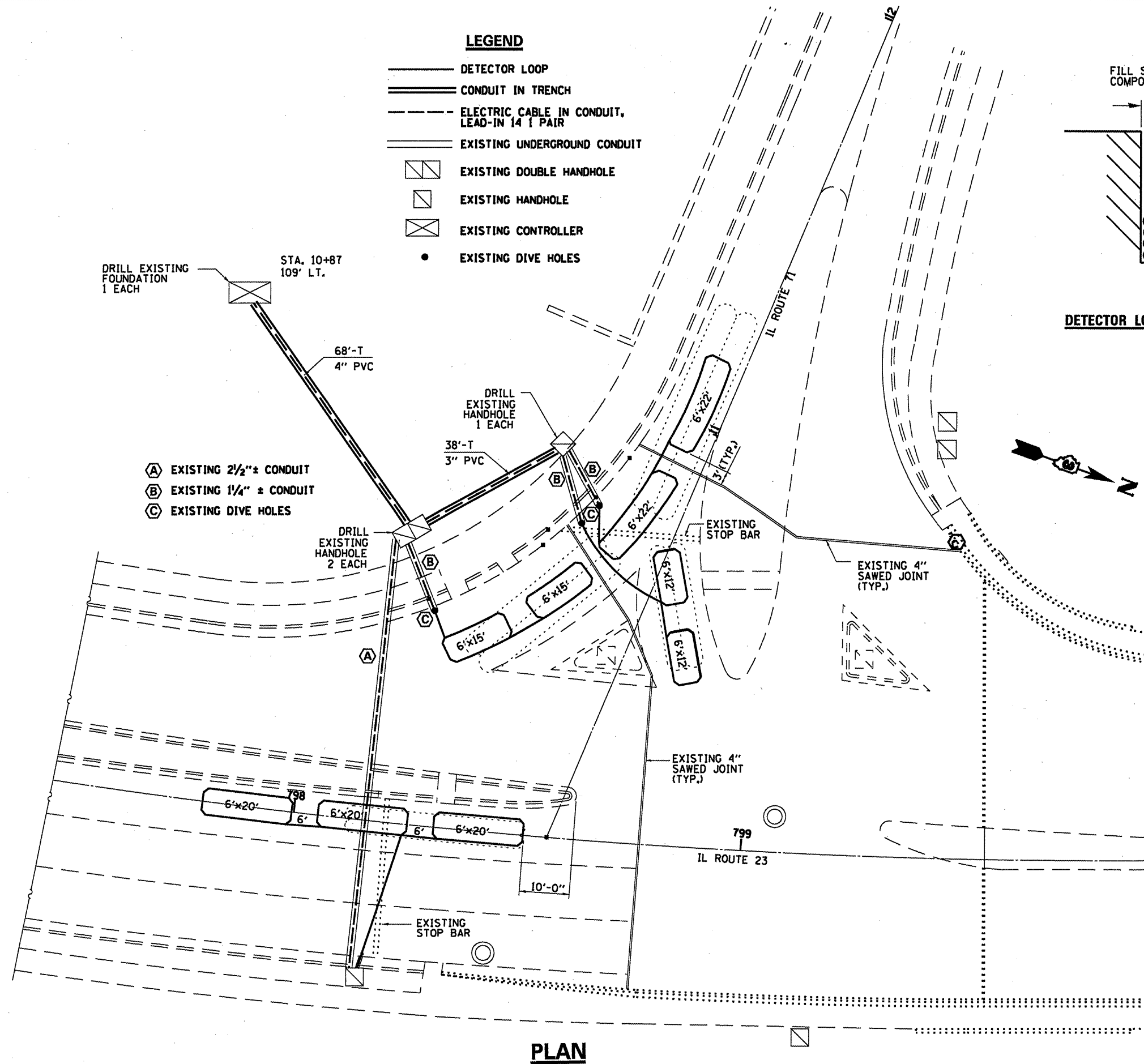

**PLAN**

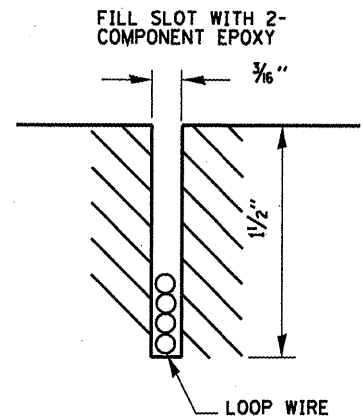

**DETECTOR LOOP INSTALLATION**

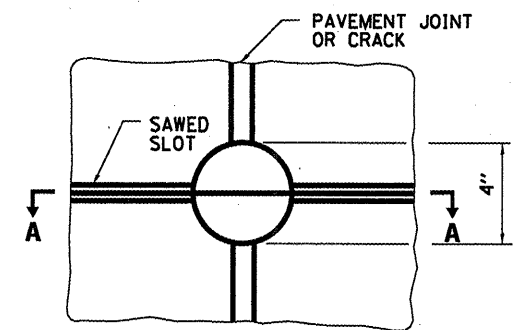

**PLAN**

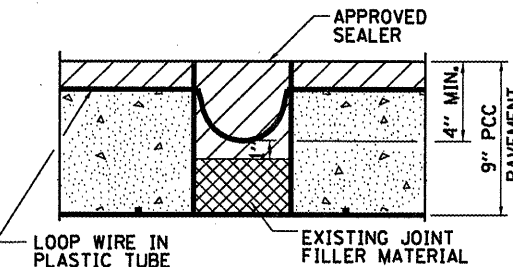

**SECTION A-A**

NOTE:  
 LOOP WIRE SHALL FOLLOW CUT TO BOTTOM, FORMING SLACK SECTION AT JOINT.

**DETECTOR LOOP AT PAVEMENT JOINT OR PAVEMENT CRACK**

**NOTES:**

THE CONTRACTOR SHALL COORDINATE THE PROPOSED DETECTOR LOOP WORK WITH THE DEPARTMENT'S TRAFFIC SIGNAL SECTION PRIOR TO BEGINNING CONSTRUCTION OPERATIONS, PHONE: (815) 434-8506.

ALL DETECTOR LOOPS SHALL HAVE FOUR (4) TURNS.

6'-0" TYPICAL DIMENSION BETWEEN DETECTOR LOOPS.

ALL EXISTING CONDUIT SHALL REMAIN IN PLACE AND IN USE.

FILE NAME =	USER NAME = woodshankr1	DESIGNED - RON WOODSHANK	REVISED -	<b>STATE OF ILLINOIS DEPARTMENT OF TRANSPORTATION</b>	<b>DETECTOR LOOP DETAILS</b>	F.A.P. RTE.	SECTION	COUNTY	TOTAL SHEETS	SHEET NO.
MAIN11-0366A56-details.dgn	DRAWN - RON WOODSHANK	REVISED -	68			(IZR)1-2	LASALLE	23	13	
PLOT SCALE = 1/8" = 1' IN.	CHECKED -	REVISED -	CONTRACT NO. 66A56							
PLOT DATE = Dec 28, 2010 - 12:43:23 PM	DATE -	REVISED -	ILLINOIS FED. AID PROJECT							
					SCALE: _____	SHEET NO. 1 OF 1 SHEETS		STA. _____ TO STA. _____		