

INDEX OF SHEETS

- 1 COVER SHEET
- 2-3 GENERAL NOTES
- 4-5 SUMMARY OF QUANTITIES
- 6 TYPICAL SECTION
- 7-9 SCHEDULES OF QUANTITIES
- 10 ALIGNMENT, TIES, & BENCHMARKS
- 11 PLAN AND PROFILE
- 12 STAGE CONSTRUCTION DETAILS
- 13 TEMPORARY EROSION CONTROL
- 14-27 STRUCTURE PLANS
- 28 BACKFILL DETAIL
- 29-34 CROSS SECTIONS
- 35-43 DISTRICT STANDARDS

HIGHWAY STANDARDS

- 000001-06 701306-03
- 001001-02 701311-03
- 280001-05 701321-11
- 666001-01 701326-04
- 701001-02 701901-01
- 701006-03 704001-06
- 701011-02 780001-02
- 701301-04

DESIGNATION	CLASSIFICATION
ADT = 2100	
MU = 125	
SU = 100	

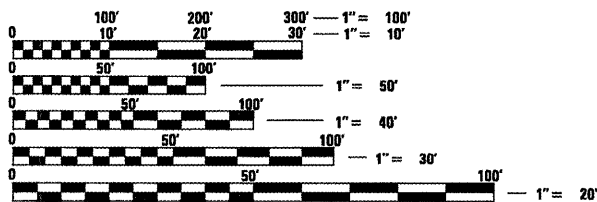

FULL SIZE PLANS HAVE BEEN PREPARED USING STANDARD ENGINEERING SCALES. REDUCED SIZED PLANS WILL NOT CONFORM TO STANDARD SCALES. IN MAKING MEASUREMENTS ON REDUCED PLANS, THE ABOVE SCALES MAY BE USED.

J.U.I.E.
JOINT UTILITY LOCATION INFORMATION FOR EXCAVATION
1-800-892-0123
OR 811

PROJECT ENGINEER: RICH DOTSON
PROJECT DESIGNER: GEORGE ELIAS

CONTRACT NO. 68662

STATE OF ILLINOIS DEPARTMENT OF TRANSPORTATION DIVISION OF HIGHWAYS PROPOSED HIGHWAY PLANS

FAP ROUTE 685 (IL 9)
SECTION (118B)BR-1
PROJECT ACF-0685(032)
TYPE of IMPROVEMENT: BRIDGE REPLACEMENT
MCDONOUGH COUNTY

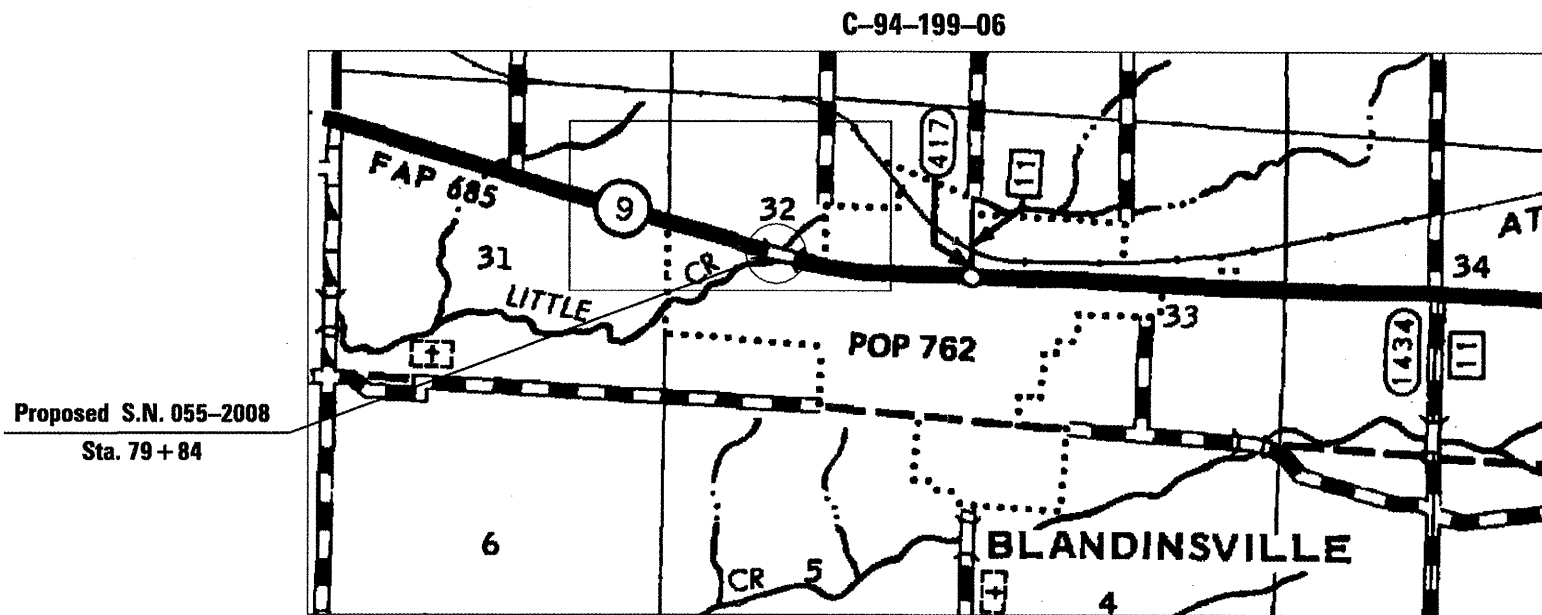

GROSS LENGTH = 505 FT. = 0.096 MILE
NET LENGTH = 505 FT. = 0.096 MILE

F.A.P. RTE.	SECTION	COUNTY	TOTAL SHEETS	SHEET NO.
685	(118B)BR-1	MCDONOUGH	43	1
IL 9 over Little Creek		ILLINOIS	CONTRACT NO. 68662	

D-94-131-06

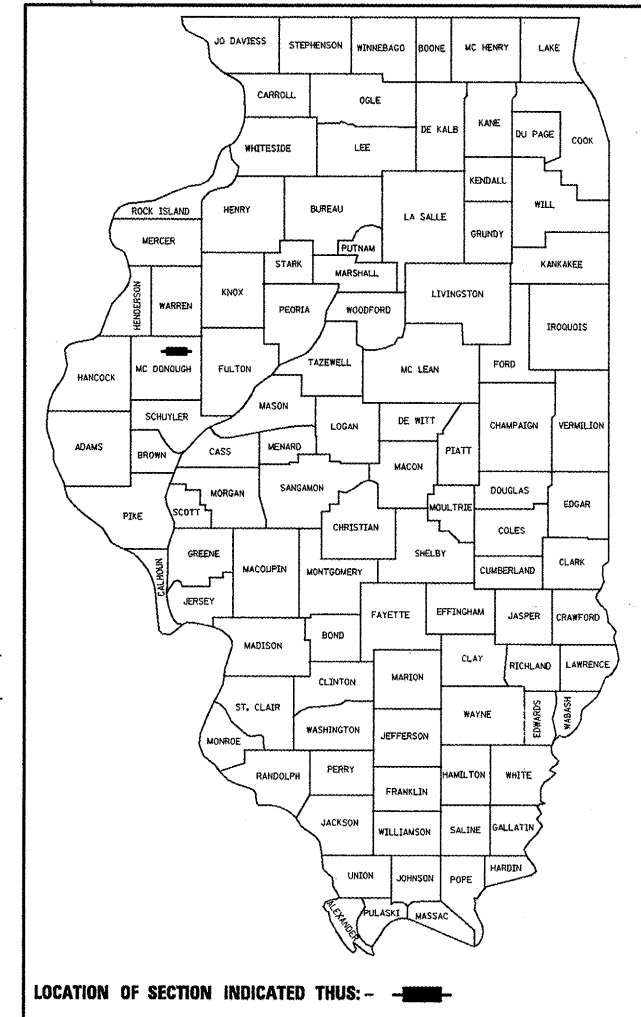

LOCATION OF SECTION INDICATED THUS: - - -

DESCRIPTION OF WORK

REPLACEMENT OF EXISTING STRUCTURE (055-0012) CARRYING IL 9 OVER LITTLE CREEK BY PROPOSED STRUCTURE (S.N. 055-2008) AT WCL BLANDINSVILLE

STATE OF ILLINOIS
DEPARTMENT OF TRANSPORTATION
DIVISION OF HIGHWAYS

SUBMITTED *Dec 20* 20 *10*

DEPUTY DIRECTOR OF HIGHWAYS, REGION ENGINEER

February 4 20 *11*

Scott E. Stitt P.E.

ENGINEER OF DESIGN AND ENVIRONMENT

February 4 20 *11*

Christine M. Reed

DIRECTOR OF HIGHWAYS, CHIEF ENGINEER

PRINTED BY THE AUTHORITY
OF THE STATE OF ILLINOIS