

RAYMOND E. FERGUSON &
LARRY J. FERGUSON

STA 79+84.00, 40° LT FWD
PR DOUBLE 10'X10' BOX CULVERT
PR SN 055-2008

PAVEMENT RECONSTRUCTION
STA 79+24 TO STA 80+59

REMOVE EX SN 055-0012

BLANDINSVILLE GOLF &
COUNTRY CLUB

EX BILLBOARD
TO BE REMOVED

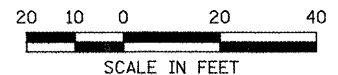

DATE	
BY	
SURVEYED	
ALIGNED	
CHECKED	
RT. OF WAY CHECKED	
PAID FILE NAME	
NO.	

DATE	
BY	
SURVEYED	
GRADES CHECKED	
STRUCTURE NOTATIONS CHECKED	
NO.	

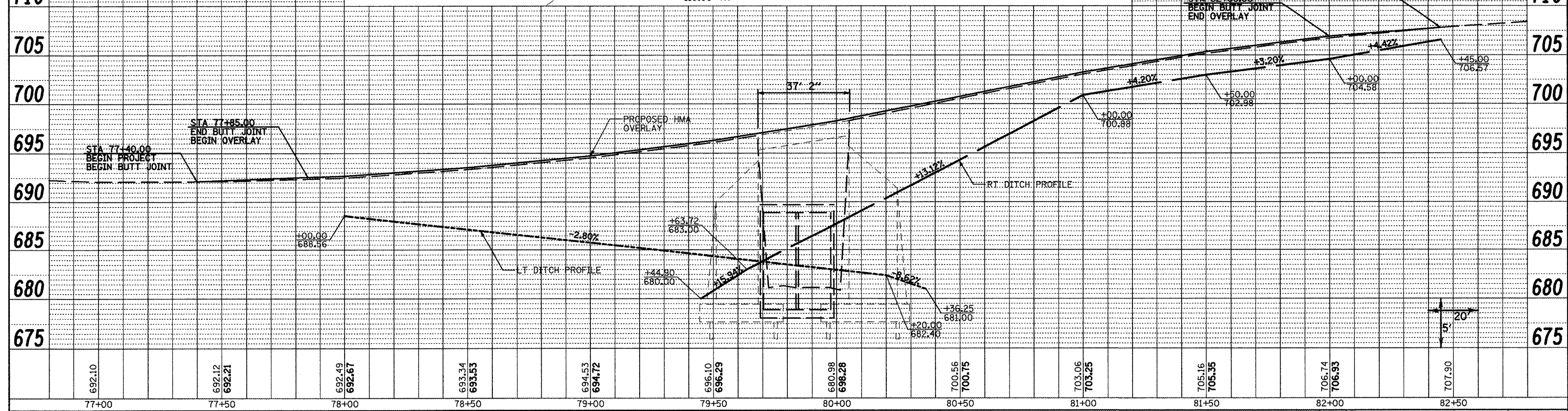
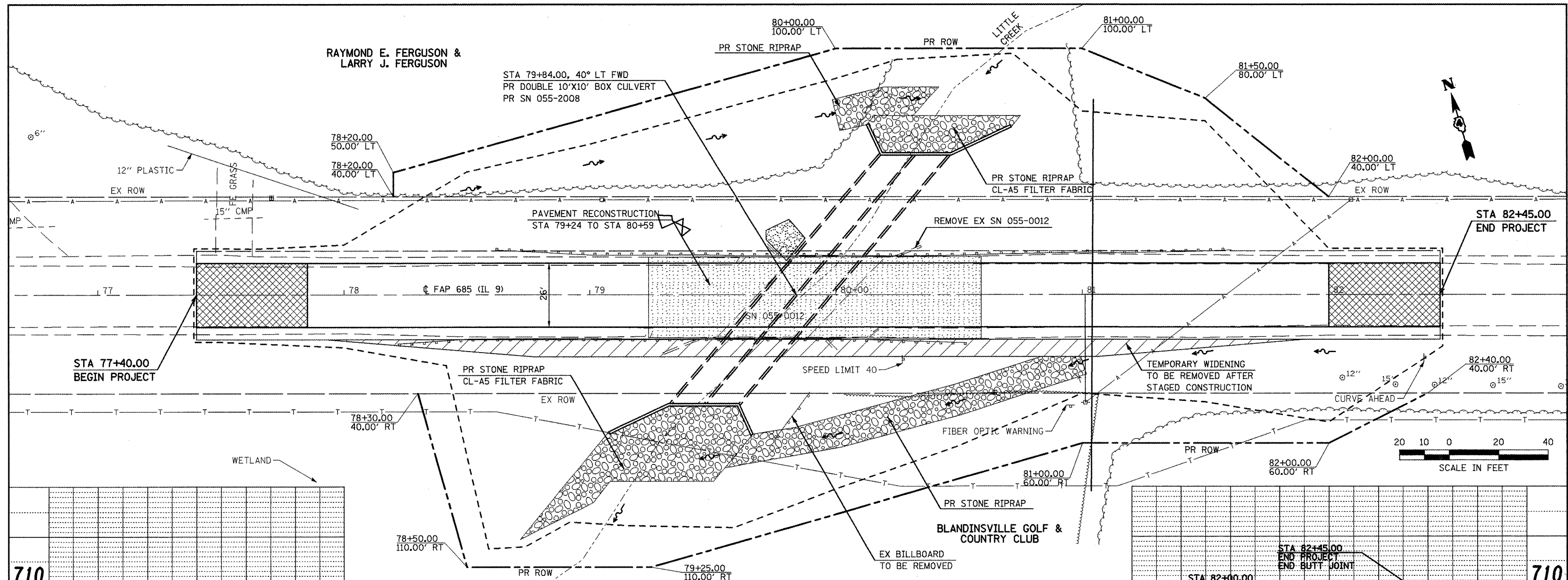

FILE NAME =	USER NAME = eschornbr	DESIGNED -	REVISED -	<p align="center">STATE OF ILLINOIS DEPARTMENT OF TRANSPORTATION</p> <p align="center">PLAN & PROFILE SHEET</p>	F.A.P. RTE.	SECTION	COUNTY	TOTAL SHEETS	SHEET NO.
D468662-Sht-PlanPrf.dgn		DRAWN -	REVISED -		685	(118)BR-1	McDONOUGH	43	11
		CHECKED -	REVISED -		IL 9 over Little Creek CONTRACT No. 68662				
		DATE -	REVISED -		FED. ROAD DIST. NO. ILLINOIS FED. AID PROJECT				
PLOT SCALE = 40.0000' / IN.				SCALE: 1"=20'	SHEET NO. OF SHEETS STA. TO STA.				
PLOT DATE = 12/21/2018									