

Stage 3- Westbound US 24

General Notes

- Pavement Marking Tape Type III-4" White- 130 ft
- Pavement Marking Tape Type III-6" Black- 70 ft
- Work Zone Pavement Marking Removal- 66 sq ft
- Temporary Concrete Barrier-125 ft
- Attenuator - Test Level 2 NRD- 1
- Changeable Message Board-1
- Arrow Board- 2

Delineation devices shall be lit with mono-directional lights at centers shown.
 Type III 6" Black Tape shall be acceptable for temporarily covering conflicting markings.
 Traffic control shall be as shown and shall be paid as TRAFFIC CONTROL AND PROTECTION (SPECIAL) unless covered by specific pay items.

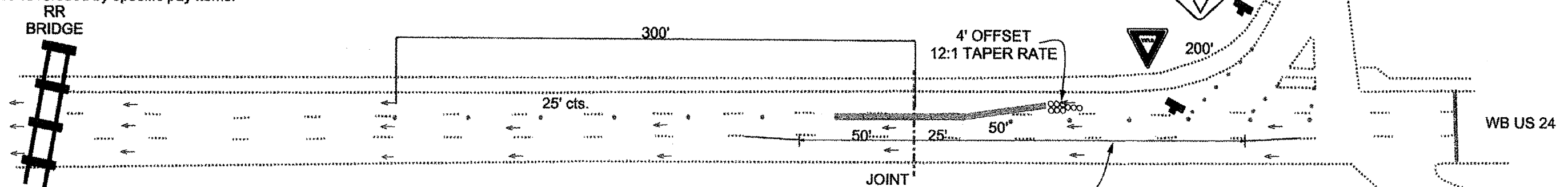

Skip dashes to be covered and re-centered where traffic lanes are not of same width.
 30' solid line to delineate beginning and end of shift.

NOTES:
 Changeable Message Signs shall be placed in locations shown at least one week in advance of project start for early traffic notification.

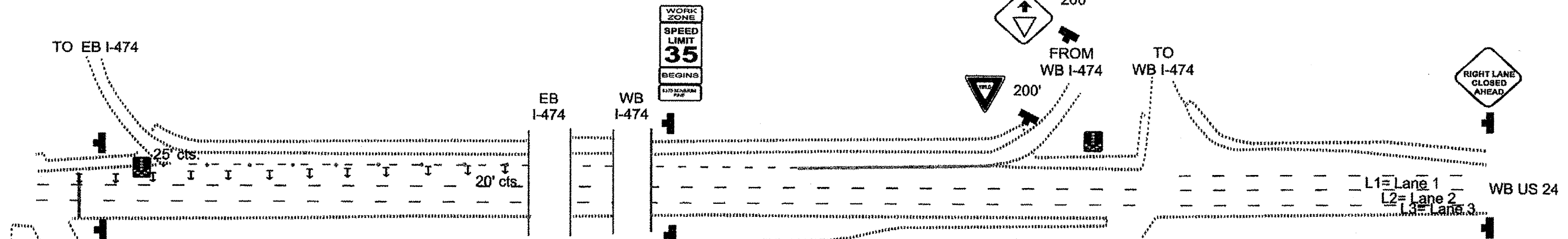

Place additional signs east of viaduct- min. 500' prior to "RIGHT LANE CLOSED AHEAD" sign located on west side of viaduct.

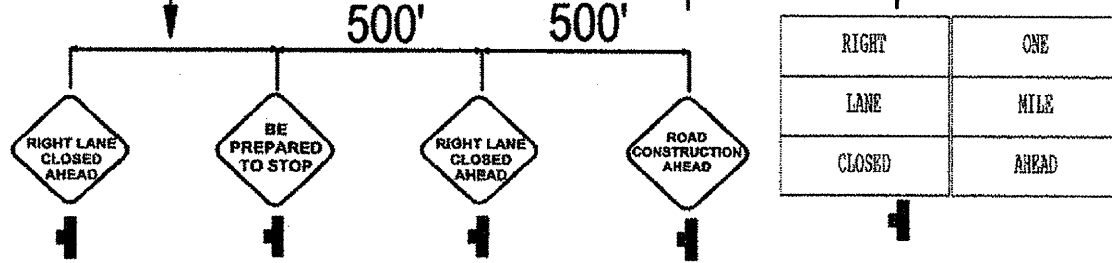

S:\GEN\DRAWING\STANDARD\PLANS/SOLID BRIDGES/BRIDGE CONTRACTS/JOINTS/SN072-0134/SN072-0134 US24vrrkicakpoc00r.k.dgn

FILE NAME = SN072-0134 US24vrrkicakpoc00r.k.dgn	USER NAME = jonesce	DESIGNED - D. HOFFMAN	REVISED -	STATE OF ILLINOIS DEPARTMENT OF TRANSPORTATION	TRAFFIC CONTROL STRUCTURE NO. 072-0134	F.A.P. RTE. 317	SECTION (488)I-1	COUNTY PEORIA	TOTAL SHEETS 26	SHEET NO. 14	
PLOT SCALE = 1/83,7051' / IN.	DRAWN - D. HOFFMAN	CHECKED -	REVISED -			N.Abut. Rehab, Brgs./Jt. Repl.	CONTRACT NO. 68995		ILLINOIS FED. AID PROJECT		
PLOT DATE = 1/11/2011	DATE - 12/30/2010	REVISED -	REVISED -			SCALE: _____	SHEET NO. ____ OF ____ SHEETS	STA. _____ TO STA. _____			