

STATE OF ILLINOIS  
DEPARTMENT OF TRANSPORTATION

**NORTH FACE OF CURB**

Location	Station	Offset	Theoretical Grade Elevations
End of West Appr. Slab	2142+22.61	-21.00	728.94
A	2142+32.61	-21.00	728.96
B	2142+42.61	-21.00	728.97
Back of West Culvert Wall	2142+52.61	-21.00	728.99
CL of Culvert	2142+74.00	-21.00	729.02
Back of East Culvert Wall	2142+95.39	-21.00	729.05
C	2143+05.39	-21.00	729.06
D	2143+15.39	-21.00	729.07
End of East Appr. Slab	2143+25.39	-21.00	729.09

**NORTH EDGE OF PAVEMENT**

Location	Station	Offset	Theoretical Grade Elevations
End of West Appr. Slab	2142+13.61	-12.00	729.12
A	2142+23.61	-12.00	729.13
B	2142+33.61	-12.00	729.15
Back of West Culvert Wall	2142+43.61	-12.00	729.16
CL of Culvert	2142+65.00	-12.00	729.19
Back of East Culvert Wall	2142+86.39	-12.00	729.22
C	2142+96.39	-12.00	729.23
D	2143+06.39	-12.00	729.25
End of East Appr. Slab	2143+16.39	-12.00	729.26

**☉ ROADWAY & P.G.**

Location	Station	Offset	Theoretical Grade Elevations
End of West Appr. Slab	2142+01.61	0.00	729.29
A	2142+11.61	0.00	729.30
B	2142+21.61	0.00	729.32
Back of West Culvert Wall	2142+31.61	0.00	729.33
CL of Culvert	2142+53.00	0.00	729.36
Back of East Culvert Wall	2142+74.39	0.00	729.39
C	2142+84.39	0.00	729.41
D	2142+94.39	0.00	729.42
End of East Appr. Slab	2143+04.39	0.00	729.43

**SOUTH EDGE OF PAVEMENT**

Location	Station	Offset	Theoretical Grade Elevations
End of West Appr. Slab	2141+89.61	12.00	729.08
A	2141+99.61	12.00	729.10
B	2142+09.61	12.00	729.11
Back of West Culvert Wall	2142+19.61	12.00	729.13
CL of Culvert	2142+41.00	12.00	729.16
Back of East Culvert Wall	2142+62.39	12.00	729.19
C	2142+72.39	12.00	729.20
D	2142+82.39	12.00	729.21
End of East Appr. Slab	2142+92.39	12.00	729.23

**SOUTH FACE OF CURB**

Location	Station	Offset	Theoretical Grade Elevations
End of West Appr. Slab	2141+85.61	16.00	729.00
A	2141+95.61	16.00	729.01
B	2142+05.61	16.00	729.02
Back of West Culvert Wall	2142+15.61	16.00	729.04
CL of Culvert	2142+37.00	16.00	729.07
Back of East Culvert Wall	2142+58.39	16.00	729.10
C	2142+68.39	16.00	729.11
D	2142+78.39	16.00	729.13
End of East Appr. Slab	2142+88.39	16.00	729.14

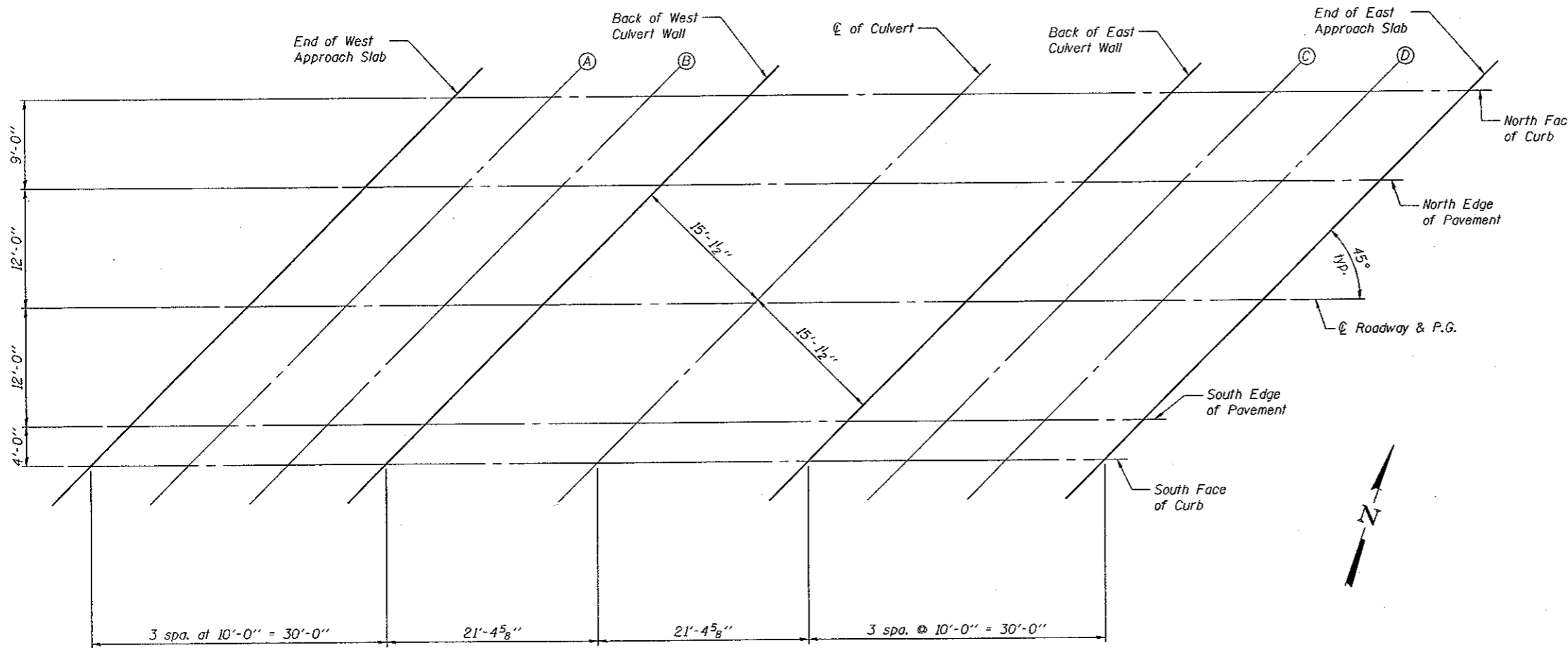

**PLAN**

**TOP OF SLAB ELEVATIONS  
STRUCTURE NO. 020-2014**



DESIGNED - BAS
CHECKED - KEF
DRAWN - SGM
CHECKED - BAS

SHEET NO. 2	F.A.P. RTE.	SECTION	COUNTY	TOTAL SHEETS	SHEET NO.
	71	(15B-1)BR-1	DEWITT	76	28
9 SHEETS	CONTRACT NO. 70271				
FED. ROAD DIST. NO. ILLINOIS FED. AID PROJECT					