

DATE	
BY	
FINAL SURVEY	
CORRECTED	
PLOTTED	
TEMPLATE	
NOTE BOOK	
AREAS CHECKED	

DATE	
BY	
ORIGINAL SURVEY	
CORRECTED	
PLOTTED	
TEMPLATE	
NOTE BOOK	
AREAS CHECKED	

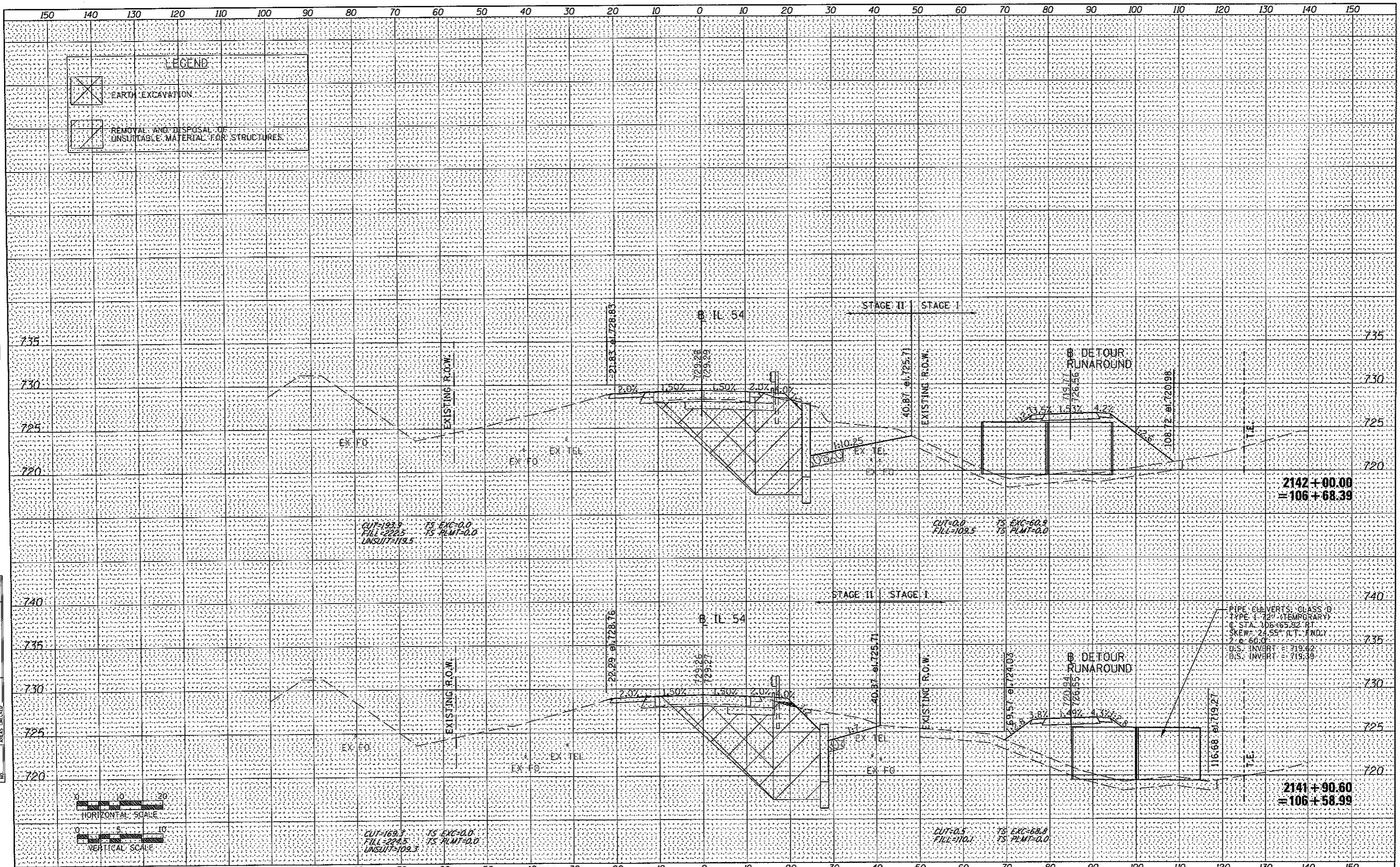

PIPE CULVERTS: CLASS D  
 TYPE 1 72" (TEMPORARY)  
 C STA. 106+65.32 RT  
 SKEW= 24.55° (LT. FWD.)  
 2' R 60.0'  
 D/S INVERT = 719.42  
 U/S INVERT = 719.39

FILE NAME = 0570271-sht-xsst-construction.dgn	USER NAME = willows	DESIGNED -	REVISED -	<b>STATE OF ILLINOIS</b> <b>DEPARTMENT OF TRANSPORTATION</b>	<b>IL 54 OVER COON CREEK CONSTRUCTION CROSS SECTIONS</b>	F.A.P. RTE. 71	SECTION 15B-16R-1	COUNTY DEWITT	TOTAL SHEETS 76	SHEET NO. 42
PLOT SCALE = 20.0000' / IN.	CHECKED -	REVISED -	SCALE:			SHEET NO. OF SHEETS	STA. 2141+90.60 TO STA. 2142+00.00	ILLINOIS FED. AID PROJECT		CONTRACT NO. 70271
PLOT DATE = 12/1/2010	DATE -	REVISED -								