

| | |
|---------------|--|
| DATE | |
| BY | |
| FINAL SURVEY | |
| NOTE BOOK | |
| NO. | |
| AREAS CHECKED | |

| | |
|-----------------|--|
| DATE | |
| BY | |
| ORIGINAL SURVEY | |
| NOTE BOOK | |
| NO. | |
| AREAS CHECKED | |

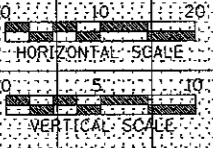
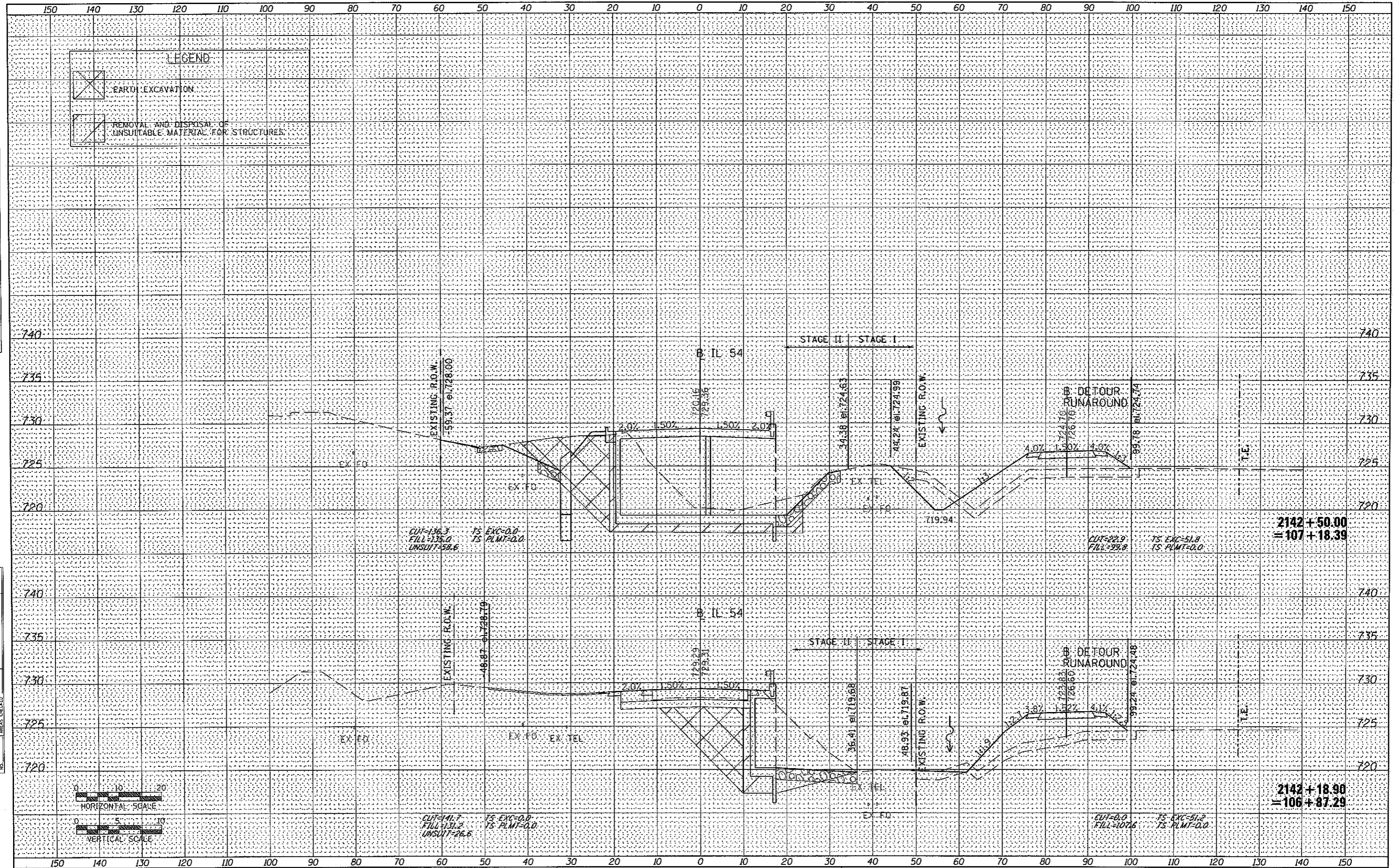

FILE NAME = 0570271-sht-xssh-construction.dgn
 USER NAME = williams
 PLOT SCALE = 20,0000' / IN.
 PLOT DATE = 12/1/2010

| | |
|------------|-----------|
| DESIGNED - | REVISED - |
| DRAWN - | REVISED - |
| CHECKED - | REVISED - |
| DATE - | REVISED - |

STATE OF ILLINOIS
 DEPARTMENT OF TRANSPORTATION

IL 54 OVER COON CREEK CONSTRUCTION CROSS SECTIONS

SCALE: SHEET NO. OF SHEETS STA. 2142+18.90 TO STA. 2142+50.00

| | | | | |
|--------------------|---------------------|---------------|-----------------|-----------------------------|
| F.A.P. RTE. 71 | SECTION (158-1BR-1) | COUNTY DEWITT | TOTAL SHEETS 76 | SHEET NO. 43 |
| CONTRACT NO. 70271 | | | | [ILLINOIS] FED. AID PROJECT |