

BY	DATE
SURVEYED	
PLotted	
NOTE BOOK	
AREAS CHECKED	

BY	DATE
ORIGINAL SURVEY	
PLotted	
NOTE BOOK	
AREAS CHECKED	

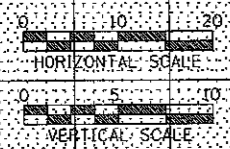
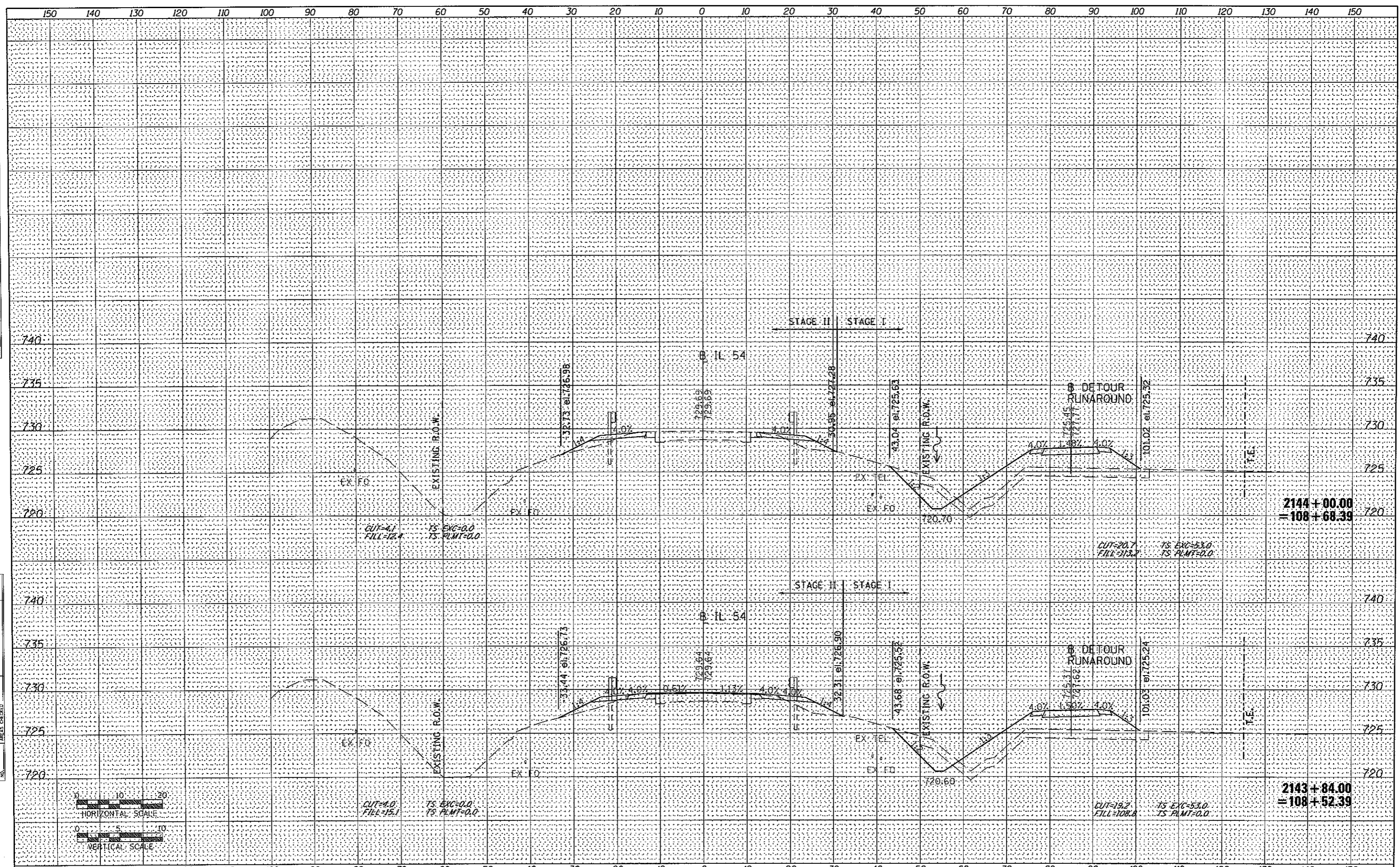

FILE NAME = 0578271-sht-ssht-construction.dgn
 USER NAME = wlewis
 PLOT SCALE = 20,0000' / IN.
 PLOT DATE = 12/1/2010

DESIGNED -	REVISED -
DRAWN -	REVISED -
CHECKED -	REVISED -
DATE -	REVISED -

**STATE OF ILLINOIS
DEPARTMENT OF TRANSPORTATION**

IL 54 OVER COON CREEK CONSTRUCTION CROSS SECTIONS

SCALE: SHEET NO. OF SHEETS STA. 2143+84.00 TO STA. 2144+00.00

F.A.P. RTE. 71	SECTION (158-1)BR-1	COUNTY DEWITT	TOTAL SHEETS 76	SHEET NO. 46
CONTRACT NO. 70271				ILLINOIS FED. AID PROJECT