

| | |
|---------------|--|
| DATE | |
| BY | |
| FINAL SURVEY | |
| NOTE BOOK | |
| AREAS CHECKED | |

| | |
|-----------------|--|
| DATE | |
| BY | |
| ORIGINAL SURVEY | |
| NOTE BOOK | |
| AREAS CHECKED | |

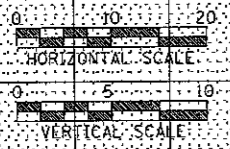
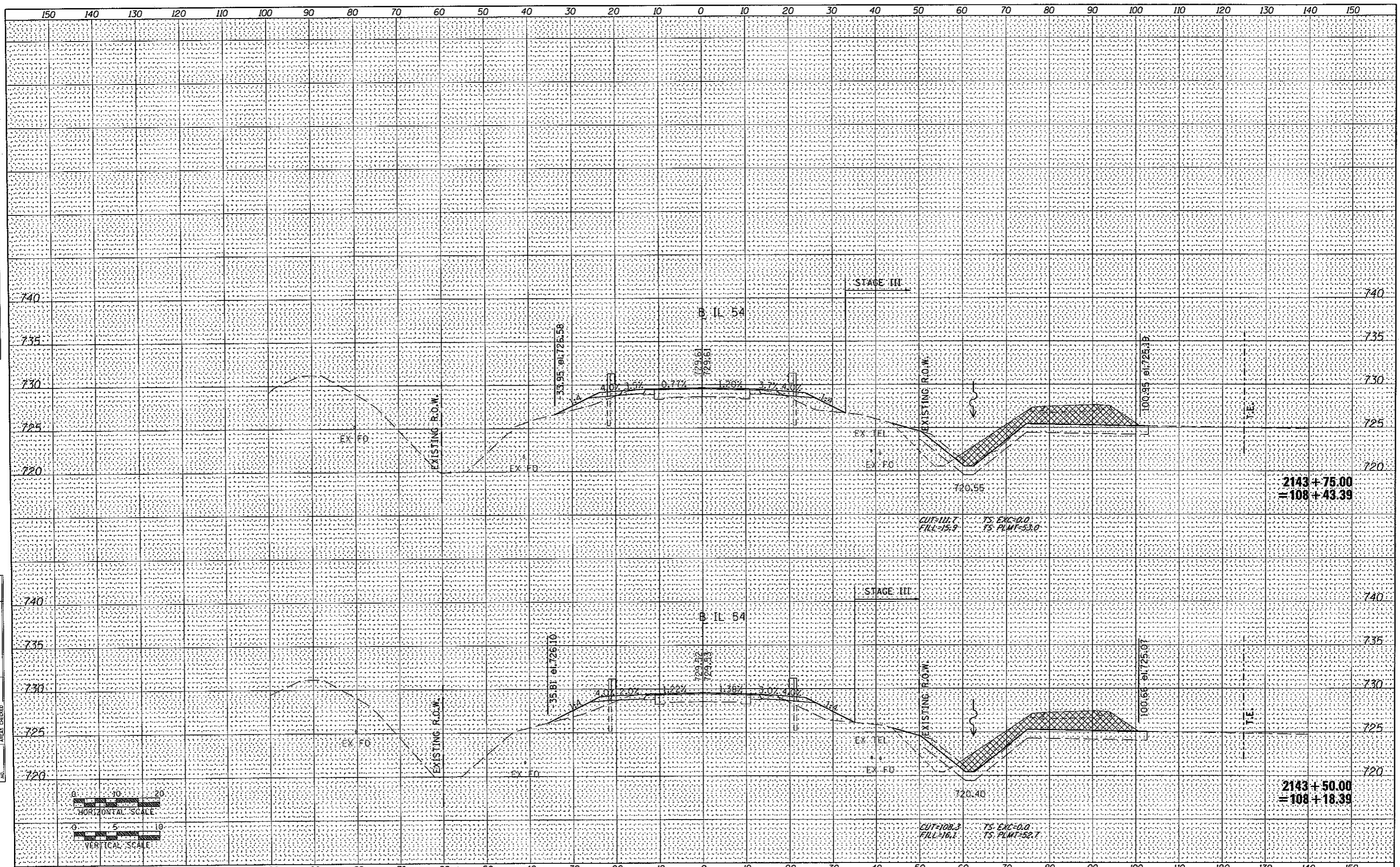

FILE NAME = DS70271-sht-ssht-final grading.dgn
 USER NAME = wlewis
 PLOT SCALE = 20.0000' / IN.
 PLOT DATE = 12/1/2010

| | |
|------------|-----------|
| DESIGNED - | REVISED - |
| DRAWN - | REVISED - |
| CHECKED - | REVISED - |
| DATE - | REVISED - |

**STATE OF ILLINOIS
DEPARTMENT OF TRANSPORTATION**

IL 54 OVER COON CREEK FINAL GRADING CROSS SECTIONS

SCALE: SHEET NO. OF SHEETS STA. 2143+50.00 TO STA. 2143+75.00

| | | | | |
|---------------------------|-------------|--------|--------------|-----------|
| F.A.P. RTE. | SECTION | COUNTY | TOTAL SHEETS | SHEET NO. |
| 71 | (158-1)BR-1 | DEWITT | 76 | 61 |
| CONTRACT NO. 70271 | | | | |
| ILLINOIS FED. AID PROJECT | | | | |