

STATE OF ILLINOIS
DEPARTMENT OF TRANSPORTATION

SOUTH CURB LINE

Location	Station	Offset	Theoretical Grade Elevations
East end of W. Appr. Slab	103810.50	-14.00	444.37
N	103820.50	-14.00	444.34
O	103830.50	-14.00	444.32
West end of W. Appr. Slab	103840.50	-14.00	444.28

SOUTH EDGE OF ROADWAY

Location	Station	Offset	Theoretical Grade Elevations
East end of W. Appr. Slab	103810.50	-12.00	444.41
N	103820.50	-12.00	444.39
O	103830.50	-12.00	444.36
West end of W. Appr. Slab	103840.50	-12.00	444.32

☉ ROADWAY & P.G.

Location	Station	Offset	Theoretical Grade Elevations
East end of W. Appr. Slab	103810.50	0.00	444.60
N	103820.50	0.00	444.57
O	103830.50	0.00	444.54
West end of W. Appr. Slab	103840.50	0.00	444.51

NORTH EDGE OF ROADWAY

Location	Station	Offset	Theoretical Grade Elevations
East end of W. Appr. Slab	103810.50	12.00	444.41
N	103820.50	12.00	444.39
O	103830.50	12.00	444.36
West end of W. Appr. Slab	103840.50	12.00	444.32

NORTH CURB LINE

Location	Station	Offset	Theoretical Grade Elevations
East end of W. Appr. Slab	103810.50	14.00	444.37
N	103820.50	14.00	444.34
O	103830.50	14.00	444.32
West end of W. Appr. Slab	103840.50	14.00	444.28

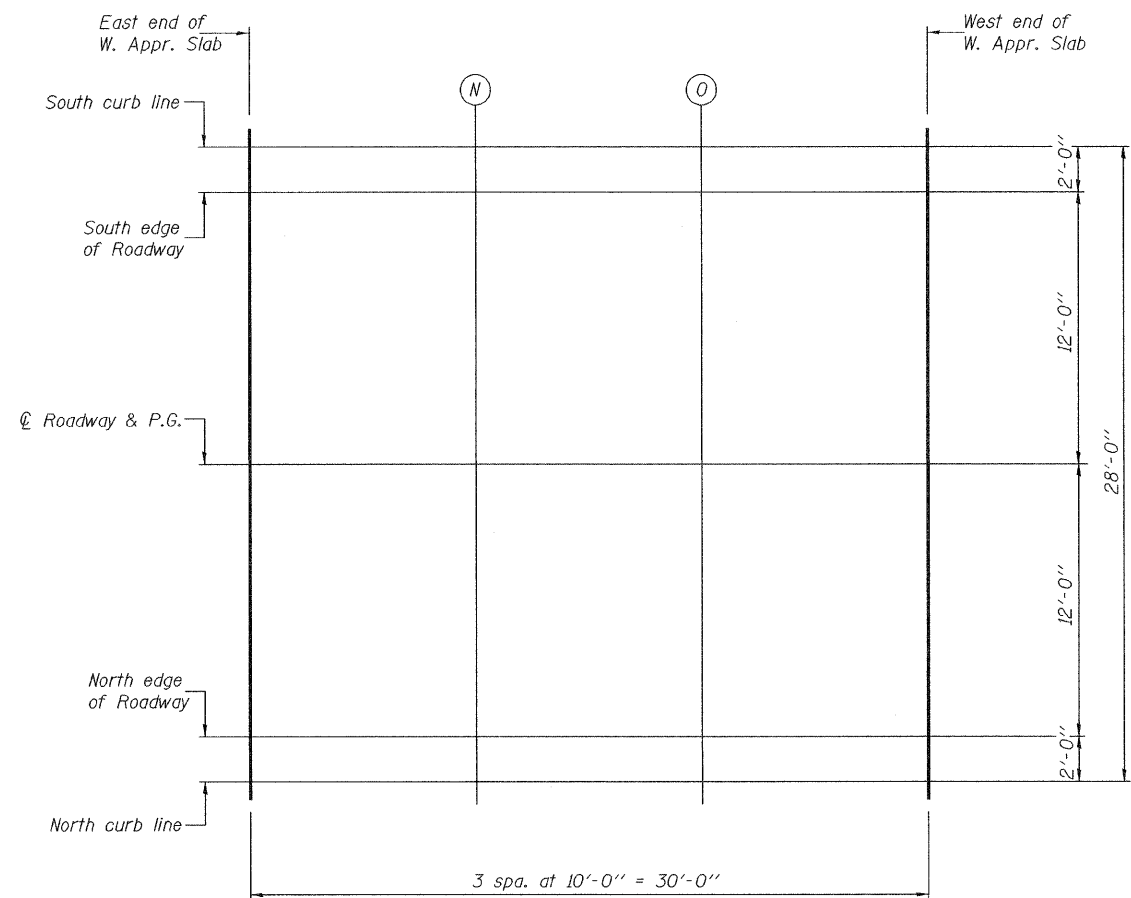

PLAN

TOP OF WEST APPROACH SLAB ELEVATIONS
STRUCTURE NO. 013-0040

DESIGNED Phillip R. Litchfield
CHECKED Roy Ahanchi
DRAWN Gregory D. Farmer <i>htd</i>
CHECKED PRL/GDF/JDE

EXAMINED <i>Thomas J. Domagalaki</i>	Sep. 9, 2010
PASSED <i>Ralph E. Anderson</i>	

SHEET NO. 7	S.B.I. RTE.	SECTION	COUNTY	TOTAL SHEETS	SHEET NO.
22 SHEETS	12	10B-1	CLAY	39	19
CONTRACT NO. 74004					
FED. ROAD DIST. NO. _ ILLINOIS FED. AID PROJECT					