

F.A.P. RTE.	SECTION	COUNTY	TOTAL SHEETS	SHEET NO.
95	(5,6)RS-2A	JASPER	19	1
		ILLINOIS	CONTRACT NO. 74506	

STATE OF ILLINOIS
DEPARTMENT OF TRANSPORTATION
DIVISION OF HIGHWAYS

**PROPOSED
HIGHWAY PLANS**

FAP ROUTE 95 (IL. RTE. 33)
SECTION (5,6)RS-2A
PROJECT ACF-0095(055)
RESURFACING (SMART)
JASPER COUNTY

C-97-018-11

FOR INDEX OF SHEETS, SEE SHEET NO. 2

STATION EQUATIONS

EQUATION: STA. 687+28.06 (BK) = STA. 687+73.01 (AH)
EQUATION: STA. 838+27.25 (BK) = STA. 838+62.16 (AH)
EQUATION: STA. 871+80.22 (BK) = STA. 871+21.76 (AH)
EQUATION: STA. 1207+23.26 (BK) = STA. 1206+92.54 (AH)
EQUATION: STA. 1229+20.94 (BK) = STA. 2229+20.94 (AH)
EQUATION: STA. 2246+85.78 (BK) = STA. 1246+91.91 (AH)

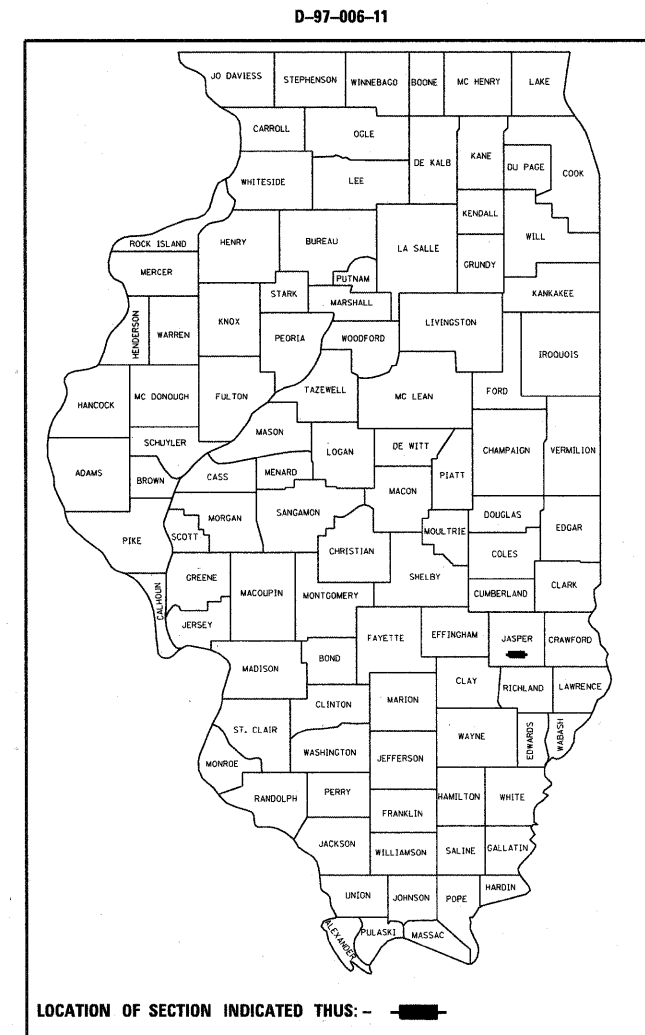

PROJECT BEGINS
STA. 689+81.63

PROJECT ENDS
STA. 1285+59.00

ADT = 5200 (2008)

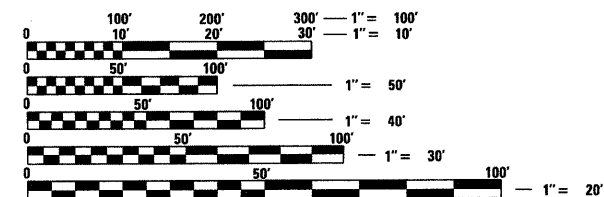

FULL SIZE PLANS HAVE BEEN PREPARED USING STANDARD ENGINEERING SCALES. REDUCED SIZED PLANS WILL NOT CONFORM TO STANDARD SCALES. IN MAKING MEASUREMENTS ON REDUCED PLANS, THE ABOVE SCALES MAY BE USED.

J.U.L.I.E.
JOINT UTILITY LOCATION INFORMATION FOR EXCAVATION
1-800-892-0123
OR 811

TOWNSHIP: NORTH MUDDY & WADE
PROJECT ENGINEER: TOM RONAN
PROJECT MANAGER: JEFF DAVISON (217-342-8314)
CONTRACT NO. 74506

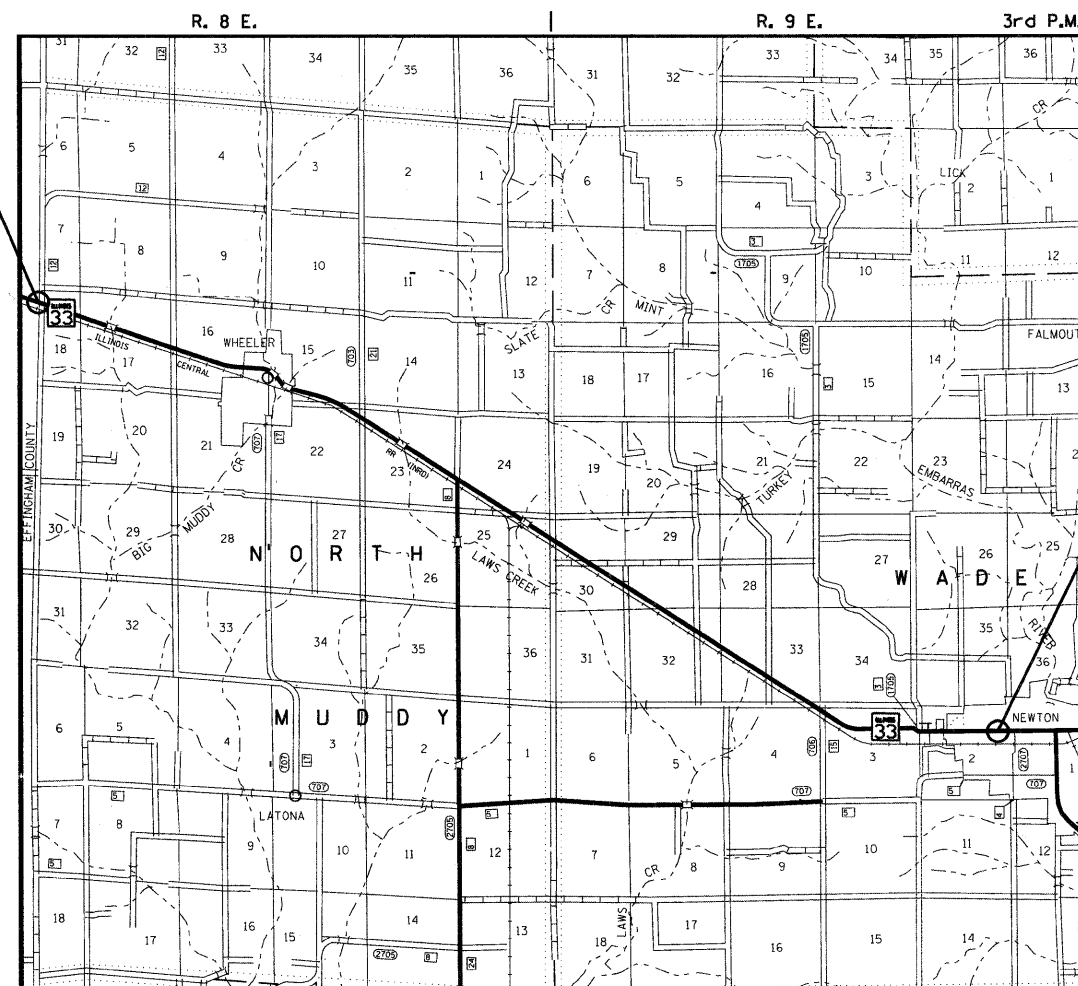

GROSS LENGTH = 59,625.51 FT. = 11.293 MILES
NET LENGTH = 59,625.51 FT. = 11.293 MILES

STATE OF ILLINOIS
DEPARTMENT OF TRANSPORTATION
DIVISION OF HIGHWAYS

SUBMITTED Dec. 13 2010
Roger I. Dushell
DEPUTY DIRECTOR OF HIGHWAYS, REGION ENGINEER

February 4 2011
Scott E. Stitt, P.E.
acting ENGINEER OF DESIGN AND ENVIRONMENT

February 4 2011
Christine M. Reed
DIRECTOR OF HIGHWAYS, CHIEF ENGINEER

**PRINTED BY THE AUTHORITY
OF THE STATE OF ILLINOIS**