

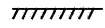

LEGEND

-  MILLING AND RESURFACING LIMITS
-  REMOVAL ITEMS

REMOVE EXISTING CONCRETE MEDIAN (2' WIDE)
 STA. 1275+00 TO STA. 1277+71
 STA. 1278+73 TO STA. 1283+24
 STA. 1283+84 TO STA. 1285+64
 STA. 1286+64 TO STA. 1290+00

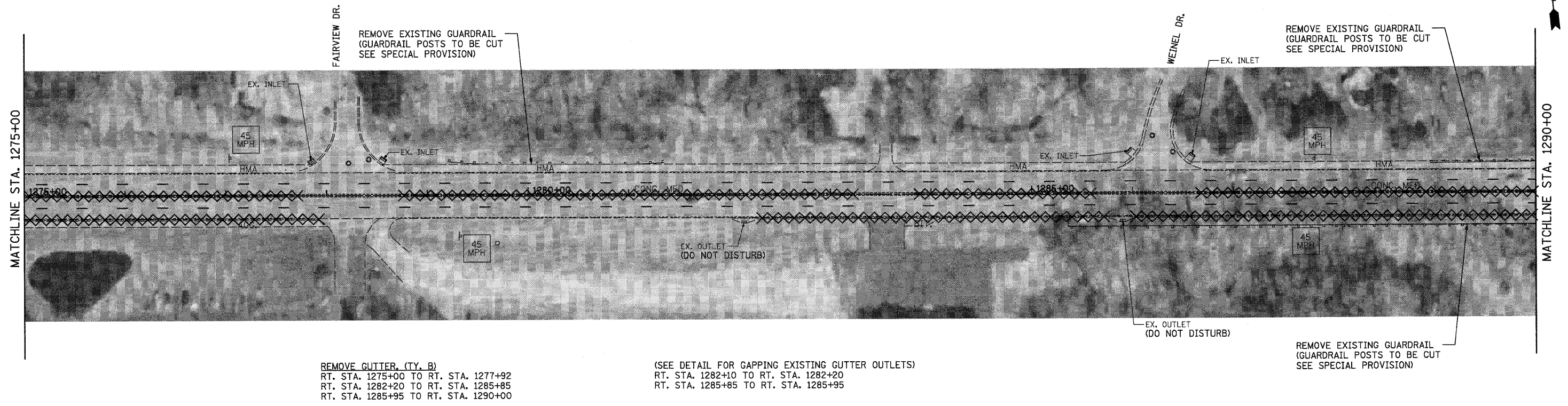

EXISTING & REMOVAL ITEMS

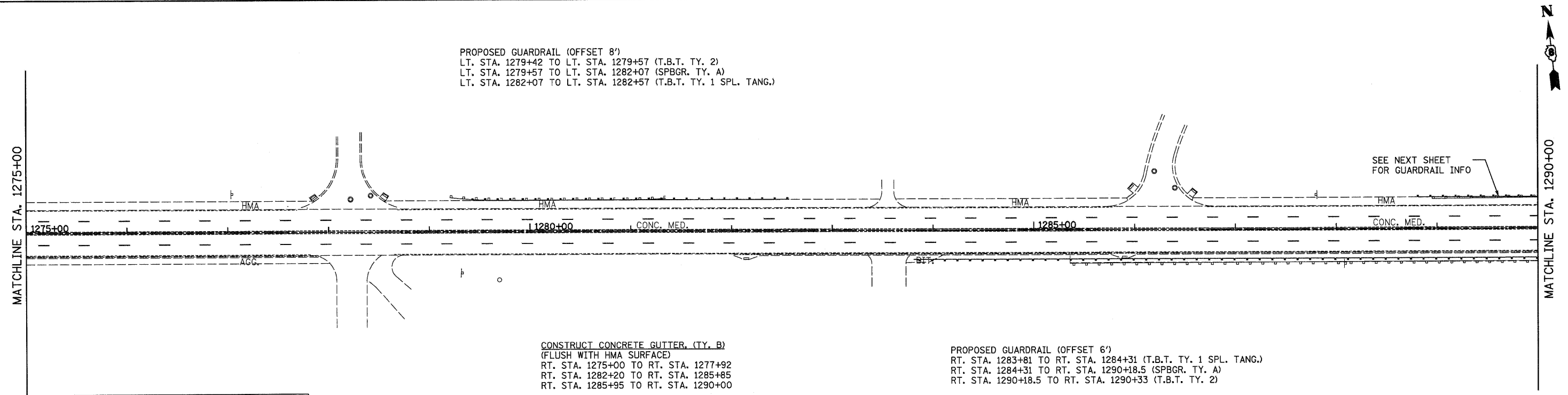

NOTE:
 AT LOCATIONS WHERE THE EXISTING MEDIAN IS TO BE REMOVED, SEE TYPICAL SECTION FOR PAVEMENT STRUCTURE REPLACEMENT.

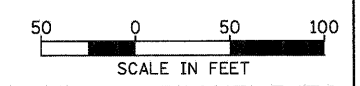

PROPOSED IMPROVEMENTS

| | | | | | | | | | | | |
|---|----------------------------|--|--|---|--|---------------------|------------------------------------|---|---------------------|--------------------|-----------------|
| FILE NAME = ...cedd\0878096-ght-plan21.dgn  Johnson, Depp & Quisenberry CONSULTING ENGINEERS Springfield, Illinois | USER NAME = SJS | DESIGNED - DRAWN - CHECKED - DATE - | REVISED - REVISED - REVISED - REVISED - | STATE OF ILLINOIS DEPARTMENT OF TRANSPORTATION | ST. CLAIR AVE./LINCOLN TRAIL PLAN SHEET | | F.A.U. RTE. 9166 | SECTION 34-IRS-3 | COUNTY ST. CLAIR | TOTAL SHEETS 87 | SHEET NO. 48 |
| | PLOT SCALE = 50.0000' / 1" | | PLOT DATE = 12/15/2010 09:38:57 | | SCALE: | SHEET NO. OF SHEETS | STA. 1275+00.00 TO STA. 1290+00.00 | ILLINOIS FED. AID PROJECT CONTRACT NO. 76D96 | | | |