

DETECTOR LOOP REQUIREMENTS AND CALCULATIONS FOR LINCOLN TRAIL AND POTOMAC DR.

LINCOLN TRAIL & POTOMAC DR.					
LOOP	PHASE	FT. X FT.	CALCULATED INDUCTANCE MICROHENRIES ( $\frac{L}{M}$ )	CALCULATED RESISTANCE OHMS ( $R$ )	REQUIRED # OF TURNS
1. EB A CCD	2	6 X 6	368.4	2.9	6
2. EB B CCD	6	6 X 6	364.4	2.9	6
3. EB LT CD	1	6 X 500	368.0	2.9	3-6-3
4. EB THRU A CD	6	6 X 500	364.4	2.9	3-6-3
5. EB THRU B CD	6	6 X 500	364.4	2.9	3-6-3
6. EB RT CD	6	6 X 500	364.4	2.9	3-6-3
7. NB THRU CD	4	N/A	N/A	N/A	
8. NB RT CD	4	N/A	N/A	N/A	
9. WB A CCD	2	6 X 6	364.4	2.9	6
10. WB B CCD	2	6 X 6	364.4	2.9	6
11. WB LT CD	5	6 X 500	841.9	2.9	3-6-3
12. WB THRU A CD	2	6 X 500	841.9	2.9	3-6-3
13. WB THRU B CD	2	6 X 500	816.4	2.3	3-6-3
14. WB RT CD	2	6 X 500	795.7	1.8	3-6-3
15. SB THRU CD	3	N/A	N/A	N/A	
16. SB RT CD	3	N/A	N/A	N/A	

THE ABOVE VALUES ARE CALCULATED OF COMBINED LOOP AND LEAD-IN INDUCTANCES AND RESISTANCES. ACTUAL MEASURED VALUES SHOULD BE WITHIN +/- 20% OF THESE VALUES.

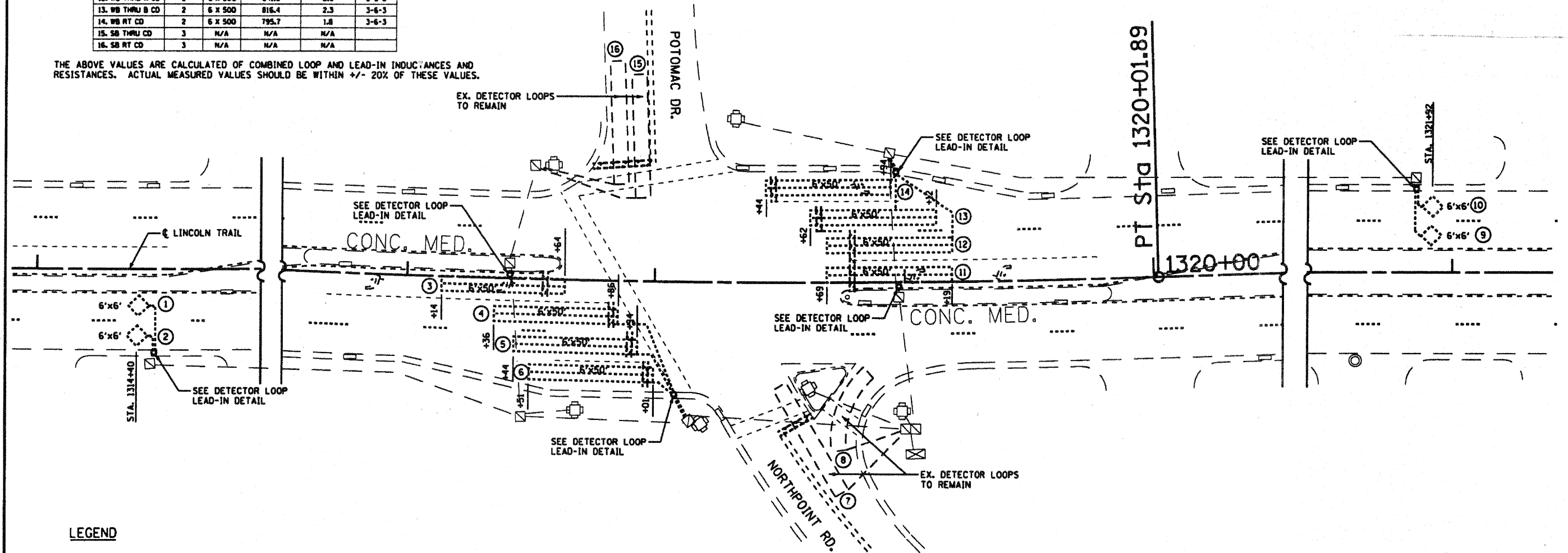

LEGEND

- EX. DETECTOR LOOP TO REMAIN
- EX. VISIBLE DETECTOR LOOP TO BE REPLACED
- BURIED DETECTOR LOOP TO BE REPLACED IF REQUIRED
- EX. TRAFFIC CONTROLLER BOX
- EX. HANDHOLE
- EX. DOUBLE HANDHOLE
- EX. TRAFFIC SIGNAL BASE
- EX. TRAFFIC CONTROLLER CONDUIT

SCHEDULE OF QUANTITIES		TOTAL QUANTITIES
ITEM	UNIT	
LOCATING UNDERGROUND CABLE	FOOT	60
DETECTOR LOOP REPLACEMENT	FOOT	1,581

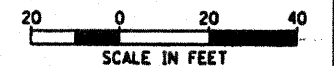

FILE NAME #FILE#	USER NAME #USER#	DESIGNED CMV	REVISED	<b>STATE OF ILLINOIS DEPARTMENT OF TRANSPORTATION</b>	<b>DETECTOR LOOP REPLACEMENT LINCOLN TRAIL &amp; POTOMAC DR.</b>	SCALE:	SHEET NO. OF SHEETS	STA. TO STA.	F.A.U. RITE 9166	SECTION 34-IRS-3	COUNTY ST. CLAIR	TOTAL SHEETS 87	SHEET NO. 78
Johnson, Drey & O'Keefe CONSULTING ENGINEERS Springfield, Illinois	PLOT SCALE #SCALE#	CHECKED CMV	REVISED						CONTRACT NO. 7809B				
	PLOT DATE #DATE#	DATE 10/21/2010	REVISED						ILLINOIS FED. AID PROJECT				