

STATE OF ILLINOIS
DEPARTMENT OF TRANSPORTATION
DIVISION OF HIGHWAYS

**PROPOSED
HIGHWAY PLANS**

FAP ROUTE 327 (US 50)
SECTION 14-15RS-1
PROJECT NHF-0327(051)
RESURFACING, 3P
CLINTON COUNTY

C-98-098-10

R 3 W

F.A.P. RTE.	SECTION	COUNTY	TOTAL SHEETS	SHEET NO.
327	14, 15RS-1	CLINTON	20	1
		ILLINOIS	CONTRACT NO. 76E10	

INDEX OF SHEETS

1. COVER SHEET, PROJECT LIMITS, ADT
2. GENERAL NOTES, STANDARDS, COMMITMENTS
3. SUMMARY OF QUANTITIES
4. LOCATION MAP
- 5.-6. SCHEDULES
7. TYPICAL SECTION
- 8.-12. PLAN VIEW SHEETS
- 13.-17. PAVEMENT MARKING SHEETS
- 18.-20. DETAIL SHEETS

D-98-076-10

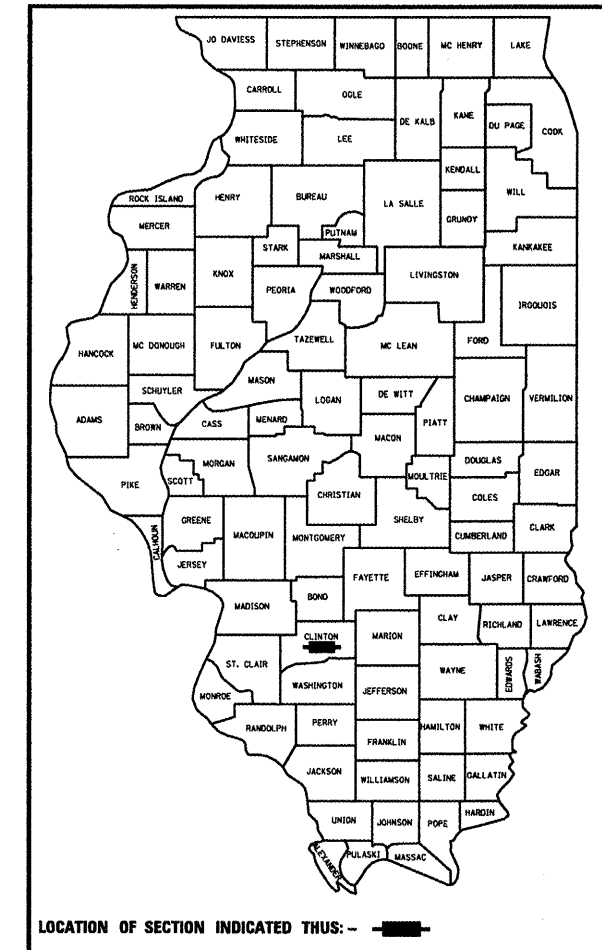

BEGIN PROJECT:
STA. 3214 + 42.17
LAT: 38.622729
LONG: -89.481843

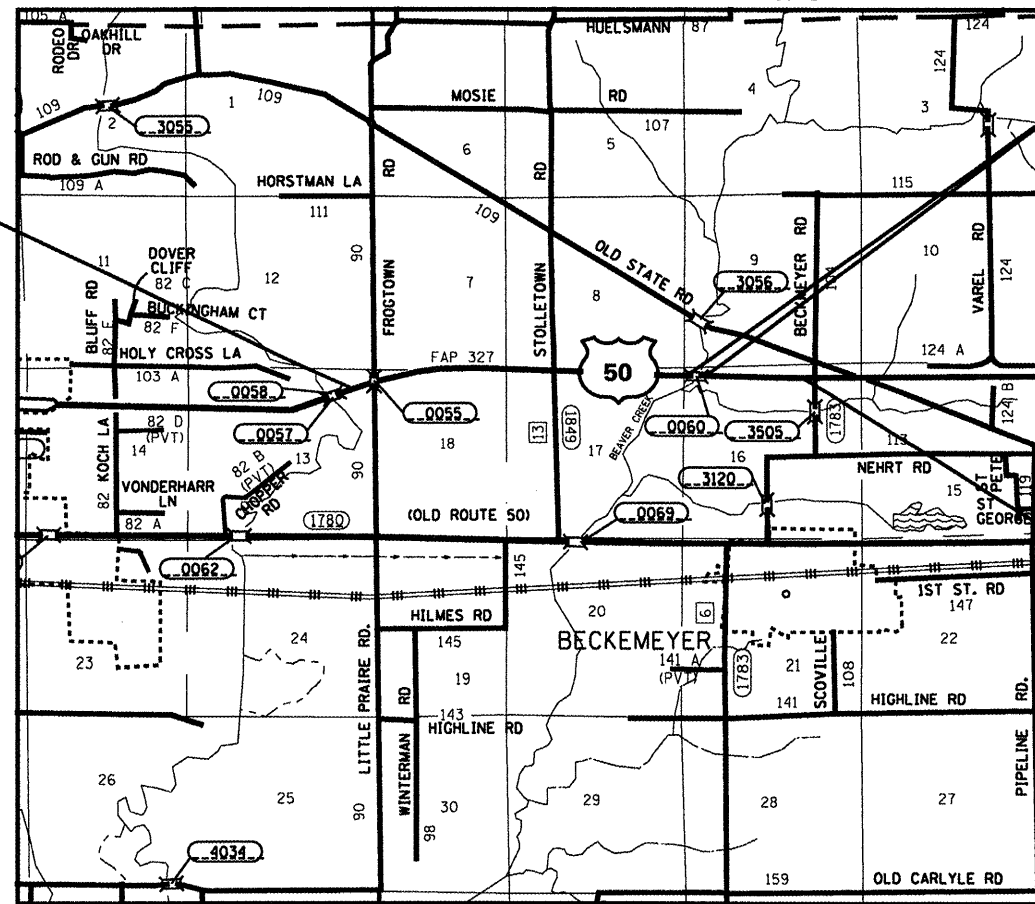

BRIDGE OMISSION:
STA. 3315 + 89 TO
STA. 3320 + 35
446 FT



END PROJECT:
STA 3341 + 38.42
LAT: 38.623589
LONG: -89.437185

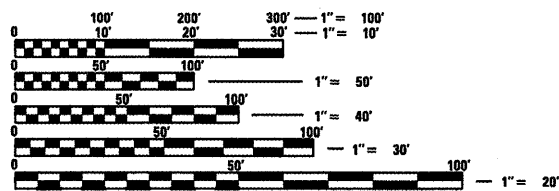

FULL SIZE PLANS HAVE BEEN PREPARED USING STANDARD ENGINEERING SCALES. REDUCED SIZED PLANS WILL NOT CONFORM TO STANDARD SCALES. IN MAKING MEASUREMENTS ON REDUCED PLANS, THE ABOVE SCALES MAY BE USED.

J.U.L.I.E.
JOINT UTILITY LOCATION INFORMATION FOR EXCAVATION
1-800-892-0123
OR 811

PROJECT ENGINEER: PATTI LEBEAU (618)346-3179
PROJECT MANAGER: CHERYL KEPLAR (618)346-3186

CONTRACT NO. 76E10

GROSS LENGTH = 12,696.25 FT. = 2.4 MILE
NET LENGTH = 12,250.25 FT. = 2.3 MILE

NOT TO SCALE

FUNCTIONAL CLASSIFICATION:
OTHER PRINCIPAL ARTERIAL

TRAFFIC DATA:
2009 = 5300
2010 = 5400
2030 = 6600
SU = 4.2%
MU = 10.4%

STATE OF ILLINOIS
DEPARTMENT OF TRANSPORTATION
DIVISION OF HIGHWAYS

SUBMITTED *December 15 2010*

Man C Jamie
DEPUTY DIRECTOR OF HIGHWAYS, REGION 5 ENGINEER

February 4 2011
Scott E. Stitt P.E. / E
acting ENGINEER OF DESIGN AND ENVIRONMENT

February 4 2011
Christine M. Reed / E
DIRECTOR OF HIGHWAYS, CHIEF ENGINEER

PRINTED BY THE AUTHORITY
OF THE STATE OF ILLINOIS

SUMMARY OF QUANTITIES

SUMMARY OF QUANTITIES			TOTAL QUANTITIES	CONSTRUCTION TYPE CODE			SUMMARY OF QUANTITIES			TOTAL QUANTITIES	CONSTRUCTION TYPE CODE		
CODE NO	ITEM	UNIT		0005 80% FED 20% STATE			CODE NO	ITEM	UNIT		0005 80% FED 20% STATE		
20201200	REMOVAL AND DISPOSAL OF UNSUITABLE MATERIAL	CU YD	1.8	1.8		70100460	TRAFFIC CONTROL AND PROTECTION, STANDARD 701306	L SUM	1	1			
40600200	BITUMINOUS MATERIALS (PRIME COAT)	TON	13.2	13.2		70300100	SHORT TERM PAVEMENT MARKING	FOOT	27684	27684			
40600300	AGGREGATE (PRIME COAT)	TON	64	64		70300210	TEMPORARY PAVEMENT MARKING LETTERS AND SYMBOLS	SQ FT	62.4	62.4			
40600895	CONSTRUCTING TEST STRIP	EACH	1	1		70300220	TEMPORARY PAVEMENT MARKING - LINE 4"	FOOT	36021	36021			
40600985	PORTLAND CEMENT CONCRETE SURFACE REMOVAL - BUTT JOINT	SQ YD	3000	3000		70300260	TEMPORARY PAVEMENT MARKING - LINE 12"	FOOT	351	351			
40600990	TEMPORARY RAMP	SQ YD	150	150		70300280	TEMPORARY PAVEMENT MARKING- LINE 24"	FOOT	46	46			
40603090	HOT-MIX ASPHALT BINDER COURSE, IL-19.0, N90	TON	5329	5329		70301000	WORK ZONE PAVEMENT MARKING REMOVAL	SQ FT	3076	3076			
40603345	HOT-MIX ASPHALT SURFACE COURSE, MIX "D", N90	TON	3553	3553		*78000100	THERMOPLASTIC PAVEMENT MARKING - LETTERS AND SYMBOLS	SQ FT	62.4	62.4			
40800020	BITUMINOUS MATERIALS (PRIME COAT)	TON	1	1		*78000200	THERMOPLASTIC PAVEMENT MARKING - LINE 4"	FOOT	36021	36021			
40800030	AGGREGATE (PRIME COAT)	TON	3	3		*78000600	THERMOPLASTIC PAVEMENT MARKING - LINE 12"	FOOT	351	351			
40800050	INCIDENTAL HOT-MIX ASPHALT SURFACING	TON	67	67		*78000650	THERMOPLASTIC PAVEMENT MARKING - LINE 24"	FOOT	46	46			
44004250	PAVED SHOULDER REMOVAL	SQ YD	5.3	5.3		*78100100	RAISED REFLECTIVE PAVEMENT MARKER	EACH	240	240			
44201000	CLASS B PATCHES, TYPE IV, 12 INCH	SQ YD	286	286		*78200410	GUARDRAIL MARKERS, TYPE A	EACH	16	16			
44201294	CLASS B PATCH - EXPANSION JOINT	FOOT	40	40		*78201000	TERMINAL MARKER - DIRECT APPLIED	EACH	4	4			
44201296	DEFORMED BARS - EXPANSION JOINT	EACH	36	36		78300200	RAISED REFLECTIVE PAVEMENT MARKER REMOVAL	EACH	240	240			
44201297	DOWEL BARS 1"	EACH	11	11		200076600	TRAINEES	HOUR	500	500			
44213200	SAW CUTS	FOOT	849	849									
44213202	TIE BARS 1"	EACH	14	14									
44300200	STRIP REFLECTIVE CRACK CONTROL TREATMENT	FOOT	2100	2100									
48102100	AGGREGATE WEDGE SHOULDER, TYPE B	TON	353	353									
48203100	HOT-MIX ASPHALT SHOULDERS	TON	4708	4708									
48300300	PORTLAND CEMENT CONCRETE SHOULDERS 8"	SQ YD	5.3	5.3									
50300225	CONCRETE STRUCTURES	CU YD	1.4	1.4									
50800205	REINFORCEMENT BARS, EPOXY COATED	POUND	291	291									
60100080	FRENCH DRAINS	CU YD	1.8	1.8									
60100085	GEOTECHNICAL FABRIC FOR FRENCH DRAINS	SQ YD	5.3	5.3									
*63000001	STEEL PLATE BEAM GUARD RAIL, TYPE A, 6 FOOT POSTS	FOOT	1104	1104									
*63100089	TRAFFIC BARRIER TERMINAL, TYPE 6B	EACH	4	4									
63200310	GUARDRAIL REMOVAL	FOOT	1100	1100									
64200105	SHOULDER RUMBLE STRIPS	FOOT	25216	25216									
67000400	ENGINEER'S FIELD OFFICE, TYPE A	CAL MO	4	4									
67100100	MOBILIZATION	L SUM	1	1									
70100450	TRAFFIC CONTROL AND PROTECTION, STANDARD 701201	L SUM	1	1									

0042
 * SPECIALTY ITEM

FILE NAME =	USER NAME = *USER*	DESIGNED - ---	REVISED - ---	STATE OF ILLINOIS DEPARTMENT OF TRANSPORTATION	SUMMARY OF QUANTITIES	F.A.R. RTE.	SECTION	COUNTY	TOTAL SHEETS	SHEET NO.
#FILE#		DRAWN - ---	REVISED - ---			.327	14.1985-1	CLINTON	20	3
		CHECKED - ---	REVISED - ---			SCALE: _____ SHEET NO. _____ OF _____ SHEETS STA. _____ TO STA. _____		CONTRACT NO. 76E10		
		DATE - -----	REVISED - ---	FED. ROAD DIST. NO. ILLINOIS FED. AID PROJECT						

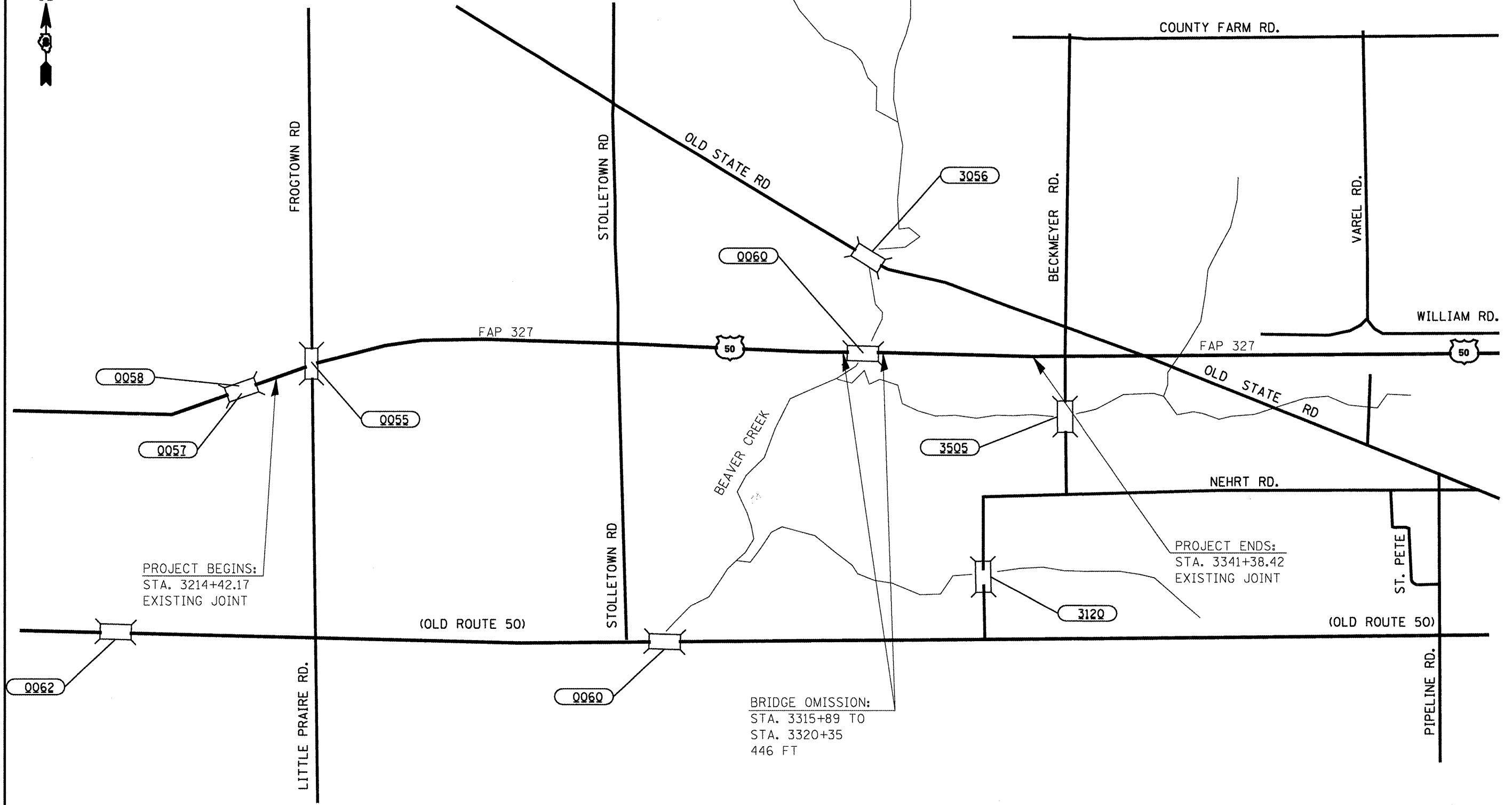

PROJECT BEGINS:
STA. 3214+42.17
EXISTING JOINT

BRIDGE OMISSION:
STA. 3315+89 TO
STA. 3320+35
446 FT

PROJECT ENDS:
STA. 3341+38.42
EXISTING JOINT

FILE NAME =	USER NAME = #USER#	DESIGNED -	REVISED -
#FILE#		DRAWN -	REVISED -
	PLOT SCALE = #SCALE#	CHECKED -	REVISED -
	PLOT DATE = #DATE#	DATE -	REVISED -

STATE OF ILLINOIS
DEPARTMENT OF TRANSPORTATION

LOCATION MAP	
SCALE: _____	SHEET NO. ____ OF ____ SHEETS STA. _____ TO STA. _____

F.A.P. RTE.	SECTION	COUNTY	TOTAL SHEETS	SHEET NO.
327	14-1585-1	CLINTON	20	9
FED. ROAD DIST. NO. - ILLINOIS FED. AID PROJECT			CONTRACT NO. 78510	

PAVEMENT MARKINGS SCHEDULE														
STATION	TO	STATION	LENGTH	LINE 24"	LINE 12"	LETTER AND SYMBOLS/TURN ARROWS	4"			RAISED REFLECTIVE PAVEMENT MARKERS				
				WHITE	YELLOW		LEFT TURN	YELLOW		WHITE	TWO-WAY AMBER	ONE-WAY AMBER	ONE-WAY CRYSTAL	REMOVAL
								LANE LINE	SKIP-DASH CENTERLINE	EDGE LINE				
(FT)	(FT)	(SQ FT)	(FT)	(FT)	(FT)	(EACH)	(EACH)	(EACH)	(EACH)					
3262+70.00	TO	3269+72.00	702		167.6									
3274+20.00	TO	3281+51.00	731		182.8									
3214+42.17	TO	3341+38.42	12696						25393					
3270+17.30	TO	3271+71.30	154						154					
3272+58.40	TO	3273+84.40	126						126					
3262+70.00	TO	3269+72.00	702				2808							
3269+72.00	TO	3271+72.00	200				400							
3272+58.00	TO	3274+20.00	162				324							
3274+20.00	TO	3281+51.00	731				2924							
3214+42.00	TO	3262+70.00	4828							60			60	
3269+69.00	TO	3271+71.00	202							5			5	
3272+58.00	TO	3274+20.00	162							5			5	
3281+51.00	TO	3341+38.00	5987							75			75	
3262+70.00	TO	3269+72.00	702								35		35	
3274+20.00	TO	3281+51.00	1031								52		52	
3270+17.00	TO	3271+71.00	154									4	4	
3272+58.00	TO	3273+84.00	126									4	4	
3270+42.06						15.6								
3271+32.50						15.6								
3272+83.50						15.6								
3273+54.28						15.6								
NO PASSING														
3257+93.00	TO	3262+70.00	477				477							
3281+84.00	TO	3287+53.00	569				569							
3214+42.00	TO	3262+70.00	4828						1207					
3281+51.00	TO	3341+38.00	5987						1497					
STOLLETOWN RD.														
19+57.00	TO	21+00.00	143						143					
19+57.00				23										
19+44.00				23										
SUB TOTAL:				46	351	62.4	7502	2704	25816	145	87	8		
TOTAL:				46	351	62.4		36021			240		240	

FILE NAME =
#FILE#

USER NAME = #USER#
DESIGNED - ---
DRAWN - ---
PLOT SCALE = #SCALE#
CHECKED - ---
PLOT DATE = #DATE#
DATE - -----

REVISOR - ---
REVISED - ---
REVISOR - ---
REVISED - ---
REVISOR - ---
REVISED - ---

DESIGNED - ---
DRAWN - ---
CHECKED - ---
DATE - -----

STATE OF ILLINOIS
DEPARTMENT OF TRANSPORTATION

SCHEDULES
SCALE: _____ SHEET NO. _____ OF _____ SHEETS STA. _____ TO STA. _____

F.A.P. RTE. 327 SECTION 14, 1985-1 COUNTY CLINTON TOTAL SHEETS 20 SHEET NO. 9 CONTRACT NO. 76510 FED. ROAD DIST. NO. ILLINOIS FED. AID PROJECT

RESURFACING SCHEDULE										
STA.	TO	STA.	WIDTH	LENGTH	HMA SURF CRSE	HMA BINDER	BITUMINOUS	AGGREGATE	HMA	AGGREGATE
					MIX D, N90	COURSE, IL 19.0, N90	MATERIAL (PRIME COAT)	(PRIME COAT)	SHOULDERS	WEDGE SHOULDER
					TON	TON	TON	TON	TON	TON
3214+42	TO	3261+00	24	4658	1043.4	1565	3.9	18.6		
3261+00	TO	3284+00	57	2300	1223.6	1836	4.6	21.9		
3284+00	TO	3341+38	24	5738	1285.3	1928	4.8	23.0		
3214+42	TO	3271+78	8	5736					2142	
3272+66	TO	3341+38	8	6872					2566	
3214+42	TO	3271+78	2	5736						161
3272+66	TO	3341+38	2	6872						192
TOTAL:					3553	5329	13.2	64	4708	353

PATCHING SCHEDULE										
STA	TO	STA	LENGTH	DOWEL BARS	TIE BARS	DEFORMED BARS	CLASS B PATCH	CLASS B PATCH,	SAW CUTS	STRIP REFLECTIVE
			FOOT	EACH	EACH	EXPANSION JOINT	TYPE IV, 12"	FOOT	FOOT	FOOT
3273+78	TO	3275+12	134	11	9	36	40	149	288	
3280+07	TO	3282+83	276		5			138	561	
3262+00	TO	3283+00	2100							2100
TOTAL:				11	14	36	40	287	849	2100

SIDEROAD/BUTT JOINT SCHEDULE							
SIDEROAD/STA.	L/R	WIDTH	INCIDENTAL HMA	(40800020) BIT.	(40800030)	TEMPORARY	P.C.C. BUTT
		(FOOT)	SURFACING	MAT. PRIME COAT	AGG. PRIME COAT	RAMPS	JOINTS
			(TON)	(TON)	(TON)	(SQ YD)	(SQ YD)
3214+42.17		40	13.1	0.15	0.67	22.2	444.4
STOLLETOWN RD.	L	25	5.1	0.15	0.13	13.9	277.8
STOLLETOWN RD.	R	85	9.1	0.15	0.17	47.2	944.4
3315+14.54		40	13.1	0.15	0.67	22.2	444.4
3321+26.85		40	13.1	0.15	0.67	22.2	444.4
3341+38.42		40	13.1	0.15	0.67	22.2	444.4
TOTAL:			67	1	3	150	3000

GUARDRAIL SCHEDULE									
STA.	TO	STA.	SIDE	STEEL PLATE	TRAFFIC BARRIER	GUARDRAIL	TERMINAL	GUARDRAIL	TRAFFIC BARRIER
				BEAM GUARDRAIL, TYPE A, 6 FOOT POSTS	TERMINAL, TYPE I, (SPECIAL) TANGENT		MARKERS, TYPE A		MARKERS DIRECT APPLIED
				(FOOT)	(EACH)	(EACH)	(EACH)	(FOOT)	(EACH)
3312+90	TO	3316+15	R	240		4		325	1
3313+90	TO	3316+15	L	144		4		225	1
3320+27	TO	3323+27	L	216		4		300	1
3320+27	TO	3322+77	R	168		4		250	1
3312+90			R		1		1		
3313+90			L		1		1		
3323+27			L		1		1		
3322+77			R		1		1		
TOTAL:				768	4	16	4	1100	4

FILE NAME =	USER NAME = *USER*	DESIGNED - ---	REVISED - ---	STATE OF ILLINOIS DEPARTMENT OF TRANSPORTATION	SCHEDULES	F.A.P. RTE.	SECTION	COUNTY	TOTAL SHEETS	SHEET NO.	
FILE#	PLOT SCALE = *SCALE*	DRAWN - ---	REVISED - ---			327	14-1985-1	CLINTON	20	6	
	PLOT DATE = *DATE*	CHECKED - ---	REVISED - ---			CONTRACT NO. 78E10		FED. ROAD DIST. NO. ILLINOIS FED. AID PROJECT			
		DATE - -----	REVISED - ---			SCALE: -----	SHEET NO. OF SHEETS	STA. TO STA.			

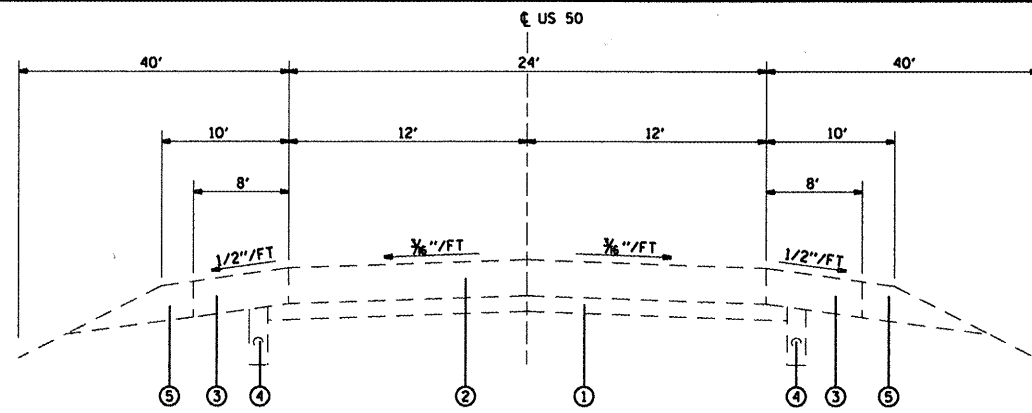

EXISTING TYPICAL SECTION
 STA. 3214+42.17 TO STA. 3230+56.57
 STA. 3249+22.72 TO STA. 3262+00.17
 STA. 3283+00.15 TO STA. 3341+38.42

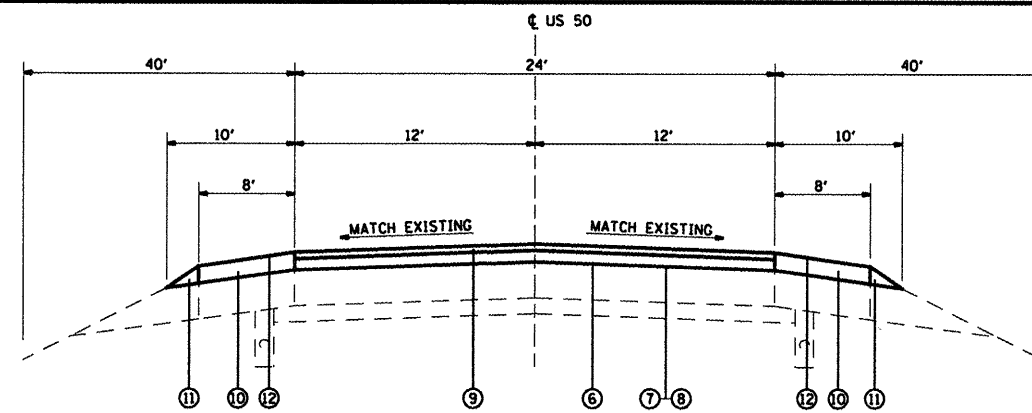

PROPOSED TYPICAL SECTION
 STA. 3214+42.17 TO STA. 3230+56.57
 STA. 3249+22.72 TO STA. 3262+00.17
 STA. 3283+00.15 TO STA. 3341+38.42

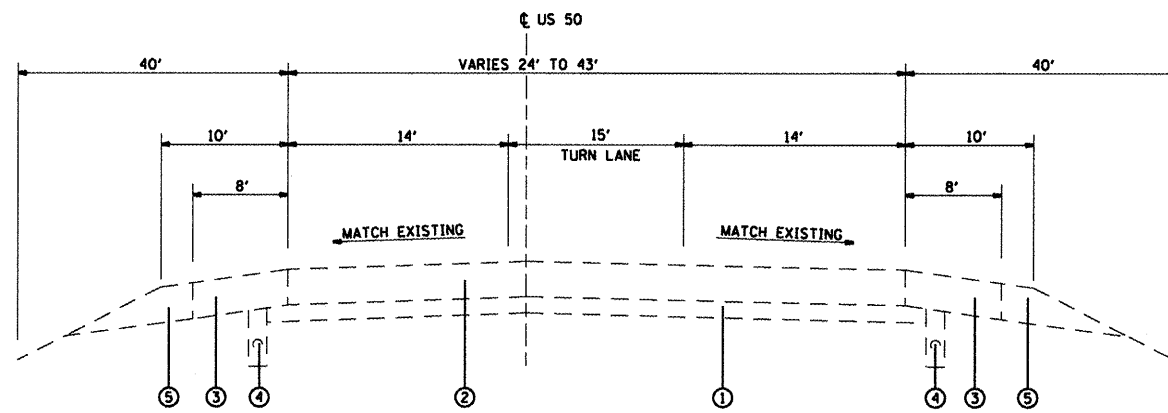

EXISTING TYPICAL SECTION
 STA. 3262+00.17 TO STA. 3283+00.15

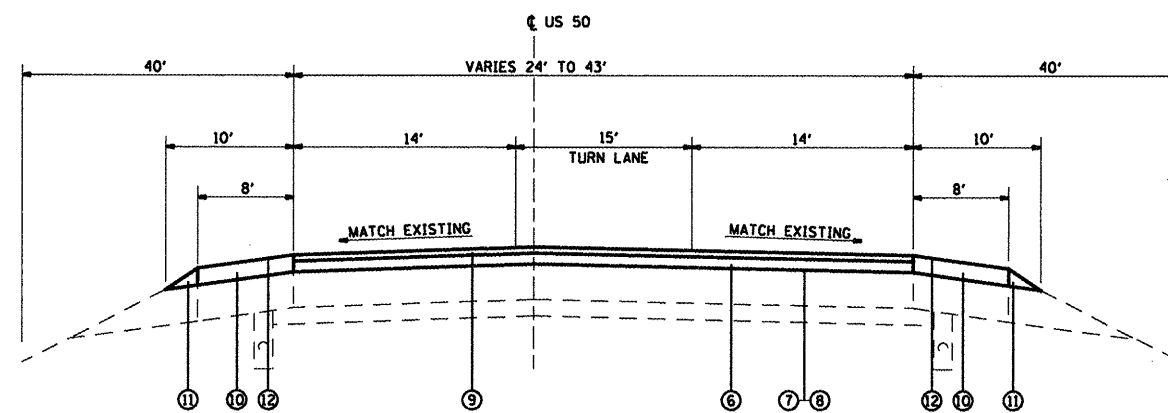

PROPOSED TYPICAL SECTION
 STA. 3262+00.17 TO STA. 3283+00.15

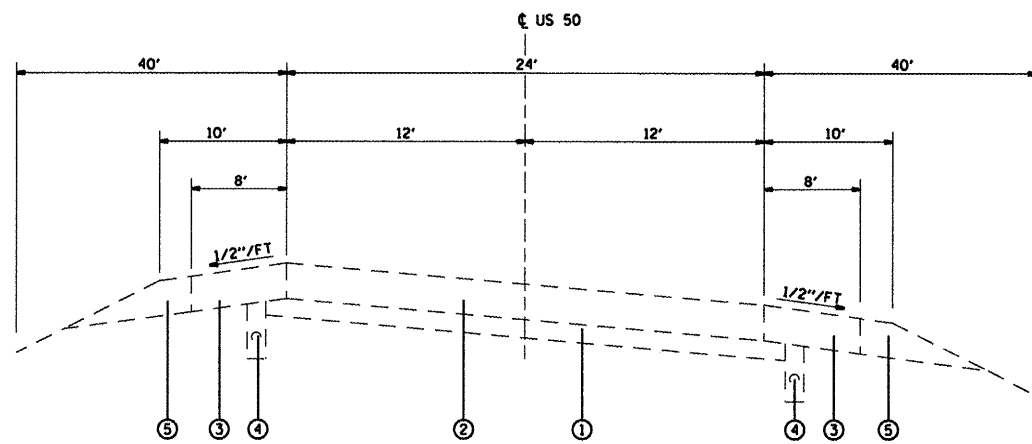

EXISTING SUPERELEVATED SECTION
 STA. 3230+56.57 TO STA. 3249+22.72

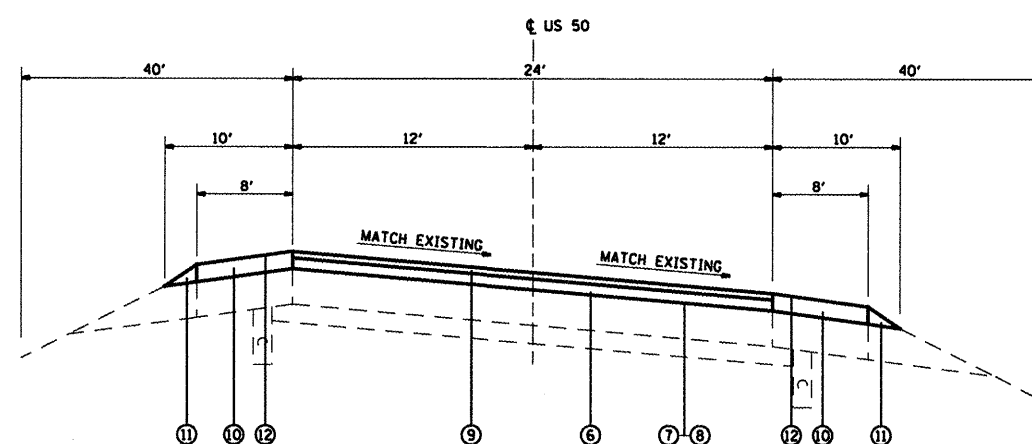

PROPOSED SUPERELEVATED SECTION
 STA. 3230+56.57 TO STA. 3249+22.72

LEGEND

- | | |
|--|---|
| ① EXISTING STABILIZED SUB-BASE 4" | ⑥ PROPOSED HMA BINDER COURSE, IL 19.0, N90, 2 1/4" |
| ② EXISTING PORTLAND CEMENT PAVEMENT 8" | ⑦ PROPOSED AGGREGATE PRIME COAT |
| ③ EXISTING BITUMINOUS SHOULDERS 8" | ⑧ PROPOSED BITUMINOUS PRIME COAT |
| ④ EXISTING PIPE DRAINS, 4" | ⑨ PROPOSED HMA SURFACE COURSE, MIX "D", N90, 1 1/2" |
| ⑤ EXISTING AGGREGATE SHOULDERS, TYPE B | ⑩ PROPOSED HMA SHOULDER, 3 3/4" |
| | ⑪ PROPOSED AGGREGATE SHOULDER WEDGE |
| | ⑫ PROPOSED SHOULDER RUMBLE STRIP |

FILE NAME =	USER NAME = #USER#	DESIGNED -	REVISED -
#FILE#		DRAWN -	REVISED -
	PLOT SCALE = #SCALE#	CHECKED -	REVISED -
	PLOT DATE = #DATE#	DATE -	REVISED -

STATE OF ILLINOIS
 DEPARTMENT OF TRANSPORTATION

TYPICAL SECTION

SCALE: _____ SHEET NO. ____ OF ____ SHEETS STA. _____ TO STA. _____

F.A.P. RTE.	SECTION	COUNTY	TOTAL SHEETS	SHEET NO.
327	14-1585-1	CLINTON	20	7
FED. ROAD DIST. NO. _____ (ILLINOIS) FED. AID PROJECT			CONTRACT NO. 76E1Q	

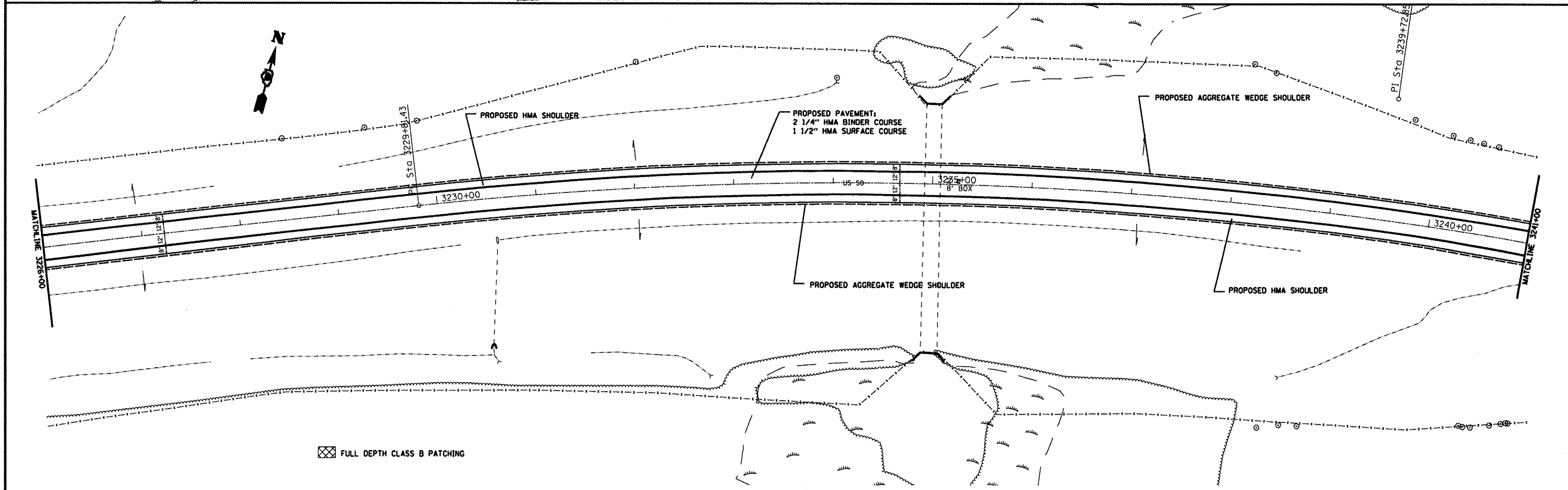
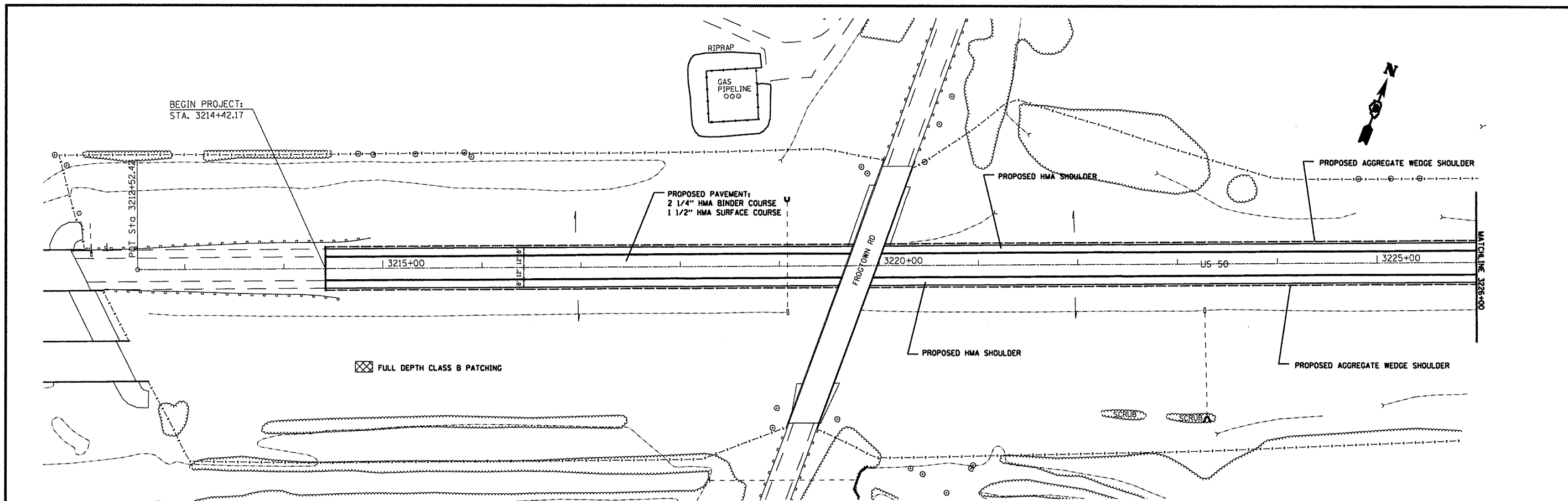

FILE NAME =	USER NAME = #USER#	DESIGNED - ---	REVISED - ---	STATE OF ILLINOIS DEPARTMENT OF TRANSPORTATION	PLAN VIEW	F.A.R. RTE. 327	SECTION 14, 1985-1	COUNTY CLINTON	TOTAL SHEETS 20	SHEET NO. 8	
#FILE#	PLOT SCALE = #SCALE#	CHECKED - ---	REVISED - ---			SCALE: 20	SHEET NO. 1 OF 5 SHEETS	STA. 3212+50 TO STA. 3241+00	CONTRACT NO. TBE10		
	PLOT DATE = #DATE#	DATE - ---	REVISED - ---			FED. ROAD DIST. NO. - ILLINOIS FED. AID PROJECT					

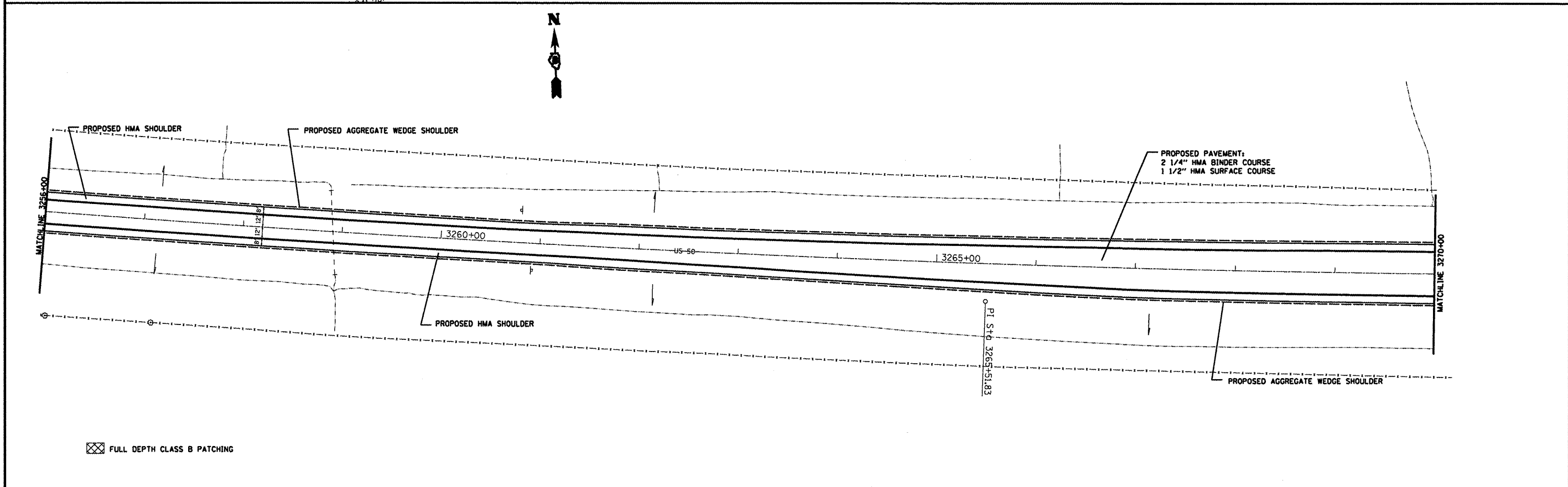
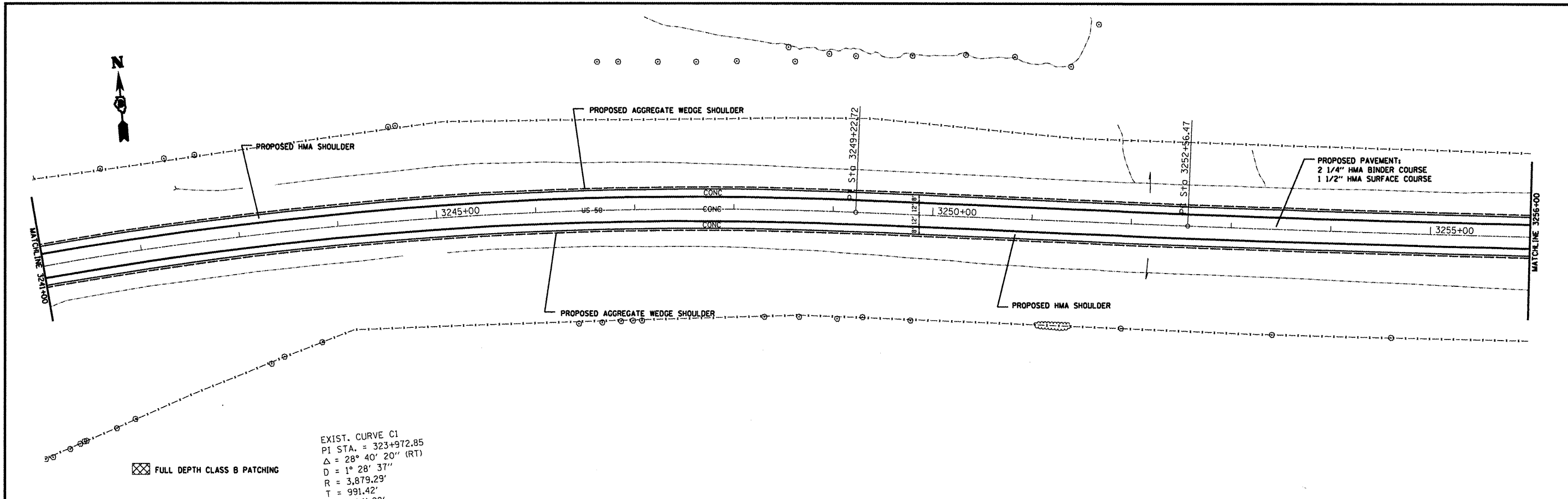

FILE NAME =	USER NAME = #USER#	DESIGNED -	REVISED -	STATE OF ILLINOIS DEPARTMENT OF TRANSPORTATION	PLAN VIEW	F.A.R. RTE.	SECTION	COUNTY	TOTAL SHEETS	SHEET NO.	
#FILE#		DRAWN -	REVISED -			327	14-1985-1	CLINTON	20	9	
	PLOT SCALE = #SCALE#	CHECKED -	REVISED -			CONTRACT NO. 76E10					
	PLOT DATE = #DATE#	DATE -	REVISED -			FED. ROAD DIST. NO. - ILLINOIS FED. AID PROJECT					
				SCALE: 20		SHEET NO. 2 OF 5 SHEETS		STA. 3241+00 TO STA. 3270+00			

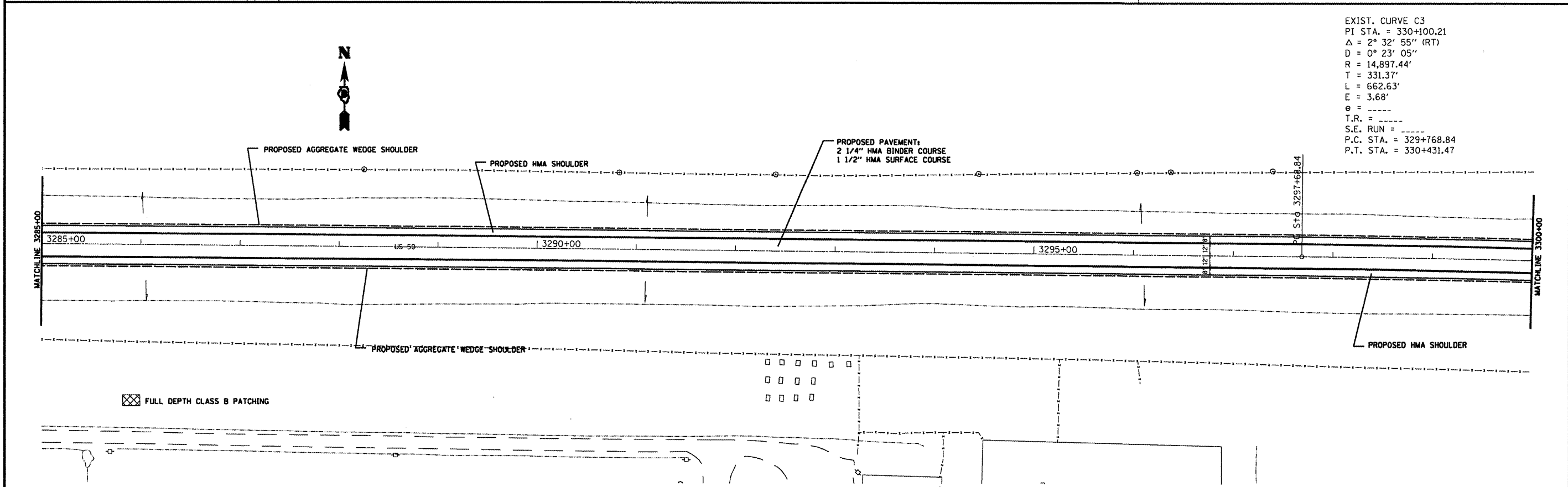
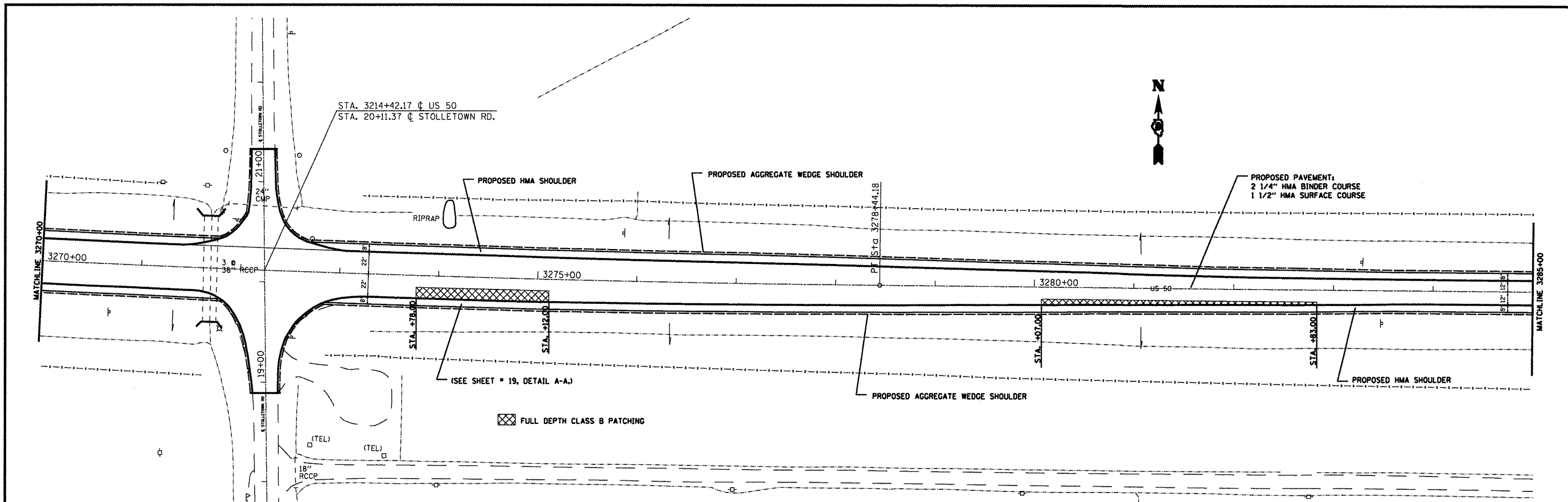

EXIST. CURVE C3
 PI STA. = 330+100.21
 $\Delta = 2^\circ 32' 55''$ (RT)
 $D = 0^\circ 23' 05''$
 $R = 14,897.44'$
 $T = 331.37'$
 $L = 662.63'$
 $E = 3.68'$
 $e =$
 $T.R. =$
 $S.E. RUN =$
 $P.C. STA. = 329+768.84$
 $P.T. STA. = 330+431.47$

FILE NAME =	USER NAME = *USER*	DESIGNED -	REVISED -
*FILE#		DRAWN -	REVISED -
	PLOT SCALE = *SCALE*	CHECKED -	REVISED -
	PLOT DATE = *DATE*	DATE -	REVISED -

**STATE OF ILLINOIS
 DEPARTMENT OF TRANSPORTATION**

PLAN VIEW

SCALE: 20' = 1" SHEET NO. 3 OF 5 SHEETS STA. 3270+00 TO STA. <3300+00>

F.A.P. RTE.	SECTION	COUNTY	TOTAL SHEETS	SHEET NO.
327	14-1985-1	CLINTON	20	10
CONTRACT NO. 76E10			FED. ROAD DIST. NO. ILLINOIS FED. AID PROJECT	

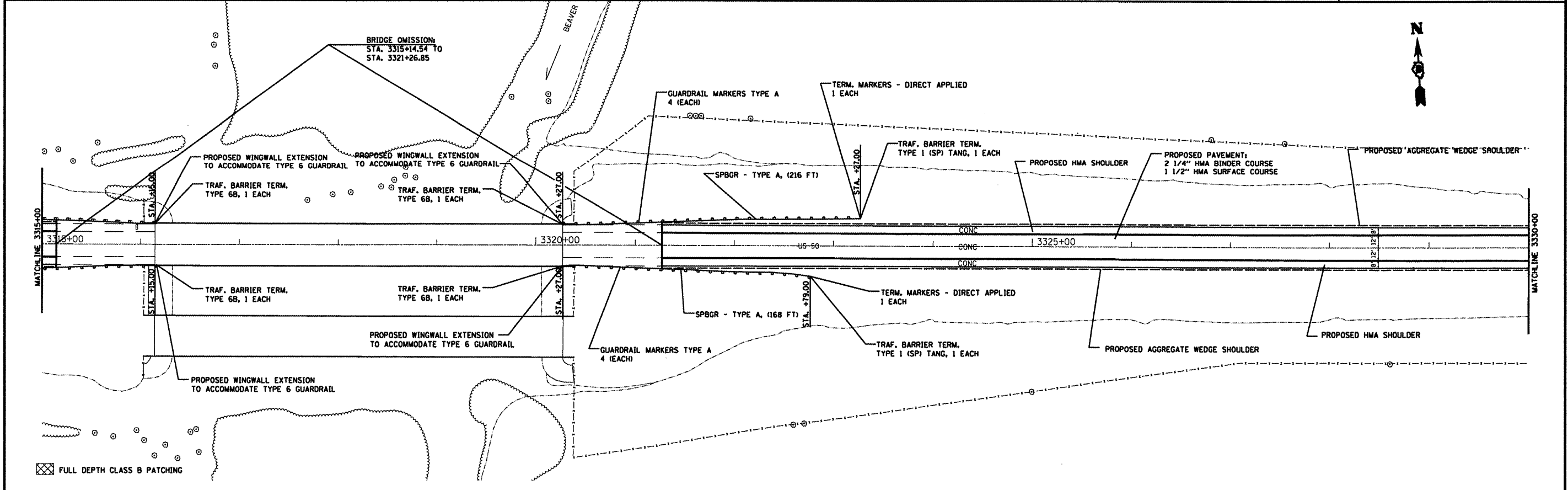
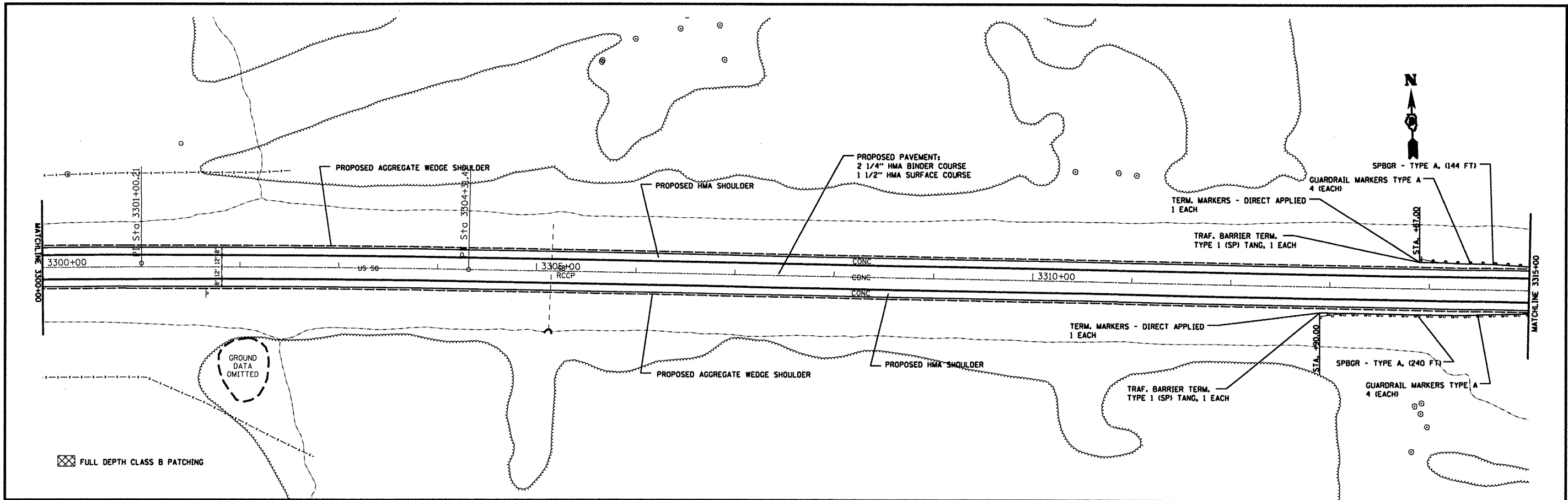

FILE NAME =	USER NAME = #USER#	DESIGNED -	REVISED -	STATE OF ILLINOIS DEPARTMENT OF TRANSPORTATION	PLAN VIEW	F.A.R. RTE.	SECTION	COUNTY	TOTAL SHEET SHEETS NO.	
#FILE#	PLOT SCALE = #SCALE#	DRAWN -	REVISED -			.321	14.1985-1	CLINTON	20	11
	PLOT DATE = #DATE#	CHECKED -	REVISED -			CONTRACT NO. 76E1Q				
		DATE -	REVISED -			FED. ROAD DIST. NO. ILLINOIS FED. AID PROJECT				

SCALE: 20 SHEET NO. 4 OF 5 SHEETS STA. 3300+00 TO STA. 3330+00

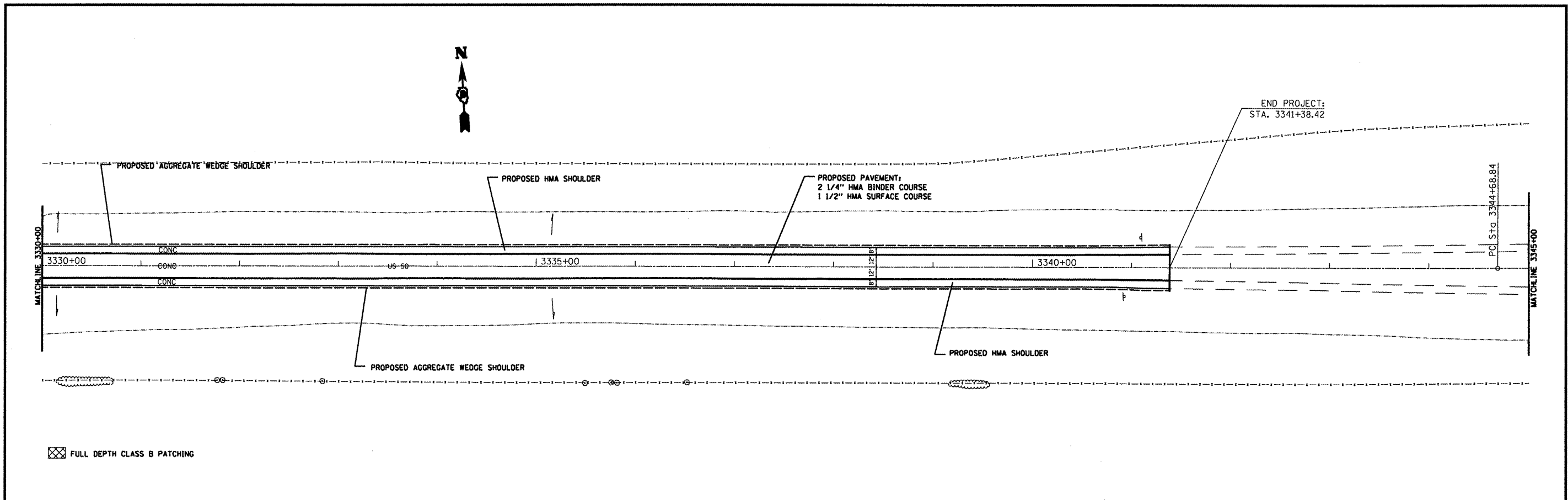

⊠ FULL DEPTH CLASS B PATCHING

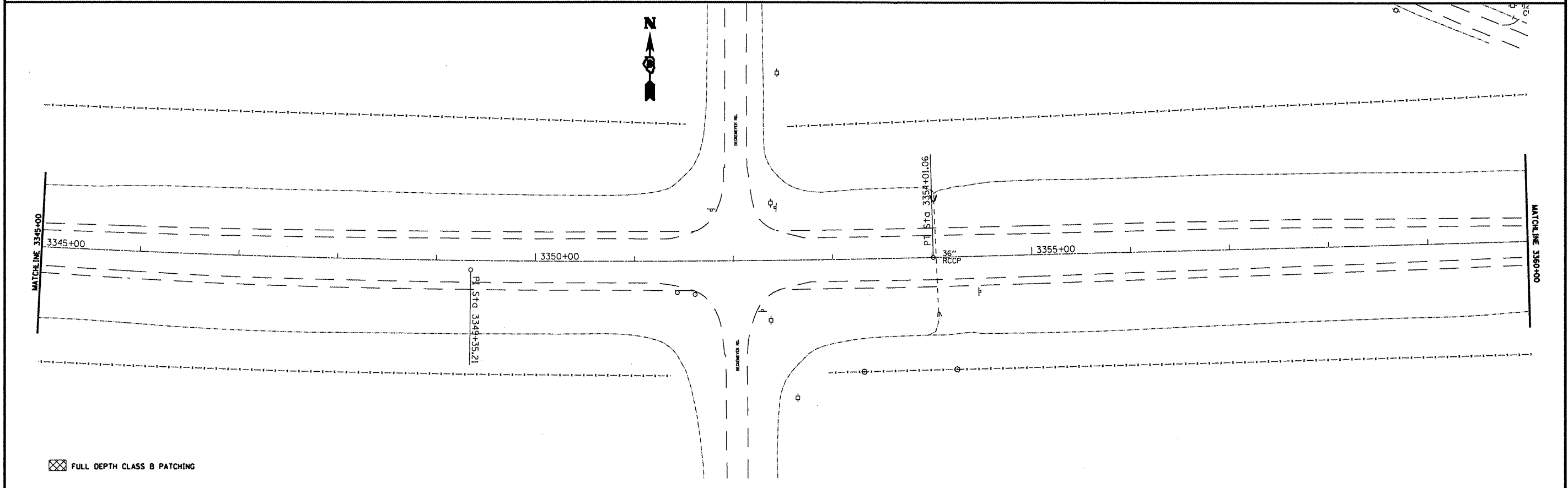

⊠ FULL DEPTH CLASS B PATCHING

FILE NAME =	USER NAME = #USER#	DESIGNED - ---	REVISED - ---
#FILE#		DRAWN - ---	REVISED - ---
	PLOT SCALE = #SCALE#	CHECKED - ---	REVISED - ---
	PLOT DATE = #DATE#	DATE - ---	REVISED - ---

**STATE OF ILLINOIS
DEPARTMENT OF TRANSPORTATION**

PLAN VIEW

SCALE: 20' = 1" SHEET NO. 5 OF 5 SHEETS STA. 3330±00 TO STA. 3360±00

F.A.P. RTE.	SECTION	COUNTY	TOTAL SHEETS	SHEET NO.
321	14-1985-1	CLINTON	20	12
FED. ROAD DIST. NO. - ILLINOIS FED. AID PROJECT			CONTRACT NO. TBELO	

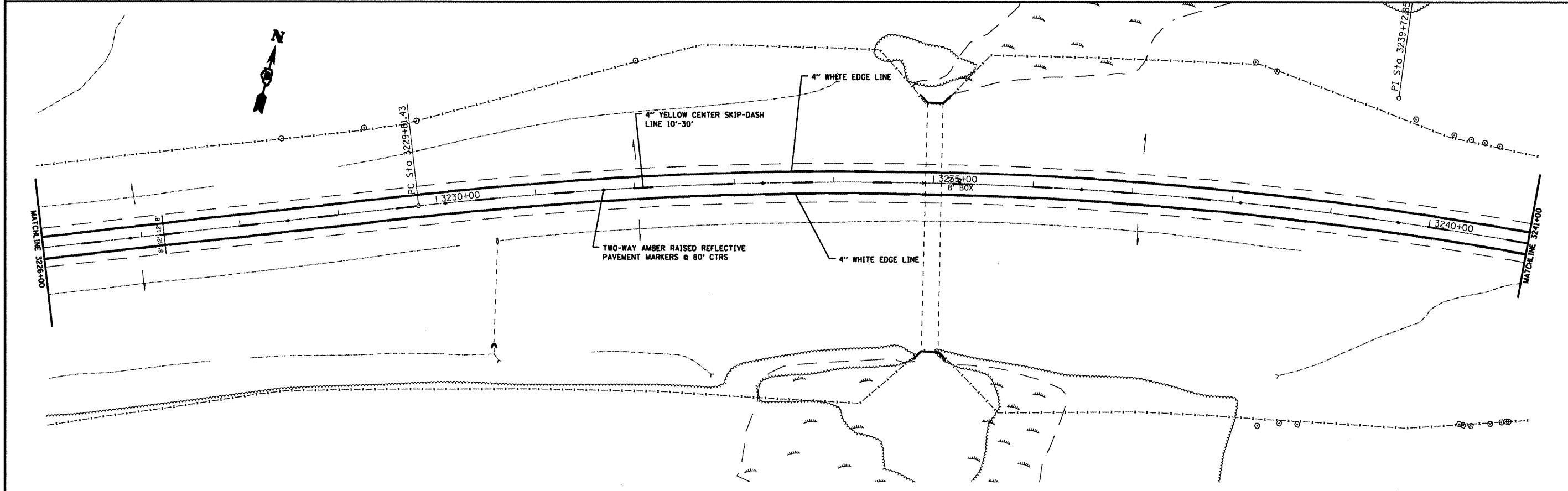
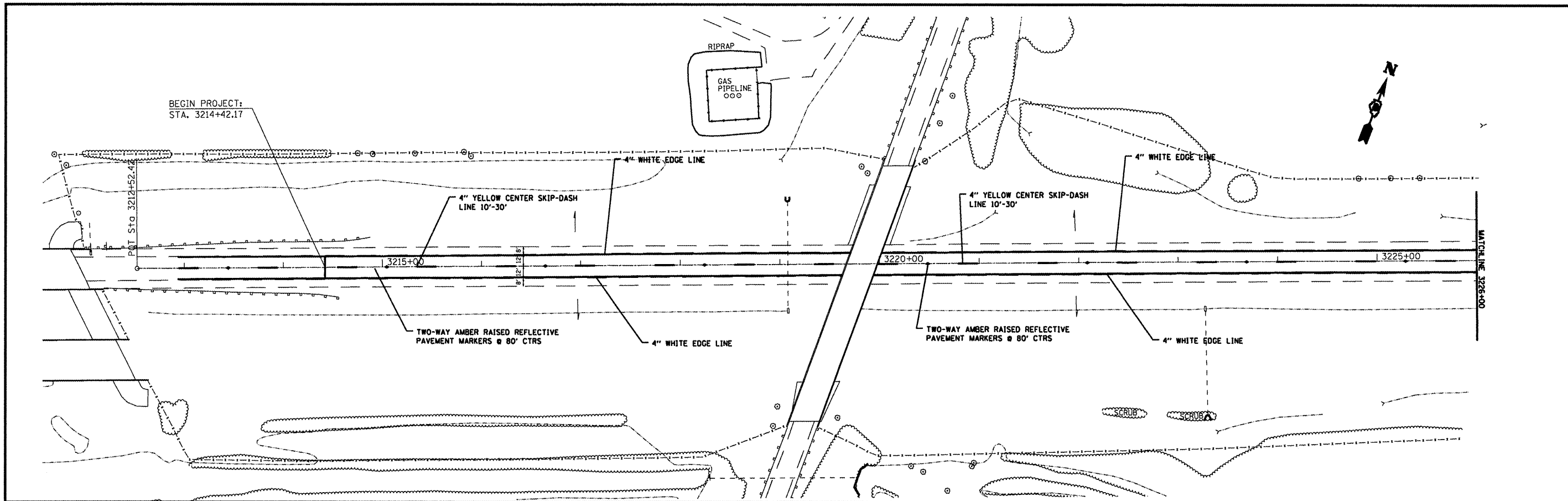

FILE NAME =	USER NAME = #USER#	DESIGNED -	REVISED -	STATE OF ILLINOIS DEPARTMENT OF TRANSPORTATION	PAVEMENT MARKING	F.A.P. RTE.	SECTION	COUNTY	TOTAL SHEETS	SHEET NO.	
#FILE#		DRAWN -	REVISED -			327	14.1585-1	CLINTON	19	13	
	PLOT SCALE = #SCALE#	CHECKED -	REVISED -			CONTRACT NO. 76E1Q					
	PLOT DATE = #DATE#	DATE -	REVISED -			FED. ROAD DIST. NO. [ILLINOIS] FED. AID PROJECT					

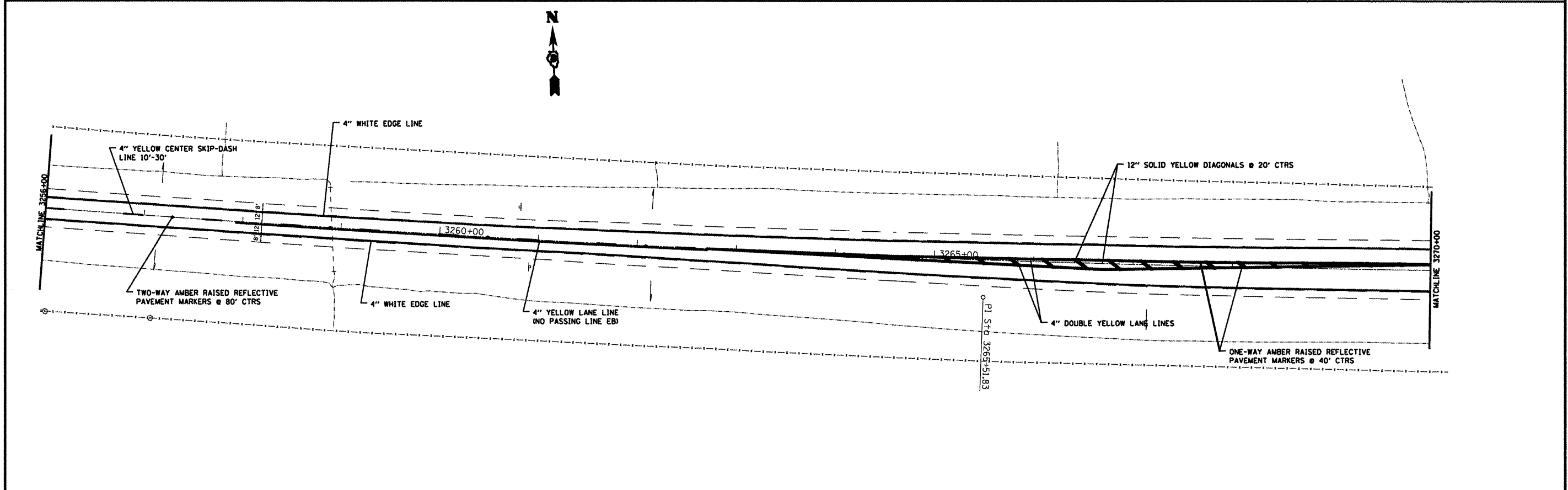
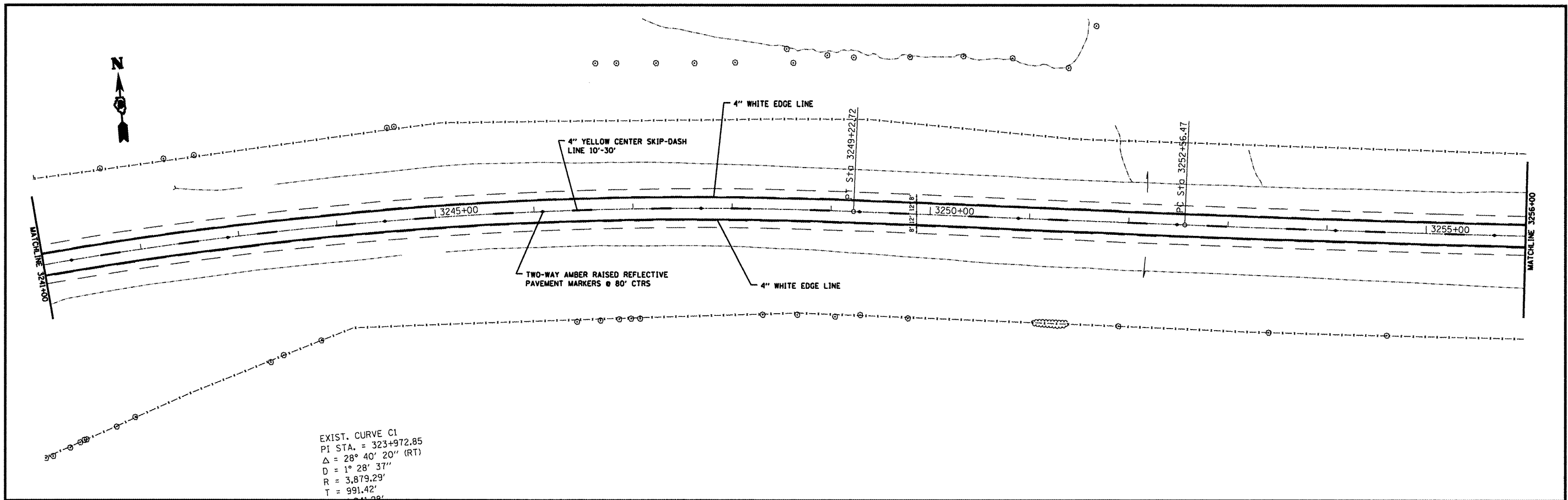

FILE NAME =	USER NAME = #USER#	DESIGNED -	REVISED -	STATE OF ILLINOIS DEPARTMENT OF TRANSPORTATION	PAVEMENT MARKING	F.A.R. RTE.	SECTION	COUNTY	TOTAL SHEETS	SHEET NO.	
#FILE#		DRAWN -	REVISED -			321	14.1585-1	CLINTON	19	14	
	PLOT SCALE = #SCALE#	CHECKED -	REVISED -			SCALE: _____ SHEET NO. _____ OF _____ SHEETS STA. _____ TO STA. _____		FED. ROAD DIST. NO. _____ ILLINOIS FED. AID PROJECT			
	PLOT DATE = #DATE#	DATE -	REVISED -			CONTRACT NO. 78E1Q					

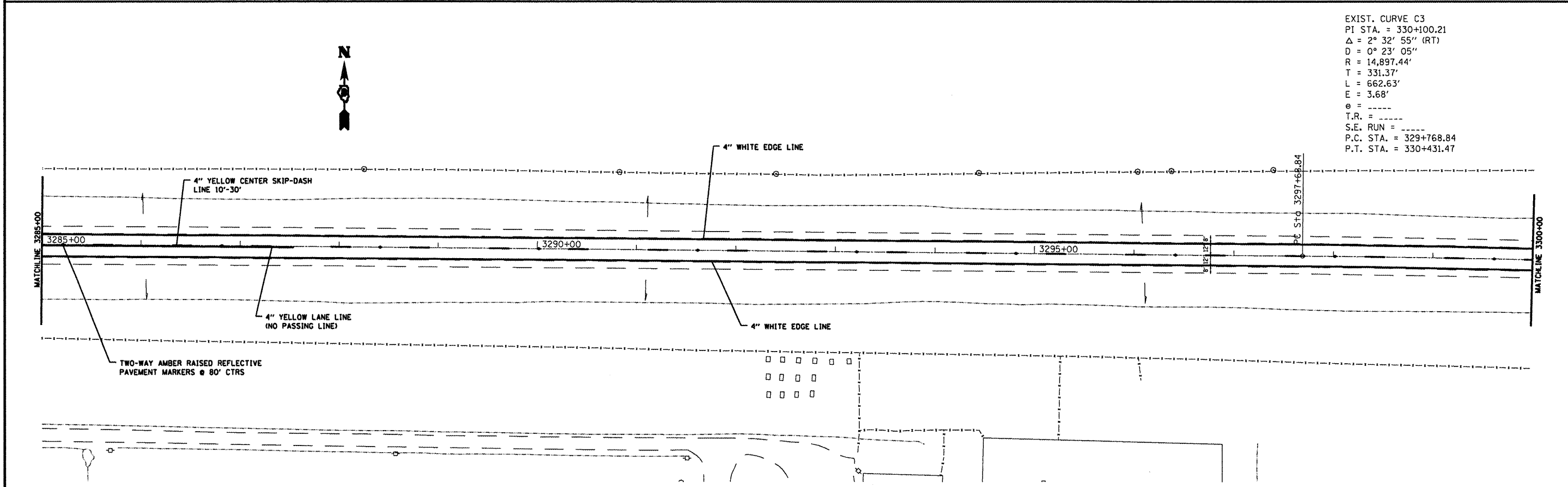
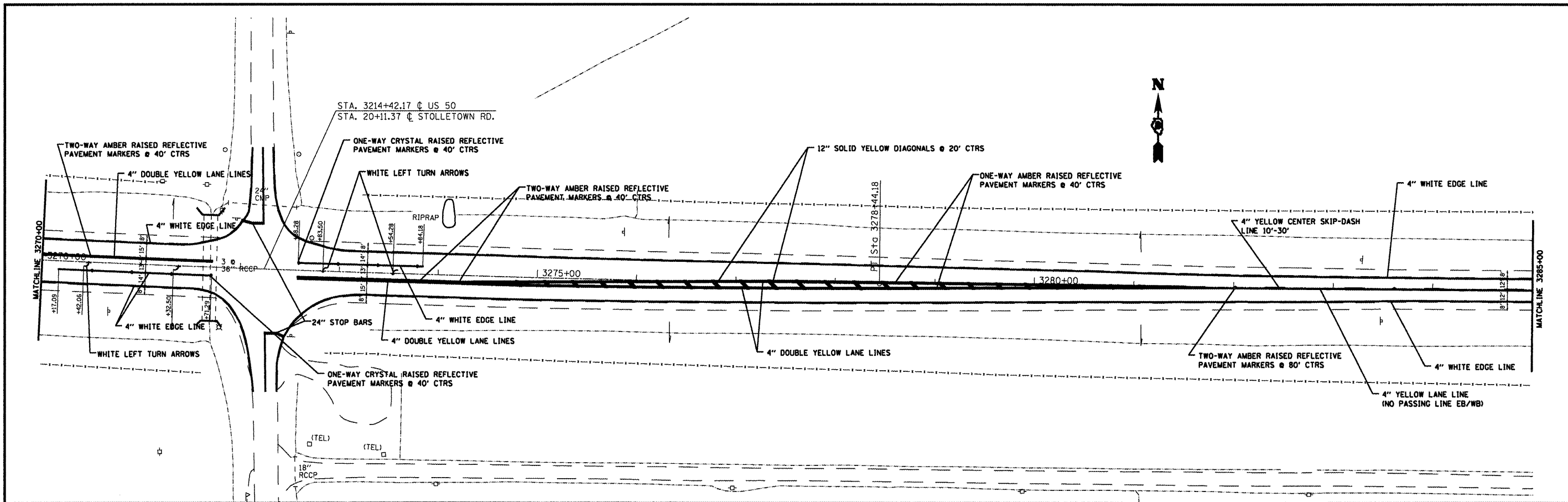

FILE NAME =	USER NAME = #USER#	DESIGNED -	REVISED -	STATE OF ILLINOIS DEPARTMENT OF TRANSPORTATION	PAVEMENT MARKING	F.A.P. RTE.	SECTION	COUNTY	TOTAL SHEETS	SHEET NO.
#FILE#	PLOT SCALE = #SCALE#	DRAWN -	REVISED -			.321	14,1985-1	CLINTON	19	15
	PLOT DATE = #DATE#	CHECKED -	REVISED -			SCALE: SHEET NO. OF SHEETS STA. TO STA.		CONTRACT NO. 76510		
						FED. ROAD DIST. NO. ILLINOIS FED. AID PROJECT				

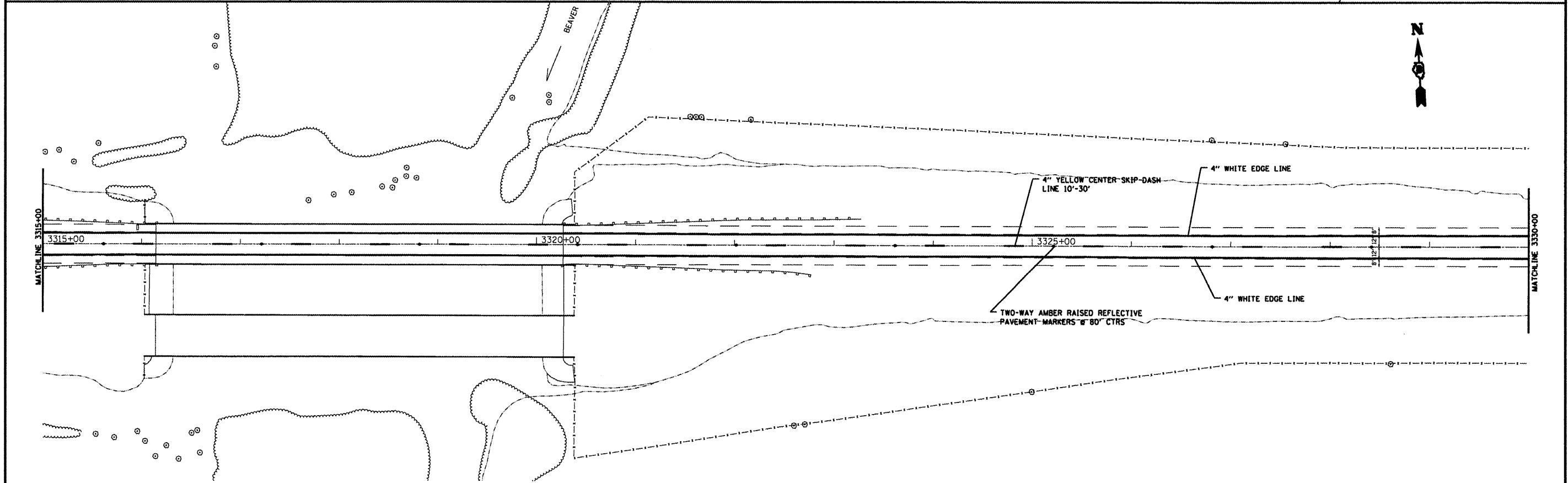
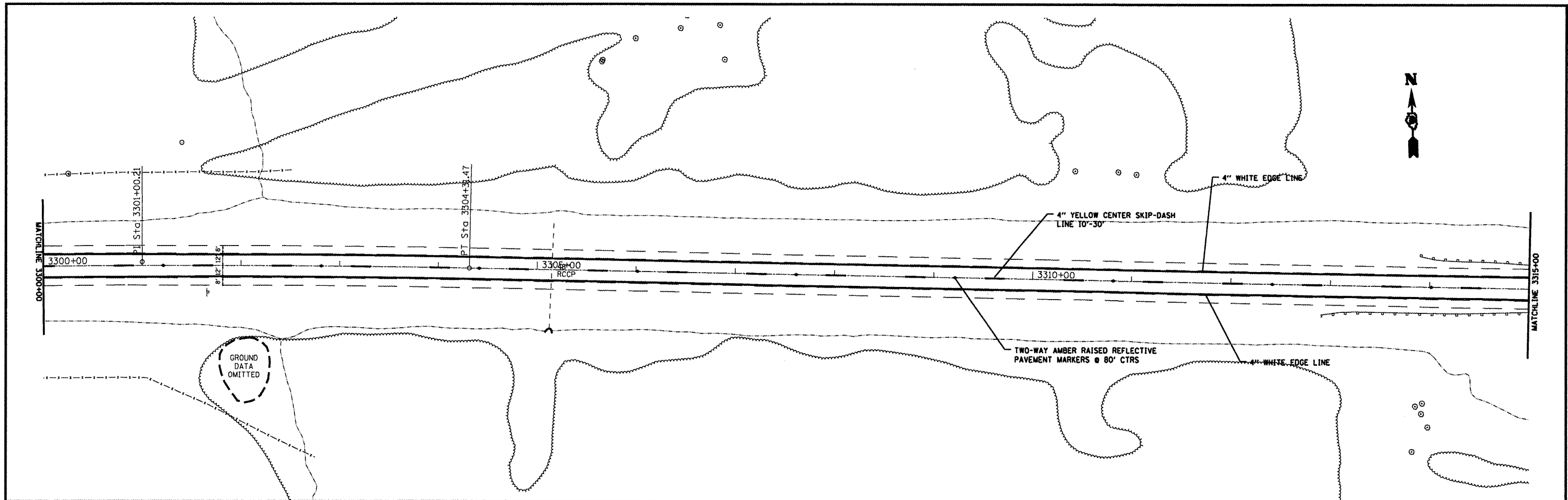

FILE NAME =	USER NAME = #USER#	DESIGNED -	REVISED -	STATE OF ILLINOIS DEPARTMENT OF TRANSPORTATION	PAVEMENT MARKING	F.A.R. RTE.	SECTION	COUNTY	TOTAL SHEETS	SHEET NO.
#FILE#		DRAWN -	REVISED -			327	14.1988:1	CLINTON	19	16
		CHECKED -	REVISED -			CONTRACT NO. 76E1Q		FED. ROAD DIST. NO. ILLINOIS FED. AID PROJECT		
	PLOT SCALE = #SCALE#	DATE	REVISED	SCALE: _____	SHEET NO. ____ OF ____ SHEETS	STA. _____	TO STA. _____			
	PLOT DATE = #DATE#									

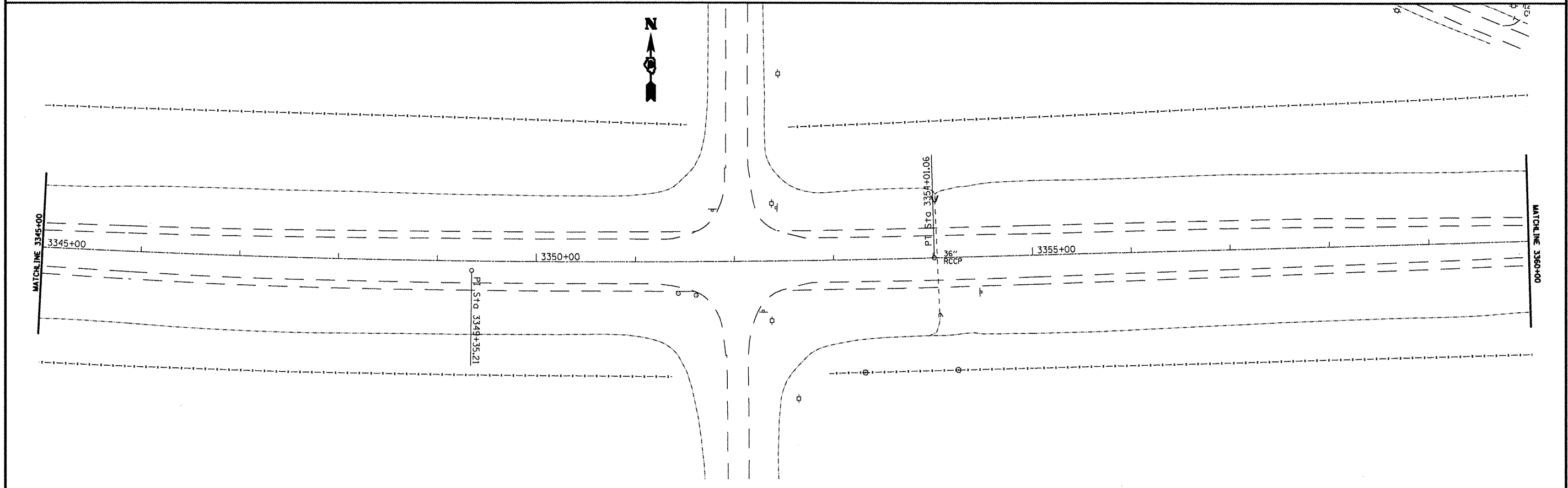
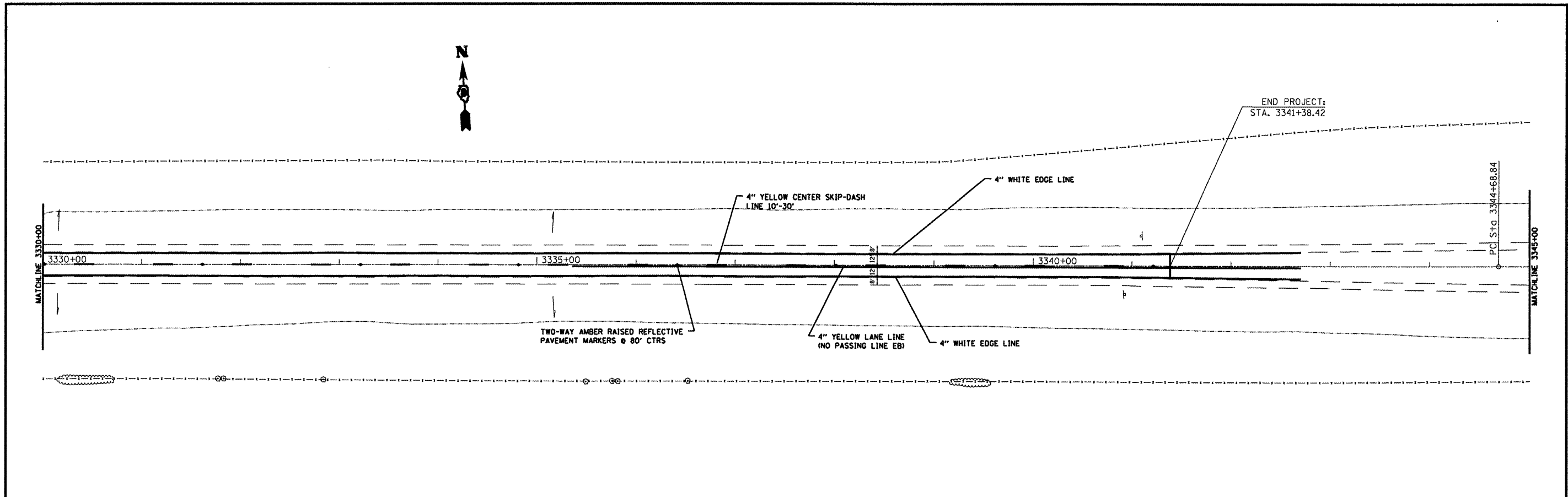

FILE NAME =	USER NAME = #USER#	DESIGNED -	REVISED -	STATE OF ILLINOIS DEPARTMENT OF TRANSPORTATION	PAVEMENT MARKING	F.A.P. RTE.	SECTION	COUNTY	TOTAL SHEETS	SHEET NO.
#FILE#		DRAWN -	REVISED -			327	14,1985-1	CLINTON	19	17
		CHECKED -	REVISED -			CONTRACT NO. 76E10		FED. ROAD DIST. NO. - ILLINOIS FED. AID PROJECT		
		PLOT SCALE = #SCALE#	REVISED -	SCALE: _____ SHEET NO. _____ OF _____ SHEETS STA. _____ TO STA. _____						
		PLOT DATE = #DATE#	REVISED -							

L	A	B
< 150	25'	-
≥ 150	50'	-
≥ 200	50'	≤ 50'

• TO BE DETERMINED BY GEOMETRICS AND SHOWN IN PLANS

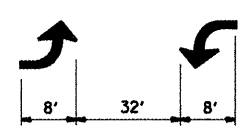
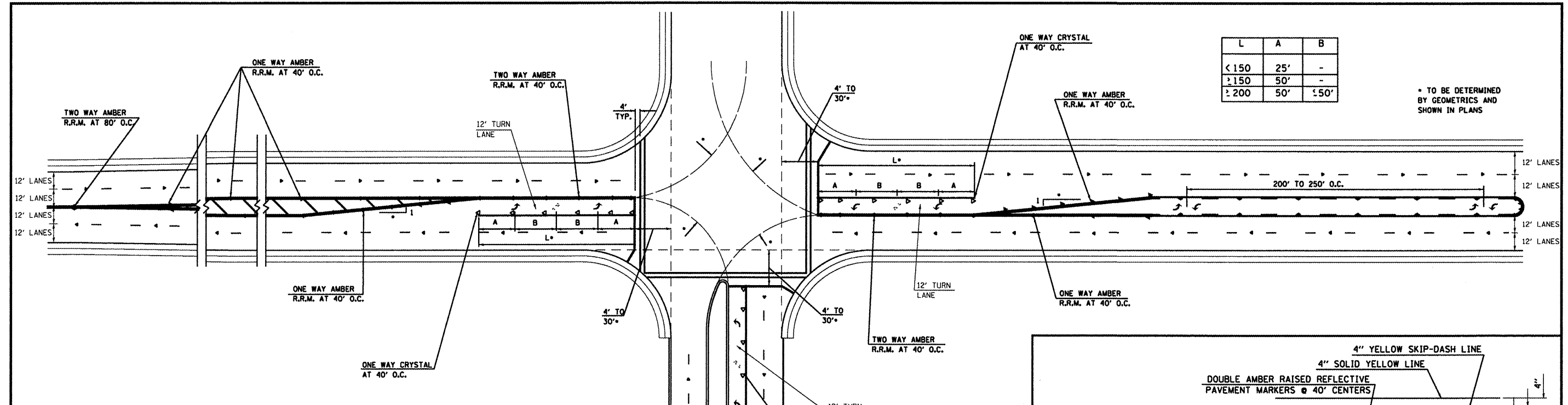

BI-DIRECTIONAL TURN ARROW @ 200' O. C.

SPEED	CHANNELIZATION & GORES	OBJECTS	CONTINUOUS
< 30 MPH	15'	10'	50'
30-45 MPH	20'	15'	75'
> 45 MPH	30'	20'	150'

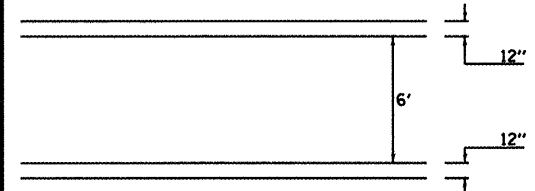

TYPICAL APPLICATION FOR PEDESTRIAN CROSSWALK

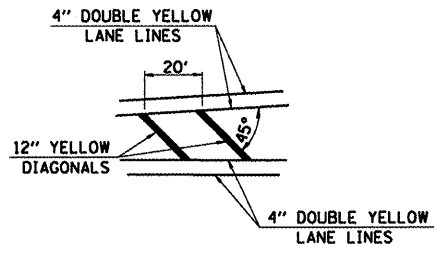

TYPICAL APPLICATION FOR MEDIAN STRIPING

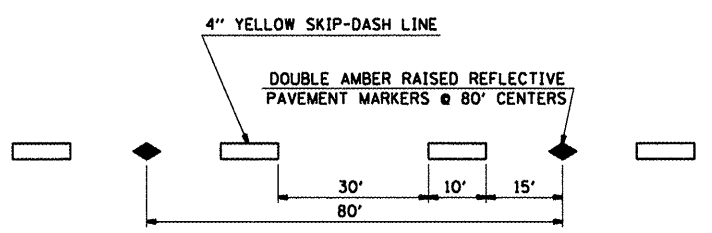

TYPICAL APPLICATION FOR YELLOW SKIP-DASH LINES WITH RAISED REFLECTIVE PAVEMENT MARKERS

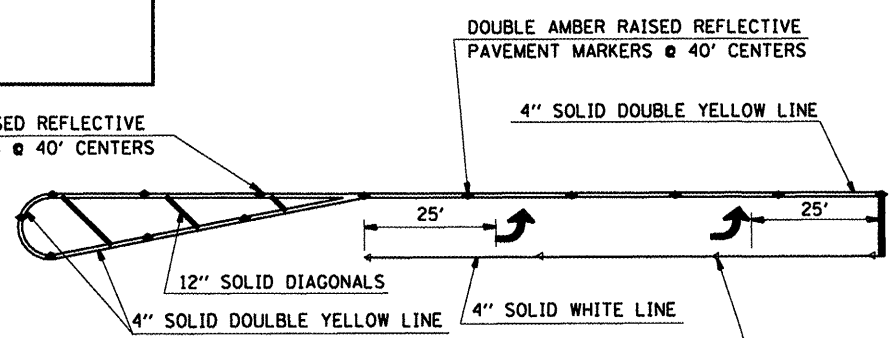

TYPICAL APPLICATION FOR LEFT TURN LANE WITH RAISED REFLECTIVE PAVEMENT MARKERS

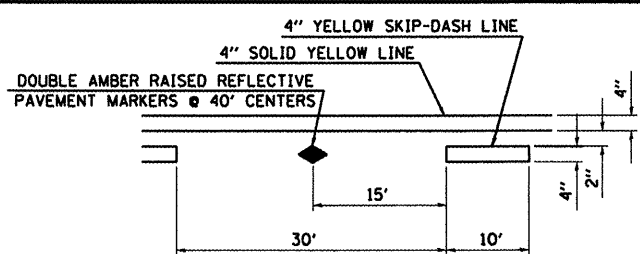

TYPICAL APPLICATION FOR BI-DIRECTIONAL TURN LANE WITH RAISED REFLECTIVE PAVEMENT MARKERS

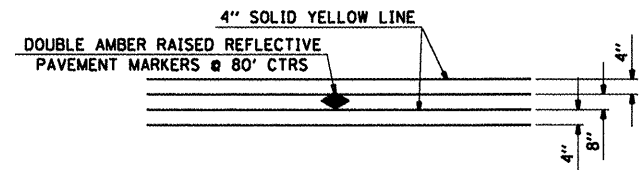

TYPICAL APPLICATION FOR DOUBLE YELLOW LANE LINES WITH RAISED REFLECTIVE PAVEMENT MARKERS

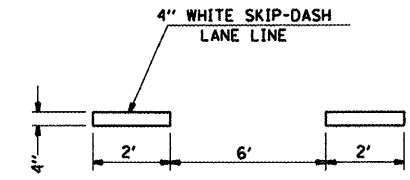

TYPICAL APPLICATION FOR WHITE SKIP-DASH AUX LANE LINES

FILE NAME =	USER NAME = #USER#	DESIGNED -	REVISED -
#FILE#		DRAWN -	REVISED -
	PLOT SCALE = #SCALE#	CHECKED -	REVISED -
	PLOT DATE = #DATE#	DATE -	REVISED -

STATE OF ILLINOIS
DEPARTMENT OF TRANSPORTATION

PAVEMENT MARKING
SCALE: SHEET NO. OF SHEETS STA. TO STA.

F.A.P. RTE.	SECTION	COUNTY	TOTAL SHEETS	SHEET NO.
322	14,1985-1	CLINTON	19	18
CONTRACT NO. 76E10			FED. ROAD DIST. NO. ILLINOIS FED. AID PROJECT	

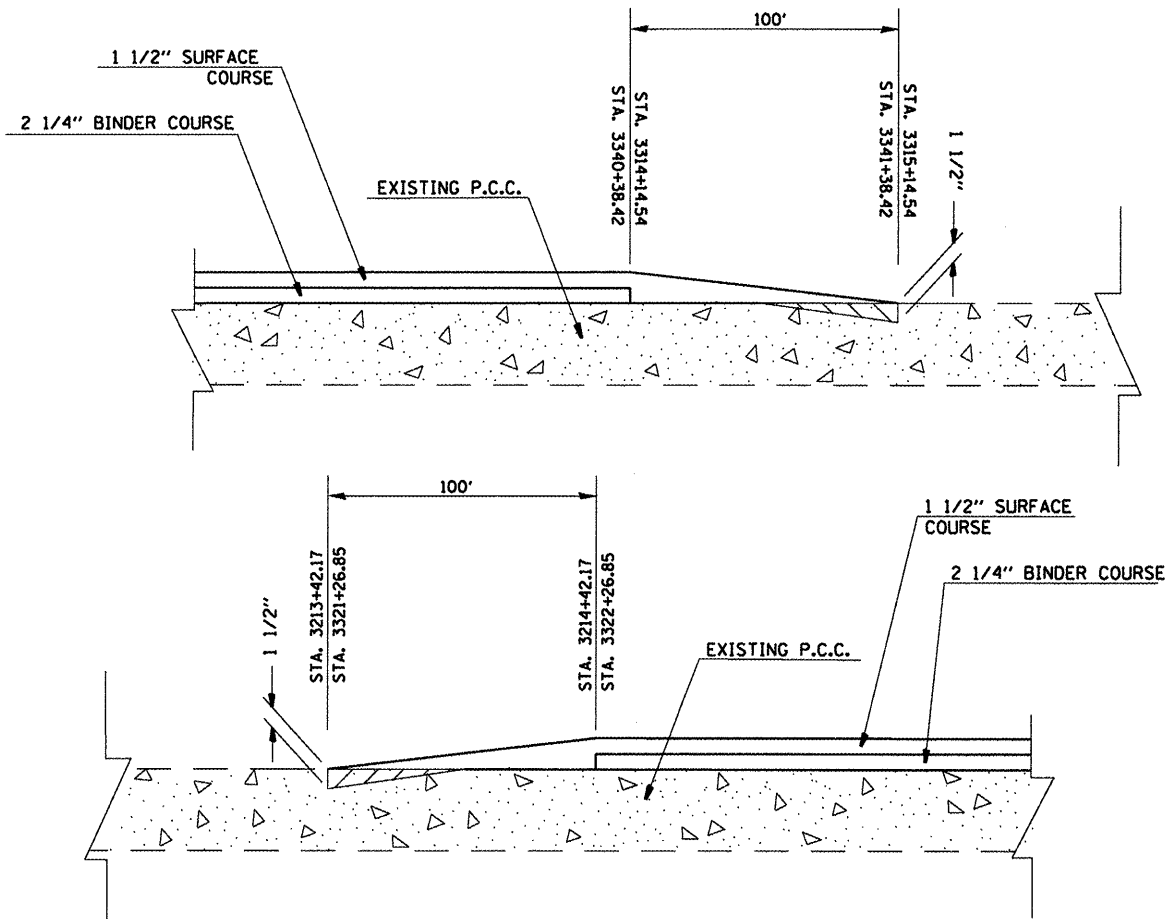

BRIDGE OMISSION & BUTT JOINT DETAIL

S.N. 014-0060 BEGIN/END PROJECT
 STA. 3315+14.54 STA. 3214+42.17
 STA. 3321+26.85 STA. 3321+26.85

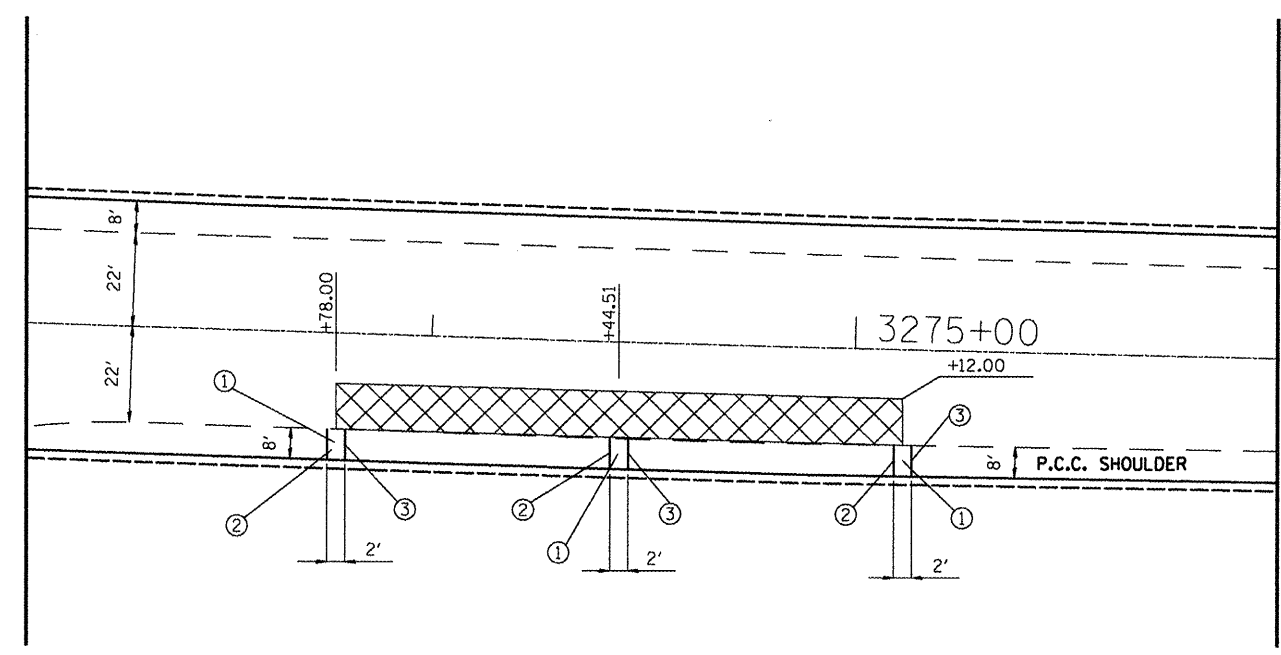

- | | |
|---|---|
| 1 | FRENCH DRAINS |
| 2 | REMOVAL AND DISPOSAL OF UNSUITABLE MATERIAL |
| 3 | PAVED SHOULDER REMOVAL |

⊠ FULL DEPTH CLASS B PATCHING

DETAIL A-A

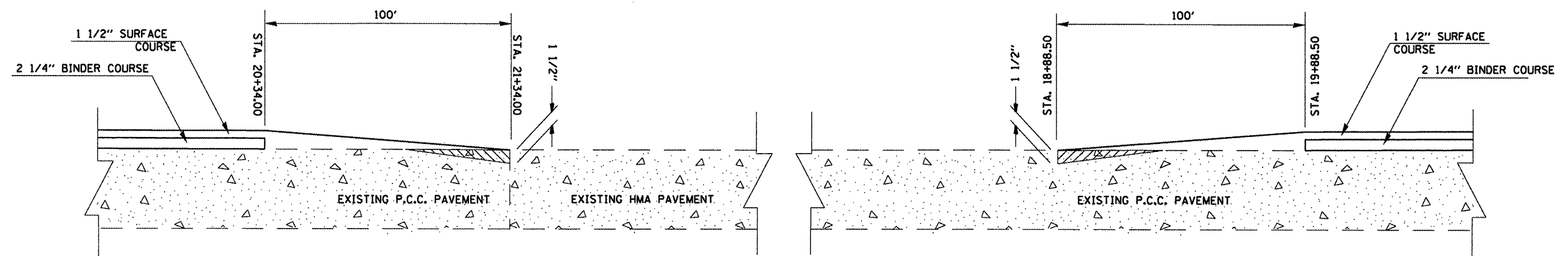

SIDEROAD BUTT JOINT DETAIL

NORTH/SOUTH STOLLETOWN RD.
 STA. 18+88.5
 STA. 18+88.5

FILE NAME =	USER NAME = #USER#	DESIGNED -	REVISED -	STATE OF ILLINOIS DEPARTMENT OF TRANSPORTATION	DETAIL SHEET	F.A.R. RTE.	SECTION	COUNTY	TOTAL SHEETS	SHEET NO.	
#FILE#		DRAWN -	REVISED -			327	14-1585-1	CLINTON	20	19	
		CHECKED -	REVISED -			CONTRACT NO. 1BE10					
		DATE -	REVISED -			FED. ROAD DIST. NO. ILLINOIS FED. AID PROJECT					

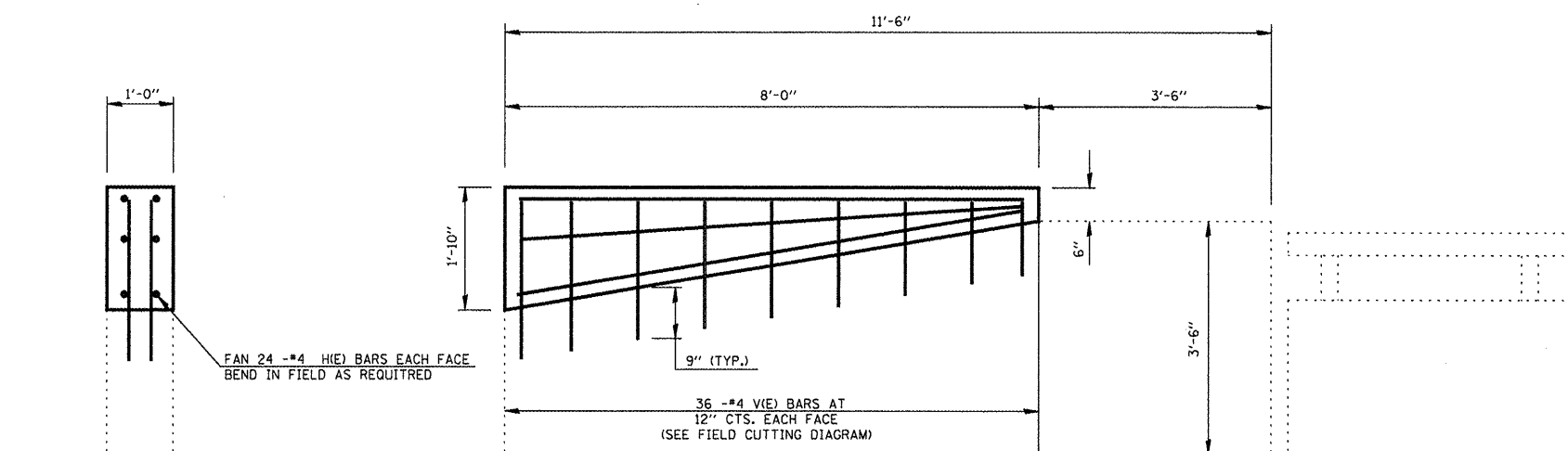

FAN 24 -#4 (H/E) BARS EACH FACE
BEND IN FIELD AS REQUIRED

36 -#4 (V/E) BARS AT
12" CTS. EACH FACE
(SEE FIELD CUTTING DIAGRAM)

S.N. 014-0060

BILL OF MATERIAL

Bar	No.	Size	Length	Shape
h(E)	24	#4	7'-8"	—
v(E)	36	#4	3'-6"	—
Concrete Structures		Cu. Yd.	1.4	
Reinforcement Bars, Epoxy Coated		Pound	210	

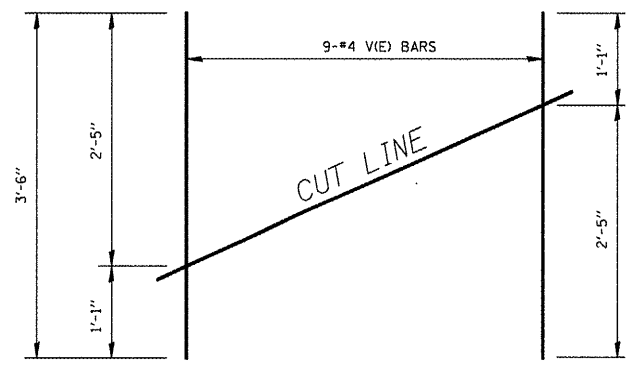

FIELD CUTTING DIAGRAM

ORDER (V/E) FULL LENGTH. CUT AS SHOWN AND
USE REMAINDER OF BARS IN OPPOSITE FACE.

NOTE: THE ADDITION OF CEMENT TO THESE BRIDGE PARAPETS
IS TO PROPERLY ATTACH THE GUARDRAIL TO THE PARAPET
AFTER RAISING THE EXISTING ROADWAY WITH THE 2 1/2" RESURFACING.

FILE NAME =	USER NAME = #USER#	DESIGNED -	REVISD -	STATE OF ILLINOIS DEPARTMENT OF TRANSPORTATION	BRIDGE WINGWALL DETAIL SHEET	F.A.P. RTE.	SECTION	COUNTY	TOTAL SHEETS	SHEET NO.
#FILE#		DRAWN -	REVISD -			327	14-1985-1	CLINTON	20	20
		CHECKED -	REVISD -			SCALE: _____ SHEET NO. _____ OF _____ SHEETS STA. _____ TO STA. _____		CONTRACT NO. 78E10		
		PLOT SCALE = #SCALE#	REVISD -	FED. ROAD DIST. NO. _____ ILLINOIS FED. AID PROJECT						
		PLOT DATE = #DATE#	REVISD -							