

STATE OF ILLINOIS
DEPARTMENT OF TRANSPORTATION

GENERAL NOTES

A Concrete Sealer shall be applied to the surfaces of the deck and parapets. See Special Provisions for Bridge Deck Concrete Sealer.

Existing pavement markings shall be temporarily covered prior to application of the deck surface treatment, to prevent the material from being applied over the markings. The temporary covering shall be removed after the application of the deck surface treatment and prior to opening to traffic. Cost included with Concrete Sealer.

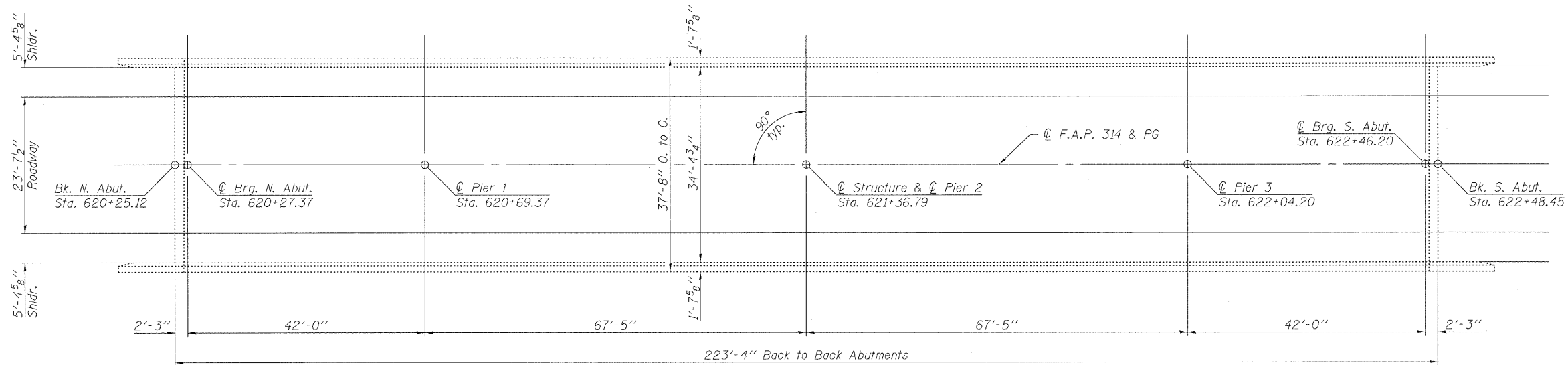

PLAN

Notes:
All stations and dimensions are converted from Metric units. Original Route 4 Metric ϕ structure station = 18+939.292. Original I-70 Metric station = 37+415.421.

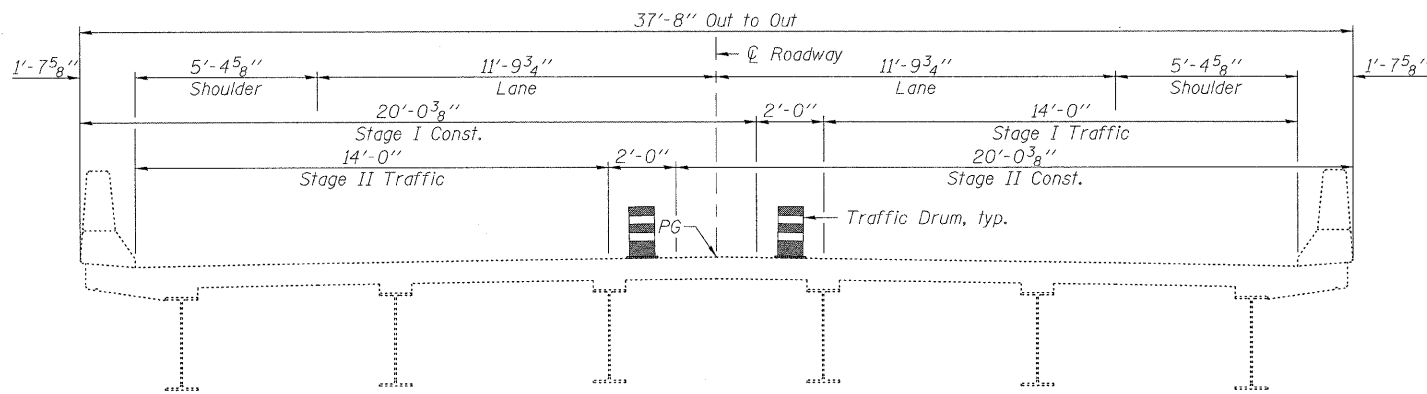

CROSS SECTION
(Looking South)

TOTAL BILL OF MATERIAL

ITEM	UNIT	SUPER	SUB	TOTAL
Concrete Sealer	Sq. Ft.	9,424		9,424

DESIGNED	---
CHECKED	---
DRAWN	KAK
CHECKED	EML

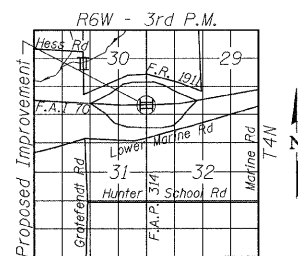

LOCATION SKETCH

HORNER & SHIFRIN, INC.
ENGINEERS

GENERAL PLAN
ILLINOIS ROUTE 4 OVER I-70
F.A.I. RTE. 70
SEC. DIST. 8 BRIDGE DECK 2011-3
MADISON COUNTY
STATION 1227+54.01
STRUCTURE NO. 060-0108

SHEET NO. 1 1 SHEETS	F.A. RTE.	SECTION	COUNTY	TOTAL SHEETS	SHEET NO.
	VAR.	DIST 8 BRIDGE DECK 2011-3	MADISON	29	13
			CONTRACT NO. 76E43		
ILLINOIS FED. AID PROJECT					