

RTE.	SECTION	COUNTY	TOTAL SHEETS	SHEET NO.
N 5TH ST	03-00289-00-BR	ADAMS	90	29
STA.	40+00.00	TO STA.	45+00.00	
CONTRACT NO. 93542				

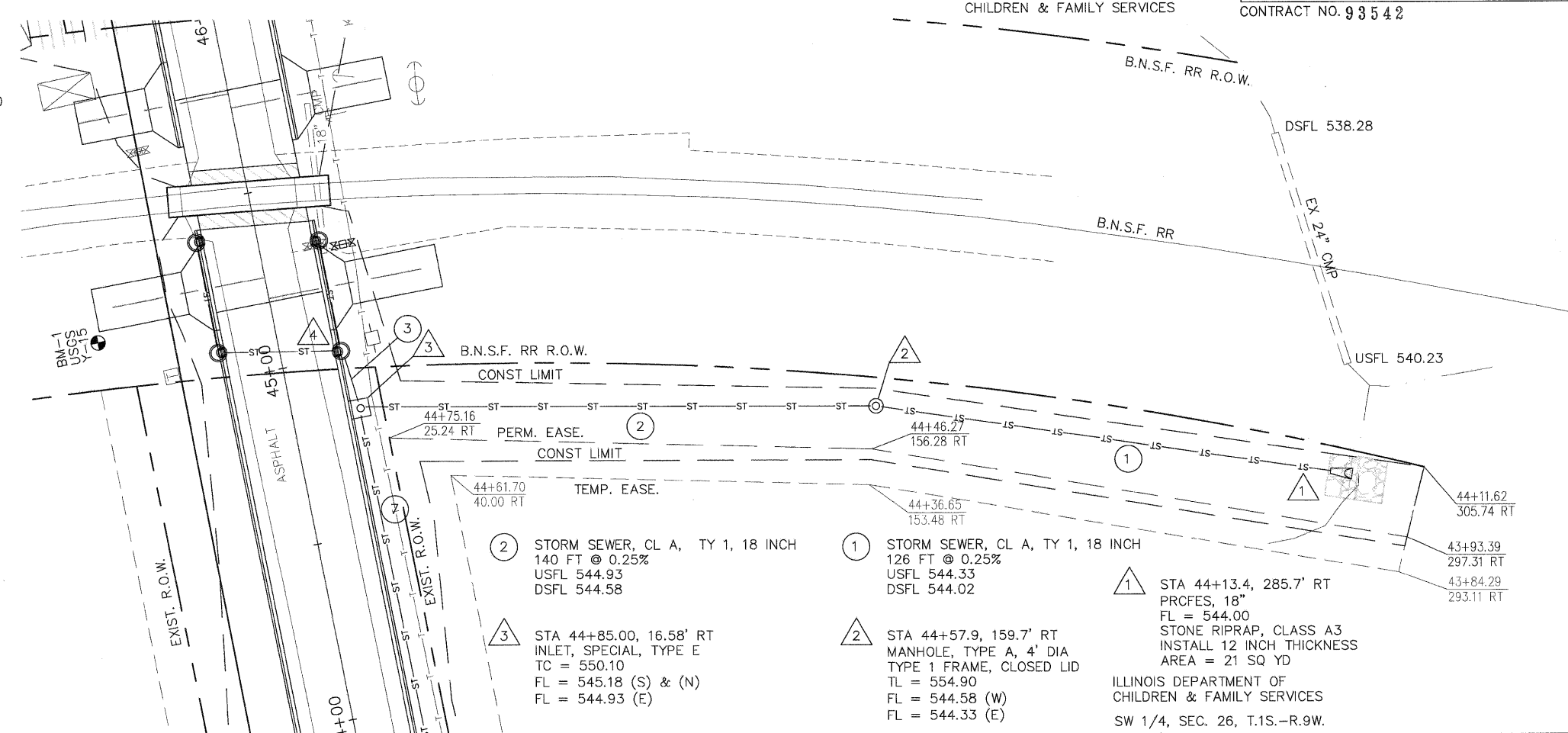

- ② STORM SEWER, CL A, TY 1, 18 INCH
140 FT @ 0.25%
USFL 544.93
DSFL 544.58
 - ① STORM SEWER, CL A, TY 1, 18 INCH
126 FT @ 0.25%
USFL 544.33
DSFL 544.02
 - ③ STA 44+85.00, 16.58' RT
INLET, SPECIAL, TYPE E
TC = 550.10
FL = 545.18 (S) & (N)
FL = 544.93 (E)
 - ② STA 44+57.9, 159.7' RT
MANHOLE, TYPE A, 4' DIA
TYPE 1 FRAME, CLOSED LID
TL = 554.90
FL = 544.58 (W)
FL = 544.33 (E)
 - ① STA 44+13.4, 285.7' RT
PROFES, 18"
FL = 544.00
STONE RIPRAP, CLASS A3
INSTALL 12 INCH THICKNESS
AREA = 21 SQ YD
- ILLINOIS DEPARTMENT OF CHILDREN & FAMILY SERVICES
SW 1/4, SEC. 26, T.1S.-R.9W.

BM 1 - EXISTING USGS MONUMENT Y-15,
BRASS PLATE SET IN CONCRETE
STA 45+17.0, 49.0 LT, ELEV 550.89

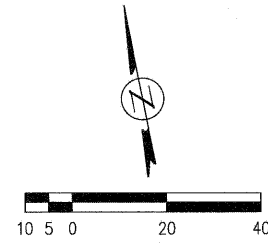