

STATE OF ILLINOIS  
DEPARTMENT OF TRANSPORTATION

RTE.	SECTION	COUNTY	TOTAL SHEETS	SHEET NO.
N 5TH ST	03-00289-00-BR	ADAMS	90	45

SUPERSTRUCTURE

CONTRACT NO. 93542

SHEET 7 OF 18

\* Order a(E) and a<sub>1</sub>(E) bars full length.  
Cut to fit skew and use remainder  
of bars in opposite end.

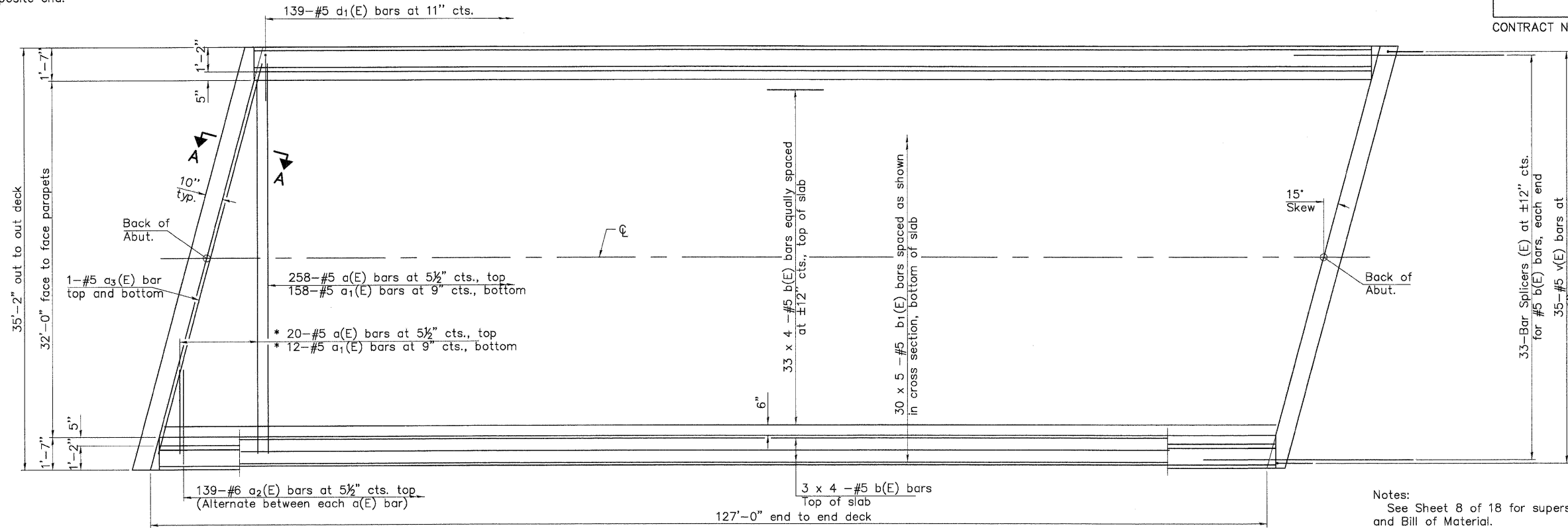

PLAN

Notes:  
See Sheet 8 of 18 for superstructure details  
and Bill of Material.  
Bars indicated thus 20 x 3-#5 etc. indicates  
20 lines of bars with 3 lengths per line.  
See Sheet 8 of 18 for parapet reinforcement.

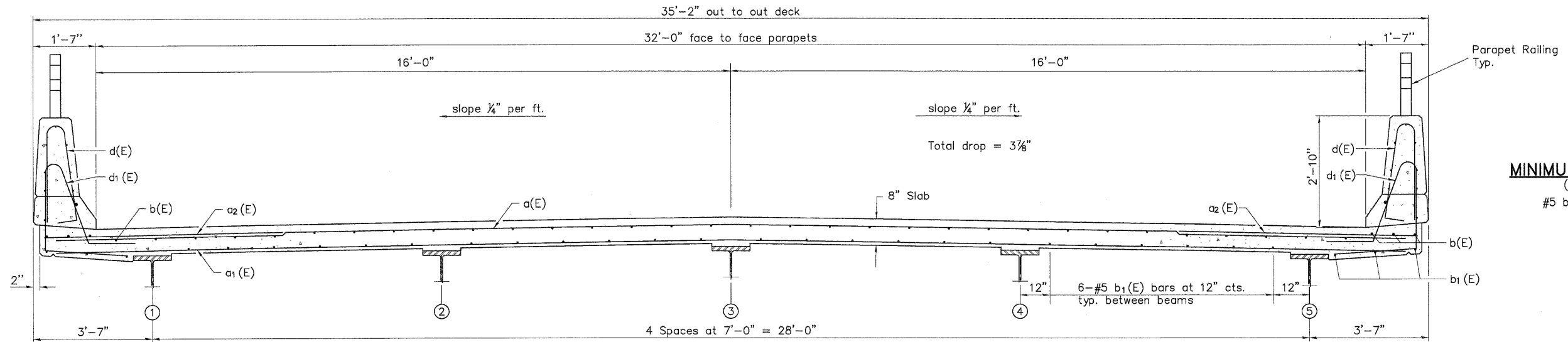

CROSS SECTION  
(Looking North)

SUPERSTRUCTURE  
STRUCTURE NO. 001-6012

DESIGNED	D.S.P.
CHECKED	C.S.B.
DRAWN	D.S.P.
CHECKED	C.S.B.

20	EXAMINED
	ENGINEER OF BRIDGE DESIGN
	PASSED
	ENGINEER OF BRIDGES AND STRUCTURES

**PSBA**  
POEPPING, STONE, BACH & ASSOCIATES, INC.  
ARCHITECTS ENGINEERS PLANNERS SURVEYORS  
100 S 54TH ST, P.O. BOX 709 • QUINCY, IL 62306  
WITH OFFICES IN IKEOKUK, IOWA & HANNIBAL, MISSOURI  
www.psba.com • PHONE 617-223-4605

REVISIONS	
NAME	DATE

CITY OF QUINCY, ILLINOIS  
N. 5TH STREET BRIDGE  
SUPERSTRUCTURE  
SCALE: VERT. \_\_\_\_\_  
DATE \_\_\_\_\_ HORIZ. \_\_\_\_\_  
DRAWN BY: DSP  
CHECKED BY: CSE