

STATE OF ILLINOIS  
DEPARTMENT OF TRANSPORTATION

F.A.U. RTE.	SECTION	COUNTY	TOTAL SHEETS	SHEET NO.
1270	2020-157-RS&SW	LAKE & COOK	21	1
		ILLINOIS	CONTRACT NO. 62M45	

FOR INDEX OF SHEETS, SEE SHEET NO. 2

THIS PROJECT IS LOCATED IN THE VILLAGES OF DEER PARK AND LAKE ZURICH

TRAFFIC DATA

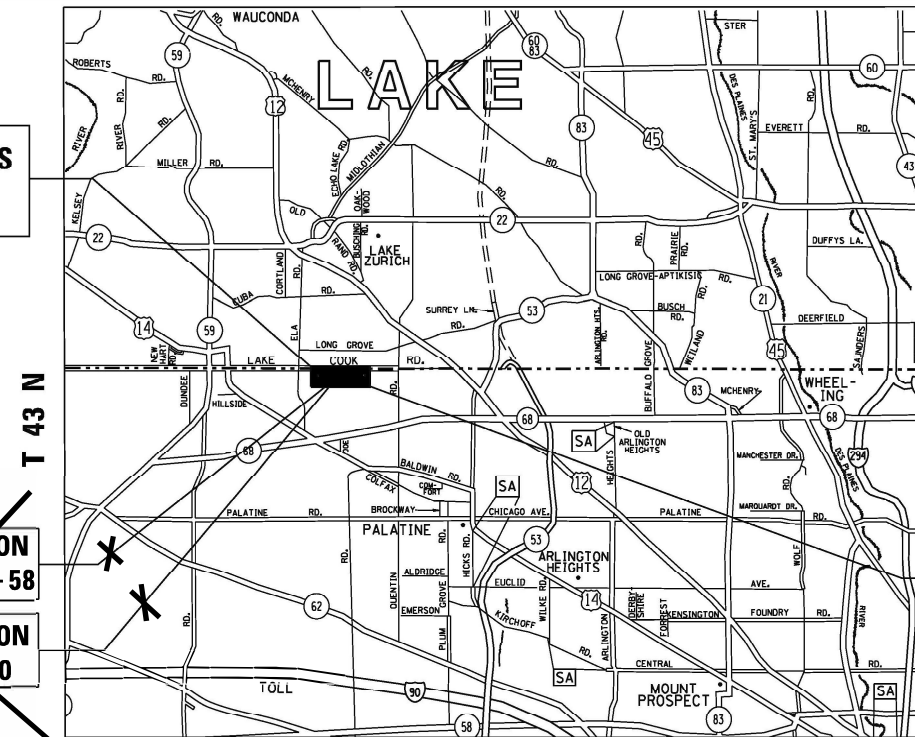
ADT 2018 = 13800  
SPEED LIMIT = 45 MPH

PROPOSED  
HIGHWAY PLANS

F.A.U. ROUTE 1270: LAKE-COOK ROAD  
FROM ELA ROAD TO RUE TOURAINE  
SECTION: 2020-157-RS&SW  
PROJECT: STP-5D8F(020)  
DESIGNED OVERLAY  
LAKE & COOK COUNTY

C-91-375-20

R 10 E

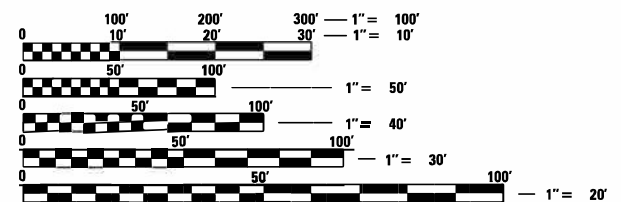


PROJECT BEGINS  
STA 16 + 88

~~OVERLAY OMISSION  
STARTS STA 91 + 58~~

~~OVERLAY OMISSION  
ENDS STA. 92 + 80~~

PROJECT ENDS  
STA 114 + 73



FULL SIZE PLANS HAVE BEEN PREPARED USING STANDARD ENGINEERING SCALES. REDUCED SIZED PLANS WILL NOT CONFORM TO STANDARD SCALES. IN MAKING MEASUREMENTS ON REDUCED PLANS, THE ABOVE SCALES MAY BE USED.

J.U.L.I.E.  
JOINT UTILITY LOCATION INFORMATION FOR EXCAVATORS  
1-800-892-0123  
OR 811

GROSS & NET LENGTH = 9785 FT. = 1.853 MILE

PROJECT ENGINEER: RODRIGO LEDEZMA (847) 705-4580  
PROJECT MANAGER: JEAN ALAIN MIDY (847) 221-3056

CONTRACT NO. 62M45

D-91-576-20



LOCATION OF SECTION INDICATED THIS: - [black rectangle]

STATE OF ILLINOIS  
DEPARTMENT OF TRANSPORTATION  
SUBMITTED ~~DECEMBER~~ 20 21  
*Jose Luis Lopez* REGIONAL ENGINEER  
February 4 2022  
*Stephen M. Smith* ENGINEER OF DESIGN AND ENVIRONMENT  
February 4 2022  
DIRECTOR OF HIGHWAYS PROJECT IMPLEMENTATION 2

PRINTED BY THE AUTHORITY  
OF THE STATE OF ILLINOIS



SUMMARY OF QUANTITIES			URBAN TOTAL QUANTITIES	CONSTRUCTION TYPE CODE				
CODE NO	ITEM	UNIT		0005 80% FED 20% ST COOK COUNTY	0005 80% FED 20% ST LAKE COUNTY	0005 STATE 100%		
X2100002	PRUNING FOR SAFETY AND EQUIPMENT	UNIT	6	3	3			
	CLEARANCE							
20100110	TREE REMOVAL (6 TO 15 UNITS DIAMETER)	UNIT	30	15	15			
40600290	BITUMINOUS MATERIALS (TACK COAT)	POUND	26000	13000	13000			
40600370	LONGITUDINAL JOINT SEALANT	FOOT	13000	6500	6500			
40600400	MIXTURE FOR CRACKS, JOINTS, AND FLANGEWAYS	TON	56	28	28			
40600982	HOT-MIX ASPHALT SURFACE REMOVAL - BUTT JOINT	SO YD	420	210	210			
40601005	HOT-MIX ASPHALT REPLACEMENT OVER PATCHES	TON	960	480	480			
40602985	HOT-MIX ASPHALT BINDER COURSE, IL-9.5, N70	TON	4242	2121	2121			
40604062	HOT-MIX ASPHALT SURFACE COURSE, IL-9.5, MIX "D", N70	TON	3712	1856	1856			
42001300	PROTECTIVE COAT	SO YD	30	15	15			
44000164	HOT-MIX ASPHALT SURFACE REMOVAL, 3 3/4"	SO YD	37862	18931	18931			
44002219	HOT-MIX ASPHALT REMOVAL OVER PATCHES, 4 3/4"	SO YD	3600	1800	1800			

SUMMARY OF QUANTITIES			URBAN TOTAL QUANTITIES	CONSTRUCTION TYPE CODE				
CODE NO	ITEM	UNIT		0005 80% FED 20% ST COOK COUNTY	0005 80% FED 20% ST LAKE COUNTY	0005 STATE 100%		
44201753	CLASS D PATCHES, TYPE II, 9 INCH	SO YD	1190	595	595			
44201757	CLASS D PATCHES, TYPE III, 9 INCH	SO YD	570	285	285			
44201759	CLASS D PATCHES, TYPE IV, 9 INCH	SO YD	1560	780	780			
48102100	AGGREGATE WEDGE SHOULDER, TYPE B	TON	630	315	315			
67100100	MOBILIZATION	L SUM	1	0.5	0.5			
70100460	TRAFFIC CONTROL AND PROTECTION, STANDARD 701306	L SUM	1	0.5	0.5			
70102620	TRAFFIC CONTROL AND PROTECTION, STANDARD 701501	L SUM	1	0.5	0.5			
70102635	TRAFFIC CONTROL AND PROTECTION, STANDARD 701701	L SUM	1	0.5	0.5			
70300100	SHORT TERM PAVEMENT MARKING	FOOT	16296	8148	8148			
70300150	SHORT TERM PAVEMENT MARKING REMOVAL	SO FT	9500	4750	4750			
70300211	TEMPORARY PAVEMENT MARKING LETTERS AND SYMBOLS - PAINT	SO FT	74	37	37			
70300221	TEMPORARY PAVEMENT MARKING - LINE 4" - PAINT	FOOT	30130	15065	15065			

FILE NAME =	USER NAME = shanda	DESIGNED -	REVISED -
pw\N\dot-pw\benrey.com\PIV\DOT\Documents\DOT - Office\District\Projects\157620\CAD\Drawings\157620-sh-3-DRAWN -		REVISOR -	REVISOR -
	PLOT SCALE = 100.0000 "/ in.	CHECKED -	REVISOR -
	PLOT DATE = 12/15/2021	DATE -	REVISOR -

**STATE OF ILLINOIS  
DEPARTMENT OF TRANSPORTATION**

**LAKE-COOK ROAD (ELA RD TO RUE TOURAINE)  
SUMMARY OF QUANTITIES**

SCALE: SHEET NO. OF SHEETS STA. TO STA.

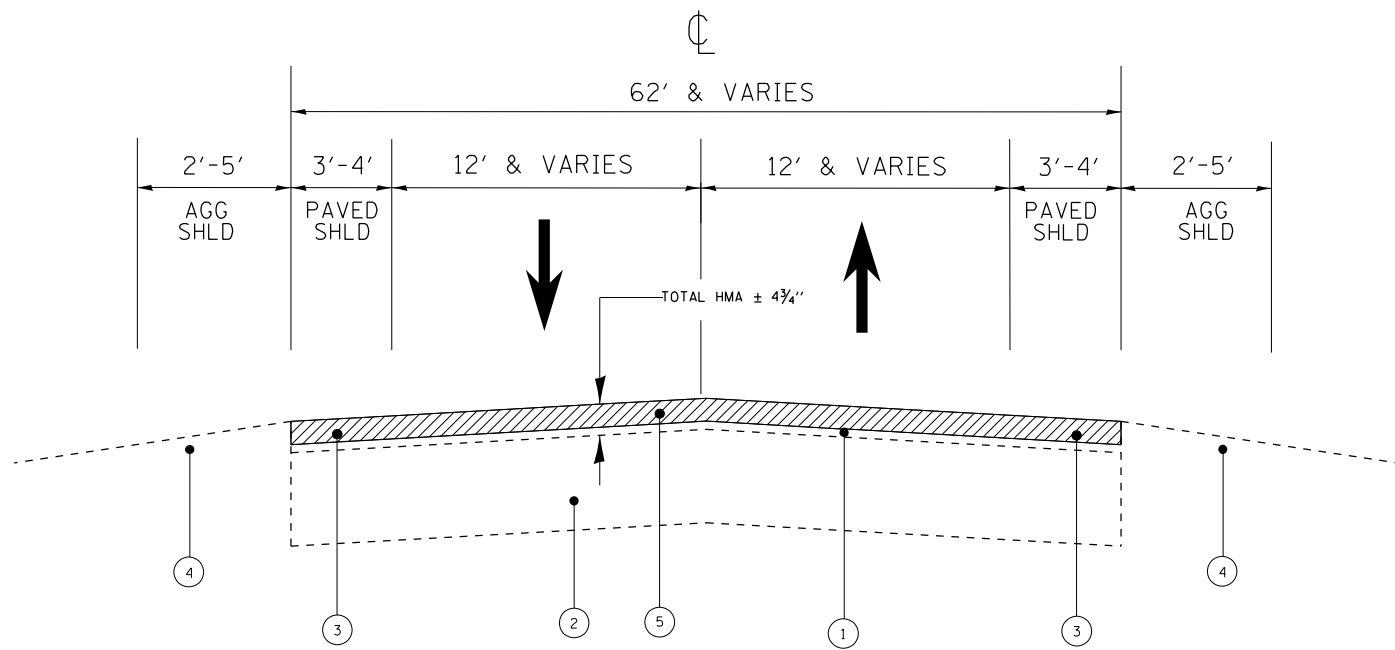
F.A.U. RTE.	SECTION	COUNTY	TOTAL SHEETS	SHEET NO.
1270	2020-157-RS&SW	COOK & LAKE	21	3
FED. ROAD DIST. NO. 1 ILLINOIS FED. AID PROJECT			CONTRACT NO. 62M45	

\* SPECIALTY ITEM

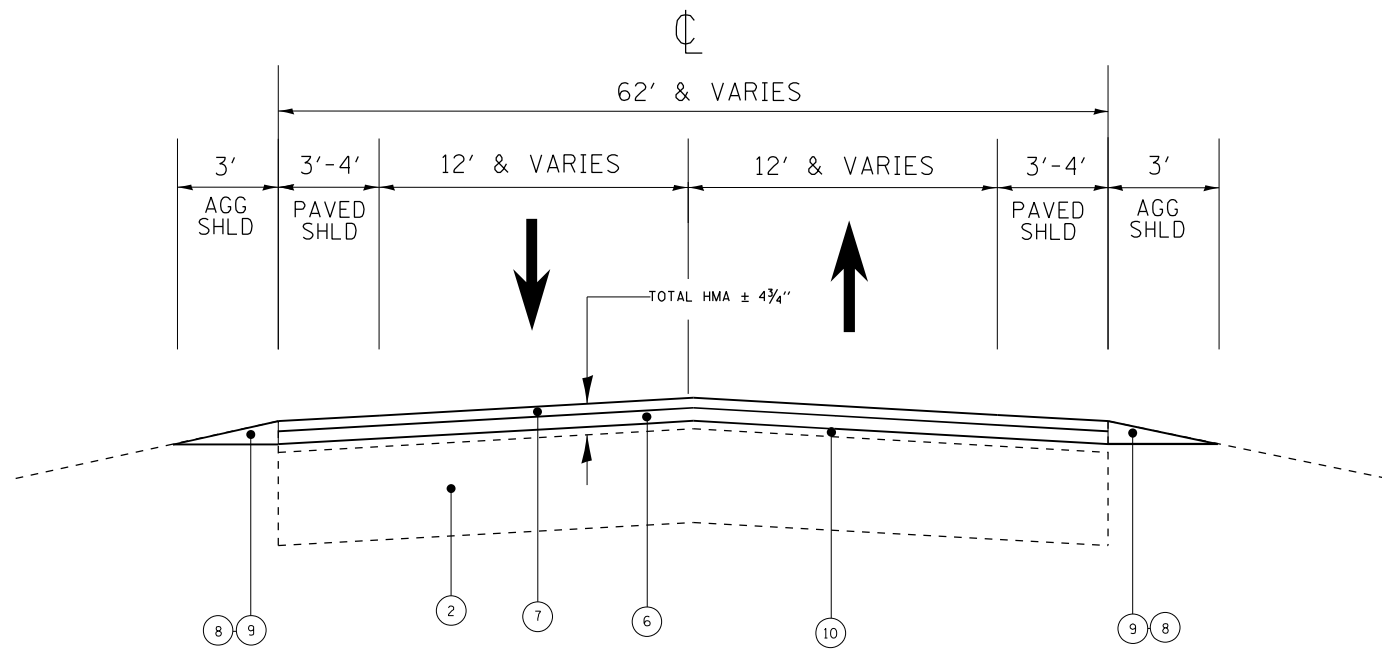
REV-SEP







LAKE-COOK ROAD  
EXISTING TYPICAL SECTION  
STA 16+88 TO STA 114+73



LAKE-COOK ROAD  
PROPOSED TYPICAL SECTION  
STA 16+88 TO STA 114+73

\*GRADING AND SHAPING SHOULDER & AGGREGATE WEDGE SHOULDER LOCATIONS WILL BE DETERMINED IN THE FIELD BY THE RESIDENT ENGINEER

**LEGEND**

- ① EXISTING HMA SURFACE COURSE, ± 4 3/4"
- ② EXISTING PCC PAVEMENT, ± 9"
- ③ EXISTING HMA SHOULDER
- ④ EXISTING AGGREGATE SHOULDER
- ⑤ PROPOSED HMA SURFACE REMOVAL, 3 3/4"
- ⑥ PROPOSED HMA BINDER COURSE, IL-9.5, N70, 2"
- ⑦ PROPOSED HMA SURFACE COURSE MIX "D", IL-9.5, N-70, 1 3/4"
- ⑧ PROPOSED AGGREGATE WEDGE SHOULDERS, TYPE B
- ⑨ PROPOSED GRADING AND SHAPING SHOULDERS
- ⑩ EXISTING HMA PAVEMENT TO REMAIN, ± 1"

MIXTURE REQUIREMENTS		VOIDS @ Ndes	QUALITY MANAGEMENT PROGRAM (QMP)
MIXTURE USES			
<b>PAVEMENT RESURFACING</b>			
HOT-MIX ASPHALT SURFACE COURSE, MIX "D", N70 (IL 9.5 mm), 1 3/4"		4% AT 70 GYR.	<b>QCP</b>
HOT-MIX ASPHALT BINDER COURSE, IL-9.5, N70, 2"		4% AT 70 GYR.	<b>QCP</b>
<b>PATCHING</b>			
CLASS D PATCHES (HMA BINDER, IL-19.0 mm), 9"		4% AT 70 GYR.	<b>QC/QA</b>
HOT-MIX ASPHALT REPLACEMENT OVER PATCHES (HMA BINDER IL-19 MM), 4 3/4"		4% AT 70 GYR.	<b>QC/QA</b>
<b>TEMPORARY RAMP (SPECIAL)</b>			
HOT-MIX ASPHALT BINDER COURSE, IL-9.5, N70 (VAR DEPTH)		4% AT 70 GYR.	<b>QC/QA</b>

QMP Designation: Quality Control/Quality Assurance (QC/QA); Quality Control for Performance (QCP)

**NOTES:**

- THE UNIT WEIGHT USED TO CALCULATE ALL HMA SURFACE MIXTURE QUANTITIES IS 112 LBS/SOYD/IN.
- THE "AC TYPE" FOR POLYMERIZED HMA MIXES SHALL BE "SBS/SBR PG 76-22" AND FOR NON-POLYMERIZED HMA THE "AC TYPE" SHALL BE "PG 64-22" UNLESS MODIFIED BY RECLAIMED MATERIALS SPECIFICATIONS.

**NOTES:**

- CONTRACTOR SHALL PATCH FIRST THEN MILL.
- THE LONGITUDINAL JOINT SEALANT SHALL BE PLACED OVER HMA BINDER IL-9.5.

MOORE Default FILE: \\moore.pw.us\idoc\pw\_bentley.com\PROJECTS\DOT Documents\DOT\_Offices\Bentley\1\Projects\157629\CADD\Bentley\Design\157629\shl-typical.dgn

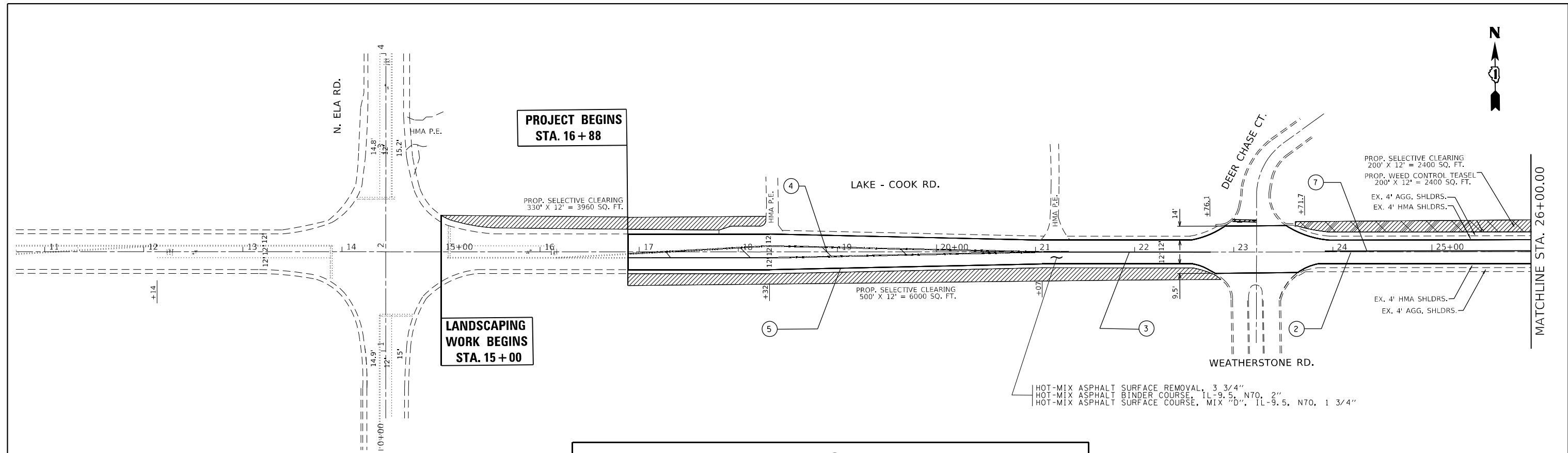
USER NAME = shaheda	DESIGNED -	REVISED -
PLOT SCALE = 100.0000' / in.	DRAWN -	REVISED -
PLOT DATE = 1/19/2022	CHECKED -	REVISED -
	DATE -	REVISED -

**STATE OF ILLINOIS  
DEPARTMENT OF TRANSPORTATION**

**LAKE-COOK ROAD (ELA RD TO RUE TOURNAINE)  
EXISTING AND PROPOSED TYPICAL SECTIONS**

SCALE: SHEET OF SHEETS STA. TO STA.

F.A.U. RTE.	SECTION	COUNTY	TOTAL SHEETS	SHEET NO.
1270	2020-157-R5&SW	COOK & LAKE	21	5
			CONTRACT NO. 62M45	
		ILLINOIS	FED. AID PROJECT	

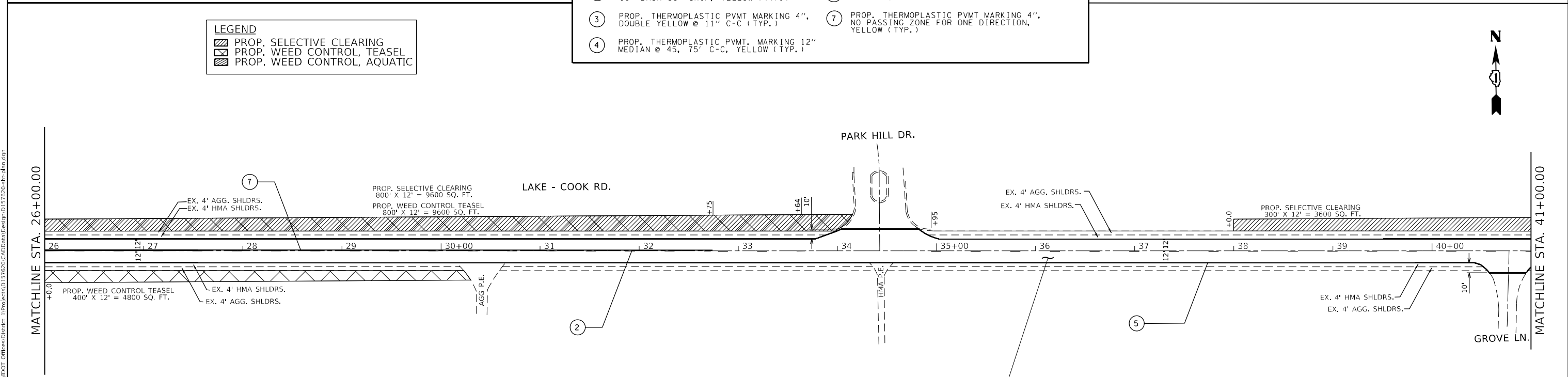


MATCHLINE STA. 26+00.00

**LEGEND**

	PROP. SELECTIVE CLEARING
	PROP. WEED CONTROL, TEASEL
	PROP. WEED CONTROL, AQUATIC

- |  |   |
|--|---|
| ① PROP. THERMOPLASTIC PVMT MARKING 4", 10' DASH 30' SKIP, WHITE (TYP.)     | ⑤ PROP. THERMOPLASTIC PVMT MARKING 4", SHOULDER LANE, WHITE (TYP.)                      |
| ② PROP. THERMOPLASTIC PVMT MARKING 4", 10' DASH 30' SKIP, YELLOW (TYP.)    | ⑥ PROP. THERMOPLASTIC PVMT MARKING LINE, 24" STOPBAR, WHITE (TYP.)                      |
| ③ PROP. THERMOPLASTIC PVMT MARKING 4", DOUBLE YELLOW @ 11" C-C (TYP.)      | ⑦ PROP. THERMOPLASTIC PVMT MARKING 4", NO PASSING ZONE FOR ONE DIRECTION, YELLOW (TYP.) |
| ④ PROP. THERMOPLASTIC PVMT MARKING 12" MEDIAN @ 45, 75' C-C, YELLOW (TYP.) |   |



MATCHLINE STA. 41+00.00

NOTE:  
1. IF A DEAD/HAZARDOUS TREE IS FOUND IN THE SELECTIVE CLEARING AREAS THAT IS LARGER THAN 6", USE PAY ITEM: TREE REMOVAL (6 TO 15 UNITS).

MODEL: Default  
FILE NAME: p:\projects\157620\CADD\Drawings\157620\LAKE-COOK-RD.dwg  
PROJECT: 157620\CADD\Drawings\157620\LAKE-COOK-RD.dwg

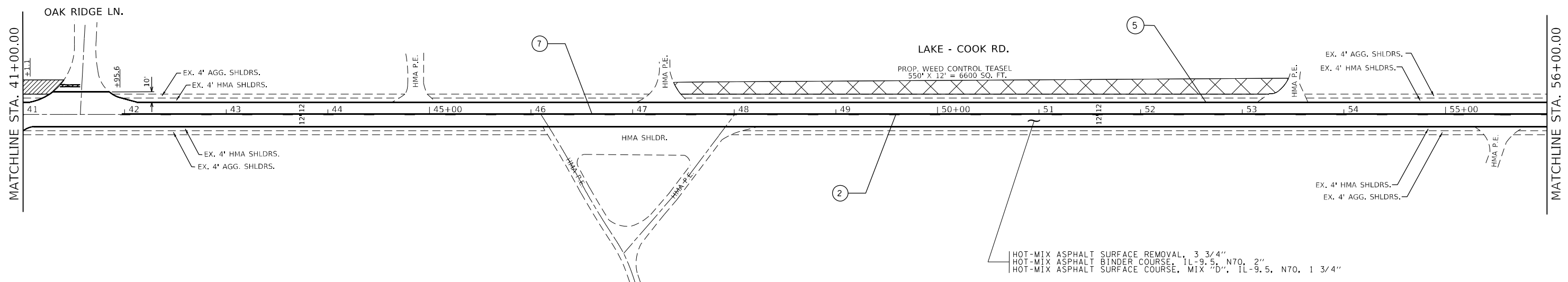
USER NAME = shahda	DESIGNED -	REVISED -
PLOT SCALE = 100,0000' / in.	DRAWN -	REVISED -
PLOT DATE = 12/15/2021	CHECKED -	REVISED -
	DATE -	REVISED -

**STATE OF ILLINOIS  
DEPARTMENT OF TRANSPORTATION**

**ROADWAY PLAN LAKE-COOK RD.  
(ELA RD. TO RUE TOURAINE)**

SCALE: 1"=50'      SHEET 1 OF 4 SHEETS      STA. 11+00.00 TO STA. 41+00.00

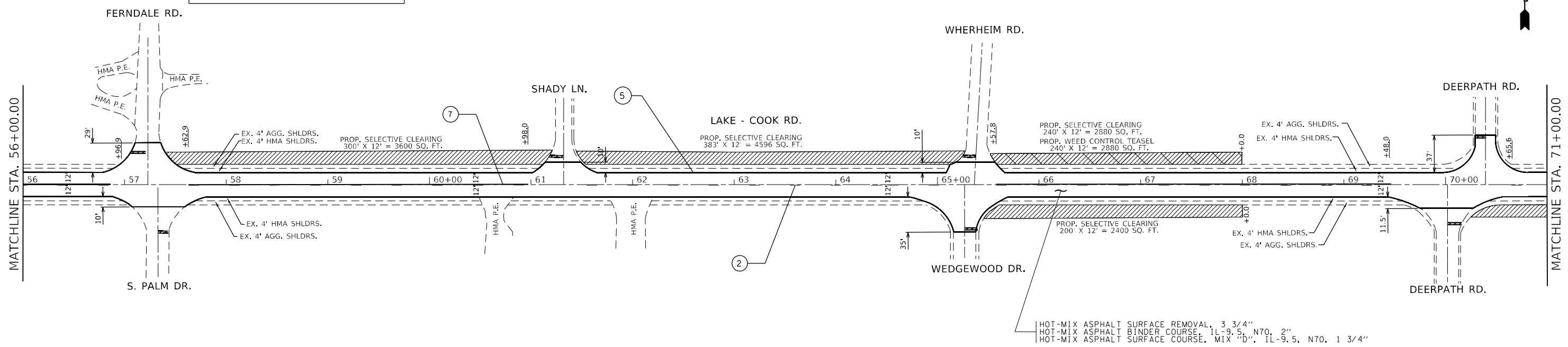
F.A.U. RTE.	SECTION	COUNTY	TOTAL SHEETS	SHEET NO.
1270	2020-157-R5&SW	COOK & LAKE	21	6
CONTRACT NO. 62M45			ILLINOIS FED. AID PROJECT	



HOT-MIX ASPHALT SURFACE REMOVAL, 3 3/4"  
 HOT-MIX ASPHALT BINDER COURSE, 1L-9.5, N70, 2"  
 HOT-MIX ASPHALT SURFACE COURSE, MIX "D", 1L-9.5, N70, 1 3/4"

- ① PROP. THERMOPLASTIC PVMT MARKING 4", 10' DASH 30' SKIP, WHITE (TYP.)
- ② PROP. THERMOPLASTIC PVMT MARKING 4", 10' DASH 30' SKIP, YELLOW (TYP.)
- ③ PROP. THERMOPLASTIC PVMT MARKING 4", DOUBLE YELLOW @ 11" C-C (TYP.)
- ④ PROP. THERMOPLASTIC PVMT MARKING 12" MEDIAN @ 45, 75' C-C, YELLOW (TYP.)
- ⑤ PROP. THERMOPLASTIC PVMT MARKING 4", SHOULDER LANE, WHITE (TYP.)
- ⑥ PROP. THERMOPLASTIC PVMT MARKING LINE, 24" STOPBAR, WHITE (TYP.)
- ⑦ PROP. THERMOPLASTIC PVMT MARKING 4", NO PASSING ZONE FOR ONE DIRECTION, YELLOW (TYP.)

**LEGEND**  
 PROP. SELECTIVE CLEARING  
 PROP. WEED CONTROL, TEASEL  
 PROP. WEED CONTROL, AQUATIC



HOT-MIX ASPHALT SURFACE REMOVAL, 3 3/4"  
 HOT-MIX ASPHALT BINDER COURSE, 1L-9.5, N70, 2"  
 HOT-MIX ASPHALT SURFACE COURSE, MIX "D", 1L-9.5, N70, 1 3/4"

NOTE:  
 1. IF A DEAD/HAZARDOUS TREE IS FOUND IN THE SELECTIVE CLEARING AREAS THAT IS LARGER THAN 6", USE PAY ITEM: TREE REMOVAL (6 TO 15 UNITS).

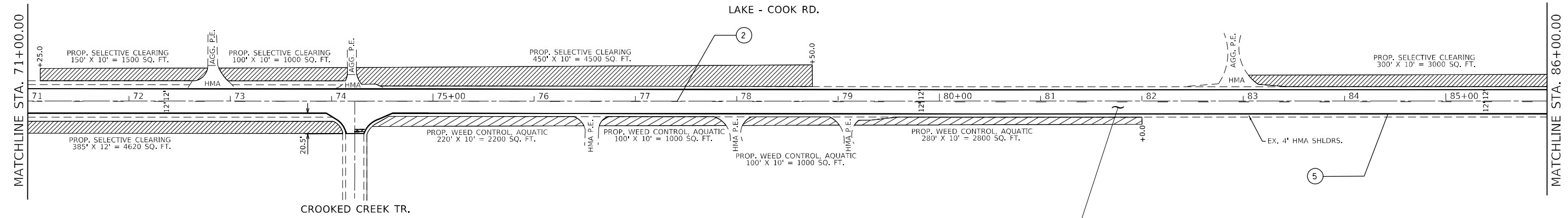
MODEL: Default  
 FILE NAME: p:\projects\157620\CADD\Drawings\157620-Sub-A-100.dwg  
 PROJECT: 157620\CADD\Drawings\157620-Sub-A-100.dwg  
 PROJECT: 157620\CADD\Drawings\157620-Sub-A-100.dwg  
 PROJECT: 157620\CADD\Drawings\157620-Sub-A-100.dwg

USER NAME = shahda	DESIGNED -	REVISED -
PLOT SCALE = 100,0000' / in.	DRAWN -	REVISED -
PLOT DATE = 12/15/2021	CHECKED -	REVISED -
	DATE -	REVISED -

**STATE OF ILLINOIS  
 DEPARTMENT OF TRANSPORTATION**

<b>ROADWAY PLAN LAKE-COOK RD. (ELA RD. TO RUE TOURAINE)</b>	
SCALE: 1"=50'	SHEET 2 OF 4 SHEETS
STA. 41+00.00	TO STA. 71+00.00

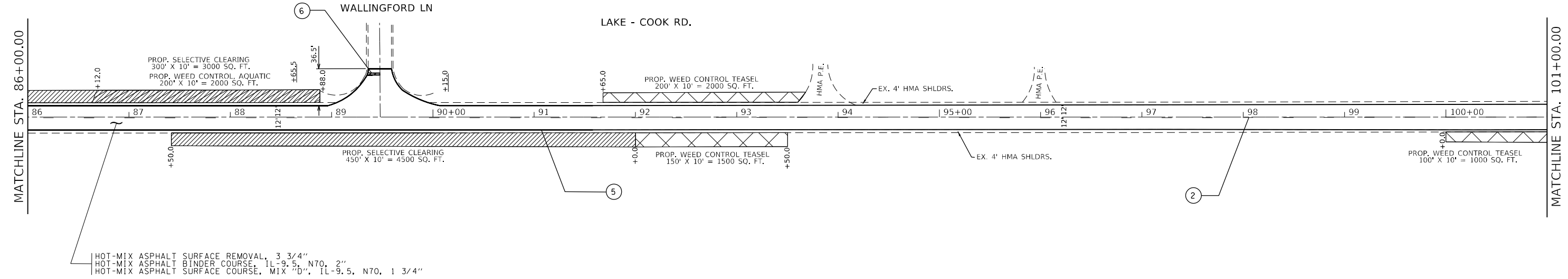
F.A.U. RTE.	SECTION	COUNTY	TOTAL SHEETS	SHEET NO.
1270	2020-157-R5&SW	COOK & LAKE	21	7
CONTRACT NO. 62M45				
ILLINOIS FED. AID PROJECT				



**LEGEND**

	PROP. SELECTIVE CLEARING
	PROP. WEED CONTROL, TEASEL
	PROP. WEED CONTROL, AQUATIC

- |   |  |   |   |
|---|--|---|---|
| ① | PROP. THERMOPLASTIC PVMT MARKING 4", 10' DASH 30' SKIP, WHITE (TYP.)     | ⑤ | PROP. THERMOPLASTIC PVMT MARKING 4", SHOULDER LANE, WHITE (TYP.)                      |
| ② | PROP. THERMOPLASTIC PVMT MARKING 4", 10' DASH 30' SKIP, YELLOW (TYP.)    | ⑥ | PROP. THERMOPLASTIC PVMT MARKING LINE, 24" STOPBAR, WHITE (TYP.)                      |
| ③ | PROP. THERMOPLASTIC PVMT MARKING 4", DOUBLE YELLOW @ 11" C-C (TYP.)      | ⑦ | PROP. THERMOPLASTIC PVMT MARKING 4", NO PASSING ZONE FOR ONE DIRECTION, YELLOW (TYP.) |
| ④ | PROP. THERMOPLASTIC PVMT MARKING 12" MEDIAN @ 45, 75' C-C, YELLOW (TYP.) |   |   |



NOTE:  
1. IF A DEAD/HAZARDOUS TREE IS FOUND IN THE SELECTIVE CLEARING AREAS THAT IS LARGER THAN 6", USE PAY ITEM: TREE REMOVAL (6 TO 15 UNITS).

MODEL: Default  
FILE NAME: p:\projects\2022\157620\CADD\Drawings\157620-Sub-1-Plan.dwg  
PROJECT: 157620\CADD\Drawings\157620-Sub-1-Plan.dwg

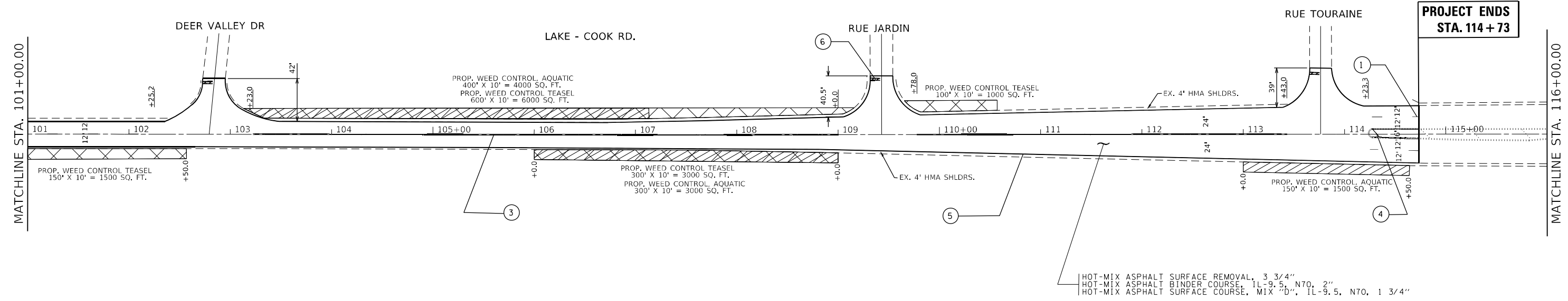
USER NAME = shahda	DESIGNED -	REVISED -
	DRAWN -	REVISED -
PLOT SCALE = 100,0000' / in.	CHECKED -	REVISED -
PLOT DATE = 1/21/2022	DATE -	REVISED -

**STATE OF ILLINOIS  
DEPARTMENT OF TRANSPORTATION**

**ROADWAY PLAN LAKE-COOK RD.  
(ELA RD. TO RUE TOURAINE)**

SCALE: 1"=50'    SHEET 3 OF 4 SHEETS    STA. 71+00.00 TO STA. 101+00.00

F.A.U. RTE.	SECTION	COUNTY	TOTAL SHEETS	SHEET NO.
1270	2020-157-R5&SW	COOK & LAKE	21	8
CONTRACT NO. 62M45				
ILLINOIS FED. AID PROJECT				



HOT-MIX ASPHALT SURFACE REMOVAL, 3 3/4"  
 HOT-MIX ASPHALT BINDER COURSE, 1L-9.5, N70, 2"  
 HOT-MIX ASPHALT SURFACE COURSE, MIX "D", 1L-9.5, N70, 1 3/4"

NOTE:  
 1. IF A DEAD/HAZARDOUS TREE IS FOUND IN THE SELECTIVE CLEARING AREAS THAT IS LARGER THAN 6", USE PAY ITEM: TREE REMOVAL (6 TO 15 UNITS).

LEGEND	
	PROP. SELECTIVE CLEARING
	PROP. WEED CONTROL, TEASEL
	PROP. WEED CONTROL, AQUATIC

①	PROP. THERMOPLASTIC PVMT MARKING 4", 10' DASH 30' SKIP, WHITE (TYP.)	⑤	PROP. THERMOPLASTIC PVMT MARKING 4", SHOULDER LANE, WHITE (TYP.)
②	PROP. THERMOPLASTIC PVMT MARKING 4", 10' DASH 30' SKIP, YELLOW (TYP.)	⑥	PROP. THERMOPLASTIC PVMT MARKING LINE, 24" STOPBAR, WHITE (TYP.)
③	PROP. THERMOPLASTIC PVMT MARKING 4", DOUBLE YELLOW @ 11" C-C (TYP.)	⑦	PROP. THERMOPLASTIC PVMT MARKING 4", NO PASSING ZONE FOR ONE DIRECTION, YELLOW (TYP.)
④	PROP. THERMOPLASTIC PVMT MARKING 12" MEDIAN @ 45, 75' C-C, YELLOW (TYP.)		

MODEL: Default  
 FILE NAME: p:\projects\157620\CADD\data\Design\157620-shr-1a.dwg  
 PROJECT: 157620\CADD\data\Design\157620-shr-1a.dwg

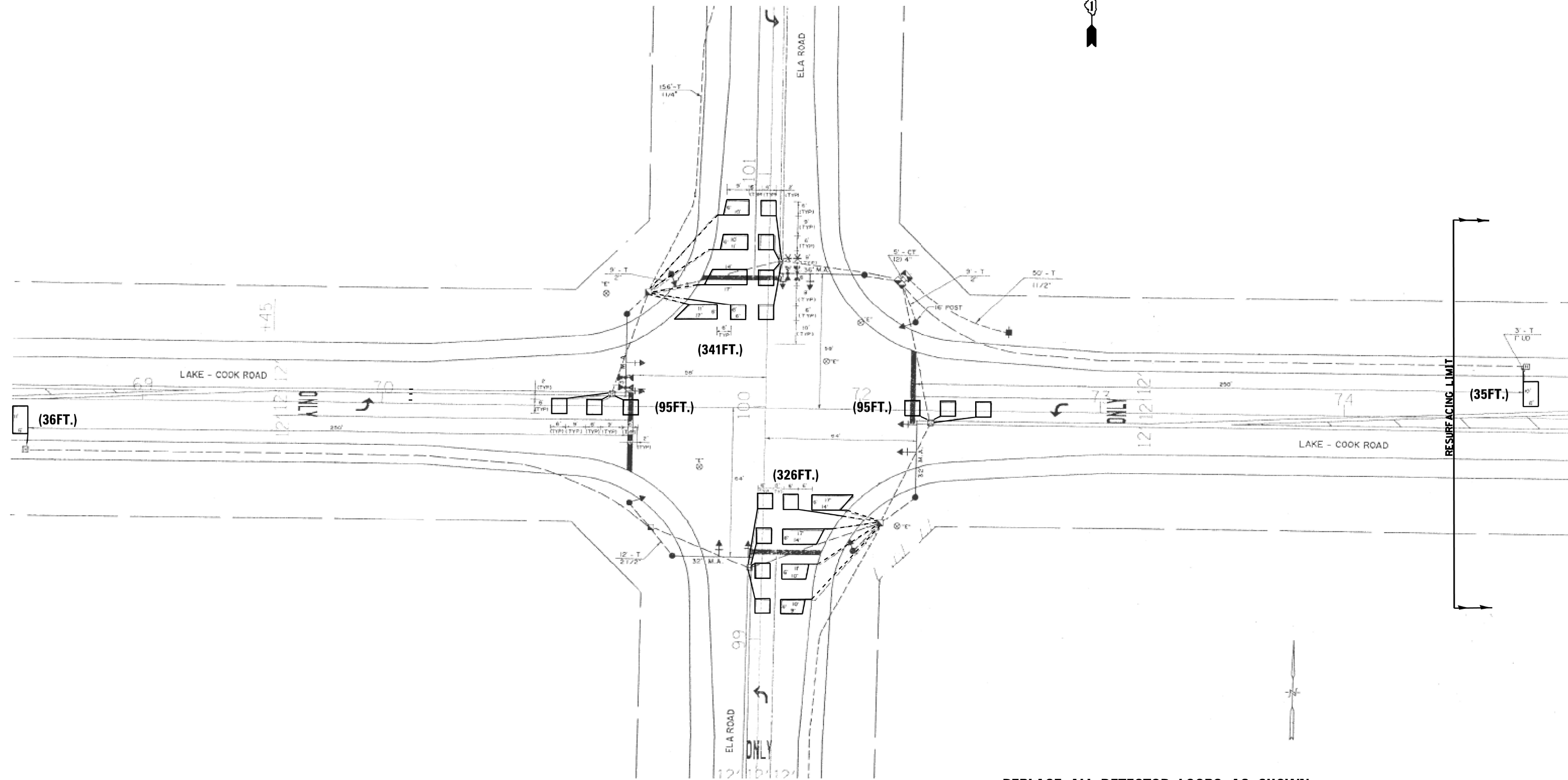
USER NAME = shahda	DESIGNED -	REVISED -
	DRAWN -	REVISED -
PLOT SCALE = 100,0000' / in.	CHECKED -	REVISED -
PLOT DATE = 1/21/2022	DATE -	REVISED -

**STATE OF ILLINOIS  
 DEPARTMENT OF TRANSPORTATION**

**ROADWAY PLAN LAKE-COOK RD.  
 (ELA RD. TO RUE TOURAINE)**

SCALE: 1"=50' SHEET 4 OF 4 SHEETS STA. 101+00.00 TO STA. 116+00.00

F.A.U. RTE.	SECTION	COUNTY	TOTAL SHEETS	SHEET NO.
1270	2020-157-R5&SW	COOK & LAKE	21	9
CONTRACT NO. 62M45				
ILLINOIS FED. AID PROJECT				



**REPLACE ALL DETECTOR LOOPS AS SHOWN  
(WITHIN THE RESURFACING LIMITS)**

**NOTES:**

1. WORK SHALL MEET THE REQUIREMENTS OF THE SPECIAL PROVISION, "DETECTOR LOOP REPLACEMENT AND/OR INSTALLATION (ROADWAY GRINDING, RESURFACING & PATCHING OPERATIONS).
2. THIS PLAN IS FOR THE SOLE PURPOSE OF DETECTOR LOOP REPLACEMENT.

CODE	ITEM	QUANTITY	UNIT
88600600	DETECTOR LOOP REPLACEMENT	35	FOOT

**TS#21210**

**STATE OF ILLINOIS  
DEPARTMENT OF TRANSPORTATION**

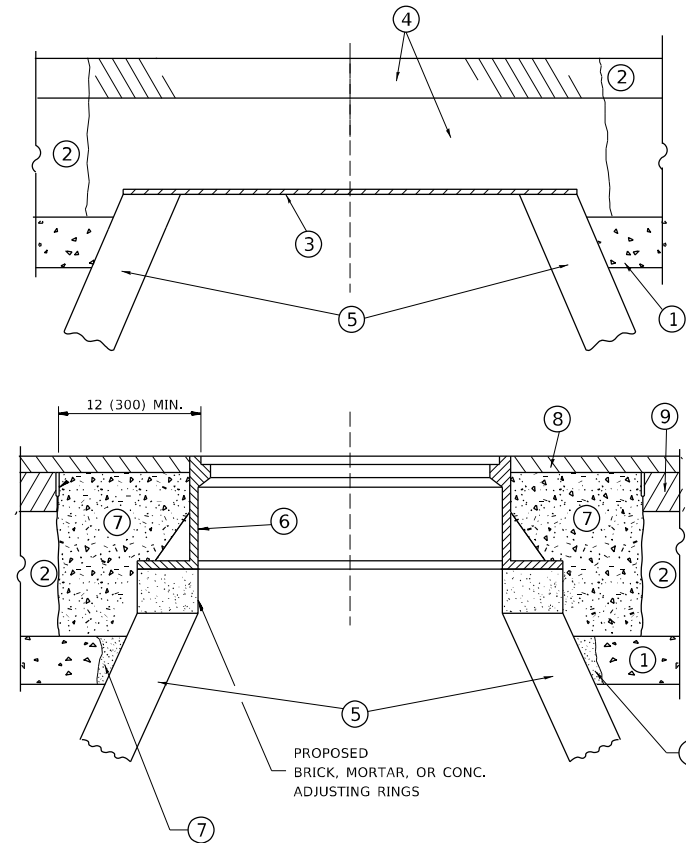
**LAKE-COOK ROAD (ELA RD TO RUE TOURAINE)  
DETECTOR LOOP REPLACEMENT PLAN**

F.A.U. RTE.	SECTION	COUNTY	TOTAL SHEETS	SHEET NO.
1270	2020-157-R5&SW	COOK & LAKE	21	10
CONTRACT NO. 62M45				

SCALE: SHEET OF SHEETS STA. TO STA.

ILLINOIS FED. AID PROJECT

MODEL: Default  
 FILE: Main.dwg  
 PLOT: 12/15/2021 10:00:00 AM  
 PLOT SCALE: 1/8" = 1'-0"  
 PLOT DATE: 12/15/2021



**CONSTRUCTION PROCEDURES**

**STAGE 1 (BEFORE PAVEMENT MILLING)**

- A) REMOVE A MINIMUM OF 12 (300) OF THE PAVEMENT FROM AROUND THE STRUCTURE.
- B) REMOVE THE EXISTING FRAME AND LID FROM THE STRUCTURE.
- C) COVER THE STRUCTURE OPENING WITH A 36 (900) DIAMETER METAL PLATE.
- D) BACKFILL WITH CRUSHED STONE AND A MINIMUM 1½ (40) THICK HMA SURFACE MIX APPROVED BY THE ENGINEER.

**STAGE 2 (AFTER PAVEMENT MILLING)**

- A) REMOVE THE HMA SURFACE MIX AND CRUSHED STONE.
- B) INSTALL THE FRAME AND LID; ADJUST THE FRAME TO ITS FINAL SURFACE ELEVATION.
- C) THE SURROUNDING SPACE SHALL BE FILLED WITH CLASS PP-1 \* CONCRETE TO THE ELEVATION OF THE SURFACE OF THE EXISTING BASE COURSE OR THE BINDER COURSE.

\* UNLESS OTHERWISE SPECIFIED IN THE PLANS.

THE PROCEDURE EXPLAINED ABOVE SHALL CONFORM TO THE APPLICABLE PORTIONS OF SECTIONS 353, 406, 602, AND 603 OF THE STANDARD SPECIFICATIONS EXCEPT THAT "THE CONTRACTOR SHALL ADJUST THE STRUCTURES TO THE FINISHED PAVEMENT ELEVATION NO MORE THAN 5 CALENDAR DAYS PRIOR TO PLACEMENT OF THE FINAL LIFT OF SURFACE UNLESS APPROVED BY THE ENGINEER."

**LEGEND**

- ① SUB-BASE GRANULAR MATERIAL
- ② EXISTING PAVEMENT
- ③ 36 (900) DIAMETER METAL PLATE
- ④ PROPOSED CRUSHED STONE AND HMA SURFACE MIX
- ⑤ EXISTING STRUCTURE
- ⑥ FRAME AND LID (SEE NOTES)
- ⑦ CLASS PP-1 \*CONCRETE
- ⑧ PROPOSED HMA SURFACE COURSE
- ⑨ PROPOSED HMA BINDER COURSE

**LOCATION OF STRUCTURES**

THE CONTRACTOR WILL BE REQUIRED TO KEEP A RECORD OF THE LOCATIONS OF THE BURIED STRUCTURES ACCORDING TO THE STATION AND DISTANCE LEFT OR RIGHT OF THE CENTERLINE OF PAVEMENT. UPON COMPLETION OF THE WORK, THE CONTRACTOR WILL DELIVER THE RECORD TO THE ENGINEER.

**BASIS OF PAYMENT**

REMOVING FRAMES AND LIDS ON DRAINAGE AND UTILITY STRUCTURES IN THE PAVEMENT PRIOR TO MILLING, AND ADJUSTING TO FINAL GRADE PRIOR TO PLACING THE SURFACE COURSE, WILL BE PAID FOR AT THE CONTRACT UNIT PRICE EACH FOR "FRAMES AND LIDS TO BE ADJUSTED (SPECIAL)."

THIS WORK WILL NOT BE PAID FOR WHEN DRAINAGE AND UTILITY STRUCTURES ARE SPECIFIED FOR PAYMENT AS STRUCTURE RECONSTRUCTION.

NEW FRAMES AND LIDS, WHEN SPECIFIED, WILL BE PAID FOR SEPARATELY.

**NOTES**

EXISTING BROKEN FRAMES AND LIDS SHALL BE REMOVED AND DISPOSED OF BY THE CONTRACTOR AND SHALL BE REPLACED AS DIRECTED BY THE ENGINEER. REPLACEMENT FRAMES AND LIDS WILL BE PAID FOR IN ACCORDANCE WITH ARTICLE 109.04 OF THE STANDARD SPECIFICATIONS UNLESS A SEPARATE PAY ITEM HAS BEEN PROVIDED.

IF THE EXISTING LIDS ARE OPEN, THE FRAME WILL BE ADJUSTED TO THE ELEVATION OF THE MILLED PAVEMENT SURFACE PRIOR TO THE MILLING OPERATION. THE FRAME WILL NOT BE REMOVED AND COVERED BY THE METAL PLATE.

CITY OF CHICAGO CASTINGS ARE THE PROPERTY OF THE CITY AND THE CONTRACTOR SHALL NOTIFY THE CITY FOR REMOVAL AND DISPOSITION OF THE CASTINGS.

THE METAL PLATE USED TO COVER THE STRUCTURE SHALL REMAIN THE PROPERTY OF THE CONTRACTOR.

WHEN STRUCTURES ARE TO BE ADJUSTED OR RECONSTRUCTED, THE LOWERING AND RAISING OF THE FRAMES AND LIDS WILL NOT BE PAID FOR SEPARATELY BUT WILL BE INCLUDED IN THE COST OF THE CORRESPONDING PAY ITEM.

**DETAILS FOR FRAMES AND LIDS ADJUSTMENT WITH MILLING**

ALL DIMENSIONS ARE IN INCHES (MILLIMETERS) UNLESS OTHERWISE SHOWN

MODEL: Default  
FILE NAME: p:\ultra\paw\_bentley.com\PIV\DOT\Documents\DOT\_offices\Dir\drt. I:\projects\157620\CADD\data\Design\Bd603.dgn

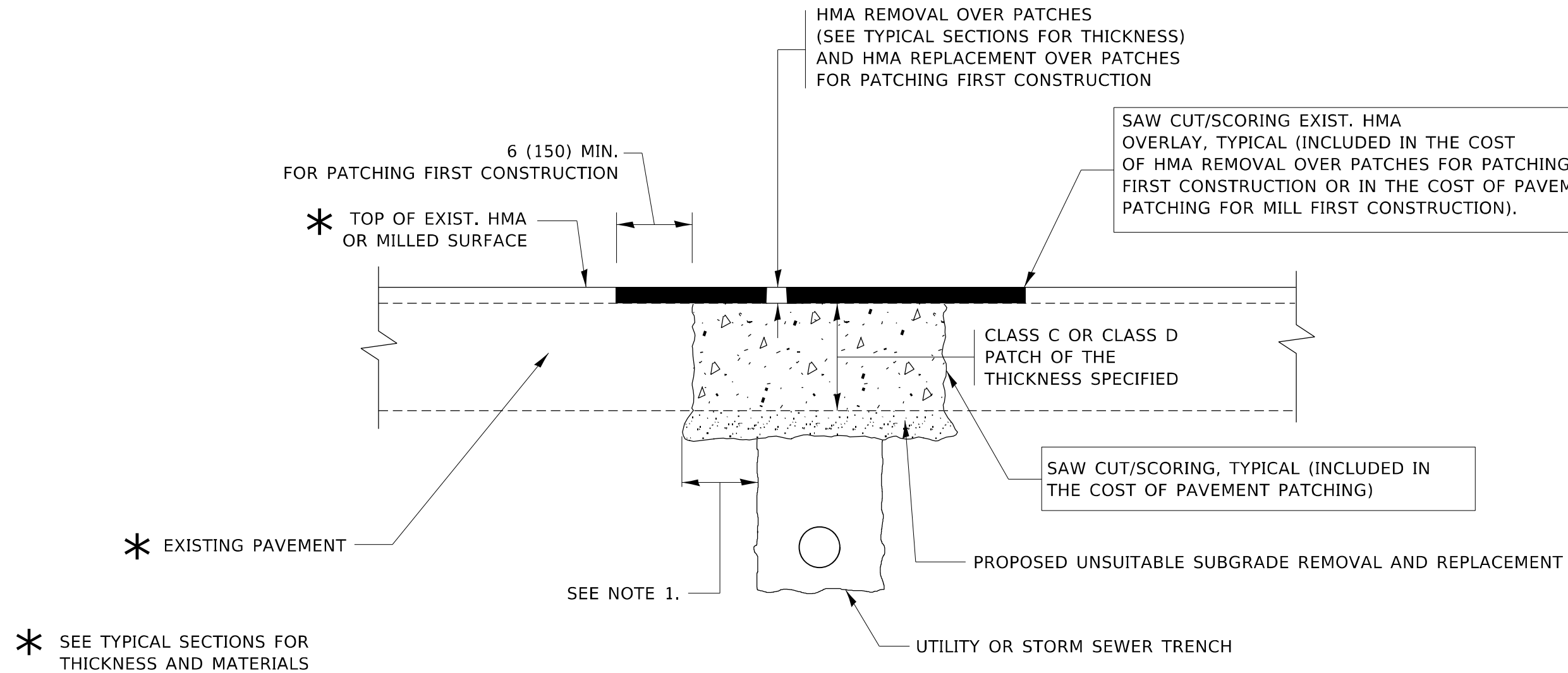
USER NAME = shahda	DESIGNED - R. SHAH	REVISED - R. WEDEMAN 05-14-04
	DRAWN -	REVISED - R. BORO 01-01-07
PLOT SCALE = 100,0000' / in.	CHECKED -	REVISED - R. BORO 03-09-11
PLOT DATE = 12/15/2021	DATE - 10-25-94	REVISED - R. BORO 12-06-11

STATE OF ILLINOIS  
DEPARTMENT OF TRANSPORTATION

DETAILS FOR  
FRAMES AND LIDS ADJUSTMENT WITH MILLING

SCALE: NONE SHEET 1 OF 1 SHEETS STA. TO STA.

F.A.U. RTE.	SECTION	COUNTY	TOTAL SHEETS	SHEET NO.
1270	2020-157-R5&SW	COOK & LAKE	21	11
BD600-03 (BD-8)			CONTRACT NO. 62M45	
ILLINOIS FED. AID PROJECT				



**NOTES:**

1. THE WIDTH OF THE FULL DEPTH PATCH OVER A TRENCH SHALL BE 12 (300) WIDER ON EACH SIDE OF THE TRENCH.
2. FOR METHOD OF MEASUREMENT AND BASIS OF PAYMENT, SEE RECURRING SPECIAL PROVISION "PATCHING WITH HOT-MIX ASPHALT OVERLAY REMOVAL".

**SEQUENCE OF CONSTRUCTION (PATCHING FIRST)**

1. REMOVE THE EXISTING HMA MATERIAL OVER THE AREA TO BE PATCHED.
2. REMOVE AND REPLACE WITH CLASS C OR D PATCH.
3. REPLACE HMA MATERIAL OVER THE AREA TO BE PATCHED.

**SEQUENCE OF CONSTRUCTION (MILLING FIRST)**

1. MILL HMA FIRST IF THERE IS AT LEAST 4½ INCHES OR MORE OF HMA MATERIAL ON TOP OF THE EXISTING PAVEMENT OR IF THE PAVEMENT IS FULL DEPTH HMA. A MINIMUM OF 2 INCHES OF HMA MATERIAL SHALL BE IN PLACE AFTER MILLING.
2. REMOVE AND REPLACE WITH FULL DEPTH CLASS D PATCHES TO TOP OF MILLED SURFACE.

ALL DIMENSIONS ARE IN INCHES (MILLIMETERS) UNLESS OTHERWISE SHOWN.

MODEL: Default  
FILE: hma157620.ctb  
PROJECT: I:\Projects\157620\CADD\DATA\Design\Bd400.dgn

USER NAME = shahda	DESIGNED - R. SHAH	REVISED - A. ABBAS 04-27-98
	DRAWN -	REVISED - R. BORO 01-01-07
PLOT SCALE = 100,0000' / in.	CHECKED -	REVISED - R. BORO 09-04-07
PLOT DATE = 12/15/2021	DATE - 10-25-94	REVISED - K. ENG 10-27-08

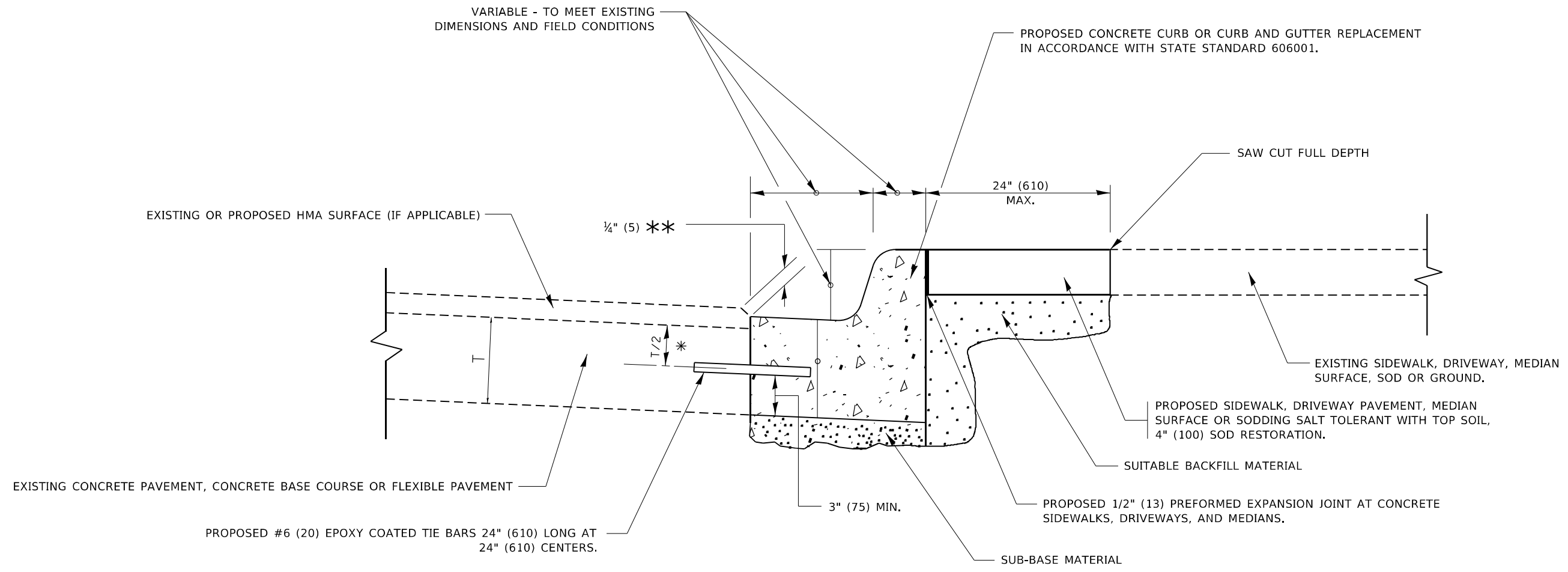
**STATE OF ILLINOIS  
DEPARTMENT OF TRANSPORTATION**

**PAVEMENT PATCHING FOR  
HMA SURFACED PAVEMENT**

SCALE: NONE SHEET 1 OF 1 SHEETS STA. TO STA.

F.A.U. RTE.	SECTION	COUNTY	TOTAL SHEETS	SHEET NO.
1270	2020-157-R5&SW	COOK & LAKE	21	12
<b>BD400-04 (BD-22)</b>			CONTRACT NO. 62M45	
ILLINOIS FED. AID PROJECT				





- \* 3" (75) MINIMUM FROM TOP AND BOTTOM OF THE CONCRETE PAVEMENT OR BASE COURSE.
- \*\* IF THE FINAL SURFACE OF THE PAVEMENT IS CONCRETE, THE GUTTER IS TO BE FLUSH WITH THE PAVEMENT.

# CURB OR CURB AND GUTTER REMOVAL AND REPLACEMENT

ALL DIMENSIONS ARE IN INCHES (MILLIMETERS) UNLESS OTHERWISE SHOWN.

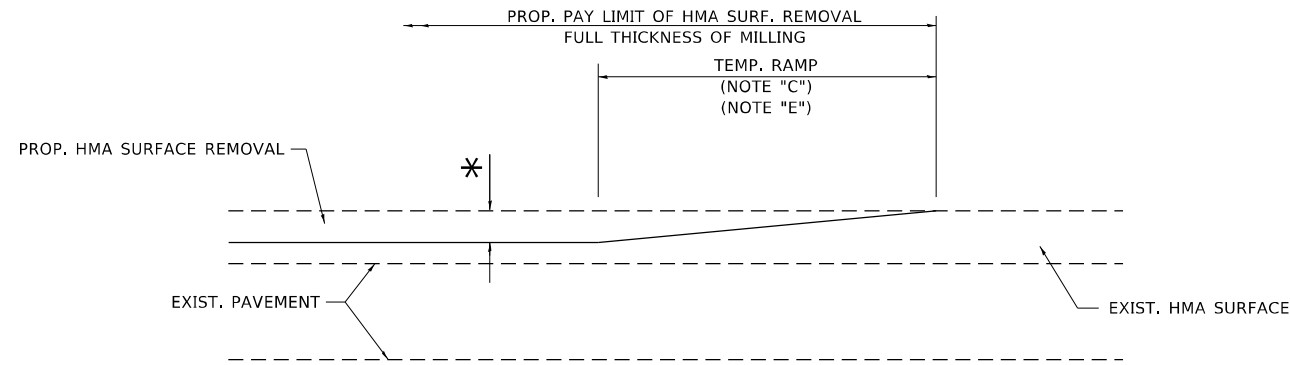
MODEL: Default FILE: \\blm\p\project\paw\benefy.com\PIV\DOT\Documents\DOT Office\Dir\drt. \\project\ID157620\CADD\data\Design\BdR5.dgn

USER NAME = shahda	DESIGNED - A. HOUSEH	REVISED - A. ABBAS 03-21-97
	DRAWN -	REVISED - M. GOMEZ 01-22-01
PLOT SCALE = 100,0000 ' / in.	CHECKED -	REVISED - R. BORO 12-15-09
PLOT DATE = 12/15/2021	DATE - 03-11-94	REVISED - K. SMITH 07-11-19

**STATE OF ILLINOIS  
DEPARTMENT OF TRANSPORTATION**

<b>CURB OR CURB AND GUTTER REMOVAL AND REPLACEMENT</b>			
SCALE: NONE	SHEET 1	OF 1 SHEETS	STA. TO STA.

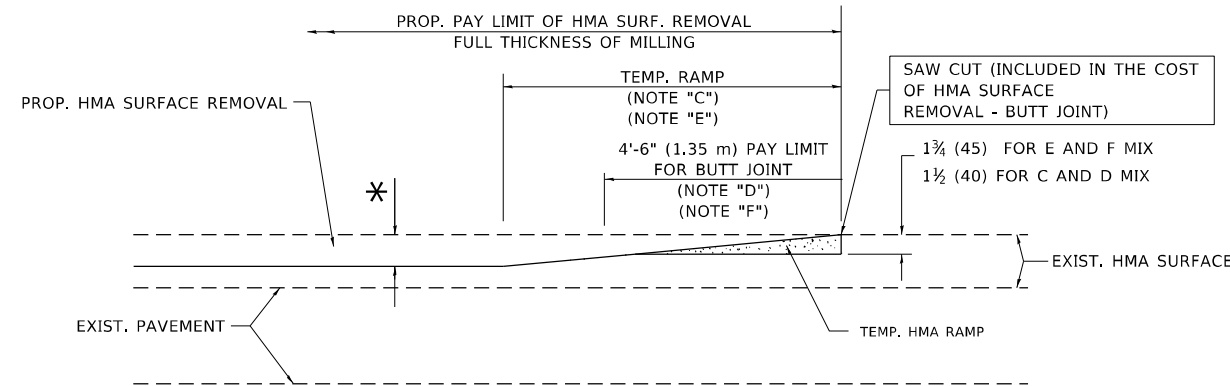
F.A.U. RTE.	SECTION	COUNTY	TOTAL SHEETS	SHEET NO.
1270	2020-157-R5&SW	COOK & LAKE	21	13
<b>BD600-06 (BD-24)</b>			CONTRACT NO. 62M45	
ILLINOIS FED. AID PROJECT				



**MILLED TEMPORARY RAMP**

(FOR BUTT JOINT AND HMA TAPER SEE DETAIL BELOW)

**OPTION 1**

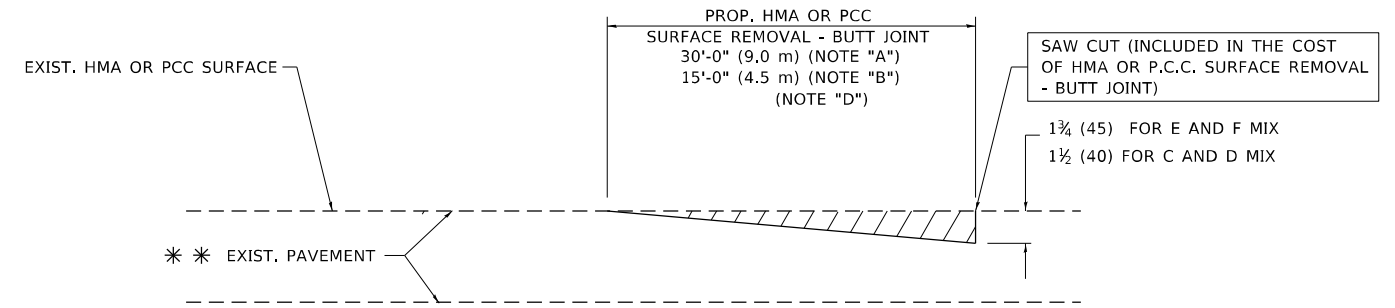


**HMA CONSTRUCTED TEMPORARY RAMP**

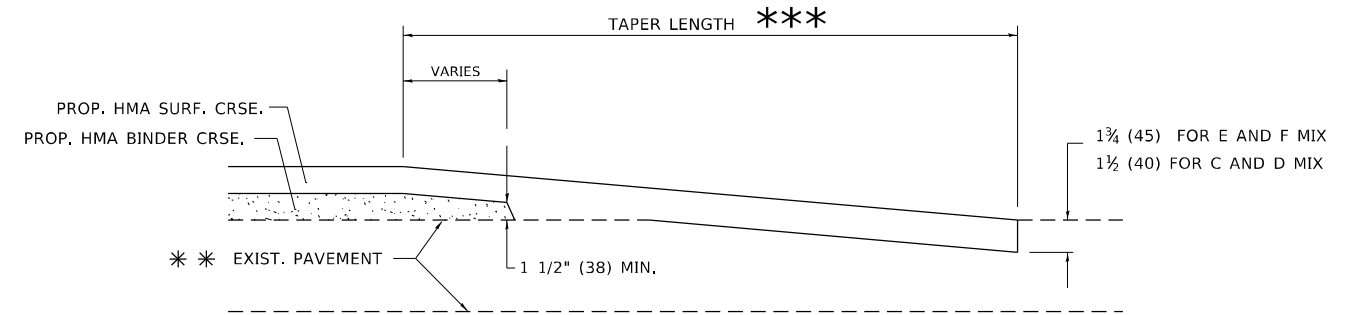
(FOR BUTT JOINT AND HMA TAPER SEE DETAIL BELOW)

**OPTION 2**

**TYPICAL TEMPORARY RAMP**



**BUTT JOINT DETAIL**



**HMA TAPER DETAIL**

**TYPICAL BUTT JOINT AND HMA TAPER FOR RESURFACING ONLY**

\*\*\* PC CONCRETE, HMA OR HMA RESURFACED PAVEMENT.

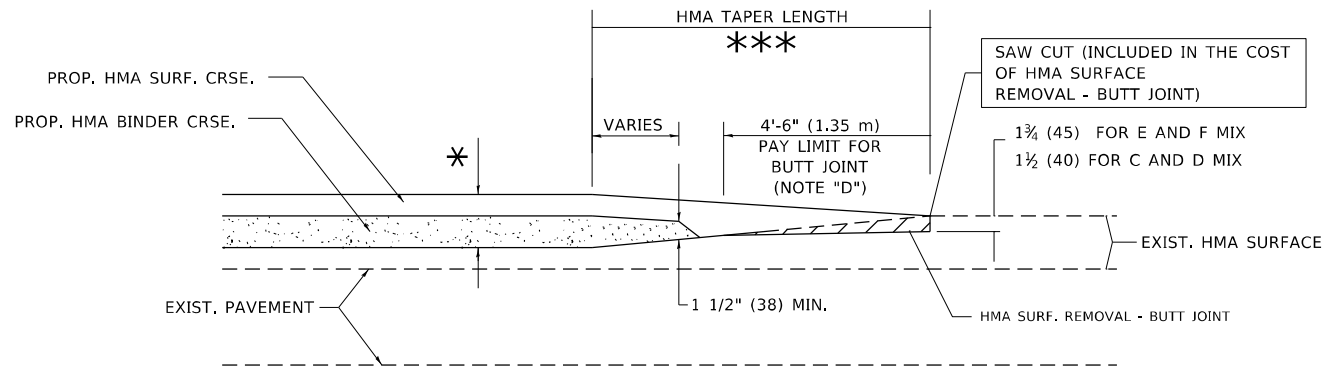
**NOTES**

- A. MAINLINE ROADWAYS AND MAJOR SIDE ROADS.
- B. MINOR SIDE ROADS.
- C. THE TEMP. RAMP SHALL BE CONSTRUCTED IMMEDIATELY UPON REMOVAL OF THE EXISTING HMA SURFACE.
- D. THE BUTT JOINT SHALL BE CONSTRUCTED IMMEDIATELY PRIOR TO PLACING THE PROPOSED HMA COURSES.
- E. TAPER THE TEMP. RAMP AT A RATE OF 3'-0" (900 mm) PER 1 INCH (25 mm) OF MILLING THICKNESS.
- F. INSTALLATION AND REMOVAL OF THE 4'-6" (1.35 m) TEMP. RAMP IS INCLUDED IN COST OF HMA SURFACE REMOVAL - BUTT JOINT.  
\* SEE TYPICAL SECTIONS FOR MILLING THICKNESS.
- G. SEE ARTICLE 406.08 AND 406.14 OF THE STANDARD SPECIFICATIONS FOR "HMA AND/OR PCC SURFACE REMOVAL, BUTT JOINT".  
\*\*\* 20'-0" (6.1 m) PER 1 (25) RESURFACING (NOTE "A")  
10'-0" (3.0 m) PER 1 (25) RESURFACING (NOTE "B")

**BASIS OF PAYMENT**

THE BUTT JOINT WILL BE PAID FOR AT THE CONTRACT UNIT PRICE PER SQUARE YARD (SQUARE METER) FOR "HOT-MIX ASPHALT SURFACE REMOVAL - BUTT JOINT" OR FOR "PORTLAND CEMENT CONCRETE SURFACE REMOVAL - BUTT JOINT".

ALL DIMENSIONS ARE IN INCHES (MILLIMETERS) UNLESS OTHERWISE SHOWN.



**BUTT JOINT AND HMA TAPER**

**TYPICAL BUTT JOINT AND HMA TAPER FOR MILLING AND RESURFACING**

MODEL: Default  
FILE: hmafe\_pav\_buttjoint.dwg  
PROJECT: I:\Projects\DOT\Office\Drawings\11\Project\1157620\CADD\data\Design\BtJtStd.dgn

USER NAME = shahda	DESIGNED - M. DE YONG	REVISED - R. SHAH 10-25-94
	DRAWN -	REVISED - A. ABBAS 03-21-97
PLOT SCALE = 100,0000' / in.	CHECKED -	REVISED - M. GOMEZ 04-06-01
PLOT DATE = 12/15/2021	DATE - 06-13-90	REVISED - R.BORO 01-01-07

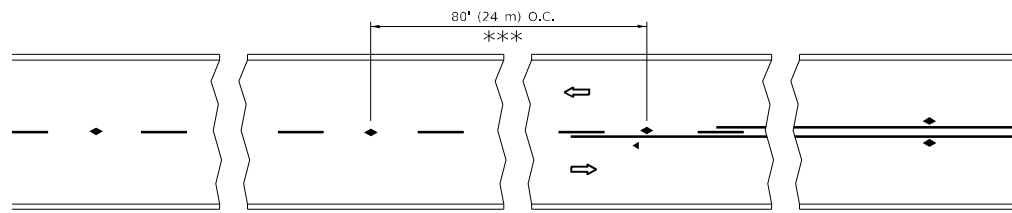
STATE OF ILLINOIS  
DEPARTMENT OF TRANSPORTATION

BUTT JOINT AND  
HMA TAPER DETAILS

SCALE: NONE SHEET 1 OF 1 SHEETS STA. TO STA.

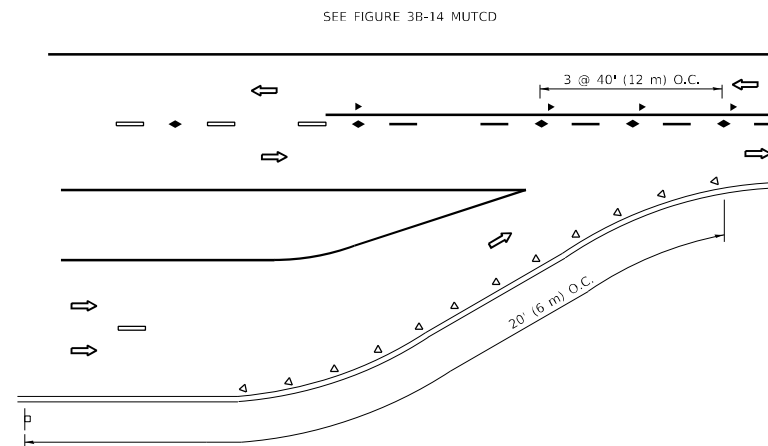
F.A.U. RTE.	SECTION	COUNTY	TOTAL SHEETS	SHEET NO.
1270	2020-157-R5&SW	COOK & LAKE	21	14
BD400-05 BD32		CONTRACT NO. 62M45		
ILLINOIS FED. AID PROJECT				



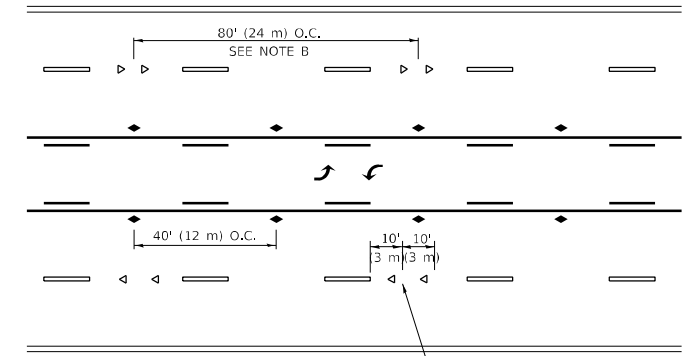


\*\*\* REDUCE TO 40' (12 m) O.C. ON CURVES WITH POSTED OR ADVISORY SPEED 45 M.P.H. (70 km/h) OR LESS.

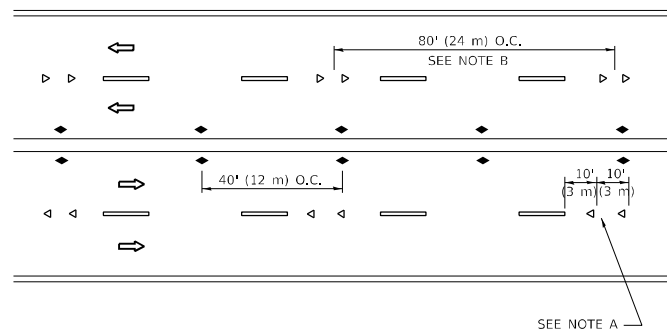
**TWO-LANE/TWO-WAY**



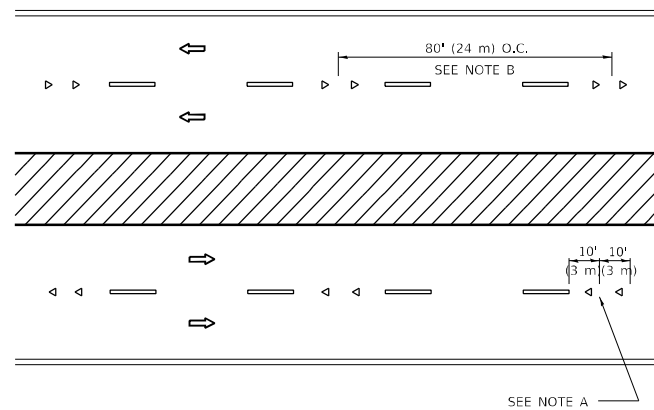
**LANE REDUCTION TRANSITION**



**TWO-WAY LEFT TURN**



**MULTI-LANE/UNDIVIDED**



**MULTI-LANE/DIVIDED**

**GENERAL NOTES**

1. MARKERS USED WITH DASHED LINES SHALL BE CENTERED IN THE GAP BETWEEN SEGMENTS.
2. MARKERS USED ADJACENT TO SOLID LINES SHALL BE OFFSET 2 TO 3 (50 TO 75) TOWARD TRAFFIC AS SHOWN.
3. MARKERS THROUGH TANGENTS LESS THAN 500' (150 m) IN LENGTH BETWEEN CURVES SHALL BE INSTALLED AT THE LESSER OF THE TWO CURVE SPACINGS.
4. MARKERS ARE TO BE USED ADJACENT TO BOTH SOLID WHITE LINES IN DUAL LEFT TURN LANES

**SYMBOLS**

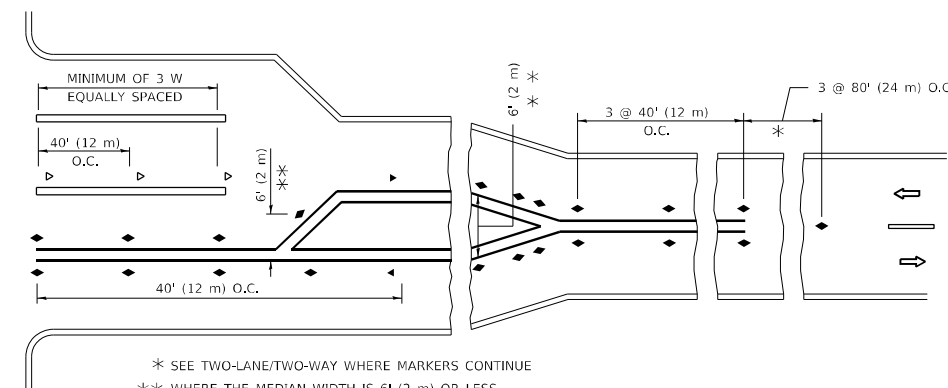
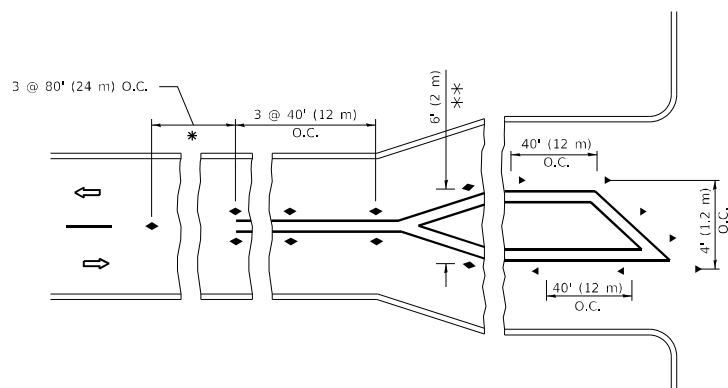
- YELLOW STRIPE
- WHITE STRIPE
- ◀ ONE-WAY AMBER MARKER
- ◀ ONE-WAY CRYSTAL MARKER (W/O)
- ◆ TWO-WAY AMBER MARKER

**LANE MARKER NOTES**

- A. USE DOUBLE LANE LINE MARKERS SPACED AS SHOWN.
- B. REDUCE TO 40' (12 m) O.C. ON CURVES WHERE ADVISORY SPEEDS ARE 10 M.P.H (20 km/h) LOWER THAN POSTED SPEEDS.

**DESIGN NOTES**

1. DOUBLE LANE LINE MARKERS SHALL BE USED UNLESS SPECIFIED OTHERWISE.
2. EXCEPT AS SHOWN ON THE LANE REDUCTION TRANSITION AND FREEWAY EXIT RAMP DETAIL, MARKERS ARE NOT TO BE SPECIFIED ON RIGHT EDGE LINES.
3. THE EXACT MARKER LIMITS, SPACING, AND COLOR SHALL BE INCLUDED IN THE PLANS WHEN STANDARD SPECIFICATIONS ARE NOT BEING USED.
4. MARKERS SHOULD NOT BE USED ALONGSIDE CURBS EXCEPT FOR EXTREMELY SHORT SECTIONS OF CURBS WHERE NOT MORE THAN TWO MARKERS WOULD BE INVOLVED.



\* SEE TWO-LANE/TWO-WAY WHERE MARKERS CONTINUE  
 \*\* WHERE THE MEDIAN WIDTH IS 6' (2 m) OR LESS USE TWO-WAY MARKERS.

**TURN LANES**

All dimensions are in inches (millimeters) unless otherwise shown.

MODEL: Default  
 FILE NAME: p:\projects\2021\1270\1270-CO-Data\Design\Drawings\Drawings.dgn

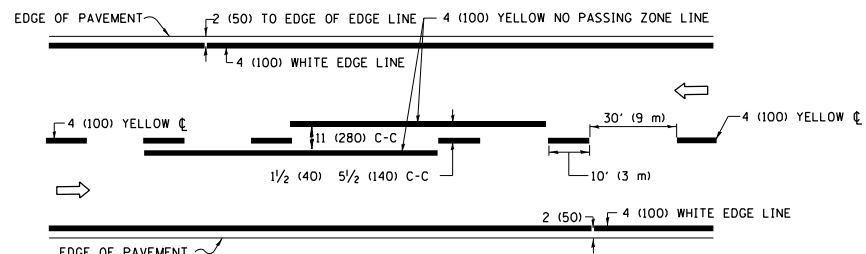
USER NAME = shahda	DESIGNED -	REVISED - T. RAMMACHER 03-12-99
PLOT SCALE = 100,0000' / in.	DRAWN -	REVISED - T. RAMMACHER 01-06-00
PLOT DATE = 12/15/2021	CHECKED -	REVISED - C. JUCIUS 09-09-09
	DATE -	REVISED - C. JUCIUS 07-01-13

**STATE OF ILLINOIS  
 DEPARTMENT OF TRANSPORTATION**

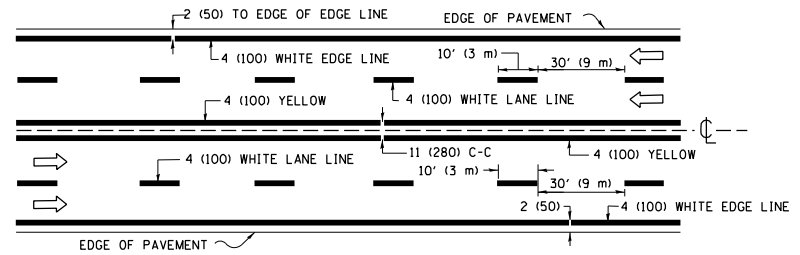
**TYPICAL APPLICATIONS  
 RAISED REFLECTIVE PAVEMENT MARKERS (SNOW-PLOW RESISTANT)**

SCALE: NONE SHEET 1 OF 1 SHEETS STA. TO STA.

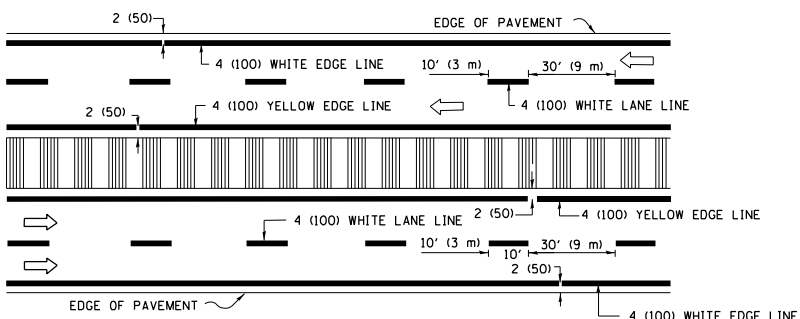
F.A.U. RTE.	SECTION	COUNTY	TOTAL SHEETS	SHEET NO.
1270	2020-157-R5&SW	COOK & LAKE	21	16
TC-11			CONTRACT NO. 62M45	
ILLINOIS FED. AID PROJECT				



**2-LANE ROADWAY**

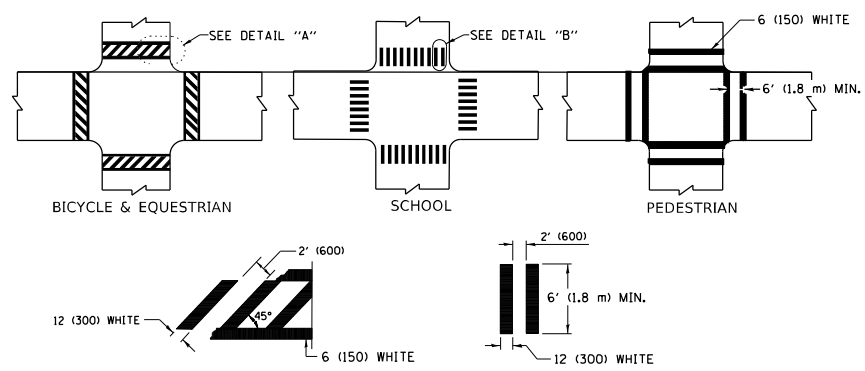


**MULTI-LANE UNDIVIDED**



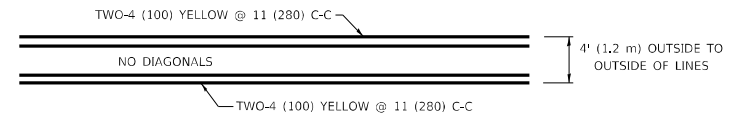
**MULTI-LANE DIVIDED WITH MEDIAN**

**TYPICAL LANE AND EDGE LINE MARKING**

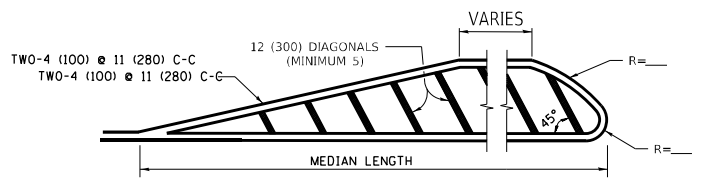


**TYPICAL CROSSWALK MARKING**

\* MARKINGS SHALL BE INSTALLED PARALLEL TO THE CENTERLINE OF THE ROAD WHICH IT CROSSES



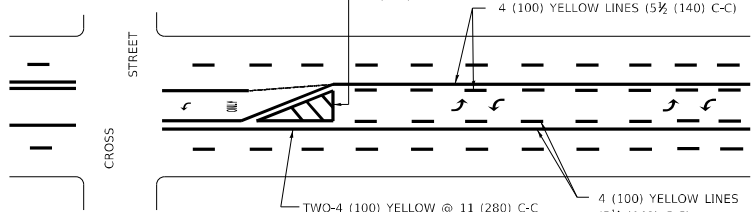
**4' (1.2 m) WIDE MEDIANS ONLY**



**MEDIANS OVER 4' (1.2 m) WIDE**

FOR MEDIAN LENGTHS WHERE DIAGONAL SPACING CANNOT BE ATTAINED, USE 5 (FIVE) EQUALLY SPACED DIAGONAL LINES.

DIAGONAL LINE SPACING: 50' (15 m) C-C (LESS THAN 30MPH (50 km/h))  
75' (25 m) C-C 30MPH (50 km/h) TO 45MPH (70 km/h)  
150' (45 m) C-C (MORE THAN 45MPH (70 km/h))



**MEDIAN WITH TWO-WAY LEFT TURN LANE**

**TYPICAL PAINTED MEDIAN MARKING**

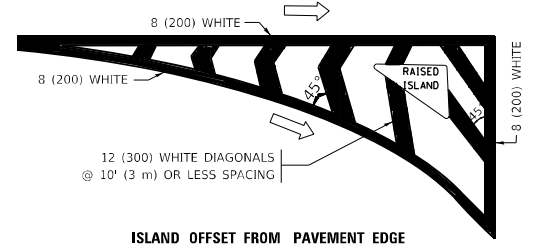
A MINIMUM OF TWO PAIRS OF TURN ARROWS SHALL BE USED, WHITE IN COLOR. ADDITIONAL PAIRS SHALL BE PLACED AT 200' (60 m) TO 300' (90 m) INTERVALS.

FULL SIZE LETTERS 8' (2.4 m) AND ARROWS SHALL BE USED.  
AREA = 15.6 SQ. FT. (1.5 m<sup>2</sup>) ONLY AREA = 20.8 SQ. FT. (1.9 m<sup>2</sup>)

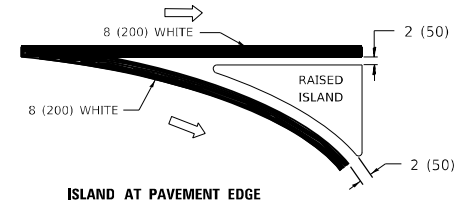
\* TURN LANES IN EXCESS OF 400' (120 m) IN LENGTH MAY HAVE AN ADDITIONAL SET OF ARROW - "ONLY" INSTALLED MIDWAY BETWEEN THE OTHER TWO SETS OF ARROW - "ONLY".

**TYPICAL LEFT (OR RIGHT) TURN LANE**

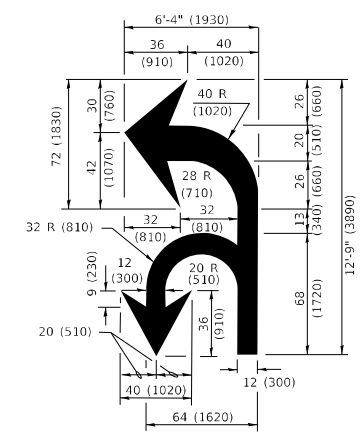
**TYPICAL TURN LANE MARKING**



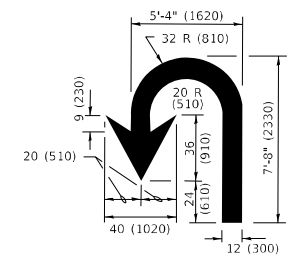
**ISLAND OFFSET FROM PAVEMENT EDGE**



**TYPICAL ISLAND MARKING**



**COMBINATION LEFT AND U-TURN**



**U-TURN**

**LANE REDUCTION TRANSITION**

\* LANE REDUCTION ARROWS REQUIRED AT SPEEDS OF 45 MPH OR GREATER OR WHEN SPECIFIED IN PLANS.

D(FT)	SPEED LIMIT
345	30
425	35
500	40
580	45
665	50
750	55

TYPE OF MARKING	WIDTH OF LINE	PATTERN	COLOR	SPACING / REMARKS
CENTERLINE ON 2 LANE PAVEMENT	4 (100)	SKIP-DASH	YELLOW	10' (3 m) LINE WITH 30' (9 m) SPACE
CENTERLINE ON MULTI-LANE UNDIVIDED PAVEMENT	2 @ 4 (100)	SOLID	YELLOW	11 (280) C-C
NO PASSING ZONE LINES: FOR ONE DIRECTION FOR BOTH DIRECTIONS	4 (100) 2 @ 4 (100)	SOLID SOLID	YELLOW YELLOW	5/2 (140) C-C FROM SKIP-DASH CENTERLINE 11 (280) C-C OMIT SKIP-DASH CENTERLINE BETWEEN
LANE LINES	4 (100) 5 (125) ON FREEWAYS	SKIP-DASH SKIP-DASH	WHITE WHITE	10' (3 m) LINE WITH 30' (9 m) SPACE
DOTTED LINES (EXTENSIONS OF CENTER, LANE OR TURN LANE MARKINGS)	SAME AS LINE BEING EXTENDED	SKIP-DASH	SAME AS LINE BEING EXTENDED	2' (600) LINE WITH 6' (1.8 m) SPACE
EDGE LINES	4 (100)	SOLID	YELLOW-LEFT WHITE-RIGHT	OUTLINE MEDIANS IN YELLOW
TURN LANE MARKINGS	6 (150) LINE; FULL SIZE LETTERS & SYMBOLS (8' (2.4m))	SOLID	WHITE	SEE TYPICAL TURN LANE MARKING DETAIL
TWO WAY LEFT TURN MARKING	2 @ 4 (100) EACH DIRECTION 8' (2.4m) LEFT ARROW	SKIP-DASH AND SOLID IN PAIRS	YELLOW WHITE	10' (3 m) LINE WITH 30' (9 m) SPACE FOR SKIP-DASH; 5/2 (140) C-C BETWEEN SOLID LINE AND SKIP-DASH LINE SEE TYPICAL TWO-WAY LEFT TURN MARKING DETAIL
CROSSWALK LINES (PEDESTRIAN) A. DIAGONALS (BIKE & EQUESTRIAN) B. LONGITUDINAL BARS (SCHOOL)	2 @ 6 (150) 12 (300) @ 45° 12 (300) @ 90°	SOLID SOLID SOLID	WHITE WHITE WHITE	NOT LESS THAN 6' (1.8 m) APART 2' (600) APART 2' (600) APART SEE TYPICAL CROSSWALK MARKING DETAILS.
STOP LINES	24 (600)	SOLID	WHITE	PLACE 4' (1.2 m) IN ADVANCE OF AND PARALLEL TO CROSSWALK, IF PRESENT. OTHERWISE, PLACE AT DESIRED STOPPING POINT, PARALLEL TO CROSSROAD CENTERLINE, WHERE POSSIBLE
PAINTED MEDIANS	2 @ 4 (100) WITH 12 (300) DIAGONALS @ 45° NO DIAGONALS USED FOR 4' (1.2 m) WIDE MEDIANS	SOLID	YELLOW: TWO WAY TRAFFIC WHITE: ONE WAY TRAFFIC	11 (280) C-C FOR THE DOUBLE LINE SEE TYPICAL PAINTED MEDIAN MARKING.
GORE MARKING AND CHANNELIZING LINES	8 (200) WITH 12 (300) DIAGONALS @ 45°	SOLID	WHITE	DIAGONALS: 15' (4.5 m) C-C (LESS THAN 30MPH (50 km/h)) 20' (6 m) C-C 30MPH (50 km/h) TO 45MPH (70 km/h) 30' (9 m) C-C (OVER 45MPH (70 km/h))
RAILROAD CROSSING	24 (600) TRANSVERSE LINES: "RR" IS 6' (1.8 m) LETTERS; 16 (400) LINE FOR "X"	SOLID	WHITE	SEE STATE STANDARD 780001 AREA OF: "R"=3.6 SQ. FT. (0.33 m <sup>2</sup> ) EACH "X"=54.0 SQ. FT. (5.0 m <sup>2</sup> )
SHOULDER DIAGONALS (REQUIRED FOR SHOULDERS ≥ 8')	12 (300) @ 45°	SOLID	WHITE - RIGHT YELLOW - LEFT	50' (15 m) C-C (LESS THAN 30MPH (50 km/h)) 75' (25 m) C-C 30 MPH (50 km/h) TO 45MPH (70 km/h) 150' (45 m) C-C (OVER 45MPH (70 km/h))
U TURN ARROW	SEE DETAIL	SOLID	WHITE	16.3 SF
2 ARROW COMBINATION LEFT AND U TURN	SEE DETAIL	SOLID	WHITE	30.4 SF

FOR FURTHER DETAILS ON PAVEMENT MARKING REFER TO STANDARD SPECIFICATIONS FOR ROAD AND BRIDGE CONSTRUCTION AND STATE STANDARD 780001.

All dimensions are in inches (millimeters) unless otherwise shown.

MODEL: Default  
FILE NAME: p:\project-pw-benefits.com\p\DOT\Documents\DOT Office\Dist\ref: \p\project\157620\CADD\data\Design\Dist\Std.dgn

USER NAME = shahda	DESIGNED - EVERS	REVISED - C. JUCIUS 09-09-09
DRAWN -	REVISED - C. JUCIUS 07-01-13	
PLOT SCALE = 100,0000' / in.	CHECKED -	REVISED - C. JUCIUS 12-21-15
PLOT DATE = 12/15/2021	DATE - 03-19-90	REVISED - C. JUCIUS 04-12-16

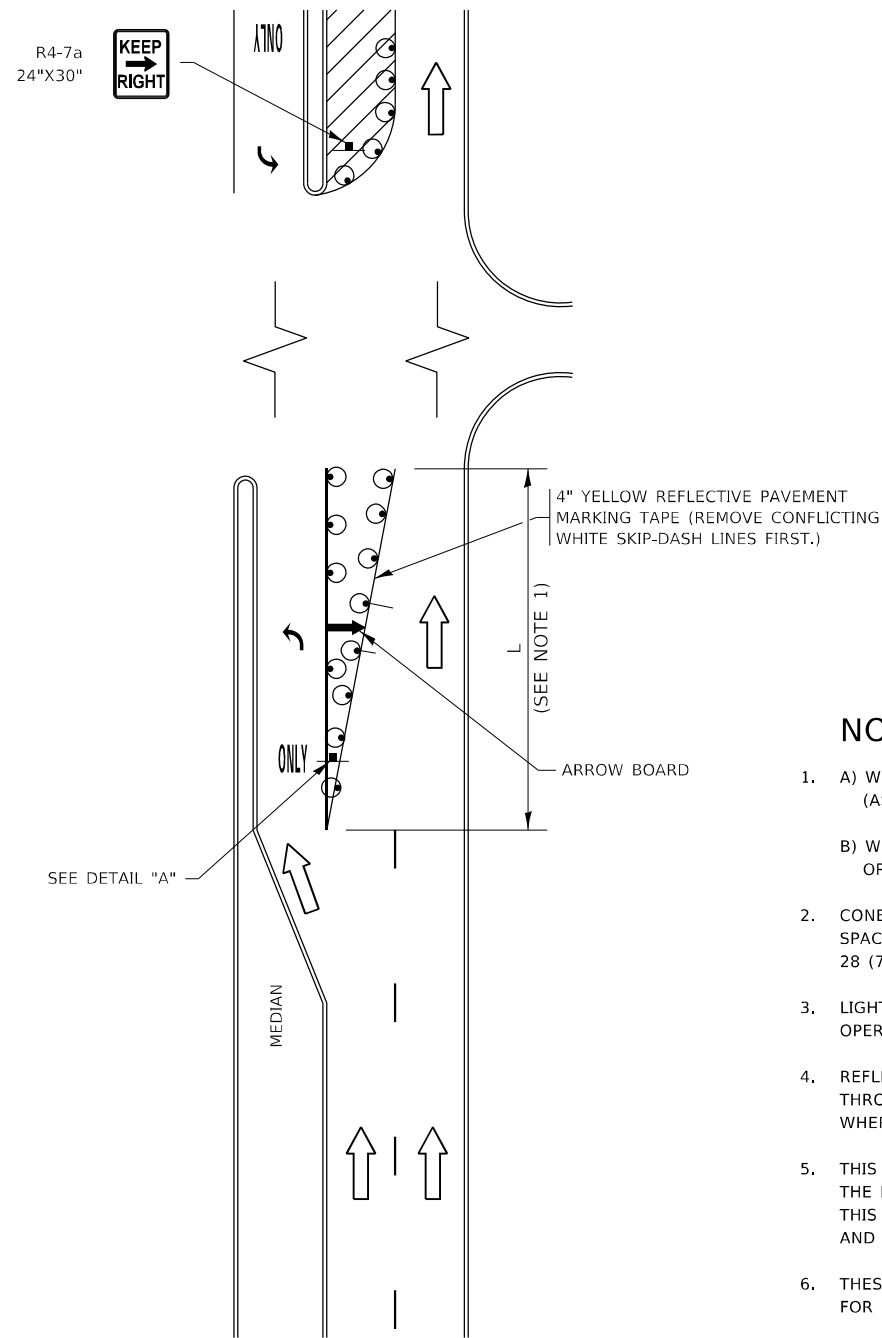
**STATE OF ILLINOIS  
DEPARTMENT OF TRANSPORTATION**

**DISTRICT ONE  
TYPICAL PAVEMENT MARKINGS**

SCALE: NONE	SHEET 1 OF 2 SHEETS	STA. TO STA.
-------------	---------------------	--------------

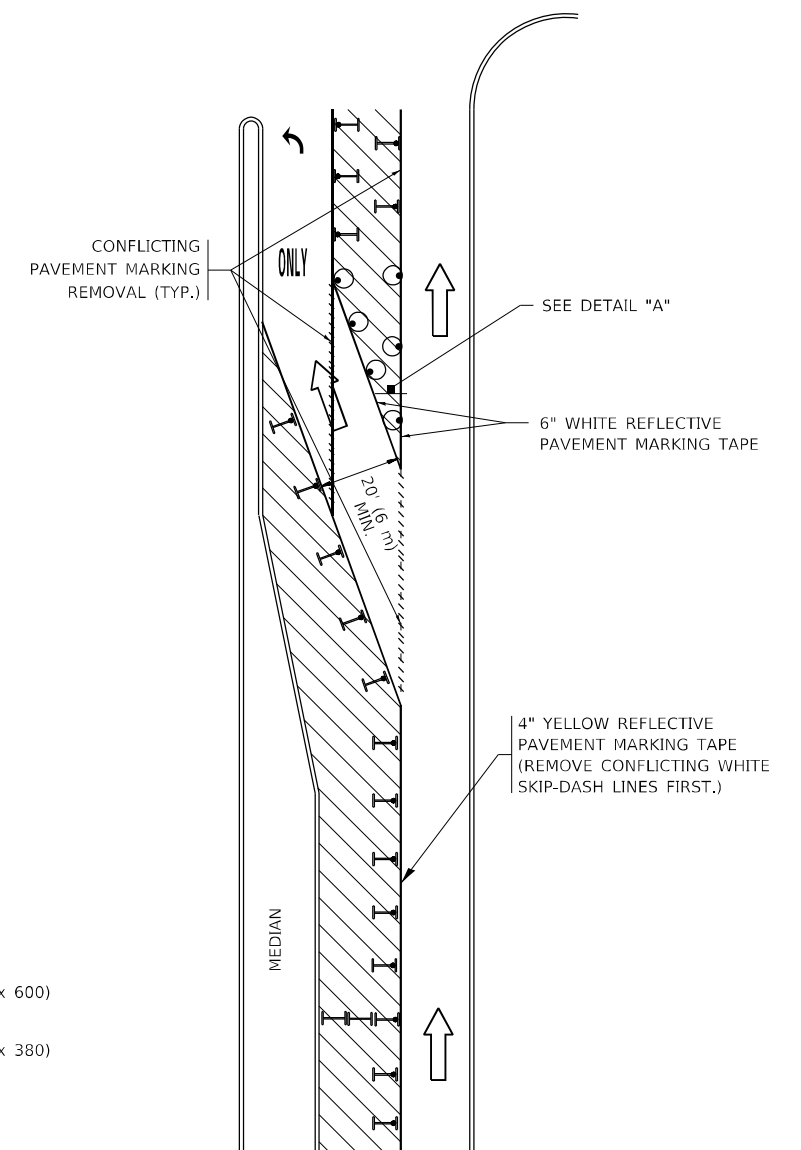
F.A.U. RTE.	SECTION	COUNTY	TOTAL SHEETS	SHEET NO.
1270	2020-157-R5&SW	COOK & LAKE	21	17
<b>TC-13</b>		CONTRACT NO. 62M45		
ILLINOIS FED. AID PROJECT				

# TURN BAY ENTRANCE AT START OF LANE CLOSURE TAPER

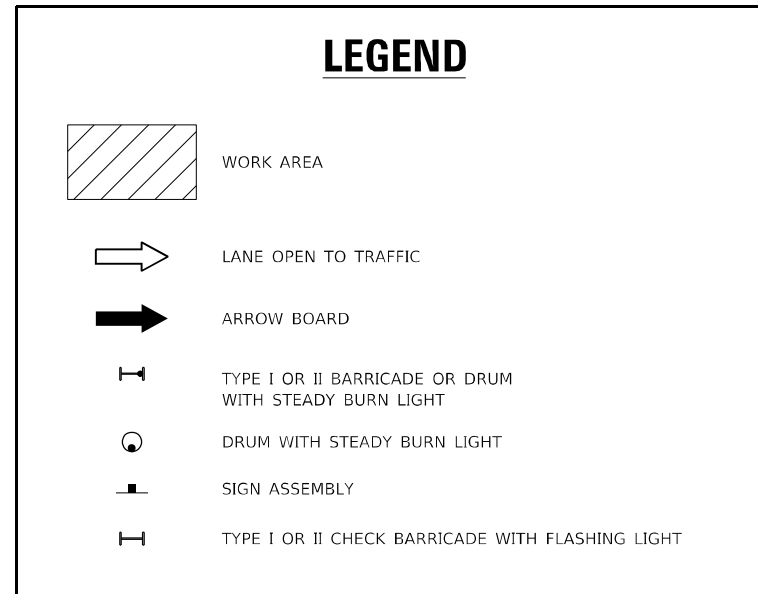


**FIGURE 1**

# TURN BAY ENTRANCE WITHIN A LANE CLOSURE

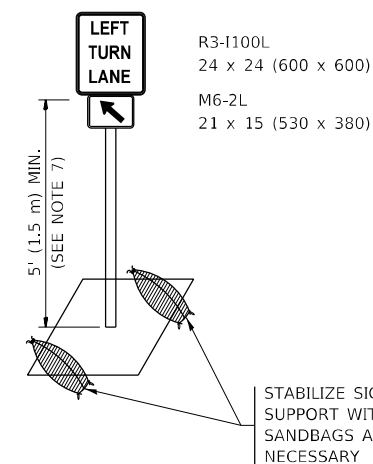


**FIGURE 2**



### NOTES:

1. A) WHEN "L" IS  $\leq$  THE STORAGE LENGTH OF THE TURN LANE (AS SHOWN IN FIG. 1), USE FIGURE 1.  
B) WHEN "L" IS  $>$  THE STORAGE LENGTH OF THE TURN LANE OR THE TURN LANE IS WITHIN THE LANE CLOSURE, USE FIGURE 2.
2. CONES MAY BE SUBSTITUTED FOR BARRICADES OR DRUMS AT HALF THE SPACING DURING DAY OPERATIONS. CONES SHALL BE A MINIMUM OF 28 (710) IN HEIGHT.
3. LIGHTS WILL NOT BE REQUIRED ON BARRICADES OR DRUMS FOR DAY OPERATIONS. ALL LIGHTS SHALL BE MONODIRECTIONAL.
4. REFLECTIVE TEMPORARY PAVEMENT MARKINGS SHALL BE PLACED THROUGHOUT THE BARRICADED AREAS OF EACH TURN BAY AS SHOWN WHERE THE CLOSURE TIME IS GREATER THAN FOURTEEN (14) DAYS.
5. THIS APPLICATION ALSO APPLIES WHEN WORK IS BEING PERFORMED IN THE RIGHT LANE(S) AND THE RIGHT TURN BAY IS TO REMAIN OPEN. UNDER THIS CONDITION, "RIGHT TURN LANE" R3-1100R 24 x 24 (600 x 600) AND M6-2R 21 x 15 (530 x 380) SHALL BE USED.
6. THESE CONTROLS SHALL SUPPLEMENT MAINLINE TRAFFIC CONTROL FOR LANE CLOSURES.
7. THE SIGNS SHALL BE MOUNTED ABOVE THE BARRICADES/DRUMS ON SEPARATE SIGN SUPPORTS THAT MEET NCHRP 350 OR MASH REQUIREMENTS.
8. TRAFFIC CONTROL AND PROTECTION AT TURN BAYS (TO REMAIN OPEN TO TRAFFIC) SHALL BE INCLUDED IN THE COST OF SPECIFIED TRAFFIC CONTROL STANDARDS OR ITEMS.



**DETAIL A**

All dimensions are in inches (millimeters) unless otherwise shown.

MODEL: Default FILE: h:\mfc\p\project\paw\benefit\com\p\m\dot\Documents\DOT\Office\Dir\rdet\_1\project\157620\CADD\data\Design\BartSt.dgn

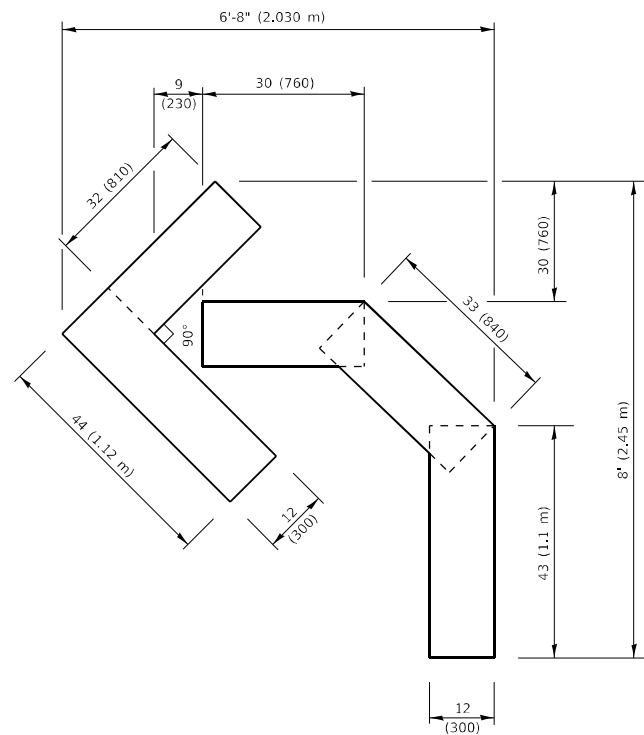
USER NAME = shahda	DESIGNED - T. RAMMACHER 09-08-94	REVISED - R. BORO 09-14-09
	DRAWN - A. HOUSEH 11-07-95	REVISED - A. SCHUETZE 07-01-13
PLOT SCALE = 100,0000' / in.	CHECKED - A. HOUSEH 10-12-96	REVISED - A. SCHUETZE 09-15-16
PLOT DATE = 12/15/2021	DATE - T. RAMMACHER 01-06-00	REVISED -

**STATE OF ILLINOIS  
DEPARTMENT OF TRANSPORTATION**

**TRAFFIC CONTROL AND PROTECTION AT TURN BAYS  
(TO REMAIN OPEN TO TRAFFIC)**

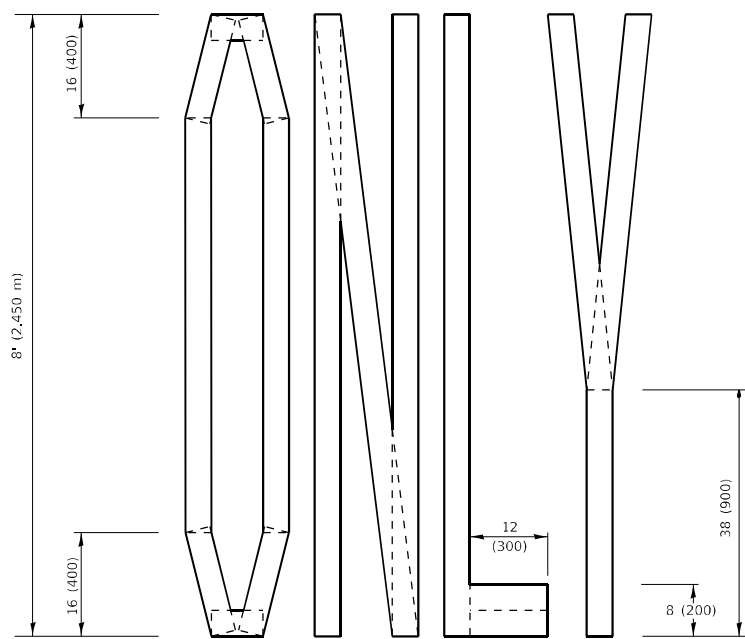
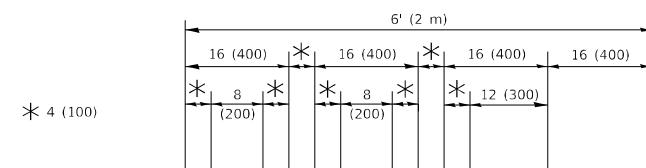
SCALE: NONE SHEET 1 OF 1 SHEETS STA. TO STA.

F.A.U. RTE.	SECTION	COUNTY	TOTAL SHEETS	SHEET NO.
1270	2020-157-R5&SW	COOK & LAKE	21	18
TC-14		CONTRACT NO. 62M45		
ILLINOIS FED. AID PROJECT				



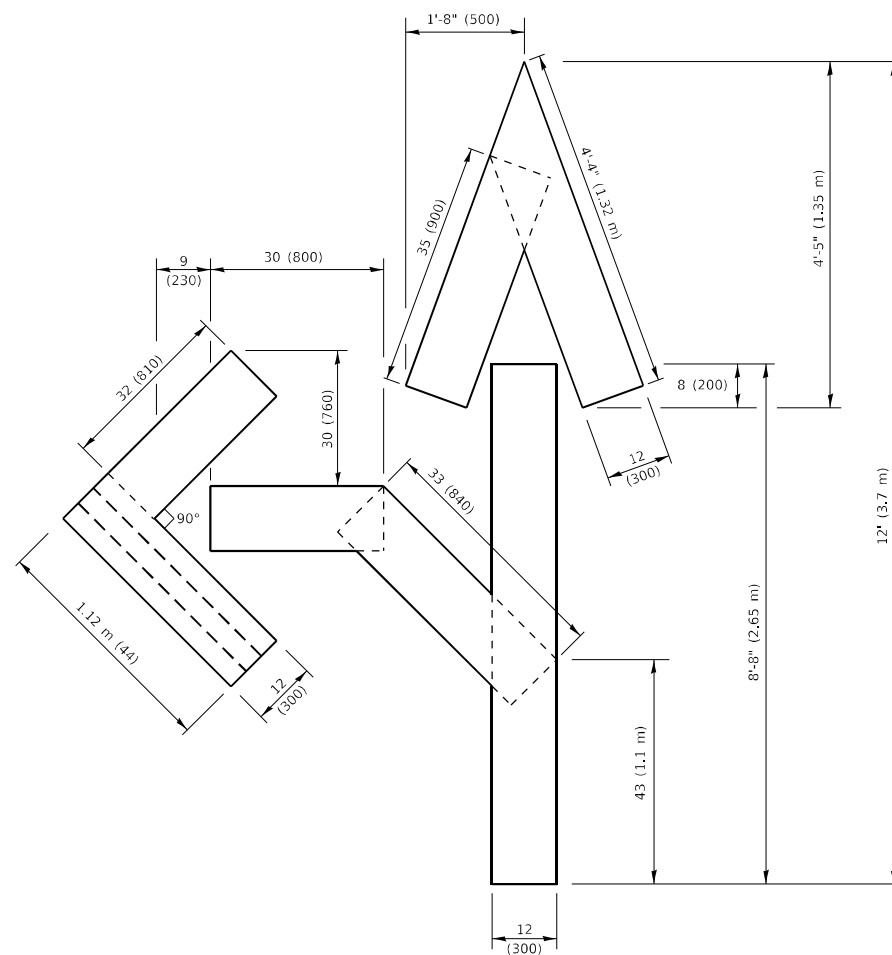
**QUANTITY**

4 (100) LINE = 45.5 ft. (13.9 m)  
15.2 sq. ft. (1.41 sq. m)



**QUANTITY**

4 (100) LINE = 64.1 ft. (19.5 m)  
21.4 sq. ft. (1.99 sq. m)

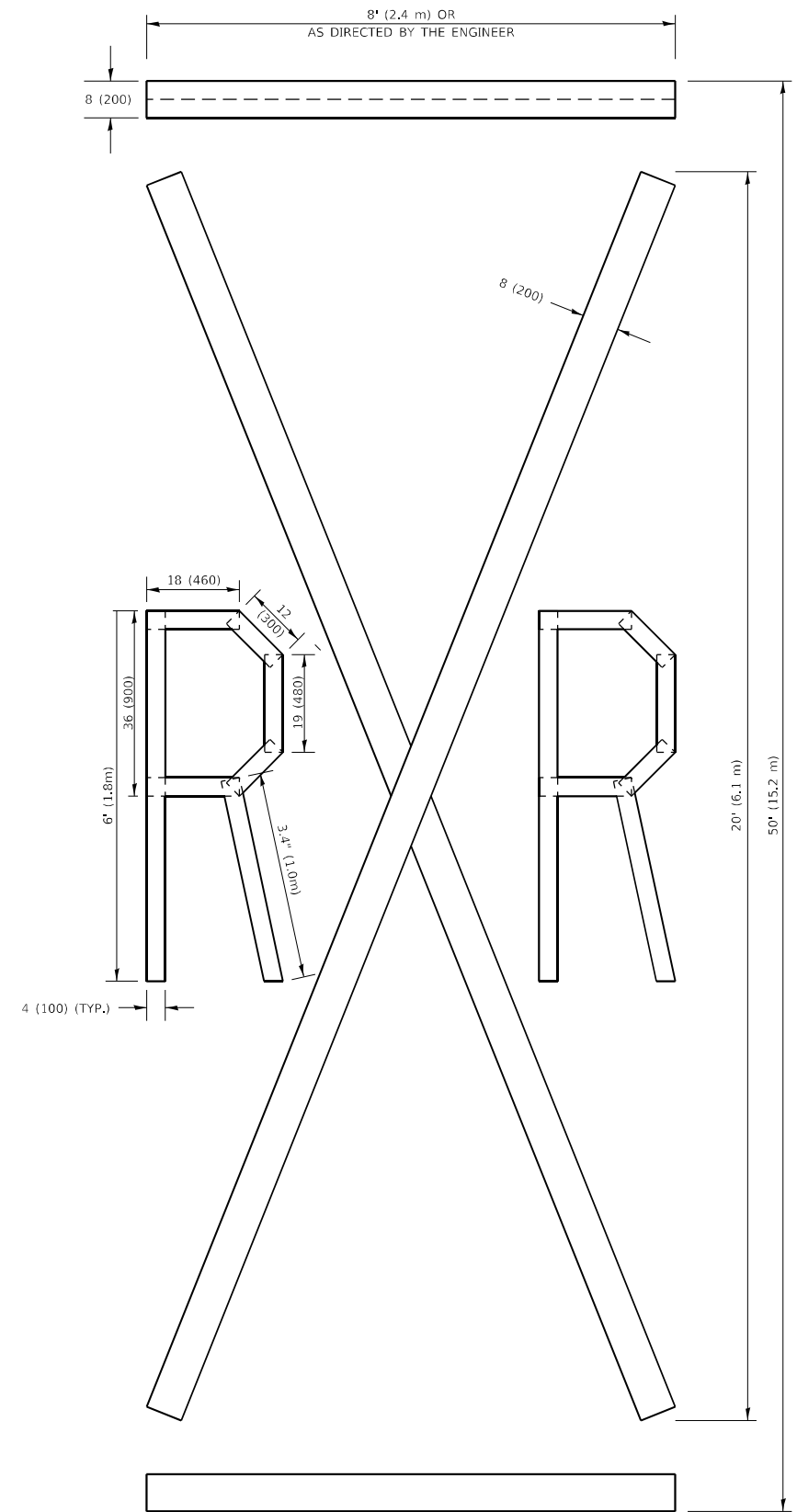


**QUANTITY**

4 (100) LINE = 82.5 ft. (25.1 m)  
27.5 sq. ft. (2.53 sq. m)

**NOTE:**

ALL QUANTITIES OF PLACEMENT ARE REPRESENTED IN LINEAR FEET OF 4" LINES TO MATCH THE 4" TEMPORARY TAPE PAY ITEM AND REPRESENTS THE TOTAL QUANTITY OF 4" TAPE REQUIRED.



**QUANTITY**

4 (100) LINE = 225.9 ft. (68.9 m)  
75.3 sq. ft. (6.99 sq. m)

All dimensions are in inches (millimeters) unless otherwise shown.

MODEL: Defaul... FILE: MarkE... \\blbpcw\server\com\pwwork\Documents\DOT\_Offices\shanda\11\Projects\157620\CADD\Drawings\Drawings.dwg

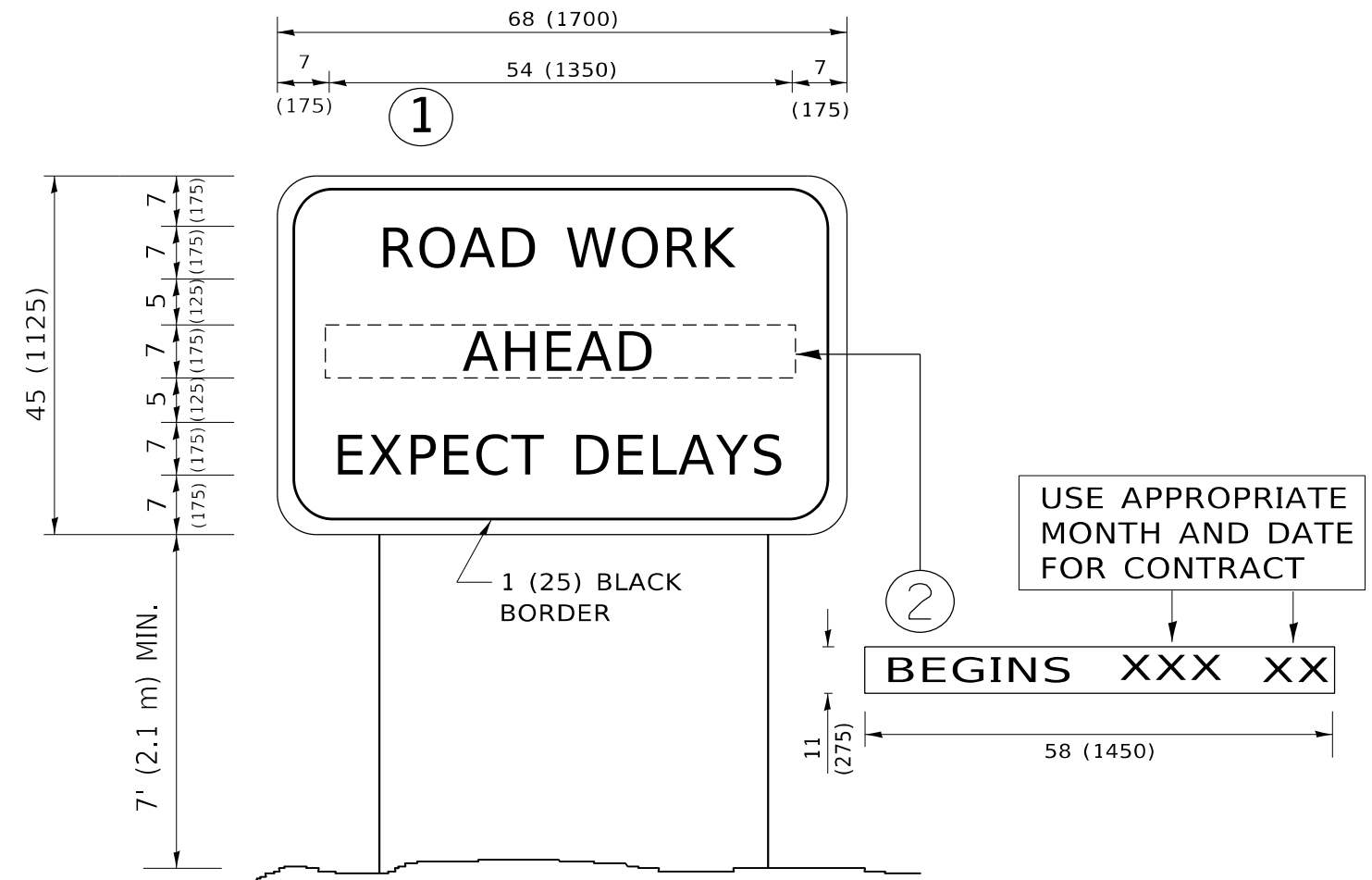
USER NAME = shanda	DESIGNED -	REVISED - T. RAMMACHER 03-02-98
	DRAWN -	REVISED - E. GOMEZ 08-28-00
PLOT SCALE = 100,0010 ' / in.	CHECKED -	REVISED - E. GOMEZ 08-28-00
PLOT DATE = 12/15/2021	DATE - 09-18-94	REVISED - A. SCHUETZE 09-15-16

**STATE OF ILLINOIS  
DEPARTMENT OF TRANSPORTATION**

**SHORT TERM PAVEMENT MARKING LETTERS AND SYMBOLS**

SCALE: NONE SHEET 1 OF 1 SHEETS STA. TO STA.

F.A.U. RTE.	SECTION	COUNTY	TOTAL SHEETS	SHEET NO.
1270	2020-157-R5&SW	COOK & LAKE	21	19
<b>TC-16</b>			CONTRACT NO. 62M45	
ILLINOIS FED. AID PROJECT				



**NOTES:**

1. USE BLACK LETTERING ON ORANGE BACKGROUND.
2. ERECT SIGNS IN ADVANCE OF THE LOCATION FOR THE "ROAD CONSTRUCTION AHEAD" SIGN AT LOCATIONS AS DIRECTED BY THE ENGINEER.
3. ERECT SIGN ① WITH INSTALLED PANEL ② ONE WEEK PRIOR TO THE START OF CONSTRUCTION.
4. REMOVE PANEL ② SOON AFTER THE START OF CONSTRUCTION.
5. SEE SPECIAL PROVISION FOR "TEMPORARY INFORMATION SIGNING" FOR ADDITIONAL INFORMATION.
6. ONE SIGN ASSEMBLY EQUALS 25.70 SQ. FT. (2.3 SQ. M.)
7. SHALL BE PAID FOR AS TEMPORARY INFORMATION SIGNING.

ALL DIMENSIONS ARE IN INCHES (MILLIMETERS) UNLESS OTHERWISE SHOWN.

MODEL: Default  
 FILE NAME: p:\project\paw\_bentley.com\P\I\DOT\Documents\DOT Office\Dir\rdet - I\Project\157620\CADD\data\Design\BtES.dgn

USER NAME = shahda	DESIGNED -	REVISED - R. MIRS 09-15-97
	DRAWN -	REVISED - R. MIRS 12-11-97
PLOT SCALE = 100,0000 ' / in.	CHECKED -	REVISED - T. RAMMACHER 02-02-99
PLOT DATE = 12/15/2021	DATE -	REVISED - C. JUCIUS 01-31-07

**STATE OF ILLINOIS  
DEPARTMENT OF TRANSPORTATION**

**ARTERIAL ROAD  
INFORMATION SIGN**

SCALE: NONE SHEET 1 OF 1 SHEETS STA. TO STA.

F.A.U. RTE.	SECTION	COUNTY	TOTAL SHEETS	SHEET NO.
1270	2020-157-R5&SW	COOK & LAKE	21	20
<b>TC-22</b>			CONTRACT NO. 62M45	
ILLINOIS FED. AID PROJECT				



