

STATE OF ILLINOIS
DEPARTMENT OF TRANSPORTATION

PROPOSED HIGHWAY PLANS

FAP 618 (IL 41)
SECTION (35XVB-BR)BRR
CONTRACT MAINTENANCE
McDONOUGH COUNTY

C-94-094-21

FAP RTE.	SECTION	COUNTY	TOTAL SHEETS	SHEET NO.
618	(35XVB-BR)BRR	McDONOUGH	16	1
		ILLINOIS	CONTRACT NO. 68G70	

D-94-072-21



PROJECT DESCRIPTION:
SUBSTRUCTURE BRIDGE REPAIRS ON SN 055-0008 OVER KJRY & BNSF RR AND SHOULDER REPAIRS, 2.8 MILES SOUTH OF BUSHNELL

INDEX OF SHEETS

1. COVER SHEET
2. GENERAL NOTES
- 3-4. SUMMARY OF QUANTITIES
5. SCHEDULE OF QUANTITIES
6. LINE DIAGRAM
7. EXISTING PLAN VIEW S.N. 055-0008
8. NORTH ABUTMENT REPAIRS
9. SOUTH ABUTMENT REPAIRS
10. PIER REPAIRS
11. PARAPET SEALING DETAIL
12. GUARDRAIL EROSION CONTROL TREATMENT
13. INLETS TO BE ADJUSTED DETAILS
- 14-16. DISTRICT DETAILS

HIGHWAY STANDARDS:

- 701001-02
- 701006-05
- 701326-04
- 701901-08

ADT 3,100 (2019)
MU 8.9%
SU 3.0%

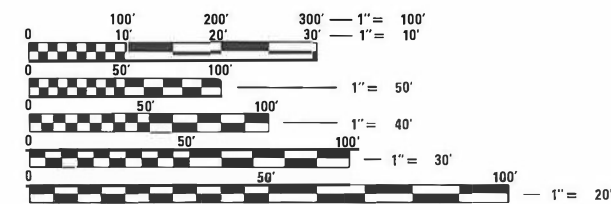

FULL SIZE PLANS HAVE BEEN PREPARED USING STANDARD ENGINEERING SCALES. REDUCED SIZED PLANS WILL NOT

ON REDUCED PLANS, THE ABOVE SCALES MAY BE USED.

J.U.L.I.E.
JOINT UTILITY LOCATION INFORMATION FOR EXCAVATORS
1-800-892-0123
OR 811

PROJECT ENGINEER: RICH DOTSON (309)671-3455
PROJECT MANAGER: DAVID GREEN (309)671-3473
CATALOG NO. 036257-00D
CONTRACT NO. 68G70

S.N. 055-0008
PROJECT BEGINS STA. 977 + 11
PROJECT ENDS STA. 990 + 89

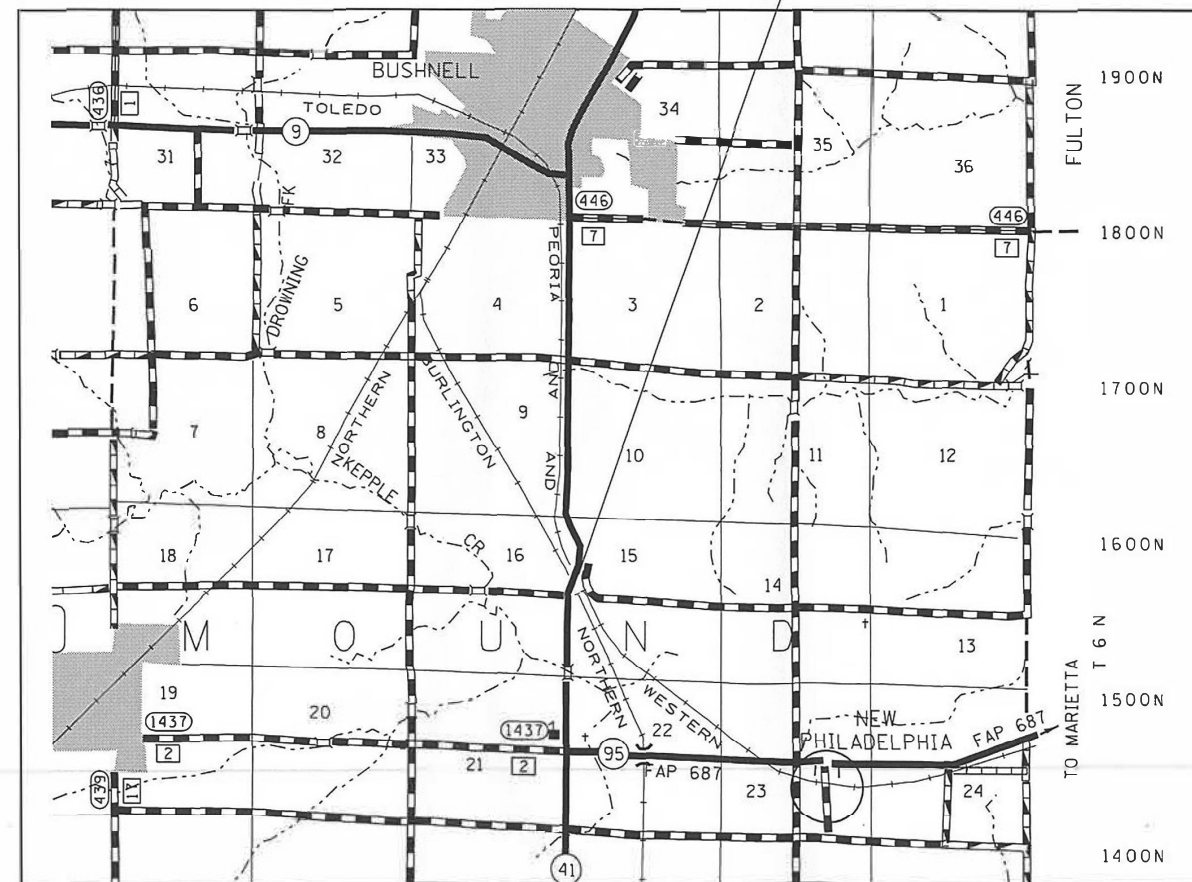

JOB LENGTH = 1378.0 FT. = 0.26 MILE

STATE OF ILLINOIS
DEPARTMENT OF TRANSPORTATION

SUBMITTED Dec 21 2021
Rensia Garnett RSD
REGIONAL ENGINEER

February 4 2022
[Signature]
ENGINEER OF DESIGN AND ENVIRONMENT

February 4 2022
Stephen McLean
DIRECTOR OF HIGHWAYS PROJECT IMPLEMENTATION

**PRINTED BY THE AUTHORITY
OF THE STATE OF ILLINOIS**

CODE NO.	ITEM	UNIT	TOTAL QUANTITY	CONSTRUCTION CODE	
				McDONOUGH CO. 100% STATE	
				BRIDGE 0013 055-0008	ROADWAY 0021 RURAL
20200100	EARTH EXCAVATION	CU YD	29		29
28100825	STONE DUMPED RIPRAP, CLASS B3	TON	30		30
44000400	GUTTER REMOVAL	FOOT	20		20
44004250	PAVED SHOULDER REMOVAL	SQ YD	15		15
48300800	PORTLAND CEMENT CONCRETE SHOULDERS 13"	SQ YD	15		15
59000200	EPOXY CRACK INJECTION	FOOT	22	22	
60260100	INLETS TO BE ADJUSTED	EACH	2		2
67100100	MOBILIZATION	L SUM	1	1	
70100500	TRAFFIC CONTROL AND PROTECTION, STANDARD 701326	L SUM	1		1
70103815	TRAFFIC CONTROL SURVEILLANCE	CAL DA	2		2
70107025	CHANGEABLE MESSAGE SIGN	CAL DA	14		14
Z0001002	GUARDRAIL AGGREGATE EROSION CONTROL	TON	263		263
Z0012754	STRUCTURAL REPAIR OF CONCRETE (DEPTH EQUAL TO OR LESS THAN 5 INCHES)	SQ FT	19	19	
Z0048665	RAILROAD PROTECTIVE LIABILITY INSURANCE	L SUM	1	1	

MODEL: Default
 FILE: \\mfc-pw-bentley.com\PW\DOT\Documents\DOT Office\Dir\ref. dl\Project\ID_68G70\CADD\Draw\CAD\Sheet\DAxxxxx-shc-cover.dgn

USER NAME = greenom	DESIGNED -	REVISED -
PLOT SCALE = 100,0000 ' / in.	DRAWN -	REVISED -
PLOT DATE = 12/20/2021	CHECKED -	REVISED -
	DATE -	REVISED -

**STATE OF ILLINOIS
DEPARTMENT OF TRANSPORTATION**

SUMMARY OF QUANTITIES

SCALE: SHEET OF SHEETS STA. TO STA.

FAP RTE.	SECTION	COUNTY	TOTAL SHEETS	SHEET NO.
618	(35XVB-BR)BRR	McDONOUGH	16	3
			CONTRACT NO. 68G70	
		ILLINOIS	FED. AID PROJECT	

CODE NO.	ITEM	UNIT	TOTAL QUANTITY	CONSTRUCTION CODE	
				McDONOUGH CO. 100% STATE	
				BRIDGE 0013 055-0008	ROADWAY 0021 RURAL
X0326444	SURFACE FILLER (SPECIAL)	GALLON	2	2	
X5030550	PROTECTIVE COAT (SPECIAL)	SQ YD	484	484	
X6062700	CONCRETE GUTTER, TYPE A (SPECIAL)	FOOT	20		20

MODEL: Default
 FILE NAME: p:\ultra-cw-bea\paw.com\PIV\DOT\Documents\DOT Office\Dir\rdet_4\Project\ID_68G70\CADD\Bids\CAD\Sheet\DAxxxxx-shc-cover.dgn

USER NAME = greenom	DESIGNED -	REVISED -	STATE OF ILLINOIS DEPARTMENT OF TRANSPORTATION	SUMMARY OF QUANTITIES				FAP RTE.	SECTION	COUNTY	TOTAL SHEETS	SHEET NO.
PLOT SCALE = 100,0000' / in.	DRAWN -	REVISED -						618	(35XVB-BR)BRR	McDONOUGH	16	4
PLOT DATE = 12/20/2021	CHECKED -	REVISED -		CONTRACT NO. 68G70				ILLINOIS FED. AID PROJECT				
	DATE -	REVISED -		SCALE:	SHEET	OF	SHEETS	STA.	TO STA.			

STRUCTURE QUANTITIES				
LOCATION	Z0012754	59000200	X0326444	X5030550
	STRUCTURAL REPAIR OF CONCRETE (DEPTH EQUAL TO OR LESS THAN 5")	EPOXY CRACK INJECTION	SURFACE FILLER (SPECIAL)	PROTECTIVE COAT (SPECIAL)
	SQ FT	FOOT	GAL	SQ YD
North Abutment		18.5		
South Abutment	6.5	3		
Pier #2	10.5			
Pier #3	1.5			
Parapets			2	484
TOTALS	19	22	2	484

TRAFFIC CONTROL	
LOCATION	70103815
	TRAFFIC CONTROL SURVEILLANCE
IL 41	CAL DA
JOBSITE	2
TOTAL	2

CHANGEABLE MESSAGE SIGNS	
LOCATION	70107025 CHANGEABLE MESSAGE SIGN
	CAL DA
JOBSITE	14
TOTAL	14

NOTE: 2 SIGNS AT 7 DAYS EACH

GUARDRAIL TREATMENT				
LOCATION	Z0001002	20200100	28100825	
	GUARDRAIL AGGREGATE EROSION CONTROL	EARTH EXCAVATION	STONE DUMPED RIPRAP, CLASS B3	
	TON	CU YD	TONS	
NW Quadrant	STA. 977+00 LT. TO STA. 980+00 LT.	62.6	6.9	
NE Quadrant	STA. 977+85 RT. TO STA. 980+00 LT.	44.9	5.0	
SE Quadrant	STA. 983+44 RT. TO STA. 990+89 RT.	155.6	17.2	
SW Quadrant	STA. 984+34 RT.			30
TOTAL		263	29	30

NOTE: 6" AVERAGE DEPTH USED FOR GUARDRAIL AGGREGATE EROSION CONTROL CALCULATIONS

INLET ADJUST					
LOCATION	60260100	44000400	44004250	X6062700	48300800
	INLETS TO BE ADJUSTED	GUTTER REMOVAL	PAVED SHOULDER REMOVAL	CONCRETE GUTTER, TYPE A (SPECIAL)	PORTLAND CEMENT CONCRETE SHOULDERS 13"
	EACH	FOOT	SQ YDS	FOOT	SQ YDS
NW Quadrant	1	20	8.9	20	8.9
NE Quadrant	1	0	6.2	0	6.2
TOTALS	2	20	15	20	15

MODEL: Default
FILE: \\nafe-pw-bentley.com\PW\DOT\Documents\DOT Office\Dir\dir.ctb: \\project\104_68G70\CADD\Drawings\CAD\Sheet\104xxxx-shc-cover.dgn

USER NAME = greenom	DESIGNED -	REVISED -	STATE OF ILLINOIS DEPARTMENT OF TRANSPORTATION	SCHEDULE OF QUANTITIES		FAP RTE.	SECTION	COUNTY	TOTAL SHEETS	SHEET NO.
PLOT SCALE = 100,0000' / in.	DRAWN -	REVISED -				618	(35XVB-BR)BRR	McDONOUGH	16	5
PLOT DATE = 12/20/2021	CHECKED -	REVISED -		SCALE:	SHEET OF SHEETS	STA. TO STA.	ILLINOIS FED. AID PROJECT			
	DATE -	REVISED -					CONTRACT NO. 68G70			



NEW PHILADELPHIA

BUSHNELL

IMPROVEMENT BEGINS
STA. 977 + 11

COUNTY ROAD 1550 N

FAP 618

IL 41

IL 95

FAP 618

IL 41

KEOKUK JUNCTION RAILWAY

MURPHY ROAD

COUNTY ROAD 1700 N

BURLINGTON NORTHERN & SANTA FE RR

S.N. 055-0008

COUNTY ROAD 1550 N

COUNTY ROAD 1450 N

IMPROVEMENT ENDS
STA. 990 + 89

* DRAWING NOT TO SCALE

MODEL: Default
FILE NAME: p:\bullet\paw_bentley.com\PW\DOT\Documents\DOT_offices\Dir\drt_4\Project\ID4_68G70\CADD\Draws\CAD\Sheet\ID4xxxx-shc\cover.dgn

USER NAME = greenom	DESIGNED -	REVISED -
	DRAWN -	REVISED -
PLOT SCALE = 100,0000' / in.	CHECKED -	REVISED -
PLOT DATE = 12/20/2021	DATE -	REVISED -

STATE OF ILLINOIS
DEPARTMENT OF TRANSPORTATION

LINE DIAGRAM

SCALE: SHEET OF SHEETS STA. TO STA.

FAP RTE.	SECTION	COUNTY	TOTAL SHEETS	SHEET NO.
618	(35XVB-BR)BRR	McDONOUGH	16	6
CONTRACT NO. 68G70			ILLINOIS FED. AID PROJECT	



S.N. 055-0008

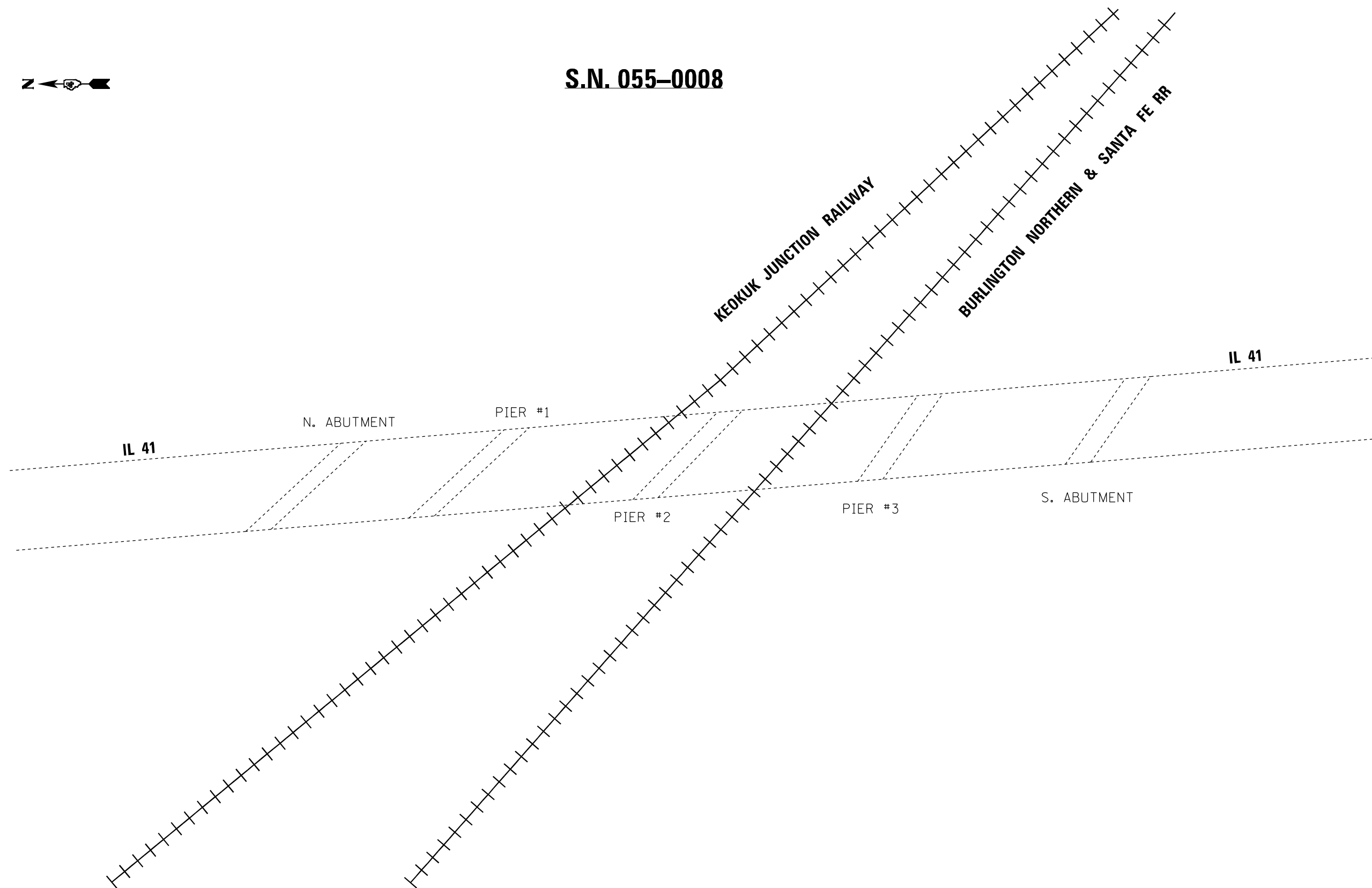

* DRAWING NOT TO SCALE

MODEL: Default
 FILE: \\na11c1-pw-bentley.com\PW\DOT\Documents\DOT Office\Dir\rdt_4\Project\ID_68G70\CADD\Bri\35XVB-RR\Sheet\Axxxxx-shc-cover.dgn

USER NAME = greenom	DESIGNED -	REVISED -
	DRAWN -	REVISED -
PLOT SCALE = 100,0000 ' / in.	CHECKED -	REVISED -
PLOT DATE = 12/20/2021	DATE -	REVISED -

**STATE OF ILLINOIS
DEPARTMENT OF TRANSPORTATION**

**EXISTING PLAN VIEW
S.N. 055-0008**

SCALE: SHEET OF SHEETS STA. TO STA.

FAP RTE.	SECTION	COUNTY	TOTAL SHEETS	SHEET NO.
618	(35XVB-BR)BRR	MCDONOUGH	16	7
CONTRACT NO. 68G70				
ILLINOIS FED. AID PROJECT				

S.N. 055-0008

PROPOSED LEGEND

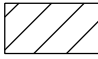
 STRUCTURAL REPAIR OF CONCRETE (DEPTH EQUAL TO OR LESS THAN 5")

 EPOXY CRACK INJECTION

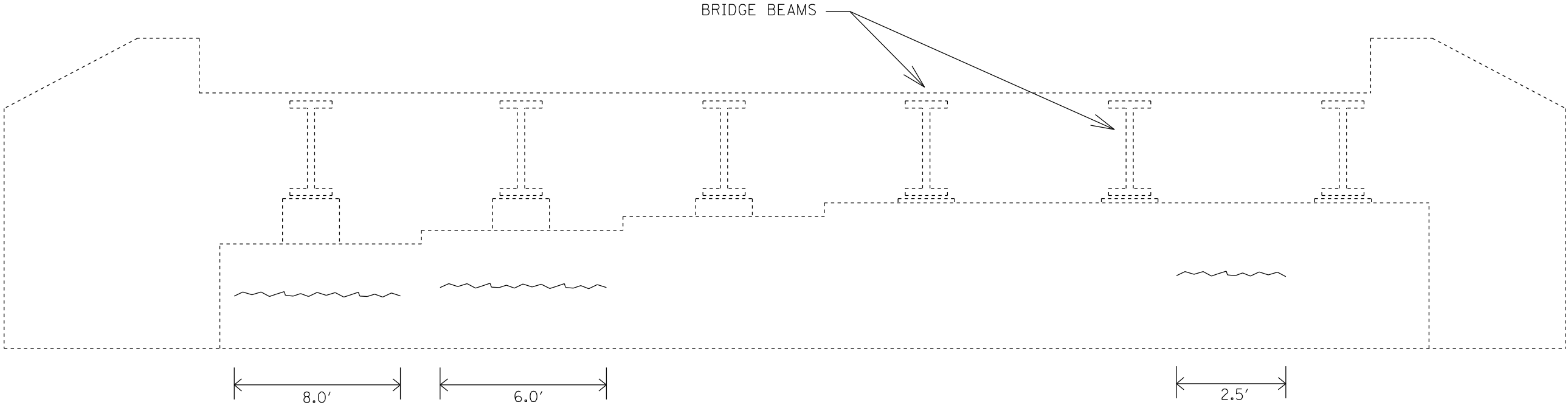

ELEVATION OF NORTH ABUTMENT REPAIRS

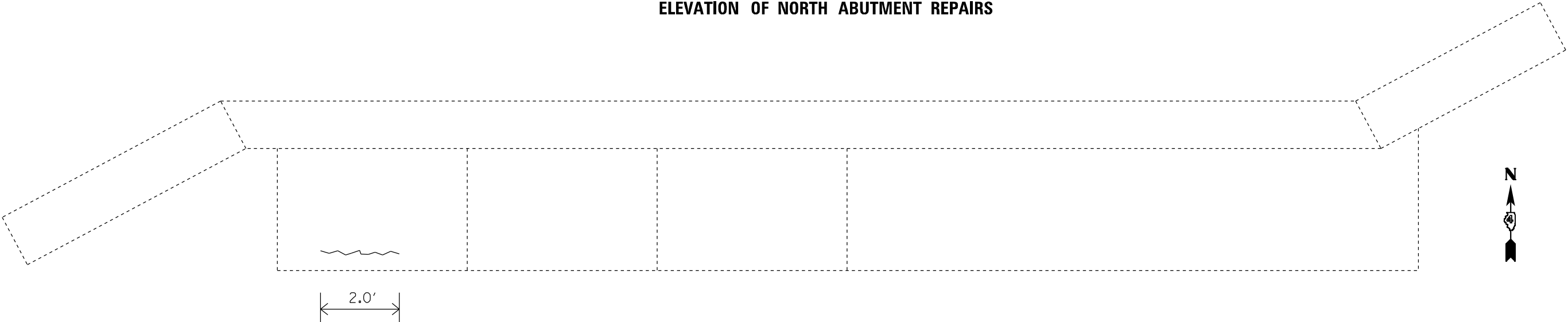

PLAN OF NORTH ABUTMENT REPAIRS

* DRAWING NOT TO SCALE

MODEL: Default
 FILE: \\mupc-pw-bentley.com\P\INDOT\Documents\DOT Offices\District_4\Projects\DA_68G70\CADD\DA_68G70\CADD\Sheet\DAxxxxx-shc-cover.dgn

USER NAME = greenom	DESIGNED -	REVISED -
	DRAWN -	REVISED -
PLOT SCALE = 100,0000' / in.	CHECKED -	REVISED -
PLOT DATE = 12/20/2021	DATE -	REVISED -

**STATE OF ILLINOIS
DEPARTMENT OF TRANSPORTATION**

NORTH ABUTMENT REPAIRS				
SCALE:	SHEET	OF	SHEETS	STA. TO STA.

FAP RTE.	SECTION	COUNTY	TOTAL SHEETS	SHEET NO.
618	(35XVB-BR)BRR	McDONOUGH	16	8
CONTRACT NO. 68G70				
ILLINOIS FED. AID PROJECT				



S.N. 055-0008

PROPOSED LEGEND

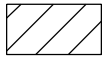
 STRUCTURAL REPAIR OF CONCRETE (DEPTH EQUAL TO OR LESS THAN 5")

 EPOXY CRACK INJECTION

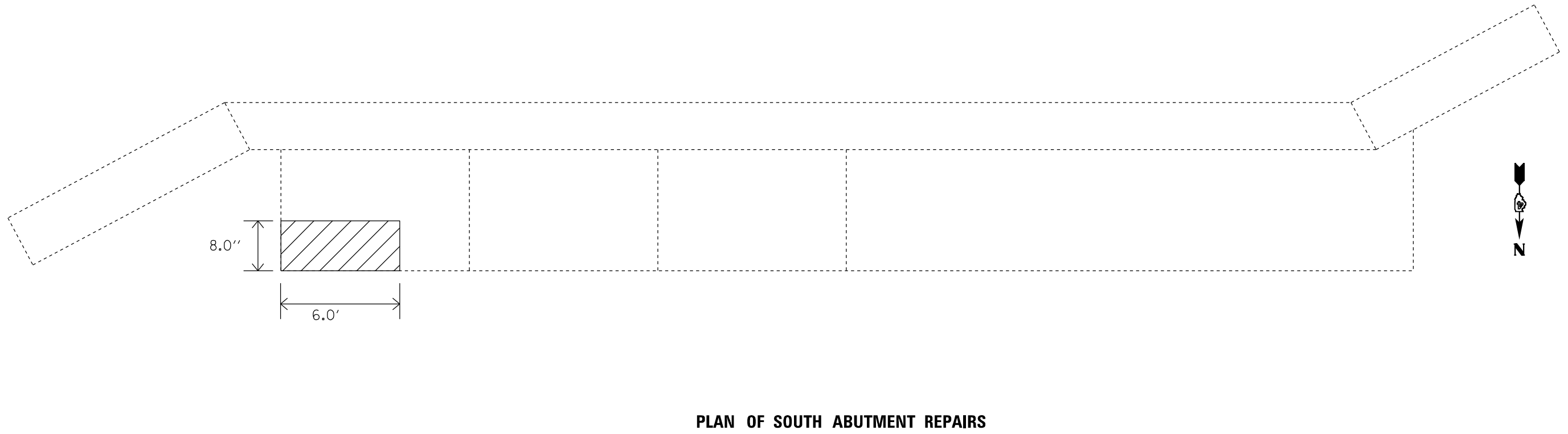
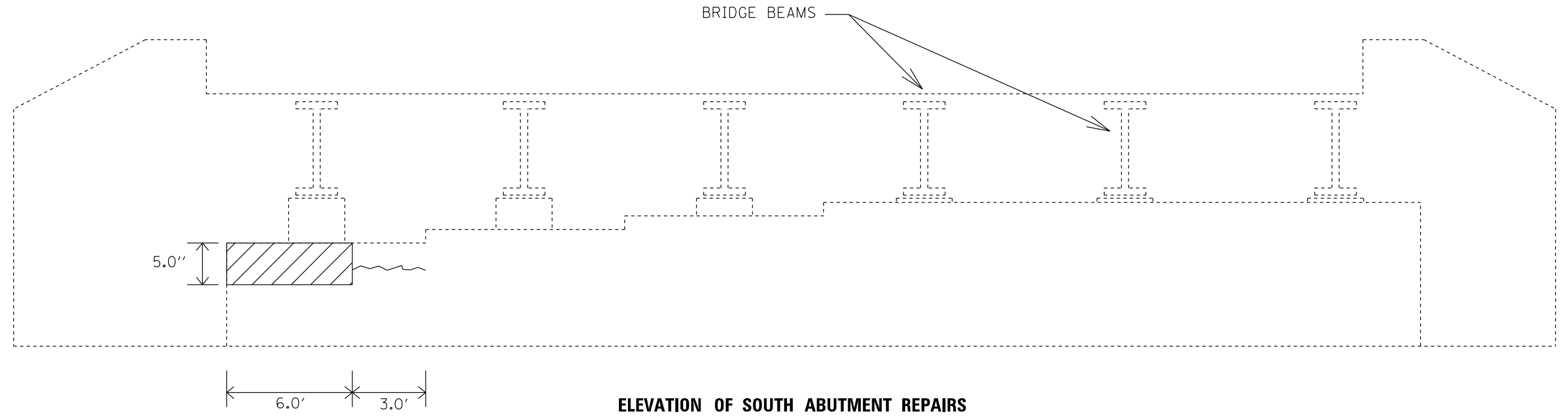

* DRAWING NOT TO SCALE

MODEL: Default
FILE: \\mfrs-pw-backend.com\P\W\DOT\Documents\DOT Office\Director_d\Project\ID_68G70\CADD\Drawings\CAD\Sheet\Drawings\Sheet\68G70-055-0008.dwg

USER NAME = greenom	DESIGNED -	REVISED -
	DRAWN -	REVISED -
PLOT SCALE = 100,0000' / in.	CHECKED -	REVISED -
PLOT DATE = 12/20/2021	DATE -	REVISED -

**STATE OF ILLINOIS
DEPARTMENT OF TRANSPORTATION**

SOUTH ABUTMENT REPAIRS

SCALE: SHEET OF SHEETS STA. TO STA.

FAP RTE.	SECTION	COUNTY	TOTAL SHEETS	SHEET NO.
618	(35XVB-BR)BRR	McDONOUGH	16	9
CONTRACT NO. 68G70				
ILLINOIS FED. AID PROJECT				

S.N. 055-0008

PIER #2 5TH COLUMN FROM THE EAST

PIER #3 3RD COLUMN FROM THE WEST

PROPOSED LEGEND

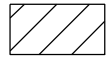
 STRUCTURAL REPAIR OF CONCRETE (DEPTH EQUAL TO OR LESS THAN 5')

 EPOXY CRACK INJECTION

LOOKING SOUTH

LOOKING EAST

LOOKING WEST

LOOKING SOUTH

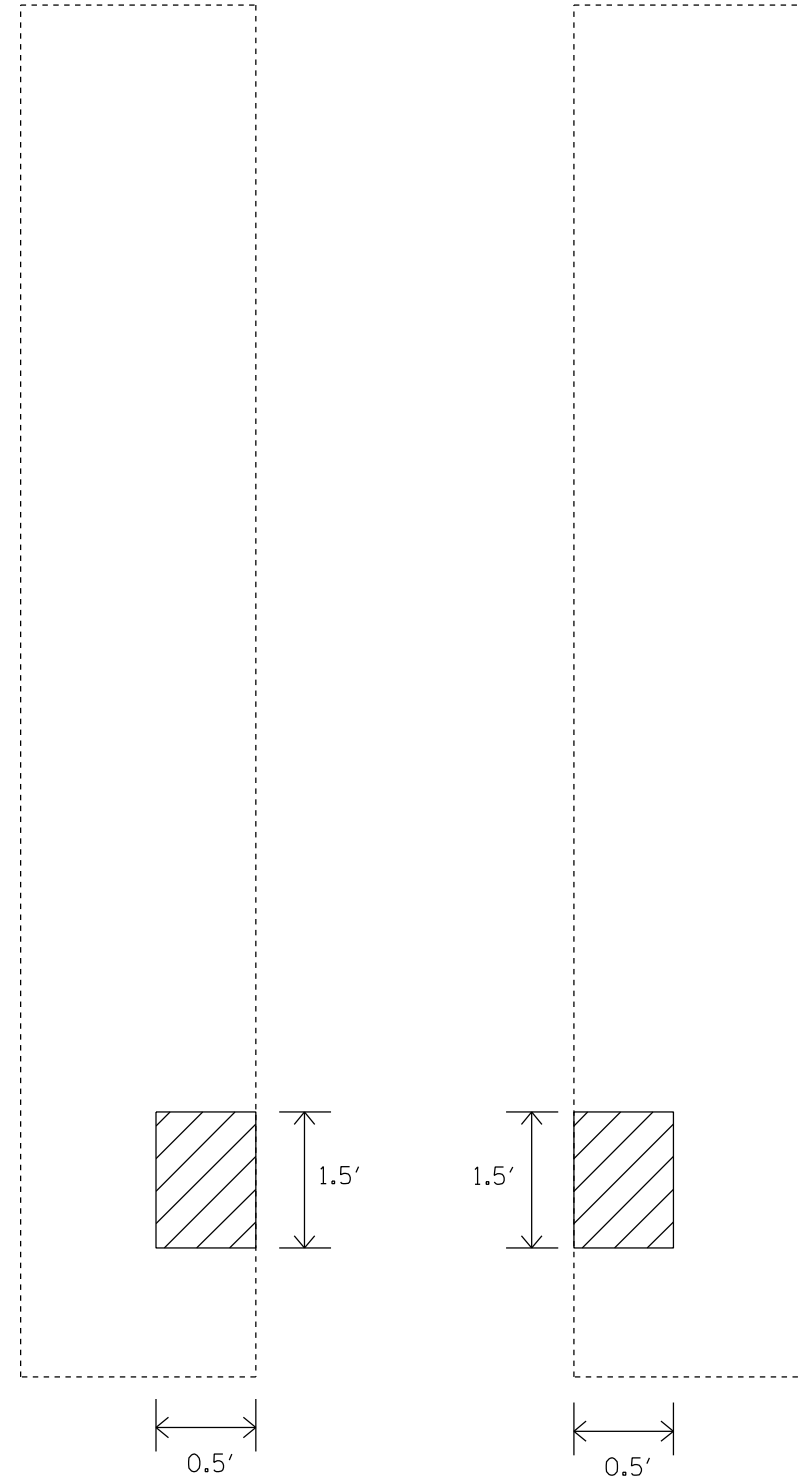
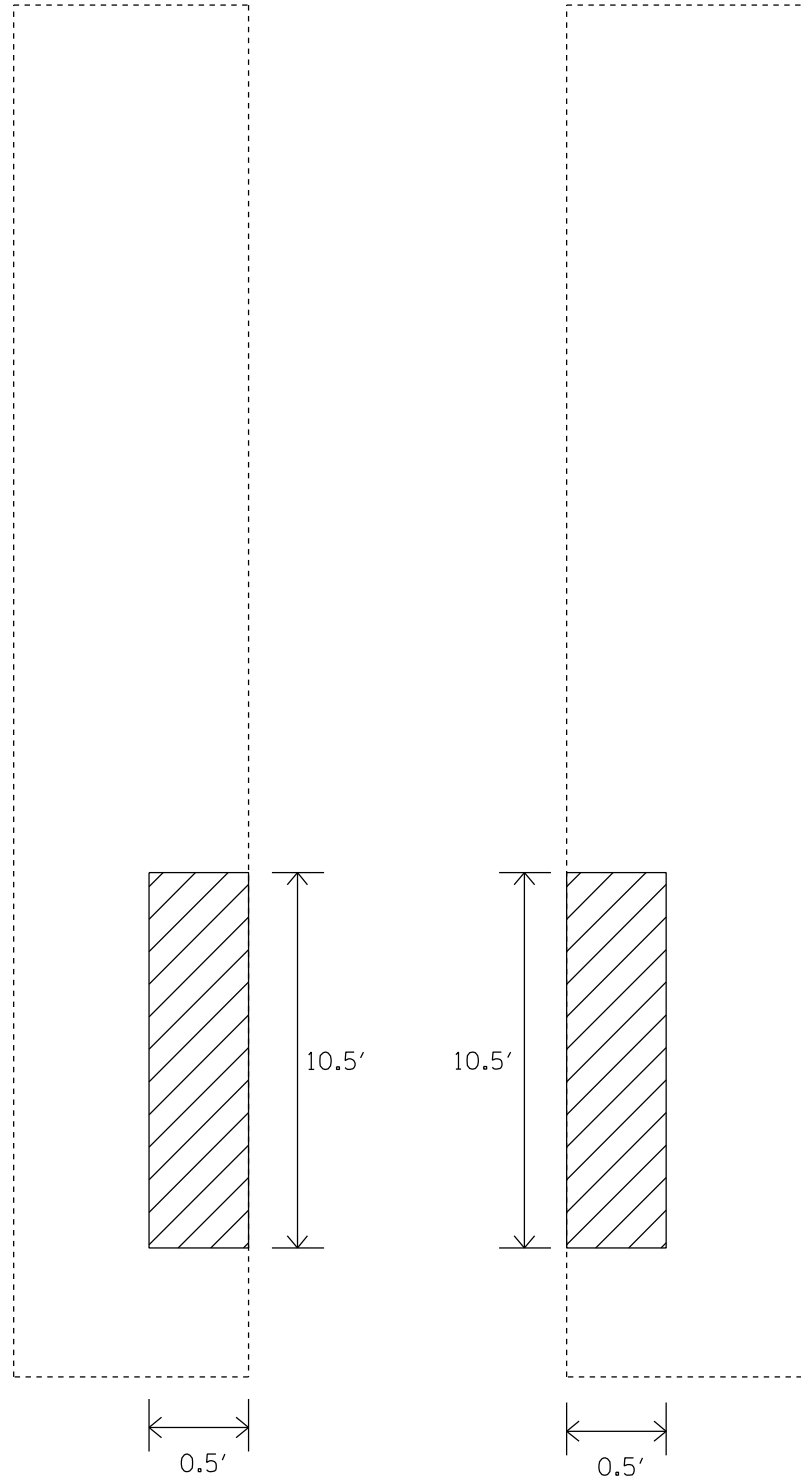

* DRAWING NOT TO SCALE

MODEL: Default
 FILE NAME: p:\ultra-cw-bea\paw.com\PIV\DOT\Documents\DOT Office\Dir\ref. d\Project\ID_68G70\CADD\Draws\CAD\Sheet\DAxxxxx-shc-cover.dgn

USER NAME = greenom	DESIGNED -	REVISED -
	DRAWN -	REVISED -
PLOT SCALE = 100,0000 ' / in.	CHECKED -	REVISED -
PLOT DATE = 12/20/2021	DATE -	REVISED -

**STATE OF ILLINOIS
DEPARTMENT OF TRANSPORTATION**

PIER REPAIRS

SCALE: SHEET OF SHEETS STA. TO STA.

FAP RTE.	SECTION	COUNTY	TOTAL SHEETS	SHEET NO.
618	(35XVB-BR)BRR	McDONOUGH	16	10
CONTRACT NO. 68G70				
ILLINOIS FED. AID PROJECT				

S.N. 055-0008

EXISTING BRIDGE PARAPET

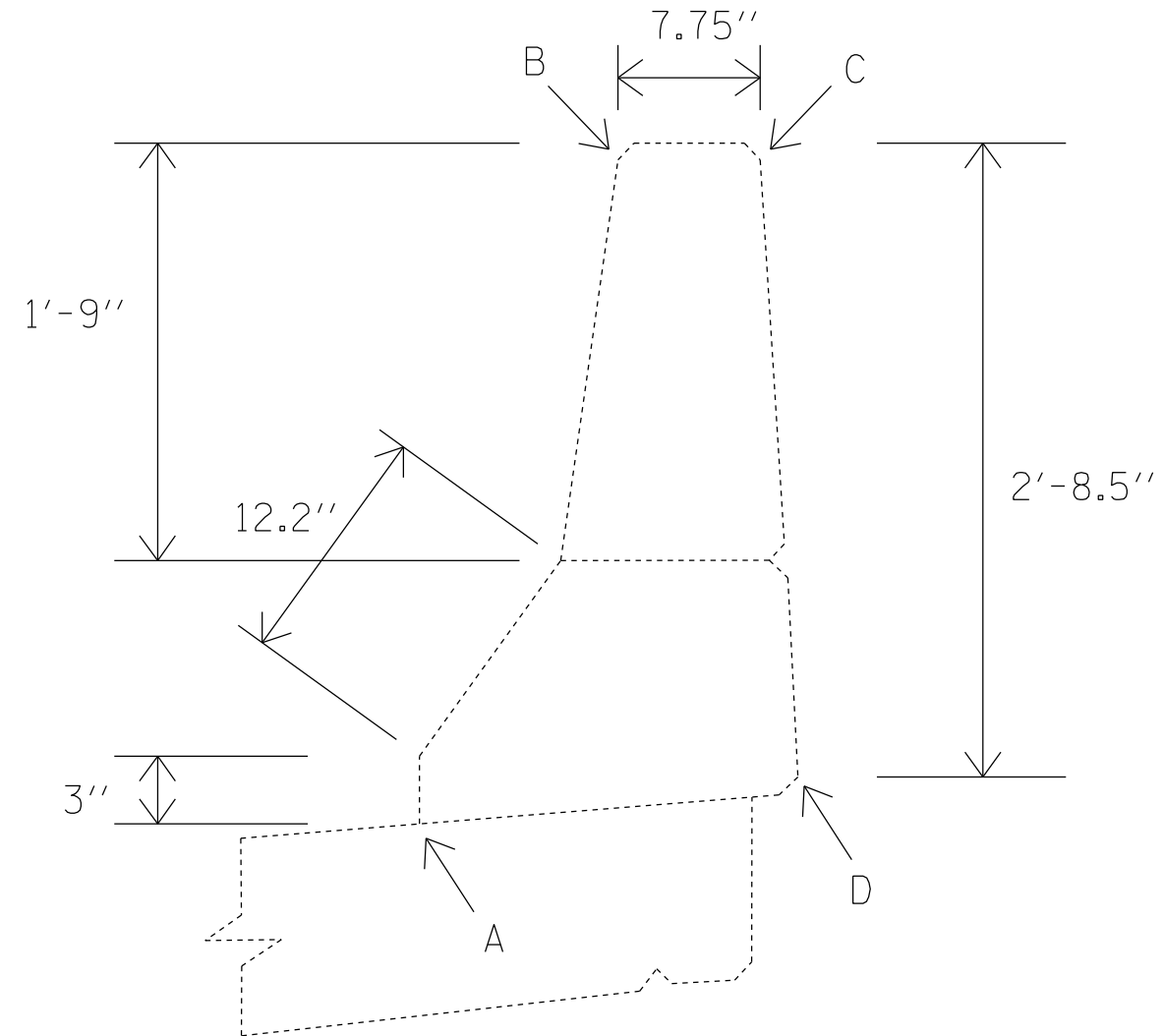

NOTE:

1. PROTECTIVE COAT (SPECIAL) SHALL COVER FROM POINT A THROUGH POINTS B, C, AND D OF ALL EXISTING PARAPETS.

MODEL: Default
 FILE: \\mfrs-pw-bentley.com\PW\DOT\Documents\DOT Offices\District 4\Project\ID_68G70\CADD\Draws\CAD\Sheet\DAxxxx-shc-cover.dgn

USER NAME = greenom	DESIGNED -	REVISED -
	DRAWN -	REVISED -
PLOT SCALE = 100,0000 ' / in.	CHECKED -	REVISED -
PLOT DATE = 12/20/2021	DATE -	REVISED -

STATE OF ILLINOIS
DEPARTMENT OF TRANSPORTATION

PARAPET SEALING DETAIL

SCALE: SHEET OF SHEETS STA. TO STA.

FAP RTE.	SECTION	COUNTY	TOTAL SHEETS	SHEET NO.
618	(35XVB-BR)BRR	MCDONOUGH	16	11
CONTRACT NO. 68G70				
ILLINOIS FED. AID PROJECT				

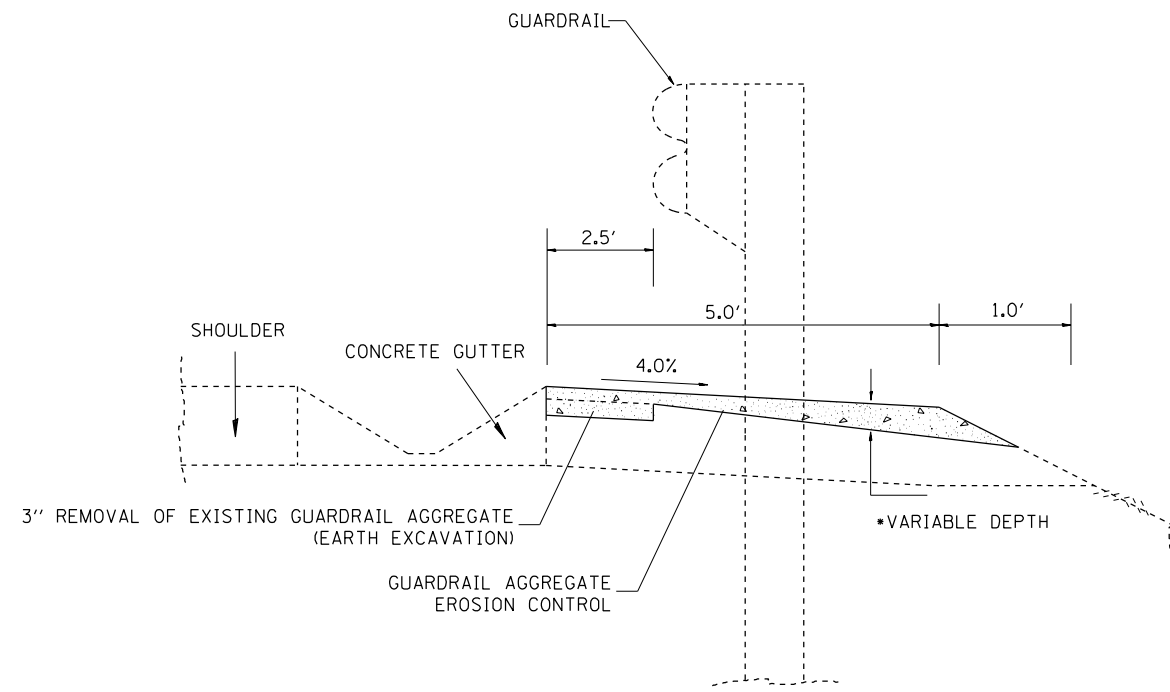

TYPICAL SECTION

GENERAL NOTES: GUARDRAIL AGGREGATE EROSION CONTROL

1. This work shall consist of placing and shaping crushed aggregate around and behind existing Steel Plate Beam Guardrail in accordance with this detail.
 2. No Geotextile Fabric needed.
 3. The aggregate shall be deposited, compacted and shaped by either mechanical or hand methods, in a manner reasonably true to line and grade.
 4. The crushed aggregate shall be CA1 gradation in accordance with Article 1004.01(c) of the Standard Specifications.
- * Depth may vary based on existing ground elevation. 3" of existing guardrail rock shall be removed between face of guardrail and the adjacent gutter (2.5' width). This removal will be paid for at the contract unit price per cubic yard for EARTH EXCAVATION.

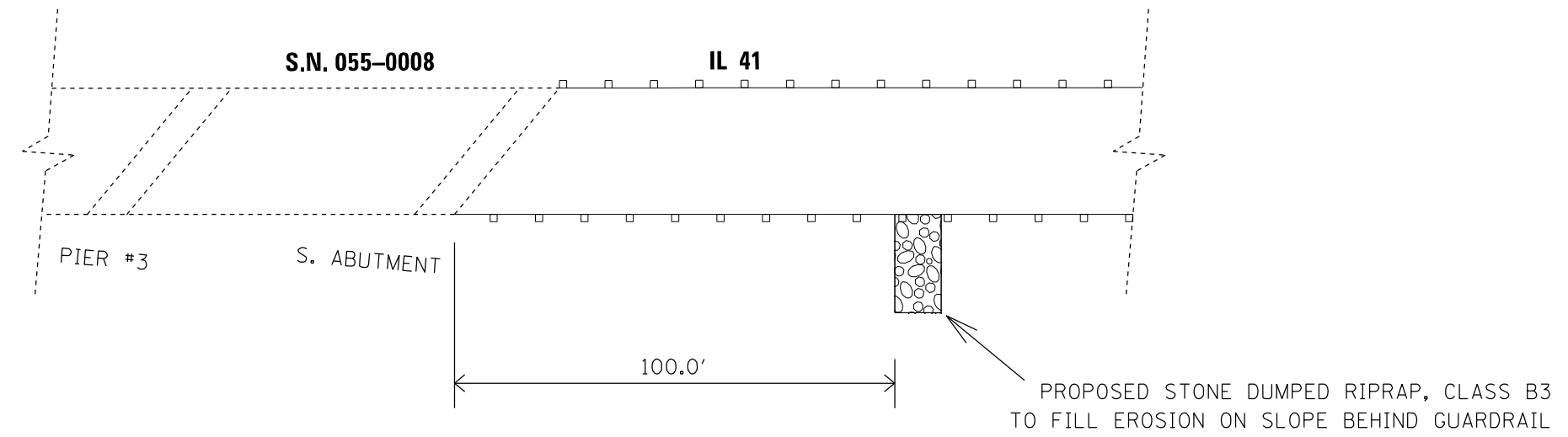

MODEL: Default
 FILE: \\mupic-pw-bentley.com\PW\DOT\Documents\DOT Office\Dir\ret. d\Project\ID_68G70\CADD\ba\CAD\sheet\DAxxxxx-shc-cover.dgn

USER NAME = greenom	DESIGNED -	REVISED -
	DRAWN -	REVISED -
PLOT SCALE = 100,0000 ' / in.	CHECKED -	REVISED -
PLOT DATE = 12/20/2021	DATE -	REVISED -

**STATE OF ILLINOIS
DEPARTMENT OF TRANSPORTATION**

GUARDRAIL EROSION CONTROL TREATMENT

SCALE: SHEET OF SHEETS STA. TO STA.

FAP RTE.	SECTION	COUNTY	TOTAL SHEETS	SHEET NO.
618	(35XVB-BR)BRR	McDONOUGH	16	12
CONTRACT NO. 68G70				
ILLINOIS FED. AID PROJECT				

PROPOSED CONCRETE GUTTER, TYPE A (SPECIAL)

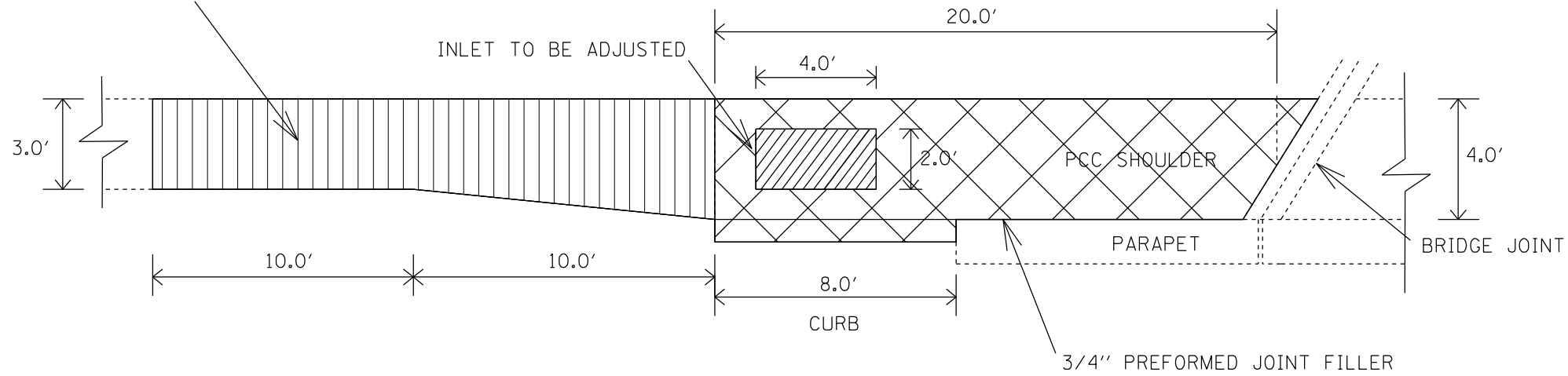

NW QUADRANT INLET

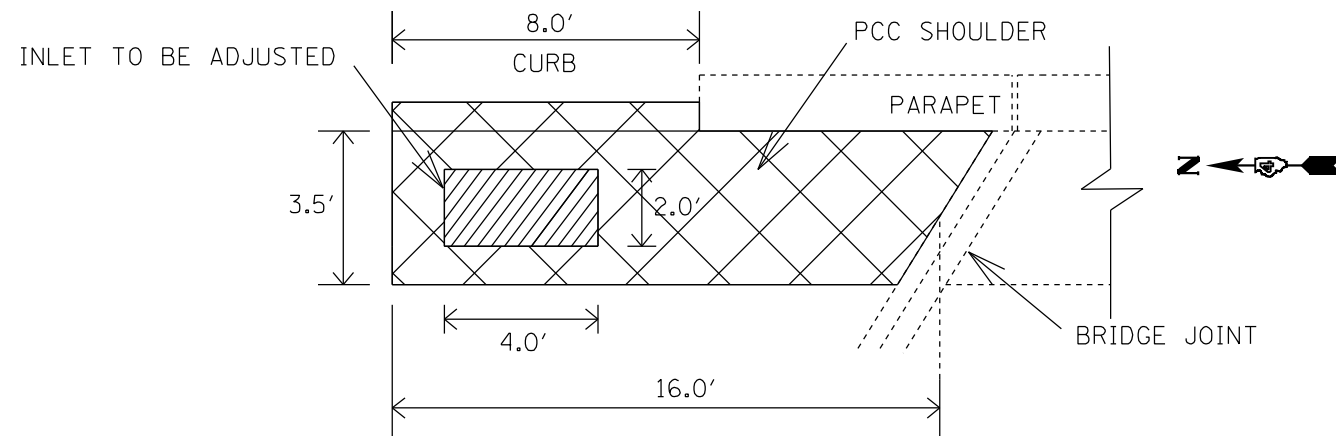

NE QUADRANT INLET

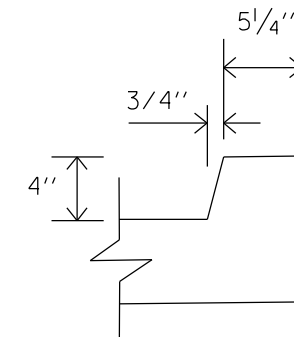

**CURB DETAIL
(CURB SHALL BE POURED WITH SHOULDER)**

NOTES:

1. 3/4" PREFORMED JOINT FILLER SHALL BE PLACED BETWEEN EXISTING PARAPET AND PROPOSED SHOULDER FROM THE END OF THE PARAPET TO THE BRIDGE EXPANSION JOINT. THE JOINT FILLER SHALL BE CONSIDERED INCLUDED IN THE COST OF PCC SHOULDERS 13".
2. CONCRETE CURB REMOVAL SHALL BE CONSIDERED INCLUDED IN THE COST OF PAVED SHOULDER REMOVAL. THE CONCRETE CURB SHALL BE REPLACED AND SHALL BE CONSIDERED INCLUDED IN THE COST OF PCC SHOULDERS 13".
3. THE EXISTING INLET SHALL BE REMOVED TO 8" BELOW THE TOP OF THE EXISTING RIM ELEVATION. THE TOP OF INLET ELEVATION SHALL BE ADJUSTED TO MATCH IN WITH ADJACENT PAVEMENT. THE EXISTING FRAMES AND GRATES SHALL BE USED.

LEGEND

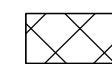

PAVED SHOULDER REMOVAL AND PROPOSED PORTLAND CEMENT CONCRETE SHOULDERS 13"



GUTTER REMOVAL AND PROPOSED CONCRETE GUTTER, TYPE A (SPECIAL)

MODEL: Default
 FILE: \\mfrs-pw-bentley.com\P\11001\Documents\11001_Offices\Director_d\Project\11001_68G70\CADD\Draws\CAD\Sheet\11001\Drawings\68G70.dgn

USER NAME = greenom	DESIGNED -	REVISED -
PLOT SCALE = 100,0000' / in.	DRAWN -	REVISED -
PLOT DATE = 12/20/2021	CHECKED -	REVISED -
	DATE -	REVISED -

**STATE OF ILLINOIS
DEPARTMENT OF TRANSPORTATION**

INLETS TO BE ADJUSTED DETAILS

SCALE: SHEET OF SHEETS STA. TO STA.

FAP RTE.	SECTION	COUNTY	TOTAL SHEETS	SHEET NO.
618	(35XVB-BR)BRR	McDONOUGH	16	13
CONTRACT NO. 68G70				
ILLINOIS FED. AID PROJECT				

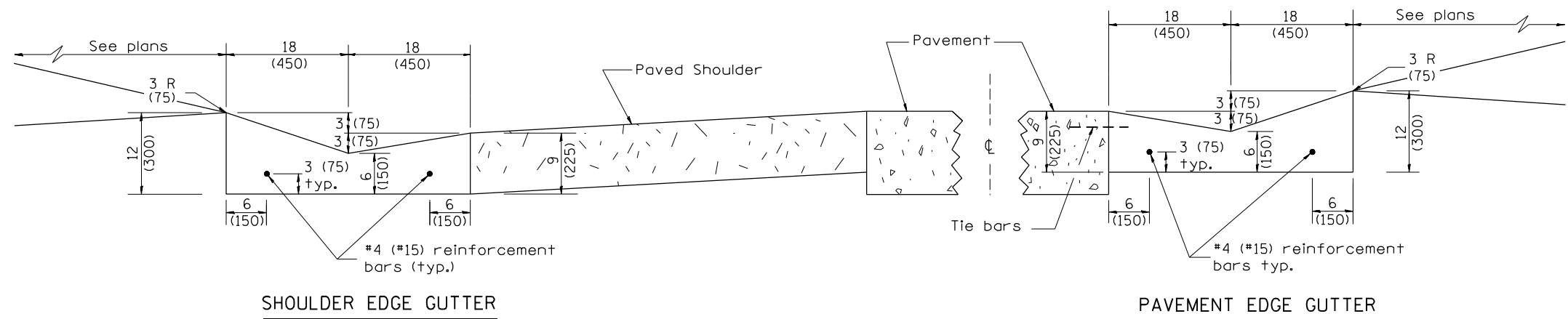

SHOULDER EDGE GUTTER

PAVEMENT EDGE GUTTER

CONCRETE GUTTER, TYPE A, (SPECIAL)

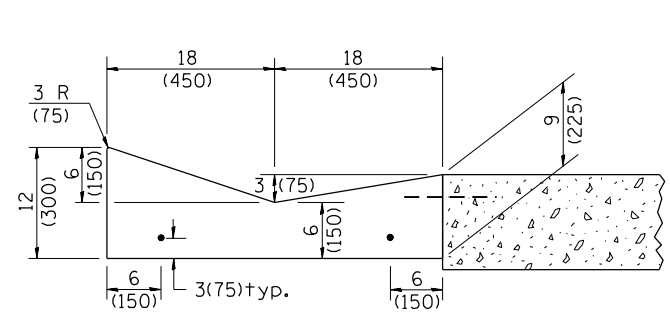

SECTION A-A

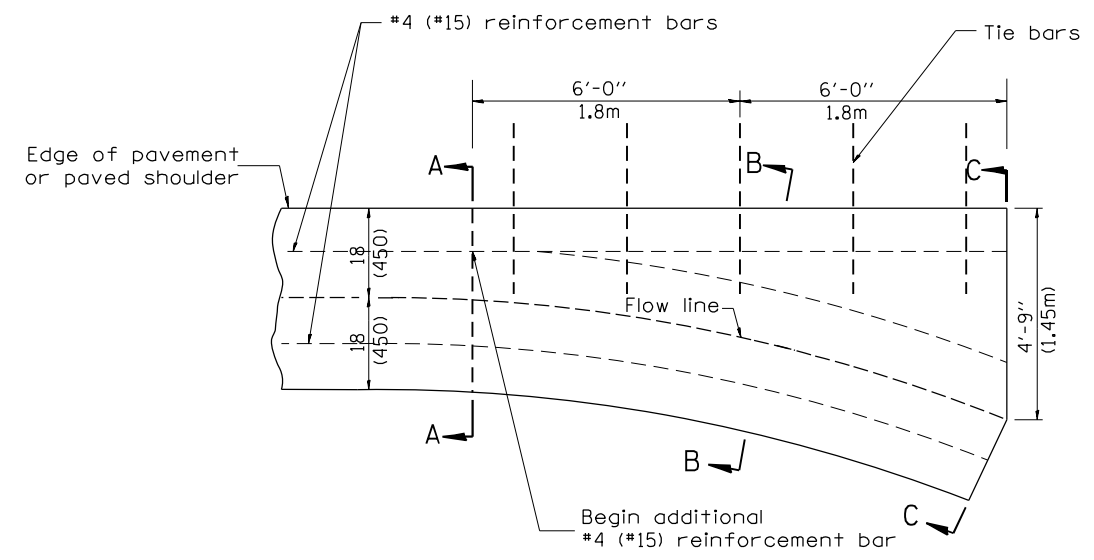

PLAN

QUANTITY
Section C-C to A-A= 1.2 cu. yd.
(0.92 m³) concrete.

GENERAL NOTES:

1. CONCRETE GUTTER, TYPE A, (SPECIAL) shall conform to the applicable portions of Section 606.
2. Tie bars shall be No. 6x24 (No. 19x600) at 36" (900mm) centers unless otherwise shown.
3. Gutter, gutter inlets, gutter outlets, and gutter entrances shall be tied to rigid pavement in accordance with details shown on Standard 420001.
4. Joints shall be constructed in accordance with Article 606.06.
5. Welded wire fabric shall conform to Article 1006.10(c)(1), and shall not be less than 58 lbs/100 sq.ft. (2.83 kg/m²).

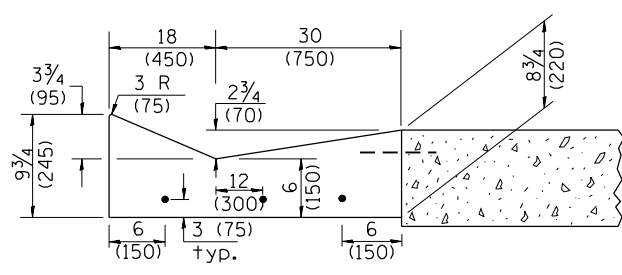

SECTION B-B

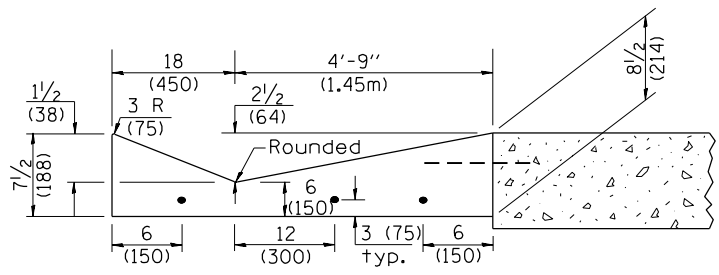

SECTION C-C

INLET

QUANTITIES
CALC. BY: _____ DATE: _____
CHECKED BY: _____ DATE: _____

QUANTITY CALCULATIONS ARE ON FILE AT THE DISTRICT 4 OFFICE; BUREAU OF PROJECT IMPLEMENTATION; DOCUMENTATION SECTION

01-01-97	RENUM. A-1.02, NEW REVISION BOX, ELIMINATED	T.P.	01-10-07	REVISED QUANTITY	M.A.
	EXPANSION ANCHOR TIES		11-16-07	REVISED QUANTITY	M.A.
02-28-02	ENTRANCE TYPICALS REVISED	M.A.	02-15-11	CHANGED MODIFIED TO SPECIAL	R.D.
10-16-06	REVISED TO 2007 SPEC.	M.A.	01-31-18	REVISED TIE BAR SIZE & SPACING	R.D.

**STATE OF ILLINOIS
DEPARTMENT OF TRANSPORTATION**

**CONCRETE GUTTER, TYPE A, (SPECIAL)
(INLET, OUTLET & ENTRANCE)**

NOT TO SCALE

SHT. 1 OF 3
CADD STD. 606101-D4

All dimensions are in inches (millimeters) unless otherwise noted.

FAP R.T.E.	SECTION	COUNTY	TOTAL SHEETS	SHEET NO.
618	(35XVB-BR)BRR	McDONOUGH	16	14
FED. ROAD DIST. NO. ILLINOIS FED. AID PROJECT			CONTRACT NO. 68G70	

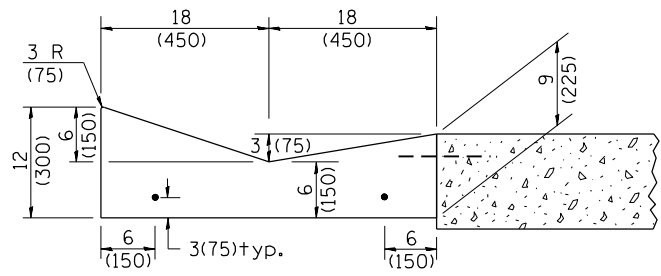

SECTION A-A

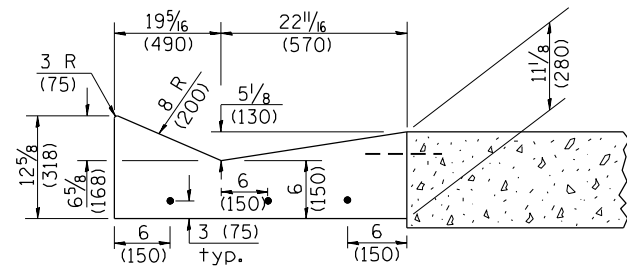

SECTION B-B

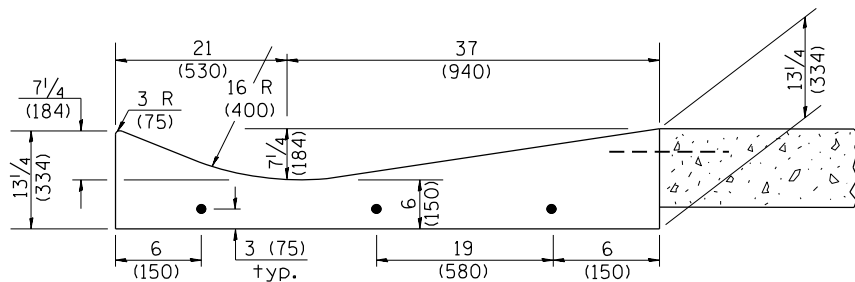

SECTION C-C

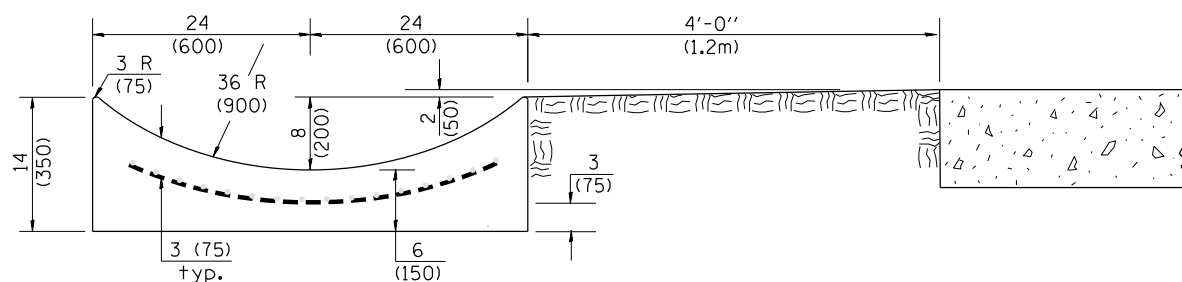

SECTION E-E

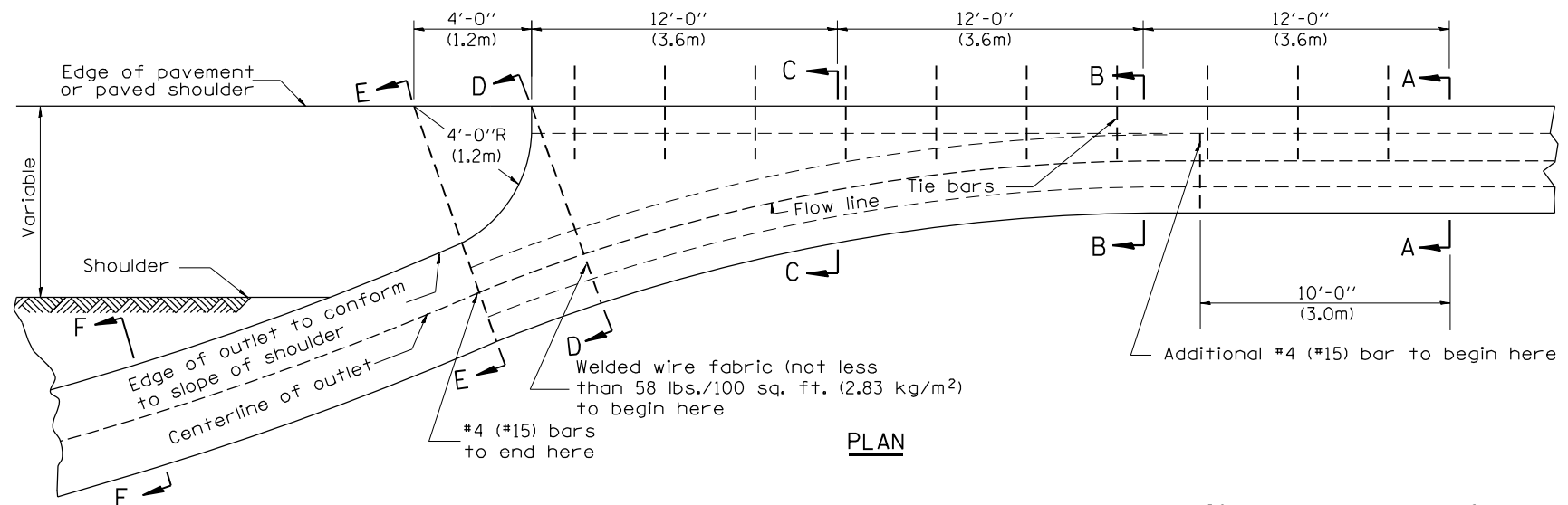

PLAN

QUANTITY
 Section A-A to E-E = 4.5 cu. yd. (3.36 m³) concrete.
 Section E-E to F-F = 0.10 cu. yd./ft. (0.26 m³/m) concrete.

If the average grade of pavement for the distance from section A-A to section D-D exceeds 2%, this distance shall be increased 6 ft. (1.8 m) for each 1% increase in grade. A quantity adjustment is required.

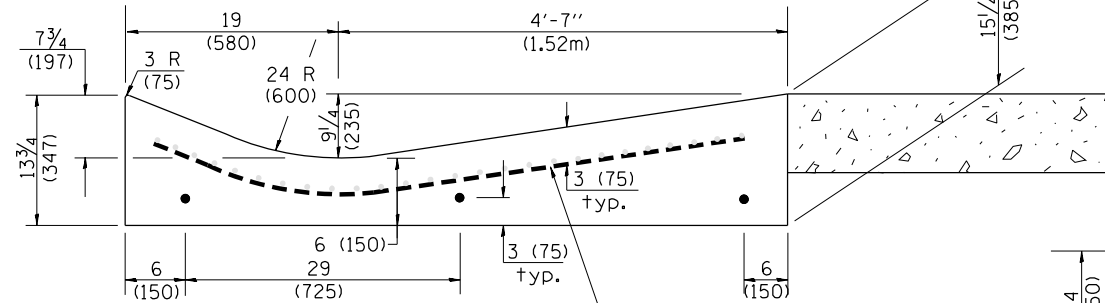

SECTION D-D

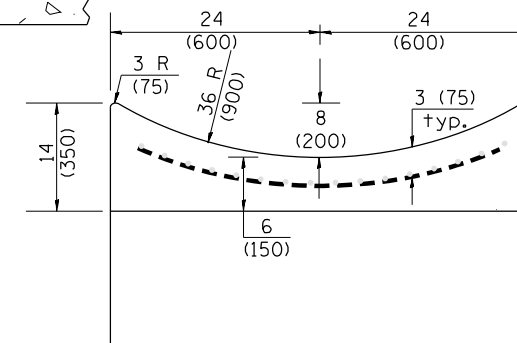

SECTION F-F

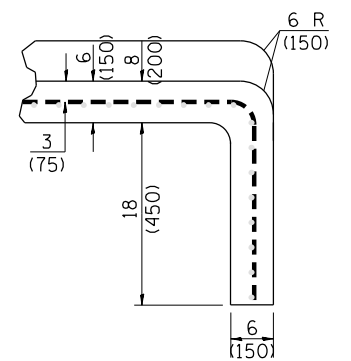

SECTIONS AT END OF OUTLET
(CURTAIN WALL)

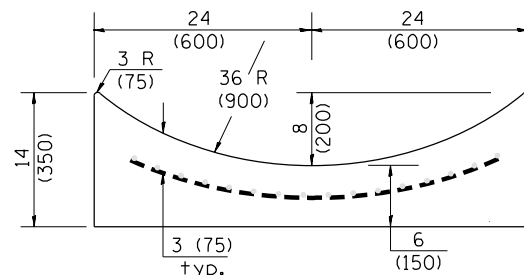

QUANTITY
 Curtain Wall = 0.1 cu. yd. (0.08 m³) concrete.

QUANTITIES
 CALC. BY: _____ DATE: _____
 CHECKED BY: _____ DATE: _____
 QUANTITY CALCULATIONS ARE ON FILE AT THE DISTRICT 4 OFFICE; BUREAU OF PROJECT IMPLEMENTATION; DOCUMENTATION SECTION

OUTLET

FAP R.T.E.	SECTION	COUNTY	TOTAL SHEETS	SHEET NO.
618	(35XVB-BR)BRR	McDONOUGH	16	15
CONTRACT NO. 68G70				
FED. ROAD DIST. NO. ILLINOIS FED. AID PROJECT				

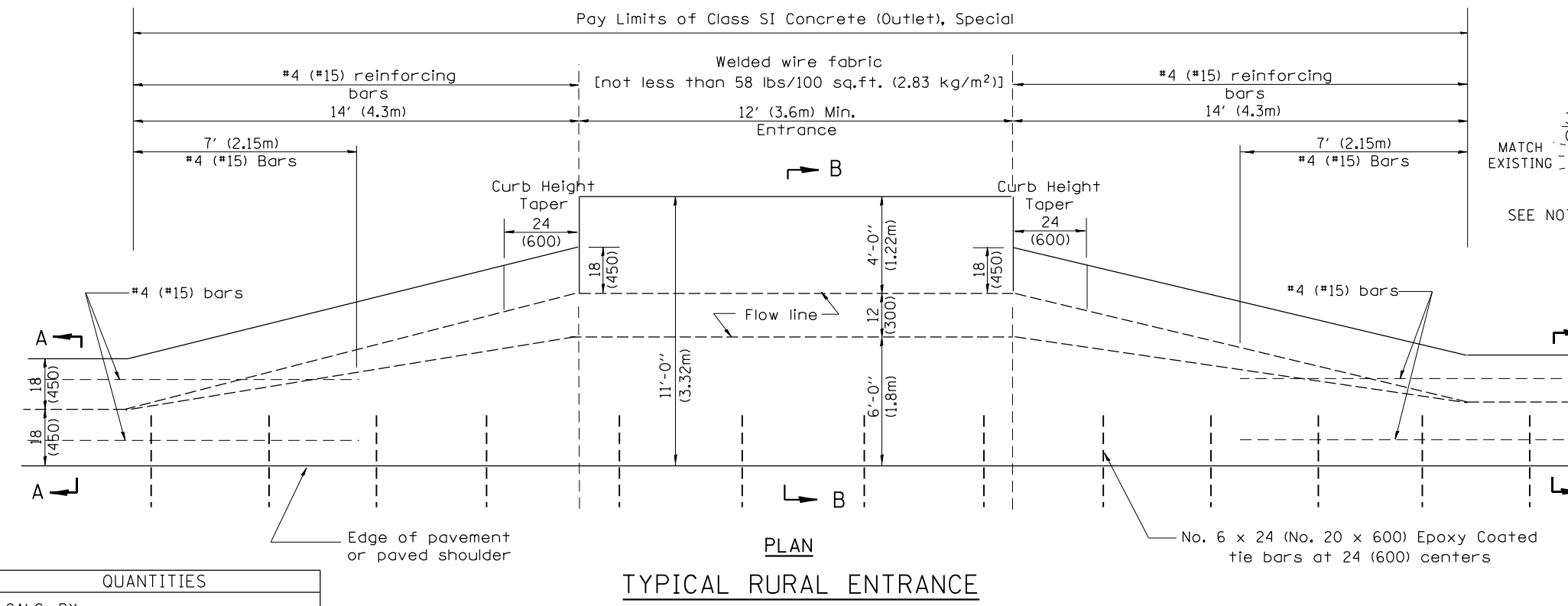
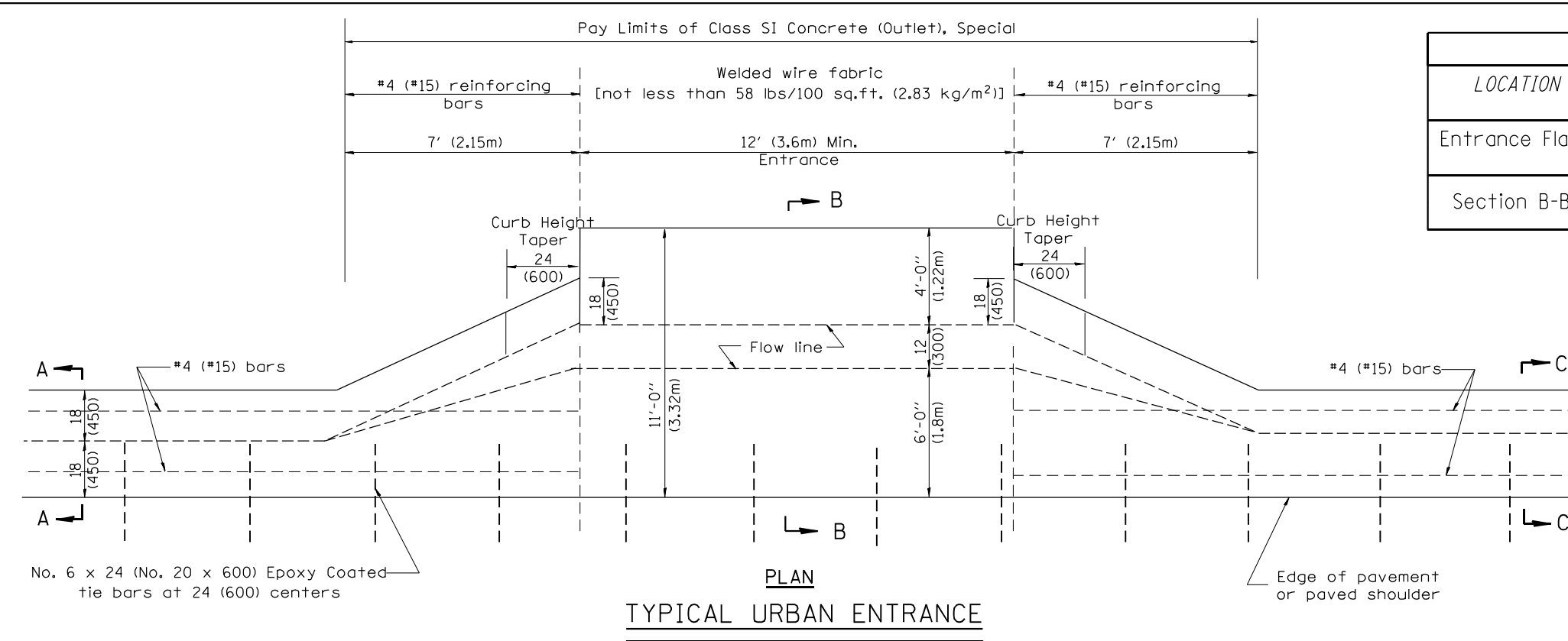

QUANTITIES

CALC. BY: _____ DATE: _____

CHECKED BY: _____ DATE: _____

QUANTITY CALCULATIONS ARE ON FILE AT THE DISTRICT 4 OFFICE; BUREAU OF PROJECT IMPLEMENTATION; DOCUMENTATION SECTION

QUANTITY CALCULATION			
LOCATION	LENGTH	NON-COMMERCIAL 6 (150)	COMMERCIAL ENTRANCE 8 (200)
Entrance Flare	7 Ft (2.15 m) Urban 14 Ft (4.30 m) Rural	0.15 Cu Yd / Ft (0.37 Cu M / M)	0.18 Cu Yd / Ft (0.45 Cu M / M)
Section B-B	See Plans	0.23 Cu Yd / Ft (0.57 Cu M / M)	0.28 Cu Yd / Ft (0.70 Cu M / M)

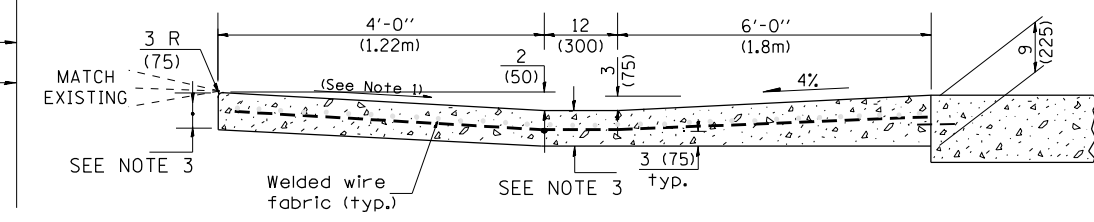
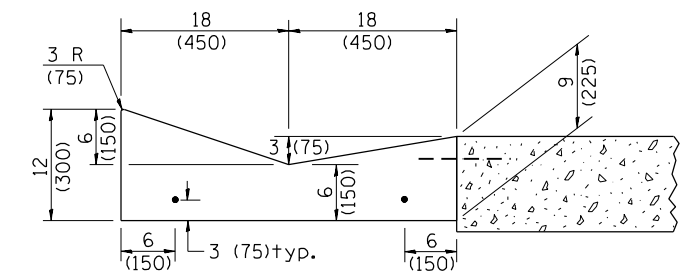

- GENERAL NOTES**
- Slope may be increased from 4% (min.) to 6% (max.) in order to match the existing.
 - The cross-slope is to be constructed as given in the plans from back turnout to where driveway matches existing.
 - For Non-Commercial Entrances the driveway thickness shall be 6 (150). For Commercial Entrances the driveway thickness shall be 8 (200).

All dimensions are in inches (millimeters) unless otherwise noted.

STATE OF ILLINOIS
DEPARTMENT OF TRANSPORTATION

CONCRETE GUTTER, TYPE A, (SPECIAL)
(INLET, OUTLET & ENTRANCE)

SHT. 3 OF 3
CADD STD. 606101-D4

FAP RTE.	SECTION	COUNTY	TOTAL SHEETS	SHEET NO.
618	(35XVB-BR)BRR	McDONOUGH	16	16
CONTRACT NO. 68G70				
FED. ROAD DIST. NO. ILLINOIS FED. AID PROJECT				

NOT TO SCALE