

STATE OF ILLINOIS
DEPARTMENT OF TRANSPORTATION

F.A.U. RTE.	SECTION	COUNTY	TOTAL SHEETS	SHEET NO.
6348	15RS-3	MCLEAN	27	1
		ILLINOIS	CONTRACT NO. 70E19	

FOR INDEX OF SHEETS, SEE SHEET NO. 2
FOR SUMMARY OF QUANTITIES, SEE SHEET NOS. 3-5

PROPOSED HIGHWAY PLANS

FAU ROUTE 6348 (OLD ROUTE 66)
SECTION 15 RS-3
PROJECT STP-MYQF(797)
DESIGNED OVERLAY
S OF VETERANS PKWY TO 1.7 MI SW
OF TOWANDA
MCLEAN COUNTY

TRAFFIC DATA:

F.A.U. 6348 (Old Rte 66)			
	Leg "A"	Leg "B"	
2019 ADT =	2,350	2,200	
P.V. % =	94.5	92.7	
S.U. % =	2.1	3.2	
M.U. % =	3.4	4.1	
FUNCT. CLASS.	MINOR ARTERIAL		
TRUCK RTE. =	NO	NO	
N.H.S. RTE. =	NO	NO	

Leg "A" is Old Rte 66 from Towanda Ave to Veteran's Pkwy SB Ra
Leg "B" is Old Rte 66 from Veteran's Pkwy SB Ramp to Airport Rd

DESIGN DESIGNATION	N/A
TOWNSHIP	NORMAL



FULL SIZE PLANS HAVE BEEN PREPARED USING STANDARD ENGINEERING SCALES. REDUCED SIZED PLANS WILL NOT CONFORM TO STANDARD SCALES. IN MAKING MEASUREMENTS ON REDUCED PLANS, THE ABOVE SCALES MAY BE USED.

J.U.L.I.E.
JOINT UTILITY LOCATION INFORMATION FOR EXCAVATORS
1-800-892-0123
OR 811

PROJECT ENGINEER: JASON STULTS, PE
SQUAD LEADER: JASON GOBLE
PHONE: (217) 465-4181
CONTRACT NO. 70E19

C-95-014-20

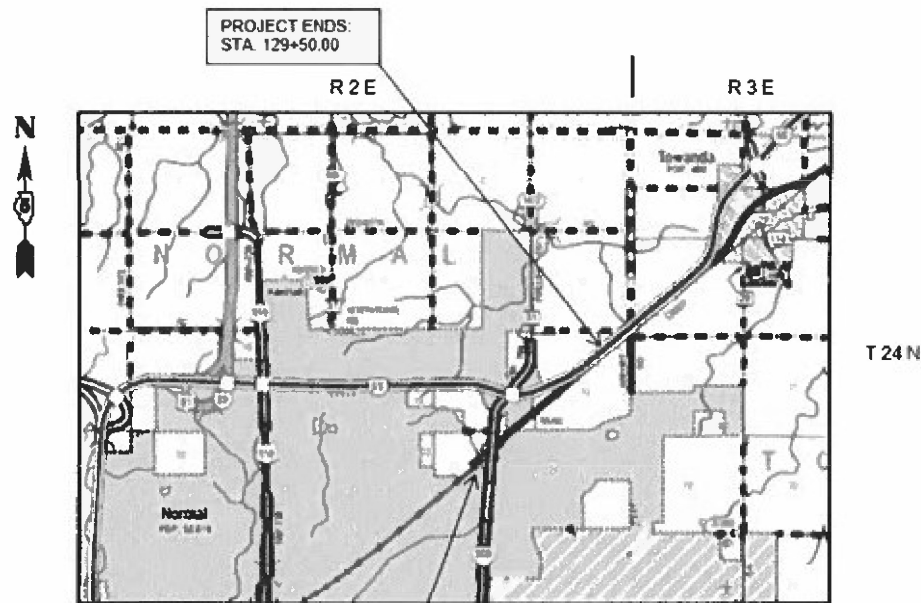

PROJECT ENDS:
STA 129+50.00

PROJECT BEGINS:
STA 37+64.00



GROSS LENGTH = 9,186.00 FT. = 1.739 MILE
NET LENGTH = 9,186.00 FT. = 1.739 MILE

P-95-003-20

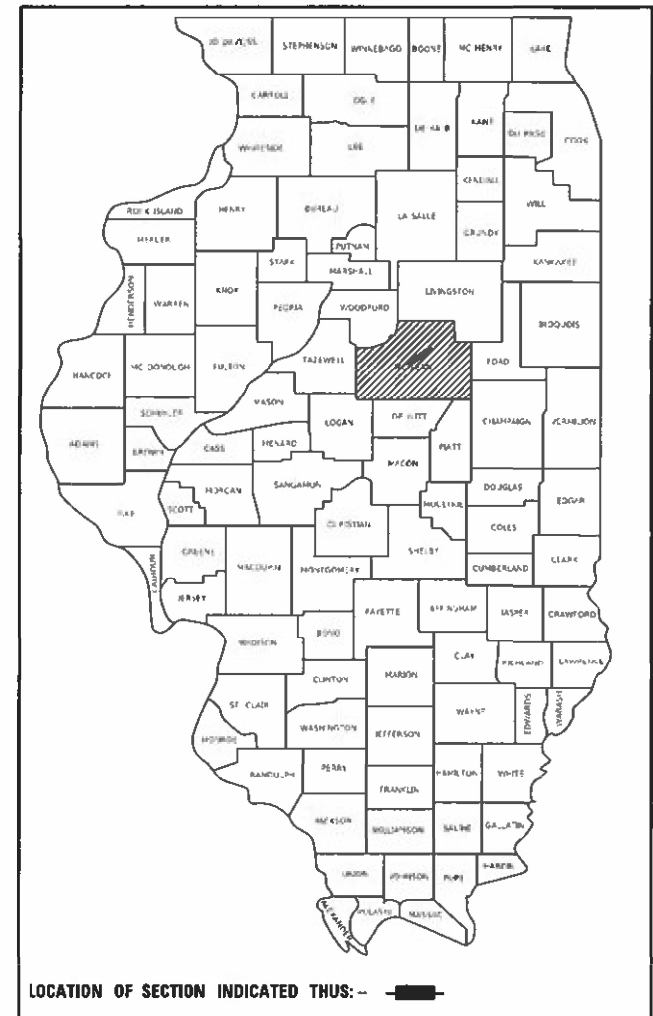

LOCATION OF SECTION INDICATED THIS: - [shaded area]

STATE OF ILLINOIS
DEPARTMENT OF TRANSPORTATION

SUBMITTED 12/17/2021
Kensil A. Barnett
REGIONAL ENGINEER

February 4, 2022
Stephen M. Faria
ENGINEER OF DESIGN AND ENVIRONMENT

February 4, 2022
Stephen M. Faria
DIRECTOR OF HIGHWAYS PROJECT IMPLEMENTATION

PRINTED BY THE AUTHORITY
OF THE STATE OF ILLINOIS

INDEX OF SHEETS:

1	COVER SHEET
2	INDEX OF SHEETS
2	HIGHWAY STANDARDS
2	GENERAL NOTES
2	COMMITMENTS
3-5	SUMMARY OF QUANTITIES
6-9	TYPICAL CROSS SECTIONS
10-12	SCHEDULE OF QUANTITIES
13-16	PLAN SHEET
17-18	DETAIL FOR SIDEROAD & SIDESTREETS (RURAL)
19-20	DETAIL FOR FIELD ENTRANCES (NONCOMMERCIAL RURAL)
21-22	DETAIL FOR PRIVATE COMMERCIAL ENTRANCES (NONCOMMERCIAL AND COMMERCIAL RURAL)
23-26	DETAIL FOR PAVEMENT MARKING AND MARKERS (RURAL & URBAN APPLICATIONS)
27	DETAIL FOR SURVEY MARKERS TYPE 1 & 2 (SPECIAL)

LIST OF HIGHWAY STANDARDS:

000001-08	STANDARD SYMBOLS, ABBREVIATIONS AND PATTERNS
001006	DECIMAL OF AN INCH AND OF A FOOT
442201-03	CLASS C AND D PATCHES
630001-12	STEEL PLATE BEAM GUARDRAIL
630301-09	SHOULDER WIDENING FOR TYPE 1 (SPECIAL) GUARDRAIL TERMINALS
701006-05	OFF-RD OPERATIONS, 2L, 2W, 15' TO 24" FROM PAVEMENT EDGE
701011-04	OFF-RD MOVING OPERATIONS, 2L, 2W, DAY ONLY
701201-05	LANE CLOSURE, 2L, 2W, DAY ONLY, FOR SPEEDS ≥ 45 MPH
701301-04	LANE CLOSURE, 2L, 2W, SHORT TIME OPERATIONS
701306-04	LANE CLOSURE, 2L, 2W, SLOW MOVING OPERATIONS DAY ONLY, FOR SPEEDS ≥ 45 MPH
701311-03	LANE CLOSURE 2L, 2W MOVING OPERATIONS-DAY ONLY
701901-08	TRAFFIC CONTROL DEVICES
725001-01	OBJECT AND TERMINAL MARKERS
780001-05	TYPICAL PAVEMENT MARKINGS
781001-04	TYPICAL APPLICATIONS RAISED REFLECTIVE PAVEMENT MARKERS
782006-01	GUARDRAIL AND BARRIER WALL REFLECTOR MOUNTING DETAILS

GENERAL NOTES:

G.N.-100A
ELECTRONIC FILES AND/OR ELECTRONIC SURVEY INFORMATION INCLUDING CADD FILES WILL NOT BE AVAILABLE TO THE CONTRACTOR.

G.N.-105.09A
ALL ELEVATIONS SHOWN IN THE PLANS ARE BASED ON NORTH AMERICAN VERTICAL DATUM OF 1988. (NAVD 88)

G.N.-406H
THE FOLLOWING MIXTURE REQUIREMENTS ARE APPLICABLE FOR THIS PROJECT:

Location	Old 66	Old 66	Old 66	Old 66
Mixture Use	Binder mainline	Surface mainline	Class D & P.D Patch	Incidental
AC/PG	PG 64-22	PG 64-22	PG 64-22	PG 64-22
Design Air Voids	4.0% @ Ndes=50	4.0% @ Ndes=50	4.0% @ Ndes=50	4.0% @ Ndes=50
Mix Comp(Gradation)	IL 19.0	IL 9.5	IL 19.0	IL 9.5
Friction Aggregate	N.A.	Mix C	Mix C	Mix C
Mixture Weight	112	112	112	112
Quality Management Program	QCP	QCP	QC/QA	QC/QA
Sublot Size	1000	1000	N.A.	N.A.
Material Transfer Device (Required ?)	NO	NO	NO	NO

G.N.- 703A
SHORT TERM PAVEMENT MARKING SHALL BE APPLIED TO THE PAVEMENT AFTER ANY OF THE FOLLOWING: COLD MILLING AND/OR PLACING BITUMINOUS MATERIALS (TACK COAT), BINDER AND SURFACE COURSES. SHORT TERM PAVEMENT MARKING PLACED ON THE SURFACE SHALL COINCIDE WITH THE FINAL PAVEMENT STRIPING. SHORT TERM PAVEMENT MARKING PLACED PRIOR TO THE SURFACE SHALL COINCIDE WITH THE EXISTING PAVEMENT MARKINGS. USE 4 FEET PER 40 FEET (OR 10% PER STATION).

G.N.- 781
THE FINAL PAVEMENT MARKINGS SHALL BE IN PLACE PRIOR TO PLACING THE RAISED REFLECTIVE PAVEMENT MARKERS.

COMMITMENTS:

NO COMMITMENTS REQUIRED FOR THIS PROJECT.

MODEL: I:\MODEL\NAME FILE: NAME: P:\Public\paw_bentley.com\P\INDOT\Documents\DOT Office\Dir\dir: S:\Project\10570E 19\CADD\data\CAD\Sheet\10570E 19\sh-Centhorcs.dgn

USER NAME = g01lejr	DESIGNED - JRG	REVISED -
	DRAWN - JRG	REVISED -
PLOT SCALE = 40,0000 * / in.	CHECKED -	REVISED -
PLOT DATE = 1/27/2022	DATE -	REVISED -

**STATE OF ILLINOIS
DEPARTMENT OF TRANSPORTATION**

**INDEX OF SHEETS, HIGHWAY STANDARDS
GENERAL NOTES, COMMITMENTS**

SCALE: NTS SHEET 1 OF SHEETS STA. TO STA.

F.A.U. RTE.	SECTION	COUNTY	TOTAL SHEETS	SHEET NO.
6348	15R5-3	MCLEAN	27	2
				CONTRACT NO. 70E19
ILLINOIS FED. AID PROJECT				

LOCATION OF WORK:

FAU 6348 (OLD US 66)

URBAN

MIN. ARTERIAL

STA. 37+64.00 TO STA. 129+50.00

MCLEAN

FEDERAL 80% / STATE 20%

0005

COUNTY:

FUNDING BREAKOUT:

CONSTRUCTION TYPE CODE:

CODE NO.	ITEM	UNIT	TOTAL QUANTITY	QUANTITY
40200800	AGGREGATE SURFACE COURSE, TYPE B	TON	12.0	12.0
40600290	BITUMINOUS MATERIALS (TACK COAT)	POUND	16,536.0	16,536.0
40600370	LONGITUDINAL JOINT SEALANT	FOOT	9,186.0	9,186.0
40600990	TEMPORARY RAMP	SQ YD	235.0	235.0
40603080	HOT-MIX ASPHALT BINDER COURSE, IL-19.0, N50	TON	3,087.0	3,087.0
40604050	HOT-MIX ASPHALT SURFACE COURSE, IL-9.5, MIX "C", N50	TON	2,059.0	2,059.0
40800029	BITUMINOUS MATERIALS (TACK COAT)	POUND	129.0	129.0
40800050	INCIDENTAL HOT-MIX ASPHALT SURFACING	TON	24.0	24.0
44000164	HOT-MIX ASPHALT SURFACE REMOVAL, 3 3/4"	SQ YD	24,497.0	24,497.0
44201815	CLASS D PATCHES, TYPE II, 14 INCH	SQ YD	144.0	144.0
44201821	CLASS D PATCHES, TYPE IV, 14 INCH	SQ YD	100.0	100.0
48102100	AGGREGATE WEDGE SHOULDER, TYPE B	TON	312.0	312.0
* 63000001	STEEL PLATE BEAM GUARDRAIL, TYPE A, 6 FOOT POSTS	FOOT	103.0	103.0
* 63100167	TRAFFIC BARRIER TERMINAL, TYPE 1 (SPECIAL) TANGENT	EACH	2.0	2.0
* SPECIALTY ITEM				

MODEL: I:\MODEL\MMF5
 FILE: MMF5_Plan\Subcontract\benefy.com\FW\DOT\Documents\DOT Office\Dir\dir: S:\Project\0570E19\CADD\data\CAD\Sheet\0570E19\sh-500.dwg

USER NAME = goblejr	DESIGNED - JRG	REVISED -
PLOT SCALE = 40,0000 */ in.	DRAWN - JRG	REVISED -
PLOT DATE = 12/17/2021	CHECKED -	REVISED -
	DATE -	REVISED -

**STATE OF ILLINOIS
DEPARTMENT OF TRANSPORTATION**

SUMMARY OF QUANTITIES

SCALE: NTS SHEET 1 OF 3 SHEETS STA. TO STA.

F.A.U. RTE.	SECTION	COUNTY	TOTAL SHEETS	SHEET NO.
6348	15RS-3	MCLEAN	27	3
CONTRACT NO. 70E19				
ILLINOIS FED. AID PROJECT				

LOCATION OF WORK:

FAU 6348 (OLD US 66)

URBAN

MIN. ARTERIAL

STA. 37+64.00 TO STA. 129+50.00

MCLEAN

FEDERAL 80% / STATE 20%

0005

COUNTY:

FUNDING BREAKOUT:

CONSTRUCTION TYPE CODE:

CODE NO.	ITEM	UNIT	TOTAL QUANTITY	QUANTITY
63200310	GUARDRAIL REMOVAL	FOOT	180.0	180.0
67100100	MOBILIZATION	L SUM	1.0	1.0
70100450	TRAFFIC CONTROL AND PROTECTION, STANDARD 701201	L SUM	1.0	1.0
70100460	TRAFFIC CONTROL AND PROTECTION, STANDARD 701306	L SUM	1.0	1.0
70300100	SHORT TERM PAVEMENT MARKING	FOOT	2,765.0	2,765.0
70300150	SHORT TERM PAVEMENT MARKING REMOVAL	SQ FT	923.0	923.0
70300221	TEMPORARY PAVEMENT MARKING - LINE 4" - PAINT	FOOT	26,096.0	26,096.0
* 72501000	TERMINAL MARKER - DIRECT APPLIED	EACH	2.0	2.0
* 78001110	PAINT PAVEMENT MARKING - LINE 4"	FOOT	26,096.0	26,096.0
* 78100100	RAISED REFLECTIVE PAVEMENT MARKER	EACH	221.0	221.0
* 78200005	GUARDRAIL REFLECTORS, TYPE A	EACH	9.0	9.0
78300200	RAISED REFLECTIVE PAVEMENT MARKER REMOVAL	EACH	221.0	221.0
X0327584	GRADING & SHAPING SHOULDERS, SPECIAL	FOOT	9,101.0	9,101.0
X4400196	HOT-MIX ASPHALT SURFACE REMOVAL, SPECIAL	SQ YD	286.0	286.0
* SPECIALTY ITEM				

MODEL: I:\MODEL\NAMES
FILE: NAME: P:\Public\paw_bentley.com\FW\DOT\Documents\DOT Office\Dir\dir: S:\Project\0570E19\CADD\data\CAD\Sheet\0570E19\sh-500.dwg

USER NAME = g01lejr	DESIGNED - JRG	REVISED -
	DRAWN - JRG	REVISED -
PLOT SCALE = 40,0000 */ in.	CHECKED -	REVISED -
PLOT DATE = 12/17/2021	DATE -	REVISED -

**STATE OF ILLINOIS
DEPARTMENT OF TRANSPORTATION**

SUMMARY OF QUANTITIES

SCALE: NTS SHEET 2 OF 3 SHEETS STA. TO STA.

F.A.U. RTE.	SECTION	COUNTY	TOTAL SHEETS	SHEET NO.
6348	15RS-3	MCLEAN	27	4
CONTRACT NO. 70E19			ILLINOIS FED. AID PROJECT	

(A) EXISTING TYPICAL CROSS SECTION

STATION TO STATION

STA. 37+64.00 TO STA. 56+45.00 (B)
 (B) STA. 62+48.00 TO STA. 129+50.00
 MCLEAN COUNTY

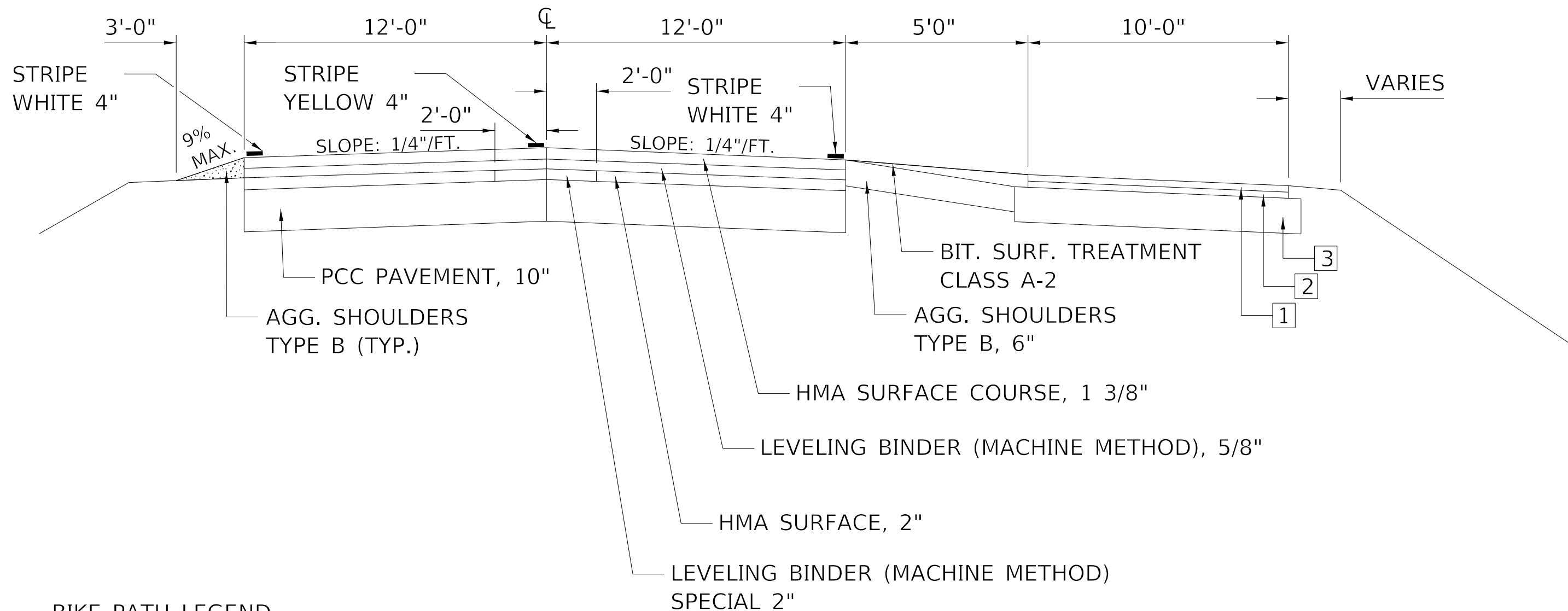

BIKE PATH LEGEND

- 1 HOT-MIX ASPHALT SURFACE COURSE,, MIX "C", N50 1 1/2"
- 2 LEVELING BINDER (MACHINE METHOD), IL 9.5FG, N50 1 1/2"
- 3 SUB-BASE GRANULAR MATERIAL, TYPE B 8"

MODEL: I:\MODEL\MAME FILE: MAME: p:\pub\cpx\beefy.com\p\INDOT\Documents\DOT Office\Dir\dr: S:\Project\10570E 19\CADD\DATA\CAD\Sheet\10570E 19\st\Typical.dgn

USER NAME = goblejr	DESIGNED - JRG	REVISED -
	DRAWN - JRG	REVISED -
PLOT SCALE = 40,0000 * / in.	CHECKED -	REVISED -
PLOT DATE = 12/17/2021	DATE -	REVISED -

**STATE OF ILLINOIS
DEPARTMENT OF TRANSPORTATION**

EXISTING TYPICAL SECTIONS	
SCALE: NTS	SHEET 1 OF 2 SHEETS STA. TO STA.

F.A.U. RTE.	SECTION	COUNTY	TOTAL SHEETS	SHEET NO.
6348	15RS-3	MCLEAN	27	6
CONTRACT NO. 70E19				
ILLINOIS FED. AID PROJECT				

(B) EXISTING TYPICAL CROSS SECTION

STATION TO STATION

(A) STA. 56+45.00 TO STA. 62+48.00 (A)

MCLEAN COUNTY

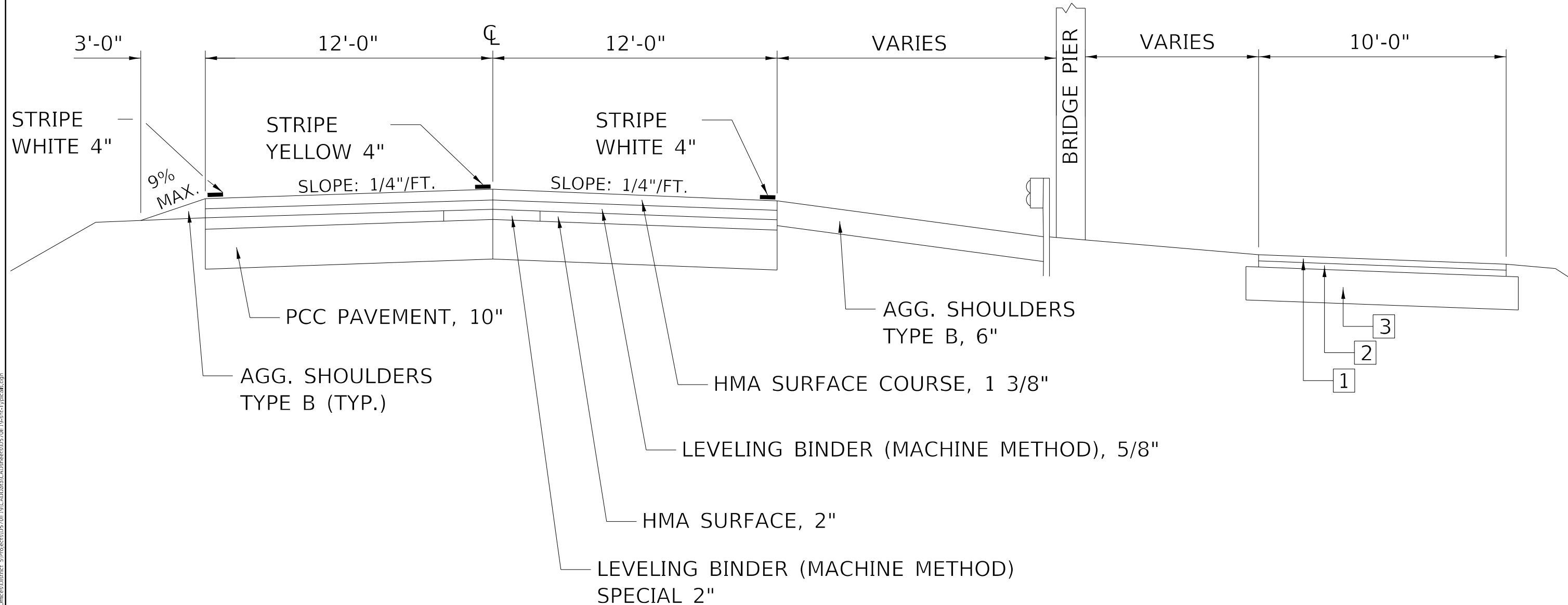

BIKE PATH LEGEND

- 1 HOT-MIX ASPHALT SURFACE COURSE,, MIX "C", N50 1 1/2"
- 2 LEVELING BINDER (MACHINE METHOD), IL 9.5FG, N50 1 1/2"
- 3 SUB-BASE GRANULAR MATERIAL, TYPE B 8"

MODEL: I:\MODEL\MAME
 FILE: MAME: p:\pub\cpx\beefy.com\p\INDOT\Documents\DOT\Office\Dir\dr: S:\Project\10570E\19\CADD\data\CAD\Sheet\10570E19\sh1Typical.dgn

USER NAME = goblejr	DESIGNED - JRG	REVISED -
	DRAWN - JRG	REVISED -
PLOT SCALE = 40,0000 * / in.	CHECKED -	REVISED -
PLOT DATE = 12/17/2021	DATE -	REVISED -

**STATE OF ILLINOIS
DEPARTMENT OF TRANSPORTATION**

EXISTING TYPICAL SECTIONS			
SCALE: NTS	SHEET 2	OF 2 SHEETS	STA. TO STA.

F.A.U. RTE.	SECTION	COUNTY	TOTAL SHEETS	SHEET NO.
6348	15RS-3	MCLEAN	27	7
CONTRACT NO. 70E19				
ILLINOIS FED. AID PROJECT				

1 PROPOSED TYPICAL CROSS SECTION

STATION TO STATION

STA. 37+64.00 TO STA. 56+45.00 ②
 ② STA. 62+48.00 TO STA. 129+50.00

MCLEAN COUNTY

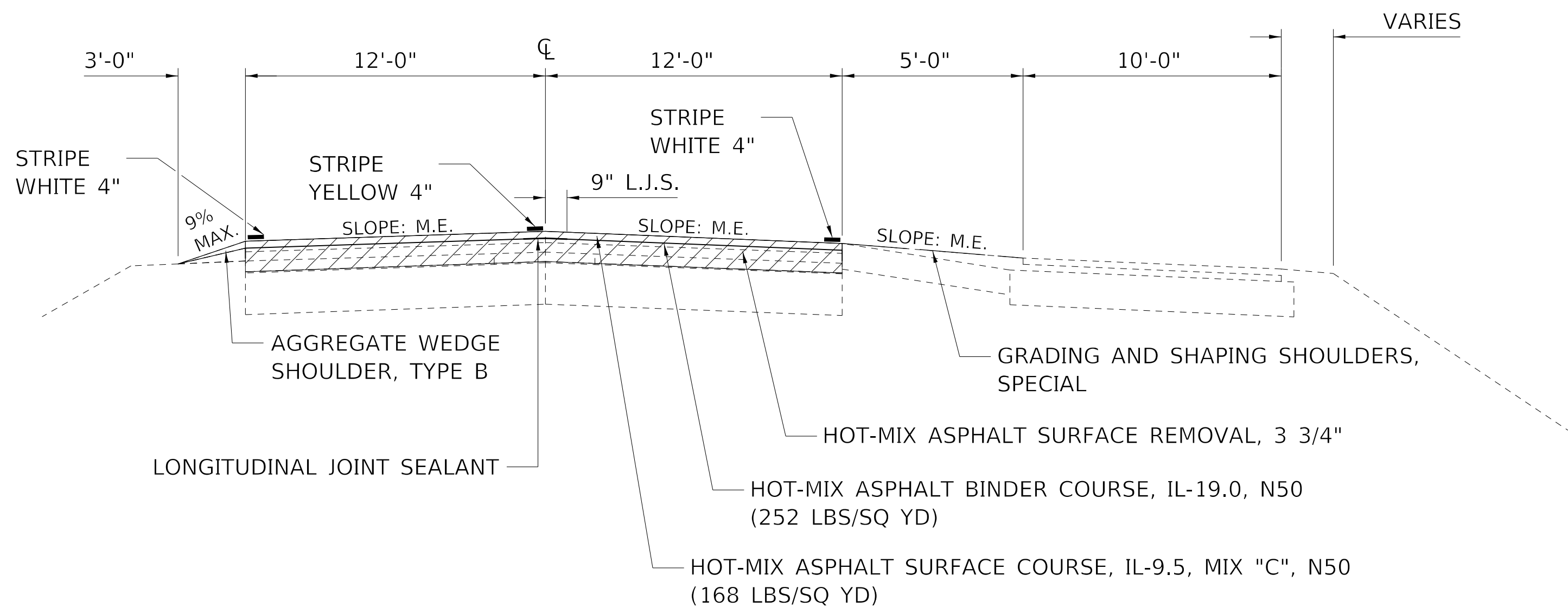

MODEL: I:\MODEL\MAME
 FILE: MAME_191118.dwg
 PROJECT: I:\PROJECTS\1570E\191118.dwg
 USER: JRG
 DATE: 12/17/2021

USER NAME = jrg	DESIGNED - JRG	REVISED -
PLOT SCALE = 40,0000 * / in.	DRAWN - JRG	REVISED -
PLOT DATE = 12/17/2021	CHECKED -	REVISED -
	DATE -	REVISED -

STATE OF ILLINOIS
DEPARTMENT OF TRANSPORTATION

PROPOSED TYPICAL SECTIONS			
SCALE: NTS	SHEET 3	OF 4 SHEETS	STA. TO STA.

F.A.U. RTE.	SECTION	COUNTY	TOTAL SHEETS	SHEET NO.
6348	15RS-3	MCLEAN	27	8
CONTRACT NO. 70E19				
ILLINOIS FED. AID PROJECT				

② PROPOSED TYPICAL CROSS SECTION

STATION TO STATION

① STA. 56+45.00 TO STA. 62+48.00 ①

MCLEAN COUNTY

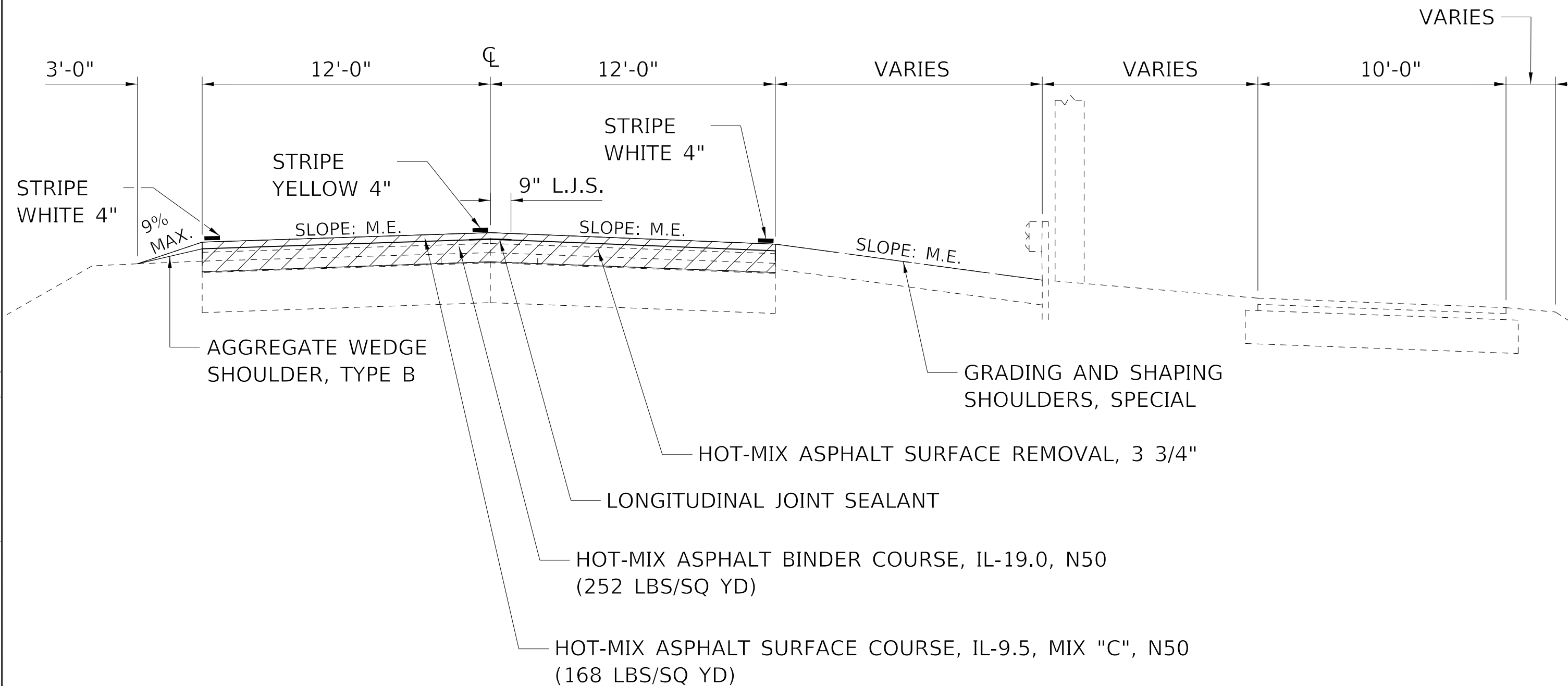

MODEL: I:\MODELS\MHFE
FILE: MHFE.dwg
PLOT DATE: 12/17/2021

USER NAME = goblejr	DESIGNED - JRG	REVISED -
	DRAWN - JRG	REVISED -
PLOT SCALE = 40,0000 * / in.	CHECKED -	REVISED -
PLOT DATE = 12/17/2021	DATE -	REVISED -

**STATE OF ILLINOIS
DEPARTMENT OF TRANSPORTATION**

PROPOSED TYPICAL SECTIONS

SCALE: NTS SHEET 4 OF 4 SHEETS STA. TO STA.

F.A.U. RTE.	SECTION	COUNTY	TOTAL SHEETS	SHEET NO.
6348	15RS-3	MCLEAN	27	9
CONTRACT NO. 70E19				
ILLINOIS FED. AID PROJECT				

HOT-MIX ASPHALT - MAINLINE SCHEDULE

LOCATION	STATION	TO	STATION	LENGTH (FT)	AVE. WIDTH (FT)	AREA (SQ YD)	HMA BINDER THICKNESS (INCHES)	HMA SURFACE THICKNESS (INCHES)	**40600290	40603080	40604050		
									BITUMINOUS MATERIAL TACK COAT (POUND)	HMA BINDER IL-19.0 N50 (TON)	HMA SURFACE IL-9.5"C" N50 (TON)		
FAU 6348													
MCLEAN COUNTY (URBAN)													
RT.	TRAVEL LANE		37+64.00		129+50.00	9186.00	12.00	12248.00	2.25	1.50	8268.40	1543.25	1029.83
LT.	TRAVEL LANE		37+64.00		129+50.00	9186.00	12.00	12248.00	2.25	1.50	8267.40	1543.25	1028.83
									FAU 6348 TOTAL =		16535.80	3086.50	2058.66
									USE =		16536.00	3087.00	2059.00
											POUND	TON	TON

**0.05 LB/SQ FT ON MILLED HMA, 0.025 LB/SQ FT BETWEEN HMA LIFTS

HOT-MIX ASPHALT - ENTRANCES, SIDEROADS, MAIL BOX TURNOUTS SCHEDULE

LOCATION	TYPE	SURFACE	AREA OF EX AGG (SQ YD)	AVG. HMA THICKNESS (INCH)	PRIME / TACK COAT APPLICATION RATE (LB/SQ FT)	X4400196	40800029	40800050	40200800	
						HOT-MIX ASPHALT SURFACE REMOVAL, SPECIAL (SQ YD)	BITUMINOUS MATERIALS (TACK COAT) (POUND)	INCIDENTAL HMA SURFACING (TON)	AGGREGATE SURFACE COURSE, TYPE B (TON)	
FAU 6348										
MCLEAN COUNTY (URBAN)										
LT.	STA 65+32.00	F.E.	AGG.	30.10	0.05 / 0.25				6.51	
LT.	STA 77+33.00	C.E.	HMA		1.50	0.05 / 0.25	145.60	65.52	12.23	
LT.	STA 85+89.00	PAPER CHASE ST	HMA		1.50	0.05 / 0.25	140.40	63.18	11.79	
LT.	STA 89+13.00	P.E.	AGG.	55.80	0.05 / 0.25				12.07	
						FAU 6348 TOTAL =	286.00	128.70	24.02	12.07
						USE =	286.00	129.00	24.00	12.00
							SQ YD	POUND	TON	TON

40600370 LONGITUDINAL JOINT SEALANT

LOCATION	STATION	TO	STATION	40600370
				LENGTH (FT)
FAU 6348				
MCLEAN COUNTY (URBAN)				
MAINLINE	C.L.		37+64.00	
			129+50.00	9186.00
				FAU 6348 TOTAL =
				9186.00
				USE =
				9186.00
				FT

MODEL: I:\MODEL\MHMF
FILE: Mainline_Plan\Subcontractor\WINDOT\Documents\DOT\Office\Dir\dir: S:\Project\10570E 19\CADD\data\CAD\Sheet\10570E 19\sh-Schedule.dwg

USER NAME = g0t0r	DESIGNED - JRG	REVISED -
	DRAWN - JRG	REVISED -
PLOT SCALE = 40,0000 */ in.	CHECKED -	REVISED -
PLOT DATE = 12/17/2021	DATE -	REVISED -

**STATE OF ILLINOIS
DEPARTMENT OF TRANSPORTATION**

SCHEDULE OF QUANTITIES

SCALE: NTS SHEET 2 OF 3 SHEETS STA. TO STA.

F.A.U. RTE.	SECTION	COUNTY	TOTAL SHEETS	SHEET NO.
6348	15RS-3	MCLEAN	27	10
CONTRACT NO. 70E19				
ILLINOIS FED. AID PROJECT				

70300100 SHORT TERM PAVEMENT MARKING

70300150 SHORT TERM PAVEMENT MARKING REMOVAL

				70300100				70300150
LOCATION	STATION	TO	STATION	QUANTITY (FT)	APPLY AFTER	APPLY TO	COLOR	QUANTITY (SQ FT)
FAU 6348								
MCLEAN COUNTY (URBAN)								
LT.	CENTERLINE	37+64.00	129+50.00	2765.0	(1) MILLING (2) HMA BINDER (3) HMA SURFACE	C.L.	YELLOW	922.7
				FAU 6348 TOTAL =				923.0
				USE =				923.0
				FT				SQ FT

70300221 TEMPORARY PAVEMENT MARKING - LINE 4" - PAINT

						70300221
LOCATION		STATION	TO	STATION	QUANTITY (FT)	COLOR
FAU 6348						
MCLEAN COUNTY (URBAN)						
RT.	EDGE LINE	37+64.00		129+50.00	9186.0	WHITE
LT.	EDGE LINE	37+64.00		52+22.00	1458.0	WHITE
LT.	EDGE LINE	53+36.50		76+44.00	2308.0	WHITE
LT.	EDGE LINE	77+85.00		84+97.00	712.0	WHITE
LT.	EDGE LINE	86+37.00		129+50.00	4313.0	WHITE
LT. / RT.	NO PASS DOUBLE	37+64.00		51+10.00	2692.0	YELLOW
RT.	NO PASS	51+10.00		58+02.00	882.0	YELLOW
LT. / RT.	NO PASS DOUBLE	58+02.00		61+29.00	654.0	YELLOW
LT.	NO PASS	61+29.00		67+65.00	806.0	YELLOW
RT.	CENTERLINE SKIP-DASH	67+65.00		72+32.00	140.0	YELLOW
RT.	NO PASS	72+32.00		80+22.00	1000.0	YELLOW
RT.	CENTERLINE SKIP-DASH	80+22.00		82+25.00	70.0	YELLOW
LT.	NO PASS	82+25.00		88+90.00	845.0	YELLOW
RT.	CENTERLINE SKIP-DASH	88+90.00		129+50.00	1030.0	YELLOW
					FAU 6348 TOTAL =	26096.00
					USE =	26096.00

78100100 RAISED REFLECTIVE PAVEMENT MARKER

78300200 RAISED REFLECTIVE PAVEMENT MARKER REMOVAL

					78100100	78300200	
LOCATION		STATION	TO	STATION	LENGTH (FT)	TWO-WAY AMBER QUANTITY (EACH)	RRPM REMOVAL QUANTITY (EACH)
FAU 6348							
MCLEAN COUNTY (URBAN)							
NO PASS DOUBLE	C.L.	37+64.00		51+10.00	1346.00	70.0	70.0
NO PASS	C.L.	51+10.00		58+02.00	692.00	18.0	18.0
NO PASS DOUBLE	C.L.	58+02.00		61+29.00	327.00	18.0	18.0
NO PASS	C.L.	61+29.00		67+63.00	634.00	16.0	16.0
SINGLE	C.L.	67+63.00		72+32.00	469.00	6.0	6.0
NO PASS	C.L.	72+32.00		80+22.00	790.00	20.0	20.0
SINGLE	C.L.	80+22.00		82+25.00	203.00	3.0	3.0
NO PASS	C.L.	82+25.00		88+90.00	665.00	17.0	17.0
SINGLE	C.L.	88+90.00		129+50.00	4060.00	53.0	53.0
					FAS 1488 TOTAL =	221.0	221.0
					USE =	221.0	221.0
					EACH	EACH	EACH

78001110 PAINT PAVEMENT MARKING - LINE 4"

				78001110	COLOR	
LOCATION		STATION	TO	STATION	QUANTITY (FT)	COLOR
FAU 6348						
MCLEAN COUNTY (URBAN)						
RT.	EDGE LINE	37+64.00		129+50.00	9186.0	WHITE
LT.	EDGE LINE	37+64.00		52+22.00	1458.0	WHITE
LT.	EDGE LINE	53+36.50		76+44.00	2308.0	WHITE
LT.	EDGE LINE	77+85.00		84+97.00	712.0	WHITE
LT.	EDGE LINE	86+37.00		129+50.00	4313.0	WHITE
LT. / RT.	NO PASS DOUBLE	37+64.00		51+10.00	2692.0	YELLOW
RT.	NO PASS	51+10.00		58+02.00	882.0	YELLOW
LT. / RT.	NO PASS DOUBLE	58+02.00		61+29.00	654.0	YELLOW
LT.	NO PASS	61+29.00		67+65.00	806.0	YELLOW
RT.	CENTERLINE SKIP-DASH	67+65.00		72+32.00	140.0	YELLOW
RT.	NO PASS	72+32.00		80+22.00	1000.0	YELLOW
RT.	CENTERLINE SKIP-DASH	80+22.00		82+25.00	70.0	YELLOW
LT.	NO PASS	82+25.00		88+90.00	845.0	YELLOW
RT.	CENTERLINE SKIP-DASH	88+90.00		129+50.00	1030.0	YELLOW
				FAU 6348 TOTAL =	26096.00	
				USE =	26096.00	
					FT	

XZ193400 SURVEY MARKER, TYPE 2 (SPECIAL)

				XZ193400	
LOCATION		OFFSET	DESCRIPTION	SURVEY MARKER, TYPE 2 (SPECIAL) (EACH)	
NORTHING	EASTING	STATION			
FAU 6348					
1405811.729	809424.347	24-79.86	0.00	POT	1.0
1405814.516	809985.542	30+41.06	0.00	P.C.	1.0
1406048.759	810625.044	37+35.91	0.00	P.T.	1.0
1407496.793	812353.808	59+91.00	0.00	P.I.	1.0
1408744.389	813844.660	79+35.00	0.00	P.I.	1.0
1410458.764	815885.043	106+00.00	0.00	P.I.	1.0
1410994.327	816524.989	114+34.48	0.00	P.I.	1.0
1411426.518	817039.680	121+06.56	0.00	P.I.	1.0
1411721.046	817393.050	125+66.58	0.00	P.I.	1.0
1411960.522	817675.439	129+36.84	0.00	P.I.	1.0
1412188.255	817932.000	132+79.90	0.00	POT	1.0
				FAU 6348 TOTAL =	11.0
				USE =	11.0
					EACH

MODEL: I:\MODEL MARKS FILE: MarkS_Paint\Bids\paw_beaufay.com\FW\DOT\Documents\DOT_Offices\Dir\dir_5\Project\0570E_19\CADD\DATA\CAD\Reest\0570E_19\sh-Schedule.docx

USER NAME = g01lejr	DESIGNED - JRG	REVISED -
	DRAWN - JRG	REVISED -
PLOT SCALE = 40,0000 * / in.	CHECKED -	REVISED -
PLOT DATE = 12/17/2021	DATE -	REVISED -

**STATE OF ILLINOIS
DEPARTMENT OF TRANSPORTATION**

SCHEDULE OF QUANTITIES

SCALE: NTS SHEET 3 OF 3 SHEETS STA. TO STA.

F.A.U. RTE.	SECTION	COUNTY	TOTAL SHEETS	SHEET NO.
6348	15RS-3	MCLEAN	27	11
CONTRACT NO. 70E19				
ILLINOIS FED. AID PROJECT				

40600990 TEMPORARY RAMP

LOCATION	STATION	TO	STATION	DROP (INCH)	LENGTH (FT)	WIDTH (FT)	QUANTITY (SQ YD)	CONSTRUCT AFTER		
FAU 6348										
MCLEAN COUNTY (URBAN)										
RT.	D.L. START		37+64.00		37+76.50	3.75	12.50	12.00	16.67	MILLING
RT.	D.L. START		37+64.00		37+69.00	1.50	5.00	12.00	6.67	HMA SURFACE
LT.	D.L. START		37+64.00		37+76.50	3.75	12.50	12.00	16.67	MILLING
LT.	D.L. START		37+64.00		37+69.00	1.50	5.00	12.00	6.67	HMA SURFACE
LT.	VETERANS PKWY OFF-RAMP		52+22.00		53+37.00	3.75	2.00	115.00	25.56	MILLING
LT.	C.E.		76+46.00		77+86.00	3.75	2.00	140.00	31.11	MILLING
RT.	D.L. MIDPOINT		83+57.00		83+69.50	3.75	12.50	12.00	16.67	MILLING
RT.	D.L. MIDPOINT		83+57.00		83+62.00	1.50	5.00	12.00	6.67	HMA SURFACE
LT.	D.L. MIDPOINT		83+44.50		83+57.00	3.75	12.50	12.00	16.67	MILLING
LT.	D.L. MIDPOINT		83+52.00		83+57.00	1.50	5.00	12.00	6.67	HMA SURFACE
LT.	PAPER CHASE ST		85+00.00		86+37.00	3.75	2.00	137.00	30.44	MILLING
LT.	C.E.		88+75.00		89+35.00	3.75	2.00	60.00	13.33	MILLING
RT.	D.L. END		129+37.50		129+50.00	3.75	12.50	12.50	17.36	MILLING
RT.	D.L. END		129+45.00		129+50.00	1.50	5.00	5.00	2.78	HMA SURFACE
LT.	D.L. END		129+37.50		129+50.00	3.75	12.50	12.50	17.36	MILLING
LT.	D.L. END		129+45.00		129+50.00	1.50	5.00	5.00	2.78	HMA SURFACE
							FAU 6348 TOTAL =		234.06	
							USE =		235.00	
									SQ YD	

TAPER RATE = 1:40 FOR MAINLINE

48102100 AGGREGATE WEDGE SHOULDER, TYPE B

LOCATION	STATION	TO	STATION	LENGTH (FOOT)	AGGREGATE SHOULDER WIDTH (FOOT)	AVERAGE SHOULDER THICKNESS (INCH)	QUANTITY (TON)	
48102100								
FAU 6348								
MCLEAN COUNTY (URBAN)								
LT.	37+64.00		52+22.00	1458.0	3.0	0.75	18.23	
LT.	53+37.00		65+15.00	1178.0	3.0	0.75	14.73	
RT.	37+64.00		56+45.00	1881.0	5.0	1.00	52.25	
RT.	56+45.00		57+30.00	85.0	8.0	1.13	4.27	
RT.	57+30.00		57+80.00	50.0	10.0	1.13	3.14	
RT.	57+80.00		61+25.00	345.0	5.0	1.00	9.58	
RT.	61+25.00		62+17.00	92.0	8.0	1.00	4.09	
RT.	62+17.00		82+25.00	2008.0	5.0	1.00	55.78	
RT.	82+65.00		87+50.00	485.0	5.0	1.00	13.47	
RT.	87+95.00		129+50.00	4155.0	5.0	1.00	115.42	
LT.	118+63.00		129+50.00	1087.0	3.0	1.13	20.38	
							FAU 6348 TOTAL =	311.34
							USE =	312.00
								TON

X0327584 GRADING AND SHAPING SHOULDERS, SPECIAL

LOCATION	STATION	TO	STATION	QUANTITY (FT)	AGGREGATE SHOULDER WIDTH (FT)	AVERAGE SHOULDER THICKNESS (INCH)
X0327584						
FAU 6348						
MCLEAN COUNTY (URBAN)						
RT.	37+64.00		56+45.00	1881.0	5.0	6.00
RT.	56+45.00		57+30.00	85.0	7.5	6.00
RT.	57+30.00		57+80.00	50.0	10.0	6.00
RT.	57+80.00		61+25.00	345.0	5.0	6.00
RT.	61+25.00		62+17.00	92.0	8.0	6.00
RT.	62+17.00		82+25.00	2008.0	5.0	6.00
RT.	82+65.00		87+50.00	485.0	5.0	6.00
RT.	87+95.00		129+50.00	4155.0	5.0	6.00
				FAU 6348 TOTAL =		9101.00
				USE =		9101.00
						FT

GUARDRAIL SCHEDULE

LOCATION	STATION	TO	STATION	OFFSET (FT)	63000001 STEEL PLATE BEAM GUARDRAIL, TYPE A, 6 FT POSTS (FT)	63100167 TRAFFIC BARRIER TERMINAL, TYPE 1 (SPECIAL) TANGENT (EACH)	63200310 GUARDRAIL REMOVAL (FT)	72501000 TERMINAL MARKER - DIRECT APPLIED (EACH)	78200005 GUARDRAIL REFLECTORS, TYPE A (EACH)	
FAU 6348										
MCLEAN COUNTY (URBAN)										
LT.	69+85.00		70+35.00	18.5		1.0		1.0		
LT.	70+35.00		70+83.00	18.5	48.0				4.0	
LT.	70+83.00		71+33.00	18.5		1.0		1.0		
LT.	70+08.00		71+33.00	18.7			125.0			
LT.	93+17.00		93+72.00	15.0			55.0			
LT.	93+17.00		93+72.00	15.5	55.0				5.0	
					FAU 6348 TOTAL =	103.0	2.0	180.0	2.0	9.0
					USE =	103.0	2.0	180.0	2.0	9.0
					FT	EACH	FT	EACH	EACH	

PATCHING SCHEDULE

STATION	SIZE (FOOT)		AREA (SQ YD)	TYPICAL SECTION NO.	44201815	44201821	
	LENGTH	WIDTH			CLASS D, 14 INCH TY II SQ YD	TY IV SQ YD	
FAU 6348							
MCLEAN COUNTY (URBAN)							
LT STA 40+78	6	x 12	8	1	8.0		
LT STA 42+55	50	x 6	33	1		33.0	
LT STA 45+28	6	x 12	8	1	8.0		
LT STA 46+78	100	x 6	67	1		67.0	
LT STA 49+03	6	x 12	8	1	8.0		
LT STA 57+18	6	x 12	8	2	8.0		
LT STA 64+77	6	x 12	8	1	8.0		
LT STA 65+89	6	x 12	8	1	8.0		
LT STA 68+25	6	x 12	8	1	8.0		
LT STA 71+13	6	x 12	8	1	8.0		
LT STA 75+25	6	x 12	8	1	8.0		
RT STA 37+89	6	x 12	8	1	8.0		
RT STA 40+78	6	x 12	8	1	8.0		
RT STA 42+78	6	x 12	8	1	8.0		
RT STA 46+28	6	x 12	8	1	8.0		
RT STA 49+03	6	x 12	8	1	8.0		
RT STA 52+33	6	x 12	8	1	8.0		
RT STA 57+18	6	x 12	8	2	8.0		
RT STA 64+77	6	x 12	8	1	8.0		
RT STA 68+25	6	x 12	8	1	8.0		
					FAU 6348 TOTAL =	144.0	100.0
					USE =	144.0	100.0
						SQ YD	SQ YD

* DENOTES CENTERLINE

44000164 HOT-MIX ASPHALT SURFACE REMOVAL, 3 3/4"

LOCATION	STATION	TO	STATION	LENGTH (FT)	PAVEMENT WIDTH (FT)	QUANTITY (SQ YD)
44000164						
FAU 6348						
MCLEAN COUNTY (URBAN)						
LT.	MAINLINE		37+64.00		129+50.00	9186.0
RT.	MAINLINE		37+64.00		129+50.00	9186.0
				FAU 6348 TOTAL =		24497.00
				USE =		24497.00
						SQ YD

MODEL: I:\MODEL\MAIF5
 FILE: MAIF5_Plan\Subc-paw-bead-fy.com\FW\DOT\Documents\DOT\Office\Dir\dir: S:\Project\0570E\91C\DD\data\CAD\Reest\0570E\91C\Subc-Schedule.dgn

USER NAME = g01e/r	DESIGNED - JRG	REVISED -
	DRAWN - JRG	REVISED -
PLOT SCALE = 40,0000 */ in.	CHECKED -	REVISED -
PLOT DATE = 12/17/2021	DATE -	REVISED -

**STATE OF ILLINOIS
DEPARTMENT OF TRANSPORTATION**

SCHEDULE OF QUANTITIES

SCALE: NTS SHEET 1 OF 3 SHEETS STA. TO STA.

F.A.U. RTE.	SECTION	COUNTY	TOTAL SHEETS	SHEET NO.
6348	15RS-3	MCLEAN	27	12
				CONTRACT NO. 70E19
				ILLINOIS FED. AID PROJECT

SECT. 23, T23N, R2E, 2ND P.M.
MCLEAN COUNTY

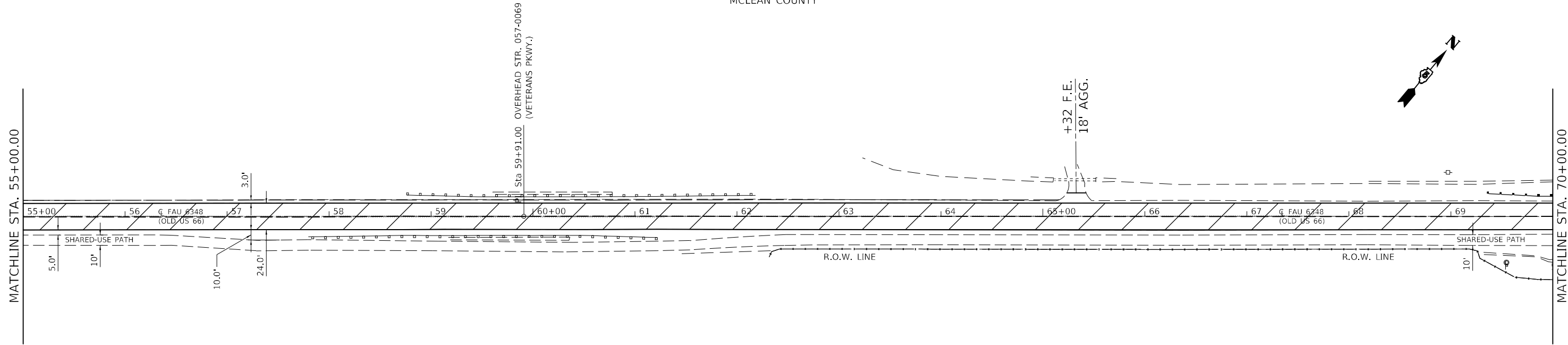

 HOT-MIX ASPHALT SURFACE REMOVAL, 3 3/4"

SECT. 14, T24N, R2E, 2ND P.M.
MCLEAN COUNTY

SECT. 23, T23N, R2E, 2ND P.M.
MCLEAN COUNTY

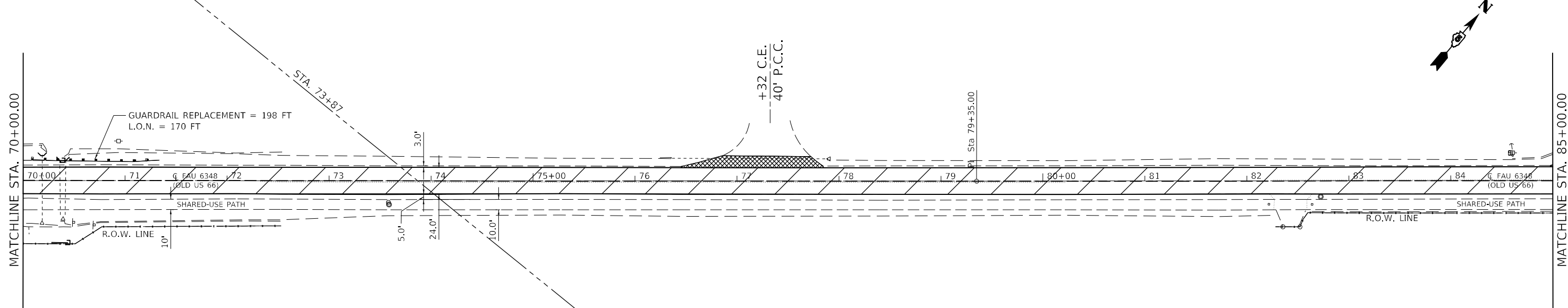

 HOT-MIX ASPHALT SURFACE REMOVAL, 3 3/4"

 INCIDENTAL HMA SURFACING

MODEL: \\MODEL\MAME
 FILE: NAME: \\PUB\c:\paw\hwy.com\PIV\DOT\Documents\DOT Office\Dir\dir: S:\Project\0570E19\CADD\data\CAD\Sheet\0570E19\sh1tblb.dgn

USER NAME = g01lejr	DESIGNED - JRG	REVISED -
	DRAWN - JRG	REVISED -
PLOT SCALE = 100,0000' / in.	CHECKED -	REVISED -
PLOT DATE = 12/17/2021	DATE -	REVISED -



**STATE OF ILLINOIS
DEPARTMENT OF TRANSPORTATION**

PLAN SHEET

SCALE: 1" = 50' SHEET 2 OF 4 SHEETS STA. 55+00.00 TO STA. 85+00.00

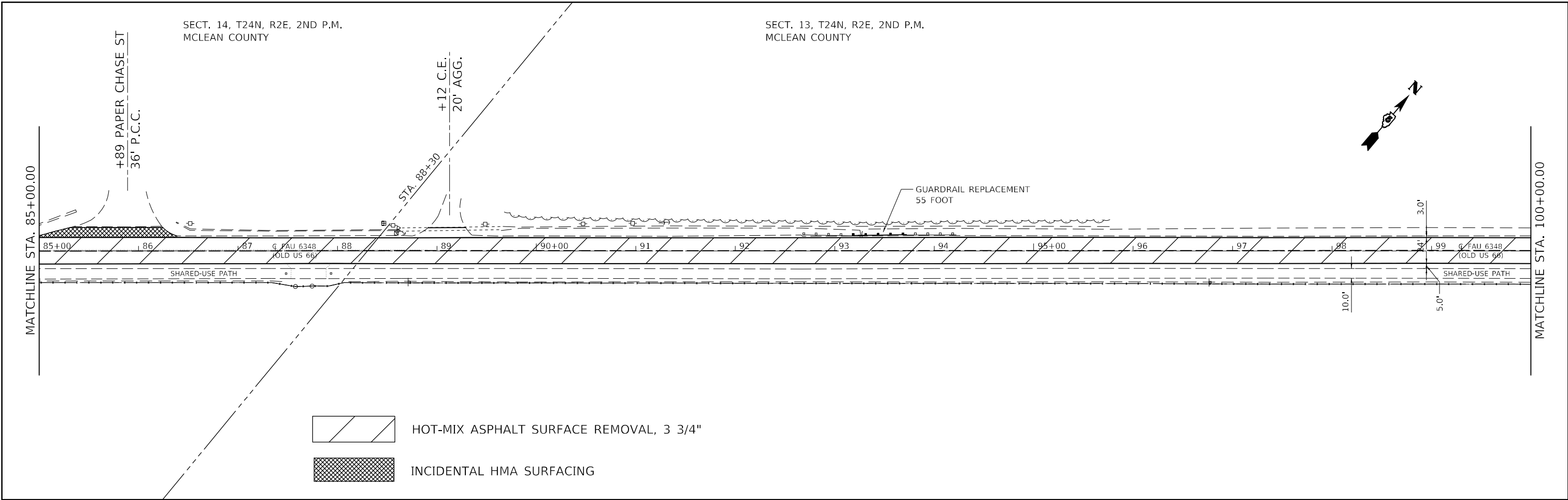
F.A.U. RTE.	SECTION	COUNTY	TOTAL SHEETS	SHEET NO.
6348	15RS-3	MCLEAN	27	14
CONTRACT NO. 70E19			ILLINOIS FED. AID PROJECT	

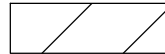

 HOT-MIX ASPHALT SURFACE REMOVAL, 3 3/4"
 INCIDENTAL HMA SURFACING

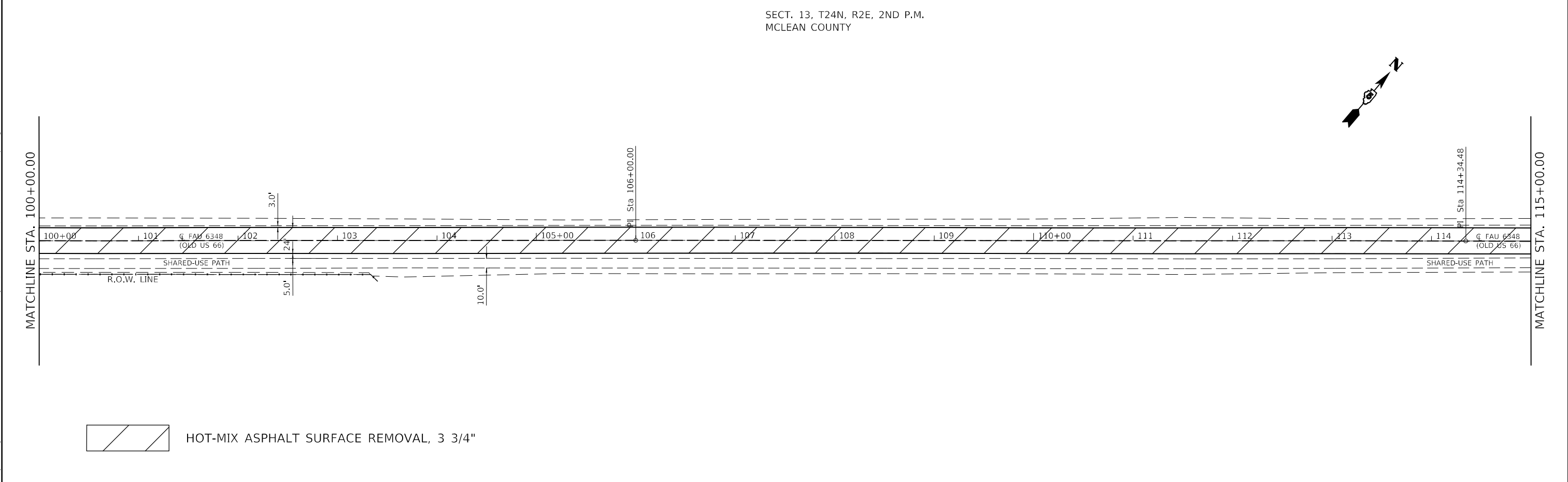

 HOT-MIX ASPHALT SURFACE REMOVAL, 3 3/4"

MODEL: \\MODEL\MAME
 FILE: \\MAILS_P\public\paw_bentley.com\PIV\DOT\Documents\DOT_Offices\Dir\dr: S:\Project\0570E_19\CADD\DATA\CAD\Sheet\0570E19\sh-14b.dgn

USER NAME = g01ejr	DESIGNED - JRG	REVISED -
DRAWN - JRG	REVISED -	
PLOT SCALE = 100,0000 ' / in.	CHECKED -	REVISED -
PLOT DATE = 12/17/2021	DATE -	REVISED -

**STATE OF ILLINOIS
DEPARTMENT OF TRANSPORTATION**

PLAN SHEET

SCALE: 1" = 50' SHEET 3 OF 4 SHEETS STA. 85+00.00 TO STA. 115+00.00

F.A.U. RTE.	SECTION	COUNTY	TOTAL SHEETS	SHEET NO.
6348	15RS-3	MCLEAN	27	15
CONTRACT NO. 70E19				
ILLINOIS FED. AID PROJECT				

SECT. 13, T24N, R2E, 2ND P.M.
MCLEAN COUNTY

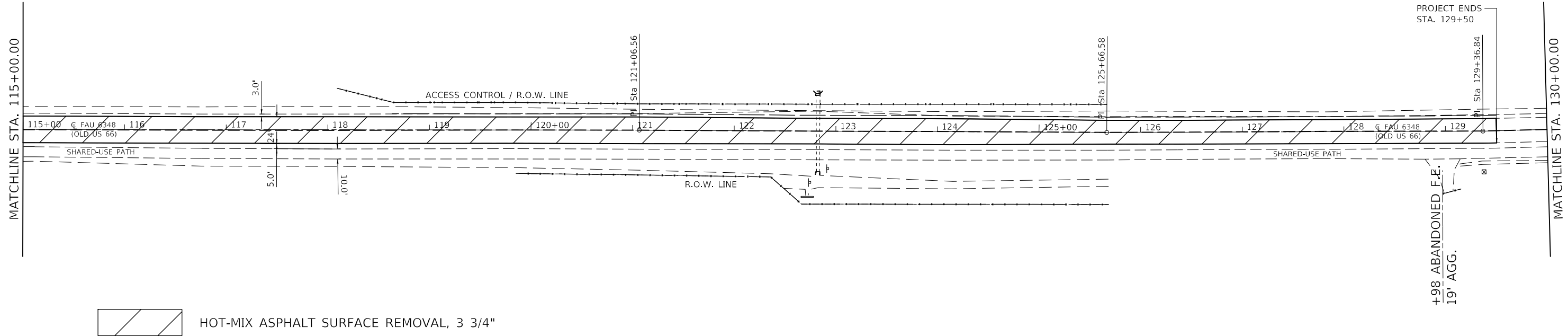

 HOT-MIX ASPHALT SURFACE REMOVAL, 3 3/4"

PROJECT ENDS
STA. 129+50

+98 ABANDONED F.E.
19' AGG.

SECT. 13, T24N, R2E, 2ND P.M.
MCLEAN COUNTY

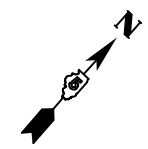
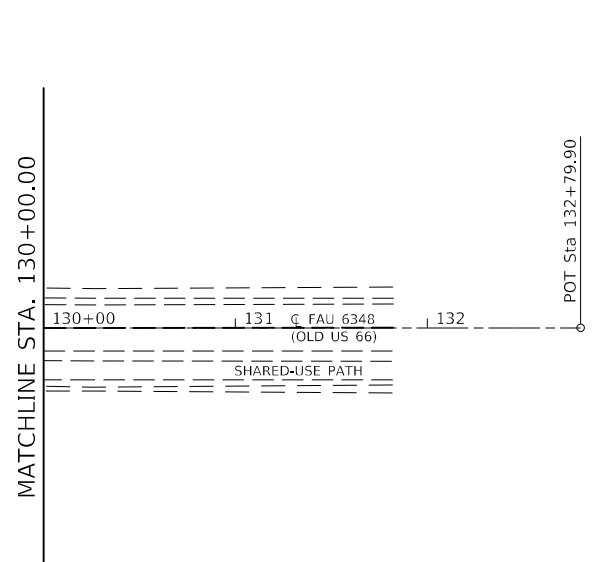

MODEL: \\MODELS\MRFS
 FILE: \\MRFS_Plan\150624\150624.dwg
 PROJECT: \\DOT\Documents\DOT\Office\150624\150624.dwg
 PROJECT: \\DOT\Documents\DOT\Office\150624\150624.dwg

USER NAME = g01lejr	DESIGNED - JRG	REVISED -
DRAWN - JRG	REVISIONS -	
PLOT SCALE = 100,0000 ' / in.	CHECKED -	REVISED -
PLOT DATE = 12/17/2021	DATE -	REVISED -

**STATE OF ILLINOIS
DEPARTMENT OF TRANSPORTATION**

PLAN SHEET
SCALE: 1" = 50' SHEET 4 OF 4 SHEETS STA. 115+00.00 TO STA. 132+79.90

F.A.U. RTE.	SECTION	COUNTY	TOTAL SHEETS	SHEET NO.
6348	15RS-3	MCLEAN	27	16
CONTRACT NO. 70E19				
ILLINOIS FED. AID PROJECT				

DESIGNER NOTE: SEE PLAN PREPARATION MEMORANDUM 40-06 CONSULT CHAPTER 49 OF BDE MANUAL

**SECTION A-A
EXISTING HMA OR PCC SIDEROAD (> 400 ADT)**

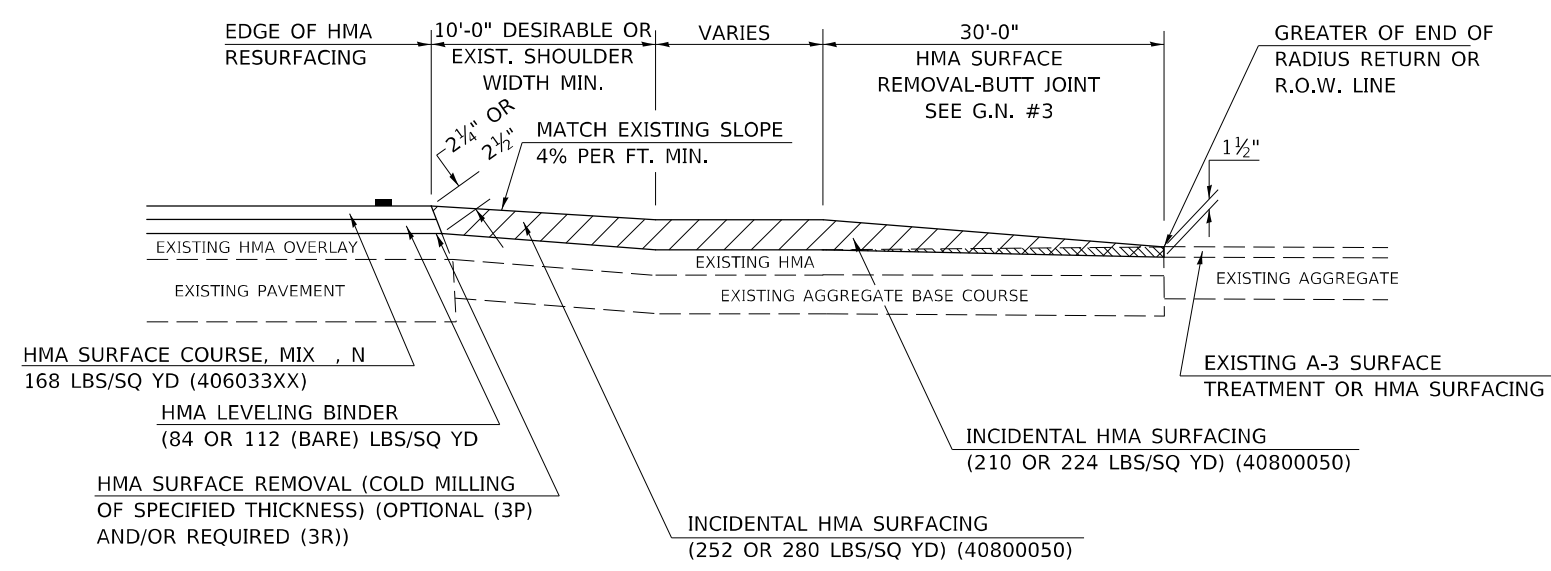

**SECTION A-A
EXISTING AGGREGATE OR SEAL COAT SIDEROAD (< 400 ADT)**

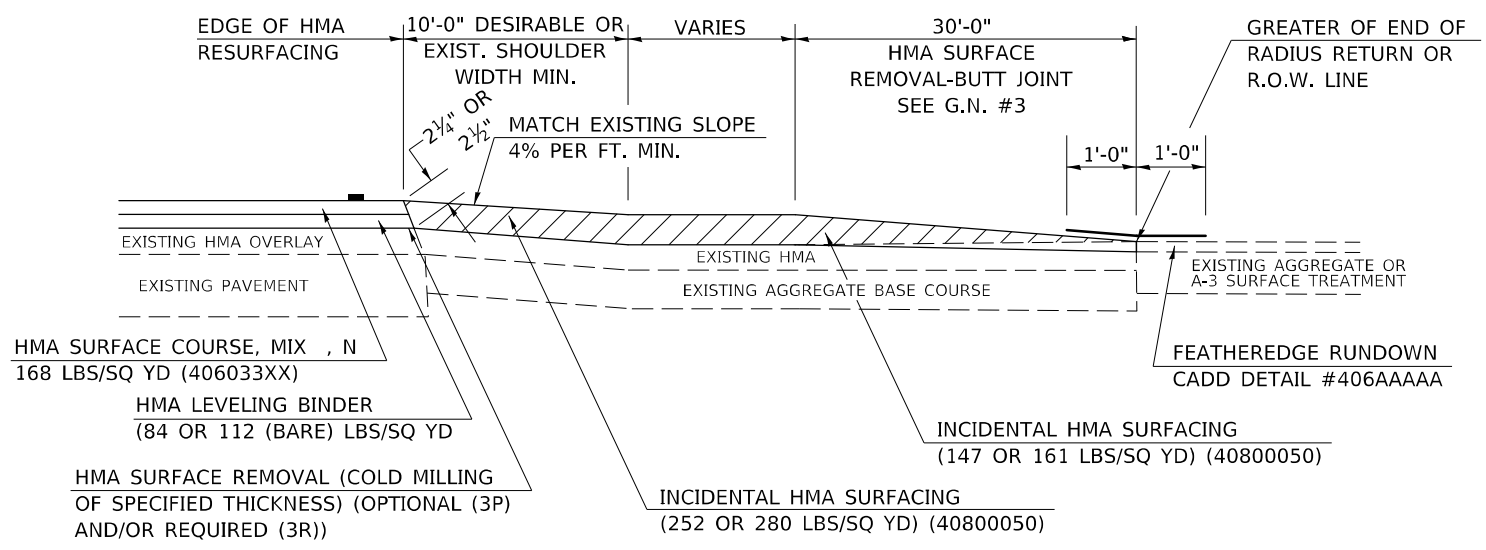

RURAL SIDEROAD DESIGN STANDARDS (PPM 40-06)										
DESIGN ELEMENT	New Construction & 3R (Existing Width Less Than 20 ft)			3R (Existing Width 20 ft or Greater) & 3P			SMART & Contract Maintenance			
	min.	des.	max.	min.	des.	max.	min.	des.	max.	
SURFACE WIDTH (FT); (Measured at end of radius or row line; greatest distance from edge of traveled way)	24	24	Coordinate with Geometrics Engineer	Resurface existing configuration to completion of radius return or row line; greatest distance from edge of traveled way; major sideroads (> 400 adt) shall have "butt joints" constructed whether the entrance is hma or pcc; minor sideroads (< 400 adt) shall have "featheredge rundown" as shown in district cadd detail 406AAAAA						resurface existing configuration with the completion of a 10 ft. featheredge rundown for ALL sideroads as shown in district cadd detail 406AAAAA
RADIUS (FT)	30	30								
SHOULDER WIDTH (FT)	4	8	10							
SHOULDER SLOPE (%)	2	4	12							
ENTRANCE GRADE (%)	1	1 to 4	4							
BREAKOVER (%)	0	5	10							
SIDE SLOPE (FT)	1:10	1:6	1:4							
INTERSECTION ANGLE	60	75 to 90								
SURFACE TYPE										
INCIDENTAL HMA SURFACING (INCH)	4			taper from 2 1/4" to 1 1/2" or featheredge			taper from 1 1/2" to featheredge			
AGGREGATE BASE COURSE, TYPE A (INCH)	8	4		if applicable use item: 35800100 Preparation of Base						
PCC PAVEMENT (INCH)		8								

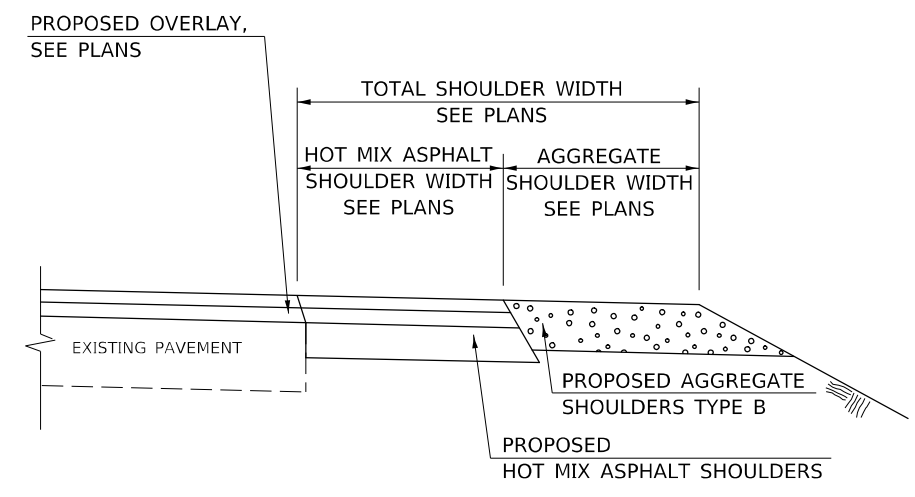

**SECTION B-B
MAINLINE SHOULDER TREATMENT**

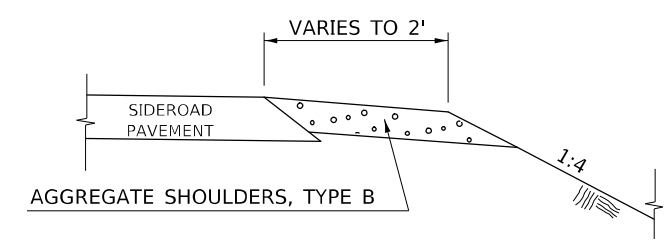

**SECTION C-C
SIDEROAD SHOULDER TREATMENT**

Note: All dimensions are in INCHES (millimeters) unless otherwise shown.

DISTRICT 5 DETAIL NO. 408000AA

MODEL: I:\MODEL\MMF5 FILE: MMF5.DWG DATE: 12/17/2021 10:00:00 AM

USER NAME = g0t0e1r	DESIGNED -	REVISD - 12/06 TJB
PLOT SCALE = 40,0000 * / in.	DRAWN -	REVISD - 09/07 KAG
PLOT DATE = 12/17/2021	CHECKED -	REVISD - 12/09 KJT
	DATE -	REVISD -

**STATE OF ILLINOIS
DEPARTMENT OF TRANSPORTATION**

SIDEROAD & SIDESTREETS (RURAL)			
SCALE:	SHEET 2 OF 2 SHEETS	STA.	TO STA.

F.A.U. RTE.	SECTION	COUNTY	TOTAL SHEETS	SHEET NO.
6348	15RS-3	MCLEAN	27	17
CONTRACT NO. 70E19			ILLINOIS FED. AID PROJECT	

PROJECTS WITHOUT RECONSTRUCTION

S.M.A.R.T. IMPROVEMENTS (ALSO CONTRACT MAINTENANCE)

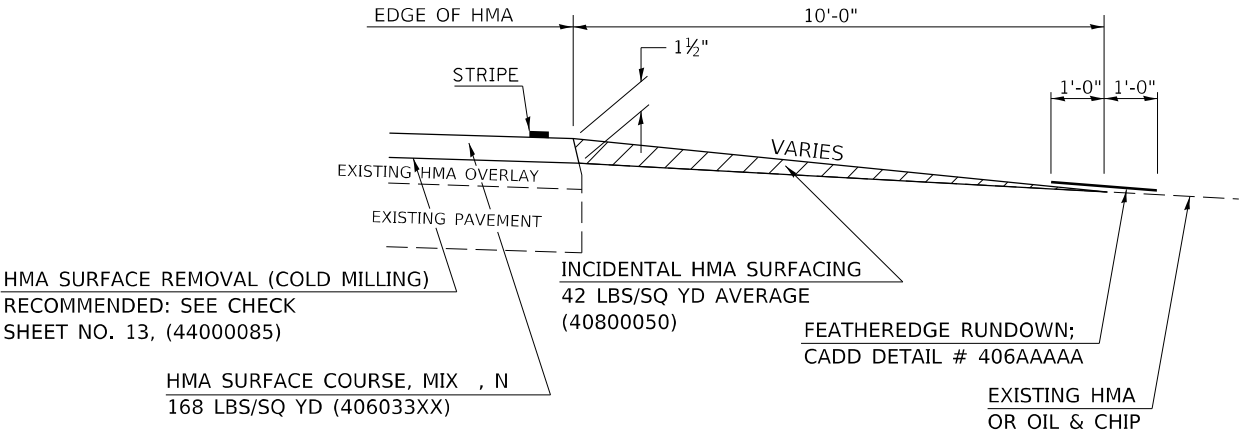

"3P" OR "3R" IMPROVEMENTS

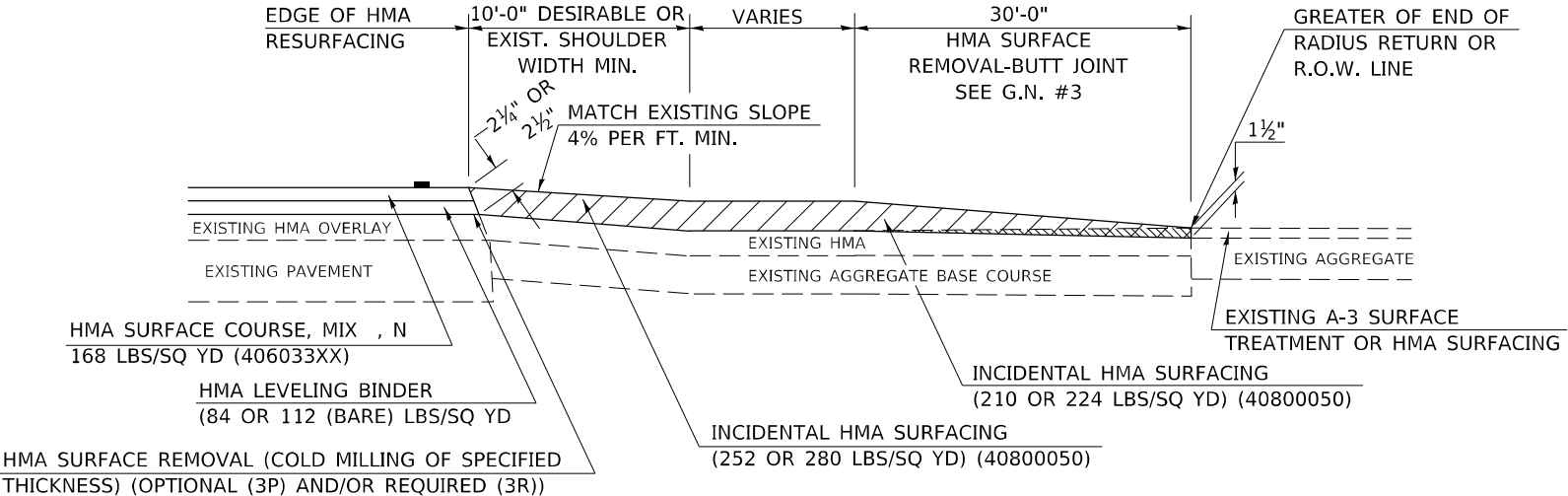

PROJECTS WITH RECONSTRUCTION

("3R" IMPROVEMENTS)

WITH HMA SHOULDER

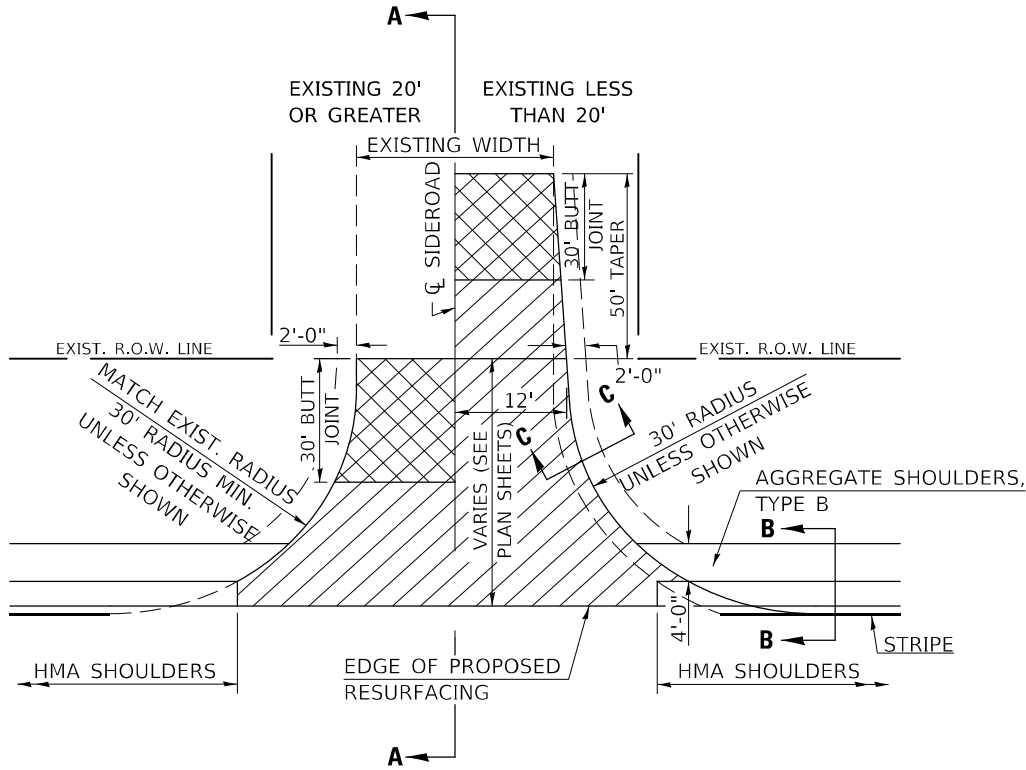

WITHOUT HMA SHOULDER

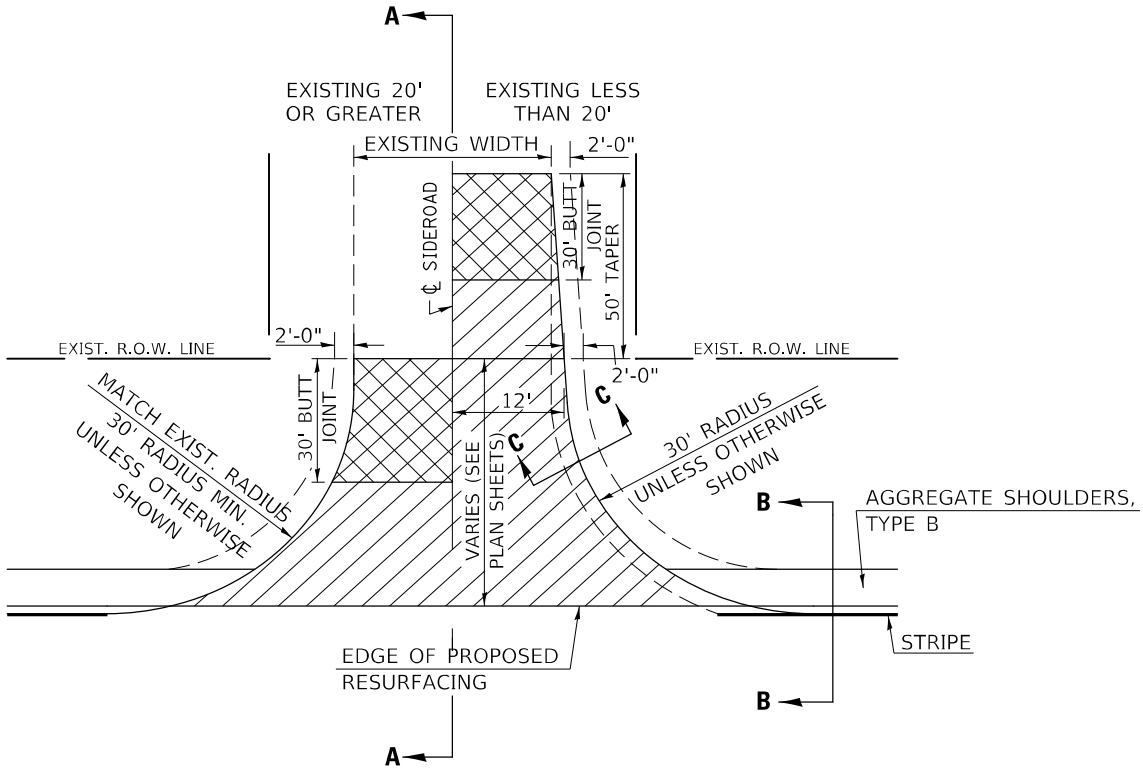

GENERAL NOTES

1. THE EXISTING SURFACE SHALL BE PREPARED IN ACCORDANCE WITH SECTION 408 OF THE STANDARD SPECIFICATIONS
2. PROPOSED SIDEROAD GRADES SHALL BE AS SHOWN IN THE PLANS AND/OR AS DIRECTED BY THE ENGINEER.
3. MAJOR SIDEROAD/SIDESTREETS (>400 ADT) SHALL HAVE "BUTT JOINTS" CONSTRUCTED WHETHER THE EXISTING ENTRANCE IS HMA OR PCC. MINOR SIDEROAD/SIDESTREETS (<400 ADT) SHALL HAVE "FEATHEREDGE RUNDOWNS".
4. AGGREGATE BASE COURSE, TYPE B OF THE THICKNESS SPECIFIED IN THE PLANS 6" MIN. SHALL BE USED WHERE IN THE OPINION OF THE ENGINEER THERE IS NOT 6" EXISTING BASE MATERIAL FOR THE PROPOSED SIDEROAD RETURNS. THIS MATERIAL SHALL BE USED TO WIDEN SIDEROAD RETURNS.
5. THE AGGREGATE BASE COURSE SHALL BE CONSTRUCTED 1' WIDER THAN THE SURFACE DIMENSIONS.
6. AGGREGATE SHOULDERS, TYPE B WILL BE WRAPPED AROUND THE SIDEROAD RETURNS. TAPER WIDTH FROM 4' ALONG MAINLINE TO 2' AT BACK OF RETURN.

Note: All dimensions are in INCHES (millimeters) unless otherwise shown.

DISTRICT 5 DETAIL NO. 408000AA

USER NAME = goblejr	DESIGNED -	REVISOR -	DATE -
	DRAWN -	REVISOR -	DATE -
PLOT SCALE = 40,0000 * / in.	CHECKED -	REVISOR -	DATE -
PLOT DATE = 12/17/2021	DATE -	REVISOR -	DATE -

**STATE OF ILLINOIS
DEPARTMENT OF TRANSPORTATION**

SIDEROAD & SIDESTREETS (RURAL)

SCALE: SHEET 1 OF 2 SHEETS STA. TO STA.

F.A.U. RTE.	SECTION	COUNTY	TOTAL SHEETS	SHEET NO.
6348	15RS-3	MCLEAN	27	18
CONTRACT NO. 70E19				
ILLINOIS FED. AID PROJECT				

DESIGNER NOTE: SEE PLAN PREPARATION MEMORANDUM 40-06 CONSULT CHAPTER 49 OF BDE MANUAL

MODEL: \\MODEL\MNMF5 FILE: \\MAILS_P\pub\15r3\15r3.dwg PROJECT: \\PROJECTS\70E19\CD\DATA\CAD\Sheet\0570E19.rvt DATE: 12/17/2021

PROJECTS WITHOUT RECONSTRUCTION

("3R" WITHOUT RECONSTRUCTION, 3P, SMART AND CM)

S.M.A.R.T. IMPROVEMENTS

(POLICY RESURFACING; BDE 53-4.03; 1½")

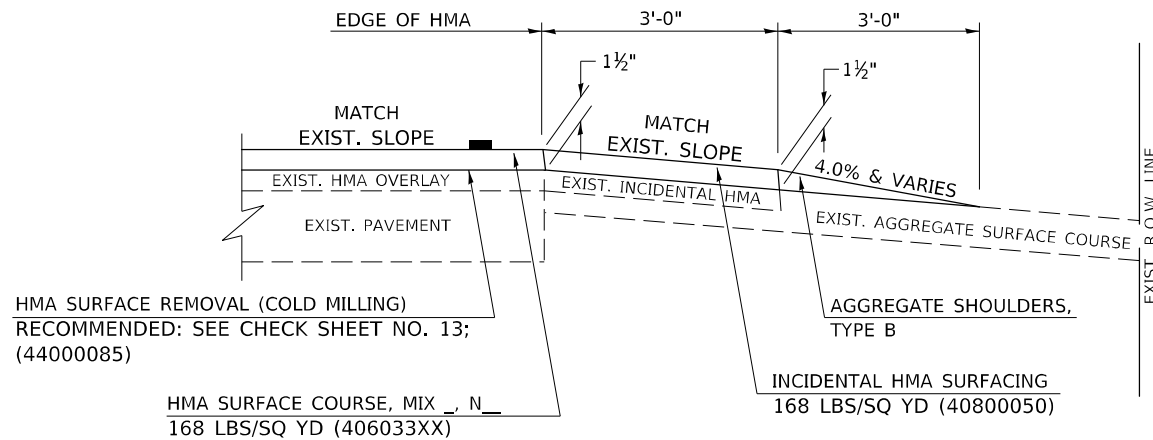

"3P" OR "3R" IMPROVEMENTS

(POLICY RESURFACING; BDE 53-4.02; 2¼" OR 2½" ON BARE CONCRETE)

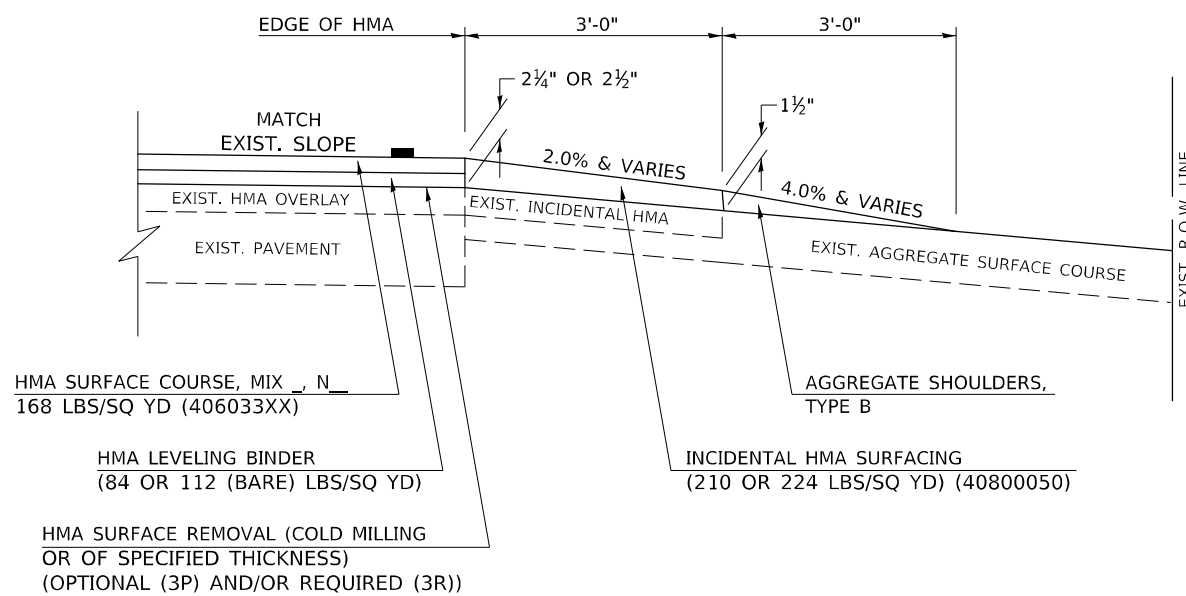

PROJECTS WITH RECONSTRUCTION

("3R" IMPROVEMENTS AND SMART/3P "SPOT" LOCATIONS)

ADJACENT TO PROPOSED HMA SHOULDERS

(AGGREGATE OR EARTH ENTRANCE)

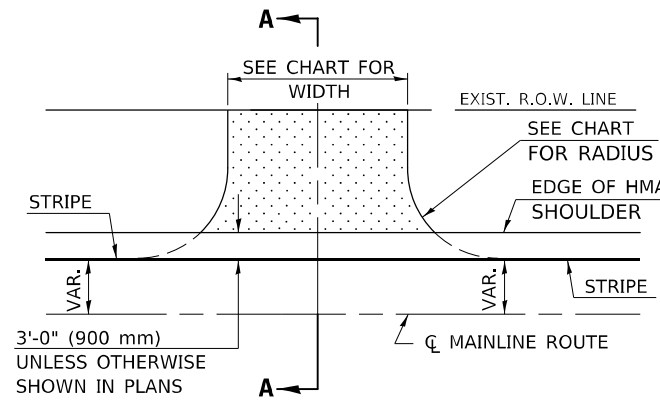

TYPICAL APPLICATION

EXISTING AGGREGATE OR EARTH ENTRANCE

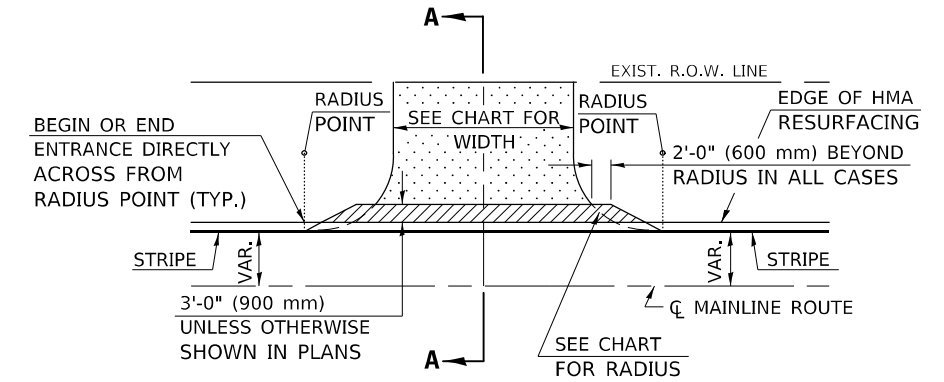

TYPICAL APPLICATION

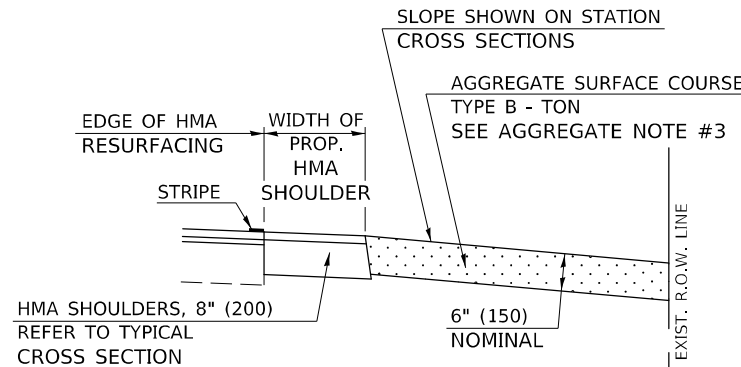

SECTION A-A

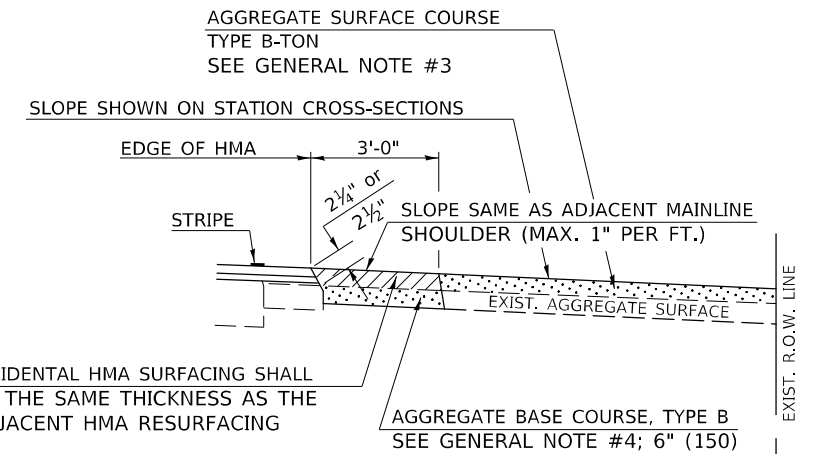

SECTION A-A

Note: All dimensions are in INCHES (millimeters) unless otherwise shown.

DESIGNER NOTE: SEE PLAN PREPARATION MEMORANDUM 40-09

MODEL: I:\MODEL\MMF5
FILE: MMF5_Plan\I\BCH\BCH.dwg, com:\P\W\DOT\Documents\DOT Office\Dir\Dir: S:\Project\10570E 19\CADD\DATA\CAD\Reest\10570E 19\st-Detail.dwg

USER NAME = g0t1eJr	DESIGNED -	REVISED - 12/06 TJB
	DRAWN -	REVISED - 09/07 KAG
PLOT SCALE = 40,0000 * / in.	CHECKED -	REVISED - 04/08 KJT
PLOT DATE = 12/17/2021	DATE -	REVISED - 3/16/17 SWN

STATE OF ILLINOIS
DEPARTMENT OF TRANSPORTATION

FIELD ENTRANCES (NONCOMMERCIAL RURAL)

SCALE: SHEET 1 OF 2 SHEETS STA. TO STA.

DISTRICT 5 DETAIL NO. 4080050A

F.A.U. RTE.	SECTION	COUNTY	TOTAL SHEETS	SHEET NO.
6348	15RS-3	MCLEAN	27	19
CONTRACT NO. 70E19				
ILLINOIS FED. AID PROJECT				

DESIGNER NOTE: SEE PLAN PREPARATION MEMORANDUM 40-09

MODEL: \\MODEL\MNMF5
FILE: \\MAILS_PUB\Public\paw_bentley.com\PIV\DOT\Documents\DOT_Offices\District_5\Project\0570E19\CADD\data\CAD\Sheet\0570E19\ent-Details.dgn

GENERAL NOTES

1. THE EXISTING SURFACE SHALL BE PREPARED IN ACCORDANCE WITH SECTION 408 OF THE STANDARD SPECIFICATIONS.
2. ANY NECESSARY WORK BEHIND THE HMA SHOULDER OR THE INCIDENTAL HMA SURFACING SHALL BE AS SHOWN IN THE PLANS AND/OR AS DIRECTED BY THE ENGINEER.
3. EARTH EXCAVATION REQUIRED FOR THE CONSTRUCTION OF THE AGGREGATE SURFACE COURSE SHALL BE INCLUDED IN THE COST OF AGGREGATE SURFACE COURSE.
4. AGGREGATE BASE COURSE, TYPE B, 6" (150 mm) MIN. SHALL BE USED WHERE IN THE OPINION OF THE ENGINEER THERE IS NOT SUFFICIENT BASE MATERIAL FOR THE PROPOSED ENTRANCES. THIS MATERIAL SHALL GENERALLY BE USED TO WIDEN ANY EXISTING RETURN OR TO CONSTRUCT NEW ENTRANCES WHERE NONE NOW EXISTS.
5. THE AGGREGATE BASE COURSE SHALL BE CONSTRUCTED 12" (300 mm) WIDER THAN THE SURFACE DIMENSIONS AS SHOWN ABOVE.
6. EXISTING FIELD ENTRANCES OF AGGREGATE OR EARTH WITH NO HMA APRON SHALL NOT RECEIVE A NEW HMA APRON WITHOUT PROPER APPROVAL THROUGH THE BUREAU OF OPERATIONS "POLICY ON PERMITS FOR ACCESS DRIVEWAYS TO STATE HIGHWAYS".
7. TO ASSURE APPROPRIATE ACCESS POLICIES ARE FOLLOWED ALL NEW ACCESS SHALL BE APPLIED FOR THROUGH THE BUREAU OF OPERATIONS PERMIT APPLICATION PROCESS. PLAN PREPARATION MEMORANDUMS 40-09 ALONG WITH DISTRICT PROJECT IMPLEMENTATION MEMORANDUM 104/01 DISCUSS THIS PROCEDURE.

RURAL ENTRANCE DESIGN STANDARDS (PPM 40-09)															
DESIGN ELEMENT	NEW CONSTRUCTION & 3R with CONSTRUCTION						3R w/out RECONSTRUCTION, 3P, SMART & CM								
	NONCOMMERCIAL			FIELD W/FARM IMPLEMENTS			COMMERCIAL			NONCOMMERCIAL			COMMERCIAL		
	PRIVATE & FIELD			FIELD W/FARM IMPLEMENTS			COMMERCIAL			PRIVATE & FIELD			COMMERCIAL		
	min.	des.	max.	min.	max.	min.	des.	max.	min.	des.	max.	min.	des.	max.	
SURFACE WIDTH (FT)	12	16	24	24	30	1 LANE, 1 WAY			1 LANE, 1 WAY						
						14	16	24							
						2 LANE, 2 WAY			2 LANE, 2 WAY						
						24	30	35	resurface existing configuration; existing aggregate or earth entrances shall have the continuation of aggregate shoulders placed behind them						
RADIUS (FT)	15	25	40	30		20	30	50							
SHOULDER WIDTH (FT)	2	2		2		1	3								
SHOULDER SLOPE (%)	2	4	6	4		2	4	6							
ENTRANCE GRADE (%)	0	2 to 5	10 or 12	2 to 5	10 or 12	0	2 to 5	8 or 10							
SIDE SLOPE (FT)	1:4	1:6	1:10	1:4	1:6	1:4	1:6	1:10							
SURFACE TYPE															
INCIDENTAL HMA SURFACING (INCH)		2		2		3 or 4			taper from hma resurfacing thickness (2 1/2", 2 1/4" or 1 1/2") to 1 1/2" to minimize aggregate shoulder						
AGGREGATE SURFACE COURSE, TYPE B (INCH)		6		6		8			if applicable, use items: Preparation of Base & Aggregate Base Repair; see PPM 30-02						
PCC DRIVEWAY PAVEMENT (INCH)		6						6 or 8							

Note: All dimensions are in INCHES (millimeters) unless otherwise shown.

DISTRICT 5 DETAIL NO. 4080050A

USER NAME = g0t0lejr	DESIGNED -	REVISED - 12/06 TJB
	DRAWN -	REVISED - 09/07 KAG
PLOT SCALE = 40,0000 * / in.	CHECKED -	REVISED - 04/08 KJT
PLOT DATE = 12/17/2021	DATE -	REVISED - 3/16/17 SWN

**STATE OF ILLINOIS
DEPARTMENT OF TRANSPORTATION**

FIELD ENTRANCES (NONCOMMERCIAL RURAL)

SCALE: SHEET 2 OF 2 SHEETS STA. TO STA.

F.A.U. RTE.	SECTION	COUNTY	TOTAL SHEETS	SHEET NO.
6348	15RS-3	MCLEAN	27	20
CONTRACT NO. 70E19				
ILLINOIS FED. AID PROJECT				

PROJECTS WITHOUT RECONSTRUCTION

S.M.A.R.T. IMPROVEMENTS (POLICY RESURFACING; BDE 53-4.03; 1½")

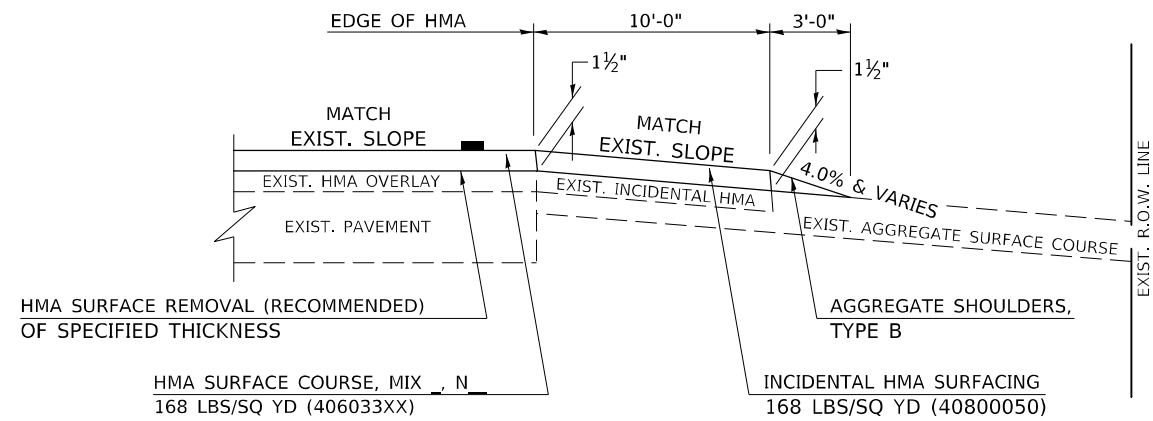

EXISTING AGGREGATE ENTRANCE

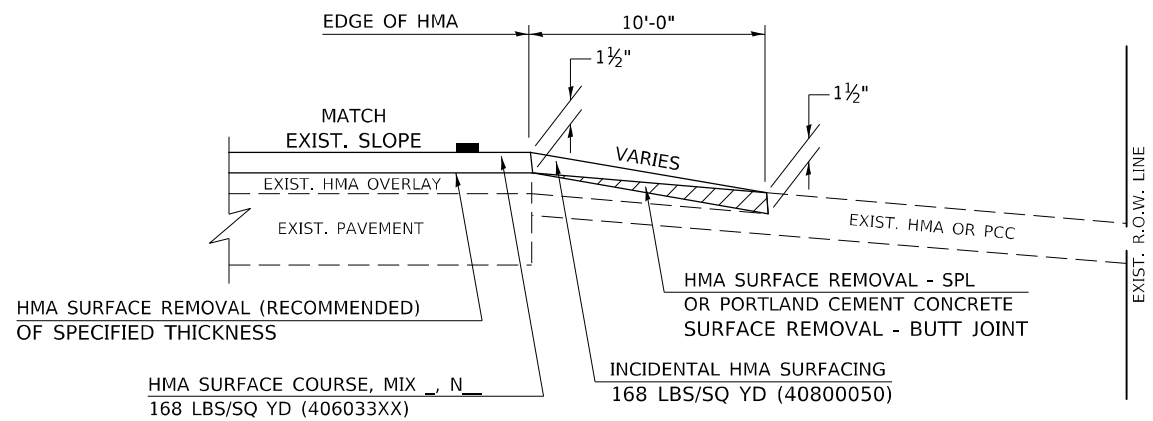

EXISTING HMA OR PCC ENTRANCE

"3P" OR "3R" IMPROVEMENTS (POLICY RESURFACING; BDE 53-4.02; 2¼" OR 2½" ON BARE CONCRETE)

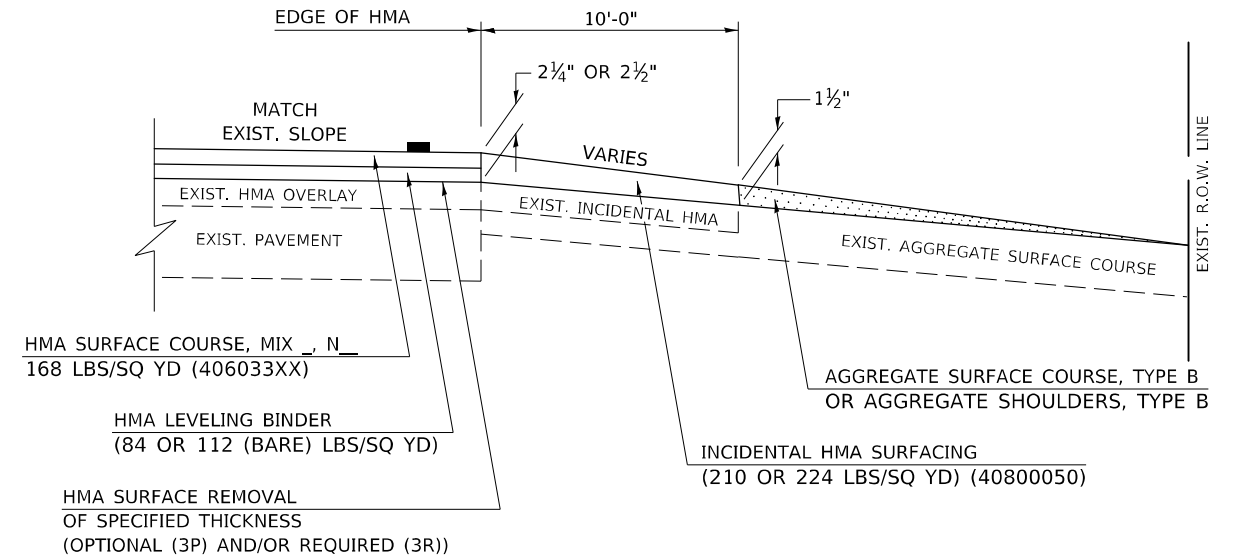

EXISTING AGGREGATE ENTRANCE

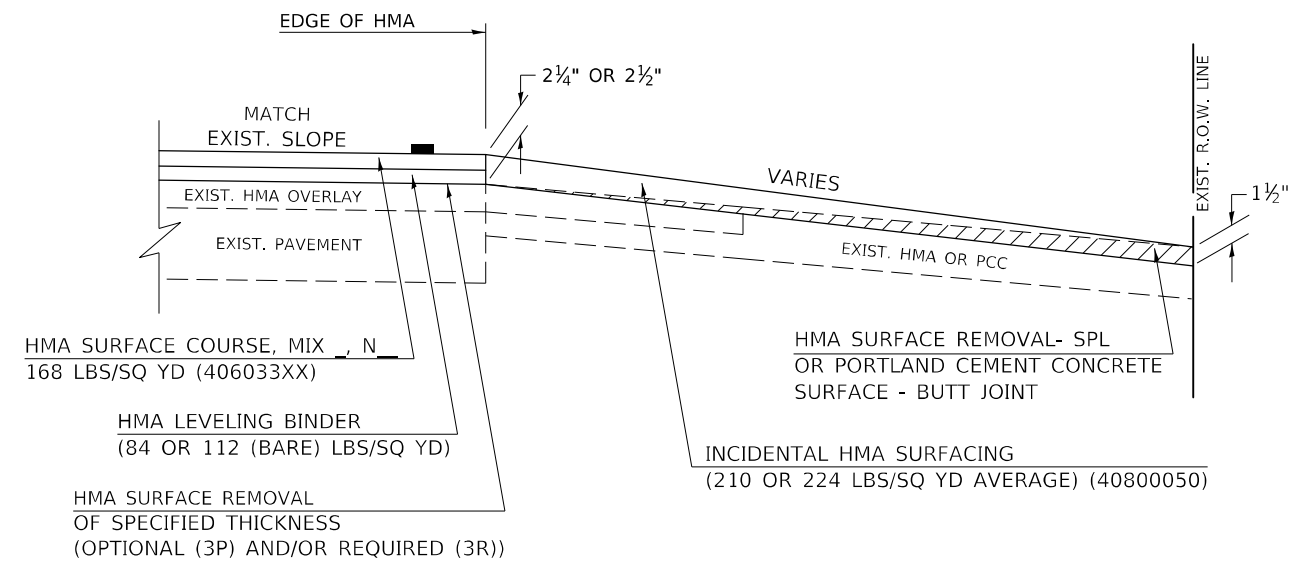

EXISTING HMA OR PCC ENTRANCE

Note: All dimensions are in INCHES (millimeters) unless otherwise shown.

DISTRICT 5 DETAIL NO. 40800050C

DESIGNER NOTE: SEE PLAN PREPARATION MEMORANDUM 40-09

MODEL: I:\MODEL\MMF5 FILE NAME: p:\pub\cpx\beadefy.com\FW\DOT\Documents\DOT Office\Drawings\Project\570E19\CADD\DATA\CAD\Sheet\0570E19\570E19.dwg

USER NAME = g0t0r	DESIGNED -	REVISED - 09/07 KAG
	DRAWN -	REVISED - 05/08 KJT
PLOT SCALE = 40,0000 * / in.	CHECKED -	REVISED - 04/10 KJT
PLOT DATE = 12/17/2021	DATE -	REVISED - 3/6/17 SWN

**STATE OF ILLINOIS
DEPARTMENT OF TRANSPORTATION**

PRIVATE COMMERCIAL ENTRANCES (NONCOMMERCIAL AND COMMERCIAL RURAL)			
SCALE:	SHEET 1 OF 2 SHEETS	STA.	TO STA.

F.A.U. RTE.	SECTION	COUNTY	TOTAL SHEETS	SHEET NO.
6348	15R5-3	MCLEAN	27	21
CONTRACT NO. 70E19				
ILLINOIS FED. AID PROJECT				

PROJECTS WITH RECONSTRUCTION

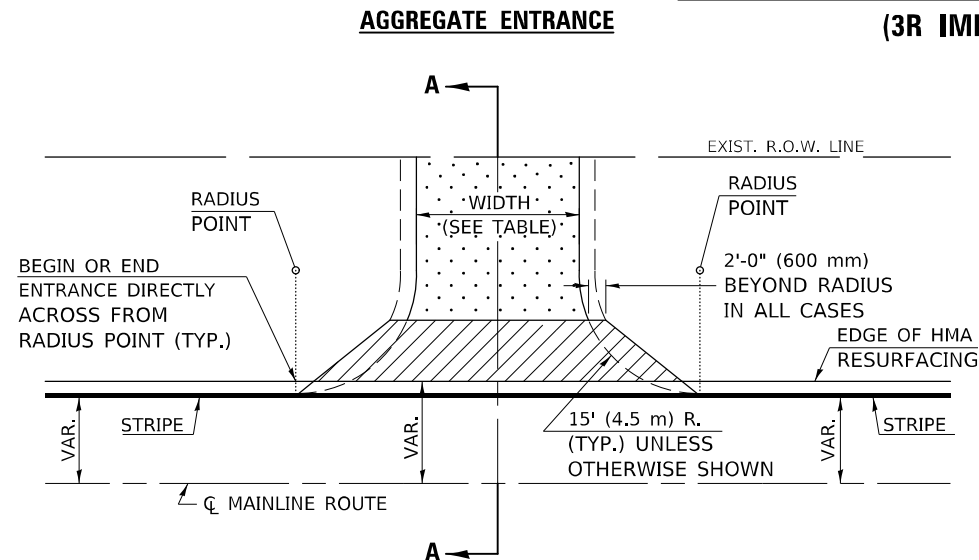

TYPICAL APPLICATION

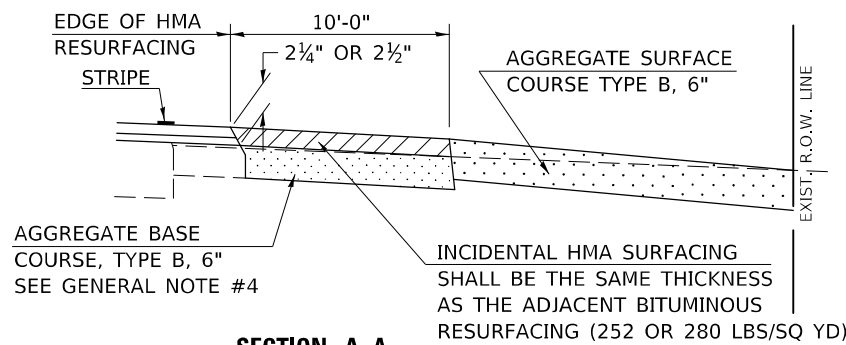

SECTION A-A

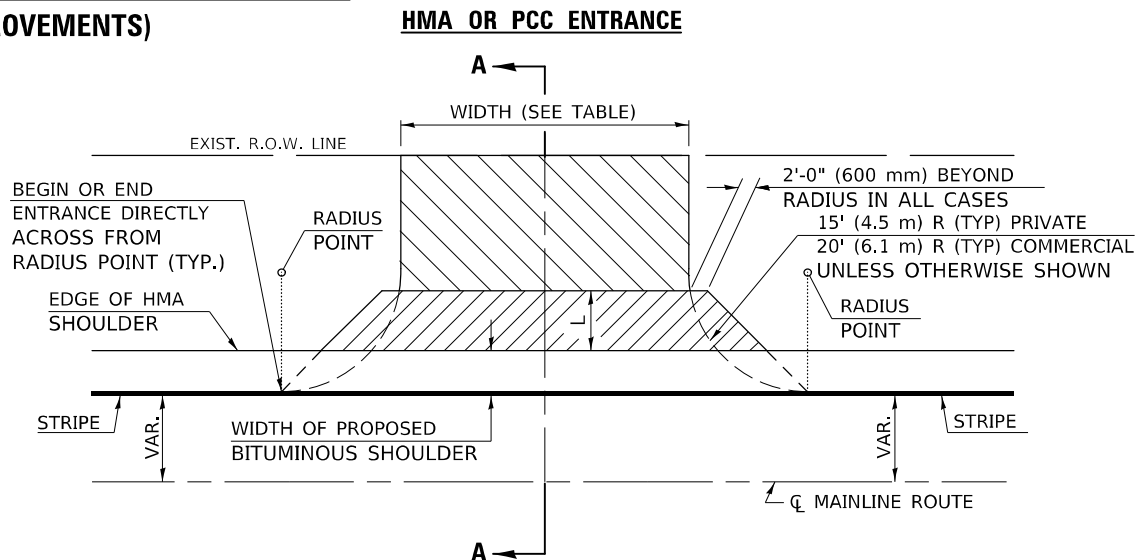

TYPICAL APPLICATION

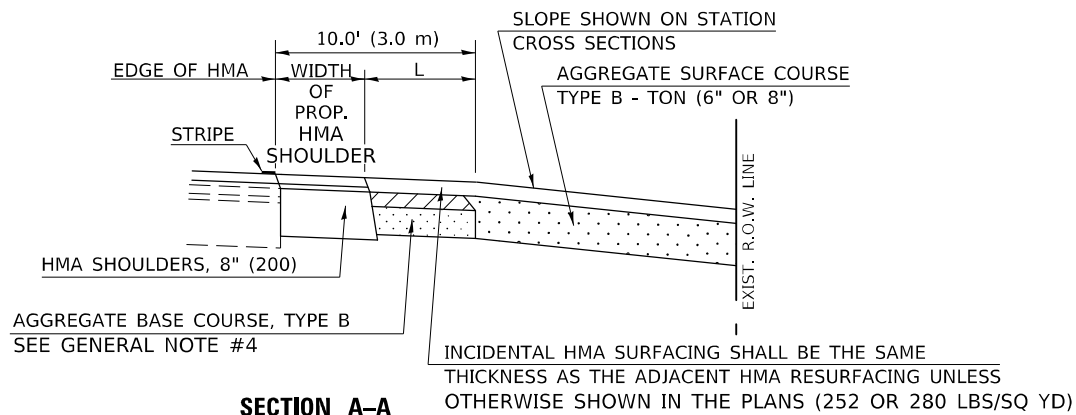

SECTION A-A "HMA EXAMPLE"

GENERAL NOTES

1. THE EXISTING SURFACE SHALL BE PREPARED IN ACCORDANCE WITH SECTION 408 OF THE STANDARD SPECIFICATIONS.
2. ANY NECESSARY WORK BEHIND THE HMA SHOULDER OR THE INCIDENTAL HMA SURFACING SHALL BE AS SHOWN IN THE PLANS AND/OR AS DIRECTED BY THE ENGINEER.
3. EARTH EXCAVATION REQUIRED FOR THE CONSTRUCTION OF THE AGGREGATE SURFACE COURSE SHALL BE INCLUDED IN THE COST OF AGGREGATE SURFACE COURSE.
4. AGGREGATE BASE COURSE, TYPE B, 6" (150 mm) MIN. SHALL BE USED WHERE IN THE OPINION OF THE ENGINEER THERE IS NOT SUFFICIENT BASE MATERIAL FOR THE PROPOSED ENTRANCES. THIS MATERIAL SHALL GENERALLY BE USED TO WIDEN ANY EXISTING RETURN OR TO CONSTRUCT NEW ENTRANCES WHERE NONE NOW EXISTS.
5. THE AGGREGATE BASE COURSE SHALL BE CONSTRUCTED 12" (300 mm) WIDER THAN THE SURFACE DIMENSIONS AS SHOWN ABOVE.
6. EXISTING FIELD ENTRANCES OF AGGREGATE OR EARTH WITH NO HMA APRON SHALL NOT RECEIVE A NEW HMA APRON WITHOUT PROPER APPROVAL THROUGH THE BUREAU OF OPERATIONS "POLICY ON PERMITS FOR ACCESS DRIVEWAYS TO STATE HIGHWAYS".
7. TO ASSURE APPROPRIATE ACCESS POLICIES ARE FOLLOWED ALL NEW ACCESS SHALL BE APPLIED FOR THROUGH THE BUREAU OF OPERATIONS PERMIT APPLICATION PROCESS. PLAN PREPARATION MEMORANDUMS 40-09 ALONG WITH DISTRICT PROJECT IMPLEMENTATION MEMO 104/01 DISCUSS THIS PROCEDURE.

Note: All dimensions are in INCHES (millimeters) unless otherwise shown.

RURAL ENTRANCE DESIGN STANDARDS (PPM 40-09)															
DESIGN ELEMENT	NEW CONSTRUCTION & 3R with CONSTRUCTION						3R w/out RECONSTRUCTION, 3P, SMART & CM								
	NONCOMMERCIAL			FIELD W/FARM IMPLEMENTS			COMMERCIAL			NONCOMMERCIAL			COMMERCIAL		
	min.	des.	max.	min.	max.	min.	des.	max.	min.	des.	max.	min.	des.	max.	
SURFACE WIDTH (FT)	12	16	24	24	30	1 LANE, 1 WAY			1 LANE, 1 WAY			1 LANE, 1 WAY			
						14	16	24							
RADIUS (FT)	15	25	40	30		2 LANE, 2 WAY			2 LANE, 2 WAY			2 LANE, 2 WAY			
						24	30	35							
SHOULDER WIDTH (FT)	2	2		2		1	3		resurface existing configuration; existing aggregate or earth entrances shall have the continuation of aggregate shoulders placed behind them						
SHOULDER SLOPE (%)	2	4	6	4		2	4	6							
ENTRANCE GRADE (%)	0	2 to 5	10 or 12	2 to 5	10 or 12	0	2 to 5	8 or 10							
SIDE SLOPE (FT)	1:10	1:6	1:4	1:6	1:4	1:10	1:6	1:4							
SURFACE TYPE															
INCIDENTAL HMA SURFACING (INCH)		2		2		3 or 4			taper from hma resurfacing thickness (2 1/2", 2 1/4" or 1 1/2") to 1 1/2" to minimize aggregate shoulder						
AGGREGATE SURFACE COURSE, TYPE B (INCH)		6		6		8			if applicable, use items: Preparation of Base & Aggregate Base Repair; see PPM 30-02						
PCC DRIVEWAY PAVEMENT (INCH)		6						6 or 8							

DISTRICT 5 DETAIL NO. 40800050C

USER NAME = g01lejr	DESIGNED -	REVISED - 09/07 KAG
	DRAWN -	REVISED - 05/08 KJT
PLOT SCALE = 40,0000 * / in.	CHECKED -	REVISED - 04/10 KJT
PLOT DATE = 12/17/2021	DATE -	REVISED - 3/6/17 SWN

STATE OF ILLINOIS
DEPARTMENT OF TRANSPORTATION

PRIVATE COMMERCIAL ENTRANCES
(NONCOMMERCIAL AND COMMERCIAL RURAL)

SCALE: SHEET 2 OF 2 SHEETS STA. TO STA.

F.A.U. RTE.	SECTION	COUNTY	TOTAL SHEETS	SHEET NO.
6348	15R5-3	MCLEAN	27	22
CONTRACT NO. 70E19			ILLINOIS FED. AID PROJECT	

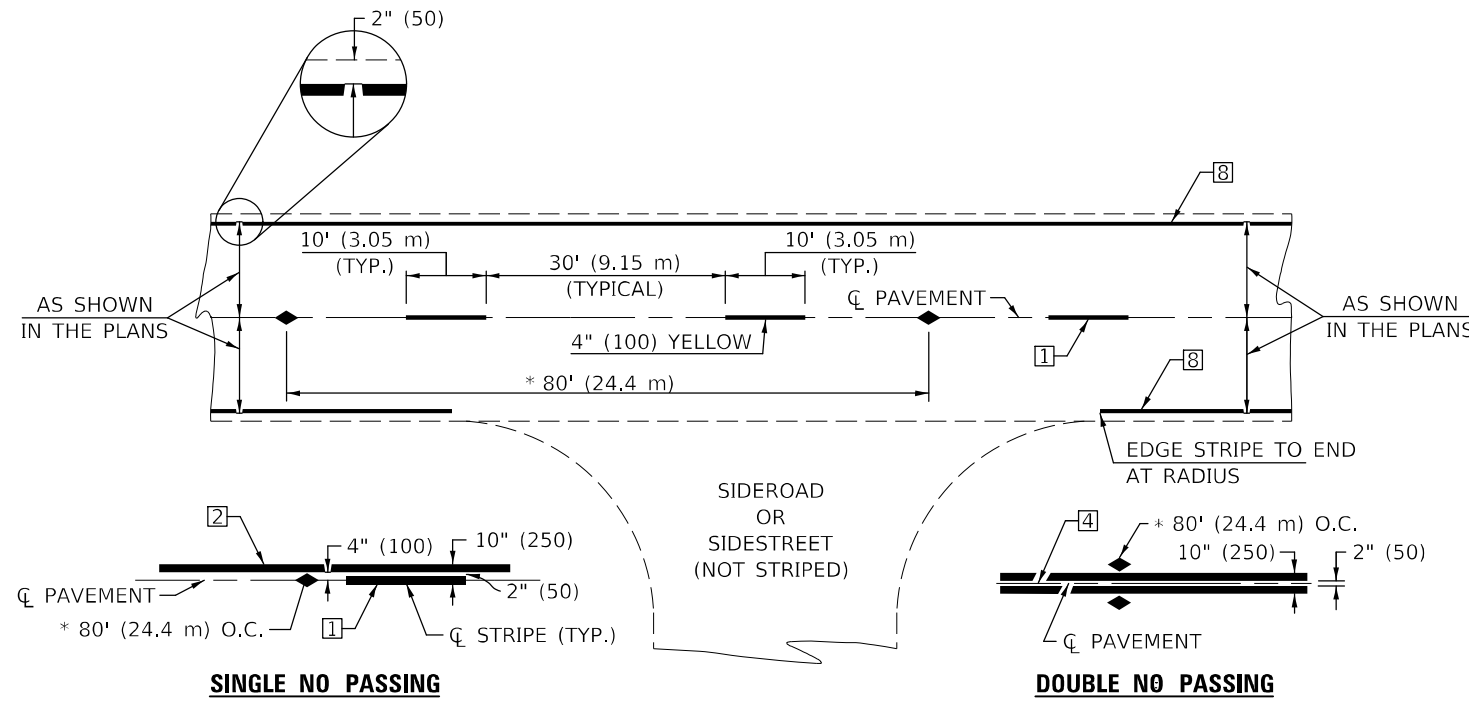

* REDUCE TO 40' (12.2 m) O.C. ON CURVES WITH POSTED OR ADVISORY SPEEDS OF 45 mph (70 km/h) OR LESS.

TWO LANE/TWO WAY

TYPICAL PAVEMENT MARKING LEGEND

- 1 4" (100) SKIP-DASH (YELLOW)
- 2 4" (100) SOLID (YELLOW)
- 3 12" (300) DIAGONAL (YELLOW)
- 4 4" (100) DOUBLE YELLOW (NARROW)
- 5 RESERVED
- 6 RESERVED
- 7 4" (100) SKIP-DASH (WHITE)
- 8 4" (100) SOLID (WHITE)
- 9 12" (300) DIAGONAL (WHITE)
- 10 6" (150) SOLID (WHITE)
- 11 24" (600) STOP BAR (WHITE)
- 12 8" (200) SOLID (WHITE)
- 13 4" (100) LANE LINE EXTENSIONS (WHITE)
- 14 4" (100) PARKING WHITE

TYPICAL PAVEMENT MARKERS LEGEND

- ◆ TWO-WAY AMBER MARKER
- ▶ ONE-WAY AMBER MARKER
- ▷ ONE-WAY CRYSTAL MARKER

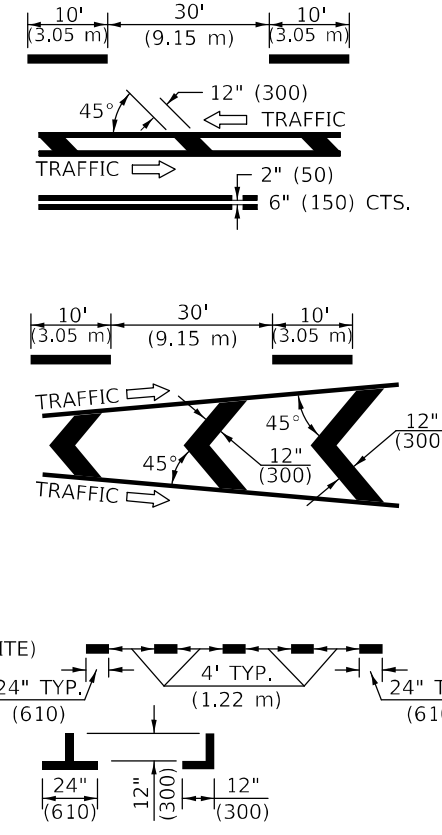

RURAL LEFT TURN

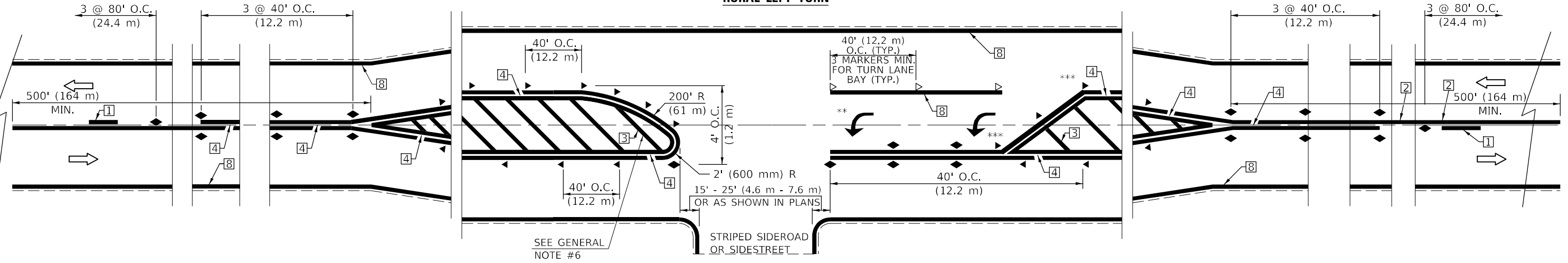

*** REDUCE SPACING IF NECESSARY TO ASSURE MARKERS AT CORNER POINTS.
 ** TURN ARROWS SHALL BE PLACED AS SHOWN ON SHEET #2.

Note: All dimensions are in INCHES (millimeters) unless otherwise shown.

MODEL: I:\MODELS\MARF...
 FILE: MARF...
 PROJECT: I:\PROJECTS\DOT...
 DRAWN: ...
 CHECKED: ...
 DATE: ...

USER NAME = goblejr	DESIGNED -	REVISD - 11/06
	DRAWN -	REVISD - 9/2009 KJT
PLOT SCALE = 40,0000 */ in.	CHECKED -	REVISD - 04/14 JLA
PLOT DATE = 12/17/2021	DATE -	REVISD - 3/2019 SWN

**STATE OF ILLINOIS
 DEPARTMENT OF TRANSPORTATION**

**PAVEMENT MARKING AND MARKERS
 (RURAL & URBAN APPLICATIONS)**

SCALE: SHEET 1 OF 4 SHEETS STA. TO STA.

DISTRICT 5 DETAIL NO. 7800AAAA				
F.A.U. RTE.	SECTION	COUNTY	TOTAL SHEETS	SHEET NO.
6348	15RS-3	MCLEAN	27	23
CONTRACT NO. 70E19				
ILLINOIS FED. AID PROJECT				

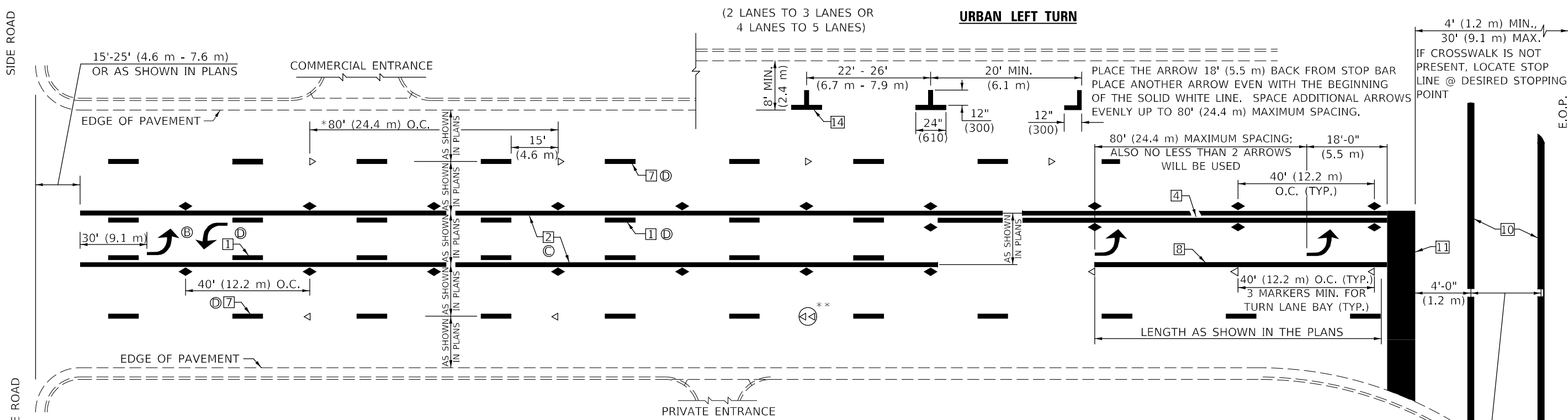

* REDUCE TO 40 FEET (12.2 METERS) ON CENTER ON CURVES WHERE ADVISORY SPEEDS ARE 10 MPH (15 km/h) LOWER THAN POSTED SPEEDS.

** DOUBLE LANE LINE MARKERS SHALL BE SPECIFIED AND SPACED AS SHOWN IN HIGHWAY STANDARD 781001 FOR MULTI-LANE DIVIDED AND UNDIVIDED HIGHWAYS.

- GENERAL NOTES:**
- ⓑ TURN ARROW PAIRS SHALL BE PLACED AT 250' (75 m) INTERVALS AND SHALL BE EVENLY SPACED BETWEEN BOTH ENDS OF THE BIDIRECTIONAL LEFT TURN LANE.
 - ⓒ THE SOLID YELLOW PAVEMENT MARKINGS ② SHOULD GENERALLY START OR END NEAR THE RADIUS POINT OF EACH STREET RETURN EXCEPT WHERE ONE OR BOTH ENDS WOULD INCLUDE STOP BARS.
 - ⓓ THE SKIP-DASH PAVEMENT MARKINGS ① OR ⑦ SHOULD BE CENTERED BETWEEN BOTH ENDS OF EACH CITY BLOCK AND SHALL BE PLACED SO THEY LINE UP ACROSS FROM EACH OTHER. SEE EXAMPLE ON SHEET 2 OF 3.
 - ⓔ USE LARGE ARROW SIZE FOR BOTH RURAL AND URBAN LOCATIONS. (SEE LAST PAGE OF SECTION 780x FOR SYMBOLS TABLE)

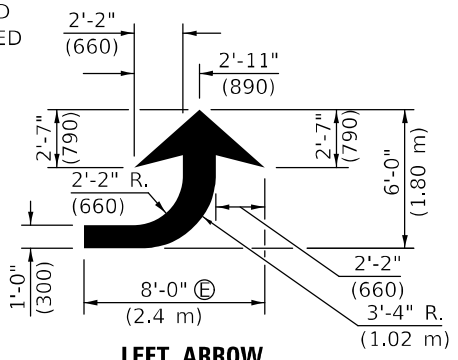

LEFT ARROW

REVERSE FOR RIGHT ARROW
 AREA = 15.6 SQ. FT. (1.47 m²)
 (WHITE)

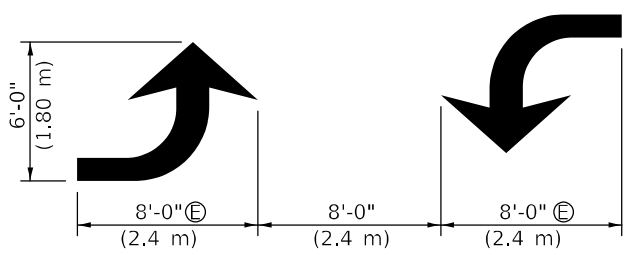

TYPICAL DOUBLE TURN ARROWS (WHITE)



BLOOMINGTON-NORMAL CITY LIMITS ONLY

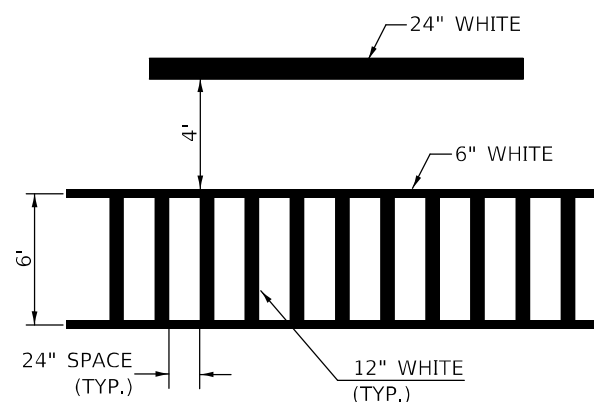

TYPICAL SPACING FOR CROSSWALKS & STOP BARS

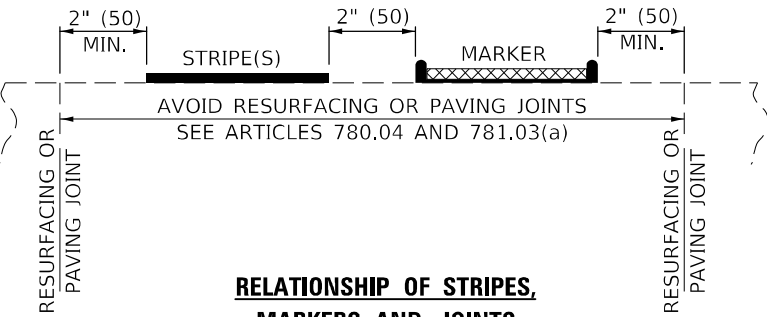

RELATIONSHIP OF STRIPES, MARKERS AND JOINTS

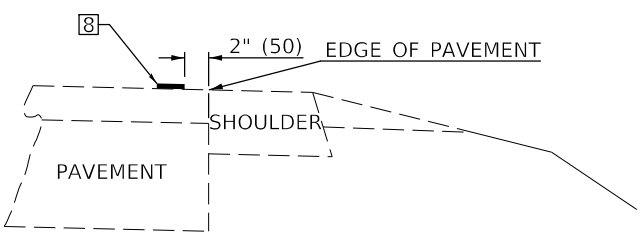

RELATIONSHIP OF EDGE LINE TO EDGE OF PAVEMENT

(SAFETY SHOULDER OR PAVED SURFACE)
 SEE ARTICLE 780.04

Note: All dimensions are in INCHES (millimeters) unless otherwise shown.

DISTRICT 5 DETAIL NO. 7800AAAA

USER NAME = g0t0lejr	DESIGNED -	REVISED - 11/06
	DRAWN -	REVISED - 9/2009 KJT
PLOT SCALE = 40,0000 */ in.	CHECKED -	REVISED - 04/14 JLA
PLOT DATE = 12/17/2021	DATE -	REVISED - 3/2019 SWN

STATE OF ILLINOIS DEPARTMENT OF TRANSPORTATION

PAVEMENT MARKING AND MARKERS (RURAL & URBAN APPLICATIONS)

SCALE: SHEET 2 OF 4 SHEETS STA. TO STA.

F.A.U. RTE.	SECTION	COUNTY	TOTAL SHEETS	SHEET NO.
6348	15R5-3	MCLEAN	27	24
				CONTRACT NO. 70E19
ILLINOIS FED. AID PROJECT				

MODEL: 44081ENR.MXD FILE: 44081ENR.DWG DATE: 12/17/2021 10:00 AM PROJECT: 15R5-3 DISTRICT 5 SHEET 24 OF 27

DESIGNER NOTE: SEE TABLE 2C-4 OF THE MUTCD FOR ADDITIONAL INFORMATION

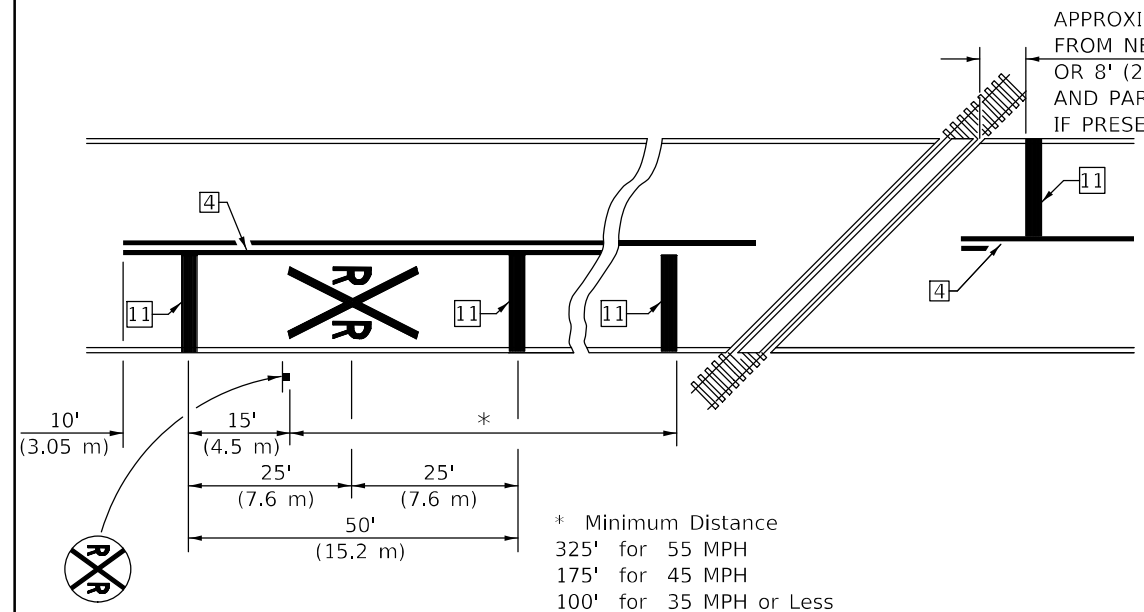

PAVEMENT MARKINGS AT RAILROAD-HIGHWAY GRADE CROSSING

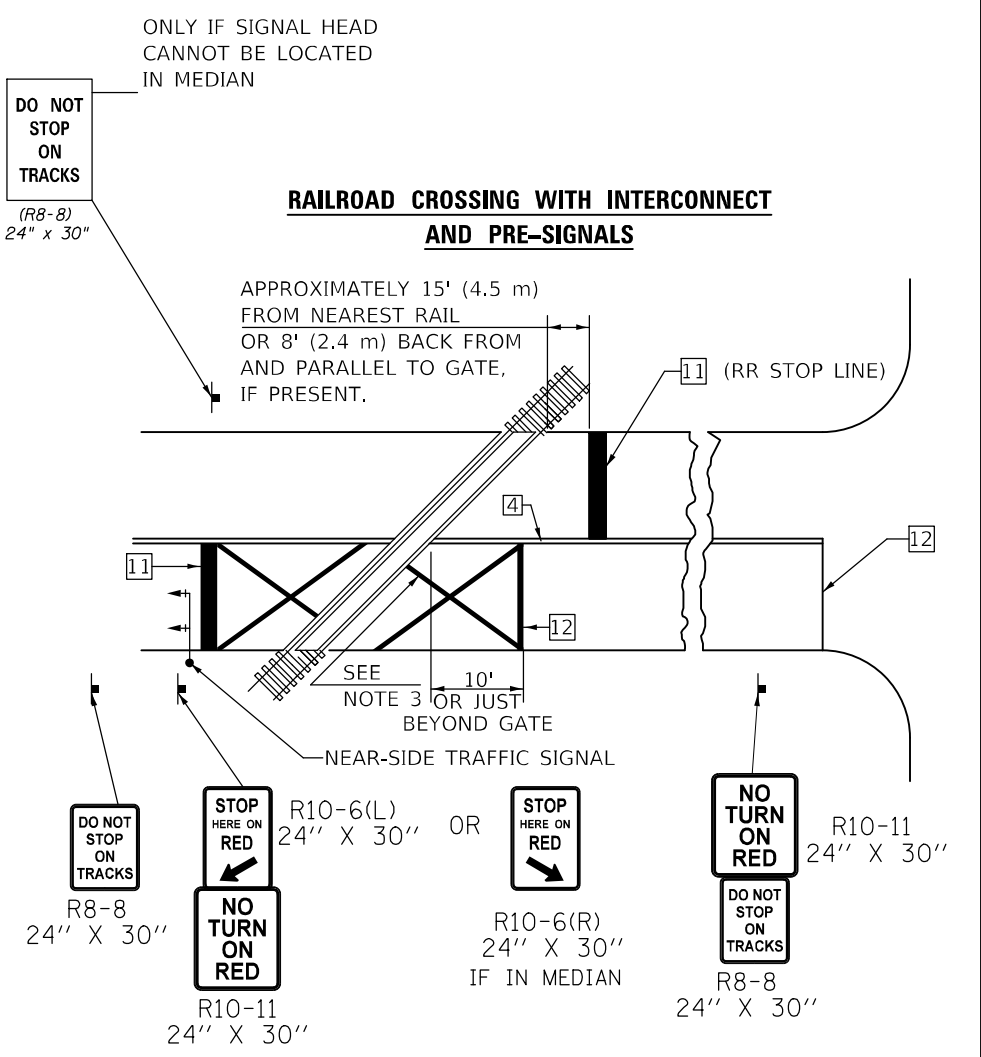
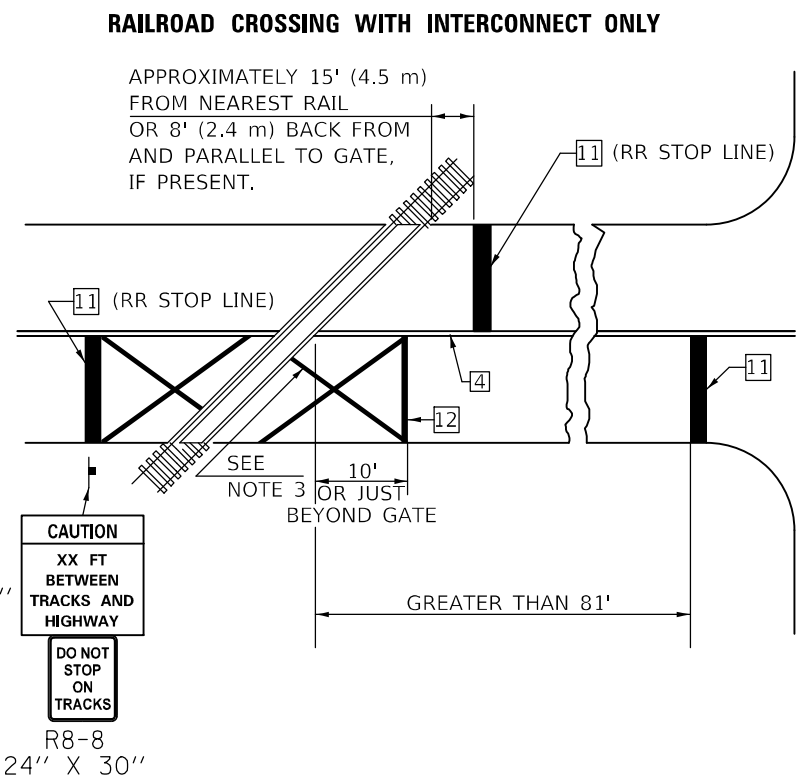

SUPPLEMENTAL PAVEMENT MARKING TREATMENT FOR RAILROAD-HIGHWAY GRADE CROSSING

GENERAL NOTES

1. SUPPLEMENTAL PAVEMENT MARKINGS TO BE INSTALLED ONLY ON APPROACHES TO INTERSECTIONS CONTROLLED BY TRAFFIC SIGNALS WHICH ARE INTERCONNECTED WITH THE RAILROAD WARNING SIGNALS.
2. EXTEND PAVEMENT MARKINGS TO THE INTERSECTION ONLY WHERE NEAR-SIDE TRAFFIC SIGNALS ARE USED.
3. 6" WHITE PAVEMENT MARKINGS AT 45° TO PAVEMENT, 8' CENTER TO CENTER.
4. XX DISTANCE TO BE SHOWN ON SIGN MEASURED FROM A POINT 6 FEET FROM THE RAIL CLOSEST TO THE INTERSECTION OR FROM THE CLOSEST POINT ALONG THE EXIT GATE IF PRESENT OVER THE ROADWAY WHEN IN THE LOWERED POSITION TO THE STOP BAR OR CROSSWALK, WHICH EVER IS CLOSEST, ROUNDED DOWN TO NEAREST 5 FEET. WHERE THERE IS NO STOP LINE, MEASURE TO POINT WHERE DRIVER HAS A VIEW OF APPROACHING TRAFFIC.
5. THE CLEARANCE SIGN IS ALSO TO BE USED AS AN INTERIM MEASURE AT LOCATIONS WITH INTERCONNECTED INTERSECTION TRAFFIC SIGNALS WHERE IT IS PLANNED TO CHANGE THEM TO NEAR-SIDE SIGNALS AT A FUTURE TIME. IN THIS CASE, THE DISTANCE TO BE SHOWN ON THE SIGN IS MEASURED FROM THE EDGE OF THE STRIPED-OUT AREA INSTEAD OF 6 FEET FROM THE RAIL. THE SIGN IS TO BE REMOVED WHEN THE NEAR-SIDE SIGNALS ARE INSTALLED AND THE PAVEMENT MARKINGS EXTENDED TO THE INTERSECTION.

ALTERNATE SIGNS

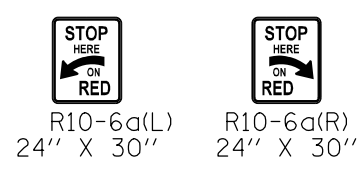

NOTES

THE TRAVERSE SPREAD OF THE "X" MAY VARY ACCORDING TO LANE WIDTH.

ON MULTI-LANE ROADS, THE STOP LINES SHALL EXTEND ACROSS ALL APPROACH LANES AND SEPARATE RXR SYMBOLS SHALL BE PLACED ADJACENT TO EACH OTHER IN EACH LANE.

WHEN THE PAVEMENT MARKING SYMBOL IS USED, A PORTION OF THE SYMBOL SHOULD BE LOCATED DIRECTLY ADJACENT TO THE ADVANCE WARNING SIGN (W10-1) AS PLACED BY TABLE II-1, CONDITION B OF THE MUTCD.

Note: All dimensions are in INCHES (millimeters) unless otherwise shown.

DISTRICT 5 DETAIL NO. 7800AAAA

STATE OF ILLINOIS DEPARTMENT OF TRANSPORTATION

PAVEMENT MARKING AND MARKERS (RURAL & URBAN APPLICATIONS)

USER NAME = goblejr	DESIGNED -	REVISED - 11/06
	DRAWN -	REVISED - 9/2009 KJT
PLOT SCALE = 40,0000 */ in.	CHECKED -	REVISED - 04/14 JLA
PLOT DATE = 12/17/2021	DATE -	REVISED - 3/2019 SWN

SCALE: SHEET 4 OF 4 SHEETS STA. TO STA.

F.A.U. RTE.	SECTION	COUNTY	TOTAL SHEETS	SHEET NO.
6348	15RS-3	MCLEAN	27	25
CONTRACT NO. 70E19				

MODEL: 440016.MXFS
FILE: 440016_PAVEMAR.dwg
PROJECT: 10570E19_CADDATA\CADD\PROJECTS\10570E19_PAVEMAR.dwg

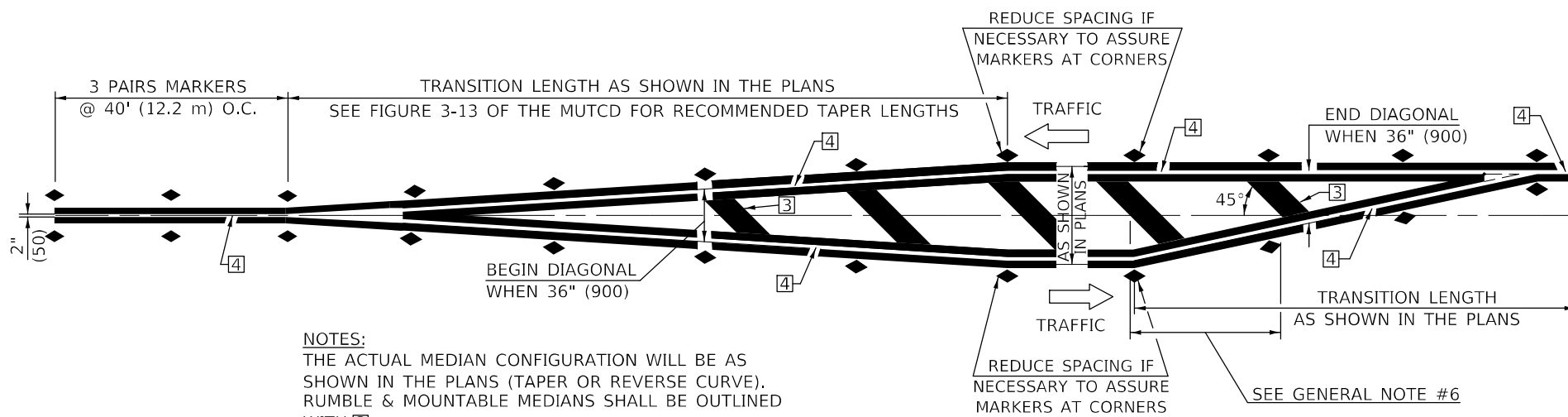

NOTES:
THE ACTUAL MEDIAN CONFIGURATION WILL BE AS SHOWN IN THE PLANS (TAPER OR REVERSE CURVE). RUMBLE & MOUNTABLE MEDIANS SHALL BE OUTLINED WITH [2].

TYPICAL MEDIAN TRANSITIONS

GENERAL NOTES

1. WHEN MEDIANS ARE PRESENT, PAVEMENT MARKINGS ARE TO BE PLACED ADJACENT TO MEDIANS.
2. SOME OF THE INFORMATION INCLUDED WITH THIS DETAIL MAY NOT BE APPLICABLE TO THIS IMPROVEMENT.
3. PAVEMENT MARKINGS ARE TO BE EXTENDED THROUGH OMISSIONS WHEN APPLICABLE.
4. A STRIPING KEY IS AVAILABLE ELSEWHERE AND SHALL BE SHOWN WHERE THE QUANTITIES ARE LISTED.
5. FINAL PAVEMENT MARKINGS SHALL BE IN PLACE PRIOR TO PLACING ANY RAISED REFLECTIVE PAVEMENT MARKERS.
6. THE FOLLOWING CRITERIA SHALL BE USED FOR SELECTING THE DIAGONAL PAVEMENT MARKING SPACING,
<30 MPH USE 15' (<50 km/h USE 4.5 m)
30-45 MPH USE 20' (50-75 km/h USE 6.0 m)
>45 MPH USE 30' (>75 km/h USE 9.0 m)

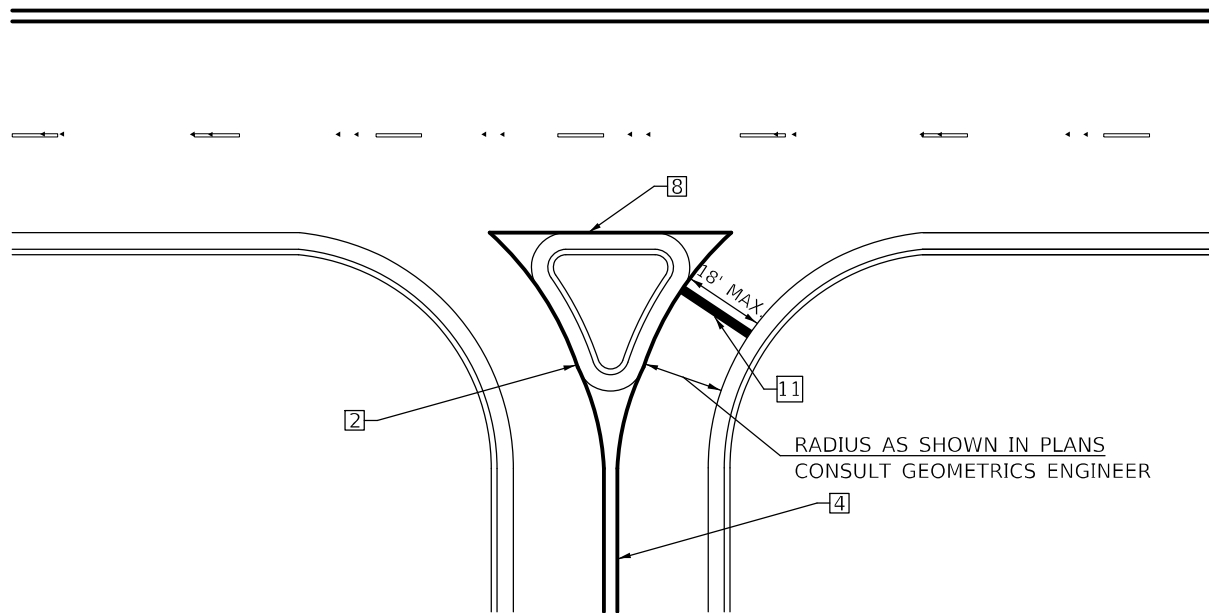

RIGHT IN - RIGHT OUT ACCESS

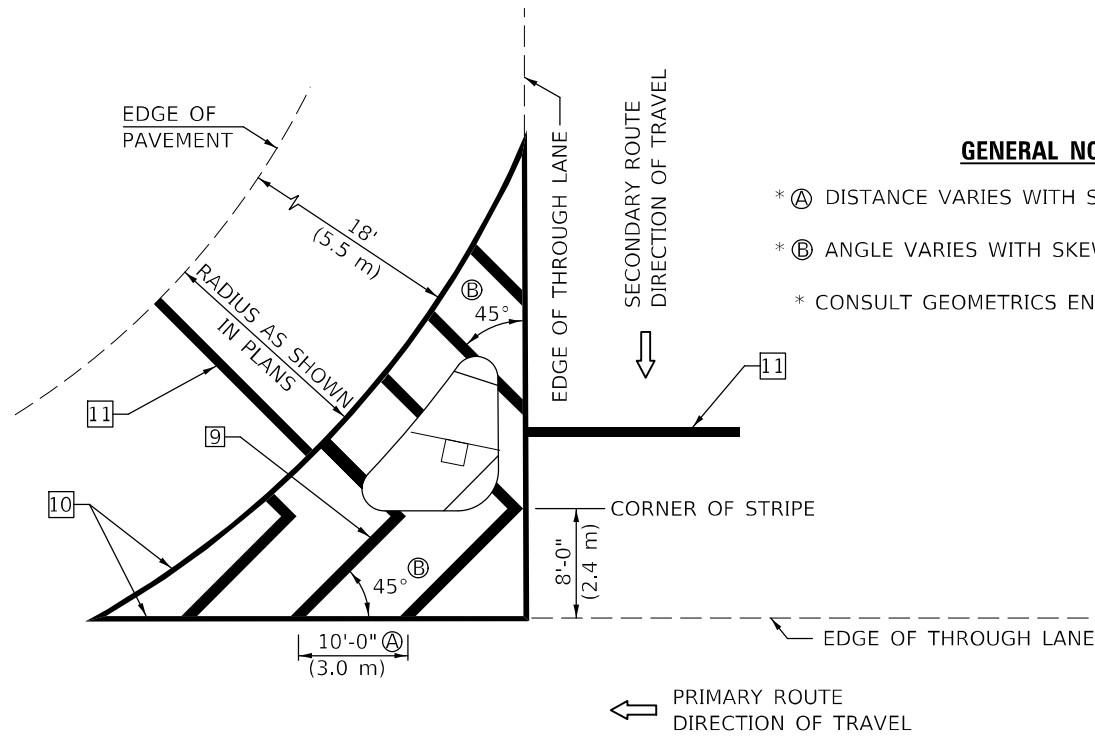

ISLAND

GENERAL NOTES

- * A DISTANCE VARIES WITH SKEW OF INTERSECTION.
- * B ANGLE VARIES WITH SKEW OF INTERSECTION.
- * CONSULT GEOMETRICS ENGINEER

Note: All dimensions are in INCHES (millimeters) unless otherwise shown.

DISTRICT 5 DETAIL NO. 7800AAAA

MODEL: I:\MODEL MARKS FILE NAME: P:\Public\paw_bentley.com\PIV\DOT\Documents\DOT Office\Dir\dir: S:\Project\10570E19\CADD\data\CAD\Sheet\10570E19.rvt-Detail.dgn

USER NAME = goblejr	DESIGNED -	REVISD - 11/06
	DRAWN -	REVISD - 9/2009 KJT
PLOT SCALE = 40,0000 * / in.	CHECKED -	REVISD - 04/14 JLA
PLOT DATE = 12/17/2021	DATE -	REVISD - 3/2019 SWN

STATE OF ILLINOIS
DEPARTMENT OF TRANSPORTATION

PAVEMENT MARKING AND MARKERS
(RURAL & URBAN APPLICATIONS)

SCALE: SHEET 3 OF 4 SHEETS STA. TO STA.

F.A.U. RTE.	SECTION	COUNTY	TOTAL SHEETS	SHEET NO.
6348	15RS-3	MCLEAN	27	26
CONTRACT NO. 70E19			ILLINOIS FED. AID PROJECT	

XZ193300 – SURVEY MARKER, TYPE 1 (SPECIAL)

TO BE INSTALLED IN FLEXIBLE PAVEMENT OR SHOULDER, BITUMINOUS TREATED SURFACE AND TURF AREAS WITHIN THE RIGHT-OF-WAY FOR PRESERVING PERMANENT SURVEY MARKERS (PI'S, PT'S, PC'S, POC'S, & POT'S)

XZ193400 – SURVEY MARKER, TYPE 2 (SPECIAL)

TO BE INSTALLED IN RIGID OR COMPOSITE PAVEMENT FOR PRESERVING PERMANENT SURVEY MARKERS (PI'S, PT'S, PC'S, POC'S, & POT'S)

SPECIFICATIONS FOR ALUMINUM TABLET

SURVEY CAP FOR REBAR. 3 1/4" (83 mm) CONVEX SURVEY CAP FOR 5/8" (15 mm) REBAR WITH ILLINOIS DEPARTMENT OF TRANSPORTATION LOGO. THIS LOGO SHALL PROVIDE LETTERS RECESSED INTO THE SURFACE A MINIMUM OF 1/32" (0.8 mm) FOR EASY AND LONG-TERM LEGIBILITY. THE ALUMINUM CAP FOR REBAR SHALL BE PRODUCED BY THE PROCESS OF ORBITAL FORGING TO PRODUCE A HIGH-STRENGTH AND DURABLE MARKER CAP WHICH WILL NOT CHIP OR BREAK AND PROVIDE A SMOOTH FINISH FOR STAMPING OF DATA IN THE FIELD. THE ALUMINUM CAP FOR REBAR SHALL BE TAPERED FOR A PERFECT COMPRESSION FIT. A SPECIAL PLASTIC INSULATOR SHALL BE INSTALLED TO PREVENT DISSIMILAR METAL CONTACT AND CORROSION. THE PLASTIC INSULATOR SHALL FORM READILY TO THE OUTER SHAPE OF THE REBAR AND TO THE INNER SHAPE OF THE ALUMINUM CAP SOCKET. THE PLASTIC INSULATOR SHALL BE LOW DENSITY POLYETHYLENE, A MINIMUM 1 1/2" (38 mm) LONG AND CONFORM TO FEDERAL SPECIFICATION L-P 390.

COMPOSITION: ALUMINUM 98.3-98.7%; OTHER 1.3-1.7%; STRENGTH: YIELD 28 KSI (193 MPa), ULTIMATE 32 KSI (221 MPa), ELONGATION 15% [IN 2" (50 mm)]. SPECIFICATIONS: ALUMINUM ALLOY 6101-0; ASTM B317-83 (EXCEPT TEMPER) AS FORGED. NO EXCEPTIONS.

SPECIFICATIONS FOR REBAR

REBAR FOR ALUMINUM TABLET. REINFORCEMENT BAR SHALL BE 5/8" (#15) X 48" (1.2 m) (DEFORMED).

INSPECTION OF REINFORCEMENT BAR 5/8" (#15) SHALL BE DONE BY DISTRICT PERSONNEL OF THE ILLINOIS DEPARTMENT OF TRANSPORTATION, DIVISION OF HIGHWAYS.

SPECIFICATIONS FOR ALUMINUM TABLET (FORKED)

ALUMINUM TABLET (FORKED) FOR USE WITH "SURVEY MARKER, TYPE 2, (SPECIAL)" SHALL BE AS SHOWN ON THE DETAIL FOR THE 3 1/4" (83 mm) CONVEX SURVEY TABLET WITH ILLINOIS DEPARTMENT OF TRANSPORTATION LOGO. THIS LOGO SHALL PROVIDE FOR LETTERS RECESSED INTO THE SURFACE A MINIMUM OF 1/32" (0.8 mm) FOR EASY AND LONG-TERM LEGIBILITY. THE ALUMINUM TABLET SHALL BE PRODUCED BY THE PROCESS OF ORBITAL FORGING TO PRODUCE A HIGH-STRENGTH AND DURABLE MARKER CAP WHICH WILL NOT CHIP OR BREAK AND PROVIDE A SMOOTH FINISH FOR STAMPING OF DATA IN THE FIELD. THE ALUMINUM TABLET SHALL BE DESIGNED NOT TO TURN OR ROTATE. THREE PRONGS ON A 2 1/2" (63 mm) STEM SHALL BE SUCH THAT THE ALUMINUM TABLET CANNOT BE EASILY REMOVED.

COMPOSITION: ALUMINUM 92-93%; MAGNESIUM 6.5-7.5%. STRENGTH: YIELD 19,000-21,000 PSI (131-145 MPa); TENSILE 38,000-44,000 PSI (262-303 MPa); ELONGATION 10-15% [IN 2" (50 mm)]. SPECIFICATIONS: ALLOY 535.0; QQ-A-601ES. NO EXCEPTIONS.

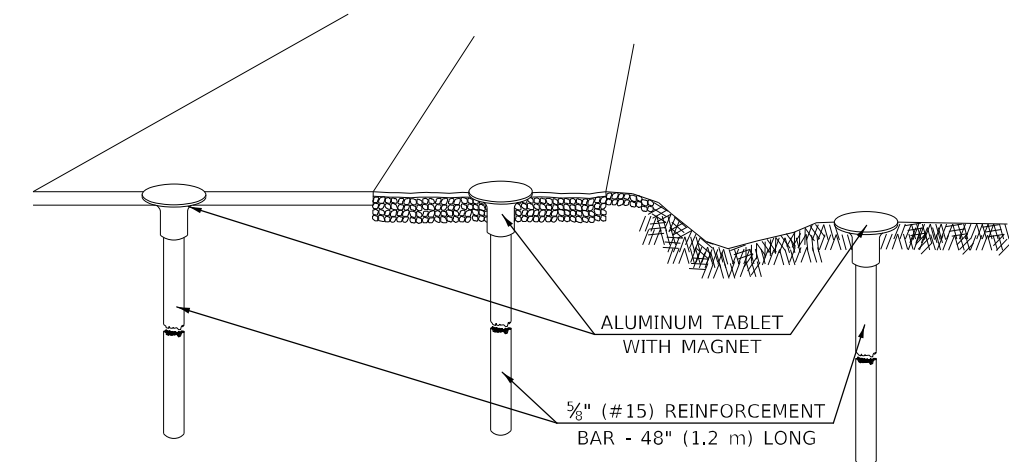

IN FLEXIBLE PAVEMENT OR SHOULDER

IN BITUMINOUS TREATED SURFACE

IN TURF AREAS WITHIN R.O.W.

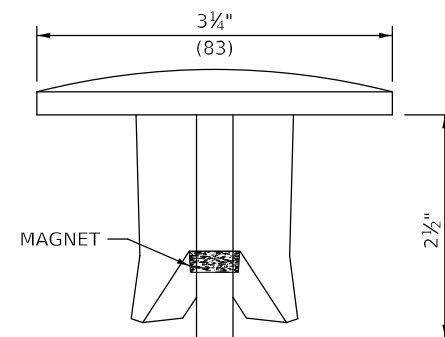
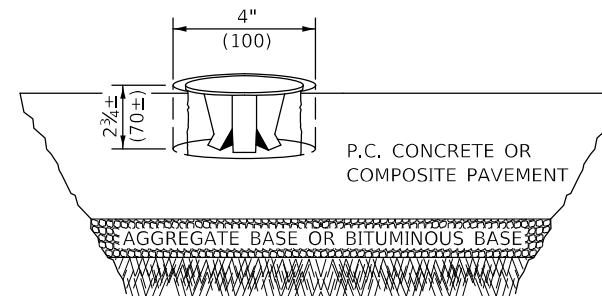

SIDE VIEW

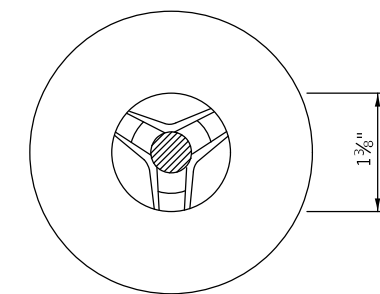

BOTTOM VIEW

THE DIMENSIONS SHOWN SHALL BE EXACT, OTHERS MAY VARY, BUT SHALL BE SHOWN ON SHOP DRAWINGS.

GENERAL NOTES

1. WORK ON THIS ITEM SHALL NOT START UNTIL THE FINAL SURFACE IS COMPLETED.
2. THE ALUMINUM TABLET (FORKED) SHALL REST UPON THE BOTTOM OF THE 4" (100 mm) CORE HOLE. IF THE HOLE IS TOO DEEP, EPOXY GROUT MUST BE USED TO DECREASE THE DEPTH AND ALLOWED TO HARDEN BEFORE PROCEEDING.
3. THE ALUMINUM TABLET SHALL BE ANCHORED IN THE 4" (100 mm) DIAMETER HOLE IN THE NEW PAVEMENT WITH TWO-COMPONENT EPOXY CONFORMING TO APPLICABLE PORTIONS OF ARTICLE 1025.01 OF THE STANDARD SPECIFICATIONS.
4. THE 4" (100 mm) CORE HOLE SHALL BE SUBJECT TO THE APPROVAL OF THE ENGINEER.
5. THE CONTRACT PRICE, EACH, FOR SURVEY MARKER, TYPE 2 (SPECIAL) SHALL BE PAYMENT IN FULL FOR FURNISHING THE ALUMINUM TABLET AND FOR ALL LABOR AND MATERIAL REQUIRED TO SET THE MARKER IN PLACE, AS SPECIFIED, INCLUDING CORRECTING THE NEW PAVEMENT.
6. ALL SURVEY MARKERS, TYPE 2 (SPECIAL) SHALL BE PLACED ± 1/4" (6 mm) BELOW THE FINAL SURFACE.

Note: All dimensions are in INCHES (millimeters) unless otherwise shown.

DESIGNER NOTE: BDE 58-8.02 "PLACE MARKERS AT THE PT'S AND PC'S OF ALL HORIZONTAL CURVES AND SPACE THEM ALONG TANGENTS SO THAT TWO MARKERS ARE ALWAYS INTERVISIBLE."

MODEL: 4400161.MXD
FILE: 4400161.dwg
PROJECT: 150701-19-CADDATA\CAD\Sheet\0570E19-01-Detail.dwg
PROJECT DIR: S:\Project\150701-19-CADDATA\CAD\Sheet\0570E19-01-Detail.dwg

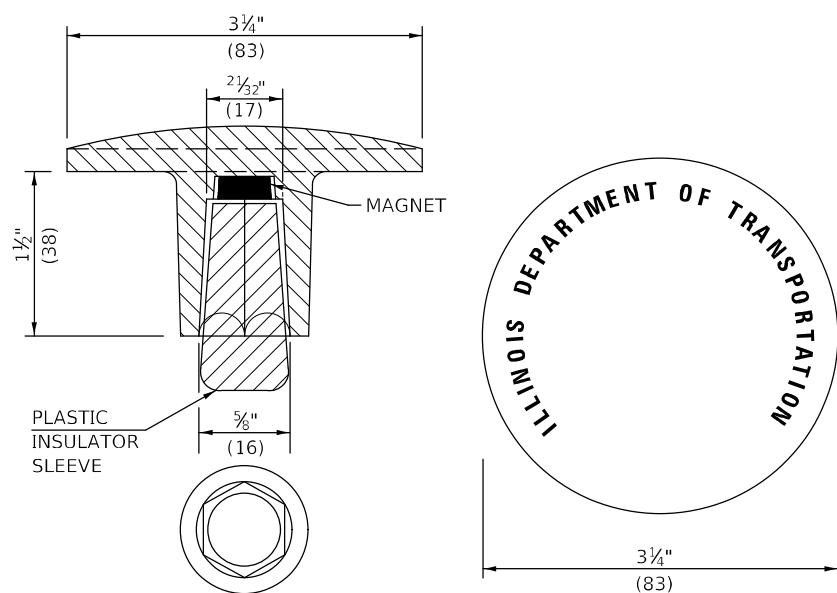

THE DIMENSIONS SHOWN SHALL BE EXACT, OTHERS MAY VARY, BUT SHALL BE SHOWN ON SHOP DRAWINGS.

GENERAL NOTES

1. THE CONTRACT UNIT PRICE, EACH, FOR SURVEY MARKER, TYPE 1 (SPECIAL) SHALL BE PAYMENT IN FULL FOR FURNISHING THE REINFORCEMENT BAR AND ALUMINUM TABLET AND FOR ALL LABOR AND MATERIAL REQUIRED TO SET THE MARKER IN PLACE.
2. ALL SURVEY MARKERS, TYPE 1 (SPECIAL) SHALL BE PLACED ±1/4" (6 mm) BELOW THE FINAL SURFACE.
3. WHEN THE TABLET AND REBAR ARE PLACED AS PART OF A SURVEY MARKER VAULT, THEY SHALL BE CONSIDERED AS INCLUDED IN THAT PAY ITEM AND THERE WILL BE NO PAYMENT FOR THE SURVEY MARKER, TYPE 1 (SPECIAL).

USER NAME = g01e1r	DESIGNED -	REVISED - 11/06
	DRAWN -	REVISED - 11/10
PLOT SCALE = 40,0000 * / in.	CHECKED -	REVISED -
PLOT DATE = 12/17/2021	DATE -	REVISED -

**STATE OF ILLINOIS
DEPARTMENT OF TRANSPORTATION**

SURVEY MARKERS TYPE 1 & 2 (SPECIAL)

SCALE: SHEET OF SHEETS STA. TO STA.

DISTRICT 5 DETAIL NO. XZ193AAA

F.A.U. RTE.	SECTION	COUNTY	TOTAL SHEETS	SHEET NO.
6348	15RS-3	MCLEAN	27	27
				CONTRACT NO. 70E19
				ILLINOIS FED. AID PROJECT