

INDEX OF SHEETS

HIGHWAY STANDARDS

1 COVER SHEET
 2 INDEX, STANDARDS, GENERAL NOTES, & SIGNATURES
 3 SUMMARY OF QUANTITIES
 EXISTING BRIDGE PLANS (FOR INFORMATION ONLY)
 4-12 LOCATION #1 & #2; SN 084-0073 & 0178

000001-08
 001006
 701101-05
 701106-02
 701423-10
 701901-08
 704001-08
 782006-01

GENERAL NOTES:

1. WORK SHALL CONSIST OF BLASTING AND PAINTING STRUCTURAL STEEL AT LOCATIONS DESCRIBED IN THE SPECIAL PROVISIONS. CLEANING AND PAINTING OF THE EXISTING STRUCTURAL STEEL SHALL BE AS SPECIFIED IN THE SPECIAL PROVISIONS FOR "CLEANING AND PAINTING EXISTING STEEL STRUCTURES". ALL AREAS TO BE PAINTED SHALL BE CLEANED PER NEAR WHITE BLAST CLEANING PER SSPC SP 10. ALL EXISTING STEEL CLEANED SHALL BE PAINTED ACCORDING TO THE REQUIREMENTS OF PAINT SYSTEM 1 - OZ/E/U. THE COLOR OF THE FINAL FINISH COATS SHALL BE AS DESCRIBED IN THE SPECIAL PROVISIONS.
2. THE USE OF AIR MONITORS WILL BE REQUIRED AT LOCATIONS AS CALLED OUT IN THE SPECIAL PROVISIONS.
3. THE SSPC-QP-1 AND SSPC-QP2 PAINTING CONTRACTOR CERTIFICATIONS WILL BE REQUIRED.
4. CARE SHALL BE TAKEN NOT TO DAMAGE RUBBER BEARING OR JOINT COMPONENTS DURING BLASTING AND CLEANING OPERATIONS. ANY DAMAGE TO THESE COMPONENTS SHALL BE REPAIRED AT THE CONTRACTOR'S EXPENSE. RUBBER COMPONENTS SHALL NOT BE PAINTED.
5. UPON COMPLETION OF PAINTING OPERATIONS, THE CONTRACTOR SHALL REMOVE ALL DEBRIS FROM PIER OR ABUTMENT CAPS UPON WHICH PAINTING OPERATIONS TOOK PLACE. FINAL CLEANUP SHALL BE CONSIDERED INCIDENTAL TO THE PAINT PAY ITEM FOR THE RESPECTIVE LOCATION. THE ENGINEER SHALL HAVE THE RIGHT TO WITHHOLD PAYMENT UNTIL SATISFACTORY CLEANUP IS ACHIEVED.
6. NORFOLK SOUTHERN RR CONTACT INFORMATION:
 BRIAN TAYLOR - ENGINEER PUBLIC IMPROVEMENTS
 NORFOLK SOUTHERN CORPORATION
 650 WEST PEACHTREE STREET NW - BOX 45
 (678) 333-4274
 GEORGE.TAYLOR3@NSCORP.COM
7. ALL WORK TO BE PERFORMED ON, OVER, UNDER, OR ADJACENT TO THE RAILROAD RIGHT-OF-WAY SHALL COMPLY WITH THE NORFOLK SOUTHERN RAILWAY COMPANY PUBLIC PROJECTS MANUAL (APPENDIX E, SPECIAL PROVISIONS FOR THE PROTECTION OF RAILWAY INTERESTS, AND APPENDIX HI, OVERHEAD GRADE SEPARATION DESIGN CRITERIA). WHEN IN CONFLICT WITH OTHER PROJECT SPECIFICATIONS, THE MOST STRINGENT ONE SHALL APPLY.
8. MINIMUM CLEARANCES FOR CONTAINMENT SYSTEM, OPERATIONS, AND REMOVAL SHALL NOT BE LESS THAN 22'-0" ABOVE THE TOP OF RAIL OF NORFOLK SOUTHERN TRACKS AND 13'-0" FROM CENTERLINE OF TRACK MEASURED AT RIGHT ANGLE. ALL PROPOSED TEMPORARY CLEARANCES WHICH ARE LESS THAN THOSE LISTED ABOVE MUST ALSO BE AUTHORIZED BY THE REGULATORY BODY OF THE STATE IF LESS THAN LEGALLY PRESCRIBED CLEARANCES.
9. EXISTING VERTICAL AND HORIZONTAL CLEARANCES MUST BE VERIFIED BY CONTRACTOR PRIOR TO COMMENCEMENT OF WORK.
10. TRACK AND GROUND PROTECTION SHALL BE PROVIDED TO PROTECT THE BALLAST SECTION AND GROUND FROM CONTAMINATION OF SPENT ABRASIVES OR OTHER MATERIAL FROM FALLING ONTO THE RAILWAY'S TRACKS AND RIGHT-OF-WAY. THE CONTRACTOR WILL BE RESPONSIBLE FOR ALL REMOVAL, REMEDIATION, AND RESTORATION WORK. CONTRACTOR TO PROVIDE THIS IN SEPARATE CONSTRUCTION SUBMITTAL.

**STATE OF ILLINOIS
 DEPARTMENT OF TRANSPORTATION
 DIVISION OF HIGHWAYS
 DISTRICT 6**

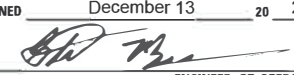
EXAMINED December 13 20 21

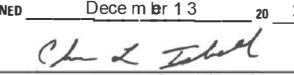
 ENGINEER OF OPERATIONS

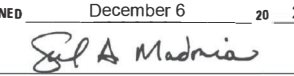
EXAMINED December 13 20 21

 ENGINEER OF PROJECT IMPLEMENTATION

EXAMINED December 6 20 21

 ENGINEER OF PROGRAM DEVELOPMENT

1 REVISED 2-22-2022

MODEL: D:\dwg\h...
 FILE NAME: S:\bridges\bridgeplans_CAD\72N07_0840073 & 0178_paintingsheet.dwg

USER NAME = dudleybm PLOT SCALE = 100.0000' / in. PLOT DATE = 2/10/2022	DESIGNED - DRAWN - CHECKED - DATE -	REVISED - REVISED - REVISED - REVISED -	STATE OF ILLINOIS DEPARTMENT OF TRANSPORTATION	INDEX OF SHEETS, STANDARDS, GENERAL NOTES, & SIGNATURES	F.A.P. RTE. 668	SECTION (28VBR) BP	COUNTY SANGAMON	TOTAL SHEETS 12	SHEET NO. 2
				SCALE: SHEET OF SHEETS STA. TO STA.	ILLINOIS FED. AID PROJECT				

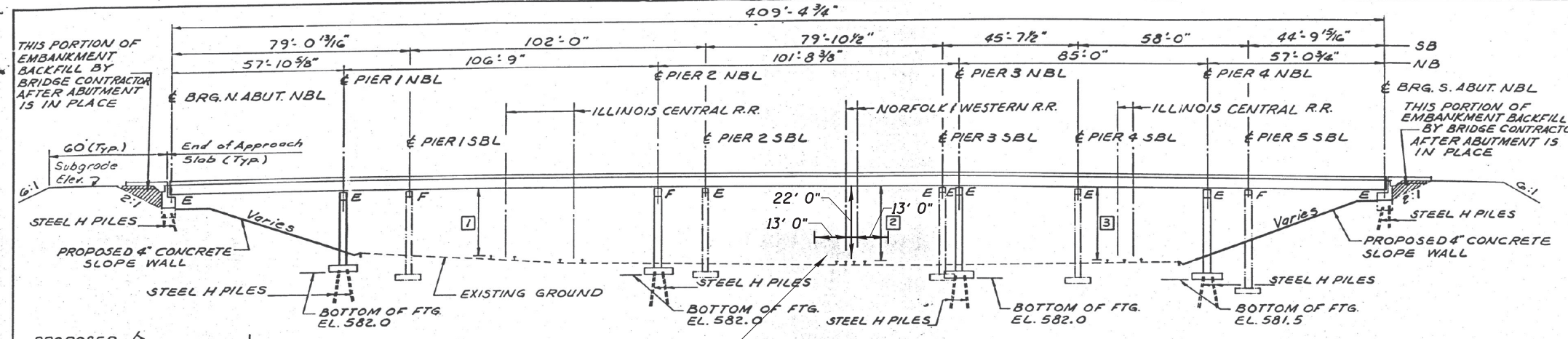
ROUTE NO.	SECTION	COUNTY	TOTAL SHEETS	SHEET NO.	SHEET NO. / SHEETS
FAU8041	28VBR	SANGAMON	84	29	30
FED. ROAD DIST. NO. 7	ILLINOIS	FED. AID PROJECT			



DESIGN STRESSES

SUPERSTRUCTURE:
 $F_c = 3,500$ P.S.I. - CONCRETE
 $F_y = 60,000$ P.S.I. - REINFORCEMENT
 $F_y = 50,000$ P.S.I. - STRUCTURAL STEEL

SUBSTRUCTURE:
 $F_c = 3,500$ P.S.I. - CONCRETE
 $F_y = 60,000$ P.S.I. - REINFORCEMENT

LOADING:
 LIVE LOAD: HS20-44
 FUTURE W.S.: 25 LBS./SQ. FT.

DESIGN SPECIFICATIONS
 1977 AASHTO SPECIFICATION #1978, 1979, 1980,
 1981 INTERIM SPECIFICATIONS.

EXISTING STRUCTURE - STA. 148+05.62, #084-0073
 BUILT AS F.A. ROUTE 149, S.C.C.'S. 28 V.B. F.A.H.
 AND 28 V.F. - F.A.G.H., IN 1939.

SUPERSTRUCTURE: ROLLED STEEL BEAMS AND REINFORCED CONCRETE DECK.

SUBSTRUCTURE: OPEN ABUTMENTS CONSTRUCTED ON REINFORCED CONCRETE PEDESTALS SUPPORTED BY REINFORCED CONCRETE FOOTINGS ON PILES. (ABUTMENT 1 ONLY, ABUTMENT 2 IS SUPPORTED ON SPREAD FOOTINGS.) REINFORCED CONCRETE FRAME PIERS ON PILES.

CONTRACTOR SHALL REMOVE THE EXISTING SUPERSTRUCTURE AND PORTIONS OF THE EXISTING SUBSTRUCTURES AS NOTED.

STAGE CONSTRUCTION
 CONSTRUCT THE NEW NORTHBOUND STRUCTURE PRIOR TO REMOVING THE EXISTING BRIDGE SUPERSTRUCTURE, MAINTAIN TWO-WAY TRAFFIC AT ALL TIMES DURING ALL STAGES OF CONSTRUCTION.

APPROVED
 FOR STRUCTURAL ADEQUACY ONLY

Carl E. Hummer
 Engineer of Bridges and Structures

BENCH MARK CHISELED "M" ON EXISTING S.W. WINGWALL, STA. 150+20 ELEV. 614.27



Edward T. Sablatny

GENERAL PLAN & ELEVATION
 ILL. RTE. 54 OVER
 ILL. CENTRAL R.R. &
 NORFOLK & WESTERN R.R.
 FAU 8041
 SECTION 28 VBR
 SANGAMON COUNTY
 STA. 147+94.62 (NB & SB)
 DALTON-DALTON-NEWPORT
 CONSULTING ENGINEERS - AKRON, OHIO

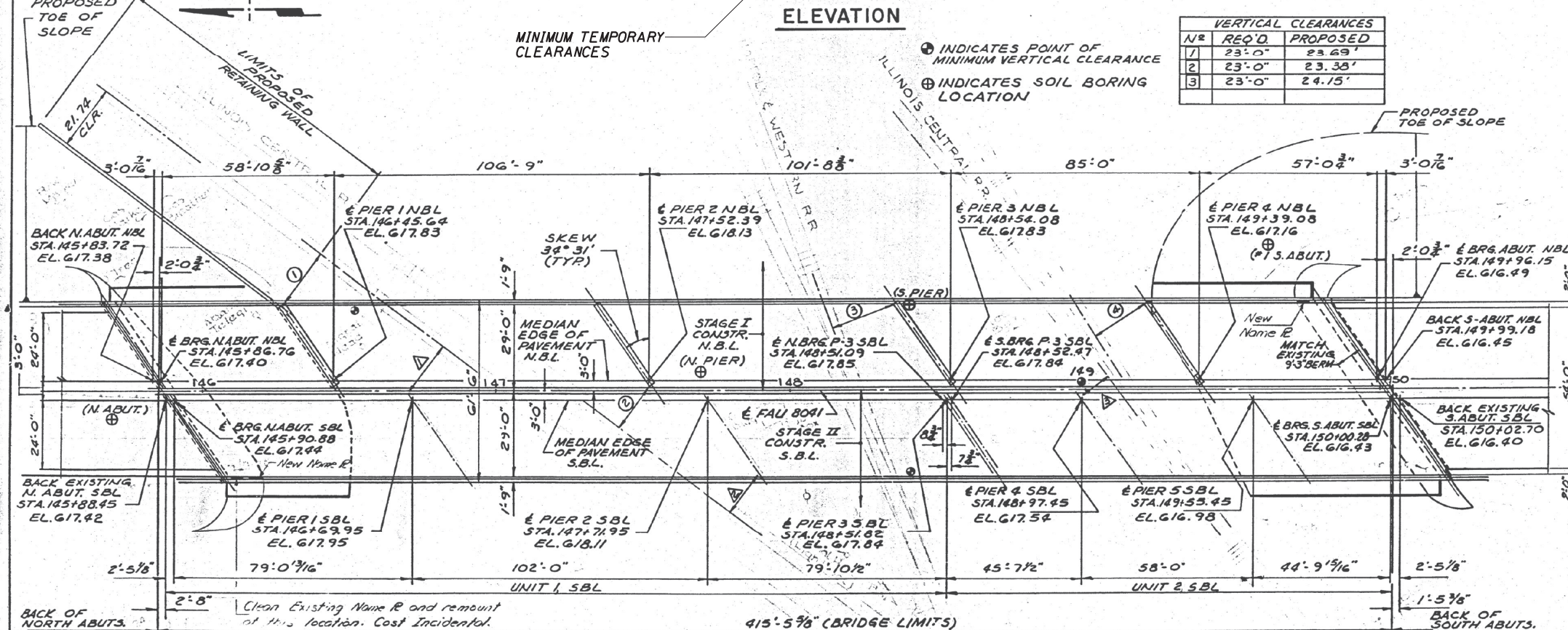

ELEVATION

PLAN

NOTE: ELEVATIONS SHOWN AT MEDIAN EDGE OF PAVEMENT LINES ARE PROFILE GRADE ELEVATIONS ON FAU-8041 FINISHED PAVEMENT ELEVATIONS ARE .047' BELOW PROFILE GRADE ELEVATIONS SHOWN

HORIZONTAL CLEARANCES

NB PIERS			SB PIERS (EXISTING)		
Nº	REQ'D	PROPOSED	Nº	REQ'D	EXISTING
1	18'-0"	20.21	1	18'-0"	19.00'
2	12'-6"	16.18	2	12'-6"	15.45'
3	18'-0"	21.16	3	12'-0"	9.75'
4	12'-0"	22.22			

DESIGNED	RLF
CHECKED	ALH
DRAWN	F.F.
CHECKED	ALH

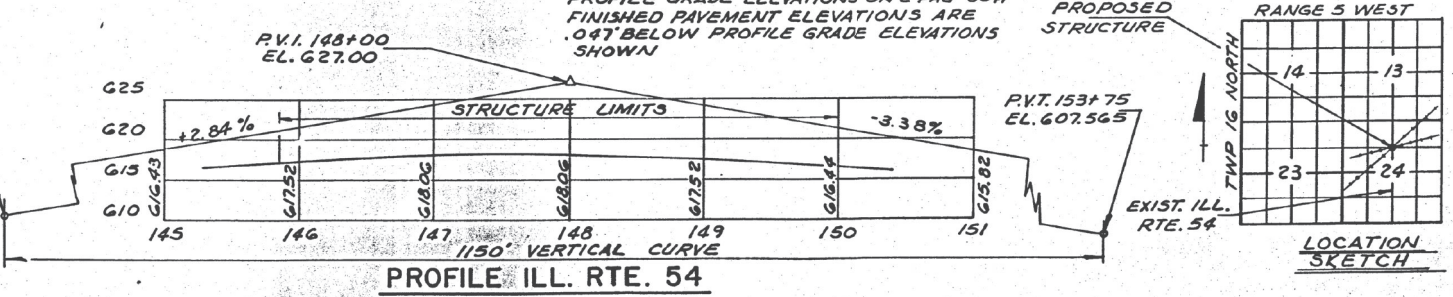

PROFILE ILL. RTE. 54

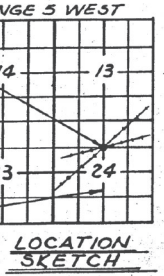

LOCATION SKETCH

Rev. 6-11-82

REVISED SHEET 2-22-2022

MODEL: D:\dtd\... FILE: \dtd\... CAD: 7/2007... 08/00/03 & 01/17/08

USER NAME = dudleybm	DESIGNED -	REVISED -	STATE OF ILLINOIS DEPARTMENT OF TRANSPORTATION		EXISTING BRIDGE PLANS, SN 084-0073 (SB) & 0178 (NB) (FOR INFORMATION ONLY)		F.A.P. RTE. 668	SECTION (28VBR) BP	COUNTY SANGAMON	TOTAL SHEETS 12	SHEET NO. 4
PLOT SCALE = 100,000' / in.	CHECKED -	REVISED -			SCALE:	SHEET OF SHEETS	STA. TO STA.	ILLINOIS FED. AID PROJECT		CONTRACT NO. 72N07	
PLOT DATE = 2/10/2022	DATE	REVISED -									