

SPECIALTY ITEM	CODE NO.	ITEM	UNIT	TOTAL QUANTITY	URBAN	ROADWAY	LAND BRIDGES		TRAFFIC SIGNALS
					URBAN	S.N. 016-D011	S.N. 016-D012	159TH & 104TH	
					0004	0008	0008	0021	
					100% STATE	100% STATE	100% STATE	100% STATE	
	60108204	PIPE UNDERDRAINS, TYPE 2, 4"	FOOT	30	30				
	60500050	REMOVING CATCH BASINS	EACH	3	3				
	60605000	COMBINATION CONCRETE CURB AND GUTTER, TYPE B-6.24	FOOT	30	30				
	61000050	CONCRETE THRUST BLOCKS	EACH	7	7				
*	63301210	REMOVE AND REERECT STEEL PLATE BEAM GUARDRAIL, TYPE A	FOOT	263	263				
*	63302000	REMOVE AND REERECT TRAFFIC BARRIER TERMINALS, TYPE 2	EACH	1	1				
*	66900200	NON-SPECIAL WASTE DISPOSAL	CU YD	208	208				⚠
*	66900530	SOIL DISPOSAL ANALYSIS	EACH	1	1				
*	66901001	REGULATED SUBSTANCES PRE-CONSTRUCTION PLAN	L SUM	1	1				
*	66901003	REGULATED SUBSTANCES FINAL CONSTRUCTION REPORT	L SUM	1	1				
*	66901006	REGULATED SUBSTANCES MONITORING	CAL DA	60	60				
	67100100	MOBILIZATION	L SUM	1	1				
	70300150	SHORT TERM PAVEMENT MARKING REMOVAL	SQ FT	583	583				

\* DENOTES A SPECIALTY ITEM

⚠ REVISED SHEET 2/25/2022

MODEL D:\4\1\1\LOCHNER\PROJECTS\10600510603\_CADD\01\_Sheets\Civil\162868-3-sht-504.dgn

**LOCHNER**  
H. W. LOCHNER, INC.  
225 WEST WASHINGTON STREET  
12 TH FLOOR  
CHICAGO, ILLINOIS 60606

USER NAME = GGIFORD	DESIGNED - GG	REVISED -
PLOT SCALE =	DRAWN - GG	REVISED -
PLOT DATE = 12/27/2021	CHECKED - AM	REVISED -
	DATE - 1/3/2022	REVISED -

**STATE OF ILLINOIS  
DEPARTMENT OF TRANSPORTATION**

**SUMMARY OF QUANTITIES  
159TH STREET**

SCALE: N/A SHEET 5 OF 7 SHEETS STA. N/A TO STA. N/A

F.A.P. RTE.	SECTION	COUNTY	TOTAL SHEETS	SHEET NO.
351	2021-150-BY	COOK	73	7
CONTRACT NO. 62P68			ILLINOIS FED. AID PROJECT	

SPECIALTY ITEM	CODE NO.	ITEM	UNIT	TOTAL QUANTITY	URBAN	ROADWAY	LAND BRIDGES		TRAFFIC SIGNALS
							S.N. 016-D011	S.N. 016-D012	159TH & 104TH
							0008	0008	0021
					100% STATE	100% STATE	100% STATE	100% STATE	
	70307120	TEMPORARY PAVEMENT MARKING - LINE 4" - TYPE IV TAPE	FOOT	10,576	10,576				
*	78009000	MODIFIED URETHANE PAVEMENT MARKING - LETTERS AND SYMBOLS	SQ FT	59	59				
*	78009004	MODIFIED URETHANE PAVEMENT MARKING - LINE 4"	FOOT	1,194	1,194				
*	78003137	PREFORMED PLASTIC PAVEMENT MARKING, TYPE B - LINE 7"	FOOT	1,194	1,194				
*	78011040	GROOVING FOR RECESSED PAVEMENT MARKING 8"	FOOT	1,194	1,194				
*	78009006	MODIFIED URETHANE PAVEMENT MARKING - LINE 6"	FOOT	461	461				
*	78100100	RAISED REFLECTIVE PAVEMENT MARKER	EACH	121	121				
*	78300200	RAISED REFLECTIVE PAVEMENT MARKER REMOVAL	EACH	121	121				
	78300202	PAVEMENT MARKING REMOVAL - WATER BLASTING	SQ FT	687	687				
*	81028390	UNDERGROUND CONDUIT, PVC, 4" DIA.	FOOT	780	780				
*	85000200	MAINTENANCE OF EXISTING TRAFFIC SIGNAL INSTALLATION	EACH	1					1
	X0327036	BIKE PATH REMOVAL	SQ YD	423	423				
	X0322936	REMOVE EXISTING FLARED END SECTION	EACH	3	3				
*	X6330103	REMOVE AND RE-ERECT TRAFFIC BARRIER TERMINAL, TYPE 1 SPECIAL, TANGENT	EACH	1	1				
	X6700407	ENGINEER'S FIELD OFFICE, TYPE A (D1)	CAL MO	5	5				

\* DENOTES A SPECIALTY ITEM

1 REVISED SHEET 2/25/2022

MODEL: Default; FILE NAME: I:\CADD\18\1000005\106\03\_CADD\01\_Sheets\Civil\182868-3-shr-506.dgn

**LOCHNER**  
H. W. LOCHNER, INC.  
225 WEST WASHINGTON STREET  
12 TH FLOOR  
CHICAGO, ILLINOIS 60606

USER NAME = GGIFFORD	DESIGNED - GG	REVISED -
PLOT SCALE =	DRAWN - GG	REVISED -
PLOT DATE = 12/27/2021	CHECKED - AM	REVISED -
	DATE - 1/3/2022	REVISED -

STATE OF ILLINOIS  
DEPARTMENT OF TRANSPORTATION

SUMMARY OF QUANTITIES  
159TH STREET

SCALE: N/A SHEET 6 OF 7 SHEETS STA. N/A TO STA. N/A

F.A.P. RTE.	SECTION	COUNTY	TOTAL SHEETS	SHEET NO.
351	2021-150-BY	COOK	73	8
		CONTRACT NO. 62P68		
(ILLINOIS FED. AID PROJECT)				

EARTHWORK SUMMARY									
LOCATION	EARTH EXCAVATION (20200100)	EXCAVATION USED AS EMBANKMENT, ADJ. FOR SHRINKAGE (15%)	EMBANKMENT	EARTHWORK BALANCE WASTE (+), SHORTAGE (-)	FURNISHED EXCAVATION (20400800)	TOPSOIL STRIPPING	TOPSOIL PLACEMENT	TOPSOIL EXCAVATION AND PLACEMENT (21101505)	NON-SPECIAL WASTE DISPOSAL (66900200)
	CU YD	CU YD	CU YD	CU YD	CU YD	CU YD	CU YD	CU YD	CU YD
382+06.1 TO 387+00.0	34	29	39	-10	* 10	50	50	50	0
393+99.6 TO 394+14.6	18	0	0	0	0	0	0	0	0
394+14.6 TO 394+44.6	23	0	0	0	0	0	0	0	0
394+44.6 TO 398+34.6	624	0	0	0	0	266	266	266	0
398+88.8 TO 400+86.9	0	0	0	0	0	104	104	104	0
<b>TOTAL</b>	699	29	39	-10	10	420	420	420	0

NOTE:  
SEE STRUCTURAL SHEETS FOR STRUCTURE EXCAVATION QUANTITIES.  
\*A QUANTITY OF 10 CU YD OF FURNISHED EXCAVATION IS PROVIDED TO ALLOW FOR THE SIDEWALK RETROFIT AND PARKWAY RESTORATION CONSTRUCTION TO OCCUR PRIOR TO THE LAND BRIDGE EXTENSION.

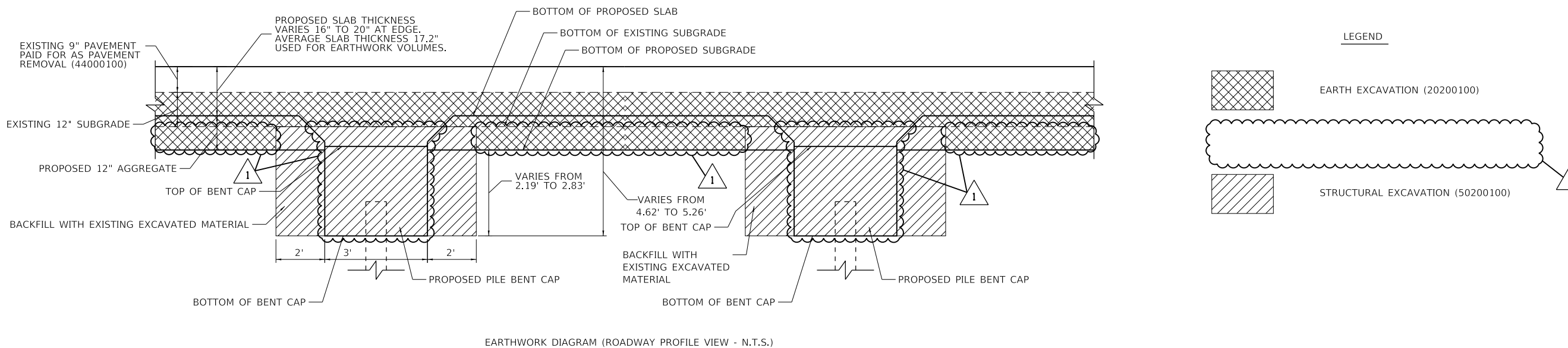

PAVING OPERATIONS SCHEDULE OF QUANTITIES									
STA.	STA.	AGGREGATE SUBGRADE IMPROVEMENT (30300001) (CU YD)	AGGREGATE SUBGRADE IMPROVEMENT 12" (30300112) (SQ YD)	AGGREGATE BASE COURSE, TYPE B 6" (35101800) (SQ YD)	BITUMINOUS MATERIALS (PRIME COAT) (40600275) (POUND)	HOT-MIX ASPHALT BINDER COURSE, IL-19.0, N50 (40603080) (TON)	HOT-MIX ASPHALT SURFACE COURSE, IL-9.5FG, MIX "D", N50 (40604010) (TON)	PAVEMENT CONNECTOR (PCC) FOR BRIDGE APPROACH SLAB (42000080) (SQ YD)	COMBINATION CONCRETE CURB AND GUTTER, TYPE B-6.24 (60605000) (FOOT)
382+58.53	382+68.02			5	10	1			
393+99.60	395+00.00	15	288	91	205	13	8	49	30
395+00.00	398+34.60		910	320	720	45	27		
<b>TOTAL</b>		15	1,198	416	935	59	35	49	30

MODEL: D:\p\h\l\LOCHNER\PROJECTS\1000005106\03\_CADD\01\_Sheets\Civil\162P68-A-21t-struct.dwg

**LOCHNER**  
H. W. LOCHNER, INC.  
225 WEST WASHINGTON STREET  
12 TH FLOOR  
CHICAGO, ILLINOIS 60606

USER NAME = GGIFORD	DESIGNED - GG	REVISED - $\Delta$ 2/24/2022
PLOT SCALE =	DRAWN - GG	REVISED -
PLOT DATE = 2/24/2022	CHECKED - AM	REVISED -
	DATE - 1/3/2022	REVISED -

**STATE OF ILLINOIS  
DEPARTMENT OF TRANSPORTATION**

SCHEDULE OF QUANTITIES 159TH STREET			
SCALE: N/A	SHEET	OF SHEETS	STA. N/A TO STA. N/A

F.A.P. RTE.	SECTION	COUNTY	TOTAL SHEETS	SHEET NO.
351	2021-150-BY	COOK	73	10
CONTRACT NO. 62P68				
ILLINOIS FED. AID PROJECT				

$\Delta$  REVISED SHEET 2/25/2022

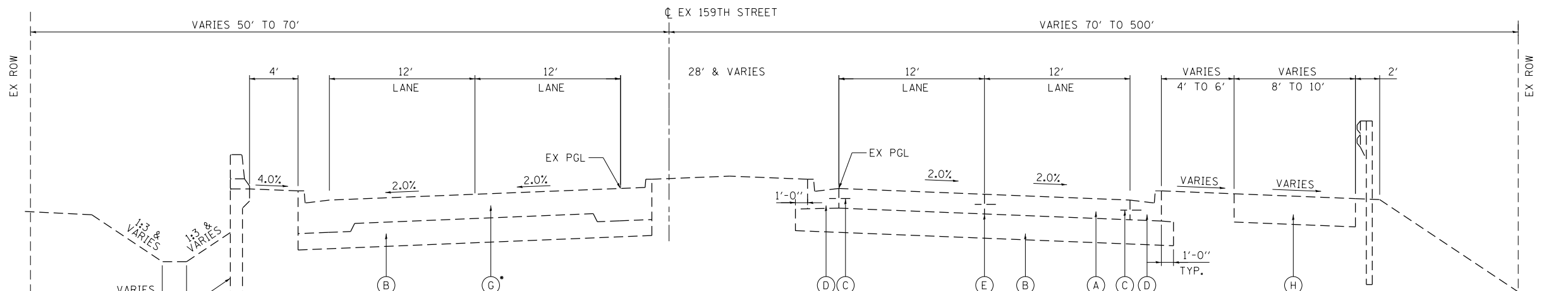

EXISTING RETAINING WALL LIMITS:  
STA. 381+44.29 TO STA. 407+61.18

\* EXISTING PCC PAVEMENT FROM STA. 393+99.60 TO STA. 395+97.60

EXISTING DRY LAND BRIDGE FROM STA. 395+97.60 TO STA. 402+33.60

**EXISTING TYPICAL SECTION**

**159TH STREET**

STA. 393+99.60 TO STA. 398+34.60

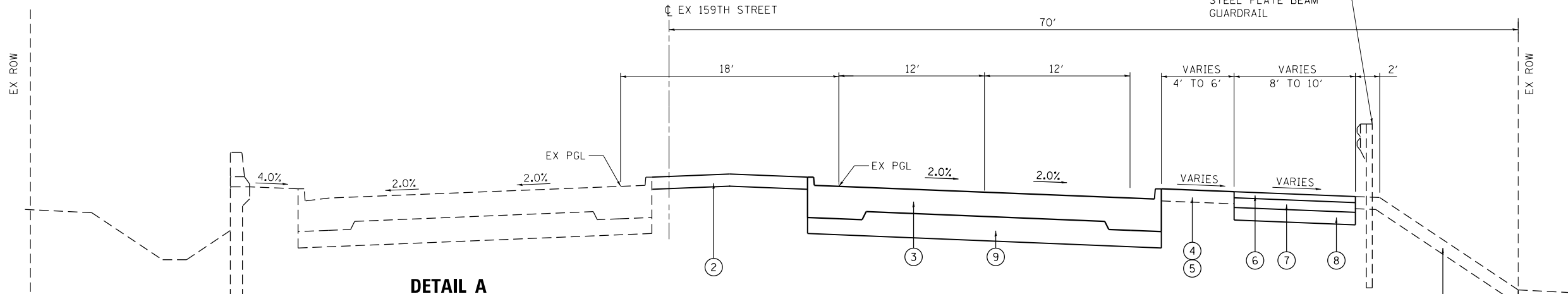

**DETAIL A**

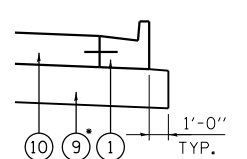

**PROPOSED TYPICAL SECTION**

**159TH STREET**

STA. 394+44.60 TO STA. 398+34.60

PAVEMENT CONNECTOR  
STA. 393+99.60 TO STA. 394+14.60  
SEE DETAIL A

BRIDGE APPROACH PAVEMENT  
STA. 394+14.60 TO STA. 394+44.60

SEE MOT TYPICAL SECTION SHEET 21 FOR MEDIAN RESTORATION WITHIN LIMITS OF TEMPORARY PAVEMENT WITHIN CROSSOVER

REMOVE AND REERECT STEEL PLATE BEAM GUARDRAIL

**NOTES**

1. PROPOSED TOPSOIL, 6" AND PROPOSED TOPSOIL, 24" WILL CONSIST OF EXISTING TOPSOIL AND PAID FOR AS 'TOPSOIL EXCAVATION AND PLACEMENT'.

\*AGGREGATE SUBGRADE IMPROVEMENT 12" EXTENDS 1'-0" BEYOND C&G ON NORTH AND SOUTH SIDE OF PAVEMENT CONNECTOR

**EXISTING LEGEND**

- (A) PORTLAND CEMENT CONCRETE PAVEMENT 9" (JOINTED)
- (B) AGGREGATE SUBGRADE 12"
- (C) NO. 6 EPOXY COATED TIE BARS 24" LONG @ 24" CTS
- (D) COMBINATION CONCRETE CURB AND GUTTER, TYPE B-6.24
- (E) LONGITUDINAL SAWED JOINT WITH NO. 6 EPOXY COATED
- (F) RETAINING WALL (SEE STRUCTURAL DRAWINGS FOR DETAILS)
- (G) EXISTING DRY LAND BRIDGE
- (H) MULTI-USE PATH

**PROPOSED LEGEND**

- (1) COMBINATION CONCRETE CURB AND GUTTER, TYPE B-6.24
- (2) PROPOSED TOPSOIL, 24" - SEE NOTE 1
- (3) DRY LAND BRIDGE (SEE STRUCTURAL DRAWINGS FOR DETAILS)
- (4) PROPOSED TOPSOIL, 6" - SEE NOTE 1
- (5) SEE LANDSCAPE PLANS FOR PERMANENT GROUND COVER INFO
- (6) HOT-MIX ASPHALT SURFACE COURSE, MIX "D", N50 (IL-9.5FG), 1 1/2"
- (7) HOT-MIX ASPHALT BINDER COURSE, N50 (IL-19.0), 2 1/2"
- (8) AGGREGATE BASE COURSE, TYPE B, 6"
- (9) AGGREGATE SUBGRADE IMPROVEMENT 12"
- (10) PAVEMENT CONNECTOR (PCC) FOR BRIDGE APPROACH SLAB (VARIES FROM 9" TO 15")

**HOT-MIX ASPHALT MIXTURE REQUIREMENTS**

MIXTURE TYPE	AIR VOIDS Ndes	QUALITY MANAGEMENT PROGRAM (QMP)
<b>TEMPORARY PAVEMENT</b>		
HOT-MIX ASPHALT SURFACE COURSE, MIX "D", N70 (IL-9.5), 2"	4% @ 70 Gyr.	QC/OA
HOT-MIX ASPHALT BINDER COURSE, N70 (IL-19.0), 8"	4% @ 70 Gyr.	QC/OA
<b>MULTI-USE PATH</b>		
HOT-MIX ASPHALT SURFACE COURSE, MIX "D", N50 (IL-9.5FG), 1 1/2"	4% @ 50 Gyr.	QC/OA
HOT-MIX ASPHALT BINDER COURSE, N50 (IL-19.0), 2 1/2"	4% @ 50 Gyr.	QC/OA

QMP DESIGNATION: QUALITY CONTROL/QUALITY ASSURANCE (QC/OA); QUALITY CONTROL FOR PERFORMANCE (QCP)

THE UNIT WEIGHT USED TO CALCULATE ALL HOT-MIX ASPHALT SURFACE MIXTURE QUANTITIES IS 112 LBS/SQ YD./IN.

THE AC TYPE FOR POLYMERIZED HMA MIXTURES SHALL BE "SBS/SBR PG 76-22" AND FOR NON-POLYMERIZED HMA THE "AC" TYPE" SHALL BE "PG 64-22" UNLESS MODIFIED BY RECLAIMED MATERIALS SPECIFICATIONS.

1 REVISION SHEET 2/25/2022

**LOCHNER**  
H.W. LOCHNER, INC.  
225 WEST WASHINGTON STREET  
12 TH FLOOR  
CHICAGO, ILLINOIS 60606

USER NAME = GGIFFORD	DESIGNED - GG	REVISED - 2/24/2022
PLOT SCALE =	DRAWN - GG	REVISED -
PLOT DATE = 2/25/2022	CHECKED - AM	REVISED -
	DATE - 1/3/2022	REVISED -

**STATE OF ILLINOIS  
DEPARTMENT OF TRANSPORTATION**

**TYPICAL SECTIONS  
159TH STREET**

SCALE: N/A SHEET 1 OF 1 SHEETS STA. N/A TO STA. N/A

F.A.P RTE.	SECTION	COUNTY	TOTAL SHEETS	SHEET NO.
351	2021-150-BY	COOK	73	11
CONTRACT NO. 62P68				
ILLINOIS FED. AID PROJECT				

MODEL: D:\cfs\h...  
FILE NAME: LOCHNER\PROJECTS\2021-150-BY\159TH ST\SS159TYPICAL.dgn

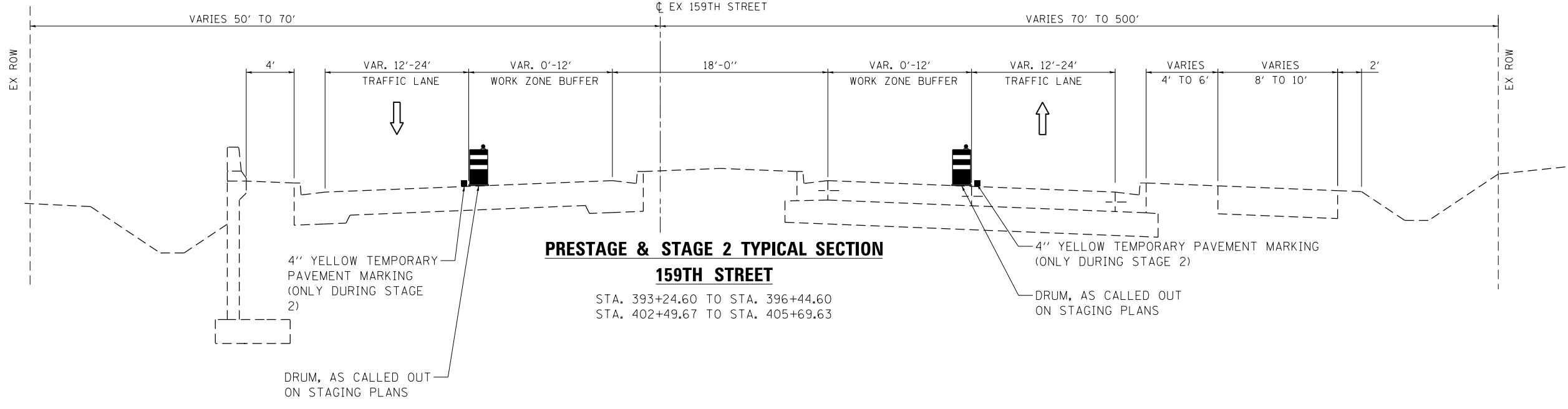
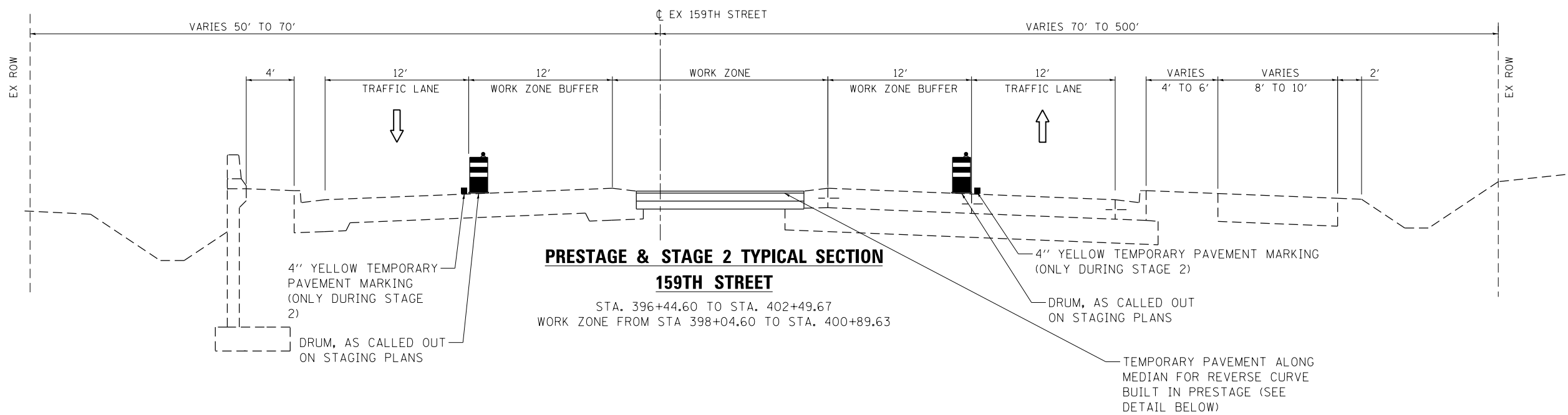

**TEMPORARY PAVEMENT DETAIL**

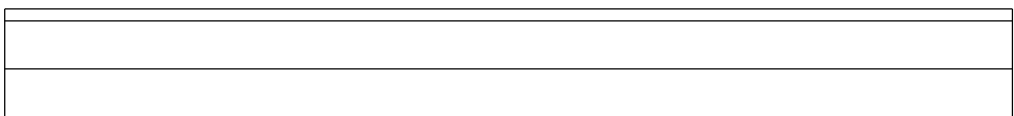

HOT-MIX ASPHALT SURFACE COURSE, MIX "D", N70 (IL-9.5), 2"  
HOT-MIX ASPHALT BINDER COURSE, N70 (IL-19.0), 8"  
SUBBASE GRANULAR MATERIAL, TYPE B, 8"

PRESTAGE: CONTRACTOR TO EXCAVATE 24" OF TOPSOIL, AND BUILD 18" OF TEMPORARY PAVEMENT PER ABOVE DETAIL.

STAGE 2: CONTRACTOR TO REMOVE 18" OF TEMPORARY PAVEMENT AND PLACE 24" OF TOPSOIL TO MATCH EXISTING CONDITION.



MODEL: D:\p\h\h\LOCHNER\PROJECTS\10603\_CADD\01\_Sheets\Civil\159TH-MOT\_Typical.dgn

**LOCHNER**  
H. W. LOCHNER, INC.  
225 WEST WASHINGTON STREET  
12 TH FLOOR  
CHICAGO, ILLINOIS 60606

USER NAME = GGIFORD	DESIGNED - JS	REVISED -  2/24/2022
	DRAWN - JS	REVISED -
PLOT SCALE =	CHECKED - AM	REVISED -
PLOT DATE = 2/25/2022	DATE - 1/3/2022	REVISED -

**STATE OF ILLINOIS  
DEPARTMENT OF TRANSPORTATION**

**MOT TYPICAL SECTIONS - PRESTAGE & STAGE 2  
159TH STREET**

SCALE: N/A SHEET 3 OF 3 SHEETS STA. N/A TO STA. N/A

F.A.P. RTE.	SECTION	COUNTY	TOTAL SHEETS	SHEET NO.
351	2021-150-BY	COOK	73	21
CONTRACT NO. 62P68				
ILLINOIS FED. AID PROJECT				

REVISED SHEET 2/25/2022

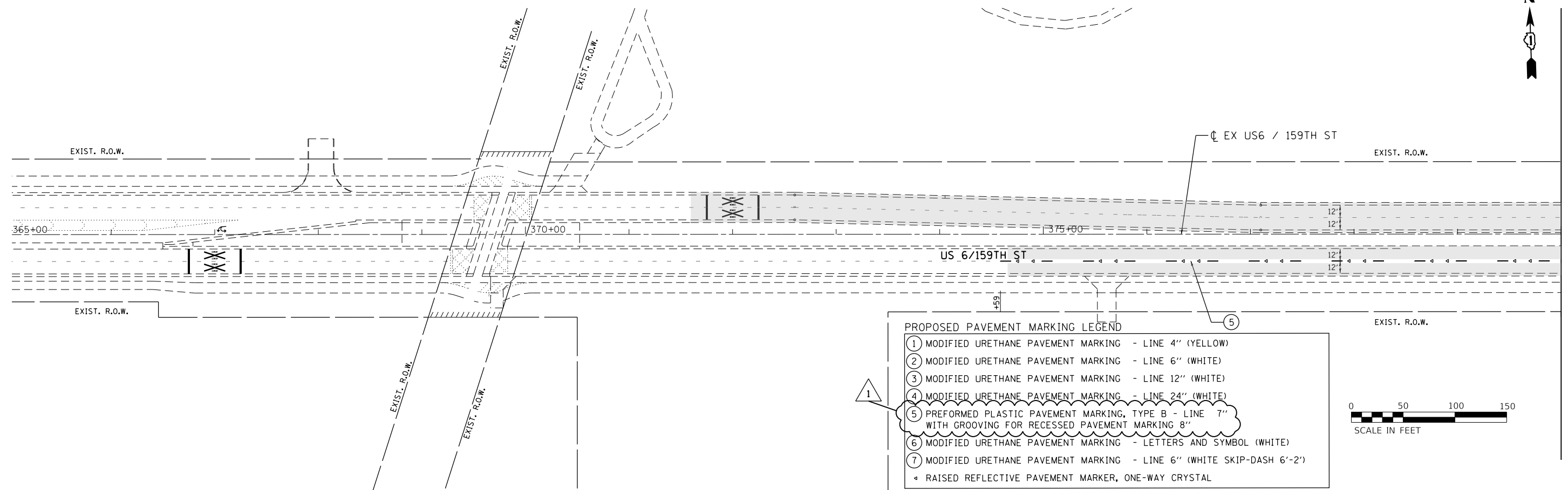

PROPOSED PAVEMENT MARKING LEGEND

- ① MODIFIED URETHANE PAVEMENT MARKING - LINE 4" (YELLOW)
- ② MODIFIED URETHANE PAVEMENT MARKING - LINE 6" (WHITE)
- ③ MODIFIED URETHANE PAVEMENT MARKING - LINE 12" (WHITE)
- ④ MODIFIED URETHANE PAVEMENT MARKING - LINE 24" (WHITE)
- ⑤ PREFORMED PLASTIC PAVEMENT MARKING, TYPE B - LINE 7" WITH GROOVING FOR RECESSED PAVEMENT MARKING 8"
- ⑥ MODIFIED URETHANE PAVEMENT MARKING - LETTERS AND SYMBOL (WHITE)
- ⑦ MODIFIED URETHANE PAVEMENT MARKING - LINE 6" (WHITE SKIP-DASH 6'-2')
- ◄ RAISED REFLECTIVE PAVEMENT MARKER, ONE-WAY CRYSTAL

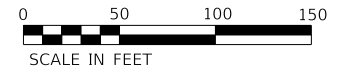

MODEL: D:\p\h\l  
 FILE NAME: I:\C\UPR\1000005\06\03\_CADD\01\_Sheets\Civil\162P68-17-rt-epmk.dgn

**LOCHNER**  
 H. W. LOCHNER, INC.  
 225 WEST WASHINGTON STREET  
 12 TH FLOOR  
 CHICAGO, ILLINOIS 60606

USER NAME = GGIFORD	DESIGNED - JS	REVISED -  2/24/2022
	DRAWN - JS	REVISED -
PLOT SCALE =	CHECKED - AM	REVISED -
PLOT DATE = 2/24/2022	DATE - 1/3/2022	REVISED -

STATE OF ILLINOIS  
 DEPARTMENT OF TRANSPORTATION

PAVEMENT MARKING PLAN  
 159TH STREET

SCALE: 1"=50' SHEET 1 OF 2 SHEETS STA. 365+00 TO STA. 380+00

REVISED SHEET 2/25/2022

F.A.P. RTE.	SECTION	COUNTY	TOTAL SHEETS	SHEET NO.
351	2021-150-BY	COOK	73	29
CONTRACT NO. 62P68				
ILLINOIS FED. AID PROJECT				

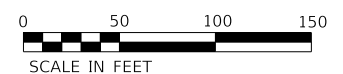
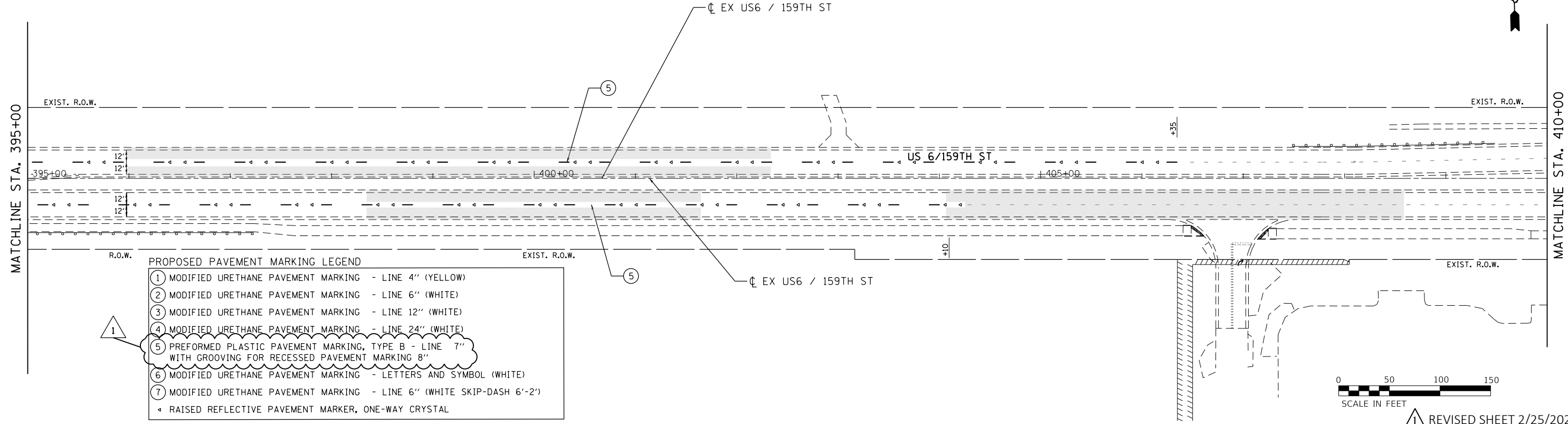
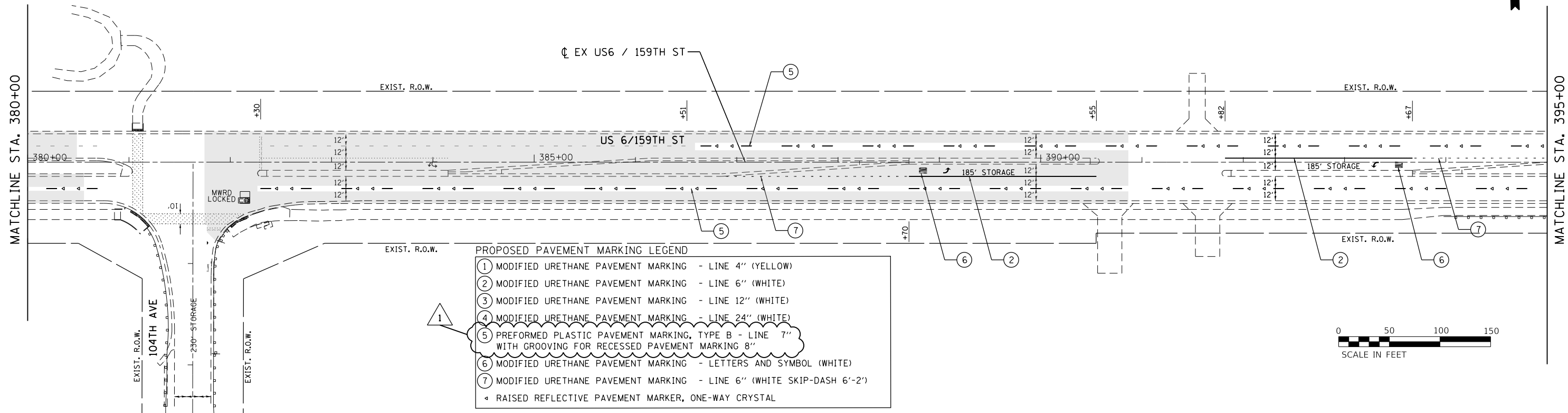

① REVISED SHEET 2/25/2022

MODEL: D:\p\h\l\LOCHNER\PROJECTS\2022\2022-150-BY\Drawings\17-24-2022.dgn  
 FILE NAME: L:\CHUPR\1000005\10603\_CADD\01\_Sheets\Civil\162P68-17-24-2022.dgn

**LOCHNER**  
 H. W. LOCHNER, INC.  
 225 WEST WASHINGTON STREET  
 12 TH FLOOR  
 CHICAGO, ILLINOIS 60606

USER NAME = GGIFORD	DESIGNED - JS	REVISED - ① 2/24/2022
PLOT SCALE =	DRAWN - JS	REVISED -
PLOT DATE = 2/24/2022	CHECKED - AM	REVISED -
	DATE - 1/3/2022	REVISED -

**STATE OF ILLINOIS  
 DEPARTMENT OF TRANSPORTATION**

**PAVEMENT MARKING PLAN  
 159TH STREET**

SCALE: 1"=50' SHEET 2 OF 2 SHEETS STA. 380+00 TO STA. 410+00

F.A.P. RTE.	SECTION	COUNTY	TOTAL SHEETS	SHEET NO.
351	2021-150-BY	COOK	73	30
CONTRACT NO. 62P68				
ILLINOIS FED. AID PROJECT				