

SI	SP	CODE NO.	ITEM	UNIT	TOTAL QUANTITY
		50300225	CONCRETE STRUCTURES	CU YD	83
		50300255	CONCRETE SUPERSTRUCTURE	CU YD	274.2
		50300260	BRIDGE DECK GROOVING	SQ YD	1,063
		50300300	PROTECTIVE COAT	SQ YD	1,395
		50301350	CONCRETE SUPERSTRUCTURE (APPROACH SLAB)	CU YD	203
		50500105	FURNISHING AND ERECTING STRUCTURAL STEEL	L SUM	1
		50500505	STUD SHEAR CONNECTORS	EACH	948
		50800205	REINFORCEMENT BARS, EPOXY COATED	POUND	146,670
		50800515	BAR SPLICERS	EACH	578
		50800530	MECHANICAL SPLICERS	EACH	26
Δ		50901720	BICYCLE RAILING	FOOT	151
Δ		50901750	PARAPET RAILING	FOOT	147
Δ		50901760	PIPE HANDRAIL	FOOT	20
		51201400	FURNISHING STEEL PILES HP10X42	FOOT	480

SI	SP	CODE NO.	ITEM	UNIT	TOTAL QUANTITY
		51202305	DRIVING PILES	FOOT	480
		51203400	TEST PILE STEEL HP10X42	EACH	2
		51204650	PILE SHOES	EACH	10
		51500100	NAME PLATES	EACH	1
		52100010	ELASTOMERIC BEARING ASSEMBLY, TYPE I	EACH	10
		52100520	ANCHOR BOLTS, 1"	EACH	12
		52200010	TEMPORARY SHEET PILING	SQ FT	433
		52200700	PRECAST MODULAR RETAINING WALL	SQ FT	700
		54001001	BOX CULVERT END SECTIONS, CULVERT NO. 1	EACH	6
		54010502	PRECAST CONCRETE BOX CULVERTS 5' X 2'	FOOT	249
		54213657	PRECAST REINFORCED CONCRETE FLARED END SECTIONS 12"	EACH	11
		54213660	PRECAST REINFORCED CONCRETE FLARED END SECTIONS 15"	EACH	4
		54213663	PRECAST REINFORCED CONCRETE FLARED END SECTIONS 18"	EACH	6
		54213669	PRECAST REINFORCED CONCRETE FLARED END SECTIONS 24"	EACH	4

Δ SPECIALTY ITEMS

MODEL: D:\proj\13-00301-15-PW\13-00301-15-PW-001.dwg
 FILE NAME: H:\P17032 - ESPE WIDENING PHASE 2\CADD\MicroStation\CADD Drawings\13-00301-15-PW-001.dwg
 ILLINOIS DESIGN FIRM LICENSE NO.: 184.001115



USER NAME = scott.feldt	DESIGNED -	REVISED - A 3/1/2022
PLOT SCALE = 100.0000' / in.	DRAWN -	REVISED -
PLOT DATE = 11/12/2021	CHECKED -	REVISED -
	DATE -	REVISED -

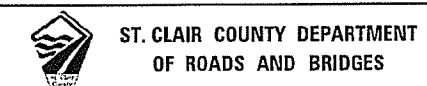

SUMMARY OF QUANTITIES			
SCALE:	SHEET 3 OF 7 SHEETS	STA.	TO STA.

F.A.U. RTE.	SECTION	COUNTY	TOTAL SHEETS	SHEET NO.
9330	13-00301-15-PW	ST. CLAIR	251	5
ILLINOIS FED. AID PROJECT			CONTRACT NO. 97752	

SI	SP	CODE NO.	ITEM	UNIT	TOTAL QUANTITY
		60240395	INLETS, TYPE B	EACH	11
		60500060	REMOVING INLETS	EACH	18
		60600605	CONCRETE CURB, TYPE B	FOOT	22
		60605000	COMBINATION CONCRETE CURB AND GUTTER, TYPE B-6.24	FOOT	15,330
		61100500	EXPLORATION TRENCH 52" DEPTH	FOOT	60
		61100605	MISCELLANEOUS CONCRETE	CU YD	1
Δ		63000001	STEEL PLATE BEAM GUARDRAIL, TYPE A, 6 FOOT POSTS	FOOT	850.0
Δ		63100070	TRAFFIC BARRIER TERMINAL, TYPE 5	EACH	2
Δ		63100085	TRAFFIC BARRIER TERMINAL, TYPE 6	EACH	2
Δ		63100167	TRAFFIC BARRIER TERMINAL, TYPE 1 (SPECIAL) TANGENT	EACH	4
		63200310	GUARDRAIL REMOVAL	FOOT	899
		67000400	ENGINEER'S FIELD OFFICE, TYPE A	CAL MO	24
		67100100	MOBILIZATION	LSUM	1
		70300100	SHORT TERM PAVEMENT MARKING	FOOT	5,116

SI	SP	CODE NO.	ITEM	UNIT	TOTAL QUANTITY
		70300150	SHORT TERM PAVEMENT MARKING REMOVAL	SO FT	1,725
		70300211	TEMPORARY PAVEMENT MARKING LETTERS AND SYMBOLS - PAINT	SO FT	48
		70300221	TEMPORARY PAVEMENT MARKING - LINE 4"- PAINT	FOOT	76,471
		70300281	TEMPORARY PAVEMENT MARKING - LINE 24"- PAINT	FOOT	34
		70400100	TEMPORARY CONCRETE BARRIER	FOOT	203
		70400200	RELOCATE TEMPORARY CONCRETE BARRIER	FOOT	203
		70600251	IMPACT ATTENUATORS, TEMPORARY (NON- REDIRECTIVE, NARROW), TEST LEVEL 3	EACH	2
		70600350	IMPACT ATTENUATORS, RELOCATE (NON- REDIRECTIVE), TEST LEVEL 3	EACH	2
Δ		72000100	SIGN PANEL - TYPE 1	SO FT	124.0
Δ		72400100	REMOVE SIGN PANEL ASSEMBLY - TYPE A	EACH	7
Δ		72400500	RELOCATE SIGN PANEL ASSEMBLY - TYPE A	EACH	11
Δ		72400710	RELOCATE SIGN PANEL - TYPE 1	SO FT	46.2
Δ		72501000	TERMINAL MARKER - DIRECT APPLIED	EACH	4
Δ		72900200	METAL POST - TYPE B	FOOT	387.5
Δ		78008200	POLYUREA PAVEMENT MARKING TYPE I - LETTERS AND SYMBOLS	SO FT	967.2

Δ SPECIALTY ITEMS

MODEL: 141117032 - ESPE WIDENING PHASE 2\CADD\Information\CADD Drawings\17032-sh-500.dgn
FILE NAME: 141117032 - ESPE WIDENING PHASE 2\CADD\Information\CADD Drawings\17032-sh-500.dgn



USER NAME = scott.feldt	DESIGNED -	REVISED - Δ 2/1/2022
PLOT SCALE = 100.0000 ' / in.	DRAWN -	REVISED -
PLOT DATE = 11/12/2021	CHECKED -	REVISED -
	DATE -	REVISED -



ST. CLAIR COUNTY DEPARTMENT OF ROADS AND BRIDGES

SUMMARY OF QUANTITIES

SCALE: SHEET 5 OF 7 SHEETS STA. TO STA.

F.A.U. RTE.	SECTION	COUNTY	TOTAL SHEETS	SHEET NO.
9330	13-00301-15-PW	ST. CLAIR	251	7
CONTRACT NO. 97752				
ILLINOIS FED. AID PROJECT				

TYPICAL SECTION LEGEND

- ① PROPOSED PROCESSING MODIFIED SOIL, 12"
- ② PROPOSED SUBBASE GRANULAR MATERIAL, TYPE A, 4"
- ③ PROPOSED PORTLAND CEMENT CONCRETE PAVEMENT, 9"
- ④ PROPOSED WELDED WIRE REINFORCEMENT
- ⑤ PROPOSED COMBINATION CONCRETE CURB & GUTTER, TYPE B-6.24
- ⑥ PROPOSED DRILL AND GROUT TIE BARS
- ⑦ PROPOSED SAWED LONGITUDINAL JOINT OR LONGITUDINAL CONSTRUCTION JOINT. SEE HIGHWAY STANDARD 420001.

NOTES: AGGREGATE BASE COURSE TYPE A 12" TO BE USED IN LIEU OF PROCESSING MODIFIED SOIL 12" WHERE PROPOSED PAVEMENT CC&G WIDTH IS LESS THAN 12".

- ① STA 58+85.96 TO STA 59+02.81 - 0'
STA 59+02.81 TO STA 61+59.56 - VARIES 1'-12"
STA 61+59.56 TO STA 66+61.93 - 18'
STA 66+61.93 TO STA 77+00.00 - 12'
- ② STA 57+40.00 TO STA 57+90.71 - 0'
STA 57+90.71 TO STA 61+44.46 - VARIES 1'-12"
STA 61+44.46 TO STA 62+87.85 - 12'
STA 62+87.85 TO STA 66+61.50 - 18'
STA 66+61.50 TO STA 77+00.00 - 12'
- ③ STA 59+95.25 TO STA 63+55.00 - 5'
STA 63+55.00 TO STA 63+88.72 - 10'
- ④ STA 59+76.84 TO STA 60+50.00 - 10'
STA 69+70.00 TO STA 70+06.42 - 15'
- ⑤ PROFILE GRADE LINE SHIFTS SOUTH FROM STA 77+00.00 TO 82+46.74 TO AN OFFSET OF 18' AND SHIFTS NORTH FROM STA 101+08.37 TO STA 106+51.79 FROM AN OFFSET OF 18'
- ⑥ STA 78+00.00 TO STA 81+00.00 - VARIES 0'-25.3'
STA 81+00.00 TO STA 82+46.74 - VARIES 25.3'-27.9'
STA 101+08.37 TO STA 106+00.00 - VARIES 20.3'-0'
- ⑦ STA 77+00.00 TO STA 77+50.00 - VARIES 0'-30'

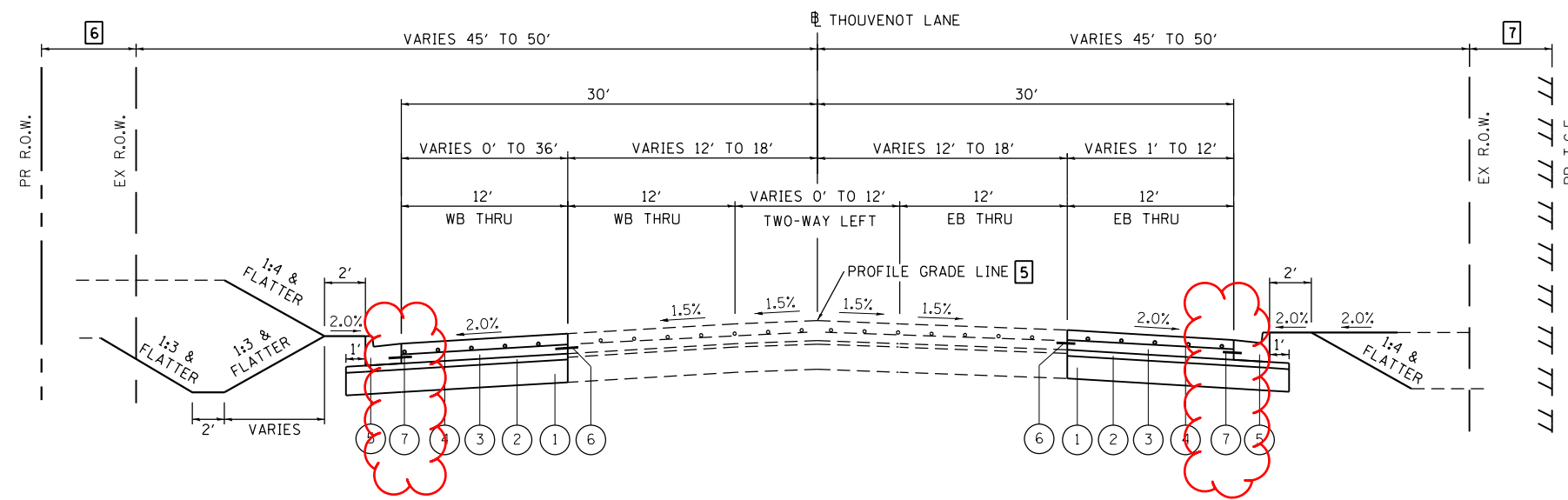

PROPOSED TYPICAL SECTION

STA 77+00.00 TO STA 82+46.74 LT/RT
STA 101+08.37 TO STA 104+01.57 RT
STA 101+08.37 TO STA 107+00.82 LT

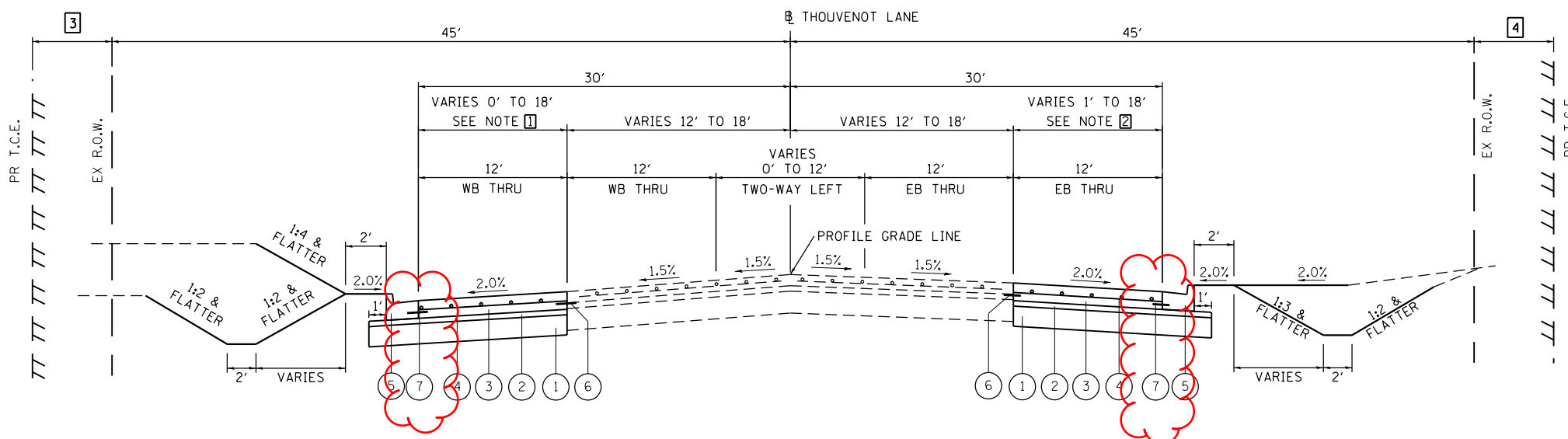

PROPOSED TYPICAL SECTION

STA 58+85.96 TO ST 77+00.00 LT
STA 57+40.00 TO STA 77+00.00 RT
STATION EQUATION: STA 74+20.17 AH = STA 70+80.10 BK

STRUCTURAL DESIGN TRAFFIC:	YEAR: 2041	
PV = 25,508	SU = 805	MU = 537
ROAD/STREET CLASSIFICATION:	CLASS: I	
PERCENT OF STRUCTURAL DESIGN TRAFFIC IN DESIGN LANE:		
P = 32%	S = 45%	M = 45%
TRAFFIC FACTOR:	ACTUAL = 3.79	
	MIN = NO MIN	
STRUCTURAL SUPPORT RATING:		
SSR = POOR		
USE:	9" PCC PAVEMENT WITH WELDED WIRE REINFORCEMENT 4" SUBBASE GRANULAR MATERIAL, TYPE A 12" PROCESSING MODIFIED SOIL	
CONSTRUCT TRANSVERSE JOINTS IN PAVEMENT AND IN CURB AND GUTTER IN PROLONGATION WITH EXISTING TRANSVERSE JOINTS AND AT MID-PANEL OR IN PROLONGATION WITH THE EXISTING MID-PANEL CRACK, AS DIRECTED BY THE ENGINEER.		

MODEL: PR Typicals 01
FILE NAME: 11/17/22 - ESSE WIDENING PHASE 2\CADD\Microstation\CADD Drawings\17032-shctypicals.dgn



USER NAME = scott.felot	DESIGNED -	REVISED -
PLOT SCALE = 2.0000' / in.	DRAWN -	REVISED -
PLOT DATE = 2/28/2022	CHECKED -	REVISED -
	DATE -	REVISED -

DESIGNED -	REVISED -
DRAWN -	REVISED -
CHECKED -	REVISED -
DATE -	REVISED -



ST. CLAIR COUNTY DEPARTMENT OF ROADS AND BRIDGES

PROPOSED TYPICAL SECTIONS

SCALE: SHEET NO. 1 OF 3 SHEETS STA. 57+50.00 TO STA. 107+00.52

F.A.U. RTE.	SECTION	COUNTY	TOTAL SHEETS	SHEET NO.
9330	13-00301-15-PW	ST. CLAIR	251	14
CONTRACT NO. 97752				
ILLINOIS FED. AID PROJECT				

TYPICAL SECTION LEGEND

- ① PROPOSED PROCESSING MODIFIED SOIL, 12"
- ② PROPOSED SUBBASE GRANULAR MATERIAL, TYPE A, 4"
- ③ PROPOSED PORTLAND CEMENT CONCRETE PAVEMENT, 9"
- ④ PROPOSED WELDED WIRE REINFORCEMENT
- ⑤ PROPOSED COMBINATION CONCRETE CURB & GUTTER, TYPE B-6.24
- ⑥ PROPOSED DRILL AND GROUT #6 TIE BARS
- ⑦ PROPOSED SAWED LONGITUDINAL JOINT OR LONGITUDINAL CONSTRUCTION JOINT. SEE HIGHWAY STANDARD 420001.

NOTES: AGGREGATE BASE COURSE TYPE A 12" TO BE USED IN LIEU OF PROCESSING MODIFIED SOIL 12" WHERE PROPOSED PAVEMENT CC&G WIDTH IS LESS THAN 12".

- ① STA 82+46.74 TO STA 82+50.00 - VARIES 27.9'-28'
 STA 82+50.00 TO STA 83+70.00 - VARIES 28'-38'
 STA 83+70.00 TO STA 85+00.00 - 38'
 STA 85+00.00 TO STA 85+50.00 - VARIES 38'-13'
 STA 85+50.00 TO STA 88+57.75 - 13'
 STA 88+57.75 TO STA 91+50.00 - VARIES 18'-23'
 STA 91+50.00 TO STA 94+00.00 - 23'
 STA 94+00.00 TO STA 96+00.00 - VARIES 23'-33'
 STA 96+00.00 TO STA 101+08.37 - VARIES 33'-20.3'
- ② STA 86+30.00 TO STA 88+57.75 - VARIES 0'-35'
 STA 91+90.00 TO STA 92+30.00 - VARIES 0'-15'
- ③ STA 114+50.00 TO STA 115+36.27 - 0'
 STA 115+36.27 TO STA 118+65.62 - VARIES 1'-18'
 STA 118+65.62 TO STA 120+05.10 - 18'
- ④ STA 115+18.55 TO STA 118+98.39 - VARIES 1'-12'
 STA 118+98.39 TO STA 120+05.10 - 12'
- ⑤ STA 118+96.24 TO STA 120+00.00 - VARIES 10'-0'
- ⑥ STA 116+85.00 TO STA 117+50.00 - VARIES 0'-12.8'
- ⑦ STA 83+68.4 TO STA 84+08.4 - COMPLETE PAVEMENT REPLACEMENT. SEE STAGING PLANS FOR DETAILS

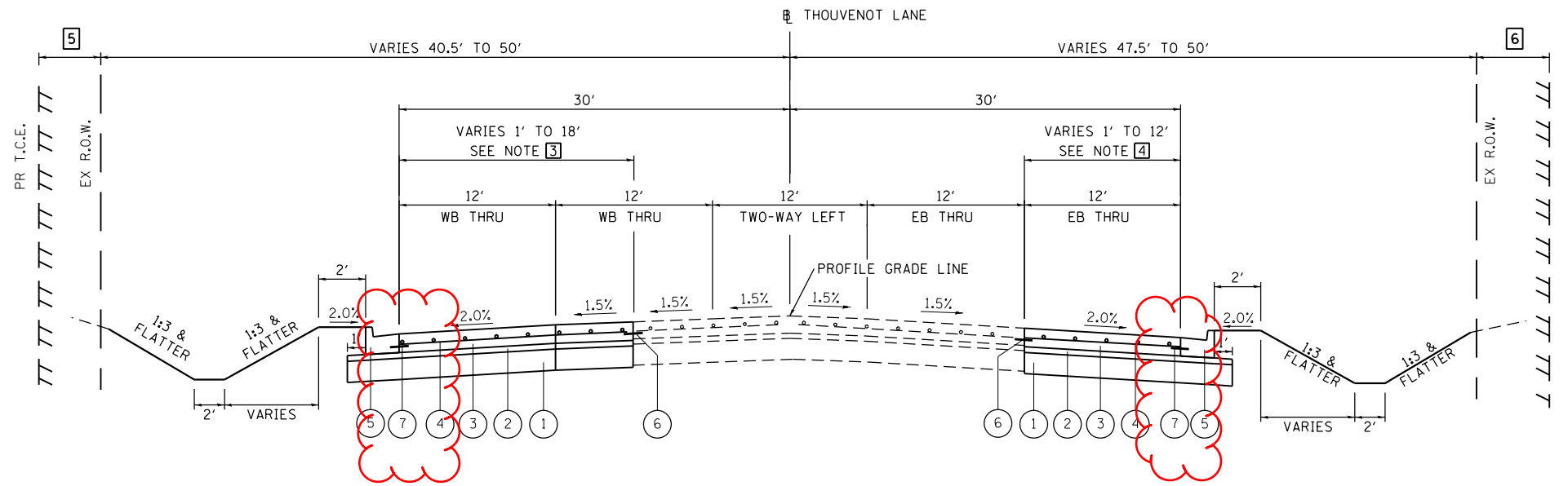

PROPOSED TYPICAL SECTION
 STA 114+50.20 TO STA 120+05.10 LT/RT

INTERSECTION OMISSION
 STA 107+00.82 TO STA 114+50.20 LT/RT

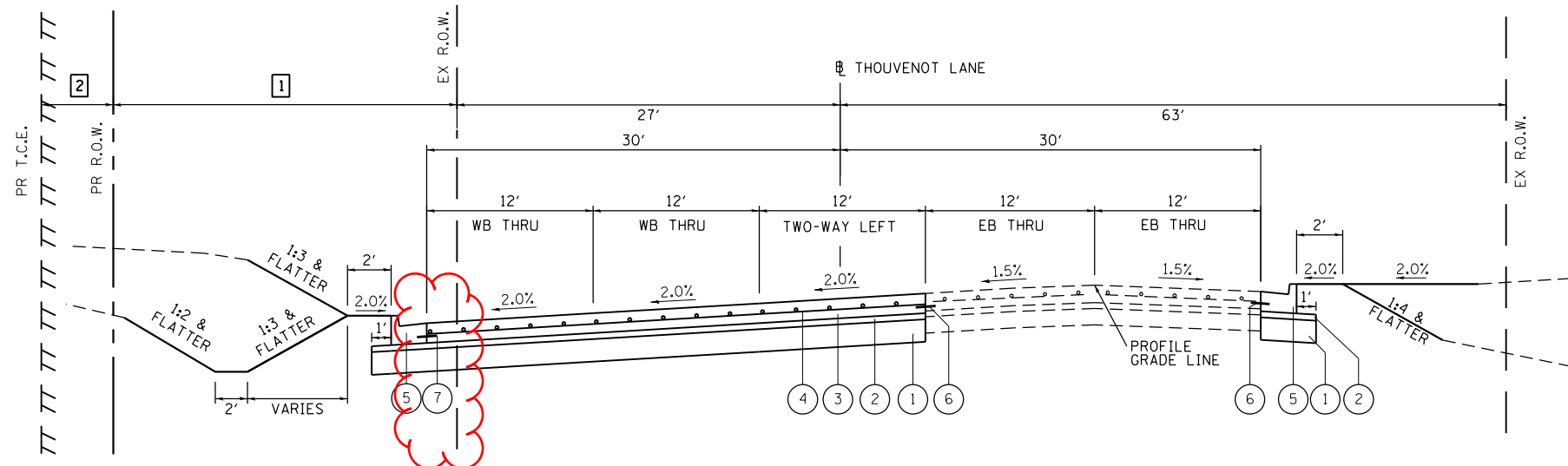

PROPOSED TYPICAL SECTION
 STA 82+46.74 TO STA 101+08.37 LT/RT ⑦

MODEL: PR Typicals 02
 FILE NAME: 11/17/2022 - ESPE WIDENING PHASE 2\CADD\Microstation\CADD Drawings\17032-shct-typical.dgn
 ILLINOIS DESIGN FIRM LICENSE NO.: 184.001115



USER NAME = scott.felot	DESIGNED -	REVISED -
PLOT SCALE = 2.0000' / in.	DRAWN -	REVISED -
PLOT DATE = 2/28/2022	CHECKED -	REVISED -
	DATE -	REVISED -



PROPOSED TYPICAL SECTIONS	
SCALE:	SHEET NO. 2 OF 3 SHEETS STA. 82+46.74 TO STA. 120+05.10

F.A.U. RTE.	SECTION	COUNTY	TOTAL SHEETS	SHEET NO.
9330	13-00301-15-PW	ST. CLAIR	251	15
CONTRACT NO. 97752				
ILLINOIS FED. AID PROJECT				

TYPICAL SECTION LEGEND

- ① PROPOSED PROCESSING MODIFIED SOIL, 12"
- ② PROPOSED SUBBASE GRANULAR MATERIAL, TYPE A, 4"
- ③ PROPOSED PORTLAND CEMENT CONCRETE PAVEMENT, 9"
- ④ PROPOSED WELDED WIRE REINFORCEMENT
- ⑤ PROPOSED COMBINATION CONCRETE CURB & GUTTER, TYPE B-6.24
- ⑥ PROPOSED DRILL AND GROUT #6 TIL BARS
- ⑦ PROPOSED SAWED LONGITUDINAL JOINT OR LONGITUDINAL CONSTRUCTION JOINT. SEE HIGHWAY STANDARD 420001.

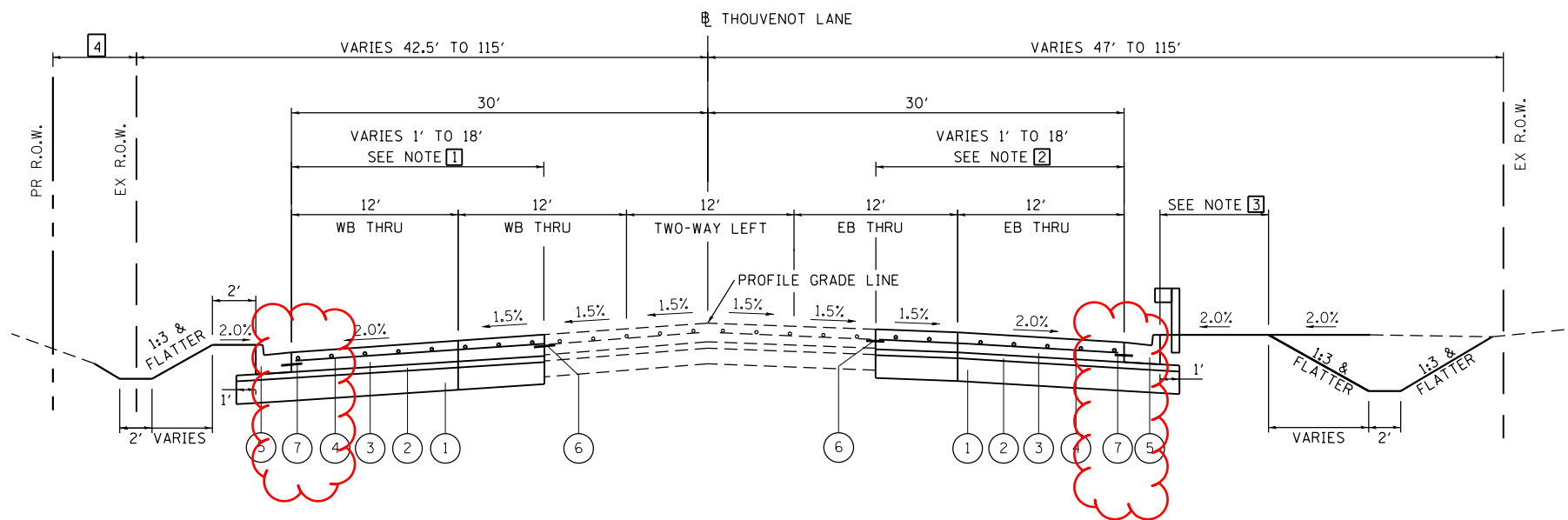

PROPOSED TYPICAL SECTION

STA 120+05.10 TO STA 142+62.25 LT
 STA 120+05.10 TO STA 142+62.25 RT
 REFER TO BRIDGE PLANS - STA 134+84.68 TO STA 136+38.93 LT & RT

NOTES: AGGREGATE BASE COURSE TYPE A 12" TO BE USED IN LIEU OF PROCESSING MODIFIED SOIL 12" WHERE PROPOSED PAVEMENT CC&G WIDTH IS LESS THAN 12'.

- ① STA 120+05.10 TO STA 137+35.00 - 18'
 STA 137+35.00 TO STA 148+14.17 - VARIES 1'-18'
 STA 148+14.17 TO STA 149+62.25 - 18'
- ② STA 120+05.10 TO STA 137+03.65 - 18'
 STA 137+03.65 TO STA 146+83.74 - VARIES 12'-18'
 STA 146+83.74 TO STA 149+62.25 - 18'
- ③ STA 120+05.10 TO STA 128+50.00 - 2'
 STA 128+50.00 TO STA 143+00.00 - 8'
 STA 143+00.00 TO STA 147+50.00 - 2'
 STA 147+50.00 TO STA 149+62.25 - 8'
- ④ STA 126+00.00 TO STA 133+71.44 - VARIES 0'-25'

MODEL: PR_Typical_03
 FILE NAME: 11/17/22 - ESPE WIDENING PHASE 2\CADD\Microstation\CADD Drawings\17032-shc-typical.dgn



USER NAME = scott.felot	DESIGNED -	REVISED -
PLOT SCALE = 2.0000' / in.	DRAWN -	REVISED -
PLOT DATE = 2/28/2022	CHECKED -	REVISED -
	DATE -	REVISED -

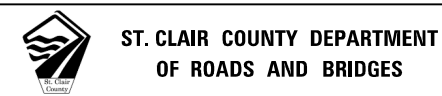

PROPOSED TYPICAL SECTIONS	
SCALE:	SHEET NO. 3 OF 3 SHEETS STA. 120+05.10 TO STA. 149+62.25

F.A.U. RTE.	SECTION	COUNTY	TOTAL SHEETS	SHEET NO.
9330	13-00301-15-PW	ST. CLAIR	251	16
ILLINOIS FED. AID PROJECT			CONTRACT NO. 97752	

SIGN

STATION	OFFSET	TYPE	DESCRIPTION	SIZE (IN X IN)	SIGN PANEL T1 (SQ FT)	REMOV SIN PAN ASSY TA (EACH)	METAL POST TY B (NOTE 1) (FOOT)	RELOC SIGN PANEL T1 (SQ FT)
55+39	RT	W9-2	LANE ENDS MERGE LEFT	36 X 36		1		
59+51	LT	R1-1	STOP SIGN	30 X 30			13.5	6.3
59+95	LT	D3-1	STREET SIGN	24 X 12			12	2
60+49	RT	R2-1	SPEED LIMIT	30 X 36	7.5		14	
61+22	LT	W3-3	SIGNAL AHEAD	30 X 30			14.5	6.3
62+50	RT	R3-9b	TWO-WAY LEFT TURN ONLY	24 X 36	6		14	
63+56	LT	R1-1	STOP SIGN	30 X 30			13.5	6.3
66+05	LT	W14-3	NO PASSING ZONE	48 X 36		1		
70+50	LT	R3-9b	TWO-WAY LEFT TURN ONLY	24 X 36	6		14	
70+50	RT	R3-9b	TWO-WAY LEFT TURN ONLY	24 X 36	6		14	
83+00	LT	R3-9b	TWO-WAY LEFT TURN ONLY	24 X 36	6		14	
83+00	RT	R3-9b	TWO-WAY LEFT TURN ONLY	24 X 36	6		14	
83+70	RT	W14-3	NO PASSING ZONE	48 X 36		1		
93+00	LT	R3-9b	TWO-WAY LEFT TURN ONLY	24 X 36	6		14	
93+00	RT	R3-9b	TWO-WAY LEFT TURN ONLY	24 X 36	6		14	
94+15	RT		SHILOH POPULATION SIGN				14	3
103+50	RT	R3-9b	TWO-WAY LEFT TURN ONLY	24 X 36	6		14	
107+50	LT	R2-1	SPEED LIMIT	30 X 36	7.5		14	
109+00	LT	W9-2	LANE ENDS MERGE LEFT	36 X 36		1		
112+36	RT	W9-2	LANE ENDS MERGE LEFT	36 X 36		1		
112+75	RT	R2-1	SPEED LIMIT	30 X 36	7.5		14	
116+00	RT	R3-9b	TWO-WAY LEFT TURN ONLY	24 X 36	6		14	
126+75	LT	R3-9b	TWO-WAY LEFT TURN ONLY	24 X 36	6		14	
126+75	RT	R3-9b	TWO-WAY LEFT TURN ONLY	24 X 36	6		14	
128+53	RT	R1-1	STOP SIGN	30 X 30			13.5	6.3
128+60	RT	D3-1	STREET SIGN	24 X 12			12	2
128+83	RT	W14-3	NO PASSING ZONE	48 X 36		1		
129+47	RT	D3-1	STREET SIGN	24 X 12			14.5	2
136+59	LT	W14-3	NO PASSING ZONE	48 X 36		1		
136+75	LT	R3-9b	TWO-WAY LEFT TURN ONLY	24 X 36	6		14	
136+75	RT	R3-9b	TWO-WAY LEFT TURN ONLY	24 X 36	6		14	
142+80	RT		TRAFFIC SIGNAL STREET SIGN					4
143+80	RT		TRAFFIC SIGNAL STREET SIGN					4
143+50	RT		TRAFFIC SIGNAL STREET SIGN					4
147+25	LT	R3-9b	TWO-WAY LEFT TURN ONLY	24 X 36	6		14	
147+25	RT	R3-9b	TWO-WAY LEFT TURN ONLY	24 X 36	6		14	
154+00	LT	R2-1	SPEED LIMIT	30 X 36	7.5		14	
157+30	LT	R3-1100	RIGHT TURN LANE	24 X 24	4		14	
TOTAL:					124.0	7	387.5	46.2

SIGN NOTES:

- UN-USED SIGNS OWNED BY S.C.C.H.D. SHALL BE GIVEN TO THE ENGINEER FOR RETURN TO THE HIGHWAY DEPARTMENT.

ENTRANCE

STATION (NOTE 1)	OFFSET	ENTRANCE TYPE	ENTRANCE WIDTH "W" (NOTE 1) (FOOT)	ENTRANCE DEPTH "D" (FOOT)	EXISTING SURFACE TYPE	AGG BASE CSE A 4 (SQ YD)	AGG BASE CSE B 4 (SQ YD)	AGG BASE CSE B 6 (SQ YD)	BIT MATLS TACK CT (POUND)	INCIDENTAL HMA SURF (TON)	PCC DRIVEWAY PAVT 6 (NOTE 2) (SQ YD)	PCC DRIVEWAY PAVT 8 (NOTE 2) (SQ YD)	DRIVEWAY PAVEMENT REM (SQ YD)
59+62.6	RT	P.E.	22	6	AGG		13				19		24
63+73.3	LT	C.E.	24		ASPH								90
69+87.6	RT	P.E.	12	17	ASPH	21			10	3	11		47
74+38.6	RT	P.E.	12	17	AGG		8				11		33
77+25.6	RT	P.E.	12	41	ASPH	44			20	5	12		50
77+56.5	LT	P.E.	12	6	AGG		8				11		
80+72.7	RT	P.E.	20	11	ASPH	16			7	2	13		20
81+91.6	RT	C.E.	30	11	AGG			46				22	
83+43.6	RT	P.E.	20	10	AGG		16				17		
84+40.7	RT	F.E.	20		EARTH						17		
85+51.7	RT	P.E.	35		CONC						27		41
85+66.5	LT	F.E.	20		EARTH						17		
86+60.0	LT	F.E.	20		EARTH						17		
86+87.6	RT	P.E.	22	14	AGG		26				18		
87+88.5	LT	P.E.	24	29	AGG		60				17		
88+33.5	RT	P.E.	20	18	AGG		33				17		
92+08.4	LT	P.E.	12	22	AGG		30				11		
93+17.8	RT	P.E.	12	13	CONC						33		40
101+48.7	LT	P.E.	12	4	AGG		6				11		
101+61.8	RT	P.E.	12	17	AGG		20				12		
102+43.3	RT	P.E.	12	7	AGG		12				12		
104+86.2	LT	P.E.	12	6	ASPH	8			4	1	5		22
115+79.8	LT	C.E.	32		AGG							79	79
117+14.0	RT	C.E.	30		ASPH							142	171
117+40.9	LT	C.E.	24		ASPH							63	108
118+21.8	LT	C.E.	24		ASPH							66	141
120+69.0	LT	P.E.	24		AGG						19		
121+00.0	RT	C.E.	30		ASPH							81	185
122+66.4	LT	P.E.	12		CONC						11		41
123+09.7	LT	P.E.	12		AGG						11		
124+51.9	LT	P.E.	12	8	AGG		11				11		
124+63.9	RT	C.E.	30		ASPH							113	207
142+00.0	RT	F.E.	16		EARTH						14		
HARTMAN LANE ENTRANCE		C.E.	40		ASPH							87	
TOTAL						89	243	46	41	11	374	653	1,299

ENTRANCE NOTES:

- SEE CONSTRUCTION DETAILS SHEET FOR ENTRANCE DETAILS.
- DEPRESSED CURB AND GUTTER THROUGH ENTRANCES SHALL BE MEASURED FOR PAYMENT AS COMBINATION CONCRETE CURB AND GUTTER, TYPE B-6.24.
- APPLICATION RATES USED FOR QUANTITY ESTIMATES ARE AS FOLLOWS:
BITUMINOUS MATERIALS (TACK COAT): 0.05
INCIDENTAL HMA SURFACING: 0.05556

TEMPORARY PAVEMENT MARKING

STATION	STATION	TEMP PVT MK LTR & SYM PNT (SQ FT)	TEMP PVT MK LINE 4 PNT (FOOT)	TEMP PAVT MK LINE 24 PNT (FOOT)	PAVMT MRKG REM WTR BL (SQ FT)
STAGE 3					
56+50	102+50		19,560		6,520
114+50	118+65	16	16,761	22	5,587
STAGE 4					
56+50	108+30	16	21,349		7,116
114+00	152+25	16	18,801	12	6,291
TOTAL		48	76,471	34	25,514

TEMP PAVT MK NOTES:

- TEMPORARY PAVEMENT MARKINGS SHALL BE REMOVED BY WATER BLASTING. NO GRINDING OF TEMPORARY PAVEMENT MARKINGS WILL BE ALLOWED.

PAVEMENT MARKING

STATION	STATION	SHORT TERM PAVT MKING (FOOT)	SHRT TRM PAVT MK REM (SQ FT)	POLYUREA PM T1 LTR-SYM (NOTE 1) (SQ FT)	POLYUREA PM T1 LN 4 (NOTE 1) (FOOT)	POLYUREA PM T1 LN 12 (NOTE 1) (FOOT)	POLYUREA PM T1 LN 24 (NOTE 1) (FOOT)	PAVMT MRKG REM WTR BL (SQ FT)
57+49	75+79	861	290	187.2	4,157		34	2,211
75+79	95+52	1198	400	249.6	6,087	54		2,580
95+52	107+00	662	226	124.8	3,330		14	1,027
115+86	128+26	746	253	156.0	3,810			1,953
128+26	139+78	773	259	124.8	3,384	81	13	1,466
139+78	158+92	876	297	124.8	6,132	112	103	2,782
TOTAL		5,116	1,725	967.2	26,900	247	164	12,019

PAVEMENT MARKING NOTES:

- SEE HIGHWAY STANDARD 780001 FOR PAVEMENT MARKING DETAILS.
- ONE APPLICATION OF SHORT TERM PAVEMENT MARKINGS WAS FIGURED FOR ABOVE QUANTITY.

EARTHWORK

STATION	STATION	EARTH EXCAVATION (CU YD)	EARTH EXCAVATION ADJUSTED FOR SHRINKAGE (NOTE 1) (CU YD)	EMBANKMENT (NOTE 2) (CU YD)	EARTHWORK BALANCE WASTE (+) OR SHORTAGE (-) (NOTE 3) (CU YD)
57+40	107+00	9,620	5,845	10,190	3,490
114+50	149+62	7,795	7,215	3,725	-4,345
TOTAL		17,415	13,060	13,915	-855

EARTHWORK NOTES:

- ESTIMATED SHRINKAGE FACTOR = 25%.
- APPROXIMATE EMBANKMENT QUANTITY IS SHOWN FOR INFORMATION ONLY.
- APPROXIMATE EARTHWORK BALANCE IS SHOWN FOR INFORMATION ONLY.

MODEL: D:\p\h\... FILE NAME: P17032 - ESSE WIDENING PHASE 2\CADD\Microstation\CADD - Drawings\17032-esse-schedule.dgn



USER NAME = scott.felot
DESIGNED -
DRAWN -
PLOT SCALE = 100.0000' / in.
CHECKED -
DATE -
PLOT DATE = 2/28/2022

DESIGNED -
DRAWN -
CHECKED -
DATE -
REVISED -
REVISED -
REVISED -
REVISED -

REVISED -
REVISED -
REVISED -
REVISED -



**ST. CLAIR COUNTY DEPARTMENT
OF ROADS AND BRIDGES**

SCALE: SHEET 2 OF 9 SHEETS STA. TO STA.

F.A.U. RTE. 9330 SECTION 13-00301-15-PW COUNTY ST. CLAIR TOTAL SHEETS 251 SHEET NO. 18 CONTRACT NO. 97752 ILLINOIS FED. AID PROJECT

- NOTES:**
1. THE PRECAST MODULAR RETAINING WALL LAYOUT AND CONCRETE STEPS IS SHOWN FOR INFORMATIONAL BIDDING PURPOSES ONLY. THE CONTRACTOR IS RESPONSIBLE FOR TO COMPLETE THE FINAL LAYOUT AND DESIGN AS PART OF THE CONSTRUCTION CONTRACT.
 2. THE DESIGN SHALL BE COMPLETED BY A STRUCTURAL ENGINEER LICENSED IN THE STATE OF ILLINOIS.
 3. THE BLOCK WALL SHALL BE ACCORDING TO SECTION 522 OF THE STANDARD SPECIFICATIONS FOR PRECAST MODULAR RETAINING WALL SYSTEMS, EXCEPT THE DESIGN SHALL BE ACCORDING TO THE INTERNATIONAL BUILDING CODE CURRENTLY ADOPTED BY ST. CLAIR COUNTY, ILLINOIS. MAXIMUM ALLOWABLE BEARING PRESSURE SHALL BE 1,500 PSF.
 4. ALL CAST-IN-PLACE CONCRETE SHALL BE ACCORDING TO SECTION 503 OF THE STANDARD SPECIFICATIONS.

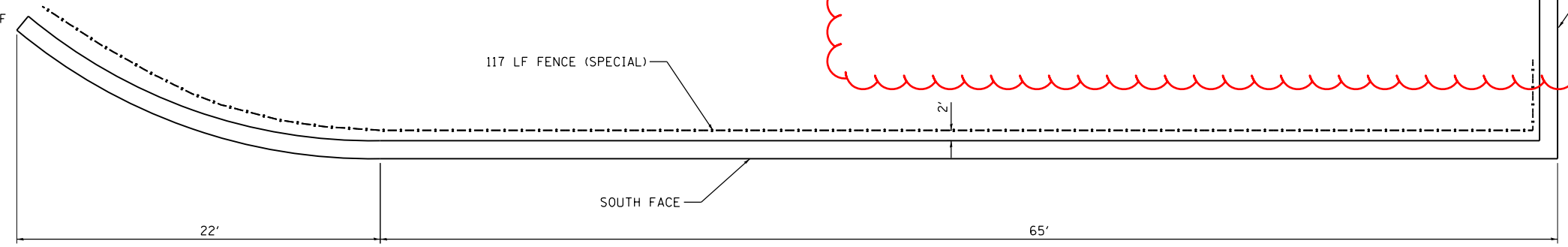
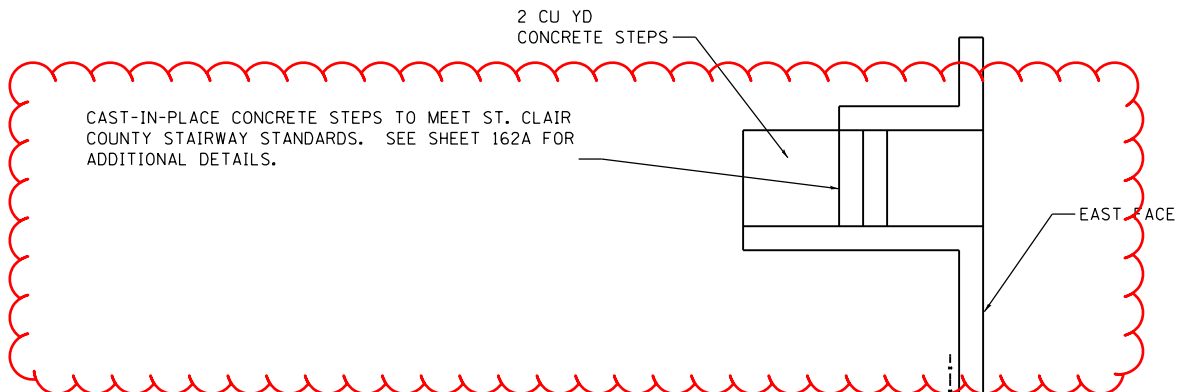

PLAN VIEW

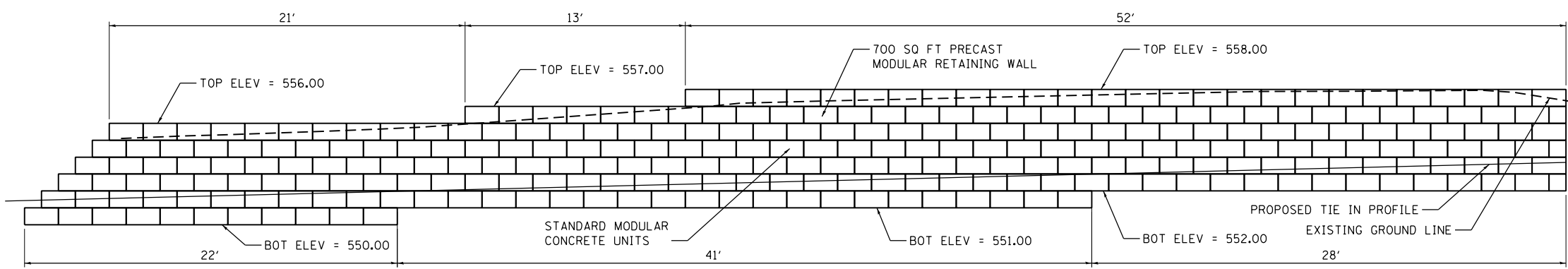

SOUTH FACE

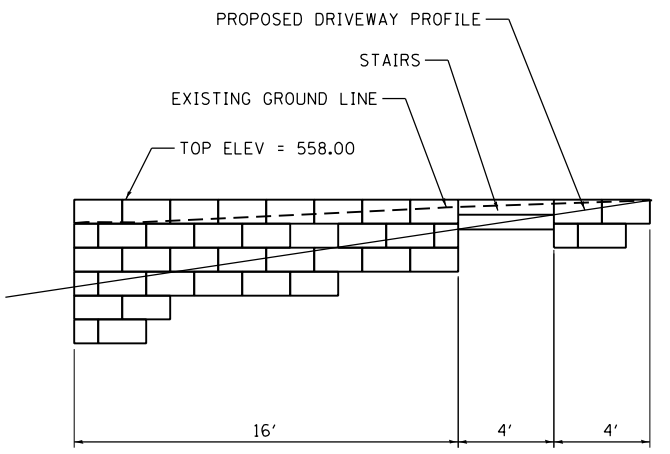

EAST FACE

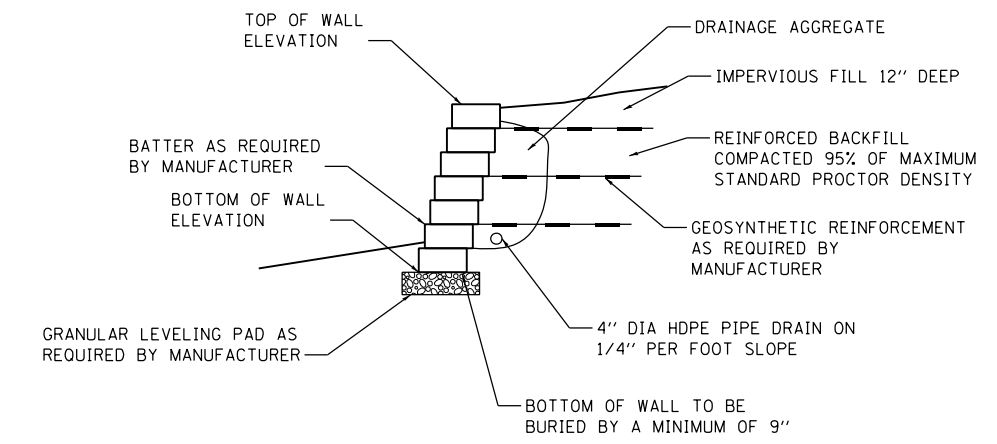

RETAINING WALL DETAIL
NOT TO SCALE

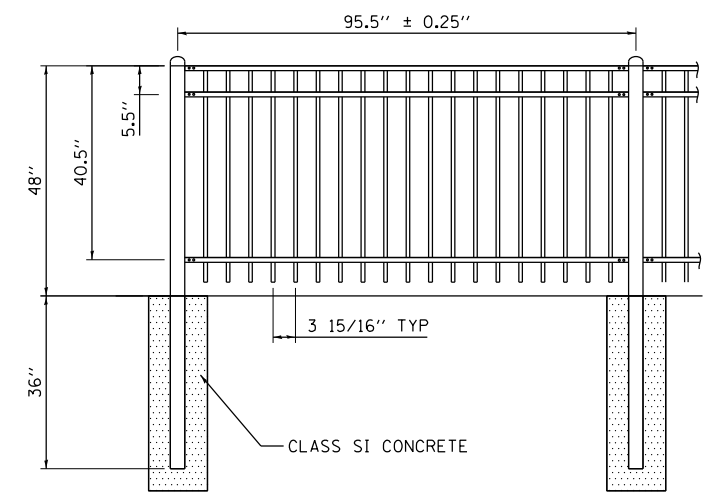

FENCE (SPECIAL) DETAIL
NOT TO SCALE

MODEL: Cover Sheet
FILE NAME: PL17032 - ESBE WIDENING PHASE 2\CADD\Microstation\CADD Drawings\17032-shc-details.dgn



USER NAME = scott.felot
PLOT SCALE = 40.0000 ' / in.
PLOT DATE = 2/28/2022

DESIGNED -	REVISED -
DRAWN -	REVISED -
CHECKED -	REVISED -
DATE -	REVISED -



ST. CLAIR COUNTY DEPARTMENT OF ROADS AND BRIDGES

DETAILS			
SCALE:	SHEET 5 OF 7 SHEETS	STA.	TO STA.

F.A.U. RTE.	SECTION	COUNTY	TOTAL SHEETS	SHEET NO.
9330	13-00301-15-PW	ST. CLAIR	251	162
CONTRACT NO. 97752				
ILLINOIS FED. AID PROJECT				

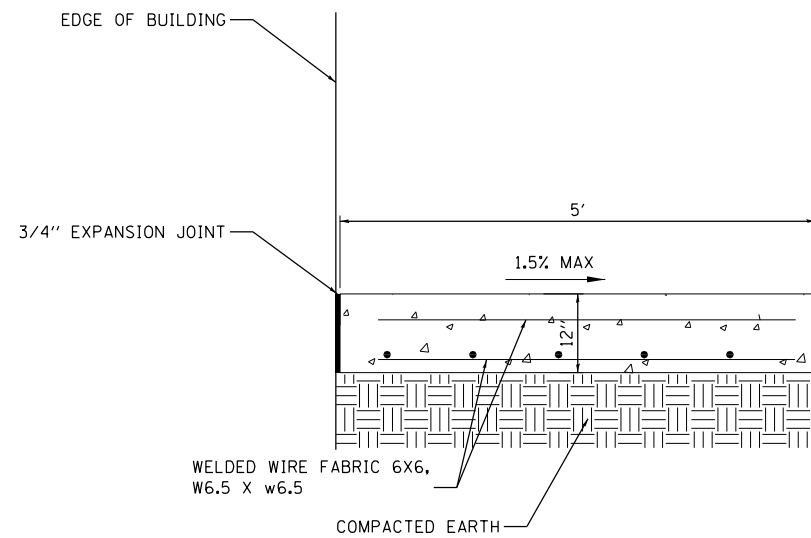

WEST FACE

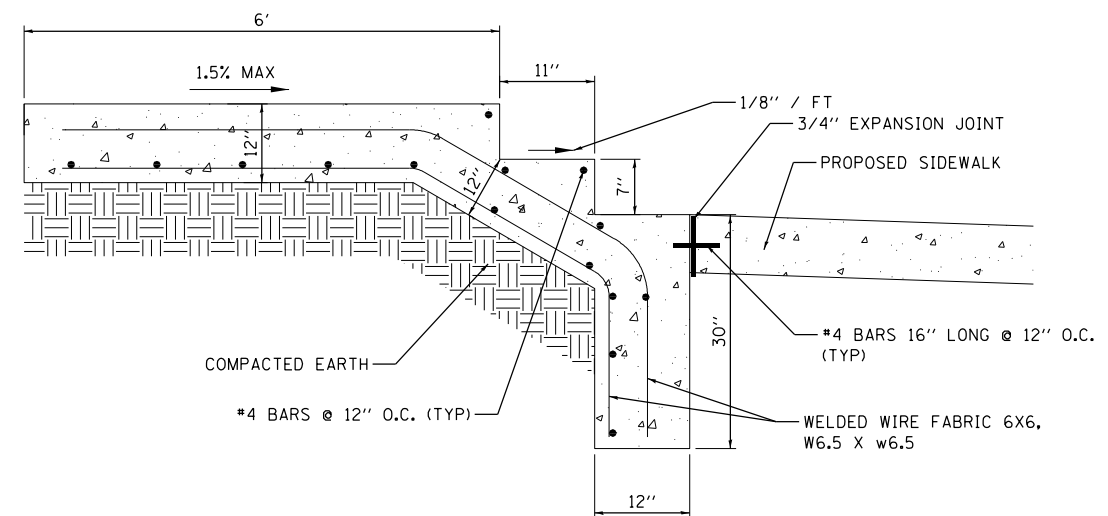

SOUTH FACE

CONCRETE STEPS DETAIL

NOT TO SCALE

NOTES:

1. DIMENSIONS FROM TREAD TO TREAD AND RISER TO RISER SHALL NOT VARY BY MORE THAN 1/4" PER SET OF STEPS. PLAN DIMENSIONS SHALL BE VERIFIED IN THE FIELD PRIOR TO CONSTRUCTION.
2. REINFORCING BARS SHALL BE EPOXY COATED. REINFORCEMENT WILL NOT BE PAID FOR SEPARATELY.
3. CONCRETE STEPS SHALL BE CONSTRUCTED OF 4,500 PSI CONCRETE.
4. A MINIMUM OF 2" SHALL BE MAINTAINED BETWEEN THE FACE OF CONCRETE AND THE NEAREST EDGE OF ALL REINFORCEMENT.
5. DIMENSIONS FOR HANDRAIL CONSTRUCTION AND TREAD AND RISERS TO BE VERIFIED PRIOR TO CONSTRUCTION.
6. EXPANSION JOINT SHALL BE PLACED WHERE STAIRS ARE ADJACENT TO CONCRETE LANDING AND AT STRUCTURES.
7. CONCRETE STEPS SHOWN FOR INFORMATIONAL BIDDING PURPOSES ONLY. THE CONTRACTOR IS RESPONSIBLE FOR THE COMPLETE AND FINAL DESIGN AS PART OF THE CONTRACT.

MODEL: Concrete Steps.dwg
FILE NAME: P:\17032 - ESSE WIDENING PHASE 2\CADD\Microstation\CADD Drawings\17032-ESSE.dwg



USER NAME = scott.feldt	DESIGNED -	REVISED -
PLOT SCALE = 40.0000 ' / in.	DRAWN -	REVISED -
PLOT DATE = 2/28/2022	CHECKED -	REVISED -
	DATE -	REVISED -



**ST. CLAIR COUNTY DEPARTMENT
OF ROADS AND BRIDGES**

DETAILS

SCALE: SHEET 5A OF 7 SHEETS STA. TO STA.

F.A.U. RTE.	SECTION	COUNTY	TOTAL SHEETS	SHEET NO.
9330	13-00301-15-PW	ST. CLAIR	251	162A
CONTRACT NO. 97752				
ILLINOIS FED. AID PROJECT				