

FILE NAME = G:\projects\2102185_0065\CA003\Structure\0160367_520_55_004_Approach Slab.dgn

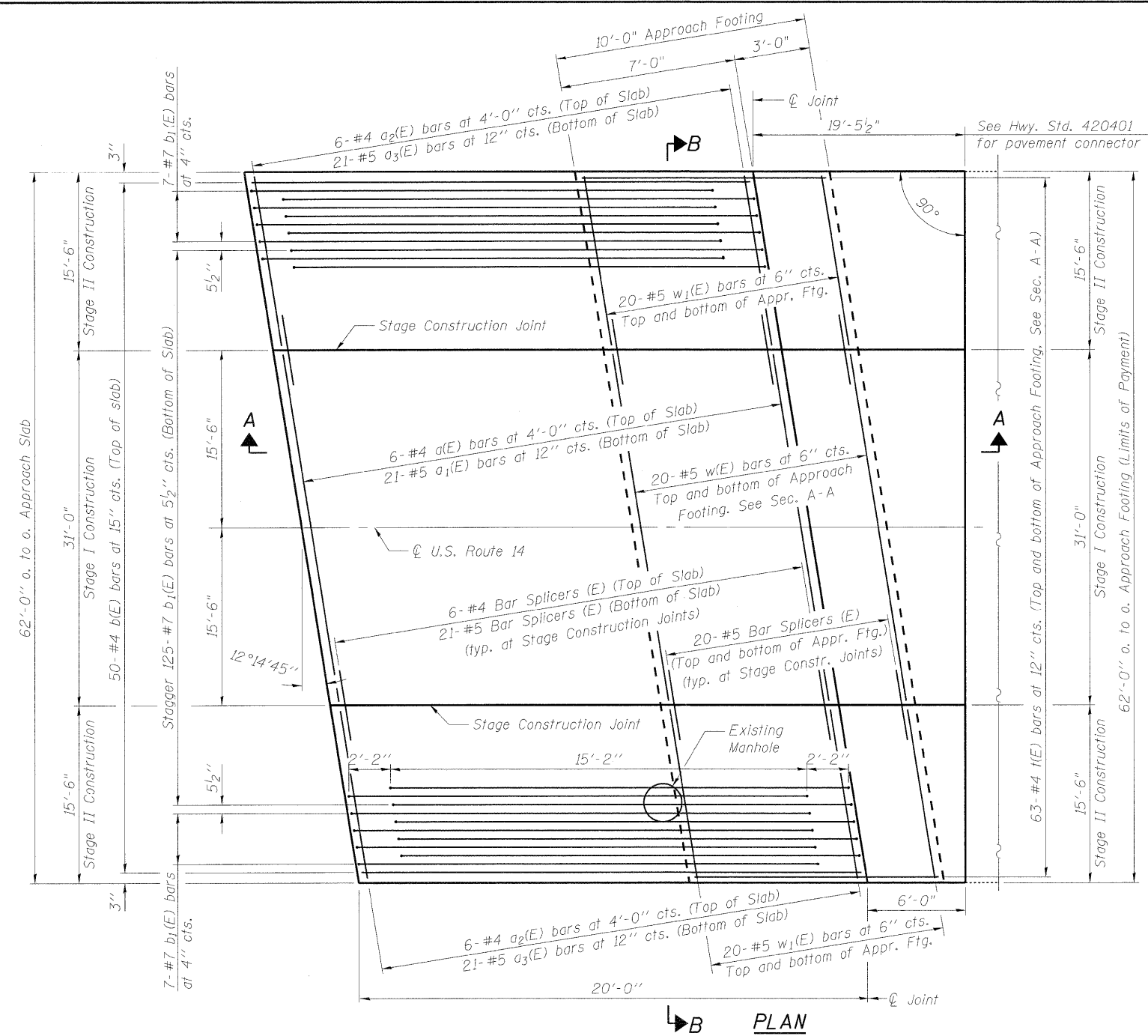

PLAN

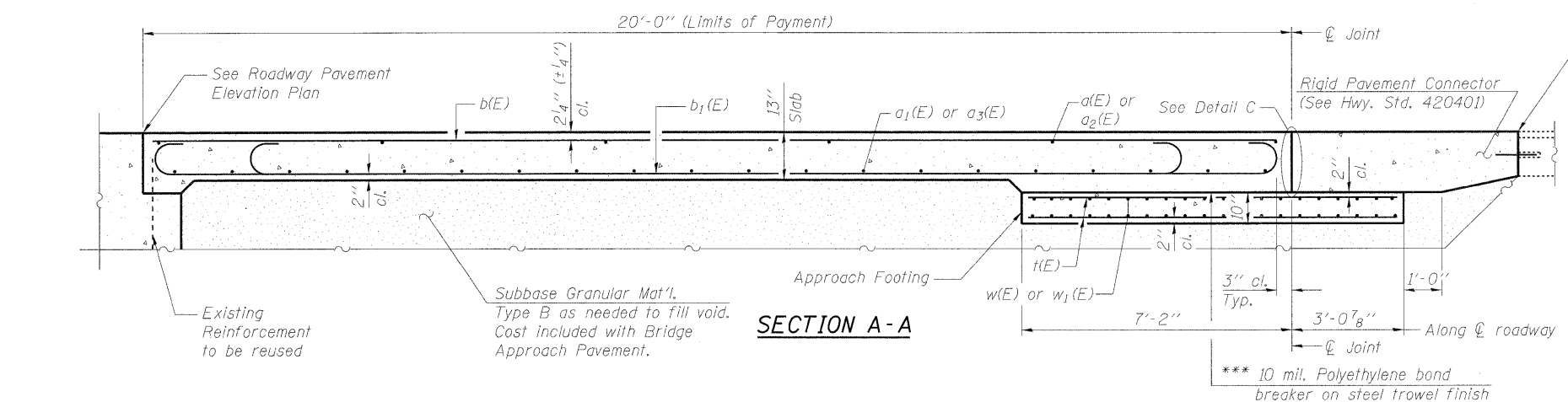

SECTION A-A

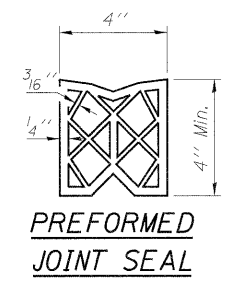

PREFORMED JOINT SEAL

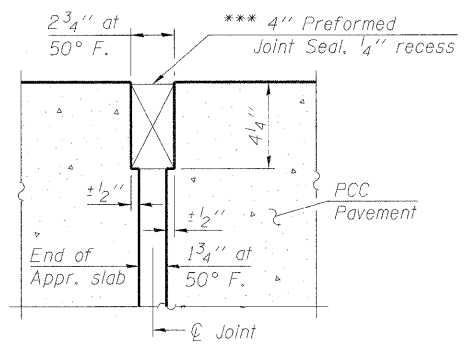

DETAIL C

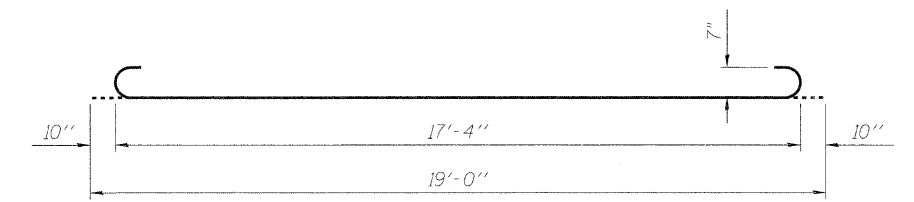

BAR b₁(E)

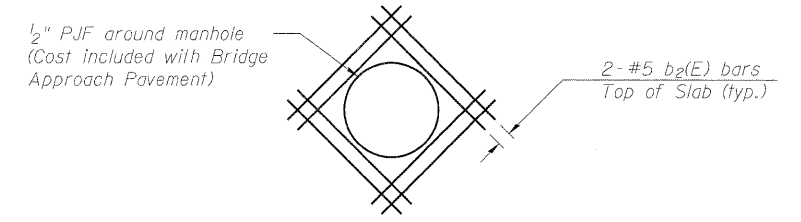

DETAIL AT MANHOLE

Notes:
 Cost of concrete, reinforcement, subbase granular material, and bar splicers for Bridge Approach Pavement and approach footing and excavation for approach footing included with Bridge Approach Pavement.
 The approach footing maximum applied service bearing pressure (Q_{max}) = 2.0 ksf.
 For bar splicer details, see Sheet S5.

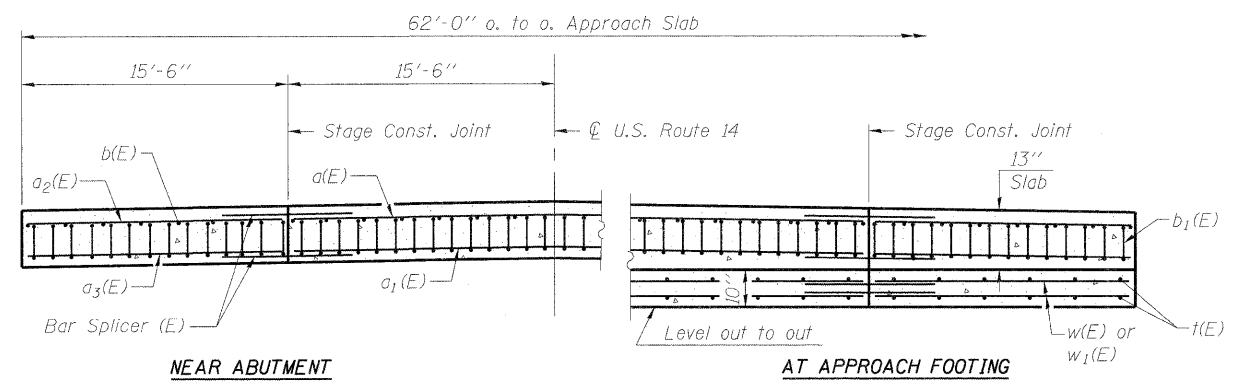

SECTION B-B

BILL OF MATERIAL

Description	Unit	Quantity
Bridge Approach Pavement	Sq. Yd.	138
Protective Coat	Sq. Yd.	226
Approach Slab Removal	Sq. Yd.	184

* Includes Pavement Connector.

*** Cost included with Bridge Approach Pavement

ESTIMATED QUANTITIES
 (for information only)

Bar	No.	Size	Length	Shape
a(E)	6	#4	31'-4"	—
a ₁ (E)	21	#5	31'-4"	—
a ₂ (E)	12	#4	15'-6"	—
a ₃ (E)	42	#5	15'-6"	—
b(E)	50	#4	19'-8"	—
b ₁ (E)	139	#7	19'-0"	—
b ₂ (E)	8	#5	4'-0"	—
t(E)	126	#4	9'-10"	—
w(E)	40	#5	31'-4"	—
w ₁ (E)	80	#5	15'-6"	—
Reinforcement Bars, Epoxy Coated		Pound		11,130



USER NAME = zsoyerb
 DESIGNED - BHS
 CHECKED - GSP
 PLOT SCALE = N/A
 DRAWN - MJB
 CHECKED - GSP
 PLOT DATE = 3/1/2011

DESIGNED - BHS
 CHECKED - GSP
 DRAWN - MJB
 CHECKED - GSP

REVISED -
 REVISED -
 REVISED -
 REVISED -

**STATE OF ILLINOIS
 DEPARTMENT OF TRANSPORTATION**

**EAST APPROACH SLAB RECONSTRUCTION
 S.N. 016-0367**

SHEET NO. 54 OF 6 SHEETS

F.A.P. RTE.	SECTION	COUNTY	TOTAL SHEETS	SHEET NO.
0341	2010-070-1	COOK	18	10
CONTRACT NO. 60L55				
FED. ROAD DIST. NO. 1 ILLINOIS FED. AID PROJECT				