

NOTE: 1.) THE SURFACE SHALL BE FINISHED ACCORDING TO ARTICLE 420.09(e)(2).  
 2.) THE TIE BARS REQUIRED FOR THIS WORK SHALL BE INCLUDED IN THE COST OF THE PCC BASE COURSE PAY ITEM.

**MEDIAN REMOVAL DETAIL**

EXIST. CURVE CUR40 @ NEW BUS 50  
 PI STA. = 497+73.51  
 $\Delta = 45^\circ 24' 50''$  (RT)  
 $D = 23^\circ 17' 06''$   
 $R = 246.06'$   
 $T = 102.97'$   
 $L = 195.03'$   
 $E = 20.67'$   
 P.C. STA. = 496+70.54  
 P.T. STA. = 498+65.58

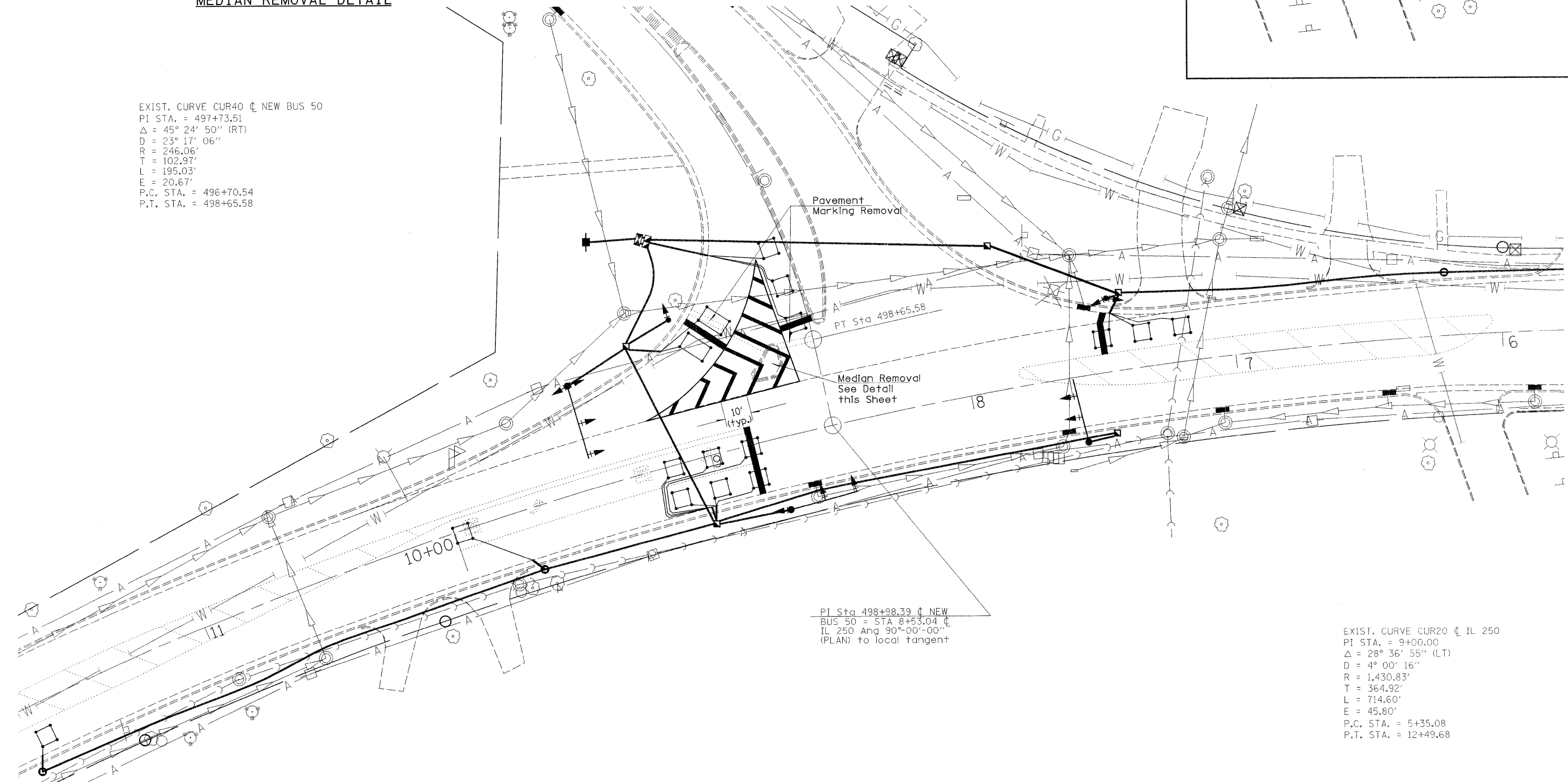
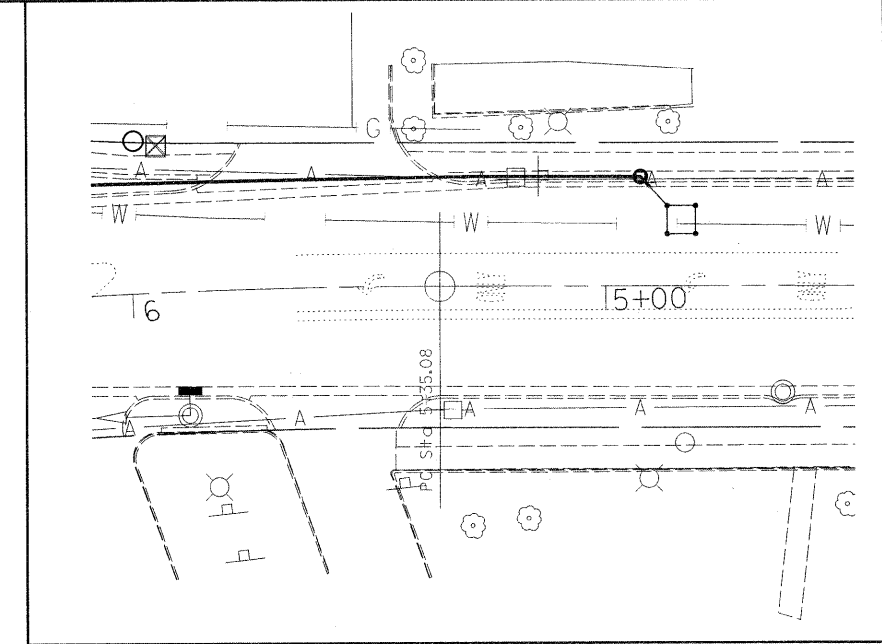

PI Sta 498+98.39 @ NEW  
 BUS 50 = STA 8+53.04 @  
 IL 250 Ang 90°-00'-00''  
 (PLAN) to local tangent

EXIST. CURVE CUR20 @ IL 250  
 PI STA. = 9+00.00  
 $\Delta = 28^\circ 36' 55''$  (LT)  
 $D = 4^\circ 00' 16''$   
 $R = 1,430.83'$   
 $T = 364.92'$   
 $L = 714.60'$   
 $E = 45.80'$   
 P.C. STA. = 5+35.08  
 P.T. STA. = 12+49.68

FILE NAME =	USER NAME = mcllennla	DESIGNED -	REVISED -	<b>STATE OF ILLINOIS DEPARTMENT OF TRANSPORTATION</b>	<b>PROPOSED SIGNAL LAYOUT WITH EXISTING UTILITIES ISLAND REMOVAL &amp; PAVEMENT MARKING</b>	F.A.S. RTE.	SECTION	COUNTY	TOTAL SHEETS	SHEET NO.	
ca:\pw_work\pwidot\mcllennla\d0196565\d	774480-TS-sht.dgn	DRAWN -	REVISED -			1809	(22)TS-1	LAWRENCE	12	5	
	PLOT SCALE = 20,0000 ' / IN.	CHECKED -	REVISED -			CONTRACT NO. 74480					
	PLOT DATE = 12/30/2018	DATE -	REVISED -			ILLINOIS FED. AID PROJECT					
					SCALE:	SHEET NO. OF SHEETS		STA. TO STA.			