

NORTHWEST CORNER
125TH STREET AND PAULINA DRIVE

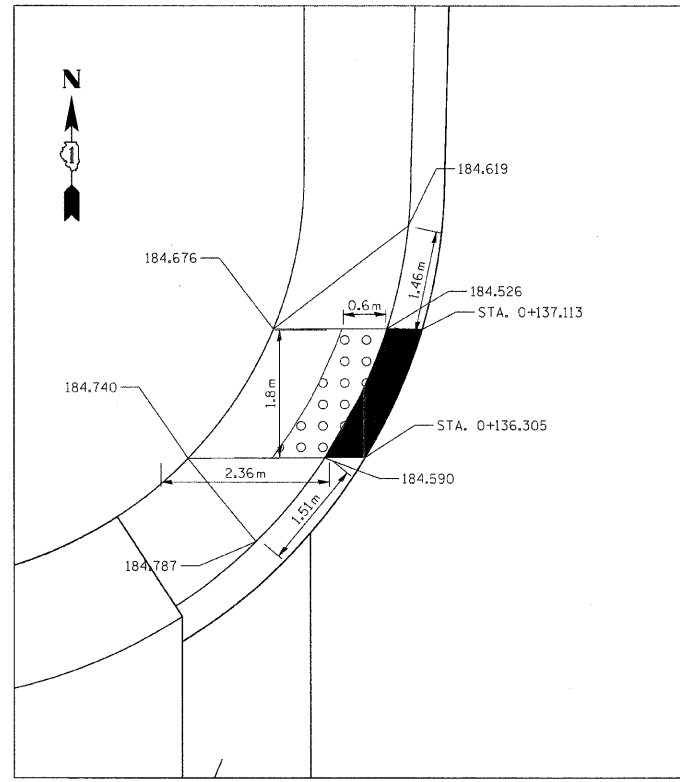

NORTHWEST CORNER
125TH STREET AND MARSHFIELD AVENUE

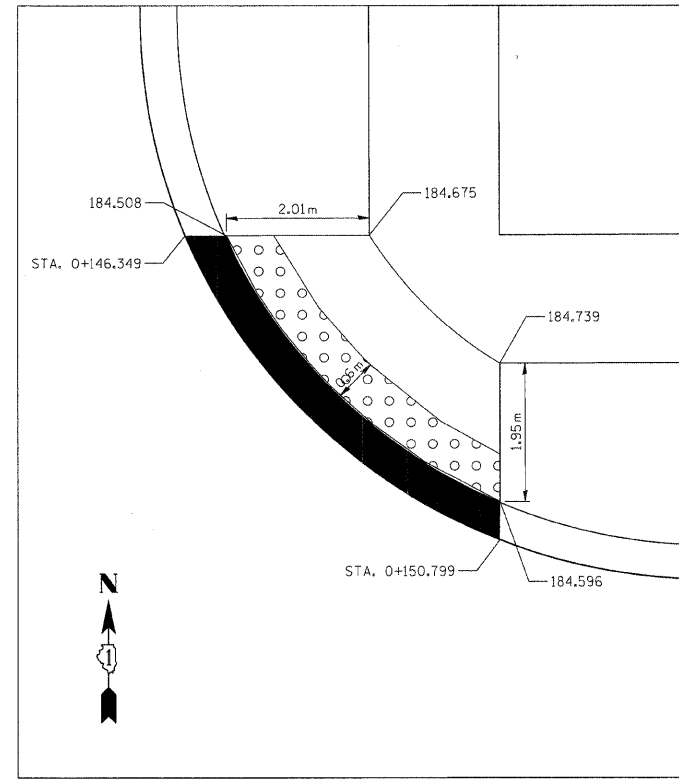

NORTHEAST CORNER
125TH STREET AND MARSHFIELD AVENUE

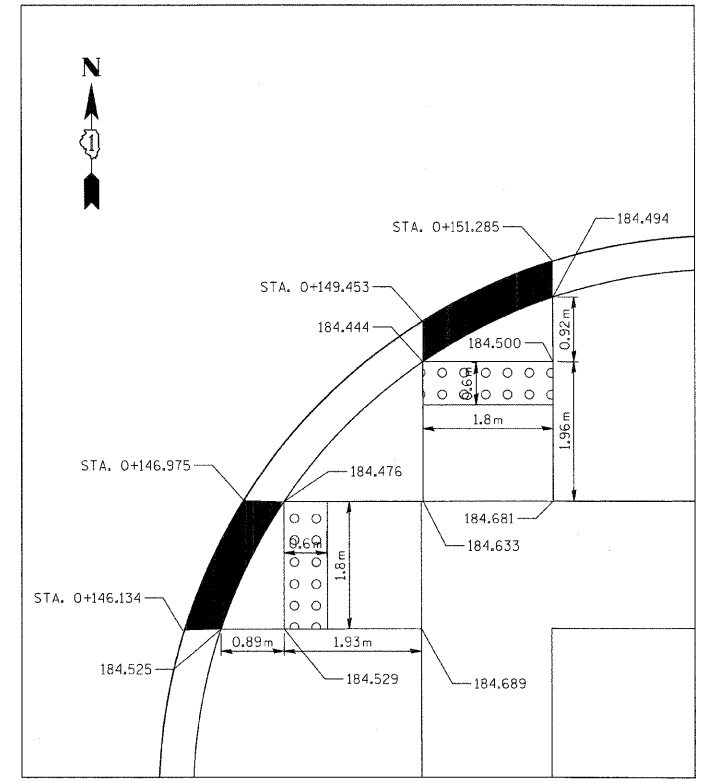

SOUTHEAST CORNER
125TH STREET AND MARSHFIELD AVENUE

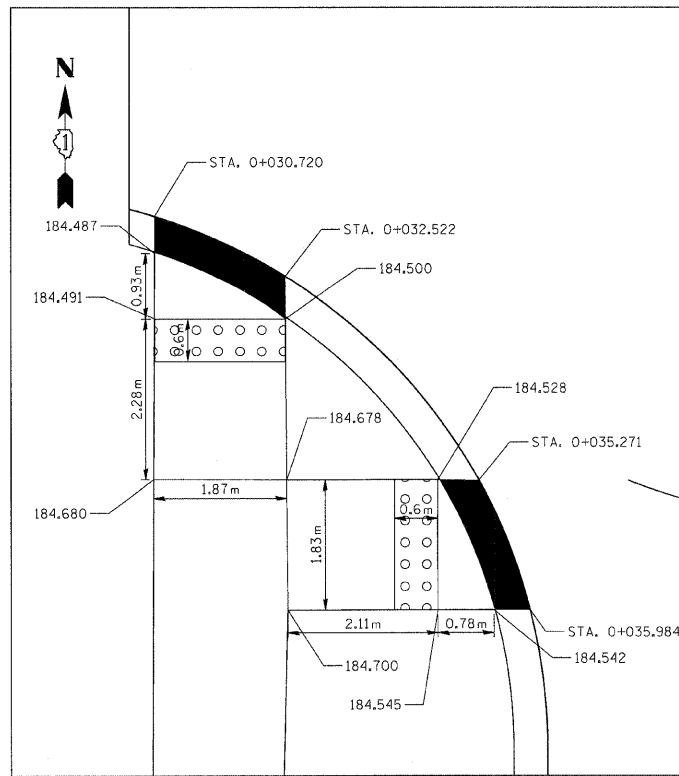

SOUTHWEST CORNER
125TH STREET AND PAULINA DRIVE

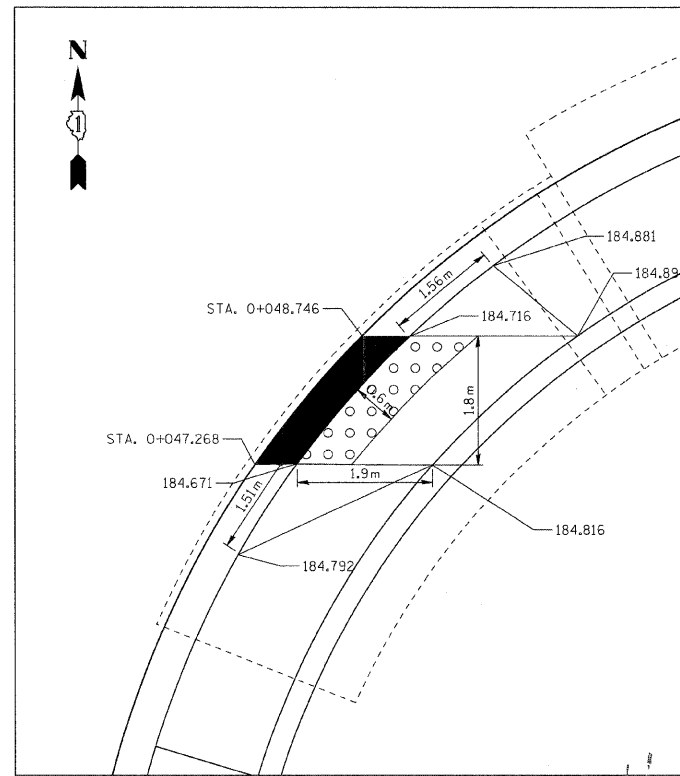

SOUTHEAST CORNER
125TH STREET AND PAULINA DRIVE

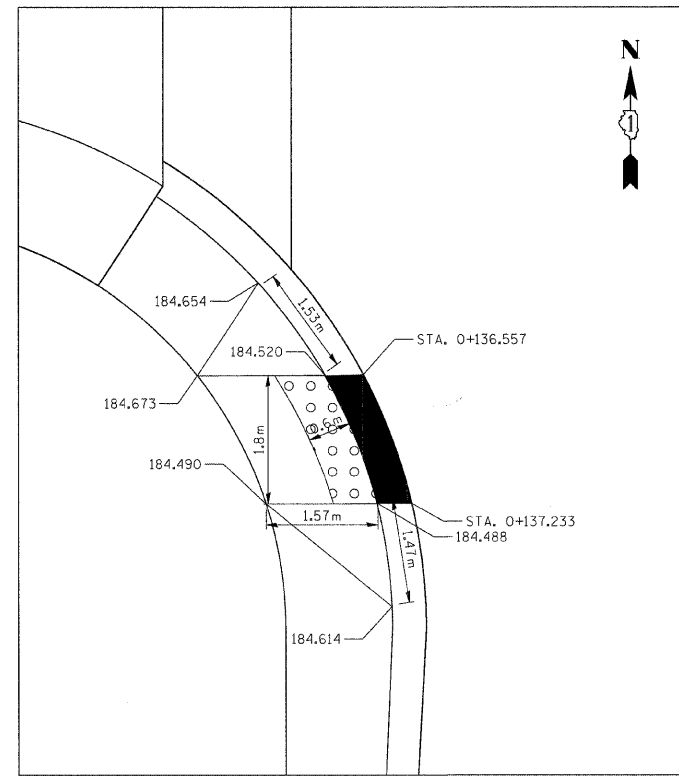

SOUTHWEST CORNER
125TH STREET AND MARSHFIELD AVENUE

DEPRESSED CURB

FILE NAME = n:\proj\3153\125th\design\Misc\Sheet\3153-125-ph-Sidewalk_12.dwg

Giorgio Group, Inc.
CONSULTING ENGINEERS
5507 North Cumberland Avenue, Suite 402
Chicago, Illinois 60656
Tel. 773.775.4009 Fax 773.775.4014

| | | |
|----------------------------|------------------|-----------|
| USER NAME = dnmorris | DESIGNED - WBL | REVISED - |
| PLOT SCALE = 0.250 m / MM. | DRAWN - WBL | REVISED - |
| PLOT DATE = 1/16/2009 | CHECKED - MJL | REVISED - |
| | DATE - 1/16/2009 | REVISED - |

STATE OF ILLINOIS
DEPARTMENT OF TRANSPORTATION

FAI 57/INTERSTATE 57
125TH STREET OVER I-57
SIDEWALK DETAILS

SCALE: SHEET NO. OF SHEETS STA. TO STA.

| F.A.I. RTE. | SECTION | COUNTY | TOTAL SHEETS | SHEET NO. |
|---|-----------|--------|--------------|-----------|
| 57 | 1818.3B-R | COOK | 58 | 13 |
| CONTRACT NO. 60862 | | | | |
| FED. ROAD DIST. NO. - ILLINOIS FED. AID PROJECT | | | | |