

NOTES:

- * - FOR N.B. LEMONT ROAD TO MAIN STREET AND WEST NEW AVENUE DETOUR SEE SHEET NO. 16.
- ** - FOR S.B. LEMONT ROAD TO E.B. EAST ILLINOIS STREET, McARTHY ROAD AND STEPHENS STREET DETOUR SEE SHEET NO. 16.
- *** - "WORKERS" SIGN WILL ONLY BE DISPLAYED WHEN WORKERS ARE PRESENT (TYP.)

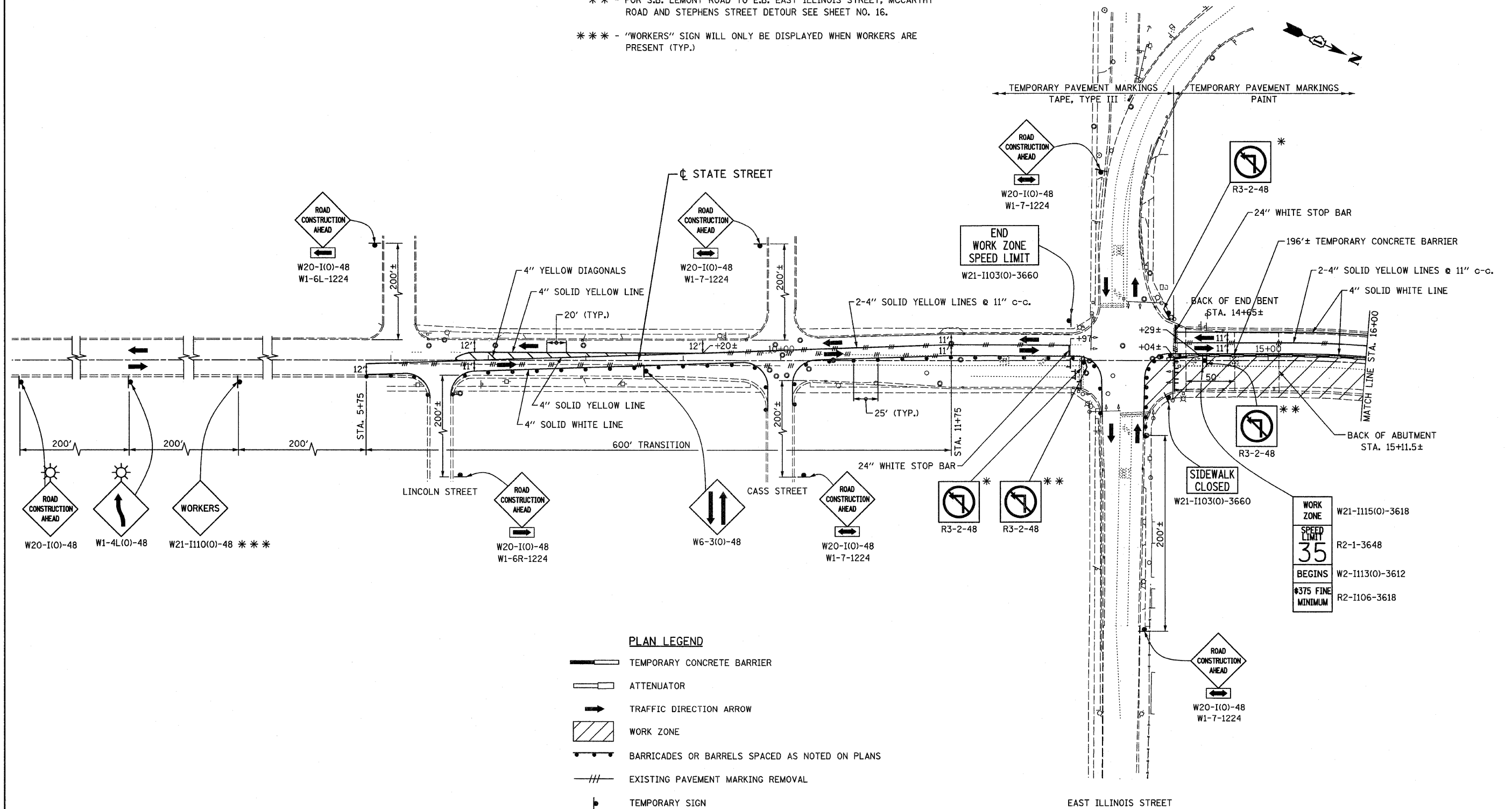

PLAN LEGEND

- TEMPORARY CONCRETE BARRIER
- ATTENUATOR
- TRAFFIC DIRECTION ARROW
- WORK ZONE
- BARRICADES OR BARRELS SPACED AS NOTED ON PLANS
- EXISTING PAVEMENT MARKING REMOVAL
- TEMPORARY SIGN

FILE NAME = 60076 etg1-01.dgn
PLOT DATE = 1/31/2009

CHRISTIAN-ROGE & ASSOCIATES, INC.
ENGINEERS-PLANNERS-SURVEYORS
211 WEST WACKER DRIVE
CHICAGO, ILLINOIS 60606
PHONE: (312)372-2023 FAX: (312)372-5274

DESIGNED - G.F.L.	REVISED -
DRAWN - B.K.	REVISED -
CHECKED - E.J.M.	REVISED -
DATE - JANUARY, 2009	REVISED -

**STATE OF ILLINOIS
DEPARTMENT OF TRANSPORTATION**

**SUGGESTED MAINTENANCE OF TRAFFIC - STAGE I
LEMONT ROAD**

SCALE: 1" = 50' SHEET NO. M3 OF M8 SHEETS STA. TO STA.

F.A.U. RTE. 2612	SECTION 3104 B-1-I-2	COUNTY COOK	TOTAL SHEETS 80	SHEET NO. 10
FED. ROAD DIST. NO. 1 ILLINOIS FED. AID PROJECT			CONTRACT NO. 60076	