

NOTE:
1. ALL TEMPORARY PAVEMENT MARKINGS THIS SHEET SHALL BE PAINT.

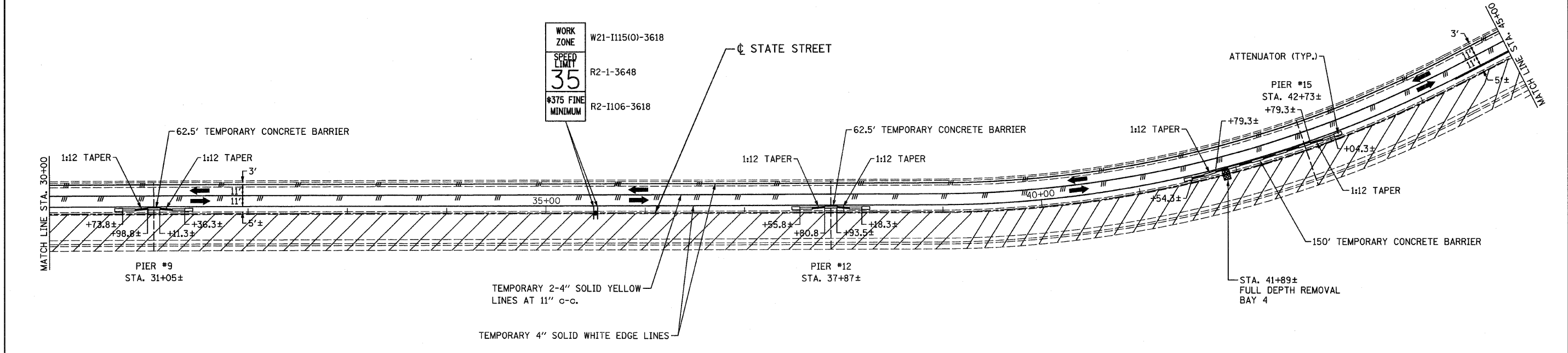

PLAN LEGEND

- TEMPORARY CONCRETE BARRIER
- ATTENUATOR
- TRAFFIC DIRECTION ARROW
- FULL DEPTH REPAIR
- CORRUGATED MEDIAN REPAIR
- EXISTING PAVEMENT MARKING REMOVAL

FILE NAME = 60076 stg1-02.dgn
PLOT DATE = 1/31/2009

CR CHRISTIAN-ROGE & ASSOCIATES, INC.
ENGINEERS-PLANNERS-SURVEYORS
211 WEST WACKER DRIVE
CHICAGO, ILLINOIS 60606
PHONE: (312)372-2023 FAX: (312)372-5274

DESIGNED - G.F.L.	REVISED -
DRAWN - B.K.	REVISED -
CHECKED - E.J.M.	REVISED -
DATE - JANUARY, 2009	REVISED -

**STATE OF ILLINOIS
DEPARTMENT OF TRANSPORTATION**

**SUGGESTED MAINTENANCE OF TRAFFIC - STAGE I
LEMONT ROAD**

SCALE: 1" = 50' SHEET NO. M4 OF M8 SHEETS STA. TO STA.

F.A.J. RTE.	SECTION	COUNTY	TOTAL SHEETS	SHEET NO.
2612	3104 B-1-I-2	COOK	80	11
FED. ROAD DIST. NO. 1 ILLINOIS FED. AID PROJECT			CONTRACT NO. 60076	